

NATIONAL REGISTER OF HISTORIC PLACES
INVENTORY - NOMINATION FORM

(Type all entries - complete applicable sections)

STATE: Maine	
COUNTY: Cumberland	
FOR NPS USE ONLY	
ENTRY NUMBER	DATE
	2/16/70

1. NAME

COMMON:
Songo Lock

AND/OR HISTORIC:

2. LOCATION

STREET AND NUMBER: On Songo River 3 miles east of Naples village on U.S. Rte 302 then 1 3/4 miles S. W.

CITY OR TOWN: Naples 04055 (1st District Hon. Peter N. Kyros)

STATE Maine	CODE 23	COUNTY: Cumberland	CODE 005
----------------	------------	-----------------------	-------------

3. CLASSIFICATION

CATEGORY (Check One)	OWNERSHIP	STATUS	ACCESSIBLE TO THE PUBLIC
<input type="checkbox"/> District <input type="checkbox"/> Building <input type="checkbox"/> Site <input checked="" type="checkbox"/> Structure <input type="checkbox"/> Object	<input checked="" type="checkbox"/> Public <input type="checkbox"/> Private <input type="checkbox"/> Both	<input type="checkbox"/> Occupied <input type="checkbox"/> Unoccupied <input checked="" type="checkbox"/> Preservation work in progress	Yes: <input type="checkbox"/> Restricted <input checked="" type="checkbox"/> Unrestricted <input type="checkbox"/> No
PRESENT USE (Check One or More as Appropriate)			
<input type="checkbox"/> Agricultural <input type="checkbox"/> Commercial <input checked="" type="checkbox"/> Educational <input checked="" type="checkbox"/> Entertainment	<input type="checkbox"/> Government <input type="checkbox"/> Industrial <input type="checkbox"/> Military <input type="checkbox"/> Museum	<input type="checkbox"/> Park <input type="checkbox"/> Private Residence <input type="checkbox"/> Religious <input type="checkbox"/> Scientific	<input checked="" type="checkbox"/> Transportation <input type="checkbox"/> Other (Specify) _____ _____ _____

4. OWNER OF PROPERTY

OWNER'S NAME: State of Maine (State Park and Recreation Commission)

STREET AND NUMBER: State Office Building

CITY OR TOWN: Augusta 04330 STATE: Maine CODE: 23

5. LOCATION OF LEGAL DESCRIPTION

COURTHOUSE, REGISTRY OF DEEDS, ETC.: Cumberland County Courthouse

STREET AND NUMBER:

CITY OR TOWN: Portland 04101 STATE: Maine CODE: 23

6. REPRESENTATION IN EXISTING SURVEYS

TITLE OF SURVEY:

DATE OF SURVEY: Federal State County Local

DEPOSITORY FOR SURVEY RECORDS:

STREET AND NUMBER:

CITY OR TOWN: STATE: CODE:

SEE INSTRUCTIONS

STATE: Maine
COUNTY: Cumberland
FOR NPS USE ONLY
ENTRY NUMBER
DATE

11/26/73 - copy received

7. DESCRIPTION

CONDITION	(Check One)					
	<input type="checkbox"/> Excellent	<input checked="" type="checkbox"/> Good	<input type="checkbox"/> Fair	<input type="checkbox"/> Deteriorated	<input type="checkbox"/> Ruins	<input type="checkbox"/> Unexposed
	(Check One)			(Check One)		
	<input checked="" type="checkbox"/> Altered	<input type="checkbox"/> Unaltered	<input type="checkbox"/> Moved	<input checked="" type="checkbox"/> Original Site		

DESCRIBE THE PRESENT AND ORIGINAL (If known) PHYSICAL APPEARANCE

LOCATION AND SETTING:

This canal lock structure is located midway of the Songo River as it flows south between Long Lake on the north and Sebago Lake on the south. This river area lies within the town of Naples, which is 27 miles northwest of Portland, 22 miles southwest of Lewiston and 20 miles east of the New Hampshire Border, in Cumberland County. The setting is rural. The Songo River is a slow moving stream which meanders south from Long Lake's Bay of Naples for six miles until it enters Sebago Lake, an overland distance of 1 3/4 miles. Crooked River joins the Songo downstream of the Songo Lock. Scenes along this Songo River are idyllic. The traveler, once oriented in Naples village, would proceed east on U. S. Rte. 302 for 3 miles. At this point he would proceed in a southwesterly direction on a side road for 1 1/2 miles arriving at the Songo Lock.

CONSTRUCTION AND MATERIALS:

This canal lock was built in 1830 originally of stone masonry with two wooden gates, each in two sections. The site of the lock was at a point where the river width from Bank to bank was 80'. The builders at that site first built an artificial island of stone masonry, filled with rubble, which was 170' long, 25' wide, and midway of the river. On the north side of this island and to the river bank a small dam with a flood gate was built. A second temporary dam was then made from the south side of the island to the south bank. The flood gate was opened on the first dam, the river water being diverted away from the construction area. The lock built of Stone masonry was 90' long and 26' wide with gates near each end. Water control valves were built into the masonry on the south side of the lock, controlled by wooden gates. Upon the completion of the lock system, the temporary dam was removed. The flood gate of the small dam closed and the river water then passed through the lock. (See continuation sheet for a plan of the Old Songo Lock.

This Songo Lock was rebuilt in 1911 by the Sebago Improvement Company who altered the original design by increasing the length of the lock between the gates to 110' and the width to 28'. Iron gates replaced the wooden gates of the control valves of the lock. The stone masonry was then faced with concrete.

The Songo Lock is in constant use from late Spring through the fall. This Songo River, Sebago and Long Lake Region, enjoys a great summer tourist trade and the Songo Lock itself is a joy to the boat enthusiast. The Songo Lock is associated with and adjacent to Sebago Lake State Park, the largest in this state.

POTENTIAL THREAT: None

The Songo Lock is maintained by the State Park and Recreation Commission. During the tourist season attendants are on duty to assist boaters traveling along this historic and enjoyable river and lake system. The Songo Lock is in excellent condition. It has been time tested and no recorded flooding has ever done more than damage gates which are readily replaceable.

SEE INSTRUCTIONS

3. SIGNIFICANCE

PERIOD (Check One or More as Appropriate)

- Pre-Columbian! 16th Century 18th Century 20th Century
 15th Century 17th Century 19th Century

SPECIFIC DATE(S) (If Applicable and Known) 1830

AREAS OF SIGNIFICANCE (Check One or More as Appropriate)

- | | | | |
|--|---|--|--|
| <input type="checkbox"/> Aboriginal | <input type="checkbox"/> Education | <input type="checkbox"/> Political | <input type="checkbox"/> Urban Planning |
| <input type="checkbox"/> Prehistoric | <input checked="" type="checkbox"/> Engineering | <input type="checkbox"/> Religion/Phi- | <input type="checkbox"/> Other (Specify) |
| <input type="checkbox"/> Historic | <input type="checkbox"/> Industry | losophy | _____ |
| <input type="checkbox"/> Agriculture | <input type="checkbox"/> Invention | <input type="checkbox"/> Science | _____ |
| <input type="checkbox"/> Architecture | <input type="checkbox"/> Landscape | <input type="checkbox"/> Sculpture | _____ |
| <input type="checkbox"/> Art | Architecture | <input type="checkbox"/> Social/Human- | _____ |
| <input checked="" type="checkbox"/> Commerce | <input type="checkbox"/> Literature | itarian | _____ |
| <input type="checkbox"/> Communications | <input type="checkbox"/> Military | <input type="checkbox"/> Theater | _____ |
| <input type="checkbox"/> Conservation | <input type="checkbox"/> Music | <input checked="" type="checkbox"/> Transportation | _____ |

STATEMENT OF SIGNIFICANCE

BACKGROUND:

One hundred and forty years ago the first boat traveled on the Cumberland and Oxford Canal which had been built over a five-year period at a cost of \$206,000, and extended 20 miles from Portland to Sebago Lake and, via a lock on the Songo river, to Harrison at the head of Long Lake.

The geographic conditions here were well suited to a canal, and as early as 1791, a company was chartered to build one.

The Presumpscot River drained two chains of lakes and ponds which reached far into the interior whose rich forests and farm lands were still largely unexploited.

Roads at this time were poor or non-existent so that a canal link to Sebago, supplemented by locks and short pieces of canal between adjoining bodies of water, would offer most of the Cumberland and Oxford counties area efficient low cost water transportation and speed the development of the area.

In 1821 the Cumberland and Oxford Canal Corporation was chartered by the Maine Legislature.

When the sale of stock and the proceeds from a lottery did not succeed in raising sufficient capital, the Legislature authorized the chartering of the Canal Bank stipulating that one-fourth of the bank's capital be invested in canal stock.

But even this was not enough to complete the construction of the canal, and the bank took three mortgages on the company before the work was finished. It was on the first of June, 1830, when the first boat journeyed up the canal from Portland.

The handsomely decorated passenger craft, "George Washington," carried a group of dignitaries up the marvelous "ditch" dug with pick and shovels by hard-working Irish immigrants, through 28 locks which raised the boats 248 feet from tide level to the lakes.

It crossed over the wooden aqueduct which carried the canal across the Little River in Gorham, and went into Sebago Lake.

The canal enabled farmers, lumbermen, manufacturers and merchants to ship or receive goods from Portland cheaply, swiftly and efficiently.

The 1830's and 1840's were successful years for the canal, but by the middle of the century a cloud appeared on the horizon.

The York and Cumberland and the Atlantic and St. Lawrence railroads were completed and cut off some of the commerce which had previously gone by the canal. This loss in freight combined with increasing costs of upkeep for repair of the wooden locks and bridges of the 20-year old canal cut revenue and profit.

SEE INSTRUCTIONS

NATIONAL REGISTER OF HISTORIC PLACES
INVENTORY - NOMINATION FORM

(Continuation Sheet)

STATE Maine	
COUNTY Cumberland	
FOR NPS USE ONLY	
ENTRY NUMBER	DATE

(Number all entries)

Significance

The C & O continued to operate with this reduced traffic and increased overhead for another 20 years, but in 1870, the Portland and Ogdensburg Railroad was completed to Sebago Lake, paralleling the canal all the way from Portland. The canal had revolutionized transportation in 1830, but 40 years later, it could not compete with the railroad.

For the next few years the canal, while still intact, was used to carry floating logs to saw mills. In 1896 the S. D. Warren Paper Company purchased the water rights and the canal ceased to be. At a later point the lock was again sold to the Sebago Lake Improvement Company.

THE SONGO LOCK:

This 1830 canal lock was rebuilt in 1911 by the Sebago Lake Improvement Company. This was done for water level control. However, this function did not exclude boating and for all these years river travel here has been continued and enjoyed. In 1959 the Sebago Lake Improvement Company deeded the Songo Lock property to the State of Maine. Some \$15,000 has been spent by the State Park and Recreation Commission in order to simplify the operation of the lock, so that today a boater can approach, enter, change the water level and pass through the Songo Lock with a physical effort reduced to a minimum. The Songo Lock is today a fitting reminder of the Cumberland and Oxford Canal and of an age in transportation that has past.

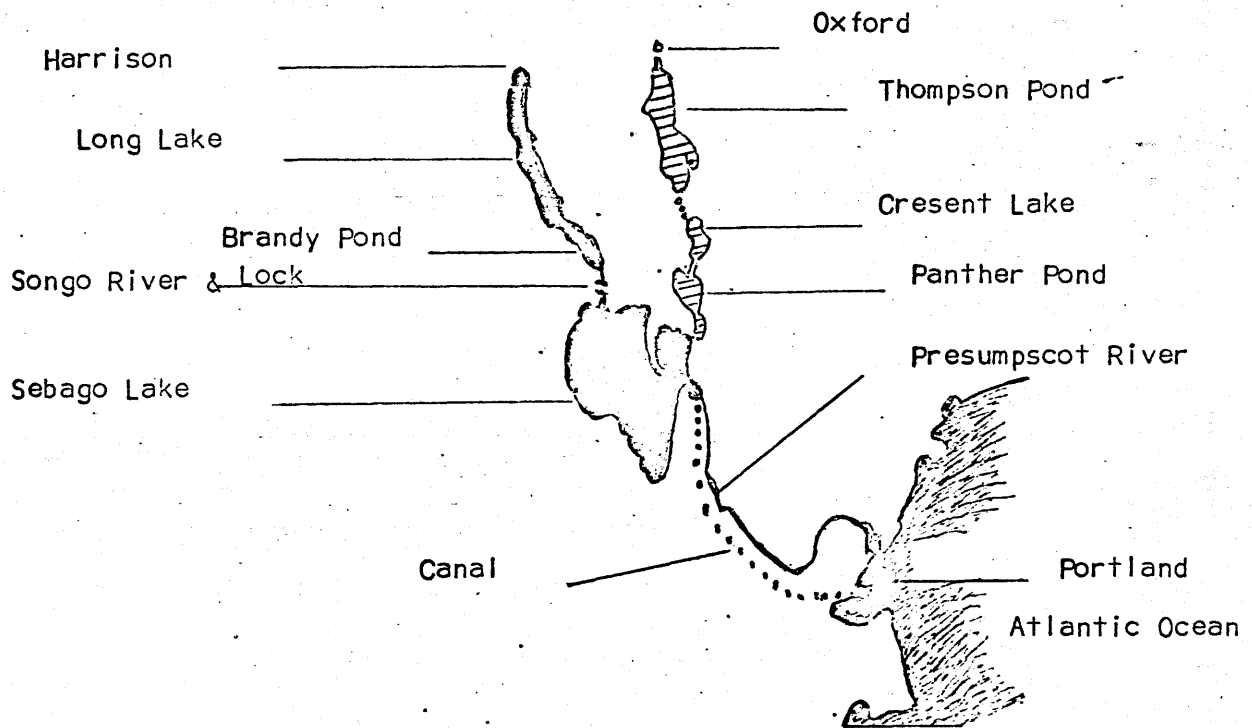

9. MAJOR BIBLIOGRAPHICAL REFERENCES

1. Carter, Harland H., A History of the Cumberland and Oxford Canal, University of Maine, 1950.
2. Newspaper Article, The Eastern Argus Portland, 1822-1831.
3. Rowe, Ernest R., Highlights of Westbrook History, Westbrook Women's Club, 1948.
4. Moulton, Alphonso; Sampson, Howard L., Fernald, Granville, Centennial History of Harrison, Maine, Portland, 1909.
5. Hebert, Richard A. Modern Maine, New York, 1951.
6. Records of the Canal National Bank of Portland, Maine.

10. GEOGRAPHICAL DATA

LATITUDE AND LONGITUDE COORDINATES DEFINING A RECTANGLE LOCATING THE PROPERTY			O R	LATITUDE AND LONGITUDE COORDINATES DEFINING THE CENTER POINT OF A PROPERTY OF LESS THAN TEN ACRES		
CORNER	LATITUDE	LONGITUDE		LATITUDE	LONGITUDE	
	Degrees Minutes Seconds	Degrees Minutes Seconds		Degrees Minutes Seconds	Degrees Minutes Seconds	
NW	° ' "	° ' "		43° 55' 55"	70° 34' 48"	
NE	° ' "	° ' "				
SE	° ' "	° ' "				
SW	° ' "	° ' "				

APPROXIMATE ACREAGE OF NOMINATED PROPERTY: 1 3/4 acres

LIST ALL STATES AND COUNTIES FOR PROPERTIES OVERLAPPING STATE OR COUNTY BOUNDARIES

STATE:	CODE	COUNTY	CODE

11. FORM PREPARED BY

NAME AND TITLE: John W. Briggs, Historian

ORGANIZATION: State Park and Recreation Commission DATE: December 24, 1969

STREET AND NUMBER: State Office Building

CITY OR TOWN: Augusta, Maine 04330 STATE: Maine CODE: 23

12. STATE LIAISON OFFICER CERTIFICATION	NATIONAL REGISTER VERIFICATION
<p>As the designated State Liaison Officer for the National Historic Preservation Act of 1966 (Public Law 89-665), I hereby nominate this property for inclusion in the National Register and certify that it has been evaluated according to the criteria and procedures set forth by the National Park Service. The recommended level of significance of this nomination is:</p> <p>National <input type="checkbox"/> State <input checked="" type="checkbox"/> Local <input type="checkbox"/></p> <p>Name <u>Lawrence Stuart</u></p> <p>Title <u>Director</u></p> <p>Date <u>December 24, 1969</u></p>	<p>I hereby certify that this property is included in the National Register.</p> <p><u>Chief, Office of Archeology and Historic Preservation</u></p> <p>Date _____</p> <p>ATTEST:</p> <p>_____ Keeper of The National Register</p> <p>Date _____</p>

SEE INSTRUCTIONS

NATIONAL REGISTER OF HISTORIC PLACES
INVENTORY - NOMINATION FORM

(Continuation Sheet)

STATE Maine	
COUNTY Cumberland	
FOR NPS USE ONLY	
ENTRY NUMBER	DATE

(Number all entries)

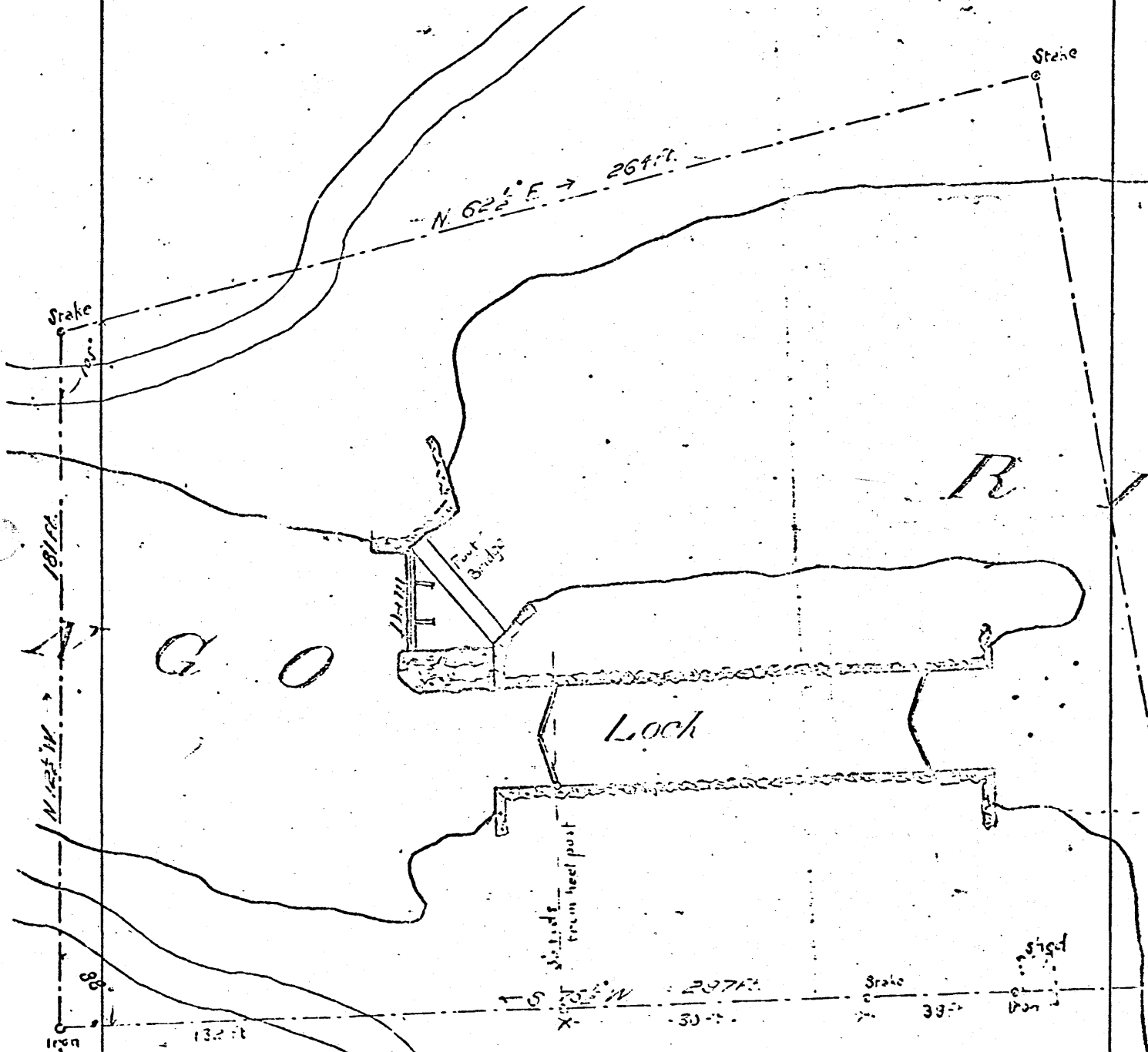

PLAN
Of Property at
Songo Lock
S. D. Warren
-Surveyed Apr. 1895
By: J. A. Warner
Scale 1"=40'

Songo Lock

Latitude
43° 55' 55"

Longitude
70° 34' 48"

UNITED STATES
OF THE ARMY
ENGINEERS

MAINE
SEBAGO LAKE QUADRANGLE
15-MINUTE SERIES

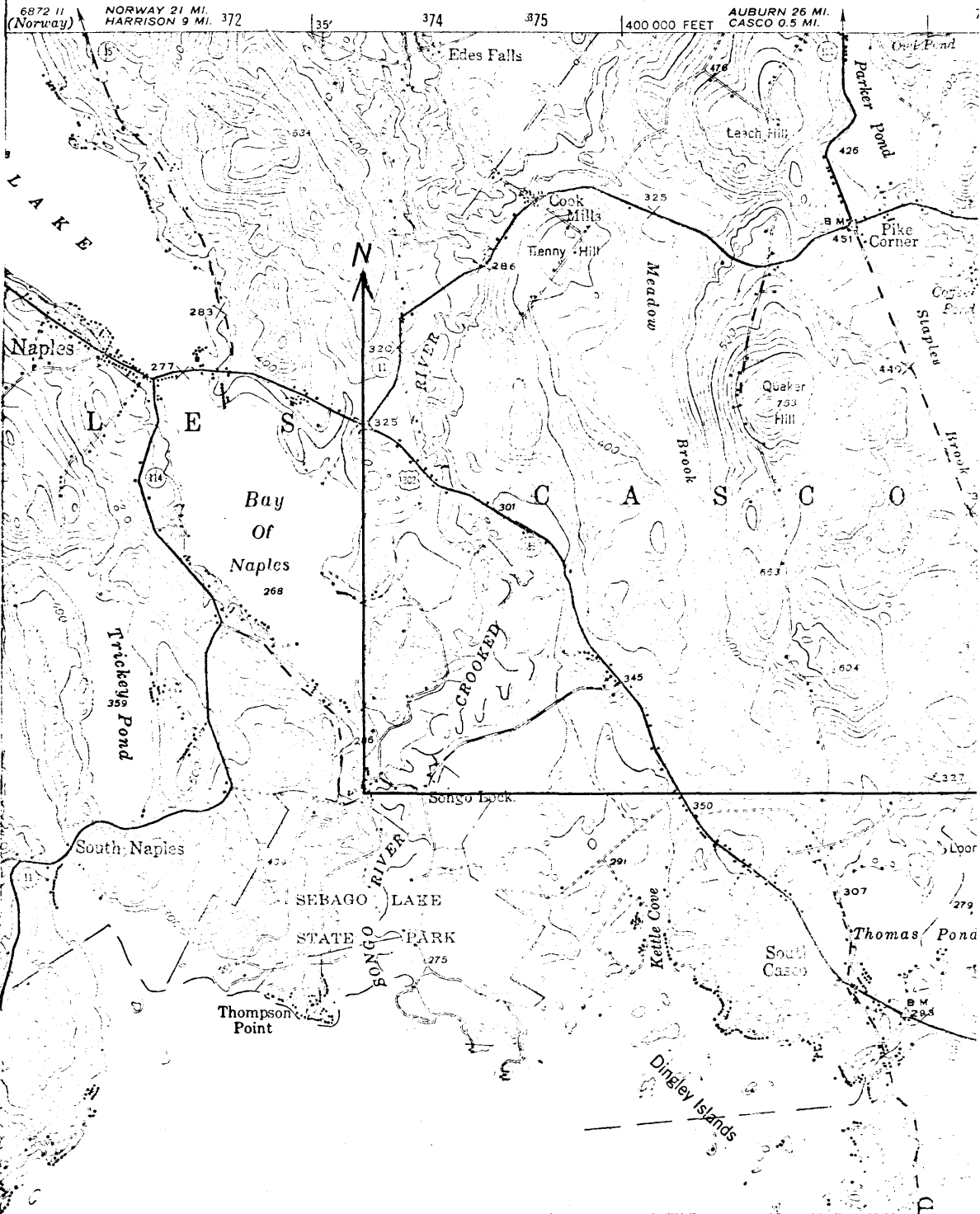

6872 11 (Norway) NORWAY 21 MI. HARRISON 9 MI. 372 35° 374 375 400 000 FEET AUBURN 26 MI. CASCO 0.5 MI.

Edes Falls
Cook Mills
Tenny Hill
Meadow Brook
Parker Pond
Fike Corner
Naples
Bay Of Naples
Trickeye Pond
Songo Lock
SEBAGO LAKE
STATE PARK
Thompson Point
Kettle Cove
Dingley Islands
Thomas Pond
South Casco