

ARCHITECTURAL/HISTORICAL SURVEY

DAVENPORT, IOWA

The Architects Office  
 Wehner, Nowysz, Pottschiull and Pfiffner  
 201 day building, Iowa city, Iowa 52240

DAVENPORT COMMUNITY DEVELOPMENT DEPARTMENT  
 IOWA DIVISION OF HISTORIC PRESERVATION

SITE # 82-10- MA-705 MAP # 3

HIST. DIST. \_\_\_\_\_

NAME Peter J. Paulsen House (H) C

ADDRESS 705 Main Street

LEGAL DES. LeClaire's 2nd Add. (See continuation  
16 sheet)  
SUB-DIVISION BLOCK PARCEL SUB-PARCEL

UTM U 15 70,23,0,0 | 4,5,9,9 | 8,9,0 ACREAGE -1 ZONE R-6M  
EASTING NORTHING

OWNER Mark & Roberta Walcott  
705 Main St., Davenport, IA 52803

TITLE H. \_\_\_\_\_  
 (IF DIFF) \_\_\_\_\_

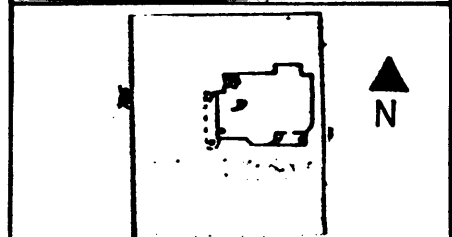
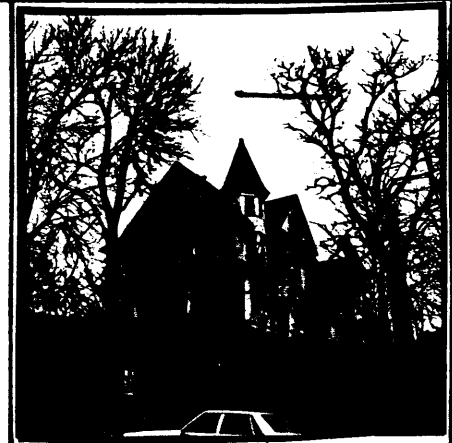

SITE SHEET

ARCHITECTURE

DESCRIPTION

FORM 2½ story dwg., irregular plan, intersecting gables, tower bay CONST. DATE 1894-1895  
 MATERIALS Wood frame, stone foundation ARCH. STYLE Queen Anne Revival  
 FENESTRATION Rectangular, various sizes  
 DIST. FEATURES Polygonal tower bay, ornamental gable ends, surface textures  
 ALTERATIONS Veranda may be slightly later  
 SITE & RELATED STR. Steep, slightly overgrown lot

STATEMENT

This house is a very good example of the Queen Anne style so popular in the late 19th century. Characteristic features include the asymmetrical composition, irregular roofscale, and conical-roofed tower (in this case rising from an oriel), and wraparound veranda. Unlike many houses of this style in the city, this one retains its original lively surface textures - a combination of narrow clapboard, scalloped wall shingle and polygonal roof shingles. Additional details include a semicircular window in the west gable end, and a palladian window in the south gable.

SOURCES

SIGNIFICANCE

HISTORY

DESCRIPTION

Peter J. Paulsen built this house in 1894-95. He operated his own grocery store on West Second Street. Paulsen moved several blocks up Main Street from his previous residence to his new home.

SOURCES

City Directories, 1890-91, 1892-93, 1894-95, 1896-97.

ARCHITECTURAL HISTORIAN: Martha Bowers

HISTORIAN: MARLYS SVENDSEN-ROESLER

SURVEY COMPI 1981

EVALUATION

ARCHITECTURAL

- I. ARCH. EVALUATION Good
- II. ENVIR. STATURE Tissue
- III. INT OF CONTEXT Good
- IV. INT. OF FABRIC Excellent

LEVEL OF SIGNIFICANCE:

NAT.  STATE  LOCAL  N. ELIG.

HISTORICAL

I. THEME(S) OF SIGNIFICANCE:

- A. PRIMARY \_\_\_\_\_
- B. SECONDARY \_\_\_\_\_

II. LEVEL OF SIGNIFICANCE

NAT  STATE  LOCAL

III. NR.H.P

ELIGIBLE  NOT ELIGIBLE

HISTORIC DISTRICT CLASSIFICATION

FOR DIVISION OF HISTORIC PRESERVATION USE ONLY

1. DATE RECEIVED \_\_\_\_\_

2. DATE OF STAFF EVALUATION \_\_\_\_\_

	A. ARCHITECTURAL	B. HISTORICAL
ELIGIBLE FOR N.R.H.P.	<input type="checkbox"/>	<input type="checkbox"/>
NOT ELIGIBLE FOR N.R.H.P.	<input type="checkbox"/>	<input type="checkbox"/>

3. N.R.H.P. ACTION

A STATE REVIEW COMM.	APP. <input type="checkbox"/>	DISAPP. <input type="checkbox"/>	TABLED <input type="checkbox"/>	DATE _____
B FEDERAL REVIEW	APP. <input type="checkbox"/>	DISAPP. <input type="checkbox"/>	TABLED <input type="checkbox"/>	DATE _____

4 D.H.P. SOURCES

- COUNTY RESOURCES
- W'SHIELD SURVEY
- NRHP
- GRANT \_\_\_\_\_

DET. OF ELIGIBILITY

- R. & C \_\_\_\_\_
- DAVENPORT A/H SURVEY
- \_\_\_\_\_
- \_\_\_\_\_

5 SUBJECT TRACES

\_\_\_\_\_  
\_\_\_\_\_  
\_\_\_\_\_

6 PHOTO

1633-9

The Architects Office

Wehner, Nowysz, Pattschull and Pfiffner  
201 city building davenport, iowa 52840

DAVENPORT COMMUNITY DEVELOPMENT DEPARTMENT  
IOWA DIVISION OF HISTORIC PRESERVATION

# 82-10- MA-705

LEGAL DESCRIPTION:

Pt of blk 16 com at NE cor of 7th and Main Sts - N 123.25' - E 180' to alley - S 108' - W along 7th St to beg.

CONTINUATION