

STATE OF INDIANA
DEPARTMENT OF NATURAL RESOURCES
INDIANA HISTORIC SITES AND STRUCTURES INVENTORY

Additional Architectural Information

A. NAME Bethuram-O'Donnell Building C. NUMBER 82-196-0255

B. ADDRESS 22 NW Sixth Street

D. UTM References 16 449960 4202780

E. Evansville's economy was booming shortly after the turn of the century, and these good times gave rise to a number of new businesses and buildings. John O'Donnell, proprietor of the Sanitary Plumbing Company, moved into premises he had recently purchased on Sixth Street in 1905. O'Donnell, a "specialist" in steam and hot water heating, however, made substantial improvements to the building some six years later--in the spring of 1911. At that time, he commissioned architect Harry E. Boyle to remodel the store. A second story was added of pressed brick and stone trimmings (to be used for apartments) and a new plate glass front was installed. Little or no change has occurred to the front elevation of the O'Donnell building. Even the prism glass transom across the front is still present. Between 1915 and 1920, O'Donnell moved his business to a Main Street site; however, the property stayed in the family until purchased by the Bethurams in 1945.

F. INFORMATION SOURCES Evansville Journal, 26 March and 10 April 1911;
City Directories; Deed Records.

G. PREPARED BY Douglas L. Stern

H. DATE 28 January 1982

51 53

C. NUMBER 82-196-0255

B. COUNTY Vanderburgh

E. TOWN/CITY Evansville

A. NAME BETHURAM VACUUM CLEANERS

F. QUAD SHEET Evansville South

G. ADDRESS 22 N. W. Sixth Street

I. UTM Reference

H. STRUCTURE

M. HAER

N. NHL

O. SITE

16 449960 4202700

CENSA TRACT #18

STATE OF INDIANA DEPARTMENT OF NATURAL RESOURCES INDIANA HISTORIC SITES AND STRUCTURES INVENTORY

1. HISTORIC NAME O'DONNELL BUILDING
2. OWNERSHIP: PUBLIC X PRIVATE
NAME Betheram, Wm. Jr.
ADDRESS
3. LOCATION NOTES Eastern Eng. 31, lot 15 (20-33-16)
4. VISIBLE FROM PUBLIC RIGHT OF WAY: X YES NO

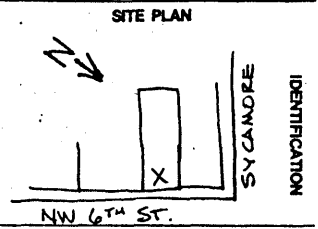

5. USE PRESENT PAST
6. CATEGORY DISTRICT X BUILDING(S) STRUCTURE SITE OBJECT
7. ACCESSIBLE X YES/RESTRICTED YES/UNRESTRICTED NO
8. ENDANGERED X NO YES/BY WHAT
9. DATE
10. ARCHITECT/BUILDER

11. PERIODS: PREHISTORIC 17TH/18TH CEN. 1800-1860 1861-1899 1900-PRESENT

12. AREAS OF SIGNIFICANCE
Archeology-Prehistoric Conservation Law Sculpture
Archeology-Historic Economics Literature Social/Humanitarian
Agriculture Education Military Theater
X Architecture Engineering Music Transportation
Art Exploration/Settlement Philosophy Other (Specify)
Commerce Industry Politics/Government
Communications Invention Religion
Community Planning Landscape Architecture Science

13. STYLE Federal Greek Revival Gothic Revival Italianate Second Empire Stick Style/Eastlake Queen Anne Romanesque Revival Colonial Revival Neo-Classical Bungalow Vernacular X Other (Specify) NA
14. CONDITION EXCELLENT X GOOD FAIR DETERIORATED RUINS UNEXPOSED
16. SITE INTEGRITY X ORIGINAL SITE MOVED DATE
17. OUTBUILDINGS/SECONDARY STRUCTURES X NO YES

15. ALTERATIONS X UNALTERED MINOR MAJOR
18. IN ESTABLISHED HISTORIC DISTRICT X NO YES/NAME

19. DESCRIPTION OF ENVIRONMENT (NATURAL AND MAN-MADE) DOWNTOWN, IN A BLOCK OF COMMERCIAL BLDGS., ONE BLOCK OFF WALKWAY.

20. INFORMATION SOURCES TOWNSHIP ASSESSOR

21. PREPARED BY NANCY J. LONG 22. DATE 9/7/77

- 1. C RECTANGLE
2. D 2 1/2 STORIES
3. C 3 BAYS (2nd FLOOR)
4. C-2 RED BRICK, STRETCHER BOND
5. D
6. B-3 STRING COURSE; B-6 YELLOW BRICK PANELS; B-9 VENTS W/ STONE SILLS
7. F NO PORCH
8.
9. J FLAT ROOF
10.
11.
12. J NO DORMERS
13. L PARAPET
14. B STONE CAP
15. R NONE
16. I NONE
17. C-A NONE
18. A FLAT WINDOWS
19. B-1 PLAIN LINTELS (2nd STORY)
20. A PLAIN SIDES
21. H BRICK SIDES, STONE LINTEL
22. A STONE SILLS
23. B DOUBLEHUNG
24. A-1, B-1
25. C NO 3RD FLOOR
26. B-A TWO DOORS W/ STORE WINDOWS BETWEEN
27. COMMERCIAL STOREFRONT W/ IRON FRAMING HAS SMALL GLASS SQUARES IN HORIZONTAL PANEL ACROSS FRONT, W/ 3 VENT OPENINGS. WOOD DOORS & FRAMES. GEORGIA MESKER LABEL ON IRON FRAME
28.
29.
30.
35. C UNKNOWN

Architectural Information

CLASSIFICATION/DATE

SIGNIFICANCE

DESCRIPTION

