

**United States Department of the Interior
Heritage Conservation and Recreation Service**

**National Register of Historic Places
Inventory—Nomination Form**



See instructions in *How to Complete National Register Forms*
Type all entries—complete applicable sections

1. Name

historic Hotel Sainte Claire

and/or common " "

2. Location

street & number 302 & 320 South Market St _____ not for publication

city, town San Jose _____ vicinity of _____ congressional district 10

state California code 06 county Santa Clara code 085

3. Classification

Category	Ownership	Status	Present Use	
<input type="checkbox"/> district	<input type="checkbox"/> public	<input checked="" type="checkbox"/> occupied	<input type="checkbox"/> agriculture	<input type="checkbox"/> museum
<input checked="" type="checkbox"/> building(s)	<input checked="" type="checkbox"/> private	<input type="checkbox"/> unoccupied	<input checked="" type="checkbox"/> commercial	<input type="checkbox"/> park
<input type="checkbox"/> structure	<input type="checkbox"/> both	<input type="checkbox"/> work in progress	<input type="checkbox"/> educational	<input type="checkbox"/> private residence
<input type="checkbox"/> site	Public Acquisition	Accessible	<input type="checkbox"/> entertainment	<input type="checkbox"/> religious
<input type="checkbox"/> object	<input type="checkbox"/> in process	<input checked="" type="checkbox"/> yes: restricted	<input type="checkbox"/> government	<input type="checkbox"/> scientific
	<input type="checkbox"/> being considered	<input type="checkbox"/> yes: unrestricted	<input type="checkbox"/> industrial	<input type="checkbox"/> transportation
		<input type="checkbox"/> no	<input type="checkbox"/> military	<input type="checkbox"/> other:

4. Owner of Property

name Park Manor Associates; A Limited Partnership

street & number 130 Bush Street

city, town San Francisco _____ vicinity of _____ state California 94104

5. Location of Legal Description

courthouse, registry of deeds, etc. Santa Clara County Recorder's Office

street & number 70 West Hedding

city, town San Jose _____ state California

6. Representation in Existing Surveys

title San Jose Historic District Survey has this property been determined eligible? yes no

date 1977 _____ federal _____ state _____ county local

depository for survey records San Jose Historical Museum 625 Phelan Ave.

city, town San Jose _____ state California

7. Description

Condition		Check one	Check one
<input type="checkbox"/> excellent	<input type="checkbox"/> deteriorated	<input type="checkbox"/> unaltered	<input checked="" type="checkbox"/> original site
<input checked="" type="checkbox"/> good	<input type="checkbox"/> ruins	<input checked="" type="checkbox"/> altered	<input type="checkbox"/> moved date _____
<input type="checkbox"/> fair	<input type="checkbox"/> unexposed		

Describe the present and original (if known) physical appearance

The Hotel Sainte Claire is a stately six story structure dominating a corner lot at a busy downtown San Jose intersection. Polygonal in plan (six sides), the northwest corner is truncated and recessed forming the corner entrance which faces the intersection of South Market and San Carlos streets. North and west elevations meet the truncated corner at a 120 degree angle, thus framing the entrance. Tawny brick sheathes the steel and concrete frame on floors two through six, and rusticated buff colored stone faces the ground level. The three part verticle composition includes an arcaded ground level, a shaft of four stories, and the sixth floor distinguished by paired windows set in arched frames. Denticular stringcourses separate the first and second floors, the third and fourth floors, and the fifth and sixth floors. Detailing is basically derived from the Renaissance Revival tradition, though there are several references to French and Spanish architecture as well.

The northwest corner entrance is divided into three bays. Entrance is gained through three archways with Renaissance moldings. Blonde marble panels are inset within the abutments of each arch. The original revolving doors were replaced with hinged doors in 1962. Cartouches, now concealed by the marquee, top each arch. Two crests, attached to the denticular stringcourse between floors, are draped with garlands and display the Fleur-de-Lis of France and horizontal bands.

Two - paned, rectangular double hung windows are the predominant window type in the next four floors. The exception, however, is that the second floor windows are topped with pediments and friezes with Renaissance Revival detailing and are edged with iron filigree balconettes. A balustraded balcony in buff stone distinguishes the fourth floor central window. A denticular stringcourse introduces the final story. Paired, round headed windows are set in arched frames of buff stone. Single Corinthian pilasters flank the outer frames, while paired Corinthian pilasters flank the central frame. A classical cornice separates the sixth floor and a final attic story. The vertical lines created by the pilasters are carried through to the attic in the form of rectangular strips crusted with ornament. Single discs of white marble are set within three enriched horizontal panels between the vertical strips.

The north elevation is divided into fifteen bays. As in the corner entrance, the ground floor is faced with rusticated buff stone. Alternating Corinthian pilasters and engaged columns flank each arch of the ground floor arcade. Plain discs are located above each engaged column and fleur-de-lis above each pilaster. Showy consoles cap each arch. Used for commercial space originally and today, cabinet windows are used in the arcade, except for six bays which have been filled in by Renzo's Bistro. Both arcade and cabinet windows rest on a black marble base, except for Renzo's Bistro, where the marble has been faced with brick. Denticular stringcourses separate the ground floor from the brick shaft and the third and forth floors. Second through sixth floor fenestration treated in the same manner as described in the corner entrance.

**NATIONAL REGISTER OF HISTORIC PLACES
INVENTORY -- NOMINATION FORM**

FOR HCRS USE ONLY	
RECEIVED	APR 28 1980
DATE ENTERED	JUN 3 1980

CONTINUATION SHEET

ITEM NUMBER 7 PAGE 1

The cornice, however, is heavier with a string of shell motifs which create a scalloped effect, an abbreviated reference to the ground floor arcade. An attic story is not included, thus the entrance rises slightly above all other elevations. As mentioned earlier, north and west elevations frame the recessed entrance. At the intersections of those three elevations, four small rectangular windows at the third through sixth floors are visible and correspond to stairwells.

The western elevation is divided into seven bays, and the arcade, shaft, sixth floor, and cornice are treated in the same manner as the north elevation, again with the exclusion of an attic story. Five of the seven bays have been filled in by the Sainte Claire Room, a restaurant. The two remaining bays have the original three part windows, consisting of a fanlight and two fifteen paned windows divided by a vertical bar.

Interior

The Hotel lobby remains the most intact interior space within the building. Coffered ceilings, details picked out with gold, a terrazzo floor, and marble create a rich effect. A vaulted hall leads to the Patio Room, once the hallmark of the Hotel, today it has been covered over and combined with the Empire Room and modernized. Originally, the open patio room was framed by a Corinthian arcade. A small formal garden and fountain created a moment of peace and greenery within the building. A third public room, the Spartan room on the second floor has been modernized. Ceilings in the lobby, Spartan, and Empire rooms were handpainted, but alterations over the years have obliterated the original work.

Wood details in the 193 guest rooms (once 200 rooms) and the ornate hand carved wood doors leading to the retail areas are intact. Many of the rooms have original bathroom fixtures. The hotel has undergone several remodelings, the major renovation being in 1962 where the revolving doors of the entrance were replaced.

8. Significance

Period	Areas of Significance—Check and justify below			
<input type="checkbox"/> prehistoric	<input type="checkbox"/> archeology-prehistoric	<input type="checkbox"/> community planning	<input type="checkbox"/> landscape architecture	<input type="checkbox"/> religion
<input type="checkbox"/> 1400-1499	<input type="checkbox"/> archeology-historic	<input type="checkbox"/> conservation	<input type="checkbox"/> law	<input type="checkbox"/> science
<input type="checkbox"/> 1500-1599	<input type="checkbox"/> agriculture	<input type="checkbox"/> economics	<input type="checkbox"/> literature	<input type="checkbox"/> sculpture
<input type="checkbox"/> 1600-1699	<input checked="" type="checkbox"/> architecture	<input type="checkbox"/> education	<input type="checkbox"/> military	<input type="checkbox"/> social/ humanitarian
<input type="checkbox"/> 1700-1799	<input type="checkbox"/> art	<input type="checkbox"/> engineering	<input type="checkbox"/> music	<input type="checkbox"/> theater
<input type="checkbox"/> 1800-1899	<input checked="" type="checkbox"/> commerce	<input type="checkbox"/> exploration/settlement	<input type="checkbox"/> philosophy	<input type="checkbox"/> transportation
<input checked="" type="checkbox"/> 1900-	<input type="checkbox"/> communications	<input type="checkbox"/> industry	<input type="checkbox"/> politics/government	<input type="checkbox"/> other (specify)
		<input type="checkbox"/> invention		

Specific dates 1926 **Builder/Architect** **Weeks and Day**

Statement of Significance (in one paragraph)

The significance of the Hotel Sainte Claire is twofold. First, it is significant in that its history is an integral part of the history of San Jose and remains to this day among the City's most recognized architectural landmarks. Secondly, it is significant in terms of its architecture, for it was designed by the prominent San Francisco architectural firm of Weeks and Day and is a fine example of a monumental eclectic style building.

The Hotel was financed by noted realtor and developer T. S. Montgomery, a prominent San Josean largely responsible for much of the commercial development in downtown San Jose. In addition to financing such an ambitious project, Montgomery donated to the City a parcel of land across from the Hotel for the new civic auditorium which stands today. Clearly then, this area of the downtown was to be the target of a major influx of people; as a result, the Sainte Claire enjoyed the status of being the premier grand hotel in the entire San Jose south peninsula region, and the reputation of having among the most elegant accommodations between San Francisco and Los Angeles. The Hotel Sainte Claire also enjoyed the status of having been designed by the prestigious firm of Weeks and Day, the same firm which designed several of the great hotels in San Francisco, including the Mark Hopkins and St. Francis.

Weeks and Day were noted for both their school and hotel designs in California. The firm was capable of designing buildings in a pure expression of a style, such as the Mission Revival Fremont High School in Sunnyvale, or artfully interweaving various stylistic vocabularies to produce fine eclectic structures, such as the Saint Francis and Mark Hopkins Hotels in San Francisco, and the Sainte Claire Hotel in San Jose.

Interior similarities exist between San Jose's Sainte Claire and the Mark Hopkins in San Francisco. Especially notable are the coffered lobby ceilings designed by the firm for both structures.

A Hotel by such a prominent firm with such exceptional architectural features is rare in San Jose, and the Hotel will continue to stand out as one of the City's stellar structures.

9. Major Bibliographical References

Architect and Engineer of California, "The Patio of Yesterday and Today" by H. W. Shepherd. V.92, Feb. 1928 #2 pages, 62,63,105,84,88,89,42,43.
 Miers, George T. of Kaplan, McLaughlin, Diaz, Architects, descriptive info.

10. Geographical Data

UTM NOT VERIFIED
ACREAGE NOT VERIFIED

Acreage of nominated property 23,520 sq. ft. (.54 acre)
 Quadrangle name San Jose, West Quadrangle scale 1:24,000

UMT References

A	<u>10</u>	<u>598960</u>	<u>413263h</u>	B	<u> </u>	<u> </u>	<u> </u>	<u> </u>	<u> </u>	<u> </u>
	Zone	Easting	Northing		Zone	Easting	Northing			
C	<u> </u>	<u> </u>	<u> </u>	D	<u> </u>	<u> </u>	<u> </u>	<u> </u>	<u> </u>	<u> </u>
E	<u> </u>	<u> </u>	<u> </u>	F	<u> </u>	<u> </u>	<u> </u>	<u> </u>	<u> </u>	<u> </u>
G	<u> </u>	<u> </u>	<u> </u>	H	<u> </u>	<u> </u>	<u> </u>	<u> </u>	<u> </u>	<u> </u>

Verbal boundary description and justification

Lot Number 56 of block B.3R.I.S. as laid down on that certain map found in Book 264, page 29, found in the Office of the Recorder of Santa Clara County.

List all states and counties for properties overlapping state or county boundaries

state	code	county	code
state	code	county	code

11. Form Prepared By

name/title Patricia M. Dixon/Margaret Welden for Mr. Karl Diaz-Hoffmann

organization Urban/Rural Conservation date Oct. 30, 1979

street & number 28 North First St. #703 telephone 408 279-2144

city or town San Jose state California 95113

12. State Historic Preservation Officer Certification

The evaluated significance of this property within the state is:

national state local

As the designated State Historic Preservation Officer for the National Historic Preservation Act of 1966 (Public Law 89-665), I hereby nominate this property for inclusion in the National Register and certify that it has been evaluated according to the criteria and procedures set forth by the Heritage Conservation and Recreation Service.

State Historic Preservation Officer signature Knox Mellon

title _____ date April 15, 1980

For HCRS use only
 I hereby certify that this property is included in the National Register.

for Sally J. Roth 6/2/80
 Keeper of the National Register

Attest: [Signature] 6-2-80

FHR-8-300A
(11/78)

UNITED STATES DEPARTMENT OF THE INTERIOR
HERITAGE CONSERVATION AND RECREATION SERVICE

**NATIONAL REGISTER OF HISTORIC PLACES
INVENTORY -- NOMINATION FORM**

FOR HCRS USE ONLY	
RECEIVED APR 28 1980	
DATE ENTERED	JUN 3 1980

CONTINUATION SHEET

ITEM NUMBER 9

PAGE one

Sanborn Insurance Maps, 1928, San Jose Historical Museum, 625 Phelan Ave., San Jose.

San Jose Mercury News, Dec. 16, 1962, Aug. 18, 1972.

San Jose Public Library, California Room, file on "Hotels". San Carlos at Almaden

259

264

29

X = 1596055
Y = 305179

X = 1596492
Y = 304425

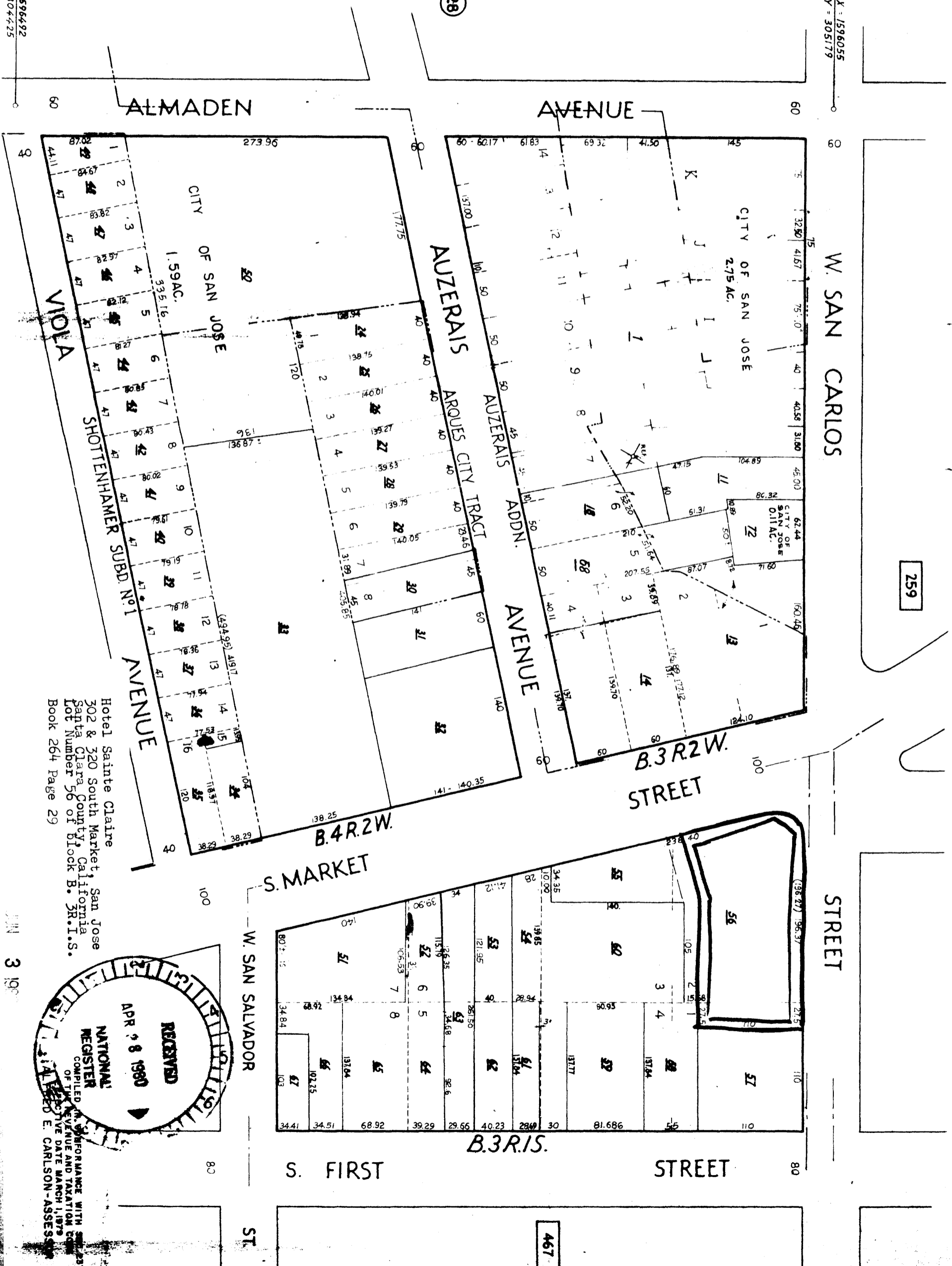
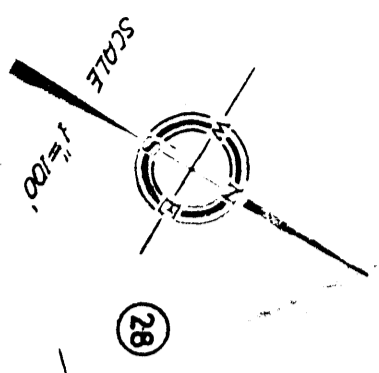

ALMADEN AVENUE

AVENUE

W. SAN CARLOS

CITY OF SAN JOSE
1.59 AC.
335.16

CITY OF SAN JOSE
2.75 AC.

AUZERAISS
ARQUES CITY TRACT

AUZERAISS
ADDN.

AVENUE

B.3R.2W.
STREET

B.4R.2W.

S. MARKET

STREET

W. SAN SALVADOR

S. FIRST

B.3R.1S.

STREET

Hotel Sainte Claire
302 & 320 South Market, San Jose
Santa Clara County, California
Lot Number 56 of Block B. 3R.1.S.
Book 264 Page 29

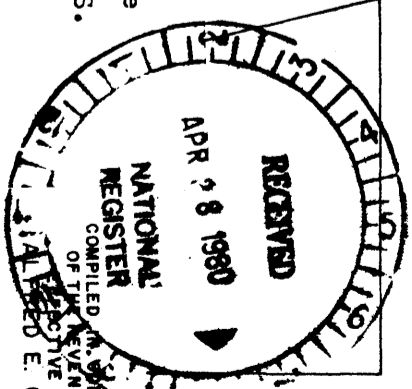

467