

NATIONAL REGISTER OF HISTORIC PLACES
INVENTORY - NOMINATION FORM

STATE: California
 COUNTY: San Francisco
 FOR NPS USE ONLY
 ENTRY NUMBER: MAR 8 1973
 DATE:

(Type all entries - complete applicable sections)

1. NAME

COMMON: HOUSE AT *1321 Scott St.
743 Turk Street Western Addition Project Area Two
 AND/OR HISTORIC: 743 Turk Street

2. LOCATION

STREET AND NUMBER: 743 Turk Street
 CITY OR TOWN: San Francisco
 STATE: California CODE: 06 COUNTY: San Francisco CODE: 075

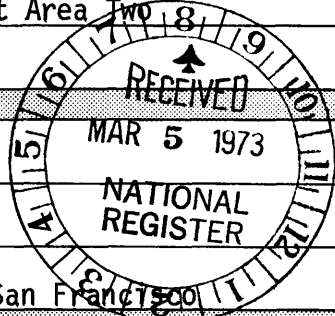

3. CLASSIFICATION

CATEGORY (Check One)	OWNERSHIP	STATUS	ACCESSIBLE TO THE PUBLIC
<input type="checkbox"/> District <input checked="" type="checkbox"/> Building <input type="checkbox"/> Site <input type="checkbox"/> Structure <input type="checkbox"/> Object	<input type="checkbox"/> Public <input checked="" type="checkbox"/> Private <input type="checkbox"/> Both	Public Acquisition: <input type="checkbox"/> In Process <input type="checkbox"/> Being Considered	Yes: <input checked="" type="checkbox"/> Restricted <input type="checkbox"/> Unrestricted <input type="checkbox"/> No
PRESENT USE (Check One or More as Appropriate)			
<input type="checkbox"/> Agricultural <input type="checkbox"/> Commercial <input type="checkbox"/> Educational <input type="checkbox"/> Entertainment	<input type="checkbox"/> Government <input type="checkbox"/> Industrial <input type="checkbox"/> Military <input type="checkbox"/> Museum	<input type="checkbox"/> Park <input checked="" type="checkbox"/> Private Residence <input type="checkbox"/> Religious <input type="checkbox"/> Scientific	<input type="checkbox"/> Transportation <input type="checkbox"/> Other (Specify) _____ <input type="checkbox"/> Comments _____

Visual access to

4. OWNER OF PROPERTY

OWNER'S NAME: San Francisco Redevelopment Agency
 STREET AND NUMBER: 762 Fulton Street
 CITY OR TOWN: San Francisco STATE: California CODE: 06

5. LOCATION OF LEGAL DESCRIPTION

COURTHOUSE, REGISTRY OF DEEDS, ETC.: San Francisco Assessor's Office
 STREET AND NUMBER: City Hall
 CITY OR TOWN: San Francisco STATE: California CODE: 06

6. REPRESENTATION IN EXISTING SURVEYS

TITLE OF SURVEY: San Francisco Conservation Committee Survey*
 (under the auspices of San Francisco Redevelopment Agency)
 DATE OF SURVEY: 1962 Federal State County Local
 DEPOSITORY FOR SURVEY RECORDS: San Francisco Redevelopment Agency
 STREET AND NUMBER: 762 Fulton Street
 CITY OR TOWN: San Francisco STATE: California CODE: 06

STATE: California
 COUNTY: San Francisco
 ENTRY NUMBER:
 DATE:
 FOR NPS USE ONLY

* Attached letter

SEE INSTRUCTIONS

*This survey was adopted by the Landmarks Preservation Advisory Board of the City and County of San Francisco.

7. DESCRIPTION

CONDITION	(Check One)					
	<input type="checkbox"/> Excellent	<input checked="" type="checkbox"/> Good	<input type="checkbox"/> Fair	<input type="checkbox"/> Deteriorated	<input type="checkbox"/> Ruins	<input type="checkbox"/> Unexposed
	(Check One)			in process (Check One)		
	<input type="checkbox"/> Altered	<input checked="" type="checkbox"/> Unaltered		<input checked="" type="checkbox"/> Moved	<input type="checkbox"/> Original Site	

DESCRIBE THE PRESENT AND ORIGINAL (if known) PHYSICAL APPEARANCE

A two-story horizontal narrow wood frame dwelling, in simple Stick Style, with some Italianate detailing.

The main entrance is at the left of the building, reached by a small flight of steps. The entrance is framed by a heavy overhanging flat pediment, supported by scrolled brackets, terminating in shell ornaments imposed upon pilasters that flank the doorway. The wood door, is panelled, single leaf, and surmounted by a large rectangular glass transom.

Above the entrance pediment a single rectangular narrow window is balanced by the double window to the right side. A similar double window is opposite the doorway on the main floor below; both first and second story double windows align vertically and are framed in bold linear doubled mouldings (inner and outer) with slightly-projecting sills supported by paired brackets.

The facade of rusticated wood siding is surmounted by a projecting wooden cornice supported by scrolled brackets. The corners of the building are without quoins or pilasters.

Aside from the grooved consoles supporting the flat door pediment, the sole decorative element associated with the doorway is the small raised wooden circle, centered above the door. The roof cornice, with its prominent supporting brackets, rises above another slight concession to ornament, namely the repetitive rectangular wood panels between brackets.

Because this building was purchased from the family of the original owner by the San Francisco Redevelopment Agency, it has remained in very good condition. This Victorian structure will be moved to Scott Street near Eddy Street to become one in a row of handsome Victorians.

SEE INSTRUCTIONS

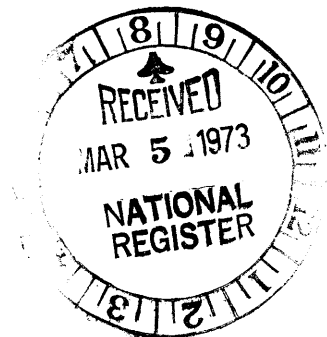

3. SIGNIFICANCE

PERIOD (Check One or More as Appropriate)

<input type="checkbox"/> Pre-Columbian	<input type="checkbox"/> 16th Century	<input type="checkbox"/> 18th Century	<input type="checkbox"/> 20th Century
<input type="checkbox"/> 15th Century	<input type="checkbox"/> 17th Century	<input checked="" type="checkbox"/> 19th Century	

SPECIFIC DATE(S) (If Applicable and Known) 1885

AREAS OF SIGNIFICANCE (Check One or More as Appropriate)

<input type="checkbox"/> Aboriginal	<input type="checkbox"/> Education	<input type="checkbox"/> Political	<input type="checkbox"/> Urban Planning
<input type="checkbox"/> Prehistoric	<input type="checkbox"/> Engineering	<input type="checkbox"/> Religion/Philosophy	<input type="checkbox"/> Other (Specify)
<input type="checkbox"/> Historic	<input type="checkbox"/> Industry	<input type="checkbox"/> Science	_____
<input type="checkbox"/> Agriculture	<input type="checkbox"/> Invention	<input type="checkbox"/> Sculpture	_____
<input checked="" type="checkbox"/> Architecture	<input type="checkbox"/> Landscape Architecture	<input type="checkbox"/> Social/Humanitarian	_____
<input type="checkbox"/> Art	<input type="checkbox"/> Literature	<input type="checkbox"/> Theater	_____
<input type="checkbox"/> Commerce	<input type="checkbox"/> Military	<input type="checkbox"/> Transportation	_____
<input type="checkbox"/> Communications	<input type="checkbox"/> Music		
<input type="checkbox"/> Conservation			

STATEMENT OF SIGNIFICANCE

The San Francisco Water Department records show this building as being connected to the water system in 1885.

Martin O'Dea was the original owner, and this property remained in the O'Dea family until purchase was made by the San Francisco Redevelopment Agency in 1972. He was a prominent horseshoer from the East. "Martin O'Dea, his experiences in the Horseshoeing Trade" is an account documented in the Bancroft Library, University of California, recounting his background in Philadelphia and in San Francisco as the fashionable horseshoer of his time. Mr. O'Dea had built this fine residence as a part of a complex from which he ran his business. This Victorian structure as well as the other two structures on the same property survived the 1906 earthquake and fire. This Stick Style house has been well maintained through the years.

Because of the zoning within the project area, this building has to be either demolished or moved to a more suitable location where it can be rehabilitated and preserved. This will be one of eight buildings to be moved onto a two-block development within the Western Addition Area 2. These two city blocks will be intensively developed with projects including scattered public housing, moderately priced private housing, private rehabilitation and rehabilitation for public bidding and resale by the San Francisco Redevelopment Agency. A few rehabilitation projects have already been completed within these two blocks.

743 Turk will be moved to Block 1127, Lot 15, to be one of a lovely row of existing Victorian homes on Eddy Street, two of which have been rehabilitated. The block also includes a designated landmark, Old St. Patrick's Church.

SEE INSTRUCTIONS



9. MAJOR BIBLIOGRAPHICAL REFERENCES

10. GEOGRAPHICAL DATA

LATITUDE AND LONGITUDE COORDINATES DEFINING A RECTANGLE LOCATING THE PROPERTY			O R	LATITUDE AND LONGITUDE COORDINATES DEFINING THE CENTER POINT OF A PROPERTY OF LESS THAN TEN ACRES		
CORNER	LATITUDE	LONGITUDE		LATITUDE	LONGITUDE	
	Degrees Minutes Seconds	Degrees Minutes Seconds		Degrees Minutes Seconds	Degrees Minutes Seconds	
NW	° ' "	° ' "		N37° 46' 55"	W122° 25' 14"	
NE	° ' "	° ' "				
SE	° ' "	° ' "				
SW	° ' "	° ' "				

APPROXIMATE ACREAGE OF NOMINATED PROPERTY: **1843 sq. ft.**

LIST ALL STATES AND COUNTIES FOR PROPERTIES OVERLAPPING STATE OR COUNTY BOUNDARIES

STATE:	CODE	COUNTY	CODE

11. FORM PREPARED BY

NAME AND TITLE:
Enid Sales, Supervisor; Susan Bragstad, Architect

ORGANIZATION: **San Francisco Redevelopment Agency*** DATE: **January 9, 1973**

STREET AND NUMBER:
762 Fulton Street

CITY OR TOWN: **San Francisco** STATE: **California** CODE: **06**

12. STATE LIAISON OFFICER CERTIFICATION

As the designated State Liaison Officer for the National Historic Preservation Act of 1966 (Public Law 89-665), I hereby nominate this property for inclusion in the National Register and certify that it has been evaluated according to the criteria and procedures set forth by the National Park Service. The recommended level of significance of this nomination is:

National State Local

Name *[Signature]*

Title State Liaison Officer

Date FEB 12 1972

NATIONAL REGISTER VERIFICATION

I hereby certify that this property is included in the National Register.

[Signature]
Chief, Office of Archeology and Historic Preservation

Date 3/8/73

ATTEST:
[Signature]
Keeper of The National Register

Date 3.7.73

UTW
10/55107
4181540
CD

SEE INSTRUCTIONS

Also *San Francisco Landmarks Preservation Advisory Board
100 Larkin Street
San Francisco, California 06

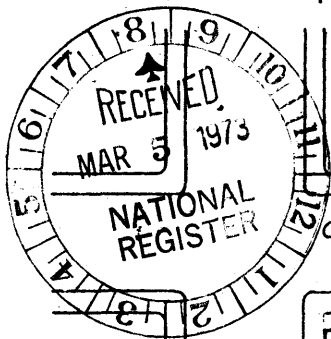

O'FARRELL STREET
BLK. 1100

DIVISADERO STREET

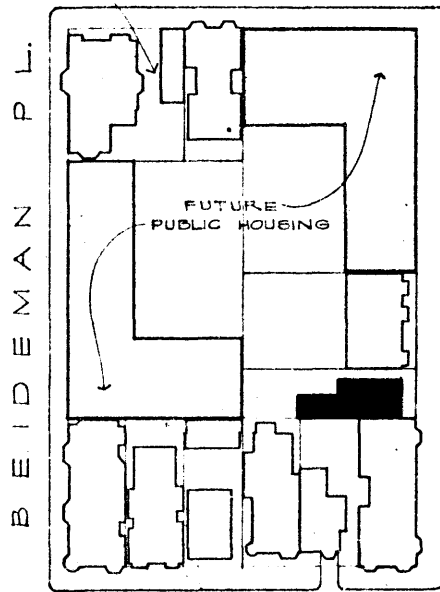
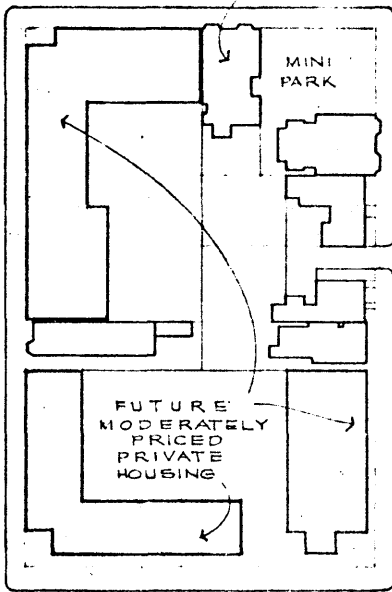

BEIDEMAN STREET

STEWART STREET

ELLIS STREET

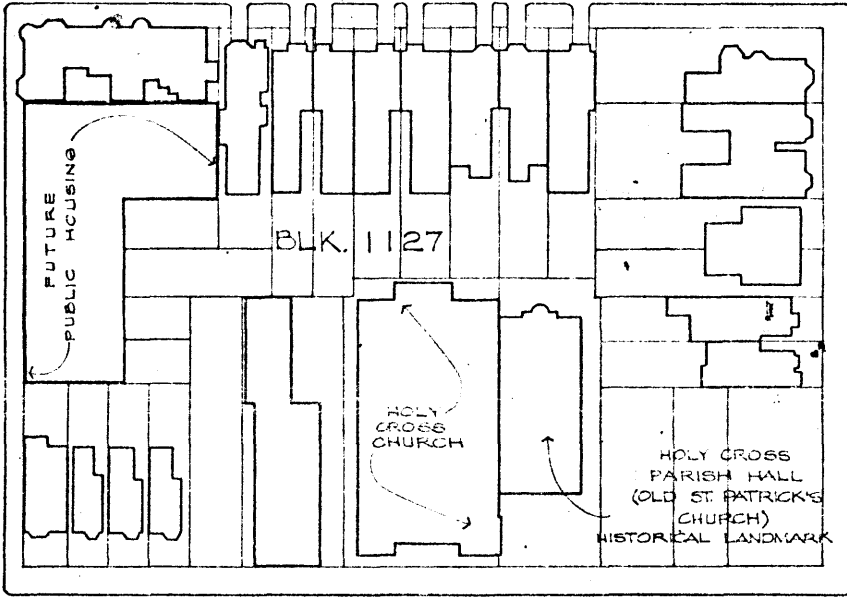

BLK. 1127

SCOTT STREET

EDDY STREET

LEGEND

- NEW LOCATION OF 743 TURK
 - BLDGS. TO BE REHABILITATED
- SCALE 1"=100'-0"



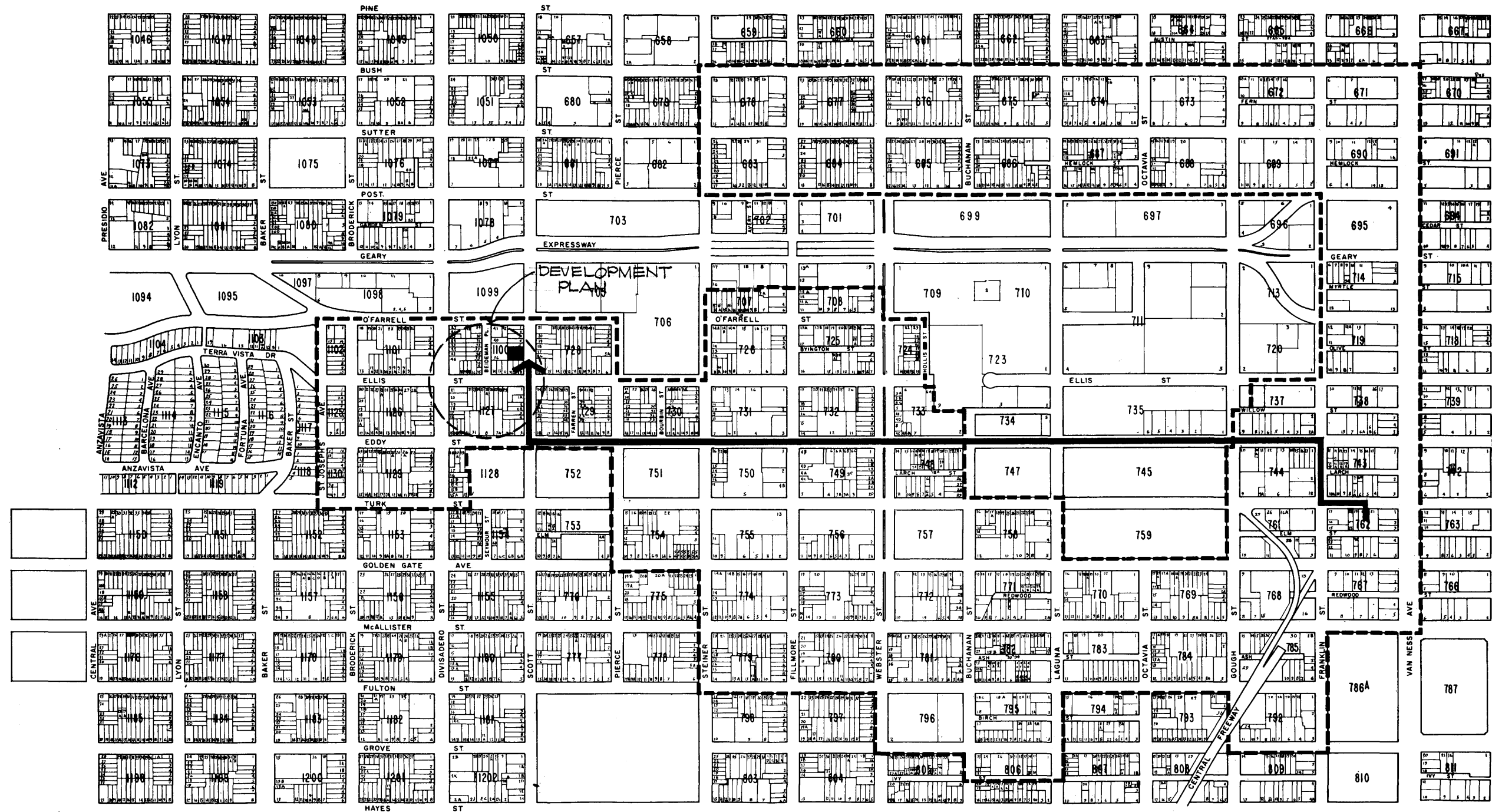

LEGEND - - - - - PROJECT BOUNDARY

WESTERN ADDITION AREA TWO

MAP B: RELOCATION OF 743 TURK

(REFER TO MAP "C" FOR DEVELOPMENT PLAN)

- █ EXIST. LOCATION
- █ NEW LOCATION

