

Okolona Historic District

Name of District

Chickasaw County, Mississippi

County, State

United States Department of the Interior
National Park Service

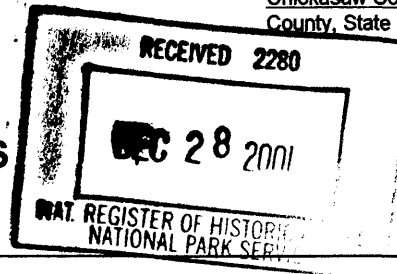

NATIONAL REGISTER OF HISTORIC PLACES REGISTRATION FORM

1. Name of Property

historic name:

other names/site number: Okolona Historic District

2. Location

street & number: roughly bounded by Fleming, Monroe, Buchanan & Washington Streets

not for publication

city or town: Okolona

state: Mississippi

code MS

county Chickasaw

vicinity 01

zip code 38860

3. State/Federal Agency Certification

As the designated authority under the National Historic Preservation Act of 1966, as amended, I hereby certify that this X nomination request for determination of eligibility meets the documentation standards for registering properties in the National Register of Historic Places and meets the procedural and professional requirements set forth in 36 CFR Part 60. In my opinion, the property X meets does not meet the National Register Criteria. I recommend that this property be considered significant nationally statewide X locally. (See continuation sheet for additional comments.)

Kenneth H. P. Paul OCT. 18, 2001
Signature of certifying official Date

Deputy State Historic Preservation Officer
State or Federal agency and bureau

In my opinion, the property meets does not meet the National Register criteria. (See continuation sheet for additional comments.)

Signature of commenting or other official Date

State or Federal agency and bureau

4. National Park Service Certification

I, hereby certify that this property is:
 entered in the National Register

See continuation sheet.

determined eligible for the National Register

See continuation sheet.

determined not eligible for the National Register

removed from the National Register

other (explain): _____

Signature of the Keeper

Date of Action

Edson H. Beall 2/5/02

5. Classification

Ownership of Property: Private

Public - Local
Public - Federal

Number of Resources within Property:

(Do not include previously listed resources in the count)

Category of Property: District

Contributing

Noncontributing

189	101	buildings
0	0	sites
0	0	structures
1	0	objects
190	101	Total

Name of related multiple property listing:

N/A

Number of contributing resources previously listed in the National Register: 2

6. Function or Use

Historic Functions: Domestic: Single Dwelling
 Domestic: Secondary Structure
 Commerce/Trade: Business
 Commerce/Trade: Financial Institution
 Government: City Hall
 Government: Courthouse
 Religious: Religious Facility
 Transportation: Railroad related
 Education: Library
 Government: Post office

Current Functions: Domestic: Single Dwelling
 Domestic: Secondary Structure
 Commerce/Trade: Business
 Commerce/Trade: Financial Institution
 Commerce/Trade: Specialty Store
 Education: School
 Education: Library
 Government: City Hall
 Government: Courthouse
 Government: Post Office
 Religious: Religious Facility
 Transportation: Road-related

7. Description

Architectural Classification(s):

Gothic, Italianate, Queen Anne, Colonial Revival, Classical Revival, Tudor Revival, Bungalow/Craftsman

Materials:

foundation: brick, stucco concrete, stone

roof: asphalt, metal

walls: weatherboard, asbestos, vinyl, shingle (wood), brick, stone, metal

other

Narrative Description: See Continuation Sheets.

8. Statement of Significance

Applicable National Register Criteria

Areas of Significance

- A** Property is associated with events that have made a significant contribution to the broad patterns of our history.
- B** Property is associated with the lives of persons significant in our past.
- C** Property embodies the distinctive characteristics of a type, period, or method of construction or represents the work of a master, or possesses high artistic values, or represents a significant and distinguishable entity whose components lack individual distinction.
- D** Property has yielded, or is likely to yield information important in prehistory or history.

- Commerce
- Government
- Architecture
- Transportation

Period of Significance

1850-1950

Significant Dates

1850
1865

Criteria Considerations:

Property is:

- A** owned by a religious institution or used for religious purposes.
- B** removed from its original location.
- C** a birthplace or a grave.
- D** a cemetery.
- E** a reconstructed building, object, or structure.
- F** a commemorative property.
- G** less than 50 years of age or achieved significance within the past 50 years.

Significant Person(s)

Cultural Affiliation(s)

Architect/Builder

Narrative Statement of Significance:

See continuation sheets.

9. Major Bibliographical References

Bibliography

See continuation sheet.

Previous documentation on file (NPS)

- preliminary determination of individual listing (36 CFR 67) has been requested.
- previously listed in the National Register
- previously determined eligible by the National Register
- designated a National Historic Landmark
- recorded by Historic American Buildings Survey
- # _____
- recorded by Historic American Engineering Record

Primary Location of Additional Data

- State Historic Preservation Office
- MS Dept. of Archives & History
- Other State agency
- Federal agency
- Local government
- University, Mississippi State University
- Other
- Name of repository:
- MS Department of Archives & History

10. Geographical Data

Acreage of Property: 96 acres

UTM References:	Zone	Easting	Northing	Zone	Easting	Northing
A	16-337700	3764450		C	16-338920	3763350
B	16-338920	3764420		D	16-337700	3763350

___ See continuation sheet.

Verbal Boundary Description See continuation sheet.

Boundary Justification: See continuation sheet.

11. Form Prepared By

name/title:	Shannon Criss		
organization:	MSU School of Architecture	date:	5 February 2001
street & number:	PO Box AQ	telephone:	(662) 325-2207
city or town:	Mississippi State	state:	MS
		zip code:	39762

Additional Documentation

Submit the following items with the completed form:

Continuation Sheets

Maps

A USGS map (7.5 or 15 minute series) indicating the property's location.

A sketch map for historic districts and properties having large acreage or numerous resources.

Photographs

Representative black and white photographs of the property.

Additional items (Check with the SHPO or FPO for any additional items)

Property Owner(s)

name: Multiple

street & number:

telephone:

city or town:

state:

zip code:

Paperwork Reduction Act Statement: This information is being collected for applications to the National Register of Historic Places to nominate properties for listing or determine eligibility for listing, to list properties, and to amend existing listings. Response to this request is required to obtain a benefit in accordance with the National Historic Preservation Act, as amended (16 U.S.C. 470 et seq.).

Estimated Burden Statement: Public reporting burden for this form is estimated to average 18.1 hours per response including the time for reviewing instructions, gathering and maintaining data, and completing and reviewing the form. Direct comments regarding this burden estimate or any aspect of this form to the Chief, Administrative Services Division, National Park Service, P.O. Box 37127, Washington, DC 20013-7127; and the Office of Management and Budget, Paperwork Reductions Project (1024-0018), Washington, DC 20503.

**United States Department of the Interior
National Park Service**

**NATIONAL REGISTER OF HISTORIC PLACES
CONTINUATION SHEET**

Section: 7

Page: 1

Okolona Historic District
Chickasaw County, Mississippi

NARRATIVE DESCRIPTION

The proposed Okolona Historic District includes 292 buildings and one object that comprise the historic downtown and historic middle and upper class residential area of the city of Okolona in Chickasaw County, Mississippi. The district's character is that of a small Southern town in the decades between Early Settlement and the end of the Second World War. Many of Okolona's industrial and railroad resources have been demolished, and much of the housing in the community has suffered significant deterioration in material integrity. Therefore, the district focuses on those commercial, institutional, and residential elements of Okolona that retain significant integrity.

The commercial core is positioned in the central portion of the district and is surrounded by residential development to the north, south and west. To the east there is the railroad related to its historic industrial buildings. The earliest portion of the commercial core lie on an east-west axis along Main Street between Silver and Olive Streets. The area developed from circa 1888 to circa 1900 and is reflective of vernacular expressions of national commercial trends at the time, characterized by attached commercial row buildings which are one or two stories in height and one or two commercial lots in width. Buildings illustrative of this development are commercial vernacular building such as Inventory #108. Several businesses were labeled "colored" on a 1904 map sketch and were owned by families who remained in business and prominent in Okolona for many years. These businesses were located primarily on the north side of Main Street, west of what is today Olive Street. (Inventory # 131, #132 and #133).

Later, in the first twenty years of the 20th century, commercial development progressed further east down Main Street, between Silver and Gatlin Streets. The Merchants and Farmers Bank (Inventory # 120), built in 1903, and the Bank of Okolona (Inventory #106), built about 1910, best characterize the buildings of this era. Other development was characterized by one and two-story vernacular commercial row buildings. The other buildings within these blocks, in the eastern portion of Main Street have undergone extensive renovations in the latter half of the twentieth century. In this area, only 25% of the buildings of the existing commercial building stock has sufficient collective integrity. Many buildings have had storefronts covered with metal panels and canopies that diminish their integrity. However, many of these downtown buildings could have their late additions removed to restore their integrity and qualify them as "contributing."

In the surrounding residential neighborhoods, along Monroe Street and School Street, many large residences were constructed between 1910 and 1925, in such styles as Colonial Revival (Inventory #39, #66, #169, #207, and #211), Queen Anne (Inventory #71, #187, #201, and #209), Neo-Classical (Inventory #59) and Tudor or English Cottage (Inventory # 72, #73, and #159). Many fine Craftsman Bungalows were constructed among these larger homes (Inventory #8, #29, #39, #84, #220, and #222).

**United States Department of the Interior
National Park Service**

**NATIONAL REGISTER OF HISTORIC PLACES
CONTINUATION SHEET**

Section: 7

Page: 2

Okolona Historic District
Chickasaw County, Mississippi

Okolona is notable for its well-preserved early twentieth century churches and institutional buildings. The churches include the First Methodist Church (##136), built in 1907-08; Grace Episcopal Church (#151), built in 1908; Okolona Presbyterian Church (#143), built in 1919; St. Theresa's Catholic Church (#177), built about 1922; and the First Baptist Church (#87), built in 1924. The Carnegie Library (#139) was built in 1915, and the Okolona High School (#158a) was built in 1924.

During the period from 1940 to 1950 a fair number of smaller middle-class residences were built (such as Inventory #76, #77, #148, #216). Many of these are scattered among older buildings, built on lots subdivided from larger lots or replacing older houses.

Two properties within the proposed district have been previously listed individually in the National Register of Historic Places – the Elliott-Donaldson House (Inventory #9), listed on 24 March 1980, and the Merchants and Farmers Bank (Inventory # 120), listed on 7 April 1987.

**United States Department of the Interior
National Park Service**

**NATIONAL REGISTER OF HISTORIC PLACES
CONTINUATION SHEET**

Section: 7

Page: 3

Okolona Historic District
Okolona, Chickasaw County

Church Street, North

- 1. 100 N. Church** **c.1990 NC**
Block 28 Lot 44.1
One-story brick commercial building with side-gabled roof and full-facade porch. Corner lot. West facing front facade. Porch has nine square columns. The right and left sides each have a 9-light door. One glazed, metal door is located to the left of the center. Two 6/6, paired windows sit between the doors. One 6/6 window sits between the end doors and the corners of the building.
- 2. 101 N. Church** **c.1930 C**
Dismukes Service Station
Block 24 Lot 10
One-story brick L-plan service station with cross-gable roof. Corner lot. Church St. facade faces East and has 4 bays. The asphalt-shingle roof extends a cross-gabled porch over the 1st bay, which rests on square brick columns. 1st bay has a centered, 7-light, entry door. The entry door is flanked to the right by 4/1 paired windows, and to the left by a 4/1 window and a 12-light door. This bay's gabled porch covers 2 gas pumps. The 2nd bay is an open garage. The 3rd and 4th bays are 2 large garages with garage doors. All gables are stucco with half-timbering. Main St. facade shows a gable end and cross-gable porch. A wooden panel door and 4-light window sit symmetrically under the gable end. A shed roof addition is attached to the left side. The addition is covered by asbestos shingles, and has a wooden louvered door.
- 3. 102 N. Church** **c.1940 NC**
Block 28 Lot 44
One-story vinyl-sided residence with flat roof and dominant front chimney. West facing front facade. The roof has been removed and a flat roof with parapet is in its place. Brick water table. The brick chimney with chimney pots is centered on the front facade. To the left of the chimney, concrete steps lead up to the wood-panel, entry door which is covered by a flat roof. To the left of the door is a 9/1 paired window. To the right of the chimney are two 9/1 paired windows.
- 4. 103 N. Church** **c.1970 NC**
Block 24 Lot 9
Mobile Home. East facing front facade.
- 5. 104 N. Church** **c.1910 C**
Block 28 Lot 45
One-story wood-sided house with hipped roof and wrap-around porch. West facing front facade. Porch has shed roof with exposed rafters supported by ten, square, wooden columns which rest on concrete masonry unit piers. Steps with pipe rails lead up to the glazed, entry door with 1-light sidelights and 1-light transom. The door is flanked by ornate 1/1 windows. Four 1-light windows sit in a hipped dormer in the center of the hipped roof.

United States Department of the Interior
National Park Service

**NATIONAL REGISTER OF HISTORIC PLACES
CONTINUATION SHEET**

Section: 7

Page: 4

Okolona Historic District
Okolona, Chickasaw County

6. 105 N. Church c.1980 NC
Block 24 Lot 8
One-story symmetrical, brick residence with cross-hipped roof. Front facade is symmetrical and faces east. House has a central block with right and left wings. The wings are set in front of the central block and form an entry courtyard. One 8/8 window with attached shutters sits in each wing. The courtyard is enclosed by a brick and iron fence. The centered entry door is a wood-paneled double door. An addition is attached to the back of the left wing.
7. 106 N. Church c.1970 NC
Block 28 Lot 26
Large, one-story stone and wood siding commercial building with attached concrete block, side-gabled building. Corner lot. West facing front facade. Storefront has three large, tripartite, metal windows broken by stone columns. The glazed metal entry door sits in a stone wall on the left side of the facade. The upper-facade is vertical wood siding. The roof is not visible. The left facade has two metal storefront windows. Back addition has one garage door and five large 18-light windows. The walls are concrete block and the roof is asphalt shingles.
8. 107 N. Church c.1910 C
Block 24 Lot 7
One-story wood-sided symmetrical residence with hipped roof and a full-facade brick porch. East facing front facade. The porch is covered by a hipped roof which rests on four square, brick columns. Brick rails with concrete coping runs between the columns. Brick steps lead up to the 8-light entry door with 4-light sidelights and 1-light transom. The entry is flanked by 1/1 tripartite windows with attached shutters. A hipped dormer with paired windows and shutters sits at the crest of the porch roof. Two brick chimneys protrude from the front slope of the roof.
9. 109 N. Church c.1850 PL
Elliott-Donaldson House
Block 24 Lot 6
Previously listed on the National Register of Historic Places (15 September 1980).
Large, two-story, symmetrical, wood-sided residence with side-gable roof and full-height entry porch. East facing front facade. Porch has an end-gable roof which rests on two large, octagonal columns and a 2nd floor balcony with wood railings. House originally had four columns. The entry door sets under the porch and has been boarded up. Above the entry door, on the 2nd floor are double doors that open up to the balcony. The porch is flanked, on the 1st and 2nd floors, by two 1/1 windows with pediment and shutters.
10. 201 N. Church c.1850 C
Block 24 Lot 5
One-story wood-sided residence with L-shaped plan, cross-gabled roof and partial porch. East facing front facade. Porch is covered by a shed roof, which rests on three square, wooden columns. On the right side of the porch is the glazed, double, entry door with 5-light sidelights and an ornate arched transom. On the left side of the porch is a 2/2 window with attached shutters. To the right of the porch the cross gable extends out and ends with 2/2 bay windows. Small shutters are attached to both sides of the bay window. A gable-wall chimney sits on the left side.

United States Department of the Interior
National Park Service

NATIONAL REGISTER OF HISTORIC PLACES
CONTINUATION SHEET

Section: 7

Page: 5

Okolona Historic District
Okolona, Chickasaw County

Church Street, South

11a. 101 S. Church

c.1910

C

Block 46 Lot 15

One-story brick T-plan residence with multiple roof forms, entry porch, corner porch and two brick chimneys. Corner Lot. East facing front facade. Front facade has a side-gable roof with front gables. A large cross-gable roof is centered in the front facade. A 15-light, arched, window sits in the pediment of the gable. Under the cross gable, to the left is an arched, brick entry porch covered by a gable roof. Under the cross gable to the right is a tripartite window with a center 6/1 window flanked by 4/1 windows. An arch is formed in the brickwork above the window. Concrete steps lead up to the arched entry door under the porch. To the left of the large gable is a smaller, matching tripartite window covered by a gable roof. To the right of the cross-gable is a small porch with brick arch covering a 4/1 window. A brick ridge chimney with chimney pots sits at the center right of the house. A concrete and brick deck sits in front of the house and extends from the porch to porch.

11b.

c.1910

C

Block 46 Lot 15 B

Outbuilding of Block 46 Lot 15 A

A stucco and brick storage shed with side-gabled roof. Double barn doors with 6-lights each door.

12. 103 S. Church

c.1920

C

Block 46 Lot 22

One-story symmetrical, brick residence with corrugated tin, hipped roof and full-facade porch. East facing front facade. Porch has four square brick columns connected by a brick knee wall with concrete coping. Large concrete steps with low, brick sidewalls lead up to the entry door. The 15-light entry door has 1-light sidelights and 1-light transom. The door is flanked by 1/1 windows. A shed roof dormer with three 1-light windows sits in the center of the shed roof.

13. 107 S. Church

c.1925

C

Block 46 Lot 24

One-story wood-sided residence with hipped roof and wrap-around porch. East facing front facade. Symmetrical central block with porch that wraps about left side to a small addition. Porch has a six, square, brick columns connected by a brick knee wall and supporting a shed roof. Concrete steps lead up to a wood-paneled, entry door with 1-light transom. The door is flanked by 6/6, paired windows. A wood-paneled door is under the porch on the left side addition. A shed roof dormer sits in the center of the roof.

**United States Department of the Interior
National Park Service**

**NATIONAL REGISTER OF HISTORIC PLACES
CONTINUATION SHEET**

Section: 7

Page: 6

Okolona Historic District
Okolona, Chickasaw County

14. 109 S. Church
Block 46 Lot 17

c.1930 C

One-story brick residence with multiple-gable roof, two doors, and three chimneys. Corner Lot. East facing front facade. Central block has side-gable roof with brick slope chimney in the center of the front slope, and brick gable-wall chimney on the left side. To the right of the chimney is bay window with 6/6 windows, covered with a hipped roof, under a large front-gable roof. To the right of the front-gable roof is a brick arch in-filled with wood-frame windows and door. To the left of the slope chimney is a 12-light entry door under a front-gable roof. The entry door is flanked by stone medallions and is covered by a metal awning. To the left of the entry door is a 6/6, paired window. A 9-light, gabled dormer sits over the window on the roof. Both doors have concrete steps leading up to a stoop. The entry door has a brick deck to the left. A metal carport is attached to the left side of the house.

15. 111 S. Church
Block A Lot 32

c.1980 NC

One-story brick commercial building with flat roof and storefront, ribbon windows. East facing front facade. Large pane ribbon windows with metal mullions rest on a low brick wall. A glazed, metal entry door is on the left side. A large metal awning/coping caps the building.

16. 113 S. Church
Block A Lot 33

c.1980 NC

One-story wood-framed commercial building with gable roof and storefront, ribbon windows. Roof extends approximately five feet beyond front façade, on a portion of the building. Steel columns support roof overhang. East facing front façade. Large pane ribbon windows with metal mullions rest on wood wall. Symmetrical façade with a glazed, metal entry door in center.

Cole Street

17. 103 Cole
Block 41 Lot 38

c.1950 NC

One-story asbestos-sided house with side-gable roof and entry porch. North facing front facade. Concrete steps lead up to a wood-panel entry door with 3 lights covered by a shed roof. 4/4 windows flank the entry.

18. 211 Cole
Block 42 Lot 62

c.1960 NC

One-story asbestos-sided house with front-gable roof and protruding front-gabled addition. North facing front facade. The addition is the front of the house. The centered, metal, entry door is covered by a front-gable roof supported by brackets. A wooden louver sits in the front-gable.

United States Department of the Interior
National Park Service

NATIONAL REGISTER OF HISTORIC PLACES
CONTINUATION SHEET

Section: 7

Page: 7

Okolona Historic District
Okolona, Chickasaw County

East Drive (previously South Street)

19. 105 East Drive
Block 56 Lot 35

c.1940 C

One-story asbestos-sided residence with side-gable roof, entry porch, and two side-gable wings. Corner lot. North facing front facade. Entry porch has a metal awning resting on two ornate, iron supports. Concrete steps lead up to a 1-light entry door on the under the left side of the porch. The porch is flanked by 6/6 windows with attached metal awnings and wood shutters. Right side wing has a large, metal door. Left side wing has a 6/6 window with attached metal awning and wooden shutters.

20. 106 East Drive
Block 40 Lot 30

c.1910 C

Two-story vinyl-sided residence with hipped roof and full-width one-story porch. South facing front facade. Porch has hipped roof supported by four square stone columns. Brick steps lead up the entry door on the right side of the house. A 1/1 tripartite window with attached shutters sits on the left side of the house. Two 1/1 windows with attached shutters sits in the 2nd story.

21. 107 East Drive
Block 56 Lot 34

c.1970 NC

One-story brick residence with side-gabled roof, full-facade porch, and inset carport. North facing front facade. Porch and right side, inset, carport are supported by five ornate, iron, supports. Wood entry door is flanked by 9/6 windows. Two doors sit in the back carport wall.

22. 108 East Drive
Block 40 Lot 25

c.1940 C

One-story symmetrical, brick residence with side-gable roof, two front-gables, entry porch, and attached carport. South facing front facade. Three bay facade. Porch is in the 2nd bay. Porch has four square, wooden columns supporting a flat roof with roof-line balustrade. Concrete steps with iron rails lead up to a wood-panel entry door flanked by 3/1 paired windows under the porch. A gable dormer with 3/1 window sits on the roof above each paired window under the porch. A brick chimney with chimney pots sits on the front slope next to the ridge. The 1st and 2nd bays have 3/1 paired windows under a front gable. A louver sits in the board-and batten gable. A side-gable carport supported by two square, wooden, columns resting on brick piers is attached to the left side.

23. 109 East Drive
Block 56 Lot 33

c.1925 C

One-story brick residence with clipped-gable roof, entry porch, and left side wing. North facing front facade. Entry porch has a clipped-gable roof with stucco pediment supported by two brick columns. Concrete steps lead up to a 12-light entry door flanked to the left by a 6/1 paired window under the porch. A 6/1 window sits to the right of the porch. Left side wing is a glazed sun porch with clipped-gable roof.

United States Department of the Interior
National Park Service

NATIONAL REGISTER OF HISTORIC PLACES
CONTINUATION SHEET

Section: 7

Page: 8

Okolona Historic District
Okolona, Chickasaw County

24. 110 East Drive c.1970 NC
Block 40 Lot 26
One-story brick and vinyl-sided residence with side-gabled roof, entry porch, and attached carport. South facing front facade. The right side of the facade is covered with vertical vinyl siding. The entry porch sits on the right side of the facade. The porch has a front-gabled roof resting on two ornate, iron supports. A wood-panel door and tripartite window sits under the porch. Two 2/2 windows sit to the left of the porch. A shed roof carport with three metal supports is attached to the right side of the house.

25. 111 East Drive c.1925 C
Block 56 Lot 32
One-story wood-sided residence with cross-gable roof, side entry porch, and right side wing. North facing front facade. Front-gable wall has a 3/1 bay window with hipped roof. Entry porch sits on the left side under the cross-gable. Cross-gable is supported by two metal columns with wooden rails. Side-roof wing sits on the right side of the house. A brick ridge chimney sits on the front-gable roof.

26. 112 East Drive c.1970 NC
Block 40 Lot 27
One-story stone and board-and-batten residence with side-gabled roof, porch, and attached garage. South facing front facade. Three bay facade. 1st bay is the side-gabled roof with full-facade porch. Porch has a shed roof supported by five square, wooden columns. The 1-light entry door is flanked by two 12/12 windows on the left. A 12/12 window and a 2-light window sit to the right of the entry door. Two gable dormers with 6/6 windows sit on the roof. 3rd bay has a stone in-filled front-gable under a board-and-batten gable. 2nd bay has a side-gable roof with a tripartite window that connects the house with the garage.

Fleming Street, North

27. 105 N. Fleming c.1925 C
Block 31 Lot 1
One-story symmetrical, asbestos-sided residence with hipped roof, full-facade porch, and right side addition. East facing front facade. Porch has a shed roof supported by four ornate, iron supports which rests on brick piers. Brick steps lead up to a wood-panel door flanked by 3/1 paired windows. A hipped dormer with two louvers sits in the center of the roof. Side-roof addition has a 1-light door flanked on the right by a 3/1 window and on the left by 3/1 paired windows. All roofs have exposed rafters.

28. 107 N. Fleming c.1910 C
Block 31 Lot 25
One-story symmetrical, wood-sided residence with hipped roof and full-width porch. East facing front facade. Porch has four square, wooden, columns with brick piers which support a horizontal band of asbestos siding and the hipped roof. Concrete steps lead up to a 1-light, wood-panel, entry door with 1-light sidelights. The door is flanked by paired, 1/1 windows. The right side of the front facade protrudes out from the rest of the facade. A concrete chimney sits on the right slope of the roof.

**United States Department of the Interior
National Park Service**

**NATIONAL REGISTER OF HISTORIC PLACES
CONTINUATION SHEET**

Section: 7

Page: 9

Okolona Historic District
Okolona, Chickasaw County

- 29. 109 N. Fleming** c.1925 C
Block 31 Lot 24
One-story asbestos-sided residence with hipped roof, porch, and right side addition. East facing front facade. Original house was symmetrical with a full-width porch. Porch has four square, wooden columns resting on brick piers which support the roof. Concrete steps lead up to a 1-light entry door flanked by paired, 3/1 windows. A hipped dormer with two wood louvers sits centered in the roof. Hipped roofs and dormer has exposed rafters. Right side addition has a shed roof; paired, 2/2 window; and concrete steps that lead up to a wood door. A metal awning sits over the wood door.
- 30. 111 N. Fleming** c.1970 NC
Block 31 Lot 23
One-story vertical wood-sided residence with front-gabled roof and attached carport. East facing front facade has a centered 6/6 window flanked by a 6/6 window on the right and a 2-light, entry door on the left. A shed roof carport is inset on the right side of the house. A wooden door sits at the back of the carport.
- 31. 113 N. Fleming** c.1889 C
Block 31 Lot 22
Two-story, symmetrical, asbestos and wood sided residence with hipped roof and full-height porch with balcony. East facing front facade. Porch has large, square, brick columns. Balcony has small, square, wooden columns connected by wooden rails. Right side of the porch and balcony has fallen in. A 1-light, wood-panel entry door is flanked by 3/1 paired windows with attached shutters. Left side window is boarded up. 2nd floor has a door flanked by 3/1 paired windows.
- 32. 115 N. Fleming** c.1889 C
Block 31 Lot 21
One-story symmetrical, asbestos-sided residence with hipped roof and porch. East facing front facade. Porch has a hipped roof supported by four square, wooden columns and two pilasters which rest on brick piers. Brick steps in a semi-circular pattern lead up to a 3-light, entry door flanked by 1/1 windows. A hipped dormer with louver sits in the center of the roof. All roofs have exposed rafters.
- 33. 117 N. Fleming** c.1970 NC
Block 31 Lot 19
Mobile Home.
- 34. 119 N. Fleming** c.1970 NC
Block 31 Lot 18
One-story brick commercial building with front-gabled roof. East facing front facade has a 1-light, wood-panel entry door on the right, and a 6/6 window in the center.

United States Department of the Interior
National Park Service

**NATIONAL REGISTER OF HISTORIC PLACES
CONTINUATION SHEET**

Section: 7

Page: 10

Okolona Historic District
Okolona, Chickasaw County

Fleming Street, South

35. 105 S. Fleming
Block 40 Lot 22

c.1970 NC

Large two-story brick apartment building with mansard roof. North facing front facade. Building has a long rectangular plan. 2nd story is in the mansard roof. 1st floor has 12 wood-panel doors and twelve, 8-light windows. 2nd floor has twelve, 8-light windows.

36. 111 S. Fleming
Block 40 Lot 24

c.1920 C

One-story symmetrical, wood-sided residence with clipped-gable roof and entry porch. East facing front facade. Porch has a hipped roof supported by four paired, square, wooden columns resting on concrete piers. Concrete steps lead up to a 1-light, wood-panel, entry door with 1-light sidelights and 1-light transom. Entry is flanked by 2/1 paired windows. A paired window has been boarded up in the stucco gable. All roofs have exposed rafters.

37. 119 S. Fleming
Block 56 Lot 38

c.1910 C

One-story wood-sided residence with hipped roof and full facade porch. Corner lot. South facing front facade. Porch has six, brick columns with connecting knee walls with concrete coping. Concrete steps lead up to a wood-panel entry door with 1-light sidelights and 1-light transom. Entry is flanked on the right by a 1/1 window. A hipped dormer with four 1-light windows sits in the center of the hipped roof. A brick chimney sits on both side slopes of the roof.

Gatlin Street, North

38. 102 N. Gatlin & 104 N. Gatlin
Block 31 Lot 8

c.1970 NC

One-story brick commercial building with two-bay facade and slope roof. West facing front facade. Both bays have a glazed metal-frame door flanked by 1-light metal-frame windows with attached shutters. Upper-facade is brick. Cornice is vinyl.

United States Department of the Interior
National Park Service

**NATIONAL REGISTER OF HISTORIC PLACES
CONTINUATION SHEET**

Section: 7

Page: 11

Okolona Historic District
Okolona, Chickasaw County

-
39. 105 N. Gatlin c.1905 C
Block 30 Lot 11
Large, two-story, symmetrical, wood-sided residence with wrap-around porch and hipped with gables roof. Corner lot. East facing front facade. Large porch wraps around house from left side to right side. Porch has a shed roof which is supported by fourteen, round, wooden columns. Concrete masonry unit steps and rails lead up to the porch under a pediment supported by two round wooden columns. The glazed entry door is flanked by 1-light sidelights and has a 1-light transom. The entry door is flanked by 1/1 windows. The 2nd story has a balcony covered by a gable, supported by four round, wooden, columns. In the center of the balcony is a glazed door flanked by matching 1-light windows. The balcony is flanked by 1/1 windows. The left and right facades have mirroring bay wings with gabled roofs. A wooden garage is attached to the back of the house.
40. 106 N. Gatlin c.1925 NC
Block 31 Lot 5.1
Two-story brick factory building. West facing front facade. Older flat roof brick structure has a newer gabled roof brick addition to the front. The building is symmetrical with its entrances on the right side. Older building has 20-light, metal frame, awning windows. Brick addition has two gables and two garage doors.
41. 107 N. Gatlin c.1899 C
Block 30 Lot 10
One-story vinyl-sided residence with multiple roof forms and entry porch. East facing front facade. The main block of the house has a hipped roof. On the right side of the front facade, an end gable protrudes out from the wall plane. A large gabled addition is attached to the back. Concrete steps with metal rails lead up to the entry porch which is covered by a shed roof, and supported by round, wooden columns resting on stone piers. The wood-panel, entry door has an oval window. To the left of the entry porch is a 6/6, tripartite window. To the right of the entry porch, a wall extends down from the protruding gable. A large 20-light window sits in this wall. On the left side a 1/1 window sits in the back addition.
42. 108 N. Gatlin c.1970 NC
Block 30 Lot 77 A
One-story brick residence with end-gabled roof and inset porch. East facing front facade. Front facade has a large 8-light window on the left and an inset porch on the right corner. The porch is supported by one square, wooden column. One 4-light window is in the inset porch wall. The end-gable is covered with board-and-batten and has a metal louver.
43. 109 N. Gatlin c.1954 NC
Block 30 Lot 77 B
One-story symmetrical, brick church with end-gable roof. East facing front facade. Front facade has concrete steps with metal rails leading up to a wood panel, double, entry doors. The doors are flanked by concrete plaques cast into the brick wall. The front facade has a low-slope gable roof that protrudes out from the main gable roof. Windows run along the left and right facades. A brick side-gabled addition sits behind the building and is connected by a covered walkway.

**United States Department of the Interior
National Park Service**

**NATIONAL REGISTER OF HISTORIC PLACES
CONTINUATION SHEET**

Section: 7

Page: 12

Okolona Historic District
Okolona, Chickasaw County

44. 110 N. Gatlin
Block 31 Lot 9

c.1905 C

Two-story, symmetrical, vinyl-sided residence with hipped roof and full-width, one-story porch. West facing front facade. Porch has four square, concrete masonry unit columns supporting a hipped roof. Concrete steps lead up to a double, entry door with 1-light sidelights and 3-light transom. Entry is flanked by 1/1 windows. 2nd floor has three 1/1 windows. A cross-gable roof with two brick chimneys sits on the back of the house. All windows have attached windows.

45. 111 N. Gatlin
Block 30 Lot 76

c.1940 C

One-story brick residence, with cross-gabled roof, and entry porch. East facing front facade. Front facade has two gables. The larger left gable sits over the entry porch. The smaller right gable sits over 6/1 paired windows. The gables are half-timbered. A brick chimney sits in between the gables. Concrete steps lead up to the entry porch which is supported by small, square, columns and covered by a shed roof. The 1-light entry door is flanked on the left by 6/1 paired windows.

46. 112 N. Gatlin
Block 31 Lot 26 A

c.1940 C

One-story brick residence with side-gable roof and attached carport. West facing front facade. Brick steps lead up to a 3-light, entry door and a concrete deck on the left side of the facade. The door is covered by a gabled pediment with brackets. A round louver sits in the pediment. The door is flanked by paired, 9/1 windows. A brick slope chimney sits on the left side of the house. On the right side of the facade sits paired, 24-light, casement windows. A side-gabled carport is attached to the right side of the house. The carport is supported by one round column and one square, brick column.

47. 113 N. Gatlin
Block 30 Lot 75

c.1940 C

One-story brick and stone residence with side-gable roof and entry porch. East facing front facade. Three bay facade. 2nd bay has concrete steps that lead up to the entry porch which extends to the 1st bay. Entry porch has four round, fluted columns supporting a flat roof. A 3-light, entry door flanked by 6/6 windows in a stone wall sit under the porch in the 2nd bay. 1st bay has a glazed door and a 6/6 window under the side-gabled roof which is supported by two round, fluted columns. 3rd bay has a 6/6 window in a gable wall.

48. 116 N. Gatlin
Block 31 Lot 27

c.1905 C

Two-story, asbestos-sided residence with hipped roof and full-width, one-story porch. West facing front facade. Porch has a hipped roof supported by four square, wooden columns resting on brick piers. Concrete steps lead up to wood-paneled, double, entry doors with 2-light transom. Door is flanked by 1/1 windows with attached shutters. Three 1/1 windows sit in the 2nd story. A round metal vent sits at the peak of the hipped roof.

**United States Department of the Interior
National Park Service**

**NATIONAL REGISTER OF HISTORIC PLACES
CONTINUATION SHEET**

Section: 7

Page: 13

Okolona Historic District
Okolona, Chickasaw County

-
- 49. 118 N. Gatlin c.1910 C**
Block 31 Lot 28
One-story symmetrical, brick residence with front-gable roof, full-width porch, and gabled dormer. West facing front facade. Porch has four square, brick columns with brick knee wall supporting the vertical wood-sided pediment. Concrete coping on the columns and knee wall. Concrete steps lead up to a 15-light entry door. The door is flanked by paired, 6/6 windows. The gabled dormer sits on the crest of the roof. Exposed rafters on roof and dormer.
- 50. 120 N. Gatlin c.1930 C**
Block 31 Lot 29
One-story stucco, flat-roof residence with full-width porch. East facing front facade. Shed roof porch is supported by six, iron, ladder supports resting on stucco piers. Two bay facade. 1st bay has a 3-light entry door flanked by 6/6 paired windows. 2nd bay has a porch of stucco knee walls, a door on the left and a 6/6 window on the right.
- 51. 122 N. Gatlin c.1950 NC**
Block 31 Lot 30
One-story vinyl-sided residence with front-gable roof and inset porch. West facing front facade. Two bay facade. 1st bay protrudes out to form a front-gable roof with centered 3/1 window. 2nd bay is an inset porch with a 3/1 window to the right of the 3-light, entry door and 1-light side entry door. A shed roof that extends from the protruded front-gable covers the porch. A vent sits in the pediment of the main roof and the protruding front-gable. A brick chimney sits in the right slope of the roof. Windows have attached shutters.
- 52a. 124 N. Gatlin c.1960 NC**
Block 31 Lot 17 A
Mobile Home.
- 52b. c.1960 NC**
Block 31 Lot 17 B
Outbuilding. One-story wood-sided building with a front-gable roof. North facing front facade has a centered, 6/6 window and louver.

Gatlin Street, South

- 53. 100 S. Gatlin c.1980 NC**
Block 40 Lot 29
One-story vertical wood-sided residence with side-gabled roof. Two 6/6 windows with attached shutters sit on the right side of the house. A wood-panel entry door flanked on the left by a 24-light window with attached shutter sit on the left side of the house.

**United States Department of the Interior
National Park Service**

**NATIONAL REGISTER OF HISTORIC PLACES
CONTINUATION SHEET**

Section: 7

Page: 14

Okolona Historic District
Okolona, Chickasaw County

54. 101 S. Gatlin

c.1925

NC

Block 41 Lot 37

One-story wood-sided residence with cross-gable roof and inset wrap-around porch. Corner lot. East facing front facade. Porch wraps the East and North facades and has seven turned spindles with wooden rails supporting the cross-gable roof. Porch has two 1-light entry doors sitting next to each other. The doors are flanked by 1/1 paired windows. Porch has lattice work. a 4-light window sits in the large, wood-sided pediment of the front gable.

55. 103 S. Gatlin

c.1925

NC

Block 41 Lot 39

One-story vinyl sided residence with cross-gable roof and partial porch. Two bay facade. East facing front facade. 1st bay has the partial porch covered by a saltbox front gable roof supported by three square, wooden columns. Concrete steps on the right side lead up to the entry door. Two 1/1 windows sit to the left of the entry door. 2nd bay has two 1/1 windows. A gable dormer sits centered on the ridge of the side gable. A stone chimney sits on the left side of the house. A side-gable carport supported by two columns is attached to the right of the house.

56. 105 S. Gatlin

c.1970

NC

Block 41 Lot 40

Two-story wood-sided residence with side-gable roof and entry porch. East facing front facade. The side-gable roof extends down to cover the 2nd story over the porch. The porch has four square, wooden columns with brackets which supports A shed roof extending from the side-gable roof. The wood-panel entry door is flanked by 6/6 windows under the porch. To the right of the porch a 6/6 window sits in both floors.

57. 107 S. Gatlin

c.1850

C

Block 41 Lot 41

One-story symmetrical residence with side-gable roof and full-facade porch. Porch has six, square, wooden columns and two pilasters supporting the side-gable roof. Paired brackets sit above the columns in the entablature. Wooden steps lead up to the 1-light, wood-panel, double, entry doors with 3-light sidelights and 5-light transom. The entry doors are flanked by 6/6, paired windows with attached shutters.

58. 108 S. Gatlin

c.1980

NC

Block 40 Lot 28

One-story brick residence with side-gable roof, porch, side-gable wings, and side-gabled left side addition. West facing front facade. Porch has four ornate, iron supports. The glazed entry door sits on the left side of the porch. A 6/6 window with attached shutters and a smaller 6/6 window with attached shutters sits under the porch to the right of the door. The right side wing has three 6/6 windows. The left side wing has a 6/6, paired window with attached shutters. Left side addition has a 6/6 window with attached shutters.

**United States Department of the Interior
National Park Service**

**NATIONAL REGISTER OF HISTORIC PLACES
CONTINUATION SHEET**

Section: 7

Page: 15

Okolona Historic District
Okolona, Chickasaw County

59. 109 S. Gatlin

c.1910

C

Block 41 Lot 42

Large, two-story, symmetrical, wood-sided residence with hipped roof, full-height entry porch, partial porch, and balcony. East facing front facade. Large fluted pilasters are on the corners of the house. Full-height entry porch has a hipped roof with dentils and stepped entablature supported by two large, paired, fluted, Ionic columns. Partial porch has a hipped roof supported by four paired, fluted, Ionic columns with wooden rails. Concrete steps lead up to the glazed, wood-panel, entry door with 2-light sidelights and 3-light transom. The entry is flanked by 1/1 windows with attached shutters. Balcony has wooden rails and two fluted pilasters. A smaller door with sidelights and transom sits in the balcony and matches the entry. The balcony is flanked by 1/1 windows with attached shutters. A gabled dormer with three multiple-light windows sits centered in the hipped roof. Two brick chimneys sit on the side slopes of the hipped roof. A carport is attached to the left of the house.

60. 110 S. Gatlin

c.1905

C

Block 56 Lot 31

Large, two-story, wood-sided residence with hipped roof, cross-gable wing, wrap-around porch, balcony, and back side addition. Corner lot. West facing front facade. Porch wraps from the front around left side to the cross-gable wing. Porch has a shed roof supported by seven, square, wooden columns with wooden rails. Wood-panel entry door has 1-light sidelights and 1-light transom. A 1/1 window with attached shutters sits to the right of the entry. Inset balcony with two square, wooden columns and wooden rails sits above the entry on the 2nd floor. A wood door with 1-light transom sits in the balcony. A 1/1 window sits to the right of the balcony. Cross-gable wing has a wood door with 1-light transom under the porch and a 1/1 window in the 2nd floor.

61. 111 S. Gatlin

c.1950

NC

Block 41 Lot 43

One-story brick and vertical wood-sided residence with cross-hipped roof, dominant front chimney, and entry porch. Corner lot. South facing front facade. Brick water table extends up to cover the corners of the house. Entry porch has steps with iron rails on the right side that lead to the entry door with one oval window. A 2/2 window sits to the right of the entry door. The porch has a shed roof supported by one square, wooden column. Two 2/2 paired windows with attached shutters sit to the right of the entry. A large, dominant brick chimney with chimney pots sits to the left of the entry. A 2/2 paired window with attached shutters sits to the left of the chimney.

62. 112 S. Gatlin

c.1899

C

Block 56 Lot 43

Large, two-story, wood-sided residence with cross-gable and hipped roof, and wrap-around porch. West facing front facade. Three bay facade. Porch covers the 1st and 2nd bays and wraps from the front cross-gable to the back cross-gable. Porch has a shed roof supported by three square, wooden columns and two pilasters resting on brick piers. 1st bay has 1-light entry door under the porch and a 2/2 window in the 2nd floor. 2nd bay has brick steps leading up to the wood-panel entry door with 1-light sidelights and 1-light transom under the porch and a 1/1 paired window in the 2nd floor. 3rd bay has a 1/1 paired window in both floors of a projecting wall under a gable roof. A 1-light window is centered in the shingled gable.

United States Department of the Interior
National Park Service

NATIONAL REGISTER OF HISTORIC PLACES
CONTINUATION SHEET

Section: 7

Page: 16

Okolona Historic District
Okolona, Chickasaw County

63. 114 S. Gatlin

c.1899

C

Block 56 Lot 42

One-story wood-sided residence with L-plan, cross-gable roof, and inset porch. West facing front facade. Right side cross-gable has a 2/2 window in a projecting wall. A wooden louver sits in the ornate, shingled gable. An ornate bracket sits at the top of the gable. The inset porch extends from the right of the cross-gable to the left of the house. The porch has a shed roof with two hipped sections supported by ten, turned spindles with brackets and wooden rails at the top and bottom. Concrete steps lead up the porch entry. The 4-light entry door with 1-light transom sits at the back of the porch. A side entry door sits under the porch. A 2/2 window sits to the left of the door.

64. 116 S. Gatlin

c.1899

C

Block 56 Lot 41

One-story stucco residence with front-gabled roof and full-width porch. Corner lot. South facing front facade. Porch has a hipped roof supported by five square, wooden columns with wooden rails. The 9-light entry door is flanked by door on the right and two 9-light windows on the left. A 6/3 window sits in the attic level of the front gable.

65. 202 S. Gatlin

c.1920

C

Block 55 Lot 12

Large, two-story, wood-sided residence with L-plan, cross-hipped roof, wrap-around porch, balcony, and right side bay window. West facing front facade. Two bay facade. 1st bay is the cross-hipped roof which extends out to form the L-plan. A 1/1 paired window sits in each floor of the 1st bay. The porch has a hipped roof supported by ten, turned spindles with wooden rails and wraps from the 2nd bay around the 1st bay to the left side of the house. 2nd bay has brick steps leading up to a 9-light entry door with 1-light transom. flanked by a 1/1 window on the left under the porch. A 1/1 window sits to the right of the porch. A balcony and 1/1 paired window sits in the 2nd floor of the 2nd bay. The balcony sits above the entry door and has a shed roof supported by one turned spindle and two pilasters with wooden rails. A large bay window with 1/1 windows and a hipped roof is attached to the right side of the house. A gabled dormer sits above the balcony in the hipped roof.

66. 203 S. Gatlin

c.1910

C

Block 54 Lot 31

Large, two-story, wood-sided residence with hipped roof, wrap-around porch, and balcony. East facing front facade. House is symmetrical, but porch wraps around to the right side. Porch has seven, square, wooden columns resting on concrete block piers. Right side of porch has been glassed in. Concrete steps lead up to a wood-panel entry door with 1-light sidelights and 1-light transom. Entry is flanked by 1/1 windows. 2nd floor balcony has a hipped roof supported by two square, wooden columns with wooden rails. A wood-panel door with 1-light sidelights and 1-light transom sit under the balcony. The balcony is flanked by 1/1 windows. Two brick chimneys sit on the side slopes of the hipped roof.

**United States Department of the Interior
National Park Service**

**NATIONAL REGISTER OF HISTORIC PLACES
CONTINUATION SHEET**

Section: 7

Page: 17

Okolona Historic District
Okolona, Chickasaw County

67. 204 S. Gatlin

c.1920

C

Block 55 Lot 11.2

Large, two-story, wood-sided residence with L-plan, hipped roof, wrap-around porch, and balcony. West facing front facade. Two cross-gables extend from the hipped roof. Right side cross-gable extends out from the facade to from the L-plan and has a two 1/1 bay windows in each floor. The porch wraps from the right side cross-gable around to the left side. The porch has shed roof supported by seven, octagonal columns. Concrete steps lead up to the entry door with oval window and 1-light transom which sits under the porch, in between the cross-gables. A shed roof balcony with exposed rafters supported by three turned spindles with wood railings sits above the entry in the 2nd floor. A wood door with ornate, oval window sits in the balcony. A 1/1 semi-hexagonal window and a 1/1 window sit in the porch under the left side cross-gable. A 1/1 paired window sits under the left side cross-gable in the 2nd floor. A 2-light window sits in each cross gable.

Gatlin Street Intersection (at Main Street)

68. Intersection of Main St. and Gatlin St.

c.1905

C

No Block or Lot # (See block 2)

Confederate monument. Stone statue of a Confederate Soldier on top of a pedestal, and a cannon set on a concrete base. Statue inscription reads: "OUR CONFEDERATE DEAD".

Jefferson Street, West

69. 313 W. Jefferson

c.1900

C

Block 29 Lot 49

One-story symmetrical, brick residence with hipped roof and entry porch. North facing front facade. Entry porch is covered by a front-gabled roof, supported by two square, wooden columns, which rest on brick piers. Concrete steps lead up to a wood-panel door with two 3-light, sidelights and 5-light transom. Entry porch is flanked on both sides by two 6/6, arched windows.

70. 315 W. Jefferson

c.1904

C

Block 29 Lot 47

Large, two-story, asymmetrical, wood-sided residence with wrap-around porch and hipped with gables roof. Corner lot. North facing front facade. Large porch wraps around house from left side to right side. Porch has a shed roof that is supported by eleven round wooden columns, resting on brick piers. The house sits upon a brick perimeter foundation. The porch has an open, wood-railing between the column piers. Brick steps and rails lead up to the porch. The glazed entry door has a 1-light transom. The right facade has a projecting bay with a gabled roof. The back of the house has an added, gabled portion.

United States Department of the Interior
National Park Service

NATIONAL REGISTER OF HISTORIC PLACES
CONTINUATION SHEET

Section: 7

Page: 18

Okolona Historic District
Okolona, Chickasaw County

71. 400 W. Jefferson c.1904 C
Block 23 Lot 19

Large, two-story, wood-sided residence with multiple roof forms, a tower, and a two entry porches. Corner Lot. Jefferson St. facade faces South. School St. facade faces East. Jefferson St. facade has a central block with tower on right and front-gabled entry porch on left. Two-story tower has semi-hexagonal, 1/1 stained-glass windows on both floors. The entry porch has four round, wooden columns with brackets that form three arches. The columns are connected by wooden rails. Stained-glass entry door with 1-light transom flanked by 1/1 stained-glass windows. A 12-light window sits in the gable. Two 1/1 stained-glass windows sit between the porch and tower. A gable dormer with brick chimney sits between the porch gable and the tower on the hipped roof. A hipped roof wing with three 2/2 stained-glass windows sit to the left of the porch. A shed roof dormer with 4-light, paired windows sits at the junction of the two hipped roofs. School St. facade has a front gable with a 1-light tripartite above a 1/1 stained-glass, tripartite window on the right side of the house. An inset, entry porch with shed roof sits between the gable and the tower. The porch has four square, wooden columns connected by wooden rails. A stained-glass, entry door with 1-light transom flanked by 2/2 stained-glass windows. A paired 2/2 stained-glass window sits to the left of the door. A front-gabled dormer with five 9-light windows sits above the porch.

72a. 401 W. Jefferson c.1930 C
Block 28 Lot 32 A

Large, one-story brick Tudor residence with multiple cross-gables and porches. Corner Lot. North facing front facade. House has a side-gabled central block with two large cross-gabled wings that are mirrored on the back facade. A gabled wing also extends from the left side of the central block. Two brick chimneys with chimney pots are of the back slope of the central block. The front facade's right wing has a 9/1 tripartite window on the right, and an arched, brick entry porch on the left. The front facade's left wing is an open porch with brick knee wall and columns. One wood panel door with one round window and 4-light fanlight are under each porch. A courtyard with brick railing connects the two porches. In the courtyard, on the central block wall, sits a 9/1 tripartite window flanked by 9/1 windows. The gables in the wings are half-timbered with pattered stucco in-fill and an arched louver. The left facade wing is a screened in porch.

72b. c.1930 C
Block 28 Lot 32 B

Outbuildings of Block 28 Lot 32 A

Small, brick front-gabled garage. Garage mimics the style of the house. East facing front facade. Front facade has large wooden double garage doors. Gable has half-timbering with patterned stucco in-fill and an arched louver. Right and left sides have one 9/1 window. Metal carport sits in front of the garage.

**United States Department of the Interior
National Park Service**

**NATIONAL REGISTER OF HISTORIC PLACES
CONTINUATION SHEET**

Section: 7

Page: 19

Okolona Historic District
Okolona, Chickasaw County

73a. 403 W. Jefferson

c.1928

C

Block 28 Lot 31 A

One-story asymmetrical, brick Tudor residence with multiple front gables and dominant, front chimney. Central block is side-gabled with an end-gable attic level. A side-gable wing is attached to the back right side. North facing front facade. On the right side of the central block facade, a concrete stoop with brick piers leads up to a wood-panel, entry door with 4-light fanlight under a gable roof. A dominant front chimney crowned with chimney pots sits to the left of the door. A tripartite window and paired 6/6 windows sit under a curved gable roof. A small, 3-light, arched window with shutters sits in the attic level under the curved gable. Three 9-light French doors sit to the left of the curved gable. Between the chimney and curved gable sit small, paired, 6-light windows under a shed roof in the attic level. A pediment with stucco in-filled half-timbering covered with a front-gable roof sits centered at the crest of the side-gable.

73b.

c.1928

C

Block 28 Lot 31 B

Outbuilding of Block 28 Lot 31 A

One-story brick residence with side-gabled roof and shed roof addition on back. North facing front facade. Wood-panel entry door has six lights and is flanked to the left by a 6/6 window. A large gabled dormer with a wooden louver sits above the entry door in the center of the roof. The left side of the house is connected to the mains house by a covered walkway. A brick chimney sits on the left side of the house.

74. 405 W. Jefferson

c.1945

NC

Block 28 Lot 30

One-story brick residence with cross-hipped roof and entry porch. North facing front facade. The right side extends out under the cross-hipped roof and covers the centered entry porch. Concrete steps lead up to the glazed, 2-light, entry door which is under the porch. The porch has a single, iron, latter, support. The right side has a 24-light, casement window. The left side has 2/2 paired windows next to the door and a 2/2 window next to the left corner of the house.

75. 407 W. Jefferson

c.1950

NC

Block 28 Lot 29

One-story brick residence with side-gable roofs and porch. House has a side-gabled central block with side-gabled wings on both sides. North facing front facade. Central block has a full-facade porch with four square, wooden columns that support a side-gable roof. Above the column is a simple entablature with dentils. Steps lead up to the wood-panel, 2-light, entry door on the right side of the porch. A 6-light window and a 4-light window sit in the middle of the porch. A small, tripartite window sits on the left side of the porch. The right wing has a 6-light window. The left wing has a large multiple-light window. An attached carport with side-gabled roof extends from the left wing.

**United States Department of the Interior
National Park Service**

**NATIONAL REGISTER OF HISTORIC PLACES
CONTINUATION SHEET**

Section: 7

Page: 19

Okolona Historic District
Okolona, Chickasaw County

73a. 403 W. Jefferson

c.1928

C

Block 28 Lot 31 A

One-story asymmetrical, brick Tudor residence with multiple front gables and dominant, front chimney. Central block is side-gabled with an end-gable attic level. A side-gable wing is attached to the back right side. North facing front facade. On the right side of the central block facade, a concrete stoop with brick piers leads up to a wood-panel, entry door with 4-light fanlight under a gable roof. A dominant front chimney crowned with chimney pots sits to the left of the door. A tripartite window and paired 6/6 windows sit under a curved gable roof. A small, 3-light, arched window with shutters sits in the attic level under the curved gable. Three 9-light French doors sit to the left of the curved gable. Between the chimney and curved gable sit small, paired, 6-light windows under a shed roof in the attic level. A pediment with stucco in-filled half-timbering covered with a front-gable roof sits centered at the crest of the side-gable.

73b.

c.1928

C

Block 28 Lot 31 B

Outbuilding of Block 28 Lot 31 A

One-story brick residence with side-gabled roof and shed roof addition on back. North facing front facade. Wood-panel entry door has six lights and is flanked to the left by a 6/6 window. A large gabled dormer with a wooden louver sits above the entry door in the center of the roof. The left side of the house is connected to the mains house by a covered walkway. A brick chimney sits on the left side of the house.

74. 405 W. Jefferson

c.1945

NC

Block 28 Lot 30

One-story brick residence with cross-hipped roof and entry porch. North facing front facade. The right side extends out under the cross-hipped roof and covers the centered entry porch. Concrete steps lead up to the glazed, 2-light, entry door which is under the porch. The porch has a single, iron, latter, support. The right side has a 24-light, casement window. The left side has 2/2 paired windows next to the door and a 2/2 window next to the left corner of the house.

75. 407 W. Jefferson

c.1950

NC

Block 28 Lot 29

One-story brick residence with side-gable roofs and porch. House has a side-gabled central block with side-gabled wings on both sides. North facing front facade. Central block has a full-facade porch with four square, wooden columns that support a side-gable roof. Above the column is a simple entablature with dentils. Steps lead up to the wood-panel, 2-light, entry door on the right side of the porch. A 6-light window and a 4-light window sit in the middle of the porch. A small, tripartite window sits on the left side of the porch. The right wing has a 6-light window. The left wing has a large multiple-light window. An attached carport with side-gabled roof extends from the left wing.

**United States Department of the Interior
National Park Service**

**NATIONAL REGISTER OF HISTORIC PLACES
CONTINUATION SHEET**

Section: 7

Page: 20

Okolona Historic District
Okolona, Chickasaw County

76. 409 W. Jefferson

c.1945

C

Block 28 Lot 28

One-story asbestos-sided residence with brick gable-wall chimney; side-gabled roof; and entry porch. North facing front facade. Concrete steps lead up to the entry porch, which is covered by a small, hipped roof and rests on two ornate, iron supports. The wood-panel entry door has a 4-light fanlight. The porch is flanked by large, 16-light windows. A 6/6 bay window sits on the right side.

77. 411 W. Jefferson

c.1946

C

Block 28 Lot 27

One-story asbestos-sided residence with side-gable roof and entry porch. North facing front facade. The entry porch is an addition to the left side of the house. It has a side-gabled roof which rests on an ornate iron support. Entry door is on the side of the porch. A brick chimney sits in the original left side end-wall. To the right of the porch is a bay window covered by a shed roof. The bay window has a large, single-pane, center window flanked by 6/6 windows. On the right side of the facade are two 6/6 windows.

Main Street, West

78. 100 W. Main

c.1930

C

Block 31 Lot 2

One-story brick residence with side-gable roof, entry porch, and right side porch. Corner Lot. South facing front facade. Entry porch has a shed roof which rests on two ornate, iron supports. Glazed entry door has two wooden pilasters. The entry porch is flanked on the right by a 2/2 window and on the left by 2/2 paired windows. The side-gabled porch rests on brick columns and ornate, iron supports.

79. 102 W. Main

c.1900

C

Block 31 Lot 3

One-story symmetrical, wood-sided residence with side-gabled roof, full-width porch and front-gabled dormer. South facing front facade. Porch has a hipped roof supported by six, square, brick columns and two pilasters connected by a brick knee wall with concrete coping on the columns and knee wall. Concrete steps with iron rails lead up to an entry door flanked by 2/2 windows. Two other 2/2 windows sit on the right and left sides of the facade. Dormer wall is asbestos siding and plywood with a 6/1 paired window. A brick chimney sits on the left end wall.

**United States Department of the Interior
National Park Service**

**NATIONAL REGISTER OF HISTORIC PLACES
CONTINUATION SHEET**

Section: 7

Page: 21

Okolona Historic District
Okolona, Chickasaw County

- 80. 103 W. Main c.1910 C**
Block 40 Lot 21
Large, two-story, wood-sided and stucco house with hipped roof, two porches, back side addition, and covered entry walkway. Corner lot. North facing front facade. 1st floor has wood siding and 2nd floor is stucco. Full-width, entry porch has a hipped roof supported by four stucco columns. A canvas covered walkway leads to concrete steps which lead to the entry door. Entry door has 12-light sidelights and a 24-light transom. The entry door is flanked to the right by a 1/1 tripartite window and to the left by a 1/1 paired window. A 9/1 tripartite window is flanked by 9/1 paired windows in the 2nd floor. A hipped dormer with louver flanked by multiple-light windows sits centered in the hipped roof. A side porch is attached to the left side of the house. Two brick chimneys are on the roof. All roofs and dormers have exposed rafters.
- 81. 104 W. Main c.1900 C**
Block 31 Lot 4
One-story wood and asbestos sided residence with cross-gabled roof and inset porch. South facing front facade. Porch is screened in and has a shed roof with exposed rafters supported by two square, brick columns connected by a brick knee wall with concrete coping. The porch has a 1/1 window on the right and a 6-light, entry door with 1-light transom on the left. To the left of the porch a cross-gable covers 1/1 bay windows. A 1/1 window sits in the middle of the shingled pediment.
- 82. 105 W. Main c.1921 C**
Block 40 Lot 20
One-story wood-sided residence with hipped roof and full-width porch. North facing front facade. Porch has a hipped roof supported by four brick columns connected by brick knee walls with concrete coping. Concrete steps lead up to a wood-panel door flanked by 3/1 paired windows. A shed dormer with three 1-light windows sits centered in the hipped roof.
- 83. 106 W. Main c.1970 NC**
Okolona Fire Department and Police Department
Block 31 Lot 5
One-story commercial-type brick building. South facing front facade. Building is divided into four bays. The 1st bay has storefront windows and a door. The 2nd, 3rd, and 4th bays are large, garage doors. A metal awning runs across the top of the building.
- 84. 107 W. Main c.1920 C**
Block 40 Lot 19
One-story wood sided residence with hipped roof and full facade porch. north facing front facade. Porch had a hipped roof supported by four columns that are covered with ivy and connected by brick knee walls with concrete coping. Concrete steps lead up to a 15-light entry door with a 12-light sidelight to the left. The door is flanked to the right by a 1/1 window and to the left by a 1/1 paired window. A hipped dormer with wood louver sits centered in the roof. All windows have attached shutters. Roof and dormer have exposed rafters.

**United States Department of the Interior
National Park Service**

**NATIONAL REGISTER OF HISTORIC PLACES
CONTINUATION SHEET**

Section: 7

Page: 22

Okolona Historic District
Okolona, Chickasaw County

-
- 85. 110 W. Main** **c.1950** **NC**
Block 31 Lot 6
One-story board-and-batten residence with side-gabled roof and inset porch. South facing front facade. Brick water-table. Porch is under the side-gabled roof and rests on ornate, iron supports. A wood-panel door flanked by 2/2 windows under the porch. A 2/2 paired window sits on the right side of the porch. A 4-light tripartite window sits in the center of the house. A 2/2 paired window sits on the right side of the house.
- 86. 112 W. Main** **c.1940** **C**
Block 31 Lot 7
One-story brick commercial building with L-plan and left side addition. Corner lot. Southwest facing front facade. Storefront has two doors framed by brick pilasters at the corners. Left side door is a wood paneled door with 12-light window. Right side door is a glazed wooden door. Asphalt shingle awning is attached above the doors and rests on three wooden supports. Upper-facade is a metal slipcover. Cornice is a metal coping. Right side has a 6/6 window and a glazed wooden door with 4-light transom. Left side addition connects lot 7 with lot 8 and has a 15-light door flanked by 6/6 tripartite windows.
- 87. 201 W. Main** **c.1924** **C**
First Baptist Church
Block 41 Lot 36
Three story, symmetrical, brick church with hipped roof and parapet; full-height entry porch; and large, matching, symmetrical, addition to the right. Corner lot. North facing, five-ranked front facade. Full-height entry porch has brick steps that lead up two the 2nd floor. Four large, Ionic columns support an entablature and pediment. Porch steps back into the building taken up the three central ranks of the facade. Two entry doors are located on the sides of the porch. A window is above both doors. Windows are 1/1 paired with stone sills. Five-ranked, right side addition has matches the original church in size and proportion, but steps out from the original building. Addition has double, glazed, entry doors with 2-light transom covered by a flat roof which is supported by two Ionic columns. All windows in the addition are 1/1 with stone sills except the central rank which are 1/1 paired windows. A stone belt course, entablature, and cornice run around the whole building. The entablature and pediment have dentils.
- 88. 207 W. Main** **c.1894** **NC**
Block 41 Lot 33
One-story stucco commercial building. North facing three-bay facade. Metal-frame windows and doors. 1st bay has three windows. 2nd and 3rd bays have door with left sidelight and transom flanked by windows. Each bay is covered by a canvas awning. Each door and window has a plywood in-filled pediment. Stucco upper-facade with metal coping.

**United States Department of the Interior
National Park Service**

**NATIONAL REGISTER OF HISTORIC PLACES
CONTINUATION SHEET**

Section: 7

Page: 23

Okolona Historic District
Okolona, Chickasaw County

- 89. 208 W. Main** **c.1889** **NC**
Block 30 Lot 12 A
Extensively altered one-story brick commercial building. South facing front facade. Original brick storefront has been bricked-over. Storefront display windows and door are metal-frame. A metal awning that covers the transom has been attached to the upper-facade and is supported by brick columns. The building retains its ornate late Victorian pressed metal cornice with corner finials.
- 90. 209 W. Main** **c.1960** **NC**
Block 41 Lot 34 & 35
One-story brick commercial building with 2-bay facade. North facing facade. Both bays have a metal-frame door flanked by metal-frame windows. Upper-facade is a plastic-tile awning.
- 91. 210 W. Main** **c.1889** **NC**
Block 30 Lot 12 B & C
Two-story brick commercial building with a 6-bay upper facade. South facing front facade. Original storefront has been bricked-over. Storefront display windows are metal-frame. A metal awning that covers the transom has been attached to the upper-facade and is supported by brick columns. Two groups of 4-light windows have been covered with plywood. The right side of the roof has a metal coping. The left side of the roof has an added gable with wood siding and wooden louver vent. Removal of attached storefront brick, metal awning, and brick supports could make this building contributing.
- 92. 211 W. Main** **c.1925** **C**
Block 41 Lot 32
One-story brick commercial building. North facing two-bay facade. 1st bay has 8/8 paired windows with 2-light transom and attached shutters. Brick soldier course above the lintel. 2nd bay is stepped out from the rest of the facade and has a recessed, glazed door. Two metal louvers sit in the upper-facade of the 1st bay.
- 93. 212 W. Main** **c.1960** **NC**
Block 30 Lot 12 A.1
One-story freestanding downtown commercial building with concrete block walls and a flat roof. South facing front facade. Triangular plan building with large, attached, rectangular, garage. Entry door has glass pane and is flanked on both sides by large, 4-light, metal frame windows. One plywood covered window sits in both side walls of the front facade. Attached garage has two garage doors.
- 94. 213 W. Main** **c.1975** **NC**
Block 41 Lot 31 D
One-story stone commercial building. North facing facade. Storefront has metal-frame, double doors flanked by metal-frame windows. A metal awning with metal supports has been attached above the storefront. Stone upper-facade with metal coping.

**United States Department of the Interior
National Park Service**

**NATIONAL REGISTER OF HISTORIC PLACES
CONTINUATION SHEET**

Section: 7

Page: 24

Okolona Historic District
Okolona, Chickasaw County

-
- 95. 214 W. Main** **c.1889** **C**
Block 30 Lot 13
One-story brick commercial building. South facing front facade. Three-bay metal-frame storefront with brick pilasters. Originally two stores with the 1st and 2nd bays comprising one store, and the 3rd bay comprising the other. Transom above windows and doors. Brick lentil is a continuous soldier course. Upper-facade has stone medallions set in two recessed, brick signboards. Cornice consists of a stepped pediment capped with a concrete coping.
- 96a. 215 W. Main** **c.1975** **NC**
Block 41 Lot 31 C
One-story stone commercial building. North facing facade. Storefront has metal-frame door on left and metal-frame window on right. A metal awning with metal supports has been attached above the storefront. Stone upper-facade. Cornice is three stone arches with metal coping.
- 96b. rear of 215 W. Main** **c.1935?** **C**
Block 41 Lot 31 E
Outbuilding of Block 41 Lot 31C.
A two-story brick building with a gable roof. Garage doors facing south. 1/1 windows.
- 97. 216 W. Main** **c.1889** **C**
Block 30 Lot 14 A
One-story brick commercial building. South facing front facade. Recessed entry door. Storefront doors and display windows are metal-frame. Brick bulkhead. A metal awning has been attached to the upper-facade and is supported by brick columns. Brick upper-wall with inset brick panel.
- 98. 217 W. Main** **c.1889** **C**
Block 41 Lot 31 B
One-story brick commercial building. North facing facade. Storefront has two bays. 1st bay has metal-frame windows and a door. 2nd bay has metal frame windows with vinyl in-fill in lower openings. Transom is covered by a metal awning resting on metal supports. Recessed brick signboard. Brick coping.
- 99. 218 W. Main** **c.1889** **NC**
Block 30 Lot 14 B
One-story brick commercial building. South facing front facade. Storefront doors and display windows are metal-frame. Brick bulkhead. A metal awning has been attached to the upper-facade and is supported by brick columns. Brick upper-wall.

**United States Department of the Interior
National Park Service**

**NATIONAL REGISTER OF HISTORIC PLACES
CONTINUATION SHEET**

Section: 7

Page: 25

Okolona Historic District
Okolona, Chickasaw County

-
- 100. 219 W. Main** **c.1889** **C**
Block 41 Lot 31 A
One-story brick commercial building. North facing facade. Brick pilasters with stone caps frame the building. Recessed entry. Storefront display windows and door are wood. Ceramic tile bulkheads. Transom is covered by a metal awning resting on metal supports. Ceramic, tile signboard with flanking ceramic tile medallions. Cornice has a ceramic tile entablature; small, shed roof with ceramic roof tile; and a ceramic tile coping.
- 101. 221 W. Main** **c.1888** **NC**
Block 41 Lot 30
Extensively altered one-story brick commercial building. North facing facade. Storefront is divided into two bays by brick pilasters. First bay is brick. Second bay is filled with metal frame windows and a door. Upper-facade is covered with a metal slipcover.
- 102. 222 W. Main** **c.1942** **C**
Block 30 Lot 15
One-story brick commercial building. South facing front facade. Windows and entry are recessed. Storefront doors and display windows are metal-frame. Bulkheads are brick. A metal awning has been attached to the upper-facade. Cornice is stone coping.
- 103. 223 W. Main** **c.1970** **NC**
Block 41 Lot 29
One-story brick commercial building. Corner lot. Main St. storefront faces North and has a glazed, metal-frame door and 1-light, metal-frame window. A wood-shingle awning with eleven, wood supports has been attached above the window and door, and wraps both facades of the building. Upper-facade is brick. Cornice is a brick parapet. Silver St. storefront faces West and has a two door openings that have been in-filled with wood-siding, and three 1-light windows. Silver St. facade has ceramic tile coping. Wrap awning extends to cover a brick addition to the back of the building. The addition has two doors and a 2-light storefront window.
- 104. 224 W. Main** **c.1889** **C**
Block 30 Lot 16 A
Two-story brick commercial building with a 3-bay facade. South facing front facade. Storefront consists of three brick arches. Recessed entry door with sidelights in the center bay. 1st and 2nd bays consist of display windows with brick bulkheads. All windows and doors are metal frame. A metal awning has been attached above the door and windows. Glass in the arches above the awning has been painted over. Upper-facade has three brick in-filled, arched, window openings topped by round, arch, brick hoods. Cornice has elaborate brick work.
- 105. 226 W. Main** **c.1889** **C**
Block 30 Lot 16 B
Two-story brick commercial building. South facing front facade. Recessed double doors and display windows. Doors are wood panel and windows are metal frame. A metal awning has been attached above the storefront. Upper-facade has four 8/8 windows with wooden frames. Two roof drains are attached on both ends of the building. Cornice consist of stepped parapet with concrete coping.

**United States Department of the Interior
National Park Service**

**NATIONAL REGISTER OF HISTORIC PLACES
CONTINUATION SHEET**

Section: 7

Page: 26

Okolona Historic District
Okolona, Chickasaw County

-
- 106. 227 W. Main** c.1924 C
Block 42 Lot 61 A & B
Two-story symmetrical, brick commercial building with one-story addition to the right. Corner lot. North facing front facade. Original building has a central frontispiece flanked by large, fluted, stone Ionic columns which rest on stone piers and extend up to the 2nd floor entablature. Stone frontispiece surrounds metal-frame double doors with large 1-light transom. Large entablature has dentils and "Bank of Okolona" in metal letters on the frieze. Stepped brick parapet has concrete coping. A copper and stained-glass clock is attached to the left corner of the building. East facade has six bays with metal-frame windows on the 1st and 2nd floor of each bay, except for the 1st floor of the 1st bay which has an entry door. Concrete addition has three bays. The 1st and 2nd bays are in-filled with a brick wall flanked by metal-frame windows. The 3rd bay is an opening for a driveway to a back parking lot.
- 107. 228 W. Main** c.1925 C
Block 30 Lot 16 C
Two-story brick commercial building. South facing front facade. Recessed double doors. Doors are wood panel and display windows are wood frame. A metal awning has been attached above the storefront. Upper-facade has three 6/6 windows with wooden frames and concrete sills. Cornice is brick with concrete coping.
- 108. 230 W. Main** c.1889 C
Block 30 Lot 17
Two-story brick commercial building. South facing front facade. Recessed double doors with one round column in front of doors. Doors and display windows are metal frame with brick bulkheads. Four ornate, iron pilasters frame the windows. A wood shingle awning has been attached above the storefront. Upper-facade has seven windows covered by wooden louver shutters. Cornice is brick and concrete with metal coping.
- 109. 231 W. Main** c.1960 NC
Block 42 Lot 59
Two-story brick commercial building. North facing facade. Storefront has metal-frame, display windows and double doors. A metal slipcover is attached to the upper-facade. A large signboard is attached to the slipcover. Metal coping.
- 110. 232 W. Main** c.1920 C
Block 30 Lot 18
Two-story brick commercial building. South facing front facade. Double doors and display windows are metal frame with brick bulkheads. A metal awning and small slipcover has been attached above the doors and windows covering the transom. Upper-facade consists of three windows with a continuous concrete sill and lentil. Upper-facade windows are small single-pane windows set in original openings with vinyl in-fill. Metal cornice has been removed. Cornice consists of bands of concrete and brick with a concrete coping.

**United States Department of the Interior
National Park Service**

**NATIONAL REGISTER OF HISTORIC PLACES
CONTINUATION SHEET**

Section: 7

Page: 27

Okolona Historic District
Okolona, Chickasaw County

111. 233 W. Main

c.1889

C

Block 42 Lot 58

Two-story brick commercial building. North facing facade. Storefront has four wood-frame, display windows with 4-light transom and brick bulkhead. To the right of the windows is the glazed entry door with transom. The transom above the windows and door is partially covered by plywood. Upper-facade has three windows with closed shutters. Brick cornice has soldier course.

112. 234, 236 & 238 W. Main

c.1925

C

Masonic Building and Chickasaw County Second District Courthouse

Block 30 Lot 19

Three-story brick Neoclassical Revival commercial and institutional building. South facing front facade. On the first story, the storefront is recessed behind two square, stone columns and two end arches. A simple concrete entablature rests on the columns and arches. Storefront had three entry doors. Storefront doors and windows are metal-frame. The transom above the doors and display windows has been painted over. The upper facade is distinguished by six monumental fluted Ionic pilasters supporting an entablature. The pilasters divide the upper-facade into three bays. Second floor windows are replacement 5-light awning types in metal frames, while 3rd floor is original 8-light casements in wood frames. Second floor transoms are painted over. Above the entablature is a shaped brick parapet with concrete coping. On the right corner of the building there is a door to provide access to the second story. Above the door is a brick in-filled window on the 2nd floor and an ornate multi-pane window on the 3rd floor.

113. 235 W. Main

c.1960

NC

Block 42 Lot 60

One-story brick commercial building. North facing facade. Storefront has metal-frame, display windows and double doors. A metal slipcover is attached to the upper-facade. A large signboard is attached to the slipcover. Metal coping.

114. 237 W. Main

c.1889

NC

Block 42 Lot 57 A

Two-story brick commercial building. North facing facade. Storefront consists of large metal-frame windows and door. Upper-facade has three arched, window openings with brick hoods. The center window opening has a 4-light window with brick in-filled arch. The right and left window openings have been in-filled with brick. Concrete medallions are set in the hoods and the cornice.

115. 238 W. Main

c.1889

NC

Block 42 Lot 57 B

Two-story brick commercial building. North facing facade. Storefront consists of metal-frame windows and door. Cast iron pilasters topped with a metal beam frame the storefront. Beam has ornate 'flower' bolts. Brick upper-facade has one centered, 4-light window.

**United States Department of the Interior
National Park Service**

**NATIONAL REGISTER OF HISTORIC PLACES
CONTINUATION SHEET**

Section: 7

Page: 28

Okolona Historic District
Okolona, Chickasaw County

116. 239 W. Main

c.1889

C

Block 42 Lot 56

Two-story brick commercial building. North facing facade. Storefront consist of three large metal-frame windows and double doors surrounded by in-fill panels of granite pebble board. A large protruding metal awning is attached over the storefront. Upper-facade has three arched, window openings with brick hoods. The window openings are covered with corrugated metal panels. Concrete medallions are set in the hoods and the cornice.

117. 240 W. Main

c.1924

C

Block 30 Lot 21

One-story brick commercial building. South facing front facade. One building with two identical storefronts located on two lots. Storefront double-doors and display windows are metal-frame. Doors are recessed. Bulkheads are brick. A metal awning has been attached above the doors and windows. Transom windows above the awning have been covered with plywood. Upper-facade consists of three recessed, brick panels with ornate brickwork in the center of each panel. Cornice consists of brick parapet with a concrete coping.

118. 241 W. Main

c.1880

C

Block 42 Lot 55

Two-story brick commercial building. North facing facade. Storefront has metal-frame, double doors and display windows. A pebble board awning has been attached above the windows and doors. Upper-facade has four round-arched window openings with brick hoods. Window openings are covered with metal panels. Ceramic tile coping.

119. 242 W. Main

c.1905

C

Block 30 Lot 22

One-story brick commercial building. South facing front facade. One building with two identical storefronts located on two lots. Storefront double-doors and display windows are metal-frame. Doors are recessed. Bulkheads are brick. A metal awning has been attached above the doors and windows. Transom windows above the awning have been covered with plywood. Upper-facade consists of three recessed, brick panels with ornate brickwork in the center of each panel. Cornice consists of brick parapet with a concrete coping.

**120. 245 W. Main & 243 W. Main
Merchant & Farmers Bank**

1903

PL

Block 42 Lot 54

Previously listed on National Register of Historic Places (14 May 1987).

Two-story stone masonry commercial building. North facing facade is rusticated with heavy stone masonry. Storefront has a large, stone arch. Arch is in-filled with a 3-bay storefront. The 1st bay is a recessed entry with upper-level entry. 2nd and 3rd bays each have a large display window with wood-panel bulkheads. A 3-light, arch transom sit above the windows and entry. The wood-frame windows has ornate columns and dentils. The upper-facade has three 1/1 arched windows with stone arch hood. The cornice is an ornate stone parapet wall. "Merchants & Farmers Bank" is inscribed in stone between the storefront and upper-facade.

**United States Department of the Interior
National Park Service**

**NATIONAL REGISTER OF HISTORIC PLACES
CONTINUATION SHEET**

Section: 7

Page: 29

Okolona Historic District
Okolona, Chickasaw County

-
- 121. 247-A W. Main** c.1905 C
Block 42 Lot 53 A
One-story concrete block commercial building. North facing facade. Storefront is scored cast concrete and has a recessed entry flanked by wood-frame, display windows. Windows have a 2-light transom. Transom above the entry is covered with plywood. concrete block upper-facade. A metal beam with ornate bolts sits between the storefront and upper-facade.
- 122. 247-B W. Main** c.1889 C
Block 42 Lot 53 B
Two-story brick commercial building. North facing facade. Storefront has a recessed entry with glazed, wood-panel door. Transom over door. Door is flanked by display windows. Brick has a ribbon texture. Brick bulkheads. Transom covering windows and entry is covered with wood siding. Brick upper-facade has three windows covered with corrugated plastic siding. Concrete beams with iron bolts run above and below the windows. Concrete coping.
- 123. 249 W. Main** c.1900 C
Block 42 Lot 52
One-story concrete block commercial building. North facing storefront has a large vertical wood-panel in-fill with 9-light wood-panel door on the left and two 1/1 windows to the right of the door. A plywood in-filled 5-light transom sits above the windows and door. Concrete masonry unit upper-facade. Brick cornice and coping.
- 124. 251 W. Main** c.1920 NC
Block 42 Lot 51
One-story Roman brick commercial building. North facing facade has a ribbon of metal-frame, storefront, display windows with a recessed metal-frame door. Brick upper-facade has metal letters that say "Simpson's". Concrete coping.
- 125. 253 W. Main** c.1925 NC
Block 42 Lot 50 B
One-story brick commercial building. West facing facade has a 3-light wood-panel door with sidelights on the left side, and a wood-panel door flanked by 8-light windows on the right side. An asphalt shingle awning supported by six, wood columns has been attached to the upper-facade.
- 126. 255 W. Main** c.1910 NC
Block 42 Lot 50 A
Extensively altered one-story brick commercial building with 2-bay facade. Corner Lot. North facing front facade. 1st bay has a frontispiece flanked by 12-light windows. Frontispiece has a wood-panel door flanked by pilasters and capped with a broken pediment. 2nd bay has storefront display windows, recessed entry door, brick bulkhead, and a wood-shingle awning. Cornice is brick with brick dentils.

**United States Department of the Interior
National Park Service**

**NATIONAL REGISTER OF HISTORIC PLACES
CONTINUATION SHEET**

Section: 7

Page: 30

Okolona Historic District
Okolona, Chickasaw County

127. 300 W. Main

c.1962

NC

Block 29 Lot 8A

One-story brick commercial building. South facing front facade. Storefront windows and double-doors are metal-frame. A metal awning has been attached above the storefront. Upper-facade is brick with a large metal signboard bolted to the facade. Ceramic tile coping.

128. 302 W. Main

c.1905

C

Block 29 Lot 7

One-story brick commercial building. South facing front facade. Ornate cast iron pilasters break the facade into four bays. Storefront windows and double-doors are metal-frame. Display windows are in the 1st, 2nd, and 4th bays. The door with transom is in the 3rd bay. The transoms above all of the windows and the door are covered with plywood. A metal awning has been attached above the storefront. Upper-facade is brick with a wood sign attached. Brick cornice has dentils with metal coping.

129. 304 W. Main

c.1905

C

Block 29 Lot 6

One-story brick commercial building with residential features. South facing front facade. Storefront consists of a central, glazed, wooden door with 1-light transom flanked by 1/1 paired windows. Bulkheads are brick. Storefront has a full-width porch. The porch has a wooden deck, brick piers topped by wood columns, and is covered by a triangular wooden pediment. Cornice consists of a stepped brick parapet in the shape of a gable.

130. 306 W. Main

c.1889, 1930s? NC

Block 29 Lot 5

Extensively altered two-story stucco-clad commercial building. South facing front facade. Storefront has metal-frame doors and windows. Entry door has sidelight to the left and a transom. Door is flanked by single-pane windows covered with latticework. Upper-facade has four 6/6 windows. Windows are smaller replacement windows with plywood in-fill. Cornice consists of a shaped parapet with concrete coping.

131. 308 W. Main

c.1899

C

Block 29 Lot 5.1

Two-story commercial building. South facing front facade. Storefront is scored concrete with four arch openings. The two end arches have been modified with a 2/1 window, plywood bulkheads, and concrete in-filled arch. The two central arches now have doors with plywood covered arches. The right-side door is a wood-panel double-door with 1-light in each door. The left-side door is a 12-light wood-panel door with plywood in-fill. The upper-facade is brick with three arches that have replacement 2/2 windows and plywood in-fill in the arches. Ornate brick garlands form a hood molding above each window. A large sign extends perpendicular from the wall. Cornice consists of elaborate brick corbelling.

**United States Department of the Interior
National Park Service**

**NATIONAL REGISTER OF HISTORIC PLACES
CONTINUATION SHEET**

Section: 7

Page: 31

Okolona Historic District
Okolona, Chickasaw County

132. 310 W. Main 1897 C
Masonic Hall, New Era Lodge No. 13

Block 29 Lot 4

Two-story brick commercial building, built for the community's African American Masonic Lodge. South facing front facade. Storefront has four arched brick openings. The arches increase in size from left to right. The 1st arch is in-filled with a 2/1 window, plywood bulkhead, and plywood arch in-fill. The 2nd has a 6-light wood door set in plywood in-fill. The 4th arch has a wood-panel door set in plywood in-fill. The 3rd arch is in-filled with a wooden door with 1/4 window and plywood in-fill. Some of the windows in the 3rd arch door are painted-over. Upper-facade has three arched openings. The 1st and 3rd arches have been in-filled with plywood. The 2nd arch has a 6/6 window that has been painted-over and plywood in-fill. The cornice features patterned rows of brick and a Masonic insignia.

133. 312 W. Main c.1926 C

Block 29 Lot 3

One-story brick commercial building. South facing front facade. Storefront has display windows and recessed double-doors. Window and door frames are wooden. Bulkheads are brick. Transom has been covered with wood siding. Upper-facade has a recessed brick panel. Cornice is a stepped brick parapet with Concrete block coping.

134. 314 W. Main c.1946 NC

Block 29 Lot 2

One-story concrete masonry unit, commercial building. South facing front facade. Storefront has a 1-light door flanked by a 1-light display windows to the left and a door flanked to the right by a 1-light display window. Doors and window frames are wooden. Upper-facade is concrete block. Cornice is concrete block.

135. 316 W. Main c.1977 NC

Block 29 Lot 63

A small, one-story brick commercial building. South facing front facade. Storefront has metal double-doors and windows. Doors are flanked by two 4-light windows and a single pane window to the right and a 4-light window the left. Upper-facade is brick. Cornice is a metal coping.

136. 317 W. Main 1907-08 C

United First Methodist Church

Block 43 Lot 82

Brick church, with irregular L-plan, multiple-gable roof, and two towers. Corner Lot. Main St. facade faces North and has gable end flanked by square towers on both sides, and a two-story addition to the right. Right side tower has steps leading up to a round arch entry way with double panel doors, a stained-glass fanlight, and a spire. Left side tower mimics the right, but has an added section with a 4-light, round, stained-glass window and a taller spire. Gable end has large, multiple-pane, stained-glass, shaped window with a small, 3-light, stained-glass fanlight. Olive St. façade has two gables, a projecting entrance, and seven, 1/1 stained-glass windows.

United States Department of the Interior
National Park Service

**NATIONAL REGISTER OF HISTORIC PLACES
CONTINUATION SHEET**

Section: 7

Page: 32

Okolona Historic District
Okolona, Chickasaw County

-
- 137. 319 W. Main 1937 C**
U. S. Post Office
Block 43 Lot 81
One-story + basement, brick building with rectangular plan, flat roof, and symmetrical North facing front facade. Concrete steps with iron railings lead up to the frontispiece. The frontispiece consists of metal-framed, glass double doors; stone pilasters; and is topped by a entablature with dentils. A 5-light transom sits between the pilasters. The door is flanked by two 8/12 windows with concrete lintels and sills. Concrete coping.
- 138. 320 W. Main c.1950 NC**
Block 29 Lot 65
One-story side-gabled, brick commercial building. South facing front facade. Ribbon storefront windows with two entry doors at each end rest on a concrete sill. Storefront is covered by a metal awning. Bricks are oversized. Side-gabled roof has asphalt shingles.
- 139. 321 W. Main 1915 C**
Carnegie Library
Block 43 Lot 2
One-story brick building with rectangular plan, symmetrical North facing front facade, and low slope hipped roof. Large addition on back. Six Tuscan pilasters sit between a simple stone entablature and water table. Concrete steps with stone rails lead up to a Greek revival frontispiece. Frontispiece consists of a glass entry door, fluted pilasters, full entablature, and pediment. The door is flanked on both sides by two 6/6 windows with stone jack-arch lintels and sills. Small, 6-light, basement windows sit under each 1st floor window in the water table. Stone Coping.
- 140. 322 W. Main c.1932 NC**
Block 29 Lot 62 B
A small, one-story brick commercial building with an asphalt shingle hipped roof. South facing front facade. Front facade has two bays. Each bay has a 24-light casement window set in wood siding in-fill.
- 141. 323 W. Main 1960 NC**
Block 43 Lot 1
One-story brick building with rectangular plan and flat roof, housing facilities of the Chickasaw County Health Department. Corner lot. Main St. facade faces North and consist of two 8/8, wood, windows and one glass and metal frame, entry door with transom and side-lights. Door and windows are symmetrically placed across the facade with the door to the left side. Metal letters spell out "Okolona Health Center". Concrete coping.
- 142. 324 W. Main c.1950 NC**
Block 29 Lot 62 A
A small, one-story brick commercial building. South facing front facade. Storefront windows and door are metal frame. Corners of facade are brick. A cloth awning is attached above the storefront. Cornice is a metal coping.

**United States Department of the Interior
National Park Service**

**NATIONAL REGISTER OF HISTORIC PLACES
CONTINUATION SHEET**

Section: 7

Page: 33

Okolona Historic District
Okolona, Chickasaw County

-
- | | | |
|---|---------------|-----------|
| 143. 326 W. Main
Presbyterian Church
Block 29 Lot 58 | 1919 | C |
| <p>One-story front-gabled, brick church with one-story addition to the left. South facing front facade. Concrete steps with iron railing leads up to an undercut porch. Front gable pediment has a stucco finish and is supported by four fluted, Ionic columns. Entry is a glazed double-door with 10-lights in each door. A transom sits above the door and the door is flanked by rectangular, stained-glass windows on the original porch. Addition has a colonnade of six small ionic columns that mimic the larger ones. Colonnade supports a shed roof off of a brick parapet wall. Addition has a panel, 6-light double-door with 10-light transom; four 1/1 stained-glass windows; and one round 9-light window.</p> | | |
| 144. 327 W. Main
Block 44 Lot 16 | c.1990 | NC |
| <p>One-story symmetrical, brick house with side-gable roof and entry porch. North facing front facade. Front-gable entry porch is supported by two round, wooden columns. A wood-panel entry door with 1-light sidelights sits under the porch. The porch is flanked by two 6/6 windows with attached shutters.</p> | | |
| 145. 328 W. Main
Block 29 Lot 57 | c.1899 | C |
| <p>One-story vinyl-sided residence with cross-gable roof and inset porch. South facing front facade. Porch has a shed roof supported by a square, wooden column resting on a brick pier and a replacement wood column. Porch has a 2/2 window flanked by 1-light doors and a side entry door. Cross-gable has a 2/2 paired window with a louver in the gable. All windows have attached shutters.</p> | | |
| 146. 329 W. Main
Block 44 Lot 15 | c.1980 | NC |
| <p>One-story vinyl-sided residence with front-gable roof and inset carport. North facing front facade. The windows and doors fill the middle of the front-gable wall. The wood entry door is flanked by two 1-light windows on the right and a 1-light window on the left. Four 1-light windows sit above the windows and door. A inset shed-roof carport resting on two metal supports sits on the left of the facade. A door sits in the back wall of the carport.</p> | | |
| 147. 330 W. Main
Block 29 Lot 56 | c.1905 | C |
| <p>One-story vinyl-sided residence with pyramidal roof and full-width porch. South facing front facade. Porch has hipped roof supported by five round, fluted, wooden columns. Concrete steps lead up to a glazed, wood-panel, entry door with transom. Door is flanked on the right side by 1/1 window. Left side projects out and is covered by a front gable roof with metal louver. A 1/1 window is centered on the left side. Both windows have attached shutters.</p> | | |

**United States Department of the Interior
National Park Service**

**NATIONAL REGISTER OF HISTORIC PLACES
CONTINUATION SHEET**

Section: 7

Page: 34

Okolona Historic District
Okolona, Chickasaw County

148. 331 W. Main

c.1940

C

Block 44 Lot 14

One-story asbestos-sided residence with side-gable roof and entry stoop. North facing front facade. A front-gabled wall projects out from the center of the facade. Concrete steps lead up to the wood-panel entry door covered with a metal awning centered in the front-gable wall. A round louver sits in the gable. The front-gable wall is flanked by a 1/1 window on the right side and a 30-light casement window on the left. Windows have attached shutters.

149. 332 W. Main

c.1900

NC

Block 29 Lot 55

One-story brick residence with cross-gabled roof and shed porch. Corner Lot. South facing front facade. Porch has shed roof and two square, brick columns. Glazed entry door is flanked to the right by two 6/6, metal-frame windows. Left side projects out and is covered by the cross-gable. One 6/6 window is centered on the left side. A metal louver sits in the gable. All windows have attached shutters.

150. 335 W. Main

c.1980

NC

Block 44 Lot 11

Two-story brick residence with a three-part plan, side-gable roofs, and full-height entry porch. North facing front facade. Asphalt shingle roofs. Central block has exterior brick chimneys on both gable walls. Porch has simple entablature and is supported by four Tuscan columns and two pilasters. Five-ranked central block has 8/8 windows with shutters, and a wood panel entry door with fanlight and sidelights. One-story wings have three windows on each side. Five of the windows match the windows in the central block, and one window to the right of the central block has been replaced by a large single-pane window with wood siding surround. Iron fence with brick posts surround the lot.

151. 400 W. Main

1908

C

Grace Episcopal Church

Block 28 Lot 38

One-story brick, rectangular church with parapet on gabled roof. Corner lot. The Main St. facade faces South and has side-gabled, lead-shingled roof and brick buttresses. The entry porch is right centered, has a tall parapet with 2 square towers, a balustrade between the towers, a hipped roof topped with a metal cross, projecting brick walls, double wooden doors, and concrete steps. The porch is flanked on the right side by three clustered, Gothic-arched stained glass windows, and on the left side by two 1-over-3 ogee arched stained-glass windows. The School Street facade is a brick parapet wall on the gable end topped with a metal cross.

152. 404 W. Main

c.1920

C

Block 28 Lot 39

One-story wood-sided residence with clipped-gable roof and full-facade porch. South facing front facade. Porch is covered by a shed roof and is supported by four brick columns connected by a brick knee wall with concrete coping. Concrete steps lead up to the center of the porch. The glazed, entry door with 10-light sidelights and 10-light transom sits in the center of the front facade. To the right of the door are two paired, 3/1 windows. To the left of the door are 3/1 paired windows. A clipped-gable roof with 3/1 tripartite windows sit in the center of the roof.

United States Department of the Interior
National Park Service

**NATIONAL REGISTER OF HISTORIC PLACES
CONTINUATION SHEET**

Section: 7

Page: 35

Okolona Historic District
Okolona, Chickasaw County

153. 406 W. Main
Block 28 Lot 40

c.1925 C

One-story vinyl-sided residence with hipped roof and inset porch. Exterior brick chimney on right side. South facing front facade. Porch has shed roof supported by four round, fluted, wooden columns. Concrete steps lead to the entry door on the porch. Entry door has 3-lights with 2-light sidelights. The door is flanked on the right and left by a set of 3/1 paired windows. Left side projects out and is covered by a broken hipped roof.

154. 407 W. Main
Block 45 Lot 30

c.1927 C

One-story brick residence with clipped-gable roof, entry porch, side-gable wing, and attached carport. North facing front facade. Porch has a hipped-roof supported by two brick columns. Concrete steps under the entry porch lead up to the 12-light entry door with 8-light sidelights and 8-light transom which is flanked to the right by a 6/1 window. The porch is flanked to the right by a 6/1 paired window and to the left by a 6/1 tripartite window. Left side wing has a 12-light door with 1-light transom flanked to the left by a 6/1 window. A side-gable carport supported by metal columns is attached to the right side of the house. A vinyl-sided hipped dormer with three 6/1 windows sits centered on the roof. A brick chimney sits on the right side of the roof.

155. 408 W. Main
Block 28 Lot 41

c.1955 NC

One-story ranch house with side-gabled roof and front-gabled addition. Centered interior, slope, brick chimney. South facing front facade. Facade consists of a front-gabled addition on the left side and a garage on the right side. Three bay facade. 1st bay has a 2/2 window with attached shutters in a gable wall. 2nd bay has a wood-paneled entry door with 1-light sidelight flanked on the right by a 2/2 tripartite window with attached shutters and on the left by a 2/2 window. A half-height stone wall sets in front of the facade. 3rd bay has a 6/6, tripartite window with attached shutters and a garage supported by five square, wooden columns.

156. 409 W. Main
Block 45 Lot 29

c.1899 C

Two-story wood-sided house with hipped roof and inset porch. North facing front facade. Four bay facade. Porch extends across the 1st through 3rd bays and has a shed roof supported by five brick columns. 2nd and 3rd bays of the porch have brick knee walls connecting the columns. 1st bay is open. 2nd bay has two 2/2 windows in both floors. 3rd bay has concrete steps that lead up to the entry door and a 6/6 window in the 2nd floor. 4th bay projects out from the facade and has a clipped-gable roof. 4th bay has a 2/2 bay window with hipped roof on the 1st floor and a 2/2 paired window in the 2nd floor. A clipped-gable dormer with three 1-light windows sit in the roof above the 3rd bay. Windows in the 1st floor have pediments with brackets.

**United States Department of the Interior
National Park Service**

**NATIONAL REGISTER OF HISTORIC PLACES
CONTINUATION SHEET**

Section: 7

Page: 36

Okolona Historic District
Okolona, Chickasaw County

157. 410 W. Main

c.1925

C

Block 28 Lot 42

One-story brick Tudor residence with cross-gabled roof. South facing front facade. Facade has two cross-gables. Four bay facade. 1st bay has a shed-roof carport supported by three brick columns. 2nd bay has a centered dominant front chimney with patterned brick work flanked by 6/6 windows in the cross-gable. 3rd bay has concrete steps with iron rails that lead up to an arched entry covered by a flat roof resting on three ornate, iron supports. The arched opening leads to a 9-light entry door under the porch. 4th bay cross-gable covers a brick arched wrap-around porch. A 6/6 window sits in the porch wall. A small, 6-light, paired window sits in the gable. A large addition is attached to the back of the house.

158a. 411 W. Main

1924

C

Okolona High School

Block 45 Lot 28 A

Three story, brick school building with T-plan and craftsman detailing. North facing front facade. Corner Lot. Main St. facade faces North and is a five-part facade. Central entrance is flanked by groups of three then four 12/8 windows in the hyphen. Projecting wings have ornate brick patterns. A concrete water table, belt course, and string course circle the entire building. The cornice is brick with a concrete coping.

158b. 411 W. Main

c.1925

C

Block 45 Lot 28 B

Two-story symmetrical, brick building with hipped roof and two concrete belt courses. West facing front facade. Three bay facade. 2nd bay projects from the facade and has two 6/6 windows in an inset arch on the 1st floor and two 6/6 windows on the 2nd floor. A gable-roof sits over the 2nd bay. 1st and 3rd bays have four 2/2 windows in both floors.

158c. 411 W. Main

1957

NC

Block 45 Lot 28 C

One-story brick building with flat roof. Two 1-light doors with a 3-light window sits on the right side of the facade. A multiple-light window sits on the left of the facade.

158d. 411 W. Main

1957

NC

Block 45 Lot 28 D

One-story brick and wood-siding building with rectangular shaped plan, flat roof, and attached gymnasium. West facing front facade. Front facade has multiple windows along the facade. Brick gymnasium has a metal barrel vault roof.

United States Department of the Interior
National Park Service

NATIONAL REGISTER OF HISTORIC PLACES
CONTINUATION SHEET

Section: 7

Page: 37

Okolona Historic District
Okolona, Chickasaw County

159. 412 W. Main
Block 28 Lot 43

c.1925 C

One-story asbestos-sided residence with clipped-gable roof and entry porch. South facing front facade. A front gable and shed roof with exposed rafters extend from the clipped-gable pediment. A 6/1 paired windows set in the clipped-gable pediment, while a louver vent sets in the front gable pediment. The porch has a brick water table and is supported by four square, wooden columns resting on brick piers. Concrete steps on the porch lead up to the centered, 15-light, entry door. The entry door is flanked on the right by a 6/1 tripartite window, and on the left by a 12-light door and a 6/1 window.

160. 503 W. Main
Block 46 Lot 14

c.1930 C

One-story brick house with multiple roof forms, entry porch, and a dominant front chimney. North facing front facade. Central block has a side-gable roof. A hipped roof wing with hipped dormer extends out from the side-gable roof on the right and left sides. The hipped roof on the right covers a 6/6, tripartite window, while the hipped roof on the left covers an arched opening in-filled with vertical wood siding. To the left of the right wing, a buttressed, brick entry porch, covered with a gable roof, leads up to a 9-light wood-paneled, entry door. To the left of the porch is a dominant, brick chimney with chimney pots and stone medallions. To the left of the chimney is a 6/6, tripartite window. A hipped dormer sits above the left side window on the side-gable roof.

161. 504 W. Main
Block 24 Lot 11

c.1980 NC

One-story vinyl-sided residence with hipped roof and front gable. South facing front facade. Three-bay facade with carport attached on right side. First bay has 1/1 window with attached shutters. Second bay has Chicago-style tripartite windows with attached shutters. Third bay has inset porch supported by an ornate iron support. A 1/1 window and side entry door. Attached carport has an ornate iron support and wood door.

162. 505 W. Main
Block 46 Lot 12

c.1930 C

Two-story residence with stucco walls, and front-gable roof. Symmetrical central block with right and left side additions. North facing front facade. Central block has three arches. The 1st arch is in-filled with the entry door. The 2nd and 3rd arches are in-filled with 6/6 windows. The door has an ornate, oval window and is topped with a 6-light fanlight. Three 6/6 windows are over the three arches in the 2nd floor. All windows and doors have attached shutters. A 6-light fanlight sits in the pediment of the front gable. The right side addition sits back from the front and has a shed roof that is a continuation of the center block gable roof. Two 6/6 windows sit in the 1st floor wall. Half of a 6-light fanlight sits in the half pediment wall. The left side addition is a sun porch and has a side-gabled roof and metal awnings.

United States Department of the Interior
National Park Service

NATIONAL REGISTER OF HISTORIC PLACES
CONTINUATION SHEET

Section: 7

Page: 38

Okolona Historic District
Okolona, Chickasaw County

163. 506 W. Main

c.1920

C

Block 24 Lot 12

One-story vinyl-sided rectangular residence with cross-gable roof, interior slope chimneys, attic and right side additions. South facing front facade. Facade has 1/1 paired windows to the left of the door and 1/1 tripartite windows to the right. Side addition has one large plate glass window with mullions and one smaller vertical plate glass window with mullions. Front stucco gable has a 1-light window. Shed roof attic addition has one 1/1 window. Entry porch has round arch and concrete steps. A metal carport is attached to the right side of the addition.

164. 507 W. Main

c.1930

C

Block 46 Lot 11

One-story vinyl-sided residence with hipped roof and entry porch. North facing front facade. Brick steps lead up to an arched entry porch with gable roof. wood panel entry door has an ornate, oval window. A 3/1 paired window covered by a front-gabled roof sit to the right of the porch. Two 3/1 paired windows sit to the left of the porch. A gabled dormer sits over the porch at the roof line.

165a. 508 W. Main

c.1920

C

Block 24 Lot 13

One-story vinyl-sided residence with clipped-gable roof, front-gable entry porch, and attached porch. South facing front facade. Entry porch has vinyl sided columns with brick stairs leading to the entry door. The entry porch is flanked by 6/6, paired windows with attached shutters. The attached porch is covered by a side-gable roof which rests on vinyl-sided columns. A half-height wall extends from the front wall into the attached porch.

165b.

c.1940

C

Block 24 Lot 13.1

Outbuilding of Block 24 Lot 13

Two-story symmetrical, garage / apartment with front-gable roof. South facing front facade. Brick on the 1st floor and stucco / timber framing on the 2nd floor and gable wall. Entry doorway is a rounded brick arch with stairs that lead up to the 2nd floor. Entry doorway is flanked on the right side by a 6/6 window and on the left side by a garage. Second floor has two 6/6 windows. A wooden louver sits in the gable.

Martin Luther King Drive

166. 302 Martin Luther King Dr.

c.1950

NC

Block 15 Lot 63

One-story brick residence with side-gable roof and entry porch. West facing front facade. House has recently burned in a fire. Porch has a shed roof resting on ornate iron supports. A centered 6-light entry door sits under the porch. Door is flanked by paired, 6/6 windows. A paired, 6/6 window sits on the left side. Right side under porch has burned down. All windows have attached shutters.

United States Department of the Interior
National Park Service

NATIONAL REGISTER OF HISTORIC PLACES
CONTINUATION SHEET

Section: 7

Page: 39

Okolona Historic District
Okolona, Chickasaw County

167. 304 Martin Luther King Dr. c.1950 NC
Block 15 Lot 24

One-story brick residence with cross gable roof and entry porch. West facing front façade. Porch has two square, brick columns support a front-gabled roof. A glazed, entry door, flanked by 6/6 windows sits under porch. A 6/6 window sit to the right side of the porch.

Monroe Street, East

168. 203 E. Monroe c.1945 C
Block 54 Lot 20

One-story asbestos-sided residence with brick perimeter foundation wall. Side-gabled porch and entry porch. North-facing front façade. Concrete steps lead up to the entry porch, which is covered by a small, hipped roof and rests on two ornate, iron supports. The wood-panel entry door has 3-lights. The porch is flanked by large, 16-light windows. A large-window, recessed room sit to the left-hand side.

Monroe Street, West

169. 105 W. Monroe c.1910 C
Block 55 Lot 4

Large, two-story, wood-sided residence with gable-on-hip roof, full-facade porch, and attached wings. Corner lot. North facing front facade. Central block is symmetrical. Porch has a hipped roof and is supported by four brick columns with brick knee walls. Steps lead up to the entry door which has 10-light sidelights and transom. The entry is flanked by 12/1 paired windows with attached shutters. The 2nd floor has a 6/1 tripartite window with attached shutters flanked by 6/1 paired windows with attached shutters. A hipped dormer with two louvers sits centered on the roof. A brick chimney with chimney pots sits on the right slope of the roof.

170. 106 W. Monroe c.1960 NC
Block 56 Lot 39

One-story board-and-batten and brick residence with L-plan, cross-gable roof, inset entry porch, and attached side-gable carport. South facing front facade. Three bay facade. 1st bay has a 2/2 paired window in the brick wall under a board-and-batten pediment in the cross-gable. The entry porch is inset into the right side of the cross-gable and has two ornate, iron supports. The wood entry door sits under the entry porch. 2nd bay has a 2/2 paired window on the right and a tripartite window on the right. 3rd bay is the side-gabled carport with a ornate, iron support.

**United States Department of the Interior
National Park Service**

**NATIONAL REGISTER OF HISTORIC PLACES
CONTINUATION SHEET**

Section: 7

Page: 40

Okolona Historic District
Okolona, Chickasaw County

171. 107 W. Monroe

c.1905

C

Block 55 Lot 3

Two-story, asbestos-sided residence with hipped roof, wrap-around porch, balcony, and right side addition. North facing front facade. Symmetrical center block. Porch wraps from the front to the right side addition and has a shed roof supported by nine, square, wooden columns. 3-light entry door has 2-light sidelights and 3-light transom. Entry door is flanked by 6-light windows with attached shutters. Balcony has a hipped roof supported by two square, wooden columns and two pilasters with wooden rails. A 1-light wood-panel door sits in the balcony. The balcony is flanked by 2/2 windows. A gable dormer sits above the balcony. A brick chimney sits on the left side of the hipped roof.

172a. 108 W. Monroe

c.1899

C

Block 56 Lot 40 A

One-story vinyl-sided residence with a hipped roof with cross-gabled wings and a wrap-around porch. South facing front facade. The left side cross-gable wing extends out to cover a semi-hexagonal window with 1/1 windows. A louver sits in the gable. The porch wraps from the left side cross-gable wing around to the back side cross-gable wing. Porch has a shed roof supported by five turned spindles. Concrete steps lead up to the entry door which is flanked by a 1/1 window. A side door sits to the left of the entry door on the cross-gable wing. A door sits at the back of the porch on the back side wing.

172b.

c.1899

C

Block 56 Lot 40 B

Outbuilding of Block 56 Lot 40 A.

Large, wood-sided barn with front-gable roof and two large open bays.

173a. 109 W. Monroe

c.1970

NC

Block 55 Lot 2 A

One-story brick residence with side-gabled roof, partial porch, and right side wing. North facing front facade. Porch runs the length of the central block of the house and is supported by six, round, wooden columns. A dentil course runs the length of the porch. Wood-panel, double entry doors are centered in the central block. A 60-light casement window and a 9/9 window with attached shutters sit to the right of the entry doors. Two 9/9 windows with attached shutters sit to the left of the entry doors. A side-gabled wing with two 9/9 windows sits on the right side of the central block.

173b.

c.1970

NC

Block 55 Lot 2 B

Outbuilding of Block 55 Lot 2 A

One-story symmetrical, vinyl-sided building with front-gable roof. Front façade faces North and consists of three 2/2 windows and two 9-light doors.

**United States Department of the Interior
National Park Service**

**NATIONAL REGISTER OF HISTORIC PLACES
CONTINUATION SHEET**

Section: 7

Page: 41

Okolona Historic District
Okolona, Chickasaw County

174. 202 W. Monroe

c.1945

C

Block 41 Lot 44

One-story vinyl-sided residence with cross-gable roof, entry porch, and attached garage. South facing front facade. Concrete steps lead up to the 3-light, wood-panel, entry door with front-gable roof resting on two ornate, iron supports. The entry sits under the right side of the front gable. Two 6/6, paired windows with attached shutters sit to the left of the porch under the front-gable roof. An arched louver sits in the pediment of the front-gable. A 6/6, paired window sits to right of the front-gable. A side-gable garage is attached to the left side of the house.

175. 204 W. Monroe

c.1945

C

Block 41 Lot 45 A

One-story asbestos-sided residence with side-gable roof, inset entry porch, and side porch. South facing front facade. Two bay facade. 1st bay is the entry porch with front-gabled roof supported by two square, wooden columns. Concrete steps lead up the 15-light entry door flanked by a 6/6 window under the porch. 2nd bay has centered 6/6 window. A shed roof porch is attached to the left side of the house.

176. 206 W. Monroe

c.1950

NC

Block 41 Lot 46 A

One-story asbestos and wood-sided residence with cross-gable roof and inset entry porch. South facing front facade. Two bay facade. 1st bay has the entry porch on the right and a 1/1 paired window on the left under a front-gable roof. Inset entry porch has side steps that lead up the 1-light entry door. The porch is supported by one square, wooden column with wooden rails. 2nd bay has a 1/1 window flanked on the right by a 1/1 window and on the left by a tripartite window. All windows have attached shutters.

177. 208 W. Monroe

c.1922

C

Saint Theresa's Catholic Church

Block 41 Lot 46 B

One-story symmetrical, brick church with front-gable roof and front entry tower with steeple. South facing front facade. Concrete steps lead up to the wood-panel, double, entry doors with arched stained glass window set in a pointed arch. Paired, 1/1 stained glass, pointed arch windows sit above the entry. The steeple has a wood-sided base and asphalt-shingled spire topped with a metal cross. The sides of the church have four stained-glass pointed-arch windows.

178. 212 W. Monroe

c.1981

NC

Block 42 Lot 68

One-story brick residence with side-gable roof and entry porch. Corner lot. South facing front facade. Entry porch sits to the left of center has a front-gable roof supported by two round, vinyl columns. A round louver sits in the pediment. The entry door sits on the right side of the porch and a 1/1 window sits on the left side of the house. The porch is flanked on the right by 1/1 paired windows and on the left by a 1/1 window. Two 1/1 paired windows sit on the right side of the house. All windows have attached shutters.

**United States Department of the Interior
National Park Service**

**NATIONAL REGISTER OF HISTORIC PLACES
CONTINUATION SHEET**

Section: 7

Page: 42

Okolona Historic District
Okolona, Chickasaw County

179. 215 W. Monroe

c.1925

NC

Block 53 Lot 1

An extensively altered one-story wood-frame residence, now clad in non-historic board-and-batten siding, with a pyramidal roof, front entry porch, back side addition and attached carport. Corner lot. North facing symmetrical front facade. Brick steps lead up to a 18-light entry door covered by a hipped roof which is supported by two ornamental iron columns. The entry is flanked by 12/8 box windows. The roof has hipped dormers on the front and back, and gabled dormers on the sides. Front hipped dormer has three 4/4 windows. A chimney sits both side slopes of the roof. A hipped roof addition is attached to the back and a hipped roof carport is attached to the addition.

180. 216 W. Monroe

c.1958

NC

Block 42 Lot 71

One-story vinyl-sided residence with cross-gable roof and attached carport. South facing front facade. Carport sits on the right side of the facade and has a front-gabled roof resting on two ornate, iron columns. A 2/2 window flanked to the left by a 6/6 window sits under the carport. The centered 3-light entry door is flanked by a tripartite window on the right and two 6/6 windows with attached shutters on the left.

181. 218 W. Monroe

c.1905

C

Block 42 Lot 72

One-story wood-sided residence with cross-gable roof, wrap-around porch, and attached carport. South facing front facade. A semi-hexagonal wall with three 1/1 windows sits under the front-gable on the left side of the house. The wrap-around porch extends from the front-gable around to front to the right side of the house. The porch has a shed-roof supported by seven, square, wooden columns. Concrete steps lead up to the entry door on the left side of the porch. A 2/2 window sits to the right of the door. A shed-roof carport is attached to the left side of the house. A wooden louver sits in the front-gable pediment.

182. 219 W. Monroe

c.1897

C

Block 53 Lot 4

Large, two-story wood-sided residence with multiple roof forms, wrap-around porch, tower, balcony, and attached carport. North facing front facade. Five bay facade. Porch extends across the first four bays and has two fluted, Doric columns in the center flanked by two square, brick columns on both sides which support a shed roof on top of another shed roof which extend across all five bays. 2nd bay has a two-story tower on the left and a 1/1 window in each story on the right. The tower has four 1/1 windows in each story; arches above the 2nd floor windows; and brackets under the roof of the tower. 3rd bay has brick steps that lead up to a double, entry door with 2-light sidelights. A shed roof balcony with bracketed columns that form an arch, cover a door and window in the 2nd floor. 4th bay has a 1/1 bay window on the 1st floor. 2nd floor consists of an ornate front-gable wall with 1/1 paired windows in the wall and a small, 1/1 window in the shingled gable. A brick chimney sits on the right side-wall of the house. 5th bay is an open carport.

United States Department of the Interior
National Park Service

NATIONAL REGISTER OF HISTORIC PLACES
CONTINUATION SHEET

Section: 7

Page: 43

Okolona Historic District
Okolona, Chickasaw County

183. 221 W. Monroe

c.1950

C

Block 53 Lot 2

One-story brick and asbestos-sided residence with side-gable roof and inset carport. North facing front facade. Four bay facade. 1st bay has a 8/8 window. 2nd bay is a front-gabled, brick section that protrudes out. An inset, wood-panel, entry door with 4-light fanlight sits on the left side of the 2nd bay. A 8/8 window sits in the right side of the 2nd bay. A round, 8-light window sits in the pediment. 3rd bay has a 6/6 window. 4th bay is an inset carport supported on the right by two round, metal supports. A door sits in the back wall of the carport. Windows have attached shutters.

184. 304 W. Monroe

c.1905

C

Block 44 Lot 24 C

One-story vertical wood-sided residence with cross-gable roof and wrap-around porch. South facing front facade. Three bay facade. Porch has a shed roof that wraps from the front facade around the right side. Seven, square, wooden columns support the porch. 1st bay has a 6/6 bay window under the porch and a front-gable roof projecting from the hipped roof. 2nd bay has concrete steps leading up to the wood-panel entry door. Entry door is flanked on the right by a 4/4 window. 3rd bay has a wood-panel door at the back of the wrap-around porch and a side-gable roof projecting from the hipped roof.

185. 306 W. Monroe

c.1914

C

Block 44 Lot 23

Two-story, vinyl-sided residence with hipped-roof, full-width one-story porch, and side-gable wings. South facing front facade. Porch has a shed roof supported by six brick columns. Concrete steps lead up to the wood-panel entry door flanked by 1/1 windows. Five 1/1 windows sit in the 2nd floor. Right side wing has a 2/2 paired window. Left side wing has a 6/6 window and a wood-panel door. Two brick chimneys sit on the side slopes of the roof.

186. 309 Monroe

c.1910

C

Block 52 Lot 7

A large, two-story, wood-sided residence with cross-hipped roof and full-width porch. North facing front facade. Symmetrical porch has shed roof supported by square brick columns on the ends and four Ionic columns in the center. Brick steps lead up to the ionic columns with are capped by a pediment. The roof line steps back and divides the house into three bays. The 1st bay has a gabled roof with wood shingles in the pediment and exposed rafters in the overhang. Under the gable are two-story bay windows. The windows are 1/1 and the 1st floor windows are larger than the 2nd story. The 2nd bay has a hipped roof with a brick ridge chimney. On the 1st floor is the entry door with 4-lights and a transom. To the right of the door is a 1/1 window. The 2nd floor has a 1/1 window. The 3rd bay has a hipped roof and a brick end-wall chimney. The 1st floor has a 1/1 window, and the 2nd floor has a paired 1/1 window.

United States Department of the Interior
National Park Service

**NATIONAL REGISTER OF HISTORIC PLACES
CONTINUATION SHEET**

Section: 7

Page: 44

Okolona Historic District
Okolona, Chickasaw County

187. 311 W. Monroe
Block 52 Lot 6

c.1910 C

A large, two-story, wood-sided residence with multiple roof forms, a tower, and wrap-around porch. North facing front facade. The house's central block has a hipped roof with ornate gabled dormer and two brick chimneys. The glazed entry door with transom and a 1/1 window are on the 1st floor of the central block. Two 1/1 windows make up the 2nd floor of the central block. The central block is flanked on the right by a three story tower, and on the left by a protruding wing. The tower has four 1/1 bay windows on the 1st and 2nd floors, and four single-pane windows on the third floor. The left wing has an ornate multi-pane window on the 1st floor, two 1/1 windows on the 2nd floor, and a single-pane window in the gable. The wrap-around porch starts at the centered entry door and continues around the right side of the house. The porch has a shed roof which sets on eight, round, wooden, columns. Brick steps with concrete rails and pediment roof lead up to the glazed entry door with transom. A single story wing is to the left of the protruding wing. This wing has a hipped roof, metal awning, and tripartite 1/1 windows.

Olive Street, North

188. 103 N. Olive
Block 29 Lot 8 B

c.1925 C

A small, one-story brick commercial building. The left side of the building was built later. East facing front facade. Two doors, one on each side of the facade. Left side door is a 6-panel, wood door and has two single-pane sidelights. Left sidelight has been covered with plywood. Right side door is a 5-panel, wood door with a single-pane window to the left. Metal coping.

189. 106 N. Olive
Block 30 Lot 27

c.1980 NC

One-story metal commercial building with metal hipped roof. South facing front facade. The Southwestern corner of the building has a brick veneer and metal storefront entry doors. A large metal warehouse is attached to the Eastern side of the building.

Olive Street, South

190. 104 S. Olive
Block 42 Lot 79

c.1905 C

One-story vinyl-sided residence with hipped roof, inset entry porch, and left side wing. West facing front facade. Two bay facade. 1st bay has a 1/1 window in a front-gable wall. A louver sits in the pediment of the front-gable. 2nd bay is the inset porch covered by a shed roof and supported by three fluted, round, vinyl columns. Concrete steps lead up to a 15-light entry door with 10-light sidelights on the left side of the porch. A 1/1 paired window sits on the right side of the porch. A concrete chimney sits on both side slopes of the hipped roof.

United States Department of the Interior
National Park Service

NATIONAL REGISTER OF HISTORIC PLACES
CONTINUATION SHEET

Section: 7

Page: 45

Okolona Historic District
Okolona, Chickasaw County

191. 105 S. Olive
Block 43 Lot 83

c.1940

C

One-story symmetrical, wood-sided residence with side-gable roof, entry porch, and side-gabled wings. East facing front facade. Concrete steps lead up to wood-panel double doors under the front-gabled entry porch which is supported by two round, wooden columns. A louver sits in the vertical wood-sided pediment. The entry is flanked by 6/6, tripartite windows. Both wings have 6/6, paired windows with attached shutters.

192. 106 S. Olive
Okolona Christian Church

c.1889

C

Block 42 Lot 78

One-story symmetrical, vinyl-sided and wood-shingled church with front-gabled roof, projecting front-gabled entry, and back addition. West facing front facade. Concrete steps with iron rails lead up to wood-panel double doors covered by a gabled pediment. The doors are centered in a projecting wall covered by a front gabled roof with wood-shingled pediment. Projecting wall is flanked by 1/1 stained glass, pointed arch windows. Paired wooden louvers sit in the wood-shingled pediment of the front-gable roof. A long, rectangular, vinyl-sided addition extends from the right side of the back of the church. Addition has a shed-roof porch supported by six, square, wooden columns. Addition has centered, wood-paneled, double doors flanked by two 1-light windows.

193. 107 S. Olive
Block 43 Lot 84

c.1905

C

Two-story, symmetrical, wood-sided residence with hipped roof, wrap-around porch, and balcony. East facing front facade. Shed-roof porch wraps from the left side around the front to the right side and is supported by eight, wooden, Ionic columns. Concrete steps lead up to the 1-light entry door with 1-light sidelights and 1-light transom. The entry is flanked by 1/1 windows. Balcony has two round, wooden columns supporting a gabled dormer. The balcony has a 1-light door. The balcony is flanked by 1/1 windows. The dormer is covered with wood-shingles and has three 1/1 windows. A brick chimney sits on the side slopes of the hipped roof.

194. 109 S. Olive
Block 43 Lot 85

c.1928

C

One-story brick residence with side-gabled roof and entry porch. East facing front facade. The entry porch is covered by a front-gable roof with multi-level eaves. An arched louver sits in each pediment. The porch is supported by two brick columns and extends a concrete deck across the right side of the façade. Concrete steps with iron rails lead up to a wood-panel entry door. The entry is flanked by 6/1 tripartite windows with attached shutters. A bay on the right side has been in-filled with a glazed door and multiple-light windows. Side-gabled roof has exposed rafters. A brick chimney sits on the left side gable wall, and a brick chimney sits in the roof ridge on the right side of the house.

United States Department of the Interior
National Park Service

**NATIONAL REGISTER OF HISTORIC PLACES
CONTINUATION SHEET**

Section: 7

Page: 46

Okolona Historic District
Okolona, Chickasaw County

195. 110 S. Olive
Block 42 Lot 77

c.1945 C

One-story asbestos-sided residence with front-gabled roof and partial porch. West facing front facade. Porch has a front-gable roof that sits on the left side of the facade and extends from the front-gabled roof. The porch is supported by four fluted, round columns. A 3-light entry door is flanked on the left by a 6/6, paired window under the porch. A 6/6 window sits to the right of the porch.

196. 111 S. Olive
Block 43 Lot 86

c.1925 C

One-story stucco residence with hipped-roof, porch, entry stoop, and dominant front chimney. East facing front facade. Two bay facade. 1st bay is a front-gable porch supported by two brick columns connected by brick knee walls. A louver sits in the pediment. 2nd bay has a dominant, front, brick chimney flanked by a entry stoop on the right and a 3/1 paired window on the left. The entry stoop has a front-gable roof supported with brackets covering the 12-light entry door.

197. 113 S. Olive
Block 43 Lot 87

c.1899 C

One-story vinyl-sided residence with cross-gable roof, entry porch, and left side shed-roof addition. East facing front facade. Porch has a hipped-roof supported by four square, wooden columns resting on brick piers. Concrete steps lead up to the entry door which is flanked by a door on the right and a 1/1 window on the left. A 1/1 window sits in the pediment of the centered front-gable roof. A brick chimney sits on the left side gable wall.

198. 114 S. Olive
Block 42 Lot 75

c.1945 C

One-story brick residence with cross-gable roof and inset entry porch. West facing front facade. Two bay facade. 1st bay is the inset entry porch with front gable roof and stucco pediment supported by two brick columns. Concrete steps lead up to the wood-panel entry door which is flanked to the left by a 24-light casement window. 2nd bay has a 6/6, paired window. All windows have attached shutters.

199. 115 S. Olive
Block 43 Lot 88

c.1905 C

One-story symmetrical, wood-sided residence with hipped roof; projecting front gable; two inset, entry porches, and a left side wing. East facing front facade. Three bay facade. 2nd bay has a 1/1 bay window on a projecting wall covered by a front-gable roof. Pediment has patterned timbering. The projecting wall is flanked in the 1st and 3rd bays by inset entry porches. The porches have hipped-roofs resting on three ornate, iron supports. Brick steps lead up to the entry doors which are flanked on the outer side by a 1/1 window and have a side entry door on the projecting wall.

**United States Department of the Interior
National Park Service**

**NATIONAL REGISTER OF HISTORIC PLACES
CONTINUATION SHEET**

Section: 7

Page: 47

Okolona Historic District
Okolona, Chickasaw County

200. 116 S. Olive
Block 42 Lot 74

c.1905 C

One-story symmetrical, wood-sided residence with side-gable roof and full-width porch. West facing front facade. The center of the side-gabled roof turns into a hipped roof. Porch has a hipped roof supported by four columns. Middle columns are square, wooden columns resting on brick piers. End columns are brick. A wood-panel, entry door with boarded up sidelights is flanked by 2/2 windows. A front-gable dormer with a 2/2 window sits in the center of the roof.

201. 117 S. Olive
Block 43 Lot 89

c.1877 C

Large, two-story, wood-sided and wood-shingled residence with hipped roof, entry porch and left side wing. Corner lot. East facing front facade. Central block is symmetrical. 1st floor is wood-sided and 2nd floor is wood-shingled. Porch has a hipped roof supported by four square, wooden columns and two pilasters resting on brick piers connected by brick knee walls. Knee walls and piers have concrete coping. Concrete steps lead up to the 12-light entry door with 8-light sidelights. The entry is flanked by 9/1 paired windows. A 2/2 paired window with hoods and brackets sits in the center of the 2nd floor. The paired window is flanked by 2/2 windows with hoods and brackets. A 9/1 paired window sits in the wing. The South facade has the hipped roof wing on the 1st floor and four 2/2 window with hoods and brackets in the 2nd floor. The wing has concrete steps leading up to a wood-panel door flanked by 9/1 tripartite windows.

202. 118 S. Olive
Block 42 Lot 73

c.1905 C

One-story vinyl-sided residence with cross-gable roof and enclosed full-width porch. Corner lot. West facing front facade. Symmetrical porch has four square, wooden columns resting on brick piers with brick knee walls supporting a hipped roof. The columns divide the facade into three bays. The porch has been in-filled with vinyl-siding. 2nd bay has an entry door covered by a front-gable roof. 1st and 3rd bays have two 6/6 windows with attached shutters. A front-gable roof sits behind the porch over the 3rd bay.

203. 200 S. Olive
Block 53 Lot 3

c.1920 C

One-story vinyl-sided residence with multiple roof forms, two wings, and a dominant front chimney. West facing front facade. Four bay facade. 1st bay is a side-gabled wing with a paired, 3/1 window and attached shutters. 2nd bay has a dominant, front, brick chimney on a side-gabled roof. A glazed, entry door covered by a shed roof with one square, wooden column sits to the right of the chimney. A paired, 3/1 window sits to the left of the chimney. 3rd bay is a front-gable wall that protrudes out from the hipped roof of the main body of the house. A paired, 3/1 window with attached shutters sits in the wall, and a louver sits in the pediment. 4th bay is a side-gabled wing that extends from the back of the house. A bay window with two 1-light windows flanked by 1/1 windows and hipped roof sits on the right side of the wing. A small, 3/1 window with attached shutters sits to the left of the bay window.

United States Department of the Interior
National Park Service

**NATIONAL REGISTER OF HISTORIC PLACES
CONTINUATION SHEET**

Section: 7

Page: 48

Okolona Historic District
Okolona, Chickasaw County

Prairie Street

204. 102 Prairie
Block 44 Lot 12

c.1980

NC

One-story brick and wood-sided residence with side-gable roof, partial porch, and side-gabled wings. West facing front facade. The porch covers the full-width of the central block. Porch has five square, wooden columns that support the side-gable roof and divide the porch into four bays. The 1st and 4th bays have a 12/12 window with attached shutters. 2nd bay has a 36-light casement window. 3rd bay has brick steps leading up to a wood-panel door. Porch has dentils in the entablature. The central block is flanked by side-gables wings. Two 12/12 windows with attached shutters sit in each wing.

205. 103 Prairie
Block 45 Lot 31

c.1920

C

One-story wood-sided residence with five front-gables, entry porch, and attached side-gable carport. East facing front facade. Two bay facade. 1st bay is the entry porch with three square, wooden columns resting on brick piers supporting a front-gable roof. A 1-light entry door sits under the porch. Entry onto the porch is from the left side. A front-gable roof sits above the porch. 2nd bay has a 6/1 window flanked by 4/1 windows under a front-gable roof. A front-gable roof sits above another front-gable roof between the 1st and 2nd bays. The top front-gable roof has a 6-light window on the corners. A side-gable garage with two square, wooden, columns resting on brick piers is attached to the left side of the house.

206. 104 Prairie
Block 44 Lot 27

c.1899

C

One-story wood-sided residence with hipped-roof and wrap-around porch. West facing front facade. Porch has a hipped-roof porch supported by seven brick columns and two brick pilasters connected by brick knee walls. The porch wraps from the front around to the left side and the columns divide the porch into four bays. 3rd bay has concrete steps leading up to a wood-panel door with 10-light sidelights and 10-light transom. 2nd and 4th bays have a 12/12 paired windows with attached shutters. 1st bay is the open bay of the wrap-around porch. A hipped dormer with 4/4 tripartite window sits on the roof over the 3rd bay.

207. 105 Prairie
Block 45 Lot 32

c.1920

C

Large, two-story, symmetrical, wood-sided residence with hipped-roof and entry porch. East facing front facade. Entry porch has a shed-roof with balustrade supported by two wooden, Ionic columns. Concrete steps lead up to the entry door with 2-light sidelights and 2-light transom under the entry porch. The porch is flanked by 1/1 windows. 2nd floor has 1/1 window flanked by 1/1 windows. A gabled dormer with a 1/1 arched window flanked by 8-light windows sits centered in the roof. The house is framed by two-story pilasters on the corners of the house. The right and left sides of the house have semi-hexagonal windows with front-gable roofs.

United States Department of the Interior
National Park Service

**NATIONAL REGISTER OF HISTORIC PLACES
CONTINUATION SHEET**

Section: 7

Page: 49

Okolona Historic District
Okolona, Chickasaw County

208. 106 Prairie
Block 44 Lot 26

c.1899 C

Two-story, symmetrical, wood-sided residence with side-gable roof, full-width one-story porch, and balcony. West facing front facade. Porch has a shed roof supported by six, round, wooden columns and two pilasters which divide the facade into five bays. 3rd bay has a wood-panel door with 1-light sidelights and 3-light transom. 1st and 5th bays have 6/6 windows. 2nd and 4th bays have a wooden door. The balcony sits above the 3rd bay and is covered by a front-gable roof supported by two iron columns and two wooden pilasters connected by iron rails. A wooden wood sits under the balcony. A 6/6 window sits in the 2nd floor over the 1st, 2nd, 4th, and 5th bays. The house is framed by a two-story pilaster on both corners.

209. 107 Prairie
Block 45 Lot 33

c.1850 C

One-story wood-sided residence with hipped roof and cross-gables, inset porch, and side-gable addition. East facing front facade. Two bay facade. 1st bay is the inset porch. Porch has a shed roof supported by four ornate, wooden columns and one pilaster with ornate brackets. A 2/2 arched window is flanked on the right by the wood-panel entry door with 1-light arched transom and on the left by a 2/2 arched window. 2nd bay has a front-gable roof with ornate eaves and brackets, and a round louver in the gable. A bay window with 2/2 arched windows and a hipped roof sits in the front-gable wall. A shed roof dormer with three 1/1 windows sits on the roof above the entry door. A concrete chimney sits on the left gable wall and on the right slope of the hipped roof. A small side-gable addition is attached to the left of the house.

210. 108 Prairie
Block 44 Lot 25

c.1950 NC

One-story brick residence with side-gable roof and inset carport. West facing front facade. Wood-panel entry door is flanked by two 6/6 windows on the right and a 6/6 paired window on the left. An inset carport covered by the roof and supported by three round, wooden columns sits on the left side of the facade. All windows have attached shutters.

211. 109 Prairie
Block 45 Lot 34

c.1850 C

Large, two-story, symmetrical, brick residence with hipped roof, entry porch, and attached carport. East facing front facade. Four two-story brick pilasters divide the facade into three bays. 2nd bay has the entry porch with shed-roof supported by six, round, wooden columns. Concrete steps lead up to the double entry doors under the porch. A 1-light door with 1-light sidelights and 3-light transom sits above the porch on the 2nd floor. The 1st and 3rd bays have a 1/1 window in both floors. All door and window openings on the 1st and 2nd floors are arched openings. A gabled dormer with 1-light arched window flanked by 1/1 windows sits centered on the roof. A balustrade sits in front of the dormer. A brick chimney sits on the right slope of the roof. A metal carport is attached to the left side of the house.

**United States Department of the Interior
National Park Service**

**NATIONAL REGISTER OF HISTORIC PLACES
CONTINUATION SHEET**

Section: 7

Page: 50

Okolona Historic District
Okolona, Chickasaw County

212. 110 Prairie

c.1950

NC

Block 44 Lot 22

One-story brick residence with hipped-roof, entry porch, side-gable wing, and attached hipped-roof garage. West facing front facade. Central block is symmetrical. Concrete steps lead up to the entry porch with front-gable roof supported by two square, wooden columns. A wood-panel entry door sits under the porch. The porch is flanked by two 6/6 windows. A side-gabled wing with three 6/6 windows is attached to the right side of the house. A brick garage with hipped roof is attached to the left of the house. All windows have attached shutters. A metal carport is attached to the left of the garage.

213. 111 Prairie

c.1860

C

Block 45 Lot 35

Large, two-story, wood-sided and stucco, residence with hipped-roof, full-height porch, balcony, and left side wing. East facing front facade. Central block is symmetrical. Porch has six, large, fluted columns and two pilasters supporting the hipped-roof. Paired brackets sit in the entablature above each column. The wall under the porch is covered with stucco. Concrete steps lead up to the 1-light, double, entry doors with 1-light arched transom. The entry is flanked by 2/2 windows. The balcony with iron rails sits above the entry. 1-light double doors with 1-light arched transom sit in the balcony. The balcony is flanked by 2/2 windows. All windows are arched and have attached shutters. Left side wing has a shed roof and a wood-panel door with 1-light transom flanked to the left by a screened in porch.

214a. 112 Prairie

c.1899

C

Block 44 Lot 24 A

One-story wood-sided residence with hipped-roof, full-width porch, and hipped-roof wing. Corner lot. West facing front facade. Porch has five paired, Ionic columns supporting the hipped roof and dividing the facade into four bays. 2nd bay has concrete steps leading up to the 12-light entry door with sidelights and transom. 1st and 3rd bays have three 1/1 windows with patterned glass. 4th bay covers the right side wing and has a wood-panel door flanked to the right by a 6/6 window. A hipped dormer with four louvers sits on the roof above the 2nd bay.

214b. rear of 112 Prairie

c.1905

C

Block 44 Lot 24 B

Outbuilding of Block 44 Lot 24 A.

One-story symmetrical, asbestos-sided house with front-gable roof, entry stoop, and attached shed-roof carport. South facing front facade. Concrete steps lead up to the wood entry door which is covered by a front-gable roof with brackets. The entry is flanked by 6/6 windows. The attached shed-roof carport extends from the entry to the left side of the house.

United States Department of the Interior
National Park Service

NATIONAL REGISTER OF HISTORIC PLACES
CONTINUATION SHEET

Section: 7

Page: 51

Okolona Historic District
Okolona, Chickasaw County

School Street, North

215. 103 N. School
Block 28 Lot 37

c.1905 C

One-story symmetrical, wood-sided residence with hipped roof and full-facade porch. East facing front facade. Porch has a shed roof supported by four square, wooden columns. Brick water table. Brick steps, under the porch, lead up to a 1-light entry door with 2-light transom. The door is flanked by 4/4 windows.

216. 104 N. School
Block 29 Lot 54

c.1945 C

One-story asbestos-sided residence with side-gabled roof and small entry porch. West facing front facade. Entry porch is covered by a front-gabled roof with pediment, supported by two ornate, iron supports. Concrete steps lead up to a wood-panel door with three lights. Entry porch is flanked by 6/6, paired windows. A semi-hexagonal bay with 6/6, paired windows sits on the right. All windows are covered by metal awnings. a metal carport is attached to the right side.

217. 105 N. School
Block 28 Lot 35

c.1945 C

One-story symmetrical, vinyl-sided residence with side-gable roof, side-gable wings, entry porch, and attached carport. East facing front facade. Concrete steps with iron rails lead up to a gabled, entry porch supported by square, wooden, columns. Pediment in gable has a louver. A glazed entry door sits under the porch. The porch is flanked on the right by a 24-light, casement window and on the left by 6/6 paired windows. Two gabled dormers with 3/1 windows sit above the windows on the roof. A 3/1 window sits in both side-gable wings. A shed roof carport supported by four round, wooden columns resting on brick piers has been attached to the left side of the garage. All lower windows have attached shutters.

218. 106 N. School
Block 29 Lot 53

c.1945 C

One-story vinyl-sided residence with side-gable roof and entry porch. West facing front facade. Three bay facade. 2nd bay contains an entry porch and 8/8 window under a centered gable with round louver. Brick steps lead up to an entry porch with arched pediment supported by paired wooden columns. 1st and 2nd bays have an 8/8 window. All windows have attached shutters.

219. 107 N. School
Block 28 Lot 34

c.1925 C

Two-story wood-sided residence with hipped roof and full-width porch. East facing front facade. Porch is divided into two bays by three square, brick columns and covered by a hipped roof. 1st bay has been filled in with a band of multiple-light metal windows. Concrete steps lead up to an open 2nd bay that frames the entry door, and is covered by a gable roof that extends from the hipped roof. The glazed entry door has 1-light sidelights and 3-light transom. The 2nd floor has two paired, 1/1 windows with attached shutters. A hipped dormer with paired louvers is centered in the hipped roof.

United States Department of the Interior
National Park Service

**NATIONAL REGISTER OF HISTORIC PLACES
CONTINUATION SHEET**

Section: 7

Page: 52

Okolona Historic District
Okolona, Chickasaw County

220. 108 N. School
Block 29 Lot 52

c.1925 C

One-story asbestos-sided residence with side-gabled roof and full-width, brick porch. West facing front facade. Porch has four square, brick columns connected by brick knee wall topped by concrete coping. Roof has a gable dormer gable with three 3-light windows and triangular knee braces for decoration. Brick steps lead up to the entry door. Entry door has a 9-light transom with 2-light sidelights. Door is flanked on both sides by a 4/1 tripartite window with attached shutters. Rafters are exposed.

221. 109 N. School
Block 28 Lot 33

c.1920 C

One-story brick residence with side-gable roof, inset porch and attached carport. East facing front facade. Porch is screened in and has three square, brick columns supporting a shed roof. An 18-light entry door with 10-light sidelights flanked by 9/1 windows sits on the left side of the porch. A 9/1 tripartite window sits on the right side of the porch. The entry door and several windows sit inside of the porch. A flat roof carport supported by three turned spindles is attached to the right side of the house. A 9/1 tripartite window sits to the left of the porch and under a side-gable roof with exposed rafters.

222. 110 N. School
Block 29 Lot 48

c.1940 C

One-story asbestos-sided residence with clipped-gable roof and entry porch. West facing front facade. Brick slope chimney on back side. Entry porch is covered by a front-gabled pediment with brackets. Concrete steps lead up to a 3-light, wood-panel door. Entry porch is flanked on both sides by paired 3/1 windows. Exposed rafters in the roof.

223. 203 N. School
Block 23 Lot 18

c.1950 NC

One-story vertical wood-sided residence with side-gabled roof and front-gabled entry porch. East facing front facade. Wood steps lead up to the porch which is supported by four square, wooden columns with wooden rails. Porch has an entry door on the right and a 6/6 window to the left. The porch is flanked to the right by 6/6, paired windows, and to the left by a 6/6 window. All windows have attached shutters.

224. 205 N. School
Block 23 Lot 16

c.1900 C

Large, one-story wood-sided residence with hipped roof; right side, front-gabled addition; inset porch; hipped dormer; and two brick chimneys. East facing front facade. A 1-light window sits in the front gable. The dormer has a 1/1 paired window. One chimney sits a junction of the hipped and gable roof, and the other at the crest of the hipped roof. Other details are hidden by overgrown vegetation.

United States Department of the Interior
National Park Service

NATIONAL REGISTER OF HISTORIC PLACES
CONTINUATION SHEET

Section: 7

Page: 53

Okolona Historic District
Okolona, Chickasaw County

225a. 207 N. School
Block 23 Lot 15 A

c.1904

C

One-story wood-sided residence with cross gable roof and inset porch. East facing front facade. Porch has a shed roof supported by four square, bracketed, wooden columns resting on brick piers. Concrete steps lead up to the glazed entry door under the porch. A 4/1 window sits to the left of the door under the porch. To the right of the porch the cross-gable covers 1/1 bay windows. A brick chimney sits on the left end-gable wall.

225b.
Block 23 Lot 15 B
Mobile home.

c.1970

NC

226. 209 N. School
Block 23 Lot 14

c.1850

C

One-story symmetrical, asbestos-sided residence with side-gabled roof and entry porch. Corner Lot. East facing front facade. Concrete steps lead up to the entry door under a front-gabled entry porch supported by two square, wooden columns and two square pilasters. The entry door has wood-paneled, double doors with 1-light sidelights and 6-light transom. The porch is flanked by 9/9 windows. Square pilasters hug the corners of the house. A brick chimney sits on the end wall of the left side.

Silver Street

227. 104 Silver St.
Block 41 Lot 49

c.1920

NC

One-story brick commercial building. West facing front facade. Two bay facade. 1st bay has a glazed door flanked to the right by a 1-light window. 2nd bay has a glazed door flanked by 1-light windows. Metal coping.

228. 106 Silver
Block 41 Lot 48

c.1970

NC

One-story brick commercial building. West facing front facade. Brick storefront has a glazed door with 1-light transom flanked by display windows. Transom and right side display window have been painted over. Cornice is vinyl.

229. 114 Silver St.
Block 41 Lot 47

part from 1899 NC

An industrial plant made up of several, large, metal-clad buildings. West facing front facade. Included within the structure is a cluster of brick buildings, possibly dating from circa 1899, which are obscured behind a metal façade.

**United States Department of the Interior
National Park Service**

**NATIONAL REGISTER OF HISTORIC PLACES
CONTINUATION SHEET**

Section: 7

Page: 54

Okolona Historic District
Okolona, Chickasaw County

230. 115 Silver
Block 42 Lot 63

c.1963 NC

One-story brick commercial building. East facing front facade. Metal windows and doors. Double entry doors with large, 1-light transom sit on the right side of the facade. Large ribbon windows extend from the entry across most of the facade. A metal awning covers the entry and windows. A service door sits on the left side of the facade. A concrete masonry unit loading ramp sits in front of the building on the left side of the parking lot.

231. 117 Silver
Block 42 Lot 64

c.1970 NC

One-story board-and-batten residence with side-gabled roof and attached garage. Corner lot. East facing front facade. Wood-panel entry door is flanked by two 2-light windows on each side. A side-gable garage with open back bay is attached to the left side.

232. 119 Silver
Block 42 Lot 65

c.1910 C

One-story wood-sided residence with cross-clipped-gable roof and inset entry porch. East facing front facade. Two bay facade. 1st bay is covered by a clipped-gable roof. A 1/1 tripartite window with front gable roof sits in a projecting wall under the right side of the 1st bay. A 1/1 paired window sits on the left side of the 1st bay. A 1/1 tripartite window sits in the gable of the 1st bay. 2nd bay is the inset porch with side-gable roof. The porch is supported by two square, brick columns. The entry door with 2-light transom sits in the back wall of the porch. A side entry door sits under the porch. A shed-roof dormer with three 1-light windows sits on the side-gable roof between the 1st and 2nd bays.

233. 120 Silver
Block 41 Lot 42.1 A

c.1970 NC

One-story wood-sided residence with front-gabled roof and left side shed-roof wing. West facing front facade. A 6/6 window flanked by 2-light windows sit in the vertical wood-sided front-gable wall. Pediment is board-and-batten. A 1-light entry door with 1/1 window sit in the wing. Mirrors house in Block 41 Lot 42.1 B.

234. 121 Silver
Block 42 Lot 66

c.1920 C

One-story vinyl-sided residence with cross-gable roof and entry porch. East facing front facade. Two bay front facade. 1st bay has a 1/1 paired window centered in a front-gable wall. 2nd bay is the entry porch with shed-roof resting on two ornate, iron supports. Porch has a brick water table with a 1/1 window on the right and entry door on right. A side entry door also sits on the porch. All windows have attached shutters.

235. 122 Silver
Block 41 Lot 42.1 B

c.1970 NC

One-story wood-sided residence with front-gabled roof and right side shed-roof wing. West facing front facade. A 6/6 window flanked by 2-light windows sit in the vertical wood-sided front-gable wall. Pediment is board-and-batten. A 1-light entry door with 1/1 window sit in the wing. Mirrors house in Block 41 Lot 42.1 A.

United States Department of the Interior
National Park Service

**NATIONAL REGISTER OF HISTORIC PLACES
CONTINUATION SHEET**

Section: 7

Page: 55

Okolona Historic District
Okolona, Chickasaw County

236. 123 Silver
Block 42 Lot 67
Mobile home.

c.1960 NC

237. 124 Silver
Block 41 Lot 42.1 C
Mobile home.

c.1970 NC

238. 124A Silver
Block 42 Lot 80

c.1920 C

One-story symmetrical, wood-sided residence with side-gable roof and partial porch. East facing front facade. Lot is in the middle of the block. Partial porch has a shed-roof and is supported by four square, wooden columns. A glazed entry door flanked on the right by a 2/2 window sits on the right side of the porch. A glazed entry door flanked on the left by a 2/2 window sits on the left side of the porch. A brick chimney sits centered on the ridge of the roof.

239. 201 Silver
Block 53 Lot 5

c.1950 NC

One-story wood-sided residence with side-gable roof, entry porch, and attached garage. East facing front facade. Concrete steps lead up to the entry door under a shed roof porch supported by square, wooden columns. A wooden deck extends from the right side of the porch. The porch is flanked by a 1/1 window to the right. A 1/1 window sits on the right and left side of the façade. All windows have attached shutters. A side-gabled garage is attached to the left side of the house.

240. 203 Silver
Block 53 Lot 6

c.1910 C

One-story vinyl-sided residence with side-gable roof, wrap-around porch, and right side addition. East facing front facade. Two bay facade. Wrap-around porch has a hipped roof supported by seven turned spindles. 1st bay is side-gabled with a centered, 1/1 paired window and left side gable wall chimney. 2nd bay is the shed roof addition. The wrap-around porch extends to the entry door on the addition. A 1/1 window sits to the right of the door.

241. 205 Silver
Block 53 Lot 7 A

c.1925 C

One-story symmetrical, asbestos-sided residence with side-gabled roof and exposed rafters. Wood-panel entry door is covered by a front-gabled roof supported by brackets. The entry is flanked by 3/1 paired windows.

United States Department of the Interior
National Park Service

NATIONAL REGISTER OF HISTORIC PLACES
CONTINUATION SHEET

Section: 7

Page: 56

Okolona Historic District
Okolona, Chickasaw County

242. 209 Silver c.1930 C
Block 53 Lot 7 B
One-story brick residence with cross-gable roof and inset entry porch. East facing front facade. Three bay facade. 1st and 2nd bays are covered by a shed roof with three supports. The 1st support is a brick column with concrete coping. The 2nd and 3rd supports are square, wooden columns resting on brick piers with brick knee wall and concrete coping. 1st bay has concrete steps leading up to the porch and 3/1 tripartite window. 2nd bay has 9-light wood-paneled door. 3rd bay is the cross-gable with a 3/1 paired window centered in the wall and a wood louver centered in the stucco gable.

243. 211 Silver c.1920 C
Block 53 Lot 8
One-story wood-sided residence with cross-gable roof and inset porch. South facing front facade. Two bay facade. 1st bay is the inset porch which is covered by the cross-gable roof. The porch originally had three Doric columns but now only has two. Wooden steps on the right side of the porch lead up to a glazed entry door with 2-light transom. Two 1/1 windows sit to the left of the door. The cross gable is shingled and has dentils at its base. A 1/1 paired window sits in the gable. 1st bay has a 1/1 paired window in the wall and a gabled dormer on the roof. A 1/1 paired window sits in the dormer.

Stonewall Street

244. 102 Stonewall c.1970 NC
Block 43 Lot 10
Mobile home.

245. 103 Stonewall c.1925 C
Block 44 Lot 17
One-story brick residence with front-gable roof, entry porch, and left side wing. East facing front facade. The porch is covered by a front-gable roof supported by four square, wooden columns resting on brick piers connected by brick knee walls with concrete coping. Concrete steps lead up to 12-light entry door flanked on the right by a 3/1 window on the right side of the porch. A 3/1 paired window sits on the left side of the porch. A louver sits in the pediment of the porch. A 3/1 paired window sits in the left side-gable wing. A brick chimney sits on the right side of the house.

246. 104 Stonewall c.1905 C
Block 43 Lot 9
One-story wood-sided residence with side-gabled roof and entry porch. West facing front facade. Entry porch has a hipped roof supported by four turned spindles and two square, wooden columns. The 1-light, wood-panel, entry door is flanked on the right by a 6/6 window and on the left by two 6/6 windows. All windows have attached shutters. A brick chimney sits centered on the ridge of the roof.

**United States Department of the Interior
National Park Service**

**NATIONAL REGISTER OF HISTORIC PLACES
CONTINUATION SHEET**

Section: 7

Page: 57

Okolona Historic District
Okolona, Chickasaw County

247. 105 Stonewall
Block 44 Lot 18

c.1925 C

One-story brick residence with clipped-gable roof, entry porch, and right side wing with attached carport. East facing front facade. Central block is symmetrical. Porch has a shed roof supported by four square, wooden columns resting on brick knee walls. Concrete steps lead up to the wooden door flanked by 4/1 paired windows. A wood-sided pediment sits centered above the shed roof. A brick chimney sits in the right gable wall. Right side wing has a wooden door with attached carport. Five metal columns support the carport. Roofs have brackets under the eaves.

248. 106 Stonewall
Block 43 Lot 8

c.1899 C

One-story symmetrical residence with cross-gable roof and entry porch. West facing front facade. Entry porch has a hipped roof supported by four square, wooden columns with wooden rails. Concrete steps lead up to the 1-light, wood-panel, entry door which is flanked by 4/1 windows with attached shutters. A brick chimney sits on the right side gable wall.

249. 107 Stonewall
Block 44 Lot 19

c.1980 NC

One-story residence with side-gable roof, full-facade porch, and inset carport. Roof is supported by six, round, fluted columns which divide the facade into four bays. 1st bay is the carport with a 6-light door and a wooden door. 2nd and 4th bays one-story brick residence have a 12/8 windows with attached shutters. 3rd bay has the wood-panel entry door.

250. 108 Stonewall
Block 43 Lot 7

c.1905 NC

One-story symmetrical, asbestos-sided residence with side-gabled roof and entry porch. West facing front facade. Porch has a hipped roof supported by four ornate, iron columns. Wooden, entry door is flanked by a 2-light window on the right and a 1-light tripartite window on the left. A brick chimney sits on the left side gable wall. House has a back side addition and a carport attached to the right. Shed roof carport is supported by six, round, metal columns.

251. 109 Stonewall & 111 Stonewall
Block 44 Lot 20

c.1900 C

One-story asbestos-sided residence with hipped-roof and full-width porch. East facing front facade. Porch has a hipped roof supported by four square, wooden columns resting on concrete masonry unit piers. Concrete steps lead up to a 1-light entry door flanked on the right by a 1/1 window and on the left by a 1/1 tripartite window.

**United States Department of the Interior
National Park Service**

**NATIONAL REGISTER OF HISTORIC PLACES
CONTINUATION SHEET**

Section: 7

Page: 58

Okolona Historic District
Okolona, Chickasaw County

252. 110 Stonewall
Block 43 Lot 6

c.1960

NC

One-story brick and board-and-batten residence with side-gable roof and inset carport. West facing front facade. Brick water table. An inset carport sits in the right corner of the facade. The carport is covered by the side-gable roof which rests on a metal column and an ornate iron column. The wood-panel entry door sits to the left of the carport and is flanked to the right by a 2/2 tripartite window. Two 2/2 windows sit on the left side of the facade. A 2/2 window sit on the back wall of the carport.

253. 114 Stonewall
Block 43 Lot 4

c.1960

NC

One-story brick residence with side-gabled roof, full-facade porch, and inset carport. West facing front facade. The carport is inset on the right side of the house. The porch and carport are covered by the side-gable roof which rests on six, ornate, iron columns. The wood-panel, entry door sits to the left of the carport and is flanked by 9/6 windows with attached shutters. Two wooden doors sits on the back wall of the carport.

254. 116 Stonewall
Block 43 Lot 3

c.1910

C

Two-story brick and vinyl-sided church with L-plan, front-gabled roof, entry tower, entry porch, steeple, and attached carport. Corner lot. West facing front facade. 2nd story is covered by the roof. Wood-panel, double, entry doors sit under the hipped roof entry porch which is supported by two square, wooden columns. The entry porch is attached to the vinyl-sided entry tower which sits in front of the front-gable wall. The entry tower has a hipped roof on the base and 2nd level. A 1-light octagonal window sits in the 2nd level of the tower. A steeple extends from the 2nd level of the tower. The entry tower is flanked by stained glass windows. A side-gabled wing extends from the back left side of the church. A metal carport is attached to the left side of the wing. A porch and balcony sit in a front-gabled inset on the right side of the South facing facade.

Washington Street, West

255. 303 W. Washington
Block 22 Lot 40

c.1925

C

One-story wood-sided residence with hipped roof and porch. North facing front facade is divided into two bays. Porch has three square, wood columns resting on brick piers supporting a hipped roof. 1st bay has an entry door on right and 2/2 window on left. 2nd bay has 2/2 paired windows, and a clipped gable dormer with centered louver. Left side has a shed roof extending from the hipped roof covering a 2/2 paired window.

256. 304 W. Washington
Block 15 Lot 22

c.1900

C

One-story wood-sided residence with cross-hipped roof and wrap-around porch. South facing front facade. Porch has four square, wood columns resting on brick piers which support a hipped roof. Left side of porch has three 2/2 windows. Glazed entry door sits in the center of the porch. Another 6-light door sits on the right side of the porch.

United States Department of the Interior
National Park Service

**NATIONAL REGISTER OF HISTORIC PLACES
CONTINUATION SHEET**

Section: 7

Page: 59

Okolona Historic District
Okolona, Chickasaw County

257. 305 W. Washington

c.1920

C

Block 22 Lot 39

One-story asbestos-sided residence with hipped roof and porch. North facing front facade. Centered porch has four square, brick columns supporting a shed roof. Entry door is centered under porch. The door is flanked by 2/2 paired windows that are located under the edges of the porch. The left side of the hipped roof turns into a side-gabled roof. A large hipped dormer with 4/4 paired windows sits in the center of the roof.

258. 306 W. Washington

c.1900

C

Block 15 Lot 24

A large, deteriorated, two-story, wood-sided residence with hipped roof and front gable. South facing front facade. House is hidden by vegetation.

259. 307 W. Washington

c.1920

C

Block 22 Lot 38

One-story symmetrical, wood-sided residence with pyramidal roof and full-facade porch. North facing front facade. Porch has four turned spindles supporting a shed roof. Concrete steps lead up to a 1-light, wood-paneled door on the left of the porch. A 6/6 window sits on the right side of the porch. A brick chimney on the right slope of the roof.

260. 308 W. Washington

c.1900

C

Block 15 Lot 58

One-story vinyl-sided residence with entry porch. Hipped with lower gables roof. South facing front facade. Bay window covered by cross-gable roof sits on the left side of the facade. Porch sits to the right of the bay window and is covered by a shed roof. Brick steps lead up to the entry door on the porch. A 1/1 window sits to the right of the door, on the porch. A hipped dormer with 4/4, paired window sits in the center of the hipped roof. Two chimneys sit on both slopes of the roof. A small shed roof addition is attached to the right side.

261. 309 W. Washington

c.1900

NC

Block 22 Lot 37

One-story vinyl-sided residence with cross-gable roof, wrap-around porch, and adjacent carport. South facing front facade. Porch has six, square, wooden columns connected with wooden railings, supporting a front-gabled roof with attached shed roof. A 2/2 tripartite window sits below the front gable. A 2/2 window sits in the back wall of the wrap-around porch. A side-gabled wing on the back of the house extends out from right and left sides of the house. A 9-light door sits in the right wing. A front-gabled carport sits in front of the right side wing.

262. 310 W. Washington

c.1960

NC

Block 15 Lot 59

One-story brick residence with cross-gable roof, entry porch, and attached front-gabled carport. South facing front facade. Left side facade has attached stone front with 3-light window. Centered entry porch has one square, brick column allows entry from side wall door. Right side has one 3-light window.

**United States Department of the Interior
National Park Service**

**NATIONAL REGISTER OF HISTORIC PLACES
CONTINUATION SHEET**

Section: 7

Page: 60

Okolona Historic District
Okolona, Chickasaw County

263. 312 W. Washington
Block 15 Lot 60 and 60.1

c.1900

NC

One-story brick, stucco, and wood sided residence with hipped roof, front entry porch, two freestanding carports, one attached carport, attached garage, and extensive, small additions to the front and back of the left side of the house. Front additions form the restaurant. South facing front facade.

264. 313 W. Washington
Block 22 Lot 5

c.1900

C

One-story symmetrical, asbestos-sided residence with hipped roof and porch. North facing front facade. Porch has six, square, wooden columns supporting a shed roof. Brick steps lead up to a centered entry door with 5-light fanlight. Door is flanked by 8-light windows with attached shutters. A shed roof dormer with 1-light window sit in the center of the roof.

265. 315 W. Washington
Block 22 Lot 4

c.1900

C

One-story symmetrical, residence with side-gable roof and entry porch. North facing front facade. Porch has four square, wooden columns supporting a hipped roof. Facade has two doors next to each other with a 1/1 window on the right and left sides under the porch. Wood siding has been applied to the facade under the porch. A brick chimney sits at the roof crest in the center.

266. 316 W. Washington
Block 15 Lot 62

c.1850

C

Two-story, vinyl-sided residence with cross-gable roof, full-height, inset porch, and right side addition. Corner lot. South facing front facade is divided into three bays. 1st bay has two 6/6 windows above two 6/6 windows under the cross-gable roof. The porch takes up the 2nd and 3rd bays, and is supported by two large, round, Doric columns. The entry door with transom sit under the porch in the 2nd bay. The entry door is covered by elaborate, iron double doors. A 6/6 window sits above the door on the 2nd floor. Two 6/6, windows sit above two 6/6 windows in the 3rd bay. All windows are metal replacements. All window have a small pediment, except the 2nd floor windows under the porch. 1st floor windows are covered by ornate iron security bars. Shed roof addition has 2/2 tripartite windows.

267. 317 W. Washington
Block 22 Lot 3

c.1900

C

One-story asbestos-sided residence with cross-gable roof, entry porch, and attached carport. North facing front facade. Centered entry door is covered by a front gabled roof that extends to the right side and is supported by three ornate, iron columns. The door is flanked by a 1-light window to the right and a 2/1 window with metal awning. Shed roof carport is supported by two ornate iron supports. A 2-light door and a 2/1 window sit in the back carport wall.

**United States Department of the Interior
National Park Service**

**NATIONAL REGISTER OF HISTORIC PLACES
CONTINUATION SHEET**

Section: 7

Page: 61

Okolona Historic District
Okolona, Chickasaw County

268. 400 W. Washington
Block 14 Lot 44

c.1945

C

One-story brick residence with cross-gable roof, full-facade porch and left side addition. South facing front facade. Corner Lot. Porch has four square, brick columns connected by brick knee walls, which divide the facade into three bays. Concrete steps lead up to the glazed 10-light entry door on the porch. The door is flanked by tripartite windows. Tripartite windows have a 5/1 window flanked by 3/1 windows. The cross-gable roof with board-and-batten gable wall extend over the 2nd and 3rd bays. Addition has a side gable roof with a 1-light window flanked by 2/2 windows. A carport with metal supports is attached to the left.

269. 402 W. Washington
Block 14 Lot 45

c.1920

C

One-story asbestos-sided residence with multiple roof forms and entry porch. South facing front facade. Original house was symmetrical, but a wing has been added to the right side and to the back. Original house has a hipped roof with front end-gable. The centered entry porch is covered by a flat roof with iron balustrade. The flat roof has dentils in a simple entablature, and is supported by two fluted, square, wooden columns and two pilasters. On the porch are concrete steps that lead up to a glazed entry door. The porch is flanked by 1/1 paired windows with attached shutters. A 1/1 paired window sits in the end-gable wall. Right wing addition has a smaller 1/1 paired window with attached shutters, and is covered by a lower hipped roof. Back addition also has a hipped roof.

270. 413 Washington
Block 23 Lot 13

c.1950

C

One-story asbestos-sided residence with side-gable roof, entry porch, and left side addition. North facing front facade. Concrete steps lead up to a glazed entry door under a front-gabled porch which rests on ornate iron supports. The porch is flanked on the right by a 1/1 window, and on the left by 2/2 paired windows. A brick chimney sits on the end wall between the central block and the left side addition. The addition sits back from the front and has a concrete deck in front of it. Addition has a brick water table and a 1/1 window.

West Drive

271. 503 West Drive
Block A Lot 31

c.1925

C

One-story vinyl-sided residence with multi-gable roof and full-width porch. North facing front facade. Porch is covered by a gable roof on the left and shed roof on the right, which rest on three iron supports. The facade is composed of a 6/1 paired window on the left and the entry door on the right. The glazed, 12-light, entry door has two 8-light sidelights.

**United States Department of the Interior
National Park Service**

**NATIONAL REGISTER OF HISTORIC PLACES
CONTINUATION SHEET**

Section: 7

Page: 62

Okolona Historic District
Okolona, Chickasaw County

272. 504 West Drive

c.1952

NC

Block 46 Lot 16

One-story brick L-plan Ranch house with cross-gable roof and brick chimney. This house mirrors the neighboring house in Block 46 Lot 13. South facing front facade. A multiple-light, tripartite window sits in the cross-gable wall on the right side of the house. Concrete steps with iron railings lead up to the entry door which sits to the left of the cross-gable. Two 4/4, paired windows sit to the left of the door. A side-gabled addition with 2/2 tripartite window is attached to the left side of the house. A brick chimney sits on the right end-wall of the house.

273. 505 West Drive

c.1920

C

Block A Lot 30

One-story wood-sided residence with hip roof and full-width porch. Roof has exposed rafters. Porch has a shed roof and is supported by four square, wooden columns. House may have had an addition to the left. Entry door has 6-lights and 4-light sidelights. The door is flanked to the right by a paired, 9/1 window and to the left by a single, 9/1 window.

274. 506 West Drive

c.1952

NC

Block 46 Lot 13

One-story brick L-plan Ranch house with cross-gable roof and brick chimney. This house mirrors the neighboring house in Block 46 Lot 16. South facing front facade. A multiple-light, tripartite window sits in the cross-gable wall on the left side of the house. The entry door sits to the right of the cross-gable. Two 4/4, paired windows sit to the right of the door. A side-gabled addition with 2/2 tripartite window is attached to the right side of the house. A brick chimney sits on the left end-wall of the house.

275. 507 West Drive

c.1920

C

Block A Lot 29

One-story brick residence with a center gable on a side-gable roof, and entry porch. North facing front facade. Porch has square brick columns with brick knee wall, which support the center gable. Center gable has board-and-batten with patterned stucco and a centered louver. 12-light entry door is located under the porch and flanked by paired 3/1 windows.

276. 508 West Drive

c.1920

C

Block 46 Lot 10

One-story brick residence with side-gable roof, dominant, front chimney, entry porch, and inset porch. South facing front facade. Entry porch has centered, front-gabled roof with wood-sided pediment, supported by two ornate, iron supports. Brick step under the porch lead up to the wood-panel entry door. An inset porch with ornate, iron supports and iron railings sits to the right of the entry porch. A dominant, brick chimney with inset brick arches and stone medallions sits to the left of the entry porch. The chimney is flanked by 9/1 windows. A front-gabled dormer with wood-sided pediment sit centered at the top of the side-gabled roof.

United States Department of the Interior
National Park Service

NATIONAL REGISTER OF HISTORIC PLACES
CONTINUATION SHEET

Section: 7

Page: 63

Okolona Historic District
Okolona, Chickasaw County

277. 509 West Drive

c.1920

C

Block A Lot 28

One-story brick residence with cross-gabled roof, entry porch, and attached carport. North facing front facade. A brick slope chimney sits in the left gable wall. Porch has a shed roof supported by two ornate, iron supports resting on brick piers and knee wall. The porch covers the glazed entry door. The entry door is flanked to the left by a 6/6 tripartite window. To the right of the door the cross-gable protrudes out. Half-timbering with patterned stucco covers the gable-end of the cross-gable. A 6/6 window sits in the wall of the cross-gable protrusion. All windows have attached shutters. A carport with metal columns resting on a brick knee wall is attached to the left side of the house.

278. 511 West Drive

c.1930

C

Block A Lot 27

One-story wood-sided residence with hip-on-gabled roof and entry porch. North facing front facade. Porch has a hipped roof with roof-line balustrade supported by three ornate, iron supports. Entry door is glazed with 9-lights and sits to the left of center. The door is flanked by 6/1 windows. A 2-light window sits above the porch in the attic level.

279. 513 West Drive

c.1930

C

Block A Lot 26

One-story wood-sided residence with front-gabled roof and wrap-around porch. North facing front facade. Facade has a dominant, front, brick chimney with stone medallions. Wrap-around porch embraces the left side, and covers the glazed, metal, entry door. Porch has a front-gabled roof with supported by four square, wooden columns resting on brick piers. A glazed, metal door sits at the back of the porch. One 3/1 window sits to the right of the chimney.

280. 515 West Drive

c.1930

C

Block A Lot 25

One-story wood-sided residence with front-gabled roof and entry porch. North facing front facade. Entry porch is to the right of center, and consists of a wood sided pediment, covered by a gabled roof, and resting on turned spindle columns. Concrete steps lead up to a wood panel entry door. Paired 3/1 windows flank the entry door.

**United States Department of the Interior
National Park Service**

**NATIONAL REGISTER OF HISTORIC PLACES
CONTINUATION SHEET**

Section: 8

Page: 64

Okolona Historic District
Chickasaw County, Mississippi

STATEMENT OF SIGNIFICANCE

The Okolona Historic District is locally significant in the areas of commerce and architecture under Criteria A and C. The period of significance spans a century, from circa 1850, when the earliest surviving buildings were constructed, to 1950, which marked the beginnings of economic changes in the area in the aftermath of the Second World War. The buildings in the district illustrate the commercial and residential development of Okolona as a center for the transportation of cotton to market, as a commercial center serving the local rural area, and as a center of government as the seat of the Eastern District of Chickasaw County. (The other county seat is located in Houston.)

Settlement and Early Development

Okolona is said to have had its beginning six miles northwest of its present location when Littlebury Gilliam settled on the old stage route in 1836 and opened his house as a public inn. Gilliam became the founder of a settlement, which he named Prairie Mount.¹ Over the next few years the locus of settlement in the area gradually shifted to the site of Okolona, where a community had begun to develop that was initially called Rose Hill. When a post office was established there, the name was changed to Okolona, reputedly based on a Chickasaw Indian name.

The town was formally incorporated in 1850. Because of the depredations of the Civil War, only a few structures survive from the 1850s. Most notable among them is the Elliott Donaldson House (Inventory #9), built in 1850. (It was individually listed on the National Register on 15 September 1980). Several other residences are believed to date from about 1850 (Inventory #10, #209, #211, #213, and #226). Okolona quickly became a trade center for Chickasaw County. Goods, especially cotton, were shipped from Okolona to far-away markets. The rich prairie soil surrounding the city was perfect for large-scale cotton production.

Baptist, Methodist, Episcopal, Presbyterian and Christian church congregations had all been established in town by the end of the 1850s. The locations were later changed. When first built, three of them – Baptist, Methodist and Episcopal Churches – were located on the corners at the intersection of Main Street and Church Street, thus the naming of Church Street.²

The Mobile and Ohio Railroad

In the year 1848, John J. McRae, later to be Governor, came to the county as agent for the Mobile and Ohio Railroad. The company wanted to build a railroad line somewhere west of the Tombigbee River. The citizens of Chickasaw County subscribed and paid by taxation for assistance in building the railroad. The tracks were completed to Okolona and beyond in 1859. The railroad quickly became the driving factor

¹ "Early History No. 1," compiled by the Okolona Chamber of Commerce, Okolona, MS, August 17 1961.

² "A History of Okolona, Mississippi," compiled by the Okolona of Commerce, Okolona, Mississippi, 2000.

United States Department of the Interior
National Park Service

NATIONAL REGISTER OF HISTORIC PLACES
CONTINUATION SHEET

Section: 8

Page: 65

Okolona Historic District
Chickasaw County, Mississippi

in commerce. The economy of the community rested largely on ginning cotton and moving the ginned cotton off to market.

Early commercial development occurred on the Main Street axis perpendicular to the railroad; however, all commercial buildings from this period, and the original depot, were burned during the Civil War.

Civil War

Okolona was just coming into its own when the Civil War began. Because of the railroad, the town was strategically important. As a result, skirmishes between Union and Confederate forces occurred at or near Okolona at least five times, beginning in November, 1862.³ In February, 1864, Federal forces under Brigadier General William Sooy Smith entered Okolona during his move from Memphis in cooperation with Major General William T. Sherman's Meridian Expedition. On February 22, Smith's forces, retreating from West Point, were defeated by Confederate cavalry under Major General Nathan Bedford Forrest north and west of town. In a running battle which culminated in the action at Ivey's Hill, believed to be approximately ten miles north of Okolona on the Pontotoc Road, the Federals were pushed back to Memphis. During the afternoon of the 22nd, General Forrest's younger brother Jeffrey, in command of a cavalry brigade, was killed.⁴ A number of houses and public buildings in Okolona were subsequently used as hospital sites. Hospitals were established at Okolona at other times during the war, most notably as a result of the battles of Shiloh and Corinth.⁵

Industrial Development and Economic Prosperity

By 1866, the population and commercial interests of the part of the country in which Okolona is located, east of Chuquatonchee Creek, had increased so that in response to the requests of its people the Legislature enacted a law dividing the county into two judicial districts.⁶ The eastern part of the county was designated as the Second Judicial District and the western part as the First. It was further provided that equal terms of Circuit and Chancery Courts would be held in each district, one in Okolona, and one in Houston.

Okolona quickly grew and became the major center of trade for Chickasaw County. In the cotton market Okolona was a fierce competitor, virtually controlling the cotton trade of the county. Leading merchants, such as C.C. Dibrell, Buchanan and Son, and Myers and Houseman transferred their business from

³ *A Guide-Index to the Official records of the Union and Confederate Armies, 1861-1865*, Volume III, Section M. (Published on CD-ROM. Carmel, Indiana: Guild Press of Indiana, 1997)

⁴ Wills, Brian Steel. *The Confederacy's Greatest Cavalryman: Nathan Bedford Forrest* (Lawrence, Kansas: University Press of Kansas, 1992), pages 158-168.

⁵ Harwell, Richard Barksdale, ed., *Kate: The Journal of a Confederate Nurse* (Baton Rouge: Louisiana State University Press, 1998), pages 9-12.

⁶ "A History of Okolona, Mississippi," compiled by the Okolona Chamber of Commerce, Okolona, Mississippi, 2000.

United States Department of the Interior
National Park Service

NATIONAL REGISTER OF HISTORIC PLACES
CONTINUATION SHEET

Section: 8

Page: 66

Okolona Historic District
Chickasaw County, Mississippi

Houston, Mississippi to Okolona. The railroad increased the processing capacity of Okolona to develop its industry of producing cotton, which allowed for efficient processing of the raw material prior to shipment to market. From 1870 to 1890, the U.S. Census figures indicate that Okolona grew from a population of 1,410 people to 2,099 people, a 49% increase.⁷ A map from 1898, from the *Atlas of the World* indicates Okolona as one of the "Chief Cities" of the state of Mississippi.⁸

From the diary of G.H. Babbitt (born in Okolona in 1877), an entry on August 11, 1897 tells of electricity coming to Okolona.⁹ The U.S. Census figures indicate a population growth of 69% between 1900 and 1920. By 1900, Main Street was much as it is today, with a long row of buildings on either side of Main Street between Olive and Gatlin Streets (was Meridian Street at the time). There were over forty businesses in the downtown area by 1904. Among them were blacksmith shops, an ice cream factory, livery stable, a saddle maker, hat shops, an opera house, Chinese laundry, meat stores and hotels. Also, there were dry goods, general merchandise, hardware and furniture stores. Several businesses were labeled "colored" on a 1904 map sketch and were owned by families who remained in business for many years. These "colored" businesses were located primarily on the north side of Main Street, west of what is today Olive Street (Inventory #130 and #132).

In 1904, there were two hotels and two banks in downtown, one of which is the Merchants and Farmers Bank (Inventory #120), built circa 1903. (It was individually listed on the National Register on 14 May 1987.) Shortly after the turn of the century, Okolona acquired a telephone system. In 1907, the first "horseless carriage" appeared in Okolona. The town continued to prosper through the 1910s and 20s, with a city steam electric plant and four cotton gins. The city's sewage system was installed between 1912 and 1915.

Because most of the older industrial buildings that stood between the railroad and the downtown have been demolished, the district, as it survives today, is illustrative of the development of commerce and residential neighborhoods. Almost all of the contributing residential architecture in the district is a direct result of the prosperity related to the industrial development spawned by the railroad and the commerce the town provided to the Eastern District of Chickasaw County.

Early twentieth century houses range from modest Craftsman and Colonial Revival bungalows (Inventory #8, #29, #39, #84, #220, and #222) to fine examples of such styles as Colonial Revival (Inventory #39, #66, #169, #207, and #211), Neo-Classical (Inventory #59), Queen-Anne (Inventory #71, #187, #201, and #209) and English Cottage (Inventory #72, #73, and #160). The houses lie within three blocks of the downtown in all directions.

⁷ The U.S. Census figures showed a major increase of Okolona's population.

⁸ This 1898 *Atlas of the World* map indicates the population of each of the "chief cities" of the state of Mississippi. Okolona is listed as one of the 29 "chief cities" with populations above two thousand people.

⁹ "A History of Okolona, Mississippi," compiled by the Okolona Chamber of Commerce, Okolona, MS, 2000.

United States Department of the Interior
National Park Service

**NATIONAL REGISTER OF HISTORIC PLACES
CONTINUATION SHEET**

Section: 8

Page: 67

Okolona Historic District
Chickasaw County, Mississippi

Okolona is notable for its well-preserved early twentieth century churches and institutional buildings. The churches include the First Methodist Church (#136), built in 1907-08; Grace Episcopal Church (#151), built in 1908; Okolona Presbyterian Church (#143), built in 1919; St. Theresa's Catholic Church (#177), built about 1922; and the First Baptist Church (#87), built in 1924. The Carnegie Library (#139) was built in 1915, and the Okolona High School (#158a) was built in 1924.

Decline and Renewal

With the Great Depression beginning in 1929 and lasting throughout the 1930s, Okolona was hard hit. The U.S. Census figures indicate a 47% loss in population from 1920 to 1940.¹⁰ All three banks closed and none existed at all for several months. In 1934, the Mobile and Ohio Railroad provided the only major payroll in Okolona. The only substantial new construction during the 1930s was the U.S. Post Office (Inventory #137), built in 1937, with Public Works Administration funding.

Soon after World War II, Okolona began a short period of growth, according to the U.S. Census figures. Scattered late 1940s houses were built among the older homes of Okolona (Inventory #76, #77, #148, and #216). This period saw the arrival of several new industries, among them a large furniture manufacturing company and the Delta Trouser factory.

However, by the 1960s and 70s, changes in agriculture and transportation had begun to bring about a loss of population in Chickasaw County and a substantial economic decline. Okolona suffered the loss of the railroad, the cotton compress, the cotton oil company, and the lumber company, all of which had a depressing effect from which the town has not yet recovered. Construction in more recent years has largely been infill housing and some replacement of commercial buildings within Okolona's historic district, along with some highway-related sprawl on the fringes of the community.

¹⁰ The U.S. Census figures showed a major decline of Okolona's population from the (late) 1920's to 1940. In the decade between 1940 and 1950, the population began to rise once again, with a good number of cottage-style homes constructed during the 1940's period.

United States Department of the Interior
National Park Service

**NATIONAL REGISTER OF HISTORIC PLACES
CONTINUATION SHEET**

Section: 9

Page: 68

Okolona Historic District
Chickasaw County, Mississippi

BIBLIOGRAPHY

"A Little City That Does Big Things." *Clarksdale Register*. September 20, 1935.

Cappleman, Josie F. "Importance of the Local History of the Civil War." *Publications of the Mississippi Historical Society*. Volume 3, pp. 107-108.

Chickasaw County Historical and Genealogical Society. *History of Chickasaw County, MS. Vol. No. 1*. Mississippi, 1985

"Cities and Towns-Okolona. School's History Told at Dedication." *The Okolona Messenger*. September 1958.

Mississippi Department of Archives and History. Historic Preservation Division. Historic Resource Inventory, Okolona, Mississippi.

Mississippi Department of Archives and History. Historic Preservation Division. Various National Register of Historic Places and Mississippi Landmark Files

"Okolona Chamber Marks 50th." *Okolona Daily Journal*. November 11, 1984

Okolona Chamber of Commerce. *A History of Okolona, Mississippi*. Okolona, Mississippi, October 2000.

Okolona Chamber of Commerce. *Early History of Okolona, No. 1*. Okolona, Mississippi, August 17, 1961.

Okolona Chamber of Commerce. *Early History of Okolona, No. 22*. Okolona, Mississippi, January 11, 1962.

Okolona Chamber of Commerce. *The History of Okolona*. Okolona, Mississippi, 1961, Rev. 1980, 1984.

Sanborn Map Company. Fire Insurance Maps for Okolona, Mississippi: 1899, 1905, 1925, and 1945 revision. New York, NY. Complete series available on Microfilm at the Mississippi Department of Archives and History, Jackson, MS.

WPA Research Project for Chickasaw County, Mississippi. On file at Mississippi Department of Archives and History, Jackson, MS.

**United States Department of the Interior
National Park Service**

**NATIONAL REGISTER OF HISTORIC PLACES
CONTINUATION SHEET**

Section: 10 Page: 69 Okolona Historic District
Chickasaw County, Mississippi

GEOGRAPHIC DATA

Verbal Boundary Description: The boundary of the Okolona Historic District is shown on the accompanying map entitled, "Okolona Historic District."

Boundary Justification: The district includes the greatest remaining contiguous concentration of contributing residential, commercial, religious, and governmental buildings that represent the historic and architectural development during the period of significance, c. 1850-1950.

PHOTOGRAPHS

The following information is the same for all photographs:

1. Okolona Historic District
2. Chickasaw County, Mississippi
3. Mississippi Department of Archives and History
4. Small Town Center, Shannon Criss, Consultant

- | | |
|---------------|---|
| Photo 1 of 25 | 5. 3 February 2000
6. #96a, 215 W. Main (Block 41, Lot 31), commercial building, view to south |
| Photo 2 of 25 | 5. 3 February 2000
6. #137, United States Post Office, 319 W. Main (Block 43, Lot 81), view to southeast |
| Photo 3 of 25 | 5. 3 February 2000
6. #139, Carnegie Library, 321 W. Main Street (Block 43, Lot 2), view to southeast |
| Photo 4 of 25 | 5. 3 February 2000
6. #73, residence, 403 W. Jefferson Street (Block 28, Lot 31), view to southeast |
| Photo 5 of 25 | 5. 3 February 2000
6. #71, residence, 315 W. Jefferson Street (Block 23, Lot 19), view to west |
| Photo 6 of 25 | 5. 3 February 2000
6. #76, residence, 409 W. Jefferson (Block 28, Lot 28), view to southwest |
| Photo 7 of 25 | 5. 3 February 2000
6. #220, residence, 108 N. Church Street (Block 29, Lot 52), view to east |
| Photo 8 of 25 | 5. 3 February 2000
6. #39, residence, 105 N. Gatlin (Block 30, Lot 11), view to west |

**United States Department of the Interior
National Park Service**

**NATIONAL REGISTER OF HISTORIC PLACES
CONTINUATION SHEET**

Section: 10 Page: 70 Okolona Historic District
Chickasaw County, Mississippi

- Photo 9 of 25 5. 3 February 2000
6. #106, Bank of Okolona, 227 W. Main, west corner of Main and Silver (Block 42, Lot 61), view to southwest
- Photo 10 of 25 5. 3 February 2000
6. #120, 245 W. Main, (Block 42, Lot 54), Merchants and Farmers Bank Building, view to south. Previously listed.
- Photo 11 of 25 5. 10 February 2000
6. #112, 235 W. Main, (Block 30, Lot 19) Masonic Building, view to north
- Photo 12 of 25 5. 10 February 2000
6. #2, northwest corner of Church and Main, (Block 24, Lot 10), view to north
- Photo 13 of 25 5. 10 February 2000
6. #165, Grace Episcopal Church , 400 W. Main (Block 28, Lot 38), view to north
- Photo 14 of 25 5. 10 February 2000
6. #9, Elliott-Donaldson House, 109 N. Church (Block 24, Lot 6), view to west. Previously listed.
- Photo 15 of 25 5. 10 February 2000
6. #10, residence, 201 N. Church Street (Block 24, Lot 5), view to west
- Photo 16 of 25 5. 17 February 2000
6. #192, Okolona Christian Church, 106 S. Olive (Block 42, Lot 78), view to east
- Photo 17 of 25 5. 17 February 2000
6. #59, residence, 109 S. Gatlin (Block 41, Lot 42), view to west
- Photo 18 of 25 5. 24 February 2000
6. #169, residence, 105 W. Monroe (Block 55, Lot 4), view to south
- Photo 19 of 25 5. 24 February 2000
6. #226, residence, 209 School Street (Block 23, Lot 14), view to west
- Photo 20 of 25 5. 24 February 2000
6. #265, residence, 315 W. Washington (Block 22, Lot 4), view to south
- Photo 21 of 25 5. 2 March 2000
6. #213, residence, 111 Prairie (Block 45, Lot 35), view to west

**United States Department of the Interior
National Park Service**

**NATIONAL REGISTER OF HISTORIC PLACES
CONTINUATION SHEET**

Section: 10

Page: 71

Okolona Historic District
Chickasaw County, Mississippi

Photo 22 of 25

5. 2 March 2000
6. #209, residence, 107 Prairie (Block 45, Lot 33), view to west

Photo 23 of 25

5. 9 March 2000
6. #29, residence, 109 N. Fleming, (Block 31, Lot 24), view to southwest

Photo 24 of 25

5. 3 February 2001
6. #130-#132, 306-310 W. Main, view to west

Photo 25 of 25

5. 3 February 2001
6. 240-250 Block of Main Street, includes Farmers and Merchants Bank Building, south side view to east.

A-16-337700-3764450
 B-16-338920-3764420
 C-16-338920-3763350
 D-16-337700-3763350

Okolona Historic District
 (Okolona, Chickasaw County)

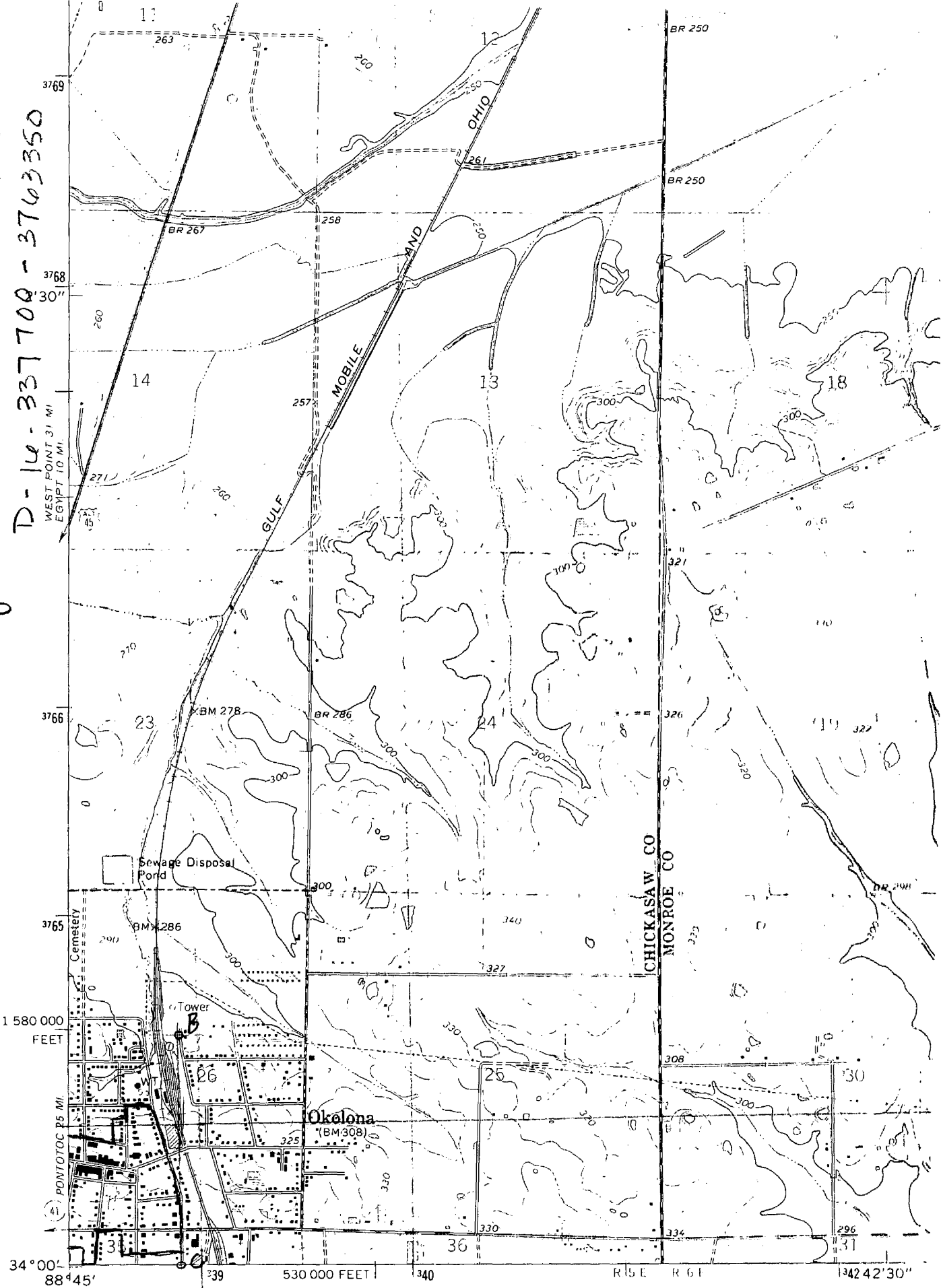

Mapped, edited, and published by the Geological Survey
 Control by USGS, USC&GS, and USCE
 Topography by photogrammetric methods from aerial
 photographs taken 1960. Field checked 1966

BUENA VISTA
 3251 IV NE

GN MN

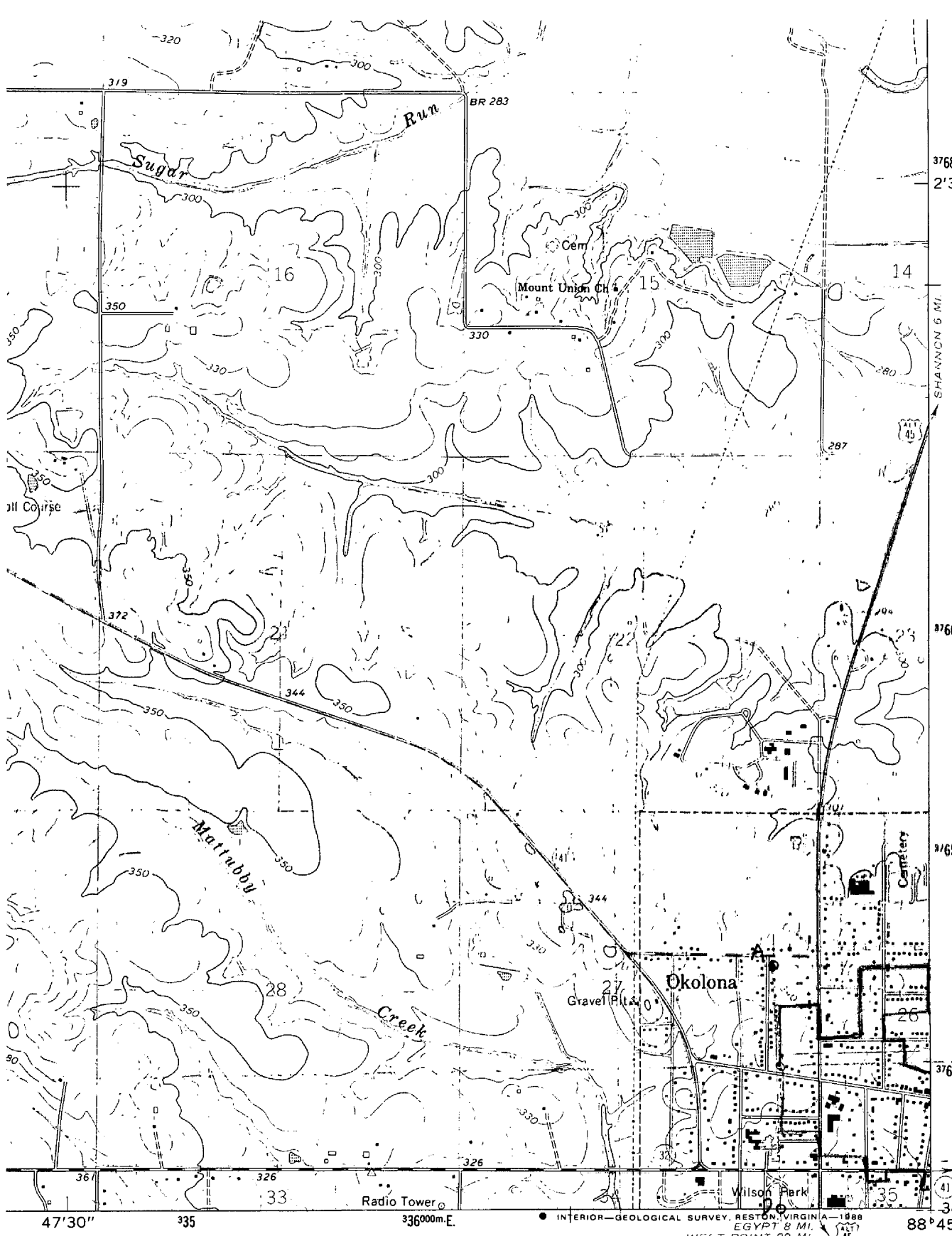

A-16-337700-3764450
 B-16-338920-3764420
 C-16-338920-3763350
 D-16-337700-3763350

Okolona Historic District
 (Okolona, Chickasaw Co)

MILE

ROAD CLASSIFICATION

- Heavy-duty ————— Light-duty —————
- Medium-duty ————— Unimproved dirt - - - - -
- State Route



QUADRANGLE LOCATION

Revisions shown in purple compiled from aerial

TROY SE, MISS.

34088-A7-TF-024

(EGYPT)
 3251 NW