

KENTUCKY HISTORIC RESOURCES INVENTORY

OL-151

p. 1 of 2

Site No.

1. Historic Name(s) **William Woolfolk House**
 Original Owner **William Woolfolk**
 2. Present Name _____
 3. Location **1/2 mile S of US 42, 1 4/10 mile E of KY 393.**
 4. Owner's Name **Mr. & Mrs. Curtis Tingle** *near La Grange*
 5. Owner's Address **5400 W Highway 42, Prospect, Kentucky 40059**
 6. Open to Public Yes No
 7. Ownership Private Local State Federal

28. ADD/County **Oldham** 093
 29. U.S.G.S. Quadrant (15'/75') **LaGrange** 095 C.I.S. Mod.
 30. UTM Reference 16 634710 4255380
 Zone Easting Northing
 31. Coordinate Accuracy

8. Site Plan with North Arrow *attached*
 9. Architect/Builder _____
 10. Date **ca. 1800** A. B.
 11. Style **Federal** **Greek Revival**
 A. B.
 12. Original Use **Residence**
 13. Present Use **Residence**
 14. Condition **Excellent**
 15. Stories, No. of **Two**

32. Prehistoric Site _____ Object _____
 Historic Site _____ Structure _____
 [Building] _____ Other _____
 33. National Register District Name: **Early Stone Beds** 111
 34. Significance of Evaluation **mut NK**
 35. Status _____ Date _____
 National Landmark
 National Register
 Landmark Certificate
 Kentucky Survey
 Local Landmark
 HABS/HAER
 36. Historic Theme **Architecture**
 Primary **Settlement**
 Secondary
 Other
 37. Endangered Yes No

16. Description **Two story, three bay dry stone house, central passage plan, size ca. 22 x 55 feet. Coursed masonry of square tooled Laurel Dolomite, golden color, tooling mostly weathered away, re-pointed with concrete. Interior chimneys each gable end, flanked by small attic windows. Full cellar without fireplaces. Openings spanned by voussoirs, except cellar windows, which have solid stone lintels, scored to resemble voussoirs (as found at Logan 24 and 97). Front doors panelled, paired, with transom, squared stone threshold (photo 4); exterior door in south end of East end wall. Tapered barge board, not**
 (Continue on Back)
 17. Single Pile **XX** NA _____
 Double Pile _____
 18. Floor Plan **Central Passage**
 19. Structural Fabric **Stone** A. B.
 20. Decorative Fabric **Stone** A. B.
 21. Roof Form & Material **Gable, Metal (not original)**
 22. Foundation Material **Stone**
 23. Outbuildings **Frame Smokehouse**
 24. Alterations **Trunk etc** Additions
 Moved Wall Treatment

38. ATTACH PHOTO **Attached**
 Roll No. **Stone 10**
 Picture No. **13 - 31**
 Direction **South etc**
 39. Prepared by: **Carolyn M. Wooley**
 40. Organization **Kentucky Heritage Council**
 41. Date **January 1984**
 42. Revision Dates _____ 43. Staff Review _____

25. History **Land on Harrod's Creek purchased by William Woolfolk in 1796; built house and mill (now gone) on creek; had six children: Richard, Martha m. Newton Lane, Param B., Samuel B., William**
 26. Significance **Large well-built early stone house with fine woodwork, well preserved.**

27. Source of Information
 16. Inspection
 19. 1981 Survey Form

16. beaded. No water table. Window frames pegged, square wooden sills. Blocks in wall indicate house originally had a front porch. Shed porch on E end.

Square hewn studs and rafters; rafters mortise and tenoned at ridge, pegged together; log floor joists, flattened on top and bottom.

Stone wall between passage and parlor, frame wall between passage and dining room. Open stair in passage along frame wall, arises toward south front; enclosed corner stair in dining room arises from S. front to "traveller's room" which has been opened to adjoining second floor rooms. (Location of stairs may indicate reversal of ~~plan~~.)

Chair rails throughout; ~~beveled~~ ^{spliced} paneled window reveals; paneled door reveals on stone walls. Reeded trim in parlor. Breakfront parlor mantel has slender, paired colonettes, reeded panels; bands of oblique reeding angle from center; central reeded triangular panel (photo 5); mitered hearth trim (~~photo 6~~). White ash floors. Dining room mantel has gougework garland in center panel (~~photo~~). Built in presses in dining room and upstairs bedroom.

One room, two story Greek Revival frame room added to northeast corner of house ca. 1857 (carpenter was Tom Carter of LaGrange) (photo 3). Fireplaces now covered. Walls have modern siding.

Early board and batten smoke house east of house, contains stone mile marker from early road (~~photo 9~~).

House faces south (at least since Greek Revival addition); has expansive view of Harrod's Creek Valley. Spring ^{house} south of house built in 1930s. Present gambrel roofed barns constructed 1940s. Family cemetery north of house has tombstone of Eliza B. Woolfolk, consort of William Woolfolk, 1789-1837.

Farm now contains 148 acres, two acres of which have been deeded to owners' child, who built modern brick house on it.

25. K., Mildred. Was residence of Mount family mid 1800s, who added frame rooms. Mount daughter married Eads, whose name is on 1879 map.

Clarence Banks restored house 1938-58; sold to present owner.

The Washburn House (SH-51 demolished) in Shelby County, 1791, is said to have been built by the same stone masons. House contains large iron mortar, used to pound limestone into dust for making mortar (~~photo 10~~).

KENTUCKY HISTORIC RESOURCE INVENTORY SUPPLEMENT
BOUNDARY AND LOCATION INFORMATION

Historic Property Name William Woolfolk house Site # 06151
Multiple Resource/Thematic Nomination Title Early Stone Bldg. of Ky.

U.T.M. Coordinates - List multiple UTM's if property is ten or more acres.

- | | |
|-----------------------------|-----------------------------|
| A. <u>16 634760 4255520</u> | D. <u>16 634540 4255400</u> |
| B. <u>16 634890 4255300</u> | E. _____ |
| C. <u>16 634680 4255160</u> | F. _____ |

Verbal Boundary Description _____ Acreage ca 17.3 acres

Beginning at A, NE of the house, thence S 919 ft to B, thence W 853 ft to C, thence N 919 ft to D, thence E 853 ft to the beginning. Barns are less than 50 years old. Barns, spring house, brick house and garage are non-contributing. Addition to house and stone house are contributing. Boundary drawn to include the portion of the farm on which the house is sited.

Sketch of Site Plan (Showing outbuildings, structures, landscape features and the site boundary as described above.)

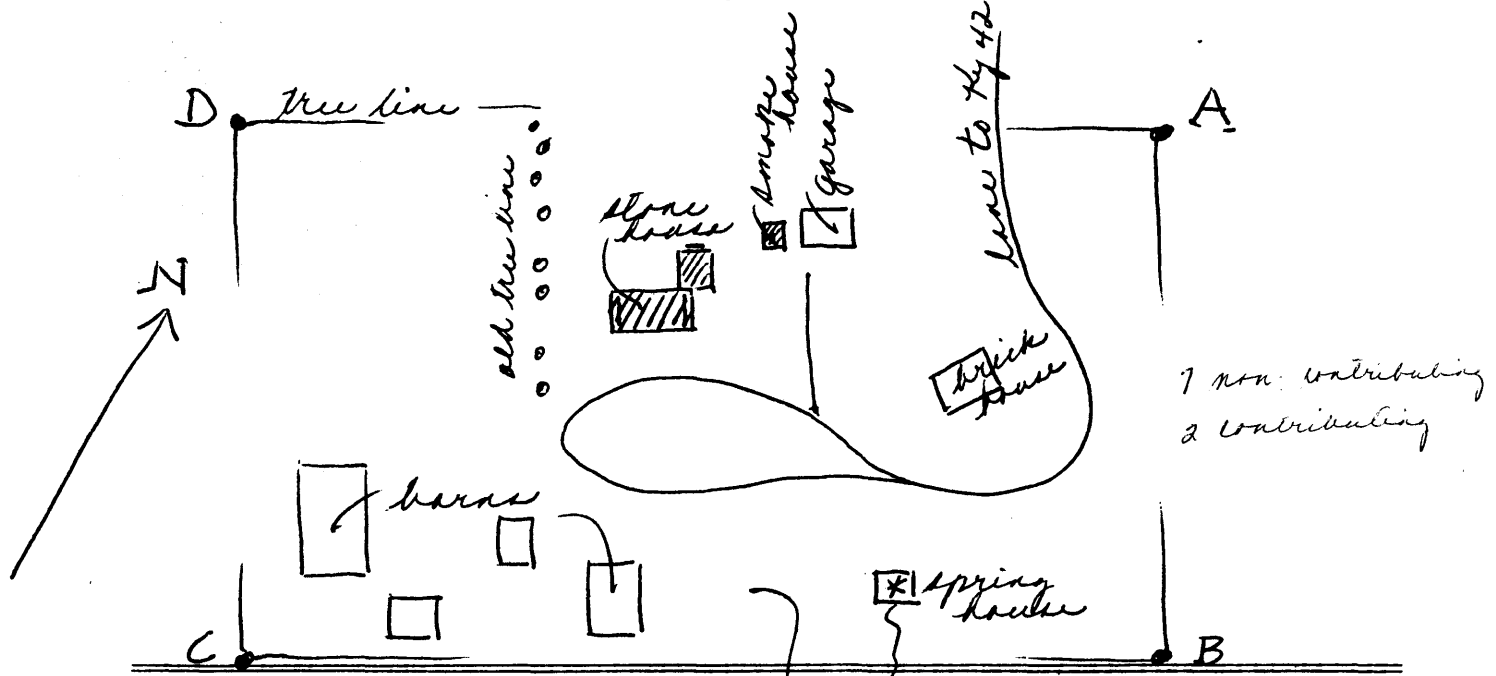

Official Courthouse Property Reference:

Oldham County
Courthouse

14. History: (Continued)

The Washburn House (SH-51 - demolished) in Shelby County, 1791, is said to have been built by the same stone masons. House contains large iron mortar, used to pound limestone into dust for making mortar.

45. Description and House Plan: (Continued)

One room, two-story, Greek Revival, frame room added to northeast corner of house ca. 1857 (carpenter was Tom Carter of LaGrange). Walls have modern siding.

Early board and batten smokehouse east of house, contains stone mile marker from early road.

House faces south (at least since Greek Revival addition); has expansive view of Harrod's Creek Valley. Springhouse south of house built in 1930s. Present gambrel roofed barns constructed 1940s. Family cemetery north of house has tombstone of Eliza B. Woolfolk, consort of William Woolfolk, 1789-1837.

Farm now contains 148 acres, two acres of which have been deeded to owners' child, who built modern brick house on it.