

United States Department of the Interior
National Park Service

RECEIVED

FEB 14 1994

NATIONAL REGISTER OF HISTORIC PLACES
REGISTRATION FORM

NATIONAL
REGISTER

1. Name of Property

historic name: North Park Street Historic District

other name/site number: N/A

2. Location

street & number: 113 North Park Street to 209 North Park Street

not for publication: N/A

city/town: Senatobia

vicinity: N/A

state: Mississippi code: MS county: Tate code: 137 zip code: 38668

3. State/Federal Agency Certification

As the designated authority under the National Historic Preservation Act of 1986, as amended, I hereby certify that this nomination request for determination of eligibility meets the documentation standards for registering properties in the National Register of Historic Places and meets the procedural and professional requirements set forth in 36 CFR Part 60. In my opinion, the property meets does not meet the National Register Criteria. I recommend that this property be considered significant nationally statewide locally. (See continuation sheet for additional comments.)

Kenneth H. P. Pool
Signature of certifying official

February 1, 1994
Date

Deputy State Historic Preservation Officer
State or Federal agency and bureau

In my opinion, the property meets does not meet the National Register criteria. (See continuation sheet for additional comments.)

Signature of commenting or other official

Date

State or Federal agency and bureau

4. National Park Service Certification

I, hereby certify that this property is:

- entered in the National Register Maq M. W. W. 3/31/94
 ___ See continuation sheet.
- determined eligible for the
 National Register
- See continuation sheet.
- determined not eligible for the
 National Register
- removed from the National Register
- other (explain): _____

Maq M. W. W. Signature of Keeper Date of Action
3/31/94

5. Classification

Ownership of Property: Multiple: private, public-local

Category of Property: District

Number of Resources within Property:

Contributing	Noncontributing	
10	1	buildings
1	-0-	sites
-0-	-0-	structures
-0-	-0-	objects
11	1	Total

Number of contributing resources previously listed in the National Register: N/A

Name of related multiple property listing:

Architectural and Historical Resources of Senatobia, Mississippi

8. Statement of Significance

APPLICABLE NATIONAL REGISTER CRITERIA

AREAS OF SIGNIFICANCE

A Property is associated with events that have made a significant contribution to the broad patterns of our history.

ARCHITECTURE

B Property is associated with the lives of persons significant in our past.

X C Property embodies the distinctive characteristics of a type, period, or method of construction or represents the work of a master, or possesses high artistic values, or represents a significant and distinguishable entity whose components lack individual distinction.

PERIOD OF SIGNIFICANCE

Ca. 1898 to ca. 1940

D Property has yielded, or is likely to yield, information important in prehistory or history.

CRITERIA CONSIDERATIONS

SIGNIFICANT DATES

Property is:

N/A

A owned by a religious institution or used for religious purposes

B removed from its original location.

C a birthplace or grave

SIGNIFICANT PERSON

D a cemetery

N/A

E a reconstructed building, object, or structure

CULTURAL AFFILIATION

F a commemorative property

N/A

G less than 50 years of age or achieved significance within the past 50 years.

ARCHITECT/BUILDER

Various. Unknown

=====

9. MAJOR BIBLIOGRAPHICAL REFERENCES

=====

X See continuation sheet.

PREVIOUS DOCUMENTATION ON FILE (NPS):

preliminary determination of individual listing (36 CFR 67) has been requested.

previously listed in the National Register
previously determined eligible by the National Register
designated a National Historic Landmark

recorded by Historic American Buildings Survey # _____
recorded by Historic American Engineering Record # _____

PRIMARY LOCATION OF ADDITIONAL DATA:

<input checked="" type="checkbox"/> State historic preservation office	Local government
<input type="checkbox"/> Other state agency	University
<input type="checkbox"/> Federal agency	Other

Specify Repository: Mississippi Department of Archives and History

=====

10. Geographical Data

=====

Acreage of Property: Approximately three acres

UTM References: Zone Easting Northing Zone Easting Northing

A	<u>16</u>	<u>228205</u>	<u>3834930</u>	B	<u>16</u>	<u>228330</u>	<u>3834940</u>
C	<u>16</u>	<u>228375</u>	<u>3834640</u>	D	<u>16</u>	<u>228260</u>	<u>3834630</u>

___ See continuation sheet.

Verbal Boundary Description: See continuation sheet.

Boundary Justification: See continuation sheet.

=====

11. Form Prepared By

=====

Name/Title: John Linn Hopkins, Preservation Consultant

Organization: N/A

Date: June 1, 1993

Street & Number: 974 Philadelphia Street

Telephone: (901) 278-5186

City or Town: Memphis

State: TN ZIP: 38104

=====

PROPERTY OWNER

=====

Name: Various

Street & Number: N/A

Telephone: N/A

City/Town: N/A

State: N/A

Zip Code: N/A

(8-86)

RECEIVED

United States Department of the Interior
National Park Service

FEB 14 1994

**NATIONAL REGISTER OF HISTORIC PLACES
CONTINUATION SHEET**

**NATIONAL
REGISTER**

Section number 7 Page # 1 North Park Street Historic District
Senatobia, Tate County, MS

=====

NARRATIVE DESCRIPTION

The North Park Street Historic District is a small group of historic structures located along a portion of North Park Street east of the Illinois Central Gulf Railroad, north of Main Street (MS Highway 4), and south of McKie Street in the city of Senatobia, Tate County, Mississippi. The district is composed of seven principal residences along with various associated outbuildings and site features.

The character of the district is largely shaped by its proximity with the Illinois Central Gulf Railroad. Each of the principal buildings within the district face west towards the railroad right of way along North Park Street, which closely parallels the same railroad right of way. A small grassy strip separates the grade of North Park Street from the elevated railroad bed.

A notable feature of the street and lot plan of the district is the public park strip that runs between the line of North Park Street and the private lot frontages of the houses in the district. The park strip ranges in width from twenty-five to forty feet, and houses in the district are set back from this strip an additional twenty-five to fifty feet atop a low, gently rising terrace. The boundary between the public and private green spaces is delineated by the public sidewalk at the summit of this low terrace, thus making the sidewalk barely visible from the right-of-way of North Park Street. Driveways for individual houses cross this public strip to connect with North Park Street, but front walks connect only with the sidewalk. This unusual sidewalk pattern ends immediately at the boundaries of the district; it is a pattern not continued elsewhere in Senatobia. The origins of this unusual public/private community planning pattern are not clear.

Given the small number of residences contained in the district, the range of sizes, scales, construction dates and architectural styles employed here is quite surprising. Queen Anne, Colonial Revival, Craftsman and Minimalist Traditional styling is found here among houses ranging in construction dates from ca. 1898 to ca. 1935-40. Homestead houses, side L-plan cottages and bungalows are the predominate house types. As in any district, a few of these houses have seen the addition of metal or vinyl siding, among other modifications, but the essential spirit of their basic form and detailing remains unaffected.

Presented below is an inventory of the buildings contained within the district. Structures which contribute to the character and quality of the district are noted with the letter designation "C". At the time of the inventory, there was only one structure found in the district that was

United States Department of the Interior
National Park Service

NATIONAL REGISTER OF HISTORIC PLACES
CONTINUATION SHEET

Section number 7 Page # 2 North Park Street Historic District
Senatobia, Tate County, MS
=====

considered to be non-contributing to the character of the district as a result of its recent construction date. It is noted as "NC".

There are notable elements of the general streetscape within the district which establish the character of its historic setting, as evolved over time. The lot divisions along North Park Street, their front yard setbacks, and side yard setbacks all combine to provide a regular rhythm as the setting for its historic buildings; the public park strip, sidewalks, lawns and private plantings all reflect evidence that the district has continuity as a place for living. All of these elements contribute to the character of the district, but are not included in the building inventory that follows. Never-the-less, these resources have been accounted for in the overall count of resources as one contributing site.

The buildings included in the district are:

001 C 113 North Park Street
Two-story, three-bay, frame modified homestead house with Colonial Revival influence, built ca. 1915-20. Complex hip and gable roofs with boxed cornice, covered with asphalt shingles. Gable-roofed dormer contains a single-light fixed sash. Exterior walls have vinyl siding. Windows are 1/1 DHSL, in pairs. Partial-width, shed-roofed porch and added porte cochere, supported by fluted Doric columns. Entrance has a solid replacement door.

002 C 115 North Park Street
Two-story, three-bay, frame homestead house with Colonial Revival influence, built ca. 1900-05. Complex hip and gable roof with enclosed gable end and boxed cornice, covered with asphalt shingles. Exterior walls have aluminum siding. Windows are 1/1 DHSL. Two-story, L-plan hip-roofed porch and porte cochere supported by brick piers, piers are replacements installed ca. 1930-35. Entrance has a solid replacement door.

Garage, ca. 1910-15. One-story, two-bay, frame, side gable roof, exterior plywood siding, overhead door. (C)

003 C 201 North Park Street
Two-story, three-bay, frame side L-plan house with Colonial Revival influence, built ca. 1900-05. Gable roofs with enclosed gable ends and boxed cornice, covered with asphalt shingles. Exterior walls have vinyl siding. Windows are 1/1 DHSL. Partial-width, hip-roofed porch supported by replacement boxed columns. Entrance contains a single-light Cottage door.

(8-86)

United States Department of the Interior
National Park Service

NATIONAL REGISTER OF HISTORIC PLACES
CONTINUATION SHEET

Section number 7 Page # 3 North Park Street Historic District
Senatobia, Tate County, MS

=====

- 004 C 203 North Park Street
One-story, three-bay, frame bungalow with Craftsman and Colonial Revival influences, built ca. 1910-15. Complex hip and gable roof with boxed cornice, covered with asphalt shingles. Shed-roofed dormer contains two single-light sashes. Exterior walls have vinyl siding. Windows are 1/1 DHSL. Partial-width, shed-roofed porch supported by fluted metal replacement columns. Entrance contains a multi-light door.
- 005 C 205 North Park Street
One-story, five bay, stucco veneered L-plan cottage with Minimalist Traditional influence, built in ca. 1935-40 with side addition ca. 1950-55. Side gable roof with boxed cornice, covered with asphalt shingles. Windows are 3/1 DHSL, some in pairs. Entrance has a solid replacement door.
- Storage Shed, ca. 1935-40. One-story, one-bay, frame, gable roof, exterior plywood siding, overhead door. (C)
- 006 C 207 North Park Street
One-story, three-bay, frame, modified composite cottage with Queen Anne influence, built ca. 1898 (The plan is U-shaped, with a center gable between the arms of the U). Complex gable roofs with exposed rafter tails, brackets and enclosed gable ends, covered with patterned sheet metal shingles. Exterior walls covered with weatherboard siding. Windows are 1/1 DHSL. Full-width shed and gable-front porch supported by turned posts with brackets and frieze. Entrance has a single-light door.
- Garage, ca. 1920-25. One-story, three-bay, frame, gable roof, weatherboard siding, shed addition. (C)
- 007 C 209 North Park Street
One-story, three-bay, frame bungalow with Craftsman influence, built ca. 1915-20. Gable-front roof with exposed rafter tails, covered with asphalt shingles. Exterior walls have weatherboard siding. Windows are 3/1 DHSL. Partial-width, hip-roofed porch and porte cochere supported by battered boxed piers on boxed bases; closed weatherboard balustrade. Entrance has a three-light, one-panel Craftsman door.
- Garage, ca. 1950-55. One-story, one-bay, frame, gable roof, weatherboard siding, hinged board and batten doors. (NC)

United States Department of the Interior
National Park Service

NATIONAL REGISTER OF HISTORIC PLACES
CONTINUATION SHEET

Section number 8

Page # 4

North Park Street Historic District
Senatobia, Tate County, MS

NARRATIVE STATEMENT OF SIGNIFICANCE

The North Park Street Historic District is proposed for nomination under criterion C in the area of architecture as a significant concentration of historic residences, which contribute to the overall qualities of the historic residential development of Senatobia during the nineteenth and twentieth centuries. The district contains notable examples of side L-plan houses, homestead houses, composite cottages and bungalows which reinforce the historical pattern of house types found in the historic areas of Senatobia; its Queen Anne, Colonial Revival, Craftsman and Minimalist Traditional influences represent a majority of the historic styles found here. In all, the district represents historic architectural qualities which cut across a large portion of the entire historic period of Senatobia's development as a city. The period of significance for the district begins with the date of construction for its earliest residence; the period concludes with the date of construction of the latest residence that supports the historic character of the district.

The historical development of North Park Street is not fully clear, in part due to the fact that the district is not represented on Sanborn maps until the 1915 map series. At this time, the street name was known as East Front Street. The alignment of the street appears to be contemporary with the development of South Park Street (part of Southeast Senatobia Historic District, NR pending), located to the south of East Main Street from the North Park District. Prior research efforts suggest that the earliest residence on this street is the Page-Woolfolk House, 207 North Park Street, built in ca. 1898, according to its current occupant, Wesley Woolfolk. The house type, architectural style, detailing and materials all appear to be generally consistent with this construction date. The presence of earlier structures in the district is not supported by the historical evidence available. Most existing structures appear to date from the roughly thirty year period following the construction of the Page-Woolfolk House.

Portions of the area east of the North Park Street district along the present-day McKie Street were platted and sold by the Senatobia Oil Company in 1914 (Plat Book 1, pg. 2; Deed Book T, pg. 590). Given the dates of construction for most houses existing along North Park Street, it is suggested that the action of the Senatobia Oil Company was something of a reaction to an existing trend in development of North Park Street. Any trend, apparently, was squelched by the uncertainties of World War One.

Though small in size and number, the North Park Street district provides an important contribution to the historic architectural fabric of

(8-86)

United States Department of the Interior
National Park Service

NATIONAL REGISTER OF HISTORIC PLACES
CONTINUATION SHEET

Section number 8 Page # 5 North Park Street Historic District
Senatobia, Tate County, MS
=====

Senatobia. Further, the district possesses unique qualities of design which add diversity to the historic streetscapes of the city. These qualities all combine to form an important contribution to the character of place unique to Senatobia.

United States Department of the Interior
National Park Service

NATIONAL REGISTER OF HISTORIC PLACES
CONTINUATION SHEET

Section number 9 Page # 6 North Park Street Historic District
Senatobia, Tate County, MS
=====

9. MAJOR BIBLIOGRAPHIC REFERENCES

Carpenter, Howard, editor, The History of Tate County (Senatobia, MS: B/C Printing, 1975)

Tate County Democrat, "Take a Walk for In-Town History Tour", Progress Edition, July 3, 1980, Section D.

Tate County Plat Book 1, page 2, filed May 27, 1914; recorded in Deed Book T, pg. 590, April 6, 1917.

Woolfolk, Wesley, Personal Communication, 1993.

(8-86)

United States Department of the Interior
National Park Service

NATIONAL REGISTER OF HISTORIC PLACES
CONTINUATION SHEET

Section number 10 Page # 7 North Park Street Historic District
Senatobia, Tate County, MS

=====

10. GEOGRAPHICAL DATA

Verbal Boundary Description

The property in nomination includes all that property, public and private, which contributes to the significance of the district, as delineated with a heavy black line on the attached Tate County Property Tax Map 99B.

Boundary Justification

The property in nomination includes all of the land historically and currently associated with the residential development of North Park Street during the period of significance, including the public park strip that is established along the entire frontage of each lot included in the district.

(8-86)

United States Department of the Interior
National Park Service

NATIONAL REGISTER OF HISTORIC PLACES
CONTINUATION SHEET

Section number Photos Page # 8 North Park Street Historic District
Senatobia, Tate County, Mississippi
=====

PHOTO LIST

NORTH PARK STREET HISTORIC DISTRICT

Senatobia, Tate County, Mississippi

Photographer: John Linn Hopkins

Date: July, 1993

Negatives: Mississippi Department of Archives and History
(Photos from MDAH Survey Files, as noted)

Photo 1 of 4

View of the public park strip between North Park Street and the properties facing North Park Street, looking north from 113 North Park Street.

Photo 2 of 4 (MDAH 2686:28)

View of 115 North Park Street, looking southeast.

Photo 3 of 4 (MDAH 2686:32)

View of 203 North Park Street, looking generally east.

Photo 4 of 4 (MDAH 2687:4)

View of 207 North Park Street, looking generally east.

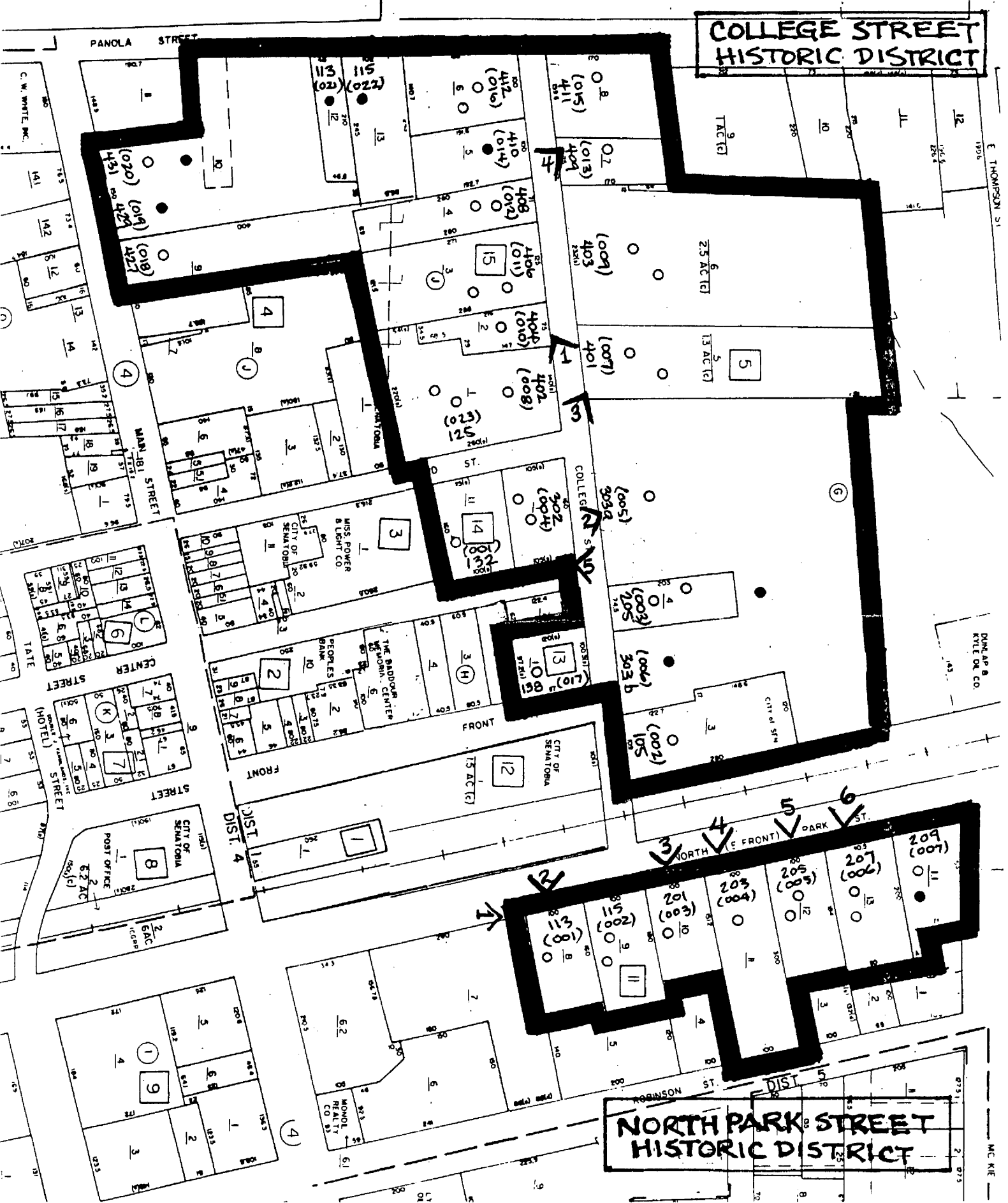

PHOTO MAP
 COLLEGE STREET HISTORIC DISTRICT (ABOVE)
 NORTH PARK STREET HISTORIC DISTRICT (BELOW)
 SENATORBIA, TATE COUNTY, MISSISSIPPI

SCALE: 1" = 200'

BOUNDARY:

CONTRIBUTING STRUCTURE: ○
 NON-CONTRIBUTING STRUCTURE: ●

