

1717

SEP 20 1989

NATIONAL REGISTER

NPS FORM 10-900 (Rev. 8-86) OMB No. 1024-0018 [SD-SHPO # ECA-OH-597-1/89] [use paper with at least 25% cotton rag content, use NLQ or LQ printer]

United States Department of the Interior -- National Park Service NATIONAL REGISTER OF HISTORIC PLACES -- REGISTRATION FORM

This form is for use in nominating or requesting determinations of eligibility for individual properties or districts. See instructions in Guidelines for Completing National Register Forms (National Register Bulletin 16). Complete each item by marking "x" in the appropriate box or by entering "NA" for "not applicable." For functions, styles, materials, and areas of significance, enter only the categories and subcategories listed in the instructions. For additional space use continuation sheets (Form 10-900a). Type all entries.

1. Name of Property

historic name: Greenfield, Dr. John C., House
other name/ site number: BO-AV-AV-1

2. Location

street & number: 307 W. First Street /NA/ not for publication
city, town: Avon /NA/ vicinity
state: SOUTH DAKOTA code: SD county: Bon Homme code: SD 009 zip code: 57315

3. Classification

Ownership of Property: Category of Property Number of Resources within Property:
Contributing Noncontributing
/XX/ private / / building(s) 2 buildings
/ / pubic-local /XX/ district sites
/ / public-state / / site 1 structures
/ / public-federal / / structure 1 objects
/ / object 4 0 Total
Name of related multiple property listing:
NA Number of contributing resources
previously listed in the National
Register: 0

11. Form Prepared by

name/title: Charles & Joanne Bryan, owners; w/tech. assistance by J. Rau, SHPO staff
organization: date: July 25, 1989
street & number: 307 W. First Street telephone: 605-286-3674
city or town: Avon state: SOUTH DAKOTA zip code: 57315

page 2: Dr. John C. Greenfield House
property name

, Bon Homme
county

, SOUTH DAKOTA
state

4. State/Federal Agency Certification

As the designated authority under the National Historic Preservation Act of 1966, as amended, I hereby certify that this / / nomination / / request for determination of eligibility meets the documentation standards for registering properties in the National Register of Historic Places and meets the procedural and professional requirements set forth in 36 CFR Part 60. In my opinion, the property / / meets / / does not meet the National Register criteria. / / See continuation sheet.

[Signature]
Signature of certifying official

9/12/89
Date

SHPD South Dakota
State or Federal agency or bureau

In my opinion, the property / /meets / / does not meet the National Register Criteria.
/ / See continuation sheet.

Signature of commenting or other official

Date

State or Federal agency or bureau

5. National Park Service Certification

I, hereby, certify that this property is:

Entered in the
National Register

- entered in the National Register
- ____ see continuation sheet
- ____ determined eligible for the National Register
- ____ see continuation sheet
- ____ determined not eligible for the National Register
- ____ removed from the National Register
- ____ other, (explain) _____

[Signature]

10/19/89

[Signature]

Signature of the Keeper

Date

page 3: Dr. John C. Greenfield House
property name

, Bon Homme
county

, SOUTH DAKOTA
state

6. Function or Use (enter categories from instructions)

Historic functions:

DOMESTIC/Single Dwelling

Current Functions:

DOMESTIC/Single Dwelling

7. Description

Architectural Classification:

(enter categories from instructions)

Queen Anne

Materials:

(enter categories from instructions)

foundation Stone

walls Wood

roof Asphalt

other Wood

Describe present and historic physical appearance:

/XX/ see continuation sheet

8. Significance

Certifying official has considered the significance of this property in

relation to other properties: / / / / /XX/

nationally statewide locally

Applicable National Register Criteria / / A / /B /XX/C / /D

Criteria Considerations / /A / /B / /C / /D / /E / /F / /G

Areas of Significance (enter from instructions)

Architecture

Period of Significance

1903

Significant Dates

1903

Significant Person

NA

Cultural Affiliation

NA

Architect/Builder

Busher, N. E.

Lewis, Joe

State significance of property, and justify criteria, criteria considerations,

and periods of significance noted above /XX/ see continuation sheet

United States Department of the Interior
National Park Service

National Register of Historic Places
Continuation Sheet

Section number 7 Page 1

Situated on a shaded corner lot in the heart of Avon, South Dakota, the Dr. John C. Greenfield House is large two-and-one-half story Queen Anne dwelling. Rising from a foundation of native Sioux quartzite, the massed rectangular building is clad with clapboard siding. It is capped by a hipped roof with gabled and hipped-roof bays projecting from all facades giving the overall roof line a very irregular form. A two-story round tower with a conical roof rises from the southeast corner of the house. Semioctagonal two-and-one-half story bays jut out from both the south and east (front) facades. Roof surfaces are covered with asphalt shingles. A large triple-flue brick chimney towers above the roof line. Modillion blocks appoint wide overhanging eaves along all facades. A partially enclosed, partially screened porch supported by Ionic columns wraps around the south and east facades. Fenestration about the house is asymmetrical. Above the south side entry door is a Georgian oval motif with a small balustrade.

Interior space is roughly divided according to a two-bay wide, triple-pile plan. Special features of the interior include hardwood floors, woodwork, pocket doors, paneling, and built-in cabinets and closets. Plaster friezes decorate the dining room, parlor, sitting room, and foyer. A corner fireplace is located in the sitting room. In the pantry, amenities include an ice box converted into a cupboard and a restored dumbwaiter. Two of the upstairs walk-in closets have built-in dressers. Characteristic of Queen Anne styling, the irregular nature of the roof line provides a variety of pleasant sitting spaces and nooks on the upper floors.

Although originally lighted by Carbide gas generated in a nearby cave, the house was one of the first in Avon to be wired for electricity. Except for those in the finished attic, the original gasoliers are no longer extant. Gas pipes are found in most walls of the house.

Just southeast of the house is a concrete and metal fountain (contributing) featuring a painted Cupid pulling a fish out of a net surrounded by four metal urns. Water spurts out of the fish's mouth. The area between the urns and the fountain was originally a goldfish pond, but it has been used as a planter for many years. The current owners recently restored the fountain.

North of the house is the cave (contributing) that once housed the Carbide plant for the gas lights. It is still used as a root cellar.

Northwest of the house is a large wood frame carriage house. Although now used as a garage, it originally housed two teams of horses and two carriages. A square wooden cupola with a weather vane rises from the center of the gable roof.

The fountain, cave, and carriage house are all contemporary with the house.

**United States Department of the Interior
National Park Service**

**National Register of Historic Places
Continuation Sheet**

Section number 7 Page 2

Sketch of Site Plan on Reverse Side

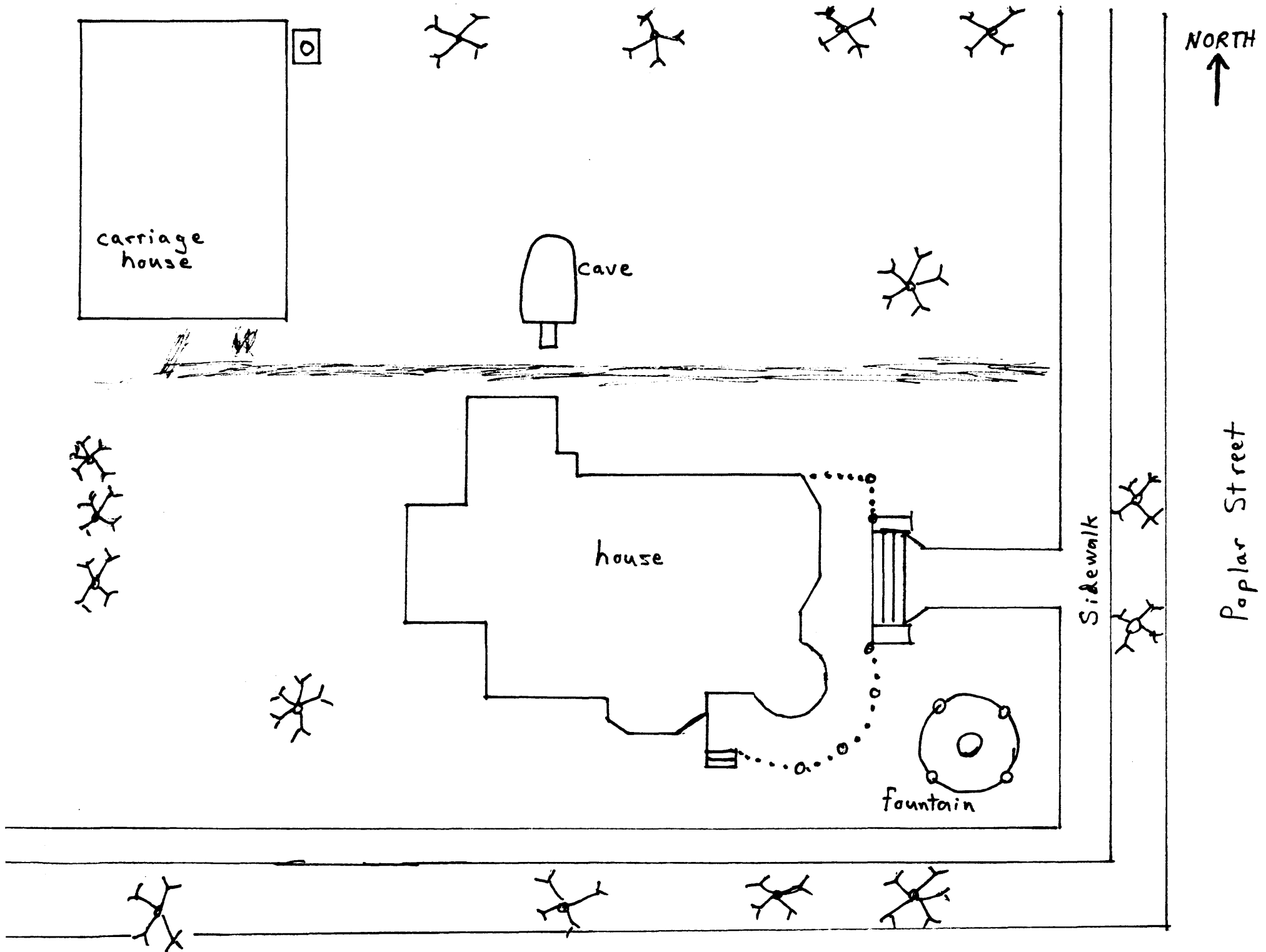

Dr. John C. Greenfield House, Avon

1st Street

United States Department of the Interior
National Park ServiceNational Register of Historic Places
Continuation SheetSection number 8 Page 1

Under Criterion C of the National Register Criteria, the Dr. John C. Greenfield House is significant in the area of architecture, because it is an outstanding example of Queen Anne styling. Constructed in 1903, the picturesque property includes the impressive wood frame dwelling, a large carriage house, a cave once used to house a Carbide plant, and a fountain. It is one of the finest historic homes in the City of Avon, South Dakota. Under the South Dakota Historical Preservation Plan, the property relates to the following historic context: IV. Permanent Rural and Urban Pioneer Settlement, D.2. Urban Development/Residential Living.

During the late 19th Century and very early 20th Century, Queen Anne styling dominated domestic building throughout South Dakota. Influenced by the work of English architect Richard Norman Shaw, Queen Anne houses provided increased comfort and domesticity for single-family households. Prominent aesthetic features of the style include asymmetrical facades, irregular roof lines, multiplicity of siding materials especially the use of fishscale shingles, and decorative treatments to gable ends, porches, and projecting bays. The front facade is usually divided into uneven squares or planes. Fenestration is always asymmetrical, often consisting of a number of shapes and sizes of windows. Frequently, a tower is incorporated into the design. Interior spaces emphasize richness and comfort. Later designs are generally simpler and usually incorporate some elements of the emerging Neo-Classical Revival movement.

In keeping with the most fundamental Queen Anne traditions, the Greenfield House displays an asymmetrical facade with an irregular roof line and a grand conical tower. However, also a product of the later influences it features Classical Ionic columns around the porch, a Georgian oval motif on the south facade, and modillion blocks all along the eave line. The interior includes a wealth of some of the finer period appointments such as built-in cabinets, a corner fireplace, a dumbwaiter, ornate plaster work, and hardwood trim. Domestic comfort was enhanced by the presence of the carriage house, cave, and fountain. The house was designed by architect N. E. Busher of Mt. Morris, Illinois, and constructed by local contractor Joe Lewis.

Bon Homme County was organized in 1862. As one of the earliest areas in Dakota Territory to be populated, its ethnic stock is considerably mixed. Situated at the extreme western edge of the county, Avon originally began in 1879 as a small post office at the pioneer home of Mr. and Mrs. George Phoenix. In 1900, the town was moved one-and-one-half miles northwest to its present location to meet up with the newly completed Chicago, Milwaukee, and St. Paul Railroad line. It continues to serve as a small agricultural service town.

United States Department of the Interior
National Park Service

**National Register of Historic Places
Continuation Sheet**

Section number 8 Page 2

John Calvin Greenfield was born in Forreston, Illinois, on August 10, 1875. He graduated from medical school in Chicago in 1898 and came to Avon, South Dakota in 1903 to practice medicine. His father-in-law, J. T. Campbell, came to Avon as early as 1892 to engage in the banking business. Greenfield gave up medicine for a short time to join his father-in-law's firm. During the Great Depression of the 1930s, he lost almost all of his assets except for his house. He returned to his medical practice until his death in 1948. Dr. Greenfield was a charter member and loyal patron of the First Presbyterian Church of Avon. He was affiliated with Bon Homme Lodge No. 101 A.F. & A.M, Elizabeth Chapter No. 54 O.E.S. at Tyndall, the Oriental Consistory at Yankton, and the El Riad Shrine at Sioux Falls. A perennial advocate of education, Greenfield served as a trustee of Huron College for many years.

His first wife, Estella Campbell, died in 1936. They had no children. He then married Janie Hagerty, who was first a school teacher and then a registered pharmacist. She helped to found the first lending library in Avon and held a number of posts in both county and city governments. She died in 1966.

Grace Brandt, a niece who came in her teens to live with the Greenfields, inherited their home and lived there until her death in 1985. Never married, she taught in high schools and colleges in both South Dakota and Indiana.

The Greenfield House was a long-time focal point for social activity in Avon. Many church-related events such as ice cream socials, club luncheons, and benefits dinners were held on the premises. It continues to be a local landmark. Currently owned by Charles and Joanne Bryan, the house is in an excellent state of repair.

The period of significance of the nominated property does not extend beyond its date of construction in 1903.

page 4: Dr. John C. Greenfield House
property name

, Bon Homme
county

, SOUTH DAKOTA
state

9. Major Bibliographical References

/XX/ see continuation sheet

Previous documentation by NPS:

- / / preliminary determination of individual listing (36 CFR 67) has been requested
- / / previously listed in the National Register
- / / previously determined eligible by the National Register
- / / designated a National Historic Landmark
- / / recorded by Historic American Buildings Survey # _____
- / / recorded by Historic American Engineering Record # _____

Primary location of additional data:

- /XX/ State historic preservation office
- / / Other State agency
- / / Federal agency
- / / Local government
- / / University
- / / Other

Specify repository:

South Dakota Historical Preservation Center

10. Geographical Data

Acreege of property: Less than one acre

UTM References:

A = /14/	/576-380/	/4761-610/	B = / /	/ /	/ /
C = / /	/ /	/ /	D = / /	/ /	/ /
ZONE	EASTING	NORTHING	ZONE	EASTING	NORTHING

Quad: Avon

Scale: 1:24000

/ / see continuation sheet

Verbal Boundary Description:

The nominated property is bounded by the legal description as recorded in the Bon Homme County Register of Deeds Office: Lots 6, 7, and 8, of Block 9, of Milwaukee Land Company's Third Addition, City of Avon, Bon Homme County, South Dakota.

/ / see continuation sheet

Boundary Justification:

The boundaries of the nominated property are based on the legally recorded lot lines of the parcel historically associated with the property.

/ / see continuation sheet

United States Department of the Interior
National Park Service

National Register of Historic Places
Continuation Sheet

Section number 9 Page 1

"Avon Services Are Held for Mrs. Greenfield." Avon (South Dakota) Clarion. 1966.

Deed Records. Bon Homme County Register of Deeds.

"Dr. J. C. Greenfield Buried Sunday, Services at Avon." Avon (South Dakota) Clarion. 1948.

Greenfield, Herman, Lucille, and Lynn. Personal Interview by Charles and Joanne Bryan at Avon. June 13, 1987.

Holleman, Eva. Personal Interview by Charles and Joanne Bryan at Avon. May 30, 1987.

Klock, Lawrence, et.al. "Dr. Greenfield Home Built in 1903." Ms. Typescript. 1985. (annotated by current owners Charles and Joanne Bryan, 1989)

"Mrs. J. C. Greenfield Passes to the Great Beyond." Avon (South Dakota) Clarion. 1932

Obituary for Grace E. Brandt. Avon (South Dakota) Clarion. May 16, 1985.

Weinhart, Ruth Metcalf. Personal Interview by Charles and Joanne Bryan at Avon. June 12, 1987.

**United States Department of the Interior
National Park Service**

**National Register of Historic Places
Continuation Sheet**

Section number photos Page 1

PHOTO DOCUMENTATION

1.
Dr. John C. Greenfield House
Avon, Bon Homme County, South Dakota
by John Rau
August 1989
Neg.: South Dakota Historical Preservation Center
East and south facades, camera facing northwest
Photo No. 1

2.
Dr. John C. Greenfield House
Avon, Bon Homme County, South Dakota
by Charles Bryan
January 1989
Neg.: South Dakota Historical Preservation Center
South facade, camera facing north
Photo No. 2

3.
Dr. John C. Greenfield House
Avon, Bon Homme County, South Dakota
by Charles Bryan
January 1989
Neg.: South Dakota Historical Preservation Center
North facade, camera facing south (rear of cave in foreground)
Photo No. 3

4.
Dr. John C. Greenfield House
Avon, Bon Homme County, South Dakota
by Charles Bryan
January 1989
Neg.: South Dakota Historical Preservation Center
Interior, hardwood paneling and staircase
Photo No. 4

5.
Dr. John C. Greenfield House
Avon, Bon Homme County, South Dakota
by John Rau
August 1989
Neg.: South Dakota Historical Preservation Center
Carriage house, south and west facades, camera facing northeast
Photo No. 5

**United States Department of the Interior
National Park Service**

**National Register of Historic Places
Continuation Sheet**

Section number photos Page 2

6.

Dr. John C. Greenfield House
Avon, Bon Homme County, South Dakota
by Charles Bryan
January 1989
Neg.: South Dakota Historical Preservation Center
Carriage house, east facade, camera facing west
Photo No. 6

7.

Dr. John C. Greenfield House
Avon, Bon Homme County, South Dakota
by John Rau
August 1989
Neg.: South Dakota Historical Preservation Center
Interior, fireplace in sitting room
Photo No. 7

8.

Dr. John C. Greenfield House
Avon, Bon Homme County, South Dakota
by John Rau
August 1989
Neg.: South Dakota Historical Preservation Center
Interior, tower nook
Photo No. 8

9.

Dr. John C. Greenfield House
Avon, Bon Homme County, South Dakota
by John Rau
August 1989
Neg.: South Dakota Historical Preservation Center
Fountain, camera facing west
Photo No. 9

10.

Dr. John C. Greenfield House
Avon, Bon Homme County, South Dakota
by John Rau
August 1989
Neg.: South Dakota Historical Preservation Center
Cave, camera facing northeast
Photo No. 10