



**United States Department of Interior  
National Park Service**

**National Register of Historic Places  
Registration Form**

This form is for use in nominating or requesting determinations for individual properties and districts. See instructions in *How to Complete the National Register of Historic Places Registration Form* (National Register Bulletin 16A). Complete each item by marking "x" in the appropriate box or by entering the information requested. If an item does not apply to the property being documented, enter "N/A" for "not applicable." For functions, architectural classification, materials, and areas of significance, enter only categories and subcategories from the instructions. Place additional entries and narrative items on continuation sheets (NPS Form 10-900A). Use a typewriter, word processor, or computer, to complete all items.

**1. Name of Property**

historic name Burlington Cemetery Chapel  
other names/site number N/A

**2. Location**

street & number 701 South Browns Lake Drive N/A not for publication  
city or town Burlington N/A vicinity  
state Wisconsin code WI county Racine code 101 zip code 53105

**3. State/Federal Agency Certification**

As the designated authority under the National Historic Preservation Act, as amended, I hereby certify that this  nomination request for determination of eligibility meets the documentation standards for registering properties in the National Register of Historic Places and meets the procedural and professional requirements set forth in 36 CFR Part 60. In my opinion, the property  meets \_ does not meet the National Register criteria. I recommend that this property be considered significant \_ nationally \_ statewide  locally. (See continuation sheet for additional comments.)

  
Signature of certifying official/Title

8/16/13  
Date

State Historic Preservation Officer - Wisconsin

State or Federal agency and bureau

In my opinion, the property \_ meets \_ does not meet the National Register criteria.  
( See continuation sheet for additional comments.)

Signature of commenting official/Title

Date

State or Federal agency and bureau

Burlington Cemetery Chapel | Racine | Wisconsin  
 Name of Property | County and State

**4. National Park Service Certification**

I hereby certify that the property is:  
 entered in the National Register.  
 See continuation sheet.  
 determined eligible for the National Register.  
 See continuation sheet.  
 determined not eligible for the National Register.  
 See continuation sheet.  
 removed from the National Register.  
 other, (explain:)

Edson K. Beall 10.9.13  
 \_\_\_\_\_  
 \_\_\_\_\_  
 \_\_\_\_\_  
 \_\_\_\_\_  
 \_\_\_\_\_  
 \_\_\_\_\_

lor Signature of the Keeper Date of Action

**5. Classification**

Ownership of Property (check as many boxes as apply)	Category of Property (Check only one box)	Number of Resources within Property (Do not include previously listed resources in the count)	
		contributing	noncontributing
<input checked="" type="checkbox"/> private	<input checked="" type="checkbox"/> building(s)		
<input type="checkbox"/> public-local	<input type="checkbox"/> district	1	buildings
<input type="checkbox"/> public-State	<input type="checkbox"/> structure		sites
<input type="checkbox"/> public-Federal	<input type="checkbox"/> site		structures
	<input type="checkbox"/> object		objects
		1	0 total

Name of related multiple property listing:  
 (Enter "N/A" if property not part of a multiple property listing.)  
N/A

Number of contributing resources previously listed in the National Register  
0

**6. Function or Use**

<b>Historic Functions</b> (Enter categories from instructions) <u>RELIGION/ religious facility</u>	<b>Current Functions</b> (Enter categories from instructions) <u>VACANT/ NOT IN USE</u>
_____	_____
_____	_____

**7. Description**

<b>Architectural Classification</b> (Enter categories from instructions) <u>LATE VICTORIAN/ Romanesque</u>	<b>Materials</b> (Enter categories from instructions)
_____	Foundation <u>STONE</u>
_____	Walls <u>STONE</u>
_____	Roof <u>TERRA COTTA</u>
_____	Other _____

**Narrative Description**  
 (Describe the historic and current condition of the property on one or more continuation sheets.)



# United States Department of the Interior

NATIONAL PARK SERVICE  
1849 C Street, N.W.  
Washington, DC 20240

October 17, 2013

Notice to file:

This property has been automatically entered in the National Register of Historic Places on: October 9, 2013

This is due to the fact that there was a lapse in appropriations by Congress and our offices were closed from October 1-16, 2013. "Nominations will be included in the National Register within 45 days of receipt by the Keeper or designee unless the Keeper disapproves a nomination" (30CFR60.(r)). If the 45<sup>th</sup> day falls on a weekend or Federal holiday, the property will be automatically listed the next business day.

The documentation is technically sufficient, professionally correct and meets the National Register criteria for evaluation. Thus, this property is automatically listed in the National Register of Historic Places.

**8. Statement of Significance**

**Applicable National Register Criteria**

(Mark "x" in one or more boxes for the criteria qualifying the property for the National Register listing.)

- A Property is associated with events that have made a significant contribution to the broad patterns of our history.
- B Property is associated with the lives of persons significant in our past.
- C Property embodies the distinctive characteristics of a type, period, or method of construction or represents the work of a master, or possesses high artistic values, or represents a significant and distinguishable entity whose components lack individual distinction.
- D Property has yielded, or is likely to yield, information important in prehistory or history.

**Criteria Considerations**

(Mark "x" in all the boxes that apply.)

Property is:

- A owned by a religious institution or used for religious purposes.
- B removed from its original location.
- C a birthplace or grave.
- D a cemetery.
- E a reconstructed building, object, or structure.
- F a commemorative property.
- G less than 50 years of age or achieved significance within the past 50 years.

**Areas of Significance**

(Enter categories from instructions)

ARCHITECTURE

**Period of Significance**

1922

**Significant Dates**

1922

**Significant Person**

(Complete if Criterion B is marked)

N/A

**Cultural Affiliation**

N/A

**Architect/Builder**

Unknown

**Narrative Statement of Significance**

(Explain the significance of the property on one or more continuation sheets.)

Name of Property

County and State

**9. Major Bibliographic References**

(Cite the books, articles, and other sources used in preparing this form on one or more continuation sheets.)

**Previous Documentation on File (National Park Service):**

- preliminary determination of individual listing (36 CFR 67) has been requested
- previously listed in the National Register
- previously determined eligible by the National Register
- designated a National Historic landmark
- recorded by Historic American Buildings Survey #
- recorded by Historic American Engineering Record #

**Primary location of additional data:**

- State Historic Preservation Office
- Other State Agency
- Federal Agency
- Local government
- University
- Other

Name of repository:

**10. Geographical Data**

Acreege of Property less than one acre

UTM References (Place additional UTM references on a continuation sheet.)

1	<u>Zone</u>	<u>Easting</u>	<u>Northing</u>
	16	396813	47269299

3	<u>Zone</u>	<u>Easting</u>	<u>Northing</u>
---	-------------	----------------	-----------------

2	<u>Zone</u>	<u>Easting</u>	<u>Northing</u>
---	-------------	----------------	-----------------

4	<u>Zone</u>	<u>Easting</u>	<u>Northing</u>
---	-------------	----------------	-----------------

See Continuation Sheet

Verbal Boundary Description (Describe the boundaries of the property on a continuation sheet)

Boundary Justification (Explain why the boundaries were selected on a continuation sheet)

**11. Form Prepared By**

<b>name/title</b>	Robert Short, Intern Architect & Historic Preservation Assistant	<b>date</b>	August 17, 2012
	Jennifer L. Lehrke, AIA, LEED AP, Principal Architect & Historic Preservation Consultant	<b>telephone</b>	(920) 783-6303
<b>organization</b>	Legacy Architecture, Inc.	<b>zip code</b>	53081
<b>street &amp; number</b>	529 Ontario Avenue, Suite FN1	<b>state</b>	WI
<b>city or town</b>	Sheboygan		

Burlington Cemetery Chapel

Racine

Wisconsin

Name of Property

County and State

**Additional Documentation**

Submit the following items with the completed form:

**Continuation Sheets**

**Maps** A USGS map (7.5 or 15 minute series) indicating the property's location.  
A sketch map for historic districts and properties having large acreage or numerous resources.

**Photographs** Representative black and white photographs of the property.

**Additional Items** (Check with the SHPO or FPO for any additional items)

**Property Owner**

(Complete this item at the request of SHPO or FPO.)

name/title	date
organization	telephone
street & number	zip code
city or town	state

**Paperwork Reduction Act Statement:** This information is being collected for applications to the National Register of Historic Places to nominate properties for listing or determine eligibility for listing, to list properties, and to amend existing listings. Response to this request is required to obtain a benefit in accordance with the National Historic Preservation Act, as amended (16 U.S.C. 470 et seq.).

**Estimated Burden Statement:** Public reporting burden for this form is estimated to average 18.1 hours per response including time for reviewing instructions, gathering and maintaining data, and completing and reviewing the form. Direct comments regarding this burden estimate or any aspect of this form to the Chief, Administrative Services Division, National Park Service, P.O. Box 37127, Washington, DC 20013-7127; and the Office of Management and Budget, Paperwork Reductions Projects, a

**United States Department of the Interior**  
National Park Service

**National Register of Historic Places**  
Continuation Sheet

Section 7 Page 1

Burlington Cemetery Chapel  
City of Burlington, Racine County, WI

---

**Narrative Description**

The City of Burlington lies at the confluence of the Fox and White rivers in southeastern Wisconsin. Situated on the eastern edge of the city is Burlington Cemetery, one of three cemeteries in the city. The Burlington Cemetery, which originally totaled just under 5-acres, has been enlarged considerably since its start in the mid-nineteenth century as one of the area's earliest graveyards, and today stands at a total of 25.2-acres. Presently, just over half of the cemetery's property has been platted as burial plots with mowed lawn, shade trees and other plantings, and a system of curvilinear paved driveways. The topography of the front, triangular-shaped, developed portion of the cemetery is generally flat; the rear, rectangular-shaped, undeveloped portion rises to the east to the nearby Browns Lake. The cemetery is bounded on the west by South Browns Lake Drive, on the south by a single-family residential neighborhood, on the east by Lake Street, and on the north by a multi-building apartment complex.

The Burlington Cemetery Chapel, at the far south end of the cemetery, is situated approximately 180-feet southeast from, and faces west towards, South Browns Lake Drive. This free-standing building is surrounded by the driveways, burial plots, mown lawns, and groups of shade trees that comprise the cemetery grounds and is accessed via the southernmost of the cemetery's three driveways running from the far southwest corner of the property eastward toward, and past, the chapel along the southern edge of the cemetery. On historic maps of the cemetery, this drive is referred to as Evergreen Avenue. At the front of the chapel, Evergreen Avenue is intersected by what was referred to as Oakwood Avenue, one in a series of looped roads that circle the platted portions of the cemetery in a frequently curving, picturesque arrangement.

One of only two cemetery chapels in the city, construction of the chapel began in 1921 to provide a shelter at the Burlington Cemetery for funerary gatherings. The Burlington Cemetery Chapel is a very fine and intact stone building and an excellent and rare one-story example of the Richardsonian Romanesque style identified in the Wisconsin Historical Society's *Cultural Resource Management in Wisconsin* and by Carole Rifkind in her *A Field Guide to American Architecture*. The chapel's characteristic Richardsonian Romanesque elements are its solid volume and simple form, weighty mass and rough-faced masonry construction, round arch, and gable parapets. The building also has a distinct Gothic Revival influence evident in its faux-buttress pilasters and use of the Tudor arch.

It is unknown when the building stopped serving the function as a chapel and shelter house and began use as a storage and maintenance building for the cemetery grounds. In the past, the chapel has received decreased maintenance from its owners. Consequently, the building's condition and disrepair have begun to negatively affect its integrity.

**United States Department of the Interior**  
National Park Service

**National Register of Historic Places**  
Continuation Sheet

Section 7 Page 2

Burlington Cemetery Chapel  
City of Burlington, Racine County, WI

---

**Building Description**

The chapel is rectilinear in plan, one story in height, and consists of a 20-foot-wide by 30-foot-deep main block flanked on both sides by an 8-foot-wide arcade which runs the full length of the building. The chapel's exterior is entirely clad with a light colored, rusticated stone and encircled by a slightly projecting, matching stone base. The main block is covered by a moderately pitched front gabled roof clad in green glazed terra cotta or clay tiles with minimal overhang; the two arcades are covered by flat roofs with minimal overhang.

The building's 36-foot-wide west-facing façade is its principal elevation. The oversized main entrance is centered in this symmetrical façade. The main entrance opening still contains its original pair of two-panel, wooden entrance doors. Both upper and lower panels of these doors are infilled with vertical tongue-and-groove wood boards; the upper panels feature segmental arched tops. A half-circle transom window above the door has been covered with vertical wooden clapboards on the exterior face as several of its glass panes have been broken and subsequently removed. However, from the interior, the half-circle frame is divided vertically into four parts. While the mullions of the two central panes are missing, their flanking panes containing a rectangular grid of 11 lights remain intact. Outlining the entry's masonry opening are slightly projecting stone quoins, vouissoirs, and a keystone. On each corner of the main block is a short and wide, buttress-like, coursed stone pilaster that is topped with stone coping and globe-shaped finial. The front wall rises above the gabled roofline becoming a sloped parapet with stepped ends that are capped with a stone coping and culminate with a stone, globe-shaped finial at its apex.

Both north- and south-facing sides feature arcades that run the full length of the building and consist of four wide, square, coursed stone columns with matching, buttress-like pilasters at the corners. Between each column is a wooden lintel that is shaped in the form of a Tudor arch and trimmed with wooden crown molding. The wooden lintels and molding at each location are in various states of deterioration. The tops of the columns rise above the height the arcade's flat roof and are capped with stone coping and the same stone, globe-shaped finials. The finials on the north façade have all been removed, but three of the four finials on the south façade remain. Both side walls of the main block are divided into three bays, corresponding to the openings of the arcade. The front bay of each side features a single, rectangular, wooden, 16-light awning window with heavy stone still; the exterior of these openings on both sides of the building has been covered with plywood. The middle and rear bays on both sides feature a single, wooden door. These two-panel doors, feature a lower panel infilled with vertical tongue-and-groove boards and a glazed, 12-light upper panel with pointed top. Similar to the window openings, the glazed panels on these doors have been covered with plywood on the exterior.



**United States Department of the Interior**  
National Park Service

**National Register of Historic Places**  
Continuation Sheet

Section 7 Page 3

Burlington Cemetery Chapel  
City of Burlington, Racine County, WI

---

On the rear, east-facing elevation are two, symmetrically-placed, single, rectangular window openings with stone sills. It is believed that the original wooden sashes, which would have matched those on the sides, have been removed as the openings are now infilled with plywood. On both corners are a short and wide, buttress-like, coursed stone pilaster topped with stone coping and globe-shaped finial. The south finial is still intact while the north finial is missing. Like the front, the rear wall rises above the gabled roofline becoming a sloped parapet with stepped ends that are capped with stone coping. The peak of the rear, sloped parapet is interrupted by a stone-capped chimney flush with the rear wall.

It is believed that the original floor plan configuration of the main block contained two rooms: a chapel measuring 18-feet wide by 20-feet deep at the front (west) and a storage or work room measuring 18-feet wide by 8-feet deep at the rear (east). As it stands today, a portion of the wall dividing the chapel and the storage or work room has been removed, as has the original heating stove in the work room. Despite this change, the rooms retain good integrity of materials and workmanship including the original unfinished concrete floor, painted plaster walls, simple painted 1" x 4" wood trim at the doors and windows, and exposed wood rafters spaced at approximately 16" on center with simple wood board roof deck.

There have been minimal modifications and modernization over the years on the building's exterior. Some of the exterior changes, such as the boarding up of all glazing at window and door openings, can be justified as a means to secure and protect the building from vandalism and are easily reversible. Other changes, such as the missing stone finials and cracking and chipped plaster interior wall finish can be attributed to deterioration and neglect due to delayed maintenance. While these changes have begun to have an effect on the building, it still retains a high degree of integrity of materials and workmanship. It is hoped that this nomination will encourage property maintenance and open opportunities for financial support.

**United States Department of the Interior**  
National Park Service

**National Register of Historic Places**  
Continuation Sheet

Section 8 Page 1

Burlington Cemetery Chapel  
City of Burlington, Racine County, WI

---

**Narrative Statement of Significance:**

The Burlington Cemetery Chapel was first identified as potentially eligible for nomination to the National Register of Historic Places in the *Architectural & Intensive Survey of the City of Burlington* completed by Legacy Architecture, Inc. in 2012. It was identified for its late representation of the Richardsonian Romanesque style, having a high degree of integrity, and having local significance under the National Register Criterion C for Architecture. Utilizing the Wisconsin Historical Society's *Cultural Resource Management in Wisconsin*, additional research centered on evaluating the chapel utilizing the Richardsonian Romanesque style subsection of the Architecture study unit of the aforementioned text and other sources. The results of this research are detailed below and show that the Burlington Cemetery Chapel possesses local significance under National Register Criterion C as an excellent late example of the Richardsonian Romanesque style. Fine, intact examples of this style utilized for small buildings are believed to be quite rare in the state. The period of significance corresponds with the building's date of completion – 1922.

**Historic Context**

Burlington was first settled in late 1835; a dam and sawmill were constructed the following year and anchored the new settlement. Farmers, skilled tradesmen, and land speculators from New England followed soon after. The settlement, initially known as both Lower Forks and Foxville, was platted as Burlington in 1839. During the 1840s, the village prospered fueled by heavy German immigration and the opening of its first school, stores, and flour mill. Burlington quickly became the center for commerce in predominantly agricultural western Racine County. Burlington was connected to Racine with the construction of a plank road in 1848, the importance of which was eclipsed by the arrival of the first railroad in 1855. The growth of industries this spurred, most notably brewing and butter and cheese production, was slowed by the onset of the Civil War. After multiple attempts, the village finally incorporated in 1886 with a population of over 1,700 residents. Burlington experienced a second boom of development with the arrival of the Wisconsin Central Railroad in 1884. It was after this that its most influential industries were formed, including the notable manufacturers of blankets, condensed milk, metal products, and the first panoramic cameras. With a population of 2,256, Burlington incorporated as a city in 1900. The economic success of the community at this time provided the means to provide new public amenities and services, including the city's first street lights, telephone system, public water works, sewer system, street pavement, and sidewalks. The city continued to grow, reaching the population of 3,626 in 1920. The 1920s saw a second spurt of civic enhancements and amenities in Burlington, including improvements to the Burlington Cemetery and construction of its chapel in 1921-1922, founding of the city's first hospital in 1923, construction of a new city hall in 1926, and the establishment of the city's first public park in 1928. Despite a decline in manufacturing during the mid-twentieth century, the city's residential population continued to

**United States Department of the Interior**  
National Park Service

**National Register of Historic Places**  
Continuation Sheet

Section 8 Page 2

Burlington Cemetery Chapel  
City of Burlington, Racine County, WI

---

increase, reaching a population of 5,856 in 1960. Today the City of Burlington, with a population of 10,464, continues to be the largest commercial and cultural center for western Racine County.<sup>1</sup>

During the community's earliest years of settlement, burials are known to have been conducted on private land at the outskirts of the village, the earliest known gravesites being located on a hillside at the west side of the city near present-day Conkey and State streets. During the early 1840s, several families began using a burial plot on the land of Nelson R. Norton near the west banks of Browns Lake. Norton deeded this portion of his land to the Town of Burlington in 1851, making it likely the first public cemetery in Burlington. The Town expanded the cemetery in 1859 by purchasing 6.6 acres nearby along what is now South Browns Lake Drive. Improvements to the cemetery during the late nineteenth century included the planting of shade trees in 1867, the digging of a well in 1871, paving and curbs in 1879, the construction of a monument to honor the area's Civil War veterans in 1880, and the erection of a tool shed in 1891. A second, substantial expansion of the cemetery occurred around 1893, with the purchase of approximately 20 acres to the cemetery's north and east, connecting the new and old burial sites. This major expansion was platted by Racine surveyor S. G. Knight in 1896. A cemetery improvement association was formed to oversee the grounds' maintenance in 1899; the group's first act was to install curvilinear gravel drives throughout the cemetery. The Town purchased 2.8 acres to further expand the cemetery to the north in 1910.<sup>2</sup>

Following the passage of state law that enabled townships to turn over cemetery lands and maintenance to an association of lot owners, the Burlington Cemetery Association was formed in early 1911, and the Town of Burlington deeded over the cemetery in May of that year. The Burlington Cemetery Association continues to own and operate the cemetery to this day. The association immediately sought to beautify the grounds by planting over one hundred trees and shrubs.<sup>3</sup>

By the early 1920s, the association saw demand for a building to shelter funeral services at the cemetery grounds. During the association's March 1921 annual meeting, members expressed a desire to erect a shelter building within the year and began soliciting donations from lot owners to finance its construction. Later that year, the association purchased a 1.35-acre strip of land along the southern edge of the cemetery on which to erect the building. Construction began that fall, but was not complete by April of 1922, at which time the association had spent just over \$1,100 on the structure thus far. It is unknown who designed or constructed the chapel; construction was described as being done as "day work" to save thousands of dollars from initial cost estimates. No record was made of when the building was completed.<sup>4</sup>

---

<sup>1</sup> General Files. On file at the Burlington Historical Society, Burlington, Wisconsin.

<sup>2</sup> Ibid.

<sup>3</sup> Ibid.

<sup>4</sup> Ibid.

**United States Department of the Interior**  
National Park Service

**National Register of Historic Places**  
Continuation Sheet

Section 8 Page 3

Burlington Cemetery Chapel  
City of Burlington, Racine County, WI

---

Burial plots surrounding the chapel were not platted until 1938. It is unknown when the chapel's use for funeral services ceased and began being used for grounds maintenance and storage; however, the Burlington Cemetery has and still continues to be one of the most heavily used burial grounds in western Racine County, and as such, was expanded again in 1942 and 1966.<sup>5</sup>

**Architecture**

The Burlington Cemetery Chapel is locally significant in the area of Architecture as an excellent one-story example of the Richardsonian Romanesque style that maintains a high level of integrity. The Richardsonian Romanesque style section of the Architecture Study Unit of the Wisconsin Historical Society's *Cultural Resource Management in Wisconsin* dates the occurrence and popularity of the Richardsonian Romanesque style in Wisconsin from approximately 1880 to 1900. Both that text and Carole Rifkind's *A Field Guide to American Architecture* note that these buildings are characterized by rough-hewn, monochromatic masonry construction, a general massiveness, solid volumes, simple forms, and massing that emphasizes a heavy horizontal which is often offset by a vertical gable or tower. The style, developed by Henry Hobson Richardson as a free translation of Romanesque forms, features common Romanesque elements, especially round arched openings, deeply recessed door openings with moldings following the curve of the arch, towers with pyramidal roofs, round turrets, roof parapets, steeply gabled wall dormers, and columns that are exaggeratedly tall or short and thin or fat. Window openings are typically varied in size, shape, and placement and express interior spaces and functions. Ecclesiastical examples are often narrow in plan.<sup>6</sup> The Burlington Cemetery Chapel, with its symmetrical and narrow basilican plan, weighty and simple massing, rough-hewn and monochromatic masonry construction, general horizontality offset by its central gable, moderately pitched parapets, repeated arch arcade, and rounded arch entry, is essentially a late vernacular example of the style as described above. Regrettably, no information has been found on the architect or builder of chapel.

It is instructive to compare this chapel with other cemetery chapels built in southeastern Wisconsin and other Richardsonian Romanesque style buildings built in Racine County. A study of the Wisconsin Historical Society's *Architecture and History Inventory* (AHI) was undertaken to establish a context for the Burlington Cemetery Chapel and assess its NRHP potential. The results of this research show that in southeastern Wisconsin only 17 comparable cemetery buildings have been previously identified

---

<sup>5</sup> Ibid.

<sup>6</sup> Rifkind, Carole. *A Field Guide to American Architecture*. New York: New American Library, Inc., 1980; and Wyatt, Barbara (ed.) *Cultural Resource Management in Wisconsin*. Madison: Historic Preservation Division, State Historical Society of Wisconsin, 1986.

**United States Department of the Interior**  
National Park Service

**National Register of Historic Places**  
Continuation Sheet

Section 8 Page 4

Burlington Cemetery Chapel  
City of Burlington, Racine County, WI

---

via reconnaissance surveys.<sup>7</sup> The study of these buildings observes two phases of cemetery chapel construction in Wisconsin; the first being a concentrated construction of Gothic Revival style chapels at church-affiliated cemeteries during the late-nineteenth century, and, the second, the construction of period revival and eclectic style chapels at both church-affiliated and public cemeteries during the early twentieth century. The Burlington Cemetery Chapel is representative of this second era of cemetery chapel construction. The Burlington Cemetery Chapel is also a somewhat rare example of the Richardsonian Romanesque style and is one of a relatively small number of buildings in the county constructed showing the influence of the Romanesque styles. Nearly all of the examples elsewhere in southeastern Wisconsin are large-scale public, institutional or commercial buildings and date from the earlier years of the style's popularity (1880s and 1890s), making the Burlington Cemetery Chapel a unique late interpretation of the style on an atypical and uncommonly small building type.

### **Conclusion**

The Burlington Cemetery Chapel is nominated at the local level under National Register Criterion C in the area of Architecture as a fine, rare, and unique example of Richardsonian Romanesque style. Although relatively simple in its overall design and diminutive in scale, the chapel gains additional dignity from its high quality of the materials used throughout. The Burlington Cemetery Chapel is now one of Racine County's most architecturally intact historic cemetery buildings and one of a limited number of buildings in Racine County constructed in the Romanesque styles.

### **Consideration A and D**

While buildings used for religious purposes are usually not eligible for listing, an exception may be made if the significance of the building meets one of the criteria considerations. The Burlington Cemetery Chapel is a property historically used for religious purposes that derives its primary significance from architectural distinction. And, while the property is located within a cemetery and the nominated parcel contains several graves, it is not the cemetery itself that is being nominated. Rather, it is the chapel building that is nominated for its architectural significance.

### **Statement of Archeological Potential**

This area of the state, along the Fox River, was likely home to considerable Native American activities. While an archeological investigation was beyond the scope of this nomination and no information about possible prehistoric remains was found during the course of this research, it is possible that some Native American resources may still be extant within the boundaries of the

---

<sup>7</sup> *Architecture and History Inventory*. Madison: Wisconsin Historical Society. <<http://www.wisconsinhistory.org/ahi>> Accessed May 26, 2012.

**United States Department of the Interior**  
National Park Service

**National Register of Historic Places**  
Continuation Sheet

Section 8 Page 5

Burlington Cemetery Chapel  
City of Burlington, Racine County, WI

---

property. It is possible that the construction of the extant cemetery and chapel would have disturbed or completely obliterated any remaining archeological artifacts.

**Preservation Activities**

The Burlington Cemetery is home to this unique Richardsonian Romanesque chapel. While maintenance has been deferred due to lack of funds, the Burlington Cemetery Association has been proactive in protecting this historic resource from vandalism. In listing this property, the association hopes to obtain access to financial incentives to preserve and maintain the property.

**United States Department of the Interior**  
National Park Service

**National Register of Historic Places**  
Continuation Sheet

Section 9 Page 1

Burlington Cemetery Chapel  
City of Burlington, Racine County, WI

---

**Major Bibliographical References:**

Abing, Laura and Kevin Abing. "Burlington Cemetery." *Wisconsin Historical Society-Determination of Eligibility Form*. Menomonee Falls, Wisconsin: Heritage Research, Ltd., March 27, 1995.

*Architecture and History Inventory*. Madison: Wisconsin Historical Society.  
<<http://www.wisconsinhistory.org/ahi>> Accessed May 26, 2012.

General Files. On file at the Burlington Historical Society, Burlington, Wisconsin.

Lehrke, Jennifer L. and Robert Short. *Architectural & Historical Intensive Survey of the City of Burlington, Wisconsin*. Sheboygan, Wisconsin: Legacy Architecture, Inc., 2012.

Rifkind, Carole. *A Field Guide to American Architecture*. New York: New American Library, Inc., 1980.

Wyatt, Barbara (ed.) *Cultural Resource Management in Wisconsin*. Madison: Historic Preservation Division, State Historical Society of Wisconsin, 1986.

---

**United States Department of the Interior**  
National Park Service

**National Register of Historic Places**  
Continuation Sheet

Section 10 Page 1

Burlington Cemetery Chapel  
City of Burlington, Racine County, WI

---

**Verbal Boundary Description:**

The property that is the subject of this nomination consists of 1 contributing resource sited on a portion of the lot associated with 701 South Browns Lake Drive in the City of Burlington, Wisconsin, as described as follows:

The northern and western boundaries of the portion referenced in this nomination are the southern and eastern edges of pavement of the curving cemetery drive referred to as Oakwood Avenue, and the southern boundary is the north edge of pavement of the east-west cemetery drive referred to as Evergreen Avenue. The eastern boundary is defined by the closest line of headstones of the adjacent platted section of burial plots.

The boundary for the Burlington Cemetery Chapel is clearly delineated on the accompanying sketch map. This boundary encloses an area of approximately 0.01 acres.

**Boundary Justification:**

The boundary encloses a 0.01-acre area that immediately surrounds the chapel. While the boundaries described above include a handful of platted burial plots, any headstones or grave markers present have not been considered as resources for the purpose of this nomination, and have not been included in the resource count because of their small size and scale. The portions of the cemetery outside of these boundaries are comprised of individual burial plots and considered extraneous for the purpose of this nomination, lacking significant connection to the chapel itself.



**United States Department of the Interior**  
National Park Service

**National Register of Historic Places**  
Continuation Sheet

Section photos Page 1

Burlington Cemetery Chapel  
City of Burlington, Racine County, WI

---

<b>Name of Property:</b>	<b>Burlington Cemetery Chapel</b>
<b>City or Vicinity:</b>	<b>City of Burlington</b>
<b>County:</b>	<b>Racine County</b>
<b>State:</b>	<b>Wisconsin</b>
<b>Name of Photographer:</b>	<b>Jennifer L. Lehrke, AIA, LEED AP</b>
<b>Date of Photographs:</b>	<b>June 29, 2012</b>
<b>Location of Original Digital Files:</b>	<b>Legacy Architecture, Inc. 529 Ontario Avenue, Suite FN1 Sheboygan, Wisconsin 53081</b>

Photo #1 (WI\_RacineCounty\_BurlingtonCemeteryChapel\_0001)  
General View, camera facing northeast.

Photo #2 (WI\_RacineCounty\_BurlingtonCemeteryChapel\_0002)  
West Façade, camera facing east.

Photo #3 (WI\_RacineCounty\_BurlingtonCemeteryChapel\_0003)  
North Façade, camera facing south.

Photo #4 (WI\_RacineCounty\_BurlingtonCemeteryChapel\_0004)  
West Façade, camera facing east.

Photo #5 (WI\_RacineCounty\_BurlingtonCemeteryChapel\_0005)  
General View, camera facing northwest.

Photo #6 (WI\_RacineCounty\_BurlingtonCemeteryChapel\_0006)  
South Façade, camera facing north.

Photo #7 (WI\_RacineCounty\_BurlingtonCemeteryChapel\_0007)  
Main Entry Door, camera facing east.

Photo #8 (WI\_RacineCounty\_BurlingtonCemeteryChapel\_0008)  
Side Entry Door from exterior, camera facing north.

Photo #9 (WI\_RacineCounty\_BurlingtonCemeteryChapel\_0009)  
Side Entry Door from interior, camera facing south.

**United States Department of the Interior**  
National Park Service

**National Register of Historic Places**  
Continuation Sheet

Section photos Page 2

Burlington Cemetery Chapel  
City of Burlington, Racine County, WI

---

Photo #10 (WI\_RacineCounty\_BurlingtonCemeteryChapel\_0010)  
Side Window from exterior, camera facing north.

Photo #11 (WI\_RacineCounty\_BurlingtonCemeteryChapel\_0011)  
Side Window from interior, camera facing south.

Photo #12 (WI\_RacineCounty\_BurlingtonCemeteryChapel\_0012)  
Interior View, camera facing west.

**United States Department of the Interior**  
**National Park Service**

**National Register of Historic Places**  
**Continuation Sheet**

Section sketch map Page 1

Burlington Cemetery Chapel  
City of Burlington, Racine County, WI

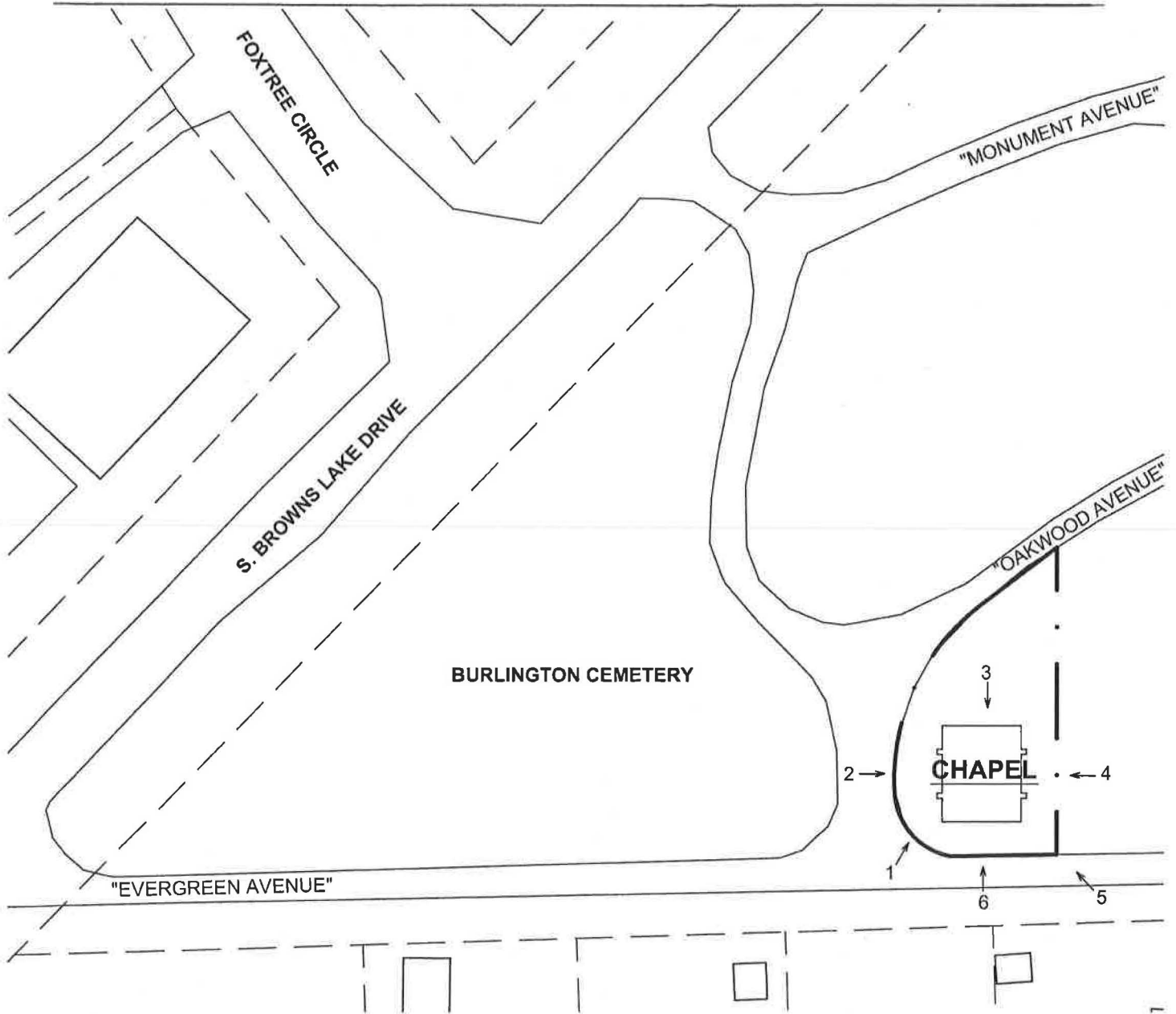

**LEGEND**

- — — — — PROPERTY LINE
- - - - - NRHP BOUNDARY
- 1 → PHOTO NUMBER & VANTAGE POINT

**SKETCH MAP**

- ↑ (North Arrow)
- 0 10 30 50 FT (Scale Bar)
- AUGUST 17, 2012

United States Department of the Interior  
National Park Service

National Register of Historic Places  
Continuation Sheet

Section sketch plan Page 1

Burlington Cemetery Chapel  
City of Burlington, Racine County, WI

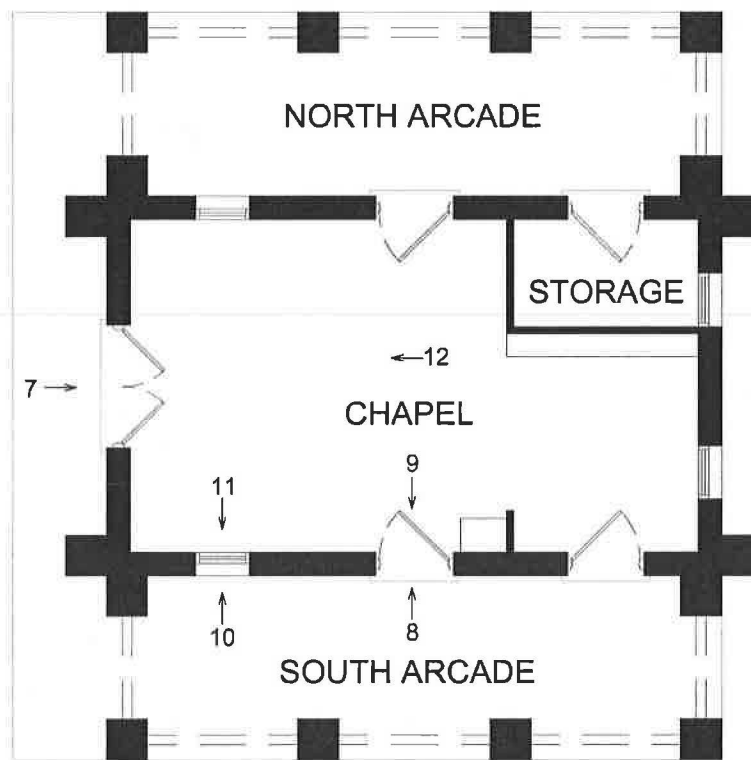

**LEGEND**

1 → PHOTO NUMBER & VANTAGE POINT

**FLOOR PLAN**

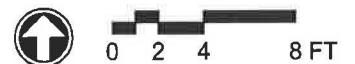

AUGUST 17, 2012







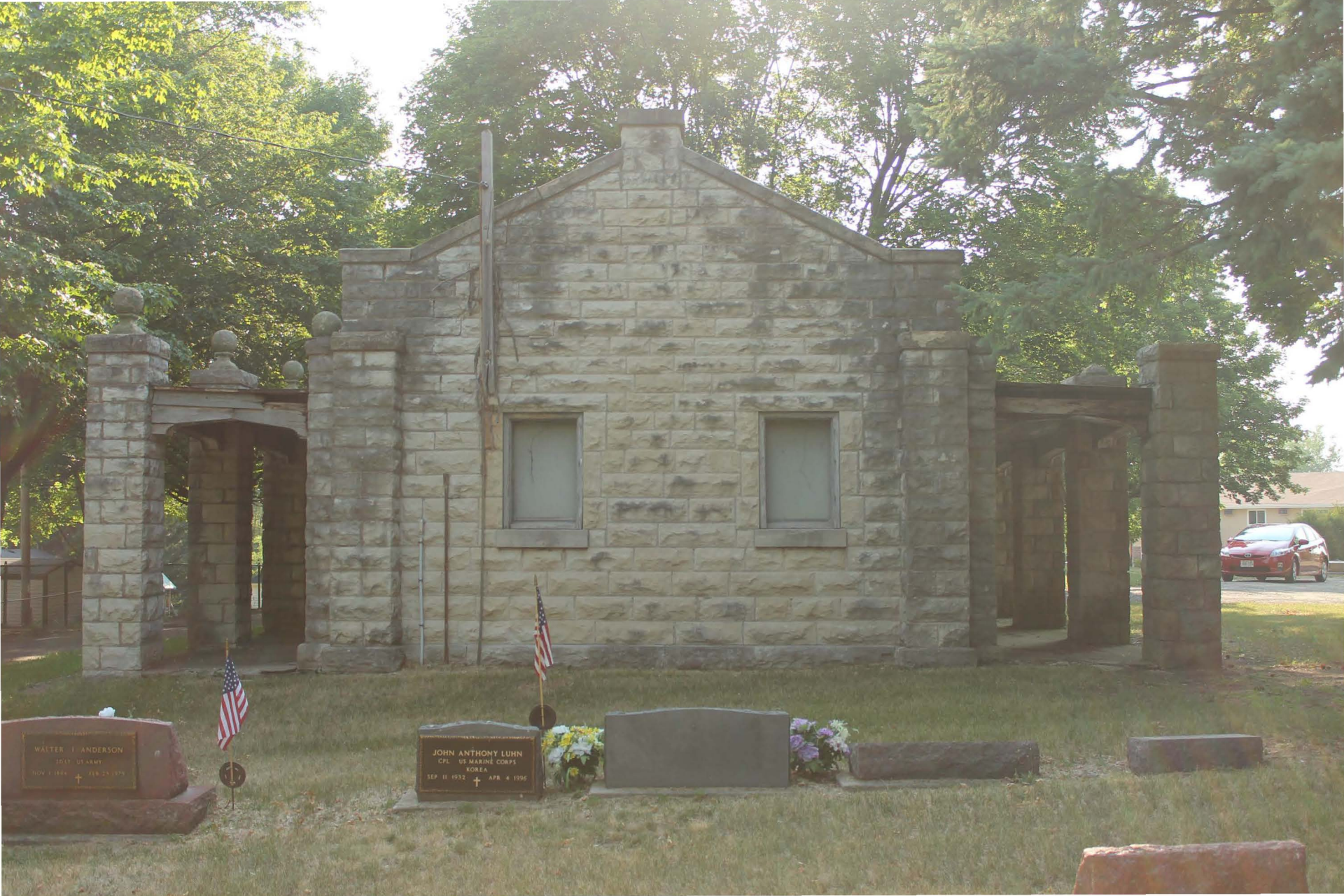

WALTER I. ANDERSON  
101st US ARMY  
NOV 9 1924 + FEB 23 1979

JOHN ANTHONY LUHN  
CPL. US MARINE CORPS  
KOREA  
SEP 11 1932 + APR 4 1990















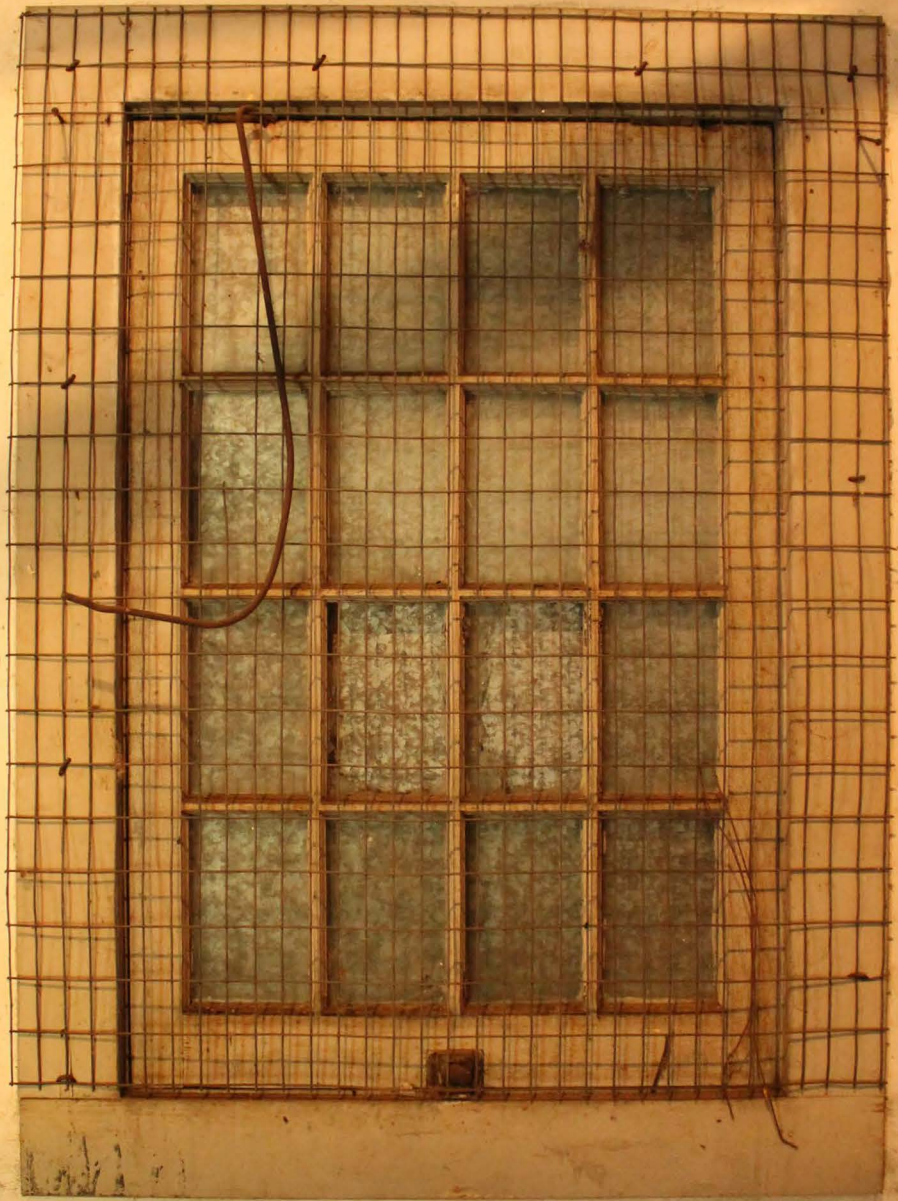





UNITED STATES DEPARTMENT OF THE INTERIOR  
NATIONAL PARK SERVICE

NATIONAL REGISTER OF HISTORIC PLACES  
EVALUATION/RETURN SHEET

REQUESTED ACTION: NOMINATION

PROPERTY Burlington Cemetery Chapel  
NAME:

MULTIPLE  
NAME:

STATE & COUNTY: WISCONSIN, Racine

DATE RECEIVED: 8/23/13 DATE OF PENDING LIST: 9/19/13  
DATE OF 16TH DAY: 10/04/13 DATE OF 45TH DAY: 10/09/13  
DATE OF WEEKLY LIST:

REFERENCE NUMBER: 13000824

REASONS FOR REVIEW:

APPEAL: N DATA PROBLEM: N LANDSCAPE: N LESS THAN 50 YEARS: N  
OTHER: N PDIL: N PERIOD: N PROGRAM UNAPPROVED: N  
REQUEST: N SAMPLE: N SLR DRAFT: N NATIONAL: N

COMMENT WAIVER: N

ACCEPT  RETURN  REJECT 10.9.13 DATE

ABSTRACT/SUMMARY COMMENTS:

**Entered in  
The National Register  
of  
Historic Places**

RECOM./CRITERIA \_\_\_\_\_

REVIEWER \_\_\_\_\_ DISCIPLINE \_\_\_\_\_

TELEPHONE \_\_\_\_\_ DATE \_\_\_\_\_

DOCUMENTATION see attached comments Y/N see attached SLR Y/N

If a nomination is returned to the nominating authority, the nomination is no longer under consideration by the NPS.



WISCONSIN  
HISTORICAL  
SOCIETY



**TO:** Keeper  
National Register of Historic Places

**FROM:** Daina Penkiunas

**SUBJECT:** National Register Nomination

The following materials are submitted on this 16th day of August 2013,  
for nomination of the Burlington Cemetery Chapel to the National Register of  
Historic Places:

1 Original National Register of Historic Places nomination form

           Multiple Property Nomination form

1 CD with electronic images

12 Photograph(s)

1 Original USGS/NOAA map(s)

2 Sketch map(s)/figure(s)/exhibit(s)

           Piece(s) of correspondence

           Other \_\_\_\_\_

**COMMENTS:**

           Please insure that this nomination is reviewed

           This property has been certified under 36 CFR 67

           The enclosed owner objection(s) do \_\_\_\_\_ do not \_\_\_\_\_  
constitute a majority of property owners.

           Other: \_\_\_\_\_