

MASSACHUSETTS HISTORICAL COMMISSION
294 Washington Street, Boston, MA 02108

Town Stoneham

Address 68 Pleasant St.

Historic Name Charles Buck House

Use: Original residence

Present residence

Ownership: Private individual Thomas E. Treacy,
Private organization O'Connor,
Trustees STVN Realty Trust

Public _____

Original owner Charles Buck

PHOTO (3x3" or 3x5", black & white)
Staple to left side of form
Photo number _____

DESCRIPTION:

Date ca. 1880

Source map research

Style Italianate

Architect unknown

Exterior wall fabric aluminum

Outbuildings weathered clapboard barn at rear

Major alterations (with dates) siding

Moved no Date N/A

Approx. acreage 18,058 sq. feet

Setting mid-late 19th century residential

Boston North Quad 1:25,000
UTM: 19 327930 4704910

SKETCH MAP

Draw map showing property's location in relation to nearest cross streets and other buildings or geographical features. Indicate north.



Carole Zellie

Recorded by (ed. Candace Jenkins, MHC)

Organization Landscape Research

Date May 1979

Assessor's Map #13-140

ARCHITECTURAL SIGNIFICANCE (describe important architectural features and evaluate in terms of other buildings within community)

The Charles Buck House is a good example of a traditional form Italianate house with a three bay facade consisting of center entry flanked by bay windows. Although this example has been sided, it preserves an intact setting in the town's original settlement area. Constructed c. 1880, the Buck House is a two story structure with a steep pitched roof and twin interior chimneys. Windows are headed by projecting lintels and contain 2/2 sash. The entry contains double doors and is protected by a porch which connects the two bays. The house faces west at the intersection of Pleasant and Summer Streets and occupies a hilly tread lot with a granite retaining wall.

HISTORICAL SIGNIFICANCE (explain the role owners played in local or state history and how the building relates to the development of the community)

The Charles Buck House possesses integrity of location, design, setting, materials and workmanship. It is significant as an example of the Italianate style, for its associations with local businessman Charles Buck and for its location in the early town center. It meets criterion A of the National Register of Historic Places.

Charles Buck was a businessman in Stoneham from the Civil War years until the 1890s. His wholesale hide business was conducted in Boston, but he maintained a store in Central Square, Stoneham, for the meat and provision trade. Buck's residence is of the gable-roofed, double-bay Italianate type seen throughout the town. The barn is a beautifully weathered structure, now part of another building lot with a turn-of-the-century two-flat in front of it.

The Charles Buck House stands on property originally belonging to the Gould family. The first meeting house (1726) and school (ca. 1718) were built on this site. The meeting house stood slightly in front of the present Buck House.

BIBLIOGRAPHY and/or REFERENCES

United States Department of the Interior
National Park Service

National Register of Historic Places
Inventory—Nomination Form

For NPS use only

received 2/28/84

date entered

Continuation sheet

Item number

Page 1 of 7

Multiple Resource Area
Thematic Group

dnr-11

Name Stoneham Multiple Resource Area
State Middlesex County, MASSACHUSETTS

Nomination/Type of Review

Date/Signature

- | | | | |
|--------------------------------------|---|-------------------------------|------------------------------|
| 1. Lang, William Bailey, House | Substantive Review
DOE/OWNER OBJECTION | Determined Eligible
Keeper | <u>Neil Drugel</u> 4/13/84 |
| 2. Martin-Maxwell Estate | Substantive Review
DOE/OWNER OBJECTION | Determined Eligible
Keeper | <u>Neil Drugel</u> 4/13/84 |
| 3. Sweetser, Warren, House | Substantive Review
DOE/OWNER OBJECTION | Determined Eligible
Keeper | <u>Neil Drugel</u> 4/13/84 |
| 4. Almshouse | Entered in the
National Register | Keeper | <u>Delores Byers</u> 4/13/84 |
| 5. Beard, Padilla, House | Entered in the
National Register | Keeper | <u>Delores Byers</u> 4/13/84 |
| 6. Boston and Main
Railroad Depot | Entered in the
National Register | Keeper | <u>Delores Byers</u> 4/13/84 |
| 7. Bottume, John, House | Entered in the
National Register | Keeper | <u>Delores Byers</u> 4/13/84 |
| 8. Brown, C. H., Cottage | Entered in the
National Register | Keeper | <u>Delores Byers</u> 4/13/84 |
| 9. Bryant, William, Octagon
House | Entered in the
National Register | Keeper | <u>Delores Byers</u> 4/13/84 |
| 10. Buck, Charles, House | Entered in the
National Register | Keeper | <u>Delores Byers</u> 4/13/84 |

NATIONAL REGISTER OF HISTORIC PLACES
EVALUATION/RETURN SHEET

Buck, Charles, House (Stoneham MRA)
Middlesex County
MASSACHUSETTS

Working No. FEB 28 1984
Fed. Reg. Date: 2/5/85
Date Due: 3-29-84 - 4-13-84
Action: ACCEPT 4-13-84
 RETURN
 REJECT
Entered in the National Register
Federal Agency: _____

- resubmission
- nomination by person or local government
- owner objection
- appeal

Substantive Review: sample request appeal NR decision

Reviewer's comments:

Recom./Criteria _____
Reviewer _____
Discipline _____
Date _____
_____ see continuation sheet

Nomination returned for: _____ technical corrections cited below
_____ substantive reasons discussed below

1. Name

2. Location

3. Classification

Category	Ownership Public Acquisition	Status Accessible	Present Use
----------	---------------------------------	----------------------	-------------

4. Owner of Property

5. Location of Legal Description

6. Representation in Existing Surveys

Has this property been determined eligible? yes no

7. Description

Condition

- excellent
- good
- fair
- deteriorated
- ruins
- unexposed

Check one

- unaltered
- altered

Check one

- original site
- moved date _____

Describe the present and original (if known) physical appearance

- summary paragraph
- completeness
- clarity
- alterations/integrity
- dates
- boundary selection

8. Significance

Period Areas of Significance—Check and justify below

Specific dates Builder/Architect
Statement of Significance (*in one paragraph*)

- summary paragraph
- completeness
- clarity
- applicable criteria
- justification of areas checked
- relating significance to the resource
- context
- relationship of integrity to significance
- justification of exception
- other

9. Major Bibliographical References

10. Geographical Data

Acreage of nominated property _____
Quadrangle name _____
UTM References _____

Verbal boundary description and justification

11. Form Prepared By

12. State Historic Preservation Officer Certification

The evaluated significance of this property within the state is:

____ national ____ state ____ local

State Historic Preservation Officer signature

title date

13. Other

- Maps
- Photographs
- Other

Questions concerning this nomination may be directed to _____

Signed _____ Date _____ Phone: _____



Buck, Charles, Hens

Greenham NRA, Ma

9250

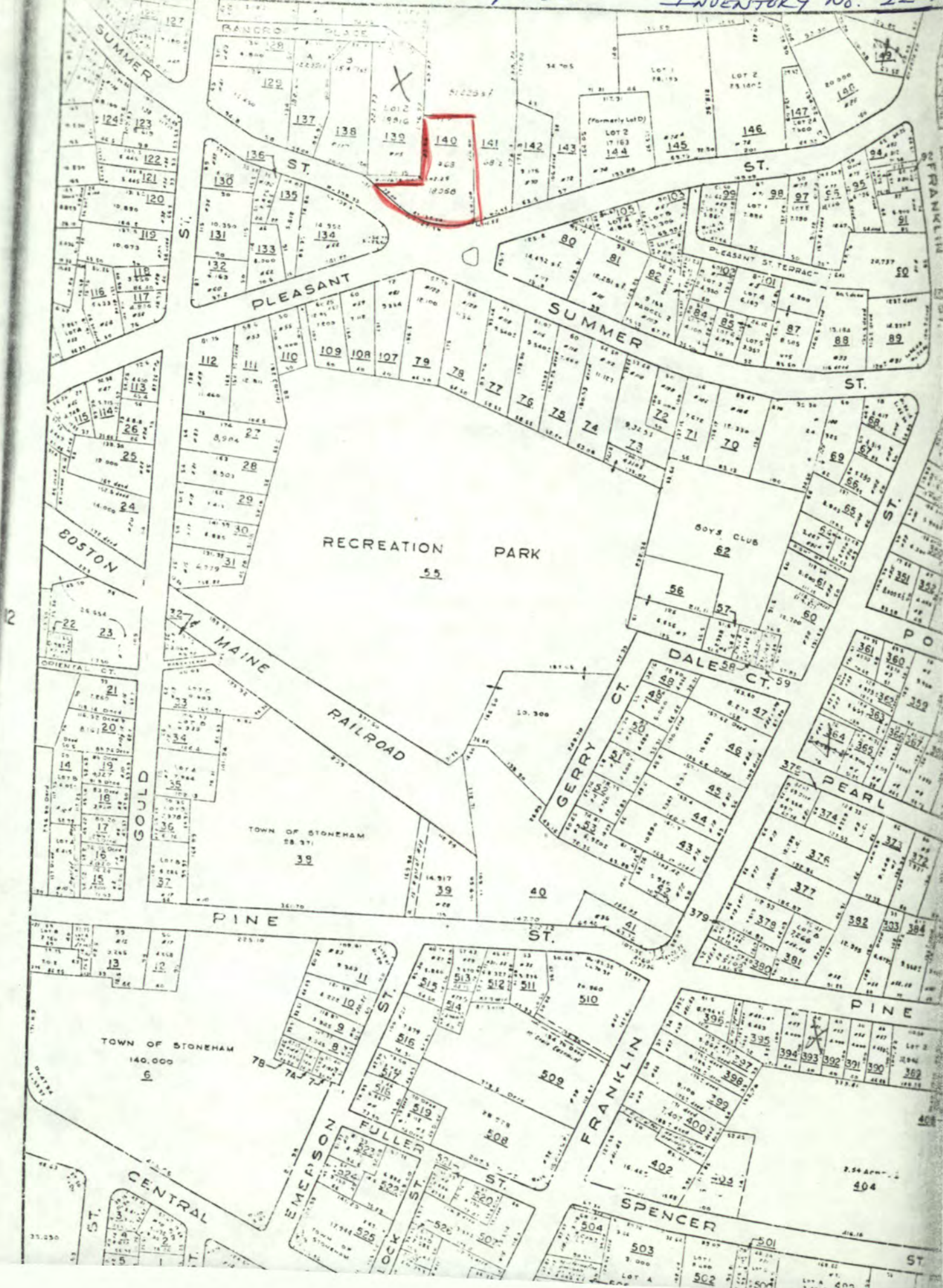

Please refer to the map in the
Multiple Property Cover Sheet
for this property

Multiple Property Cover Sheet Reference Number: 64000295