

PH0502049

DATA SHEET

UNITED STATES DEPARTMENT OF THE INTERIOR
NATIONAL PARK SERVICE

FOR NPS USE ONLY	
RECEIVED	AUG 8 1977
DATE ENTERED	APR 20 1978

**NATIONAL REGISTER OF HISTORIC PLACES
INVENTORY -- NOMINATION FORM**

SEE INSTRUCTIONS IN *HOW TO COMPLETE NATIONAL REGISTER FORMS*
TYPE ALL ENTRIES -- COMPLETE APPLICABLE SECTIONS

1 NAME

HISTORIC

Vermilion Estate

AND/OR COMMON

Pinecrest

LOCATION

STREET & NUMBER

Valley Drive

__NOT FOR PUBLICATION

CITY, TOWN

Centerville

CONGRESSIONAL DISTRICT

STATE

Iowa

__ VICINITY OF

CODE

COUNTY

Appanoose

CODE

CLASSIFICATION

CATEGORY

- DISTRICT
- BUILDING(S)
- STRUCTURE
- SITE
- OBJECT

OWNERSHIP

- PUBLIC
- PRIVATE
- BOTH
- PUBLIC ACQUISITION**
- IN PROCESS
- BEING CONSIDERED

STATUS

- OCCUPIED
- UNOCCUPIED
- WORK IN PROGRESS
- ACCESSIBLE**
- YES: RESTRICTED
- YES: UNRESTRICTED
- NO

PRESENT USE

- AGRICULTURE
- MUSEUM
- COMMERCIAL
- PARK
- EDUCATIONAL
- PRIVATE RESIDENCE
- ENTERTAINMENT
- RELIGIOUS
- GOVERNMENT
- SCIENTIFIC
- INDUSTRIAL
- TRANSPORTATION
- MILITARY
- OTHER:

OWNER OF PROPERTY

NAME

J.B. McConville, M.D.

STREET & NUMBER

R.R. 3

CITY, TOWN

Centerville

__ VICINITY OF

STATE

Iowa 52544

LOCATION OF LEGAL DESCRIPTION

COURTHOUSE,
REGISTRY OF DEEDS, ETC.

Appanoose County Courthouse

STREET & NUMBER

CITY, TOWN

Centerville

STATE

Iowa

6 REPRESENTATION IN EXISTING SURVEYS

TITLE

DATE

__FEDERAL __STATE __COUNTY __LOCAL

DEPOSITORY FOR
SURVEY RECORDS

CITY, TOWN

STATE

7 DESCRIPTION

CONDITION		CHECK ONE	CHECK ONE
<input type="checkbox"/> EXCELLENT	<input type="checkbox"/> DETERIORATED	<input checked="" type="checkbox"/> UNALTERED	<input checked="" type="checkbox"/> ORIGINAL SITE
<input checked="" type="checkbox"/> GOOD	<input type="checkbox"/> RUINS	<input type="checkbox"/> ALTERED	<input type="checkbox"/> MOVED DATE _____
<input type="checkbox"/> FAIR	<input type="checkbox"/> UNEXPOSED		

DESCRIBE THE PRESENT AND ORIGINAL (IF KNOWN) PHYSICAL APPEARANCE

The Vermilion estate, which dates from 1870, consists of a main house and outbuildings, set on a wooded knoll to the west of, and overlooking, the town of Centerville. The grounds immediately surrounding the house contain an apple orchard, pine, hickory, oak, and other shade trees, the profusion of greenery contributing to the character of this country house.

The house is a well-proportioned example of vernacular Italianate architecture, designed by Burlington architect C.A. Dunham. It is of frame construction, with a hipped roof and stone foundation, 44' wide and 52' deep. There are three brick chimneys, now covered in cement. The basically rectangular plan was extended in the rear shortly after the original construction.

A variety of detail characterizes the house. Paired brackets with decorative jigsaw work support the side eaves. While the cornice frieze in the rear is plain, that of the main block is denticular. First-floor windows are taller than those of the second story, with 2/2 lights in flat-headed box frames and bracketted hoods. Second-floor windows (also 2/2) have curved heads and plain wooden hoods. On the south side is a bay, with similar bracketting and cornicework. The main entrance porch is likewise detailed, and supported by square, slender wooden posts. The door itself is tall and narrow.

The rear section is rather simpler than the main block, with single pendant brackets and flat-headed windows lacking hoods. There is a small veranda on the west side.

Interior decorative features date from the original construction, including a quarter-turn walnut staircase, panelled doors (some with etched glass), dining-room fireplace, two chandeliers and several "beehive" light fixtures.

In close proximity to the house are six other structures, three of which ("gazebo", barn and granary) were built during the decade 1870-80 and are thus associated with the first owner of the estate. Other structures are a garage (ca. 1910), playhouse (ca. 1920), and chicken house (1942). While none of these buildings is architecturally significant, the first three may be considered important through their association with the original estate.

The "gazebo" is a small, square, hipped-roof structure, with corner posts and lattice walls. Detail is provided in the curved, keystone door heads. Its location behind, rather than in front of or beside, the house, suggests that it may have originally been a work area for a summer kitchen. The barn is typical of its kind, of board-and-batten construction below a wide gable roof with a shed extension. The granary is straightforward, with a gable roof, horizontal siding (vertical in the gable ends), and wooden grain bins on either side of a wide "drive-through". Although these latter two buildings are weatherbeaten, they are structurally sound.

The entire estate comprises 26 acres, mostly wooded pastureland. The main house and outbuildings are within an area approximately 400' x 300' (see diagram). The 26 acres included in this nomination are all that are left of Vermilion's original estate. While they have no major significance, they are an integral part of the historical and environmental character of the estate.

UNITED STATES DEPARTMENT OF THE INTERIOR
NATIONAL PARK SERVICE

**NATIONAL REGISTER OF HISTORIC PLACES
INVENTORY -- NOMINATION FORM**

FOR NPS USE ONLY	
RECEIVED	FEB 10 1978
DATE ENTERED	APR 26 1978

Vermilion Estate, Centerville vic., Appanoose County, Iowa

CONTINUATION SHEET

ITEM NUMBER 7 PAGE 1

Boundary/acreage discussion:

The 26 acres included in this nomination may be justified on two points. First, the Vermilion Estate is not an in-town property, but a type of agricultural complex, albeit on a rather small scale. At least part of the Vermilions' livelihood was made through agriculture, probably in livestock or horses with cultivation limited primarily to feed crops. Without grazing land, there would have been no use for a barn or granary: thus the acreage of woods and pasture is a principal element in the historical and environmental character of the Vermilion Estate.

The second point is rather weaker, but worthy of consideration. Vermilion's landholdings were originally over 40 acres. Through the years, sections have passed into other ownership: 11 acres are in corn and there are a few small acreages with new (or comparatively new) residences. The 26 acres included in this nomination comprise the intact remains of Vermilion's land and thus on grounds of historical association might properly be included in the National Register.

8 SIGNIFICANCE

PERIOD	AREAS OF SIGNIFICANCE -- CHECK AND JUSTIFY BELOW			
<input type="checkbox"/> PREHISTORIC	<input type="checkbox"/> ARCHEOLOGY-PREHISTORIC	<input type="checkbox"/> COMMUNITY PLANNING	<input type="checkbox"/> LANDSCAPE ARCHITECTURE	<input type="checkbox"/> RELIGION
<input type="checkbox"/> 1400-1499	<input type="checkbox"/> ARCHEOLOGY-HISTORIC	<input type="checkbox"/> CONSERVATION	<input type="checkbox"/> LAW	<input type="checkbox"/> SCIENCE
<input type="checkbox"/> 1500-1599	<input checked="" type="checkbox"/> AGRICULTURE <i>LEBOVICK</i>	<input type="checkbox"/> ECONOMICS	<input type="checkbox"/> LITERATURE	<input type="checkbox"/> SCULPTURE
<input type="checkbox"/> 1600-1699	<input checked="" type="checkbox"/> ARCHITECTURE <i>2/17/78</i>	<input type="checkbox"/> EDUCATION	<input type="checkbox"/> MILITARY	<input type="checkbox"/> SOCIAL/HUMANITARIAN
<input type="checkbox"/> 1700-1799	<input type="checkbox"/> ART	<input type="checkbox"/> ENGINEERING	<input type="checkbox"/> MUSIC	<input type="checkbox"/> THEATER
<input checked="" type="checkbox"/> 1800-1899	<input type="checkbox"/> COMMERCE	<input type="checkbox"/> EXPLORATION/SETTLEMENT	<input type="checkbox"/> PHILOSOPHY	<input type="checkbox"/> TRANSPORTATION
<input type="checkbox"/> 1900-	<input type="checkbox"/> COMMUNICATIONS	<input type="checkbox"/> INDUSTRY	<input type="checkbox"/> POLITICS/GOVERNMENT	<input type="checkbox"/> OTHER (SPECIFY)
		<input type="checkbox"/> INVENTION		

SPECIFIC DATES 1870 ~~BUILDER~~/ARCHITECT C.A. Dunham (and Jordan), Burlington

STATEMENT OF SIGNIFICANCE

The Vermilion house demonstrates a very competent handling of the Italianate style as expressed in frame construction. It was designed by the Burlington firm of C.A. Dunham and Jordan. Noteworthy are the graceful proportions and fine use of detail. The whole is enhanced by the hilltop setting, with its orchard and variety of shade trees. The various outbuildings, while not significant individually, maintain the integrity of this property as a 19th-century rural estate.

The house was built for W.F. Vermilion (1830-1894), who was born in Kentucky and came to Iowa in 1857 as a physician after attending De Pauw University and Rush Medical College in Chicago. During the Civil War, he was commissioned captain in the 36th Iowa Infantry. After the war he studied for - and was admitted to - the Iowa bar, and served one term in the Iowa Senate as a Republican. The civil township of Vermilion, east of Centerville, was named after him.

9 MAJOR BIBLIOGRAPHICAL REFERENCES

- Taylor, L.L. (ed.) Past and Present of Appanoose County, Iowa. Chicago: S.J. Clarke Publishing Co., 1913.
- Thompson, Lewis S. (ed.) Biographical and Geneological History of Appanoose and Monroe Counties, Iowa. New York: Lewis Publishing Co., 1903.
- "Specifications -- Capt. W.F. Vermilion's Residence" by Dunham and Jordan, architects. (transcribed from original, copy with Division of Historic Preservation, Iowa City)

10 GEOGRAPHICAL DATA

ACREAGE OF NOMINATED PROPERTY 26 acres

UTM REFERENCES

A	<u>15</u>	<u>5109250</u>	<u>45108300</u>	B			
	ZONE	EASTING	NORTHING		ZONE	EASTING	NORTHING
C				D			

VERBAL BOUNDARY DESCRIPTION

Commencing at the SW corner of the SW $\frac{1}{4}$ SE $\frac{1}{4}$ of Section 35, T69N R18W of the 5th P.M., Appanoose County, Iowa, thence East 54.68 rods, thence north 41.16 rods, then east to the east line of the SW $\frac{1}{4}$ SE $\frac{1}{4}$ of Section 35, Twp. 69, Range 18, thence north 18.8 rods, thence west 5 feet, thence north to the north line of said 40 acres, thence west 35 feet, thence south to a point 4 rods south of the north line of said SW $\frac{1}{4}$ SE $\frac{1}{4}$ of Section 35, Twp. 69, Range 18, thence west 620 feet, thence north 198 feet, thence east 620 feet, thence north 10 feet, thence west, to the west line of the NW $\frac{1}{4}$ SE $\frac{1}{4}$ Section 35, Twp. 69, Range 18, thence south to

the place of beginning, except the coal underlying same.

LIST ALL STATES AND COUNTIES FOR PROPERTIES OVERLAPPING STATE OR COUNTY BOUNDARIES

STATE	CODE	COUNTY	CODE
STATE	CODE	COUNTY	CODE

11 FORM PREPARED BY

NAME / TITLE

J.B. McConville, M.D.

ORGANIZATION

DATE

STREET & NUMBER

TELEPHONE

R.R. 3

CITY OR TOWN

STATE

Centerville,

Iowa 52544

12 STATE HISTORIC PRESERVATION OFFICER CERTIFICATION

THE EVALUATED SIGNIFICANCE OF THIS PROPERTY WITHIN THE STATE IS:

NATIONAL

STATE

LOCAL X

As the designated State Historic Preservation Officer for the National Historic Preservation Act of 1966 (Public Law 89-665), I hereby nominate this property for inclusion in the National Register and certify that it has been evaluated according to the criteria and procedures set forth by the National Park Service.

STATE HISTORIC PRESERVATION OFFICER SIGNATURE

Alvin D. Anderson

TITLE Director, Division of Historic Preservation

DATE 8/3/77

FOR NPS USE ONLY

I HEREBY CERTIFY THAT THIS PROPERTY IS INCLUDED IN THE NATIONAL REGISTER

William H. Stutz

DATE 4/26/78

DIRECTOR, OFFICE OF ARCHEOLOGY AND HISTORIC PRESERVATION

ATTEST: *William H. Stutz*

KEEPER OF THE NATIONAL REGISTER DATE 4-13-78

KEEPER OF THE NATIONAL REGISTER

PASTURE / WOODLAND

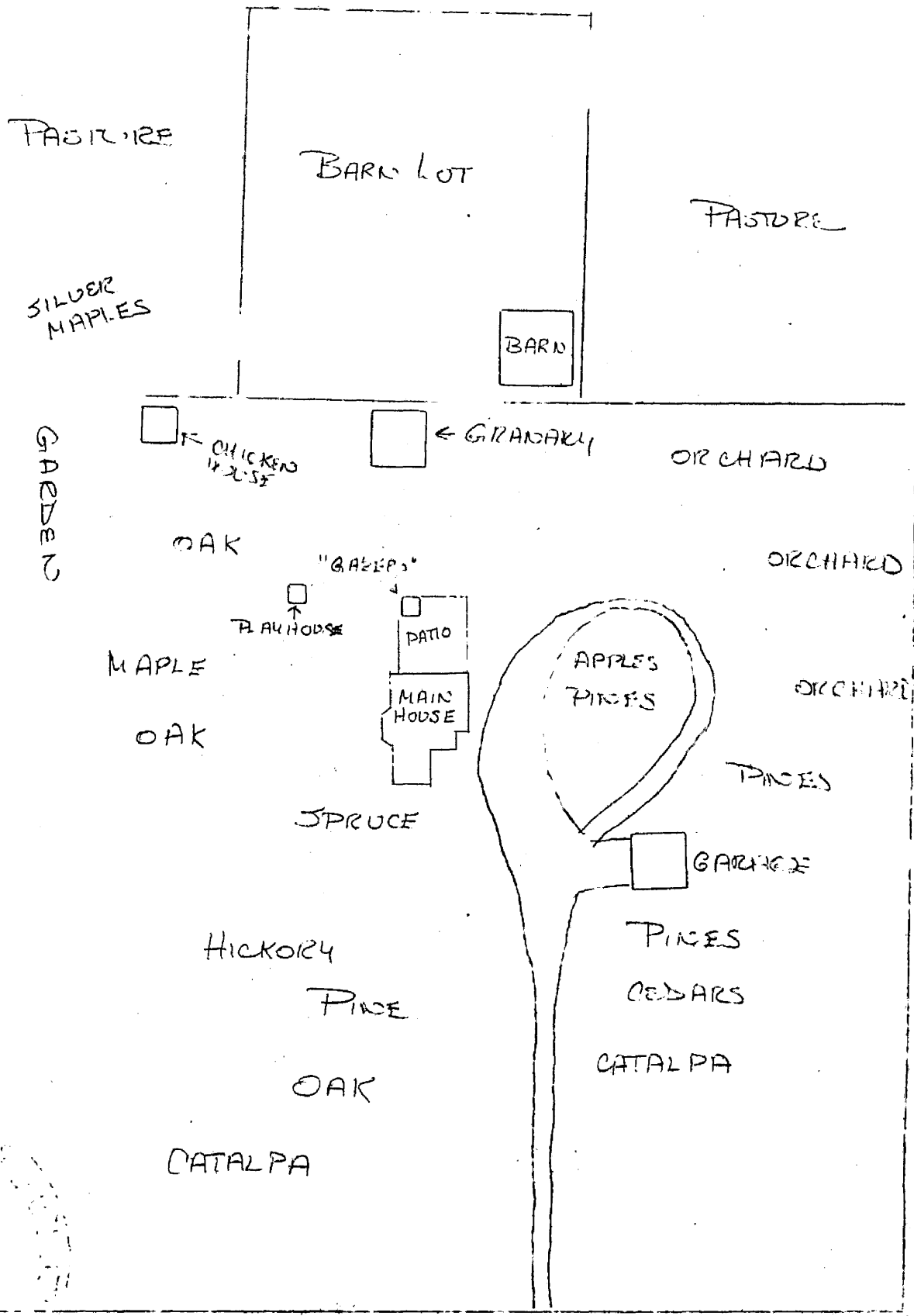

VEGETATION LISTING
 CATERPILLAR, APPROPRIATE
 DIAGRAM OF AREA CONTAINING BUILDINGS + STRUCTURES
 NEEN TO NORTH WEST + SOUTH IS WOODLAND/PASTURE
 NOT TO SCALE

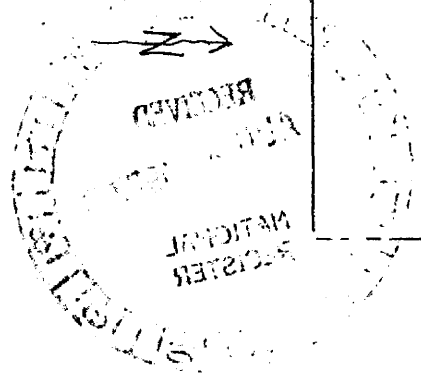

APR 1978