

25. DR. WILLIS MERIWETHER HOUSE
243 Wilson Avenue

Mr. and Mrs. Carl J. Beinert
243 Wilson Avenue
Eutaw, Alabama 35462

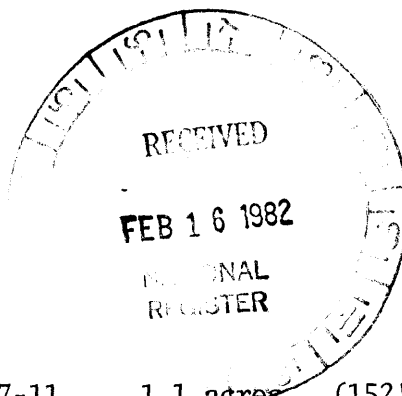

Lot #101 Tax Map: 35-18-08-33-4-7-11 1.1 acres (152' Wilson x 353')

Latitude: 32° 50' 19" Longitude: 87° 53' 17"

Reconstructed in Eutaw in 1856 Architect/builder: unknown

SIGNIFICANCE: No trace now remains of the buildings comprising the early community of Springfield in Greene County, unless it be this transplanted residence of Dr. Willis Meriwether. Thence the house has associational value as a link with another early community. More importantly, however, it is as it stands today one of a trio of 2-story houses in which square piers are used to compose a colossal order portico.

DESCRIPTION: The Meriwether house on Wilson Street is two-storied and two rooms deep, its plan and form are similar to the David R. Anthony residence (#5), only with a range of six square piers to the portico and the facade five-bayed. The roof beams are hand-adzed and would date before the erection of the house in 1856. Doors are six-paneled, following the usual early pattern (as in Washington's Mount Vernon), and flush-board dado in the southwest room belongs to the Federal period. The main staircase is unusually wide (44 1/2 inches), and curiously enough, it begins its ascent only 30 inches from the front wall of the hall. A service stairs once rose in the southwest corner of the rear hall. Existing mantels are pilastered and Greek Revival. Members of the front portico also are Greek Revival, or of the time when the house was set up on Wilson Street.

Remodeling: The house has retained most of its outer form, except that the chimneys have been removed. Inside, the back stairway and the wall that formerly separated the rear hall and northwest room have been taken out. The house is now used as a residence for the present owners, and also as a printing shop operated by Mr. Beinert. (This form was printed in the Meriwether house from type hand set by Mr. Beinert).

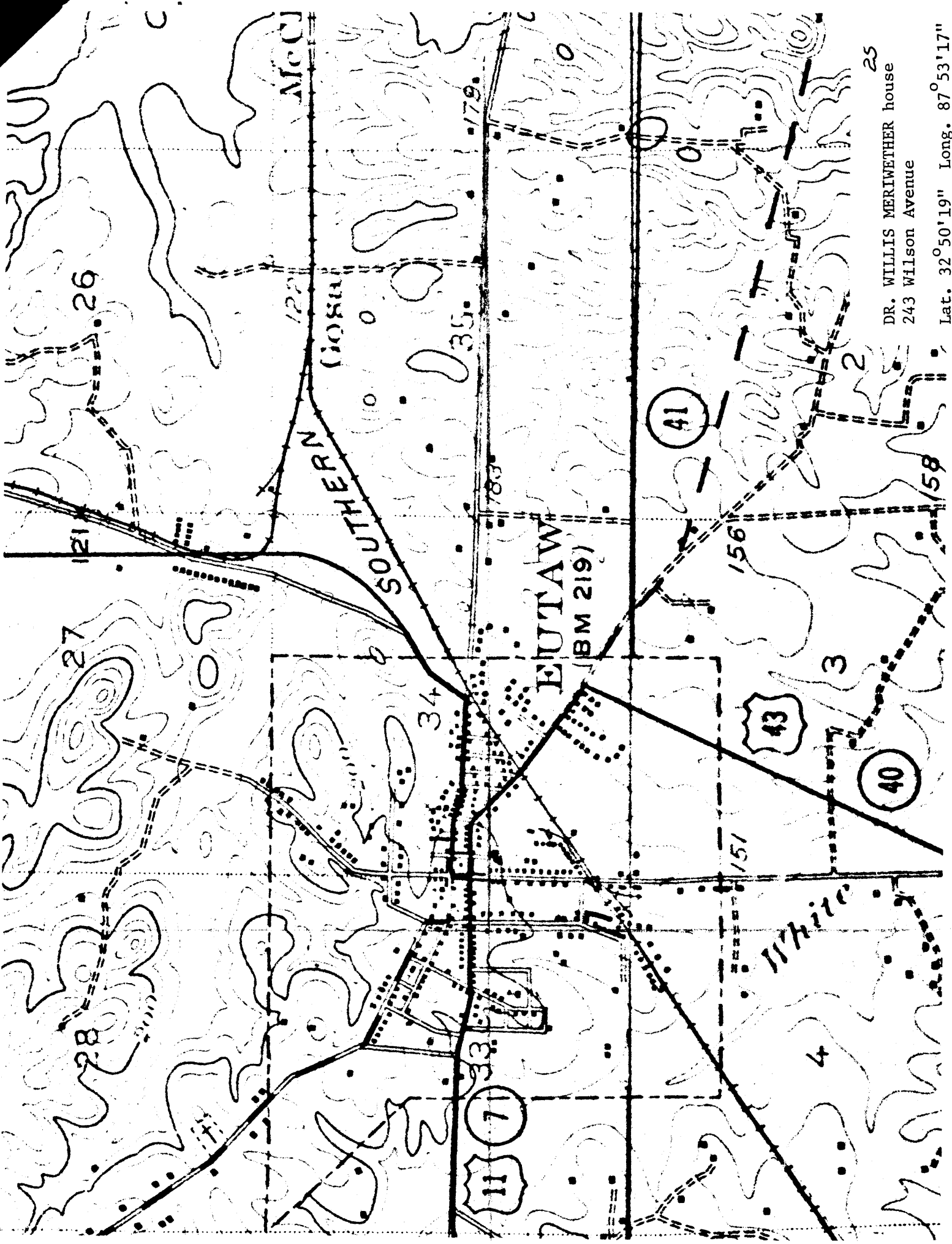

DR. WILLIS MERIWETHER house
243 Wilson Avenue
Lat. 32°50'19" Long. 87°53'17"

25

26

27

28

McCl

122

SOUTHERN COASTAL

10

34

11

7

33

35

783

179

EUTAW

(BM 219)

41

156

43

151

Wilson

4

40

3

2

58