

Davenport
Department of Community Development
Iowa Office of Historic Preservation
Dennett, Muessig & Associates, Ltd.

DAVENPORT SURVEY 1982

SITE #82-10- CJ-1102 MAP NUMBER 5
HISTORIC DISTRICT
NAME (E.A. Shaw) House ✓
ADDRESS 1102 College Ave. ✓

LEGAL DESCRIPTION Fulton's Add. to E.Dav., Blk.
4, E 55' Lot 4 & all Lot 5



ACREAGE <1 ZONE R-6M UTM 15/703840 4600430
OWNER TITLE H
Skip and Terry Willits
1102 College Ave.
Davenport, IA 52803

DESCRIPTION

ARCHITECTURAL STYLE Late Queen Anne DATE 1901
FORM 2-1/2 stories, irregular plan; hipped main roof with gables and
conical-roofed tower
MATERIALS frame on masonry foundation; extremely narrow clapboarding
FENESTRATION 1/1 d.h.s., rather wide with relation to height
FEATURES expansive veranda with paired Roman Doric columns on stone
pedestals; porte-cochere SW corner; egg and dart molding below cornice;
Palladian window in south gable; Ionic order engaged columns on 3rd stage of
semicircular corner tower
ALTERATIONS is being extensively restored, with asbestos siding removed and
new polychrome paint scheme
SITE corner lot, at crest of long hill down to river

ARCHITECTURAL SIGNIFICANCE The Shaw house is an excellent local example of the late Queen Anne style in Davenport. It offers the typical combination of Victorian asymmetry and irregularity with neoclassical detail. Another common feature of many houses of this type was their siting on corner lots, the tower emphasizing the location and giving the house additional prominence. The Shaw house is also noteworthy as a work by Gustav A. Hanssen, a local architect who had a partnership with Dietrich J. Harfst. Hanssen was particularly fond of the neoclassical idiom, as seen in his Brady Street houses (BR 2317, 2319) and his most distinguished work, the J.C. Schricker house (CV-1446). The Shaw house is definitely a worthy addition to the catalog of Hanssen's designs in Davenport.

HISTORICAL DATA

This house was built for E.A. Shaw as a family residence around 1901. Shaw held extensive timber land holdings in Minnesota and other areas. Locally, he was associated with the lumber firm of Renwick, Shaw & Crossett.

HISTORICAL SIGNIFICANCE

SOURCES John Milner Associates, East Davenport Survey, 1977
Davenport City Directories, 1900-10, 1902-3
Architectural Drawings for E. A. Shaw Residence, Gustav A. Hanssen, architect, dated 1 April, 1901; in possession of Michael Welsch, Davenport IA

ARCHITECTURAL EVALUATION

DESIGN excellent STATURE focus
LEVEL OF SIGNIFICANCE local

CONTEXT fair/good FABRIC good
DISTRICT CLASSIFICATION

HISTORICAL EVALUATION

PRIMARY THEME
LEVEL OF SIGNIFICANCE

SECONDARY THEME

NATIONAL REGISTER ELIGIBLE YES

PHOTO ID M3-10A, 1706/23-27

Martha H. Bowers, Architectural Historian

Marlys Svendsen, Historian

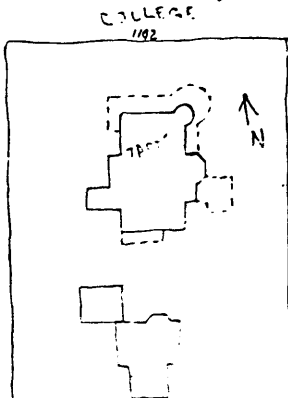

FOR DIVISION OF HISTORIC PRESERVATION USE ONLY

1 DATE RECEIVED _____

2 DATE OF STAFF EVALUATION _____

	A ARCHITECTURAL	B HISTORICAL
ELIGIBLE FOR NRHP	<input type="checkbox"/>	<input type="checkbox"/>
NOT ELIGIBLE FOR NRHP	<input type="checkbox"/>	<input type="checkbox"/>

3 NRHP ACTION

A STATE REVIEW COMM	APP <input type="checkbox"/>	DISAPP <input type="checkbox"/>	TABLED <input type="checkbox"/>	DATE _____
B FEDERAL REVIEW	APP <input type="checkbox"/>	DISAPP <input type="checkbox"/>	TABLED <input type="checkbox"/>	DATE _____

4 DHP SOURCES

<input type="checkbox"/> COUNTY RESOURCES	<input type="checkbox"/> DET OF ELIGIBILITY
<input type="checkbox"/> W SHIELD SURVEY	<input type="checkbox"/> R & C _____
<input type="checkbox"/> NRHP	<input type="checkbox"/> DAVENPORT A/H SURVEY _____
<input type="checkbox"/> GRANT _____	<input type="checkbox"/> _____

5 SUBJECT TRACES _____

6 PHOTO _____