

7/11/87

KENTUCKY HISTORIC RESOURCES INVENTORY

Site No. GN-73

1. Historic Name(s) John C. Allen House (Green Co. M.R.A.)

Original Owner John C. Allen

2. Present Name Baker House

3. Location E side KY 61; 1 M.S. of Summersville

4. Owner's Name William Milby

5. Owner's Address Route #3, Greensburg, Kentucky 42743

6. Open to Public Yes No

7. Visible from road Yes No

8. Ownership
 Private
 Local
 State
 Federal

9. Local Contact/Organization

22. ADD/County Lake Cumberland/Green 044

23. U.S.G.S. Quadrant (15'/75') G.I.S. Mod.

24. UTM Reference
 Zone Easting Northing

25. Coordinate Accuracy

26. Prehistoric Site Object
 Historic Site Structure
 (Building) Other

27. National Register District Name:

28. Significance Evaluation Eligible for National Reg. B

29. Status Date
 National Landmark
 National Register
 Landmark Certificate
 Kentucky Survey 8/15/80
 Local Landmark
 HABS/HAER

10. Site Plan with North Arrow

11. Architect

12. Builder

13. Date 1803-08 A. 2 B.

14. Style
 A. Federal B
 B.

15. Original Use Sing.Fam.Res. A

16. Present use None

17. Condition Good B

18. Description TWO-story, five-bay, brick; Flemish bond with jack arches molded watertable and string course interior chimney on W, two exterior chimneys (double shouldered) on E; narrow central enclosed stairway is original; one-room deep on W, 2 on E; original cornice; later frame addition on N; transitional mantels chairrails, splayed window reveals; 6/6 windows.

No. Stories TWO C

Single Pile NA

Double Pile

Floor Plan Sing.P./Cent.P. J

Structural Fabric Brick A. C B.

Decorative Fabric Flemish Bond A. G B.

Roof Form Gable End

(Continue on Back)

30. Historic Theme
 Primary Architecture C
 Secondary
 Other

31. Endangered Yes No

32. Preservation Project Status

Actual Cost in \$1,000s

33. ATTACH PHOTO

Roll No. _____
 Picture No. _____
 Direction _____

19. History The original land tract on which this house sits came to Nathaniel Owens in 1793. Owens sold part of the land to John Emerson in 1806, who then deeded a track to the heirs of John C. & Margaret Allen. According to an 1843 court suit, John C. Allen built the house before his death in 1808.

20. Significance Architecture: The house is one of the best examples in the county of Federal style architecture, it exhibits as well several pre-Federal features, in the brickwork and in the chimney designs.

34. Prepared by: Joe DeSpain

35. Organization Green Co. Historical Society, Inc.

36. Date 1984

37. Revision Dates _____ 38. Staff Review _____

21. Source of Information Circuit Court Suite #5751 GC Deeds 4/310; 11/48; 12/106; 12/330; 21/19; 32/274; 40/321; 70/637; 74/536.

1/11/87

KENTUCKY HISTORIC RESOURCE INVENTORY SUPPLEMENT
BOUNDARY AND LOCATION INFORMATION

Historic Property Name John C. Allen House Site # Gn-73

Multiple Resource/Thematic Nomination Title Green Co. MRA

U.T.M. Coordinates - List multiple UTMs if property is ten or more acres.

A. 16 631840 4130240 D. _____

B. _____ E. _____

C. _____ F. _____

Verbal Boundary Description _____ Acreage Approx. .5 a.

The house is centered in a domestic space with boundaries of 30' on each side. Beginning at point A on the S end of a fence line, said fence being 30' W of said house; thence E in a line 30' from said house to point B; thence N in a line 30' from said house to point C; thence W in a line 30' from said house to point D, a point in a fence line; thence along said fence to the beginning.

Sketch of Site Plan (Showing outbuildings, structures, landscape features and the site boundary as described above.)

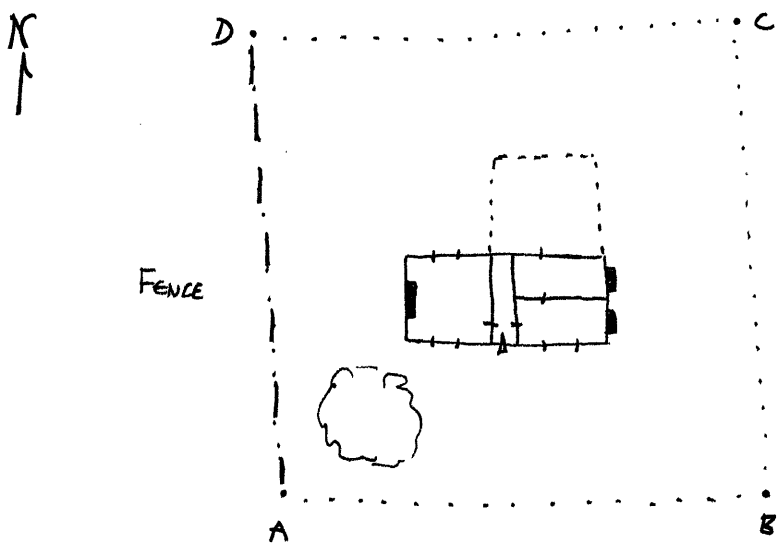

Official Courthouse Property Reference: