

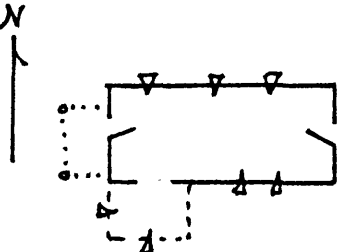

KENTUCKY HISTORIC RESOURCES INVENTORY

Site No. WS-133

1. Historic Name(s) Road Run School Original Owner Washington County		22. ADD/County Lincoln Trail/Wash. 115	
2. Present Name As above		23. U.S.G.S. Quadrant (15'/75') St. Catherine G.I.S. Mod. 0,9,8	
3. Location S. sd. Hwy 152, 8 m. SW of Springfield		24. UTM Reference 16 645450 4171210 Zone Easting Northing	
4. Owner's Name Ms. Velva Newton		25. Coordinate Accuracy	
5. Owner's Address Rt. 2, Jimtown Rd., Springfield, Ky. 40069		26. Prehistoric Site Object Historic Site Structure <u>Building</u> Other	
6. Open to Public Yes ___ No <u>X</u>	7. Visible from road Yes <u>X</u> No ___	8. Ownership Private <u>X</u> Local ___ State ___ Federal ___	
9. Local Contact/Organization Owner		27. National Register District Name N/A	
10. Site Plan with North Arrow 		28. Significance Evaluation NR <u>N</u>	
11. Architect unknown		29. Status National Landmark ___ Date ___ National Register ___ Landmark Certificate ___ Kentucky Survey ___ Local Landmark ___ HABS/HAER ___	
12. Builder unknown		30. Historic Theme Primary <u>Architecture</u> Secondary <u>Education</u> Other ___	
13. Date 1876-1900 A <u>5</u> B ___		31. Endangered Yes ___ No <u>X</u>	
14. Style A. Vernacular <u>V</u> B. ___		32. Preservation Project Status ___ Actual Cost in \$1,000s ___	
15. Original Use School <u>I</u>		33. ATTACH PHOTO 	
16. Present use Sing. fam. res. <u>B</u>		34. Prepared by: Joe DeSpain	
17. Condition Good <u>B</u>		35. Organization Green Co. Hist. Soc., Inc.	
18. Description Single bay, single story one-room school now used as residence; gable on facade decorated w/ shingles cut to create diamond effect (Continue on Back)		36. Date 5 May 1983	
19. History unknown		37. Revision Dates 1/87 38. Staff Review	
20. Significance This property is significant under criteria C & A One of few surviving rural schools in original, well-preserved condition.		39. Source of Information N/A	

KENTUCKY HISTORIC RESOURCE INVENTORY SUPPLEMENT
 BOUNDARY AND LOCATION INFORMATION

Historic Property Name Road Run School Site # WS-133

Multiple Resource/Thematic Nomination Title Washington County Multiple Resource Area

U.T.M. Coordinates - List multiple UTMs if property is ten or more acres.

A. 16 _____ D. _____
 B. _____ E. _____
 C. _____ F. _____

Verbal Boundary Description _____ Acreage 1 acre

Point A is located 240 feet east southeast of the southeast corner of the school on the west side of a driveway, from Point A thence 300 feet west along a drive and fenceline to Point B, thence 80 feet north along a fence to Point C, thence 300 feet along an imaginary line 30 feet north of the building to Point D, thence 80 feet along the west side of drive to the point of origin. The site contains one contributing building.

Sketch of Site Plan (Showing outbuildings, structures, landscape features and the site boundary as described above.)

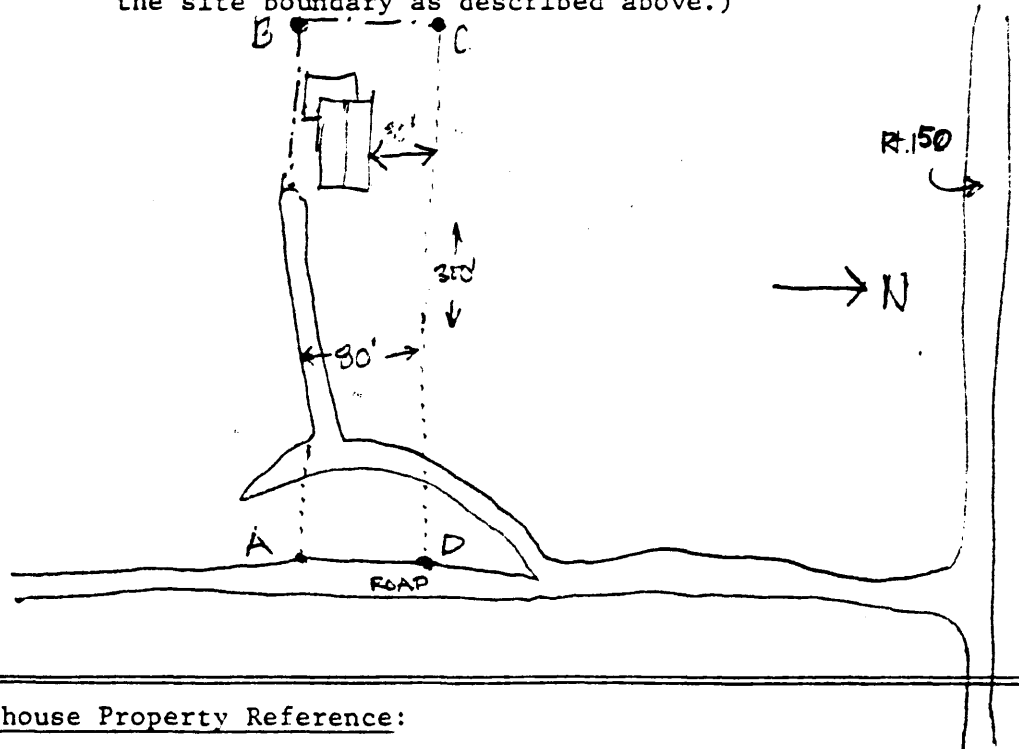

Official Courthouse Property Reference:

Washington County Courthouse, Springfield, Kentucky