

United States Department of the Interior
National Park Service

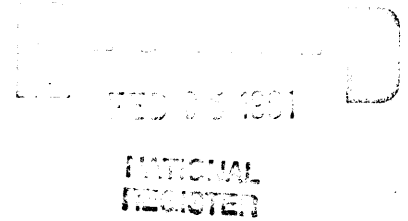

National Register of Historic Places Registration Form

This form is for use in nominating or requesting determinations of eligibility for individual properties or districts. See instructions in *Guidelines for Completing National Register Forms* (National Register Bulletin 16). Complete each item by marking "x" in the appropriate box or by entering the requested information. If an item does not apply to the property being documented, enter "N/A" for "not applicable." For functions, styles, materials, and areas of significance, enter only the categories and subcategories listed in the instructions. For additional space use continuation sheets (Form 10-900a). Type all entries.

1. Name of Property

historic name North Washington Street Historic District
other names/site number 105-055-62000

2. Location

street & number Roughly bounded by E. 10th, E. 8th, N. Walnut, and N/A not for publication
city, town N. Lincoln Streets, Bloomington N/A vicinity
state Indiana code IN county Monroe code 105 zip code 47408

3. Classification

Ownership of Property	Category of Property	Number of Resources within Property	
		Contributing	Noncontributing
<input checked="" type="checkbox"/> private	<input type="checkbox"/> building(s)	<u>35</u>	<u>3</u> buildings
<input type="checkbox"/> public-local	<input checked="" type="checkbox"/> district	<u>0</u>	<u>0</u> sites
<input type="checkbox"/> public-State	<input type="checkbox"/> site	<u>6</u>	<u>0</u> structures
<input type="checkbox"/> public-Federal	<input type="checkbox"/> structure	<u>0</u>	<u>0</u> objects
	<input type="checkbox"/> object	<u>41</u>	<u>3</u> Total

Name of related multiple property listing: N/A

Number of contributing resources previously listed in the National Register 1

4. State/Federal Agency Certification

As the designated authority under the National Historic Preservation Act of 1966, as amended, I hereby certify that this nomination request for determination of eligibility meets the documentation standards for registering properties in the National Register of Historic Places and meets the procedural and professional requirements set forth in 36 CFR Part 60. In my opinion, the property meets does not meet the National Register criteria. See continuation sheet.

Jane T. Costello 1-25-91
Signature of certifying official Date
Indiana Department of Natural Resources

State or Federal agency and bureau

In my opinion, the property meets does not meet the National Register criteria. See continuation sheet.

Signature of commenting or other official Date

State or Federal agency and bureau

5. National Park Service Certification

I, hereby, certify that this property is:

entered in the National Register. See continuation sheet.

determined eligible for the National Register. See continuation sheet.

determined not eligible for the National Register.

removed from the National Register.

other, (explain:)

Entered in the National Register
Helares Byers 3/14/91

Signature of the Keeper Date of Action

6. Function or Use

Historic Functions (enter categories from instructions)

DOMESTIC/single dwelling

DOMESTIC/secondary structure

DOMESTIC/multiple dwelling

Current Functions (enter categories from instructions)

DOMESTIC/single dwelling

DOMESTIC/secondary structure

DOMESTIC/multiple dwelling

COMMERCE/professional

COMMERCE/restaurant

7. Description

Architectural Classification

(enter categories from instructions)

Queen Anne

Classical Revival

Bungalow/Craftsman

Materials (enter categories from instructions)

foundation STONE: Limestone

walls WOOD: weatherboard

STONE: Limestone

roof Asphalt

other WOOD: shingle

BRICK

Describe present and historic physical appearance.

The North Washington Street Historic District is an outstanding collection of turn of the century houses located two blocks northeast of Bloomington's Courthouse Square. These houses, many of which have original stables or garages on the alleys, were built in the most fashionable architectural styles of their day. The district stretches along North Washington Street from just south of East Eighth Street to East Tenth Street and towards the west to include three houses on North Walnut Street. Two story residential structures surround the district to the north and east and commercial structures and surface parking lots surround the district to the south and west.

There is a slight rise in grade from the southeast to the northwest within the district. Therefore, the houses along the west side of North Washington Street and those along North Walnut Street are situated above the street level with stone retaining walls or grassy banks along the sidewalk (photographs 1, 2, 5, 7, 9, 12, and 15). Most of the houses are spaced evenly along both streets and share a common setback from the street with well landscaped front lawns and many large deciduous trees.

Of the 44 total resources, 35 are contributing buildings, 6 are contributing structures, and 3 are noncontributing buildings. The 6 contributing structures are stone retaining walls. The 3 noncontributing buildings are a garage and outbuilding built since the period of significance and a former garage that has been converted to residential use. These buildings are small in scale and sited on their respective lots so that they do not detract significantly from the district. One building is already individually listed on the National Register, and therefore is not counted. (The Morgan House at 532 North Walnut Street.)

Most of the houses in the district were built in the Queen Anne architectural style during the 1890's. Several houses were built with Queen Anne massing and Classical Revival details and a few were built in a more complete rendering of the Classical Revival style. There is also one example of the Italianate style, a few examples of the Bungalow or Craftsman architectural style and one Colonial Revival apartment building built in 1929. The majority of the primary structures are two or two and one half story, wood frame painted in various

8. Statement of Significance

Certifying official has considered the significance of this property in relation to other properties:

nationally statewide locally

Applicable National Register Criteria A B C D

Criteria Considerations (Exceptions) A B C D E F G

Areas of Significance (enter categories from instructions)

ARCHITECTURE
INDUSTRY

Period of Significance

1870 - 1929

Significant Dates

N/A

Cultural Affiliation

N/A

Significant Person

N/A

Architect/Builder

Lowe and Bollenbocher
Caldwell, Ross and George

State significance of property, and justify criteria, criteria considerations, and areas and periods of significance noted above.

The North Washington Street Historic District is significant for its embodiment of the characteristics of popular residential architectural styles of the late nineteenth and early twentieth century. The district was developed primarily by the Showers family, of the Showers Brothers furniture factory, one of Bloomington's most important industries, and is easily evaluated within the context of upper middle class neighborhoods which developed during Bloomington's turn of the century prosperity. The North Washington Street Historic District is an impressive collection of large Victorian homes, which have survived in excellent condition despite commercial encroachment from the south and west and a proliferation of student rental units to the north, east and within the district.

The North Washington Street Historic District can be evaluated according to the historic context of prestigious, upper class, residential development in Bloomington between 1889 and 1929. This time frame automatically limits the context to districts on the west and north sides of Bloomington as most housing in eastern neighborhoods were developed in and after the 1920's. Bloomington experienced a period of general growth and prosperity beginning with the boom in the limestone industry, furniture manufacturing by the Showers Brothers Company and Indiana University in the 1890's and lasting into the 1920's. The Bollman Place Addition was platted in 1889. Many of the lots were sold by the Bollman family to the Showers family and developed into what has become the North Washington Street Historic District. By 1898 the majority of lots in the district were developed.

Three other historic districts were identified in the City of Bloomington Interim Report--Indiana Historic Sites and Structures Inventory that were developed within this same time frame. However, these districts, two on the west side (West Kirkwood Historic District, 105-055-64000 and West Side Historic District, 105-055-65000) and the other on the near, southeast side (South Dunn

See continuation sheet

9. Major Bibliographical References

Blanchard, Charles, ed. Counties of Morgan, Monroe, and Brown, Indiana: Historical and Biographical. Chicago: F.A. Battey and Co., 1884.

Bloomington City Directories. Bloomington, Indiana. 1900-1940.

Bloomington Restorations, Inc. National Register of Historic Places Nomination Form, Morgan House. Indiana Division of Historic Preservation and Archaeology, 8 September 1981.

City of Bloomington Interim Report--Indiana Historic Sites and Structures Inventory. Bloomington: City of Bloomington, Indiana, February 1988.

See continuation sheet

Previous documentation on file (NPS):

- preliminary determination of individual listing (36 CFR 67) has been requested
- previously listed in the National Register
- previously determined eligible by the National Register
- designated a National Historic Landmark
- recorded by Historic American Buildings Survey # _____
- recorded by Historic American Engineering Record # _____

Primary location of additional data:

- State historic preservation office
- Other State agency
- Federal agency
- Local government
- University
- Other

Specify repository: _____

10. Geographical Data

Acreage of property 7.5 acres

UTM References

A	1,6	5,4,0,2,9,0	4,3,3,5,7,2,0
	Zone	Easting	Northing
C	1,6	5,4,0,5,0,0	4,3,3,5,4,2,0

B	1,6	5,4,0,5,0,0	4,3,3,5,7,2,0
	Zone	Easting	Northing
D	1,6	5,4,0,2,9,0	4,3,3,5,4,2,0

See continuation sheet

Verbal Boundary Description

See continuation sheet

Boundary Justification

See continuation sheet

11. Form Prepared By

name/title Cynthia Brubaker, Architectural Conservator date 30 June 1990
 organization Portfolio Design Inc. telephone 812/334-2488
 street & number 222 North College Avenue, Suite 300 state Indiana zip code 47404
 city or town Bloomington

United States Department of the Interior
National Park ServiceNational Register of Historic Places
Continuation SheetSection number 7 Page 1 North Washington Street Historic District

colors, three are brick and two are stone veneer. Six of the 22 wood frame houses have been covered with artificial siding. The Queen Anne houses feature asymmetrical massing with multi-gabled roofs, decoratively patterned shingling and elaborate barge boards and porch railings, supports and brackets. The Classical Revival influenced houses are adorned with columns, porticoes and Palladian windows. These houses display a high level of workmanship and quality of design.

The district's one example of the Italianate style as applied to residential architecture is found at 408 North Washington Street/203 East Eighth Street, built c. 1870 (photograph 12). This house displays wide eaves supported by brackets, a low-pitch hip roof, decorative window heads over tall thin windows and a recessed entry with double doors. The house served as a duplex as early as 1909 and has a small later addition on the southwest corner. It is currently divided into multiple apartments.

The North Washington Street Historic District contains several outstanding examples of the Queen Anne style. Among them are houses at 508, 514 and 522 North Washington Street and 532 North Walnut Street. The nearly identical 508 and 514 North Washington Street both have asymmetrical compositions and a variety of forms, textures and colors (photograph 6). Both were built in 1895. The variety of form is achieved by the encircling porches, multi-gabled roofs and chamfered corners. Variety of texture is achieved with diamond and fishscale shingle work and decoratively cut brackets and barge boards. The wood siding and shingles are painted in a three part scheme. The interiors of both houses retain much of the original woodwork, including carved mantels and parquet floors. The house at 522 North Washington Street, c. 1895, is similar in appearance to 508 and 514, but displays a slightly less complex overall form (photograph 3).

The Morgan House, 1892, at 532 North Walnut Street, which is individually listed on the National Register of Historic Places, is very similar in appearance to the houses described above, but achieves exterior texture through the use of carved wood panels in addition to shingles (photograph 2). The Morgan House is also in very good repair and retains much of its original woodwork and fireplaces inside. A concrete swimming pool built in the 1920's and reputed to be the first in Bloomington, is located on the southeast side of the house.

Other fine examples of the Queen Anne style in the district include 115 and 123 East Eighth Street and 420 and 515 North Washington Street (photographs 15, 11, and 7 respectively). These houses are less elaborate than those described above but, they do have asymmetrical massing, decorative shingle work and porch detail. The house at 420 North Washington Street, built c. 1890, is a one story house, the others are two stories in height (photograph 11).

United States Department of the Interior
National Park ServiceNational Register of Historic Places
Continuation SheetSection number 7 Page 2 North Washington Street Historic District

Four other examples of the Queen Anne style are found at 419, 502, 509 and 521 North Washington Street however, these houses have been covered in artificial siding, which may obscure or replace additional detail (photographs 9, 11, and 7 respectively). The house at 115 East Eighth Street cited above, has also been covered with artificial siding (photograph 15). The house at 419, c. 1890, does retain decorative porch posts, railings and brackets as well as, original tiled fireplaces with carved mantels on the inside (photograph 9).

Several houses in the district were built with the characteristic Queen Anne massing and Classical Revival details, sometimes referred to as the Free Classic style. The most outstanding example of this style in the district is the Buskirk-Showers House, c. 1897, at 520 North Walnut Street (photograph 1). This limestone veneer house is adorned with a variety of columns, pressed metal work on the porch friezes and carved limestone details. The interior has many historic features including elaborate plasterwork, woodwork and fireplaces. Other examples include 427 North Washington Street, c. 1890, which features paired columns supporting the porch (photograph 9), 527 North Washington Street, c. 1900, which features diamond paned upper sash on the windows (photograph 5) and 526 North Washington Street, c. 1890, which features dentiled cornice molding (photograph 3).

There are several outstanding examples of the Classical Revival style in the district including 321, 418 and 430 North Washington Street, c. 1905, (photographs 14, 12, and 10 respectively). The Showers-Graham House at 430 North Washington Street prominently displays a full height pedimented portico with Ionic order columns, a modillioned cornice, multi-light windows and a formal, symmetrical composition (photograph 10). The house has been restored by its current owner occupants and is in very good repair. The Showers-Myers House, c. 1900, at 321 North Washington Street also displays a symmetrical composition, modillioned porch roof cornices and multi-light windows (photograph 14). This stone veneer version of the style also has Palladian type windows and a clay tile gambrel roof. A stone veneer garage was added to the rear and a stone wall with overhead arch gateways encloses the backyard. The house at 418 North Washington Street is a one story example of the style but, it has an impressive pedimented entrance portico with Doric order columns, a dentiled cornice and flat frieze and multi-light windows (photograph 12). It was built c. 1900.

The Teter House at 528 North Walnut Street built in 1913 is a two-toned red brick Classical or Georgian Revival building designed by Chicago architects Lowe and Bollenbocher (photograph 1). The facade is characterized by a symmetrical composition, which features a projecting entrance portico with a paneled door and sidelights, multi-paned windows with flat arch lintels with pronounced keystones, a modillioned cornice and pedimented dormers. A former one story side porch composed of a blind arcade with a balustrade above, has been enclosed

United States Department of the Interior
National Park Service

National Register of Historic Places Continuation Sheet

Section number 7 Page 3 North Washington Street Historic District

and expanded in matching brick with the same dark headers and light stretchers employed on the original structure.

The Washington Terrace Apartments, 1929, at 316 North Washington Street is a two and one half story limestone and brick apartment building designed in the Classical or Colonial Revival style by architects Ross and George Caldwell of Indianapolis (photograph 13). The two story high entrance portico features a wood panel door with fan light at the ground level, large Palladian window on the second floor and an octagonal cupola above on the roof. There are also pedimented dormers at the roof level, multi-paned windows throughout and a simple cornice entablature.

The district's four examples of the bungalow and craftsman styles do not have a large impact on the district due to their dispersal throughout the district and relative lack of significant architectural detail. The house at 411 North Washington Street was remodeled in the 1910's or 1920's to its present bungalow form with gently pitched broad gables, wide overhanging eaves supported by exposed rafters and battered porch piers (photograph 15). This house has been covered with artificial siding and has had several additions attached to it. Another bungalow at 111 East Ninth Street is brick with exposed wood framing on the roof of the wide front porch (photograph 8). It was built in about 1915.

The American Foursquare style house at 208 East Tenth Street can be classified under the craftsman category (photograph 4). This c. 1910 two story house with a rectangular plan, symmetrical fenestration, a hipped, pyramidal roof and a brick front porch retains its original wood siding and six over six wood frame windows. There is a separate, freestanding garage, which has been converted to a living space. The addition of wood shingle siding and the alteration of the openings have diminished the ability of this secondary building to contribute to the district. Another craftsman style house is found at 424 North Washington Street (photograph 11). This brick variant of the American Foursquare is L-shaped in plan but, has a hipped roof, wide eaves and wide window openings. It dates from c. 1920.

Contributing wood frame garages are found at the rear or on the alley of several properties in the district including 419, 427, 508, 514, 522 and 527 North Washington Street. These structures were originally constructed as horse stables, were later used as automobile garages and are commonly storage buildings today. Two contributing brick automobile garages survive in the district, one at the rear of 430 North Washington Street and one in the side yard of 111 East Ninth Street. These two structures were built to house cars and still do so today.

As stated earlier, the only noncontributing buildings are secondary structures with minimal impact on the district. There is a painted concrete block

United States Department of the Interior
National Park Service

National Register of Historic Places Continuation Sheet

Section number 7 Page 4 North Washington Street Historic District

structure at the rear of 418 North Washington Street, an artificially sided garage at the rear of 502 North Washington Street and an original garage converted to an apartment at the side of 208 East Tenth Street (described above, photograph 4).

With the exception of more mature trees, overhead electric and telephone lines and newer paved streets, curbs and sidewalks, the district probably looks very much as it did since the period of significance. Most of the houses in the district were owner occupied or rented by single families until a larger demand for student housing occurred and many of the houses were divided into multiple rental units. In the 1980's several of the houses once again became owner occupied and were restored or rehabilitated by their owners. Rehabilitation activity is ongoing in the district.

United States Department of the Interior
National Park ServiceNational Register of Historic Places
Continuation SheetSection number 8 Page 1 North Washington Street Historic District

Street Historic District, 105-055-73000), are comprised primarily of one or one and one half story worker's cottages in vernacular forms. The only other historic district identified in Bloomington with similar resources is the Prospect Hill Historic District, which is listed in the Indiana Register of Historic Sites and Structures (105-055-66000) and for which a National Register of Historic Places nomination form has been submitted to the Indiana Division of Historic Preservation and Archaeology. The Prospect Hill Addition was platted in 1893 by the Showers brothers and developed between 1890 and 1925 with houses built in a variety of architectural styles for Bloomington's upper middle class, including many Showers Brothers Company employees.

Most of the houses in the North Washington Street Historic District were built within a relatively short period of time, in primarily two architectural styles and were occupied by Bloomington's most prosperous citizens, the owners and presidents of factories, quarries and banks. The Prospect Hill Historic District was developed over a longer period of time, with more architectural variety and housed Bloomington's managers, lawyers, merchants and employees of the residents of North Washington Street. The North Washington Street district was a natural extension of Bloomington's most prestigious neighborhood along North College Avenue and North Walnut Street. There are some remaining houses in this area, but many have been converted to commercial use and the residential ambience has been lost. Therefore, the North Washington Street district is the only remaining intact grouping of upper class homes from the late nineteenth century in Bloomington.

The history of the Showers family in Bloomington begins in 1856 when Charles C. Showers, an Episcopal minister and cabinet maker, brought his family to town. By 1868 Charles' two sons, James D. and William N., bought out their father's interest in his cabinet making business and established the Showers Brothers Company. Initially they specialized in the making of bedsteads and bedroom furniture. Over the years they expanded to include matched bedroom and dining room suites of furniture, "Hoosier" kitchen cabinets and radio consoles. In 1920 Showers produced the first furniture line to appear in the Sears catalog and also supplied Montgomery Ward and Spiegel. Also in 1920 another plant was built in Burlington, Iowa which filled orders from western markets. Four years later another factory was built at Bloomfield, Indiana which produced chairs to match the Bloomington furniture suites. The company employed 2000 in 1929, an all time high, but experienced difficulties during the 1930's with the onslaught of the depression and labor unrest within the company. By the 1950's the company was profitable again, however, family members, who were the major stockholders, decided to sell to the Storkline Company of Chicago, makers of juvenile furniture, in 1955. Storkline operated the factory for three years then sold the property to Indiana University and furniture production in Bloomington ceased.

United States Department of the Interior
National Park Service

National Register of Historic Places
Continuation Sheet

Section number 8 Page 2 North Washington Street Historic District

The first factory buildings were located at Ninth and Grant Streets in Bloomington, but after a fire in 1884, the brothers rebuilt at Ninth and Morton Streets. A 1910 expansion of the factory resulted in the buildings, some of which still stand today (City of Bloomington Interim Report 105-055-80064). The Showers Brothers Administration Building (105-055-80061) and company store building also both still stand at Tenth and Morton Streets.

On October 23, 1889, the Bollman family, who owned much of the land in the North Washington Street Historic District had the Bollman Place Addition recorded. Soon after the Bollman Place lots were available for sale, the two Showers brothers, James D. and William N. began buying them and building large, two story, Queen Anne and Free Classic style homes on the spacious lots. On lots fronting on North Walnut Street, they built homes for themselves, which are no longer standing. On the lots along North Washington Street they built homes for their children and homes which were rented to other families.

Of the 27 single family houses in the district, the Showers family owned at least 13. Seven of these were owned and occupied by members of the Showers family. Maude E. Showers, daughter of James D. Showers lived at 321 North Washington Street (photograph 14) with her husband, Dr. Burton D. Myers, who was dean of the Indiana University Medical School at one time. Lela Showers, who was the widow of Charles Showers, son of James D., lived at 427 North Washington Street (photograph 9). W. Edward Showers, son of William N., and his wife, Bertha Matthews, lived first at 430 North Washington Street (photograph 10) and later at 520 North Walnut Street (photograph 1). William N.'s daughter, Jennie lived with her husband, Joseph Smith, at 514 North Washington Street (photograph 6). Jennie's half sister, Nellie, lived first with her husband, Sanford Teter, next door to Jennie at 508 North Washington Street (photograph 6) and later at 528 North Walnut Street (photograph 1 and 2). Both W. Edward Showers and Sanford Teter were officers in the Showers Brothers Company.

At least six properties in the district were owned by members of the Showers family and rented to others including 123 East Eighth Street, 501, 502 and 515 North Washington Street (photographs 15, 7, 11 and 7 respectively). The house at 419 North Washington Street (photograph 9) was owned by William N. and occupied by Mr. and Mrs. L. W. Buskirk in 1900, Ernest H. Lindley, Indiana University professor, after whom Lindley Hall was named, and his wife Elizabeth in 1910 and Mr. and Mrs. John B. Bridwell, proprietor of Tapp and Bridwell, a Bloomington grain and feed mill, after 1916. The house at 522 North Washington Street (photograph 3) was owned by the Showers brothers and rented to Mr. and Mrs. Simeon C. Freese, of the Bloomington Gas Company.

Many of the properties in the district not owned or occupied by Showers family members were the homes of other prominent Bloomingtonians including Indiana University professors, physicians, lawyers and entrepreneurs. The duplex house

United States Department of the Interior
National Park ServiceNational Register of Historic Places
Continuation SheetSection number 8 Page 3 North Washington Street Historic District

at 203 East Eighth/408 North Washington Street (photograph 12) was the residence of James A. and Hazel Bowles of Simmons & Bowles, insurance agency, Louis and Caroline W. Becovitz, proprietor of The Vogue, ladies clothing store and Alfred H. and May Beldon, also in real estate and insurance. The house at 420 North Washington Street (photograph 11) was occupied by Mr. and Mrs. Arthur Cravens, one of the Cravens Brothers, printers and publishers of the "Daily World" and "The World-Courier", Bloomington newspapers, and later by Mrs. Jennie Seward of the Seward Iron Foundry family. Arthur Cravens' brother, Oscar and his wife Bertha, lived next door at 424 North Washington Street (photograph 11), which was later occupied by Blaine W. and Anna Bradfute, editor and proprietor of "The Bloomington Telephone". Frank M. and Rose Allen, he was the secretary and treasurer of the Wicks Company, department store, lived at 427 North Washington Street (photograph 9). The president of the short-lived Bloomington Auto Company, Omer G. Bunger, lived with his wife Jennie at 528 North Washington Street (photograph 3).

Individuals associated with the limestone industry also lived in the district. Gladstone H. Barrett was the vice president of the Matthews Brothers Company, "sawed and cut stone", when he lived with his wife Edith E. Barrett at 508 North Washington Street (photograph 6) after 1916. Addie H. Matthews, widow of W. N. Matthews, owner of the Matthews Brothers quarry and former state senator, lived at 514 North Washington Street (photograph 6). Philip Kearney Buskirk, who built the house at 520 North Walnut Street (photograph 1) and lived there with his wife, Tunie Hays Buskirk, was the president of the Empire Stone Company and the First National Bank of Bloomington. James F. Dutton, who occupied 532 North Walnut Street (photograph 2) with his wife Ethel M. Dutton, was a salesman for the Hoadley Stone Company.

The district is significant for its association with the Showers family and their impact on Bloomington. They were instrumental in developing several residential neighborhoods in town and they employed a significant number of its residents. The two Showers brothers, James D. and William N., who founded the Showers Brothers Company, were involved in real estate purchases and building in the Prospect Hill and North Washington Street Historic Districts and in an area north of Seventeenth Street and west of Rogers Street, which was developed for Showers company employees. The houses in the North Washington Street Historic District are a tangible reminder of the presence of the Showers family in Bloomington and their home environment.

The district is also significant as an exemplary collection of Queen Anne, Free Classic and Classical Revival houses, with one example of the Italianate style and a few examples of the Bungalow/Craftsman style. The Italianate style is found at 408 North Washington Street/203 East Eighth Street (photograph 12), characterized here by the wide eaves supported by brackets, a low-pitch hip roof, decorative window heads over tall thin windows and a recessed entry with

United States Department of the Interior
National Park ServiceNational Register of Historic Places
Continuation SheetSection number 8 Page 4 North Washington Street Historic District

double doors. The Queen Anne style is found at 419, 420, 502, 508, 509, 514, 515, 521 and 522 North Washington Street, 532 North Walnut Street and 115 and 123 East Eighth Street (photographs 9, 11, 11, 6, 7, 6, 7, 7, 3, 2, and 15 respectively), characterized here by asymmetrical compositions, a variety of forms, textures and colors: encircling porches, multi-gabled roofs and chamfered corners; diamond and fishscale shingle work and decoratively cut brackets and barge boards.

The Free Classic style is represented by the houses at 427, 501, 526, 527 and 528 North Washington Street and 520 North Walnut Street (photographs 9, 7, 3, 5, 3, and 1 respectively). These houses are characterized by the irregular massing of the Queen Anne style and Classical Revival details such as columns, diamond paned window sash and dentiled cornice molding. The Classical Revival style is found at 316, 321, 418 and 430 North Washington Street and 528 North Walnut Street (photographs 13, 14, 12, 10 and 1 respectively). These houses have symmetrical compositions, pedimented porticoes with columns, modillioned cornices, multi-light and Palladian windows and pedimented dormers.

The district's four examples of the bungalow and craftsman styles include houses at 411 and 424 North Washington Street, 111 East Ninth Street and 208 East Tenth Street (photographs 15, 11, 8 and 4 respectively). Gently pitched broad gables, wide overhanging eaves supported by exposed rafters and battered porch piers characterize the bungalows, while a rectangular plan, symmetrical fenestration and a hipped, pyramidal roof are elements of the craftsman style American Foursquare houses.

Contributing wood frame garages are found at the rear or on the alley of several properties in the district including 419, 427, 508, 514, 522 and 527 North Washington Street. These structures were originally constructed as horse stables, were later used as automobile garages and are commonly storage buildings today. Two contributing brick automobile garages survive in the district, one at the rear of 430 North Washington Street and one in the side yard of 111 East Ninth Street. These two structures were built to house cars and still do so today. The three noncontributing buildings are secondary structures at the rear of 418 and 502 North Washington Street and 208 East Tenth Street, which were built since the period of significance or have been altered and which have a minimal impact on the district.

This neighborhood remained a prestigious area for Bloomington's elite until later in the twentieth century when many of the houses were divided into student apartments. Commercial development increased along North Walnut Street, which resulted in the loss of the homes of James D. and William N. Showers, among others, and the conversion of the three properties along North Walnut Street in the district to commercial uses. Some of the houses in the district have remained owner occupied throughout this century and in the late 1970's several of the houses once again became owner occupied and were restored or rehabilitated by their owners. Rehabilitation activity is ongoing in the district.

United States Department of the Interior
National Park Service

National Register of Historic Places Continuation Sheet

Section number 9 Page 1 North Washington Street Historic District

Hall, Forest M. "Pop". Historic Treasures: True Tales and Deeds with Interesting Data in the Life of Bloomington, Indiana University and Monroe County - Written in Simple Language About Real People, with Other Important Things and Illustrations. Bloomington: Forest M. "Pop" Hall, 1922.

History of Lawrence and Monroe Counties, Indiana: Their, People, Industries and Institutions. Indianapolis, Indiana: B.F. Bowen & Company, 1914.

Monroe County Interim Report--Indiana Historic Sites and Structures Inventory. Bloomington: Bloomington Restorations Inc., June 1989.

Sanborn Insurance Maps. Bloomington, Indiana. 1883, 1887, 1892, 1898, 1907, 1913, 1927 and 1947.

United States Department of the Interior
National Park ServiceNational Register of Historic Places
Continuation SheetSection number 10 Page 1 North Washington Street Historic District

Verbal Boundary Description

Beginning at the southwest corner of the property at 321 North Washington Street, proceed eastward along the south property line of said property, cross North Washington Street and continue along the south, east and north property lines of 316 North Washington Street to a point intersected by the east property line of 203 East Eighth Street. From there cross East Eighth Street and proceed north along the east property lines of 203 East Eighth Street and 418 North Washington Street. Proceed east along the south property line of 430 North Washington Street then turn north and follow the east property lines of 430-528 North Washington Street to the south curblineline of East Tenth Street. Then proceed west along the south curblineline of East Tenth Street, then south along the east curblineline of North Washington Street, cross North Washington Street and continue west along the north property line of 527 North Washington Street to the east property line of 532 North Walnut Street. Proceed north along the east property line of 532 North Walnut Street to the south curblineline of East Tenth Street. Proceed west along the south curblineline of East Tenth Street and south along the east curblineline of North Walnut Street to the south property line of 520 North Walnut Street. Turn east and proceed along the south property line of 520 North Walnut Street to the west property line of 515 North Washington Street. Then turn south along the west property lines of 515-321 North Washington Street to the point of beginning.

Boundary Justification

This district is composed primarily of a two block corridor along the four and five hundred blocks of North Washington Street. The district boundaries also include two properties in the three hundred block of North Washington Street, one on East Tenth Street and three along North Walnut Street. Most of the properties in the district are part of the Bollman Place Addition, which was recorded on October 23, 1889. The properties on the east side of the four hundred block of North Washington Street are part of Bloomington City Outlot 31. The properties at 316 and 321 North Washington Street are both Bloomington City In Lots. Immediately to the south and west of the district there are surface parking lots and new commercial development. Tenth Street, a major traffic artery, is a northern boundary, however, a one story professional building at 110 East Tenth Street built in the 1960's or 1970's is excluded. To the north and east of the district there are residential dwellings, most of which were built later than the majority of the buildings in the district. Most of these dwellings were originally single family units but, have since been divided into multiple student units and are generally in fair to poor condition.

United States Department of the Interior
National Park Service

National Register of Historic Places Continuation Sheet

Section number Photo-
graphs Page 1 North Washington Street Historic District

PHOTOGRAPH INFORMATION

The following information is the same for all photographs:

North Washington Street Historic District
Bloomington, Indiana
Cynthia Brubaker
November 29, 1990
Portfolio Design Inc., 222 N. College Ave., Ste. 300, Bloomington,
Indiana 47404

1. Streetscape, 532, 528, and 520 North Walnut Street
Camera pointing northeast.
2. Streetscape, 532, 528, and 520 North Walnut Street
Camera pointing southeast.
3. Streetscape, East Tenth and North Washington Streets
Camera pointing southeast.
4. 208 East Tenth Street and noncontributing garage
Camera pointing south, north elevations.
5. 527 North Washington Street
Camera pointing northwest, south and east elevations.
6. 514, 508, and 502 North Washington Street
Camera pointing southeast, north and west elevations.
7. Streetscape, 501 - 527 North Washington Street
Camera pointing northwest, south and east elevations.
8. 111 East Ninth Street and contributing garage
Camera pointing north, south elevations.
9. 419 and 427 North Washington Street
Camera pointing southwest, north and east elevations.
10. 430 North Washington Street
Camera pointing southeast, north and west elevations.
11. 502 - 420 North Washington Street
Camera pointing northeast, south and west elevations.

United States Department of the Interior
National Park Service

National Register of Historic Places Continuation Sheet

Section number Photo-
graphs Page 2 North Washington Street Historic District

12. 418 North Washington Street and 408 North Washington/203 East Eighth Street
Camera pointing northeast, south and west elevations.
13. 316 North Washington Street
Camera pointing southeast, north and west elevations.
14. 321 North Washington Street
Camera pointing west, east elevation.
15. 115 and 123 East Eighth Street and 411 North Washington Street.
Camera pointing northwest, south and east elevations.

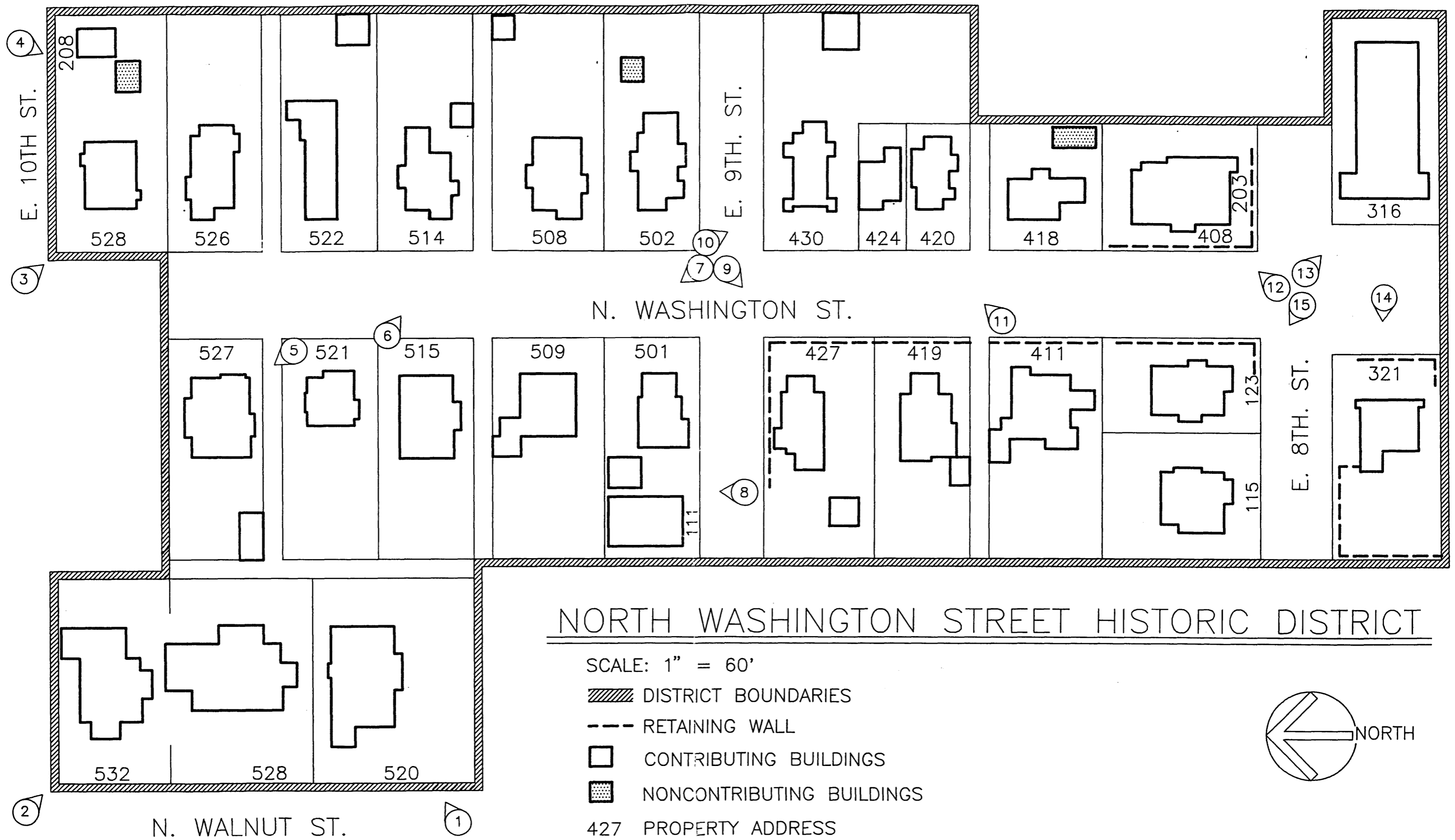

NORTH WASHINGTON STREET HISTORIC DISTRICT

SCALE: 1" = 60'

▨ DISTRICT BOUNDARIES

- - - RETAINING WALL

□ CONTRIBUTING BUILDINGS

▨ NONCONTRIBUTING BUILDINGS

427 PROPERTY ADDRESS

① PHOTOGRAPH REFERENCE

