

DEC 28 1988

3328

KENTUCKY HISTORIC RESOURCES
Individual Inventory Form

Resource # 182
Madison County

1. Name of Resource: Turner - Fitzpatrick House

2. Original Owner: Thomas Turner

3. Other Names: Fitzpatrick House

4. Prehistoric Site Building Object
Historic Site Structure Other

5. Location: Lane (East) off of Mule Shed Road

6. Owner's Name: Chester & Elbridge Johnson [P]

7. Owner's Address: Crutcher Lane
Richmond, KY 40475

8. Evaluation: [N]

9. Recognition & Date:
Nat. Landmark Local Landmark
Nat. Register HABS/HAER
Highway Marker KY Inventory 1980
KY Landmark Certificate

10. N.R. Status & Date:

11. N.R. Group:
District Name: []
Mult. Resource Area: Madison Co. []
Thematic Name: []

12. Historical Theme:
Primary: Architecture [030]
Secondary: []
Other: []

13. Statement of Significance:
See attached.

16. Date:
Original Building 1800-1825 [6]
Addition []

17. Style: Federal/ Greek Revival [2]
[3]

18. Architect/Builder: Unknown

19. No. of Stories: [1.0]

20. Original Floor Plan: Central Passage [CP]

21. Single Pile Double Pile N.A.

22. Roof Form & Material: Original
Gable Not Original

23. Structural Material: Brick [B]

24. Exterior Material: Brick [B]

25. Foundation Material: Stone [S]

26. Major Alterations: None
Moved/Rebuilt Other
Additions X frame ell at rear

27. Special Features: none

28. Outbuildings: None []

29. Original Function: Single Dwelling [01A]

30. Present Use: Single Dwelling []

31. Condition: Good [G]

32. Endangered: Yes
No

33. Attach Photos:
Roll: Photo Nos: No. of Slides:

13	26-27	
		
		

14. History:
In the early 19th century, James H. Berry sold 150 acres to S. Turner. Turner deeded the land to his son Thomas Turner who lived here until 1861, when the land was sold to John Tevis. Tevis sold the house to C.N. Fitzpatrick in 1871. His name appears on the 1876 Beers Map of the county. Other owners since the 19th century have included George Fitzpatrick 1896, T.S. Hagan 1919, and the Agees.

15. Source of historical information and/or contact person:
Deed Research: Madison County Courthouse

34. Prepared by: S. Willis & H. Powell

35. Organization: Madison Co. Hist. Society

36. Date: 1985

37. New Survey Resurvey

KENTUCKY HISTORIC RESOURCES
 Individual Inventory Form

Resource # 182

38. UTM Point of Primary Building: Quadrant: <u>Richmond South</u>	Zone <u>16</u>	Easting <u>732370</u>	Northing <u>4180100</u>	39. G.I.S. Mod. []
				40. Coordi.Accuracy []
41. UTM Points of Boundary (for N. R. eligible sites only):				
A. ---				D. ---
B. ---				E. ---
C. ---				F. ---
42. Total Acreage in Present Property:		43. Acreage included in proposed N.R. boundary:		
44. Site Plan (and boundary description and justification for N.R. sites):				

See Attached.

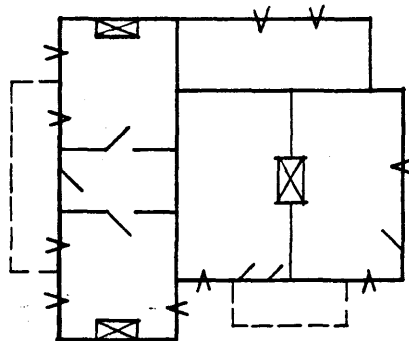

45. Description and House Plan:

The Turner House is a one story brick structure with a stone foundation. The five bay front facade is Flemish bond with jack arches over the windows and a molded wooden cornice under the eaves. The side facades are five course common bond. The central doorway has side lights, transom, and shouldered architrave trim.

The front porch is not original. It now has a brick and concrete floor with brick post bases. The existing porch is three bays, but the original porch was probably one bay covering the central entry bay. A frame ell extends to the rear. One of the shed roofed porches which flanked the ell has been enclosed.

The floorplan is a central hallway flanked on either side by one room with interior end chimneys.

KENTUCKY HISTORIC RESOURCE INVENTORY SUPPLEMENT
BOUNDARY AND LOCATION INFORMATION

Historic Property Name Turner-Fitzpatrick House Site # Ma-182
Multiple Resource/Thematic Nomination Title Madison Co. MRA

U.T.M. Coordinates - List multiple UTMs if property is ten or more acres.

A. _____ D. _____
B. _____ E. _____
C. _____ F. _____

Verbal Boundary Description Acreage .5

From a point of beginning 50 feet east and 65 feet south of the southeast corner of the house; then 165 feet west to a point; then 130 feet north to a point; then 165 feet east to a point; then 130 feet south to the point of beginning.

Sketch of Site Plan (Showing outbuildings, structures, landscape features and the site boundary as described above.)

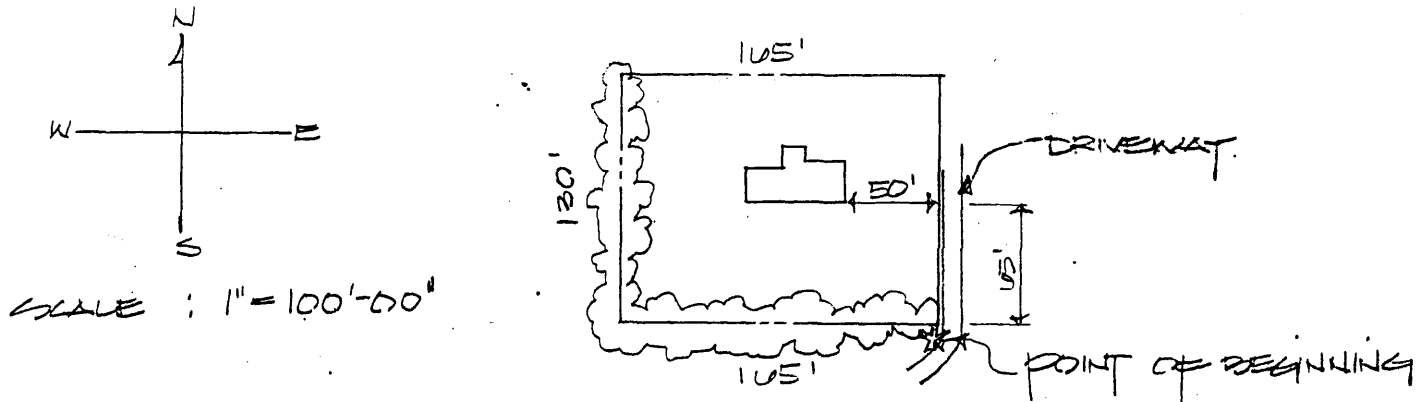

Official Courthouse Property Reference:

Page 4 of 4

Ma-182

Turner-Fitzpatrick House

Statement of Significance

The Turner-Fitzpatrick House is significant under criterion C for the period 1800 to 1825 as an example of how Madison County builders combined elements such as jack arches, elements of the Federal style, with a simple entablature around the doorway, a detail from the Greek Revival style, to ornament a single-pile, central passage house.

Verbal Boundary Justification

The boundary was chosen arbitrarily to provide a minimal setting for the house. On the west and south, a fence line with trees was chosen because it defined the edge of the domestic space and the fields. On the east a driveway was chosen because it separated the yard from the buildings associated with agriculture.

The boundary contains one contributing building.