

FORM B - BUILDING

AREA	FORM NO.
3000	5

MASSACHUSETTS HISTORICAL COMMISSION
294 WASHINGTON STREET, BOSTON, MA 02108

PHOTO: (3x3" or 3x5", black & white)
staple to left side of form

Photo number _____

Town Springfield
Address 9-13 Hampden Street
Historic Name Carlton House Block (D S M A)
Original Owner William Patton

Use: Present Commercial
Original Manufacturing

DESCRIPTION:

Date 1874-75
Source Springfield Directory 1874-75 P.412

Style Italianate Vernacular
Architect Unknown

Exterior wall fabric brick
Outbuildings none

Major alterations (with dates) _____
Parapet/storefronts E.20th C.

Moved No Date _____
Approx. acreage one acre or less

Setting urban context on narrow side street west of Main St.; surrounded by similarly scaled buildings and vacant lots.

SKETCH MAP

Show property's location in relation to nearest cross streets and/or geographical features. Indicate all buildings between inventoried property and adjacent streets.

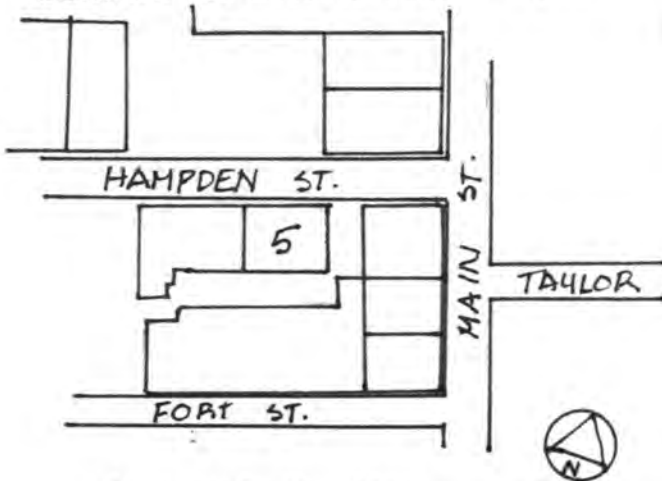

Assessor's Map #304
Recorded by Ed Lonergan, ed. Candace Jenkins, MHC
Organization Springfield Historical Commission
Date February 5, 1979

UTM Reference: 18/698910/4663880
Springfield South Quadrangle
Assessor's Map #304

(Staple additional sheets here)

ARCHITECTURAL SIGNIFICANCE (Describe important architectural features and evaluate in terms of other buildings within community.)

The Carlton House Block is a brick commercial row building which is six bays long and rises three stories to a flat roof. Constructed in 1874-75, it exhibits locally prevalent features of the Italianate style such as stilted arch, stone window hoods and 2/2 sash at the second and third stories. In the early twentieth century, features of modern commercial design were applied in a well integrated fashion. These include a parapet with cast stone trim and large plate glass storefronts headed by a broad cast stone entablature.

HISTORICAL SIGNIFICANCE (Explain the role owners played in local or state history and how the building relates to the development of the community.)

The Carlton House Block possesses integrity of location, materials, workmanship and design of both the 1870's and the early twentieth century. It is significant for its role in the development of downtown Springfield as a commercial/industrial center and as well designed example of an 1870's block updated in the early twentieth century. It thus represents a typical development pattern in the area: a building constructed for lease to a small industrial firm during Springfield's growth years, and then remodeled for new uses and tenants in the city's main era of prosperity. It meets criteria A & C of the National Register of Historic Places.

William Patton built or acquired all the blocks along the South side of Hampden Street during the 1870's and 1880's. This building replaced the Carlton House which had stood on this site and for which this block is named. The Carlton House was one of several hotels within two blocks of the railroad depot. This building was erected for lease to Culter, McIntosh & Co., wholesale boot and shoe jobbers.

Culter, McIntosh and Co. was known widely as "not only the oldest, but the largest inland boot and shoe jobbing house in the New England states"¹. They remained here until 1897, when they relocated to the Smith Block (#39) on Worthington Street.

BIBLIOGRAPHY and/or REFERENCES (name of publication, author, date, and publisher)

Springfield Directory, 1874-1875, p. 412
Centennial Map of Springfield, 1875
Springfield Street Directories

United States Department of the Interior
National Park Service

Carlton House Block (Downtown Springfield MRA)
Hampden County
MASSACHUSETTS

Working No. 11/10/82-30225

Fed. Reg. Date: _____

Date Due: 12/9/82 - 12/25/82

Action: ACCEPT

RETURN 12/22/82

REJECT

Federal Agency: _____

- resubmission
- nomination by person or local government
- owner objection
- appeal

Substantive Review: sample request appeal NR decision

Reviewer's comments:

Recom. / Criteria _____

Reviewer _____

Discipline _____

Date _____

see continuation sheet

Nomination returned for: technical corrections cited below
 substantive reasons discussed below

1. Name

2. Location

3. Classification

Category	Ownership	Status	Present Use
	Public Acquisition	Accessible	

4. Owner of Property

5. Location of Legal Description

6. Representation in Existing Surveys

has this property been determined eligible? yes no

7. Description

Condition		Check one	Check one
<input type="checkbox"/> excellent	<input type="checkbox"/> deteriorated	<input type="checkbox"/> unaltered	<input type="checkbox"/> original site
<input type="checkbox"/> good	<input type="checkbox"/> ruins	<input type="checkbox"/> altered	<input type="checkbox"/> moved date _____
<input type="checkbox"/> fair	<input type="checkbox"/> unexposed		

Describe the present and original (if known) physical appearance

- summary paragraph
- completeness
- clarity
- alterations/integrity
- dates
- boundary selection

8. Significance

Period _____ Areas of Significance—Check and justify below

Specific dates _____ Builder/Architect _____

Statement of Significance (in one paragraph)

- summary paragraph
- completeness
- clarity
- applicable criteria
- justification of areas checked
- relating significance to the resource
- context
- relationship of integrity to significance
- justification of exception
- other

9. Major Bibliographical References

X 10. Geographical Data

Acreage of nominated property _____

Quadrangle name _____

USIT References _____

X Verbal boundary description and justification *Please provide VBI*

11. Form Prepared By

12. State Historic Preservation Officer Certification

The evaluated significance of this property within the state is:

national state local

State Historic Preservation Officer signature _____

Title _____ date _____

13. Other

- Maps
- Photographs
- Other

Questions concerning this nomination may be directed to _____

Signed *S. Byers* Date *12/22/82* Phone: 202 272-3504

Comments for any item may be continued on an attached sheet

United States Department of the Interior
National Park Service

National Register of Historic Places
Inventory—Nomination Form

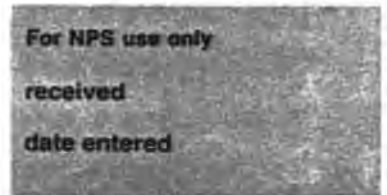

Continuation sheet

Item number

Page 1 of 5

Multiple Resource Area
Thematic Group

dnr-11

Name Downtown Springfield Multiple Resource Area
State MA

Nomination/Type of Review

Date/Signature

1. Whitcomb Warehouse

Entered in the
National Register

for
Keeper

Melvin Byers 2/24/83

Attest

2. Patton Building

Entered in the
National Register

for
Keeper

Melvin Byers 2/24/83

Attest

3. Patton and Loomis Block

Entered in the
National Register

for
Keeper

Melvin Byers 2/24/83

Attest

4. Carlton House Block

Entered in the
National Register

for
Keeper

Melvin Byers 2/24/83

Attest

5. Stacy Building

Substantive Review

Keeper

Kevin M. Dwyer 5/27/87

Attest

6. Springfield Steam Power
Company Block

Entered in the
National Register

for
Keeper

Melvin Byers 2/24/83

Attest

7. Bicycle Club Building

Entered in the
National Register

for
Keeper

Melvin Byers 2/24/83

Attest

8. Wells Block

Entered in the
National Register

for
Keeper

Melvin Byers 2/24/83

Attest

9. Worthy Hotel

Entered in the
National Register

for
Keeper

Melvin Byers 2/24/83

Attest

10. Smith Carriage Company
District

Substantive Review

Keeper

Kevin M. Dwyer 5/27/87

Attest

R

United States Department of the Interior
National Park Service

CARLTON HOUSE - BLOCK
(DOWNTOWN SPRINGFIELD MRA)

HAMPDEN CO
MA

Working No. 11/10/82-3025
Fed. Reg. Date: 2.7.84
Date Due: 4/1/83
Action: ACCEPT 2/24/83
 RETURN
 REJECT
Federal Agency: _____

Entered in the
National Register

- resubmission
- nomination by person or local government
- owner objection
- appeal

Substantive Review: sample request appeal NR decision

Reviewer's comments:

Recom./Criteria _____
Reviewer _____
Discipline _____
Date _____
see continuation sheet

Nomination returned for: technical corrections cited below
 substantive reasons discussed below

1. Name

2. Location

3. Classification

Category	Ownership	Status	Present Use
	Public Acquisition	Accessible	

4. Owner of Property

5. Location of Legal Description

6. Representation in Existing Surveys

has this property been determined eligible? yes no

7. Description

Condition		Check one	Check one
<input type="checkbox"/> excellent	<input type="checkbox"/> deteriorated	<input type="checkbox"/> unaltered	<input type="checkbox"/> original site
<input type="checkbox"/> good	<input type="checkbox"/> ruins	<input type="checkbox"/> altered	<input type="checkbox"/> moved date _____
<input type="checkbox"/> fair	<input type="checkbox"/> unexposed		

Describe the present and original (if known) physical appearance

- summary paragraph
- completeness
- clarity
- alterations/integrity
- dates

8. Significance

Period _____ Area of Significance—Check and justify below _____

Specific dates _____ Builder/Architect _____

Statement of Significance (in one paragraph)

- summary paragraph
- completeness
- clarity
- applicable criteria
- justification of areas checked
- relating significance to the resource
- context
- relationship of integrity to significance
- justification of exception
- other

9. Major Bibliographical References

10. Geographical Data

Address of nominated property _____

Geographic name _____

USIT References _____

Verbal boundary description and justification _____

11. Form Prepared By

12. State Historic Preservation Officer Certification

The evaluated significance of this property within the state is

national state local

State Historic Preservation Officer signature _____

Site _____ date _____

13. Other

- Maps
- Photographs
- Other

Questions concerning this nomination may be directed to _____

Signed _____ Date _____ Phone: 202 272-3500



EXIT
ONLY

5 Downtown Springfield MA, Ma

Carlton House Block

Carlton House Block

9-13 Hampden St.

