

1. Historic Name (s) \* / Dr. William Robb Hs. ADD/County BARI / WA

Original Owner Dr. William Robb

Present Name \_\_\_\_\_

3. Owner's Name Joe Forshee

4. Owner's Address Woodburn, KY

5. Location Market St. S. side ; at foot of Main; Woodburn

6. Open to Public Yes  No

7. Visible from road Yes  No

8. Ownership Private   
Local   
State   
Federal

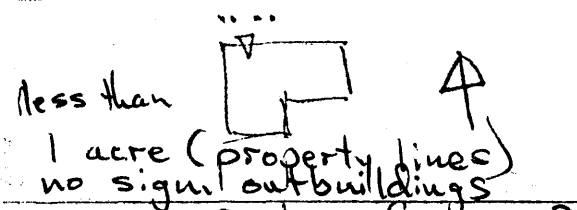
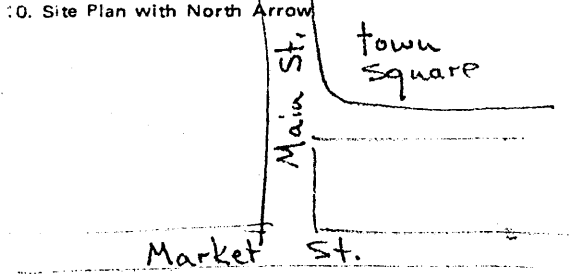

11. Architect \_\_\_\_\_

12. Builder Dr William Robb

13. Date last 1/4 of cent

14. Style Greek-Italianate

15. Original Use dwelling

16. Present Use dwelling

17. Condition Interior   
Exterior good

18. Description 2 story frame - 3 bay - side passage plan - round headed upper sash - interior end chimney - original portico with 2nd story balcony original 1 story ell; original bracketed cornice; focus of vista down Main St.

19. History \* The builder of this home was an M.D. and practiced in Woodburn - his son James was a pharmacist and ran a drug store here - Dr. Robb was born in 1821 and died 1886

20. Significance particularly clear illustration of a common style; strongly contributes to the form of the community.  
Two members of this family played an important role in the community.

21. Source of Information \* Sumpter, An Album of Early Warten County hand marks

23. Zoning Classification \_\_\_\_\_  
Magisterial District 100

24. U.S.G. S. Quadrant (15'/75') Woodburn

25. UTM Reference  
Zone 116 Easting 541980 Northing 46171100

26. Prehistoric Site \_\_\_\_\_ Object \_\_\_\_\_  
Historic Site \_\_\_\_\_ Structure \_\_\_\_\_  
Building

27. District Yes  No   
Name: \_\_\_\_\_

28. Significance Evaluation Kentucky Survey NR

29. Status National Landmark   
National Register   
Landmark Certificate   
Kentucky Survey   
Local Landmark   
HABS/HAER

30. Theme Primary Medicine  
Secondary Architecture  
Other \_\_\_\_\_

31. Endangered Yes  No

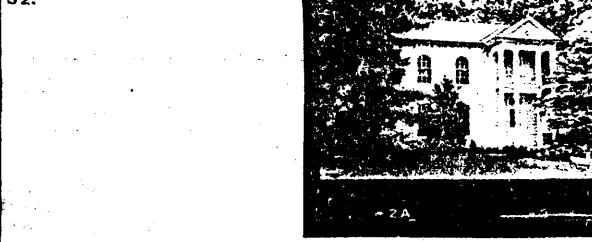

Roll No. 27  
Picture No. \_\_\_\_\_  
Direction \_\_\_\_\_

33. Tape No. \_\_\_\_\_ Negative No. \_\_\_\_\_

34. Prepared by: KTG-JCH

35. Organization KHC

36. Date Spring 1978

37. Revision Dates \_\_\_\_\_ 38. Staff Review \_\_\_\_\_

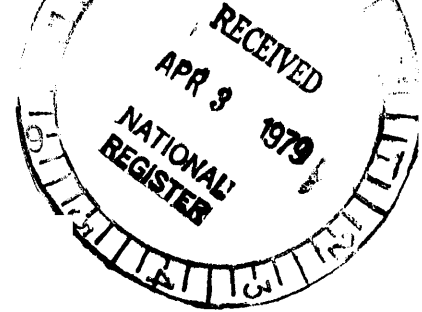

## Architecture and Medicine:

119. The architectural significance of this house--it is a good example of a Greek Revival-Italianate house based on the side passage plan type--is enhanced by the location--the main facade closes the vista down Main Street in the town of Woodburn--and by the prominence of the original owner and his son, a doctor and a pharmacist respectively.