

HISTORIC PRESERVATION UNIT
DEPARTMENT OF CULTURE & HISTORY
SCIENCE & CULTURE CENTER
CHARLESTON, WEST VIRGINIA 25305

File No: _____
Theme(s): 26.
Neg No(s): _____
USGS Quad: _____
UTM Ref: 17/451890/4346320

DISTRICT . SITE . BUILDING . STRUCTURE . OBJECT

1. NAME(S), historic/common: Union Trust & Deposit Co. /
Union Trust National Bank

(Downtown Parkersburg, WV)

2. LOCATION, street/road: 700 Market St.

TAX MAP- LOT #

91-4 city/town: Parkersburg, WV 26101
(incorporated/unincorporated)

3. USE/FUNCTION, present: bank

(public/private, restricted)

original: bank

4. OWNER/ADDRESS, present: Union Trust National Bank

(public/private)

original:

5. PHOTO/SKETCH OF: 8112-R2-F33-36, R4-F5-7, 7. PLAN (include approx. dimensions):
R5-F5-7
8201-R2-F6-7

96x126



6. LOCALE/ENVIRONMENT (map):

8. ACREAGE (approx):

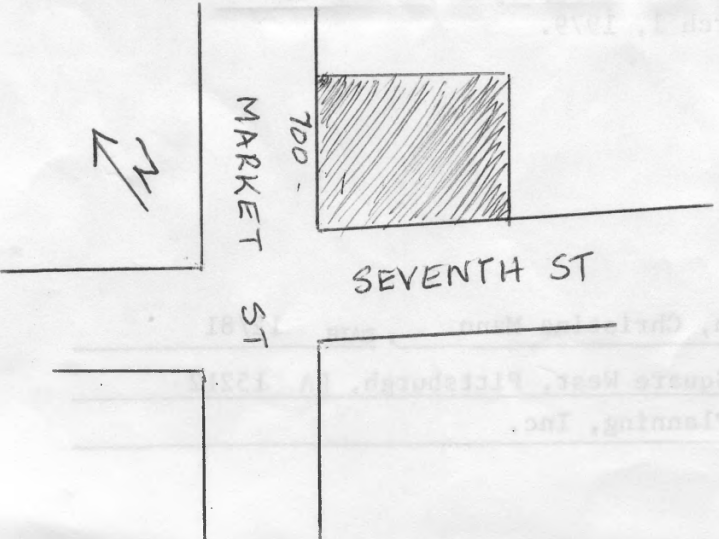

COUNTY: _____
Survey Region: _____
Planning District: _____

WOOD

9. DESCRIPTION (clarify as appropriate): See attached

<p>a. <u>Exterior Fabric</u></p> <p>stone <u>smooth dressed</u> brick <u>orange, above 1st</u> concrete _____ story stucco _____ weatherboard _____ clapboard _____ board & batten _____ shingle _____ other _____</p>	<p>b. <u>Structural System</u></p> <p>masonry _____ frame _____ log _____ metal _____ other <u>concrete, tile</u> <u>(fireproof)</u> foundation _____</p>	<p>c. <u>Roofing Material</u></p> <p>wood _____ metal _____ slate _____ tile _____ asphalt _____ composition _____ other <u>slag</u></p>
--	---	--

<p>d. <u>Associated Structures (use/type):</u></p> <p>outbuildings _____ _____ dependencies _____ _____ other _____ _____ _____</p>	<p>e. <u>Integrity (include dates):</u></p> <p><u>original site</u>/relocated _____ alterations <u>light well filled in</u> <u>c. 1960's; new bronzed windows</u> _____ additions _____ _____ _____</p>
---	---

f. Condition:

excellent X
 good _____
 fair _____
 deteriorated _____
 abandoned _____

g. Threats:

None apparent.

10. SIGNIFICANCE (use additional sheet if necessary):

<p>a. <u>Architect/Builder/Engineer:</u> <u>unknown</u></p> <p>b. <u>Style/Period:</u> <u>Classical</u></p> <p>c. <u>Date(s):</u> <u>1903 (Superintendent)</u> <u>1904</u></p>	<p>Built by Senator Camden in 1903, and it was conveyed by his heirs later to Union Trust and Deposit Company. It continues to serve as a Classical cornerstone for the central business district.</p>
--	--

The unusually broad glazing areas of Union Trust Bank (despite recent installation of bronze glass panels) and finely placed ornament, make this a highly significant example of turn-of-the-century highrise architecture, and the work of a skilled professional architect. The building was ordered by Johnson N. Camden (U.S. Senator from Parkersburg 1881-87; 1893-95, and Democratic nominee for Governor in 1868 and 1872), an oil magnate, a protege of John D. Rockefeller, and influential political party boss. (R.C.)

11. BIBLIOGRAPHY:

Sam Tyre, Tom Farson, Blue Cross employees, 12/9/81.
 See 723-35 Deed Book, March 1, 1979.

12. FORM PREPARED BY Eliza Smith, Christina Mann; DATE 12/81

a. Address Allegheny Square West, Pittsburgh, PA 15212

b. Organization Landmarks Planning, Inc.

Union Trust & Deposit Co./ Union Trust National Bank
700 Market St.
91-4

This is a solidly constructed 7 story, 5 by 7 bay building in a U-shape with the Classical columnar design of base, shaft, and capital. The base is a smooth dressed stone pilaster and window system with corner arches and a modillion cornice; the capital is a metal modillion and dentiled cornice with cartouches below and acroterions above. The shaft consists of wide window apertures with brick relieving arches and stone keystones and sills, containing replacement windows. The central bay (NW) is a projecting 3 sided bay. Above the 2nd story, whose window apertures are larger, is a balconet on consoles. The 1st story apertures, also with replacement windows, are arched at the corners. On the 2 less exposed facades (SE & NE) the fenestration is a simple system of paired d/s (1/1) with stone lintels and sills.



This is a solidly constructed 7 story, 5 by 7 bay building in a U-shaped
with the classical columnar design of base, shaft, and capital. The base
is a smooth dressed stone pilaster and window system with corner arches
and a modified cornice; the capital is a metal molding and dentilled
cornice with cartouches below and acroteria above. The shaft consists
of wide window apertures with brick relieving arches and stone keystones
and sills, containing replacement windows. The central bay (NW) is a
projecting 3 sided bay. Above the 2nd story, whose window apertures are
larger, is a balcony on consoles. The 1st story apertures, also with
replacement windows, are arched at the corners. On the 2 level exposed
facades (SE & NE) the fenestration is a simple system of paired 4's (NW)
with stone lintels and sills.

8201-RO-F7

8201-RO-F7