

OFFICE OF THE SUPERVISOR  
Baton Rouge, Louisiana

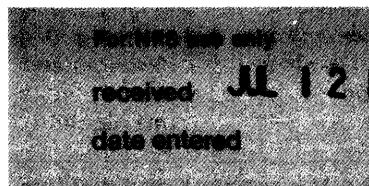

United States Department of the Interior  
National Park Service

# National Register of Historic Places Inventory—Nomination Form

See instructions in *How to Complete National Register Forms*  
Type all entries—complete applicable sections

## 1. Name

historic First United Methodist Church, Columbia, Louisiana

and/or common same

## 2. Location

street & number ~~corner of LA Hwy 165~~ <sup>LA</sup> 165 and Church Street N/A not for publication

city, town Columbia N/A vicinity of ~~Congressional district~~

state LA code 22 parish Caldwell code 021  
~~county~~

## 3. Classification

Category	Ownership	Status	Present Use
<input checked="" type="checkbox"/> district	<input type="checkbox"/> public	<input checked="" type="checkbox"/> occupied	<input type="checkbox"/> agriculture
<input checked="" type="checkbox"/> building(s)	<input checked="" type="checkbox"/> private	<input type="checkbox"/> unoccupied	<input type="checkbox"/> commercial
<input type="checkbox"/> structure	<input type="checkbox"/> both	<input type="checkbox"/> work in progress	<input type="checkbox"/> educational
<input type="checkbox"/> site	<b>Public Acquisition</b>	<b>Accessible</b>	<input type="checkbox"/> entertainment
<input type="checkbox"/> object	<input checked="" type="checkbox"/> in process	<input checked="" type="checkbox"/> yes: restricted	<input type="checkbox"/> government
	<input checked="" type="checkbox"/> being considered	<input type="checkbox"/> yes: unrestricted	<input type="checkbox"/> industrial
		<input type="checkbox"/> no	<input type="checkbox"/> military
			<input type="checkbox"/> museum
			<input type="checkbox"/> park
			<input type="checkbox"/> private residence
			<input checked="" type="checkbox"/> religious
			<input type="checkbox"/> scientific
			<input type="checkbox"/> transportation
			<input type="checkbox"/> other:

## 4. Owner of Property

name The United Methodist Church, LA Area Attention: Bishop J. Kenneth Shamblin

street & number P. O. Box 3057

city, town Baton Rouge N/A vicinity of state LA 70821

## 5. Location of Legal Description

courthouse, registry of deeds, etc. Office of Clerk of Court, Caldwell Parish Courthouse

street & number Main Street (no specific address) P. O. Box 328

city, town Columbia state LA 71418

## 6. Representation in Existing Surveys

title LA Historic Sites Survey has this property been determined eligible?  yes  no

date 1982  federal  state  county  local

depository for survey records Louisiana State Historic Preservation Office

city, town Baton Rouge state LA

---

## 7. Description

---

<b>Condition</b>		<b>Check one</b>	<b>Check one</b>
<input type="checkbox"/> excellent	<input type="checkbox"/> deteriorated	<input type="checkbox"/> unaltered	<input checked="" type="checkbox"/> original site
<input checked="" type="checkbox"/> good	<input type="checkbox"/> ruins	<input checked="" type="checkbox"/> altered	<input type="checkbox"/> moved    date <u>      N/A      </u>
<input type="checkbox"/> fair	<input type="checkbox"/> unexposed		

---

### **Describe the present and original (if known) physical appearance**

The First United Methodist Church of Columbia is a large one-and-one-half story frame structure which features a combination of three rather different historical styles - Gothic, Romanesque, and bungalow. It is located in an early to mid-twentieth century residential area of the parish seat of Columbia. Completed in 1911, it received a substantial addition in 1939 that complements the older structure through the use of the same materials and design elements. This addition was so successfully woven into the original that it enhances the broad, low-slung character of the church. Other than this addition, which should not be considered detrimental to the building's integrity, the church has been altered very little over the years.

The rectangular clapboarded church has an irregular roofline because it has two front towers of unequal height. Both towers have low, overhanging hipped roofs, bands of dentils underneath windows, and false buttresses. The taller of the two has a recessed belfry with round arched louvered openings and large scroll volute braces. The shorter one has pairs of stylized quatrefoil windows underneath its eaves. The church's main entrances are in these towers and have pointed arched openings and doors with recessed panels whose shapes are influenced by the Gothic mouchette motif. The central window on the facade is essentially a large fanlight with its segments repeating the motif of the stylized quatrefoil windows in the shorter tower. All the other windows are paired with round arched lights. There is a dado beneath the first story windows.

Gothic features include:

- (1) the mouchette motif doors
- (2) the pointed arch doorways
- (3) the false buttresses on the towers
- (4) the stylized quatrefoils set in some of the windows

Romanesque Revival features include:

- (1) the round arch windows in the taller tower
- (2) the double arch windows of the nave and narthax

Bungalow features include:

- (1) the extended rafter ends
- (2) the broad low mass
- (3) the squat pyramid shaped tower roofs
- (4) the dado

In 1939, the building was enlarged by an addition on the south and east elevations. The addition has almost identical features as the main block. These include the clapboard wall covering, paired windows with round arched lights, exposed rafters, and large "fanlights" (which in the addition have only louvers).

(Continued)

**United States Department of the Interior  
Heritage Conservation and Recreation Service****National Register of Historic Places  
Inventory—Nomination Form**

Continuation sheet First United Methodist Church Item number 7

Page 2

## Description (Cont'd)

The church appears to retain its original pews and altar furnishings set behind a semicircular railing. The sanctuary retains its beaded wainscotting and has undergone only a few renovations, which include the installation of an acoustical ceiling and wooden roll-up partitions on the west side of the building. This originally was the southern wall of the church, but now the opened partitions lead into Sunday School rooms in the 1939 addition.

Except for the addition, the exterior of the Columbia Methodist Church has received almost no alterations. The new iron stair railings on the facade and the wheelchair ramp on the north elevation do not alter the significance of the building in any way, and the addition itself is a complement to the older building. Built of the same materials and using the same design elements, it is now inseparable from the whole.

# 8. Significance

Period	Areas of Significance—Check and justify below			
<input type="checkbox"/> prehistoric	<input type="checkbox"/> archeology-prehistoric	<input type="checkbox"/> community planning	<input type="checkbox"/> landscape architecture	<input type="checkbox"/> religion
<input type="checkbox"/> 1400–1499	<input type="checkbox"/> archeology-historic	<input type="checkbox"/> conservation	<input type="checkbox"/> law	<input type="checkbox"/> science
<input type="checkbox"/> 1500–1599	<input type="checkbox"/> agriculture	<input type="checkbox"/> economics	<input type="checkbox"/> literature	<input type="checkbox"/> sculpture
<input type="checkbox"/> 1600–1699	<input checked="" type="checkbox"/> architecture	<input type="checkbox"/> education	<input type="checkbox"/> military	<input type="checkbox"/> social/ humanitarian
<input type="checkbox"/> 1700–1799	<input type="checkbox"/> art	<input type="checkbox"/> engineering	<input type="checkbox"/> music	<input type="checkbox"/> theater
<input type="checkbox"/> 1800–1899	<input type="checkbox"/> commerce	<input type="checkbox"/> exploration/settlement	<input type="checkbox"/> philosophy	<input type="checkbox"/> transportation
<input checked="" type="checkbox"/> 1900–	<input type="checkbox"/> communications	<input type="checkbox"/> industry	<input type="checkbox"/> politics/government	<input type="checkbox"/> other (specify)
	<input type="checkbox"/> invention			

Unknown for 1939 addition

**Specific dates** 1911; addition - 1939 **Builder/Architect** Architect Unknown (1911)  
 Contractor: Frank Masselin & Son, Monroe (1911)

**Statement of Significance (In one paragraph)**

### Criterion C

The First United Methodist Church is locally significant in the area of architecture because it is an architectural landmark in the town of Columbia.

Although the river port town of Columbia was incorporated in 1847, there is nothing left to represent its early development. In fact, the town's oldest surviving structures date from the turn-of-the-century, and these are mainly plain one-story Queen Anne Revival cottages. Columbia's later historic building stock consists almost exclusively of nondescript bungalows and equally nondescript 1920's commercial buildings.

Against this architectural background, the First United Methodist Church is noteworthy in the following respects:

- (1) It is one of the largest historic structures in Columbia.
- (2) It has probably the most elaborate massing of any historic structure in town. For example, it is the only one with towers.
- (3) In contrast to the conventional, even humdrum, historic building stock described above, the church features a striking and exotic blend of Gothic, Romanesque, and bungalow features.

# 9. Major Bibliographical References

History of the Frist United Methodist Church, Compiled by Mrs. Willie D. Lee. Copy in National Register File, Louisiana State Historic Preservation Office, Baton Rouge.

# 10. Geographical Data

Acreage of nominated property approx. .33 acres

Quadrangle name Columbia, LA

Quadrangle scale 1:62,500

### UMT References

A 

1	5	5	8	7	0	7	5	3	5	5	2	2	0	0
Zone			Easting					Northing						

B 

Zone			Easting					Northing						

C 

Zone			Easting					Northing						

D 

Zone			Easting					Northing						

E 

Zone			Easting					Northing						

F 

Zone			Easting					Northing						

G 

Zone			Easting					Northing						

H 

Zone			Easting					Northing						

### Verbal boundary description and justification

Please refer to sketch map.

### List all states and counties for properties overlapping state or county boundaries

state N/A code county code

state code county code

# 11. Form Prepared By

name/title Reverend E. Eugene Kimble, Pastor

organization First United Methodist Church date March 1982

street & number P. O. Box 126 telephone (318) 649-7188

city or town Columbia state LA 71318

# 12. State Historic Preservation Officer Certification

The evaluated significance of this property within the state is:

\_\_\_ national \_\_\_ state X local

As the designated State Historic Preservation Officer for the National Historic Preservation Act of 1966 (Public Law 89-665), I hereby nominate this property for inclusion in the National Register and certify that it has been evaluated according to the criteria and procedures set forth by the National Park Service.

State Historic Preservation Officer signature *Robert B. DeBlieux*  
Robert B. DeBlieux

title State Historic Preservation Officer date July 2, 1982

For NPS use only  
I hereby certify that this property is included in the National Register  
*William H. Brinson* 8/12/82  
Keeper of the National Register  
Attest: \_\_\_\_\_ date \_\_\_\_\_  
Chief of Registration

NOTE: SITE BOUNDARIES PARALLEL  
BLDG. FACADES AT DISTANCES  
SHOWN MEASURED FROM INSIDE  
CURBLINE OF STREETS.

FIRST UNITED METHODIST CHURCH OF  
COLUMBIA

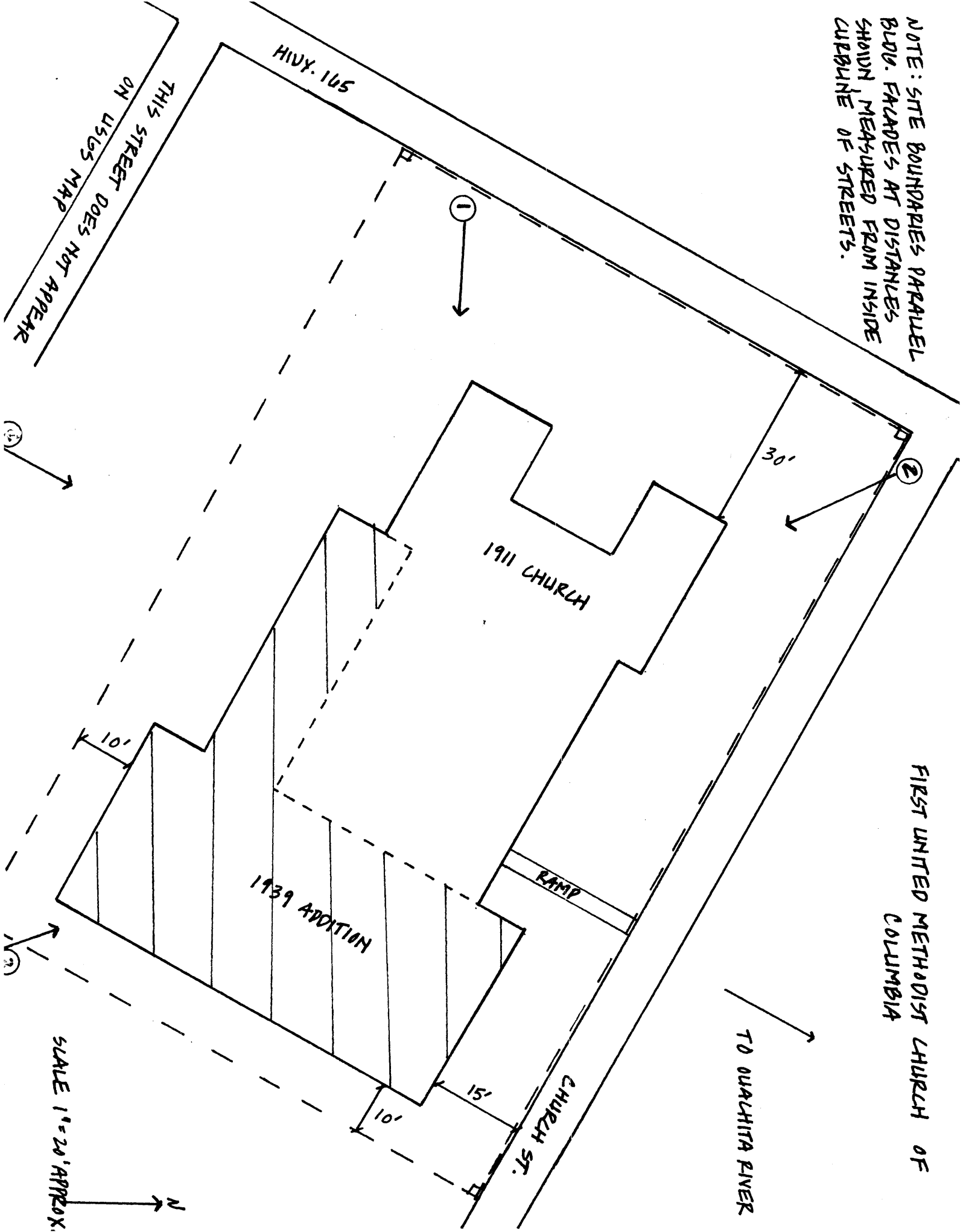

THIS STREET DOES NOT APPEAR  
ON USGS MAP

1

2

3

N

SCALE 1" = 20' APPROX.

TO QUACHITA RIVER

CHURCH ST.

1939 ADDITION

1911 CHURCH

HWY. 105

30'

10'

15'

10'

RAMP