

1503

FORM A - AREA

AUG 21 1989

NATIONAL REGISTER

MASSACHUSETTS HISTORICAL COMMISSION
80 BOYLSTON STREET, BOSTON, MA 02116

Area Letter Form numbers in this Area

H	111
---	-----

WALTHAM, MA MRA

Town Waltham

Name of Area (if any) Charles Street

Workers' Housing District

Present Use residential

General Date or Period 1860s

General Condition fair

Acreage 25,293 sq.ft. 0.580 Acres

Recorded by Ed Gordon

Organization Waltham Historical Comm.

Date July, 1986

revised by C. Jenkins 4/88

Photos (3"x3" or 3"x5" black & white). Indicate on back of each photo street addresses for buildings shown. Staple to left side of form.

Sketch Map. Draw a general map of the area indicating properties within it. Number each property for which individual inventory forms have been completed. Label streets including route numbers, if any. Indicate north. (Attach a separate sheet if space here is not sufficient).

see attached map

RESOURCE COUNT

BUILDINGS: 4C 0NC

STRUCTURES: 0C 1NC

TOTAL: 4C 1NC

UTM REFERENCE 19/315280 /4693500

USGS QUADRANGLE NEWTON
SCALE 1:25,000

NATIONAL REGISTER CRITERIA STATEMENT (if applicable)

The Charles Street Workers Housing Historic District possesses integrity of location, design, setting, materials, workmanship, feeling and associations. It is significant as a nearly intact reflection of Waltham's industrial heritage and the type of housing which housed its workers at its peak in the mid-late 19th century. It also illustrates the development of Waltham's neighborhoods during that period and is associated with the most important ethnic group of the time. Finally, the four houses are significant as well-preserved examples of vernacular workers housing. The district meets criteria A and C of the National Register of Historic Places.

ARCHITECTURAL SIGNIFICANCE Describe important architectural features and evaluate in terms of other areas within the community.

The Charles Street Workers' Housing Historic District is a small one block area defined by Charles Street (N), Williams Street (E) and Harvard Street (W). It stands amidst a mid-19th century residential neighborhood, but is differentiated from its surroundings by the similarities and well-preserved nature of its four component houses. All are unpretentious workers' houses that rise 2½ stories to gable roofs with twin stove chimneys. They are clad with wood shingles, and all but # 140 are trimmed with wide fascias recalling Greek Revival style friezes. #128-132, at the corner of Williams Street, is a double house with a symmetrical eight bay facade centered on two entries whose hip roof porches display turned posts and balustrades. Windows are simply framed and contain 2/2 sash. The adjacent house at #134 Charles Street is an identical single family house with a symmetrical five bay facade centered on its entry. The next house at #140 Charles Street retains the boxy, gable roof form of its neighbors, but lacks the fascia/frieze and has a recessed entry. The final house at the corner of Harvard Street (#144) returns to the previous details but has been altered with a new porch and 1/1 sash.

HISTORICAL SIGNIFICANCE Explain historical importance of area and how the area relates to the development of other areas of the community.

The Charles Street Workers' Housing Historic District developed c1865 after Edward Cambell purchased a large lot of land from Catherine Williams and Charles Richardson. It was part of a gradual westward expansion along Charles Street, as residences were constructed to house workers of the nearby industries. The area centered on Harvard Street appears to have developed as an Irish enclave as is reflected in some of the surrounding street names such as Noonan Street and Duddy Avenue. The histories of #128-32 and #134 are representative. They were owned by Edward Campbell and Patrick Noonan, both who were listed in Waltham Directories as laborers. On October 15, 1864, Edward Campbell paid Catherine Williams and Charles Richardson \$1,075.00 for a large tract of land. It appears that the houses in the district were built the following year. #128-132 Charles Street remained in the Campbell family until Peter Campbell, bicycle inspector sold the house to real estate tycoon Peter Kinsley on August 4, 1900 for \$4,600.00. #134 Charles Street remained in the Noonan family until at least the 1890s. According to an 1875 atlas, #140 Charles Street was owned by an M. Newell and #144 Charles Street was owned by a T. Leach.

BIBLIOGRAPHY and/or REFERENCES

Waltham Maps/Atlases: 1836, 1854, 1874, 1881, 1886, 1898
Waltham Directories: 1870s-1890s
Middlesex Registry of Deeds: 935:376, 1991:221

United States Department of the Interior
National Park Service

AUG 21 1989

National Register of Historic Places
Continuation Sheet

Section number _____ Page _____

Multiple Resource Area
Thematic Group

Name Waltham MRA
State Middlesex County, MASSACHUSETTS

Nomination/Type of Review _____ Date/Signature _____

11. Boston Manufacturing Company Housing (153--165 River St.) Entered in the National Register Keeper Helene Byers 9/28/89
Attest _____

12. Brigham House Entered in the National Register Keeper Helene Byers 9/28/89
Attest _____

13. Building at 202--204 Charles Street Entered in the National Register Keeper Helene Byers 9/28/89
Attest _____

14. Buttrick, Francis, House Entered in the National Register Keeper Helene Byers 9/28/89
Attest _____

See 15. Buttrick, Francis, Library Substantive Review Jan Keeper Betty Savage 9/28/89
Attest _____

16. Byam, Charles, House Entered in the National Register Keeper Helene Byers 9/28/89
Attest _____

17. Central Square Historic District Entered in the National Register Keeper Helene Byers 9/28/89
Attest _____

18. Charles Street Workers' Housing Historic District Entered in the National Register Keeper Helene Byers 9/28/89
Attest _____

See 19. Christ Episcopal Church Substantive Review Jan Keeper Betty Savage 9/28/89
Attest _____

20. Clough, Benjamin F., House Entered in the National Register Keeper Helene Byers 9/28/89
Attest _____

WALTHAM, MA MRA

DISTRICT DATA SHEET

CHARLES STREET WORKERS' HOUSING H.D.

<u>Street Address</u>	<u>Assessor's #</u>	<u>Square Feet</u>	<u>Historic Name/Inventory #</u>	<u>Date</u>	<u>Style</u>	<u>Status</u>
128-132 Charles St.	59-33-4	5,043	Edward Cambell House	c1865	Vernacular	C
134 Charles St.	59-33-3	5,000	Patrick Noonan House garage	c1865	Vernacular	C/NC
140 Charles St.	59-33-2	10,000	n/a	c1865	Vernacular	C
144 Charles St.	59-33-1	5,250	n/a	c1865	Vernacular	C

TOTAL: 25,293 sq.ft.

RESOURCE COUNT: buildings: 4C 0NC
 structures 0C 1NC
 total: 4C 1NC

UNITED STATES DEPARTMENT OF THE INTERIOR
NATIONAL PARK SERVICE

NATIONAL REGISTER OF HISTORIC PLACES
EVALUATION/RETURN SHEET

REQUESTED ACTION: NOMINATION

PROPERTY NAME: Charles Street Workers' Housing Historic District

MULTIPLE NAME: Waltham MRA

STATE & COUNTY: MASSACHUSETTS, Middlesex

DATE RECEIVED: 8/21/89 DATE OF PENDING LIST: 9/05/89
DATE OF 16TH DAY: 9/21/89 DATE OF 45TH DAY: 10/05/89
DATE OF WEEKLY LIST:

REFERENCE NUMBER: 89001503

NOMINATOR: STATE

REASONS FOR REVIEW:

APPEAL: N DATA PROBLEM: N LANDSCAPE: N LESS THAN 50 YEARS: N
OTHER: N PDIL: N PERIOD: N PROGRAM UNAPPROVED: N
REQUEST: N SAMPLE: N SLR DRAFT: N NATIONAL: N

COMMENT WAIVER: N

ACCEPT RETURN REJECT 9/28/89 DATE

Entered in the
National Register

ABSTRACT/SUMMARY COMMENTS:

RECOM./CRITERIA _____
REVIEWER _____
DISCIPLINE _____
DATE _____

DOCUMENTATION see attached comments Y/N see attached SLR Y/N

CLASSIFICATION

count resource type

STATE/FEDERAL AGENCY CERTIFICATION

FUNCTION

historic current

DESCRIPTION

architectural classification
 materials
 descriptive text

SIGNIFICANCE

Period Areas of Significance--Check and justify below

Specific dates Builder/Architect
Statement of Significance (in one paragraph)

summary paragraph
 completeness
 clarity
 applicable criteria
 justification of areas checked
 relating significance to the resource
 context
 relationship of integrity to significance
 justification of exception
 other

BIBLIOGRAPHY

GEOGRAPHICAL DATA

acreage verbal boundary description
 UTM's boundary justification

ACCOMPANYING DOCUMENTATION/PRESENTATION

sketch maps USGS maps photographs presentation

OTHER COMMENTS

Questions concerning this nomination may be directed to

_____ Phone _____

Signed _____ Date _____



130, 132 Charles St.

MHC #111

Waltham, MA MRA

Charles St. Workers' Housing H.P.



130, 132; 134 Charles St

Waltham MA MRA

Charles St. Workers Housing H.P.



134 Charles St

MHC #111

Waltham, MA MRA

Charles St. Workers Housing H, 10

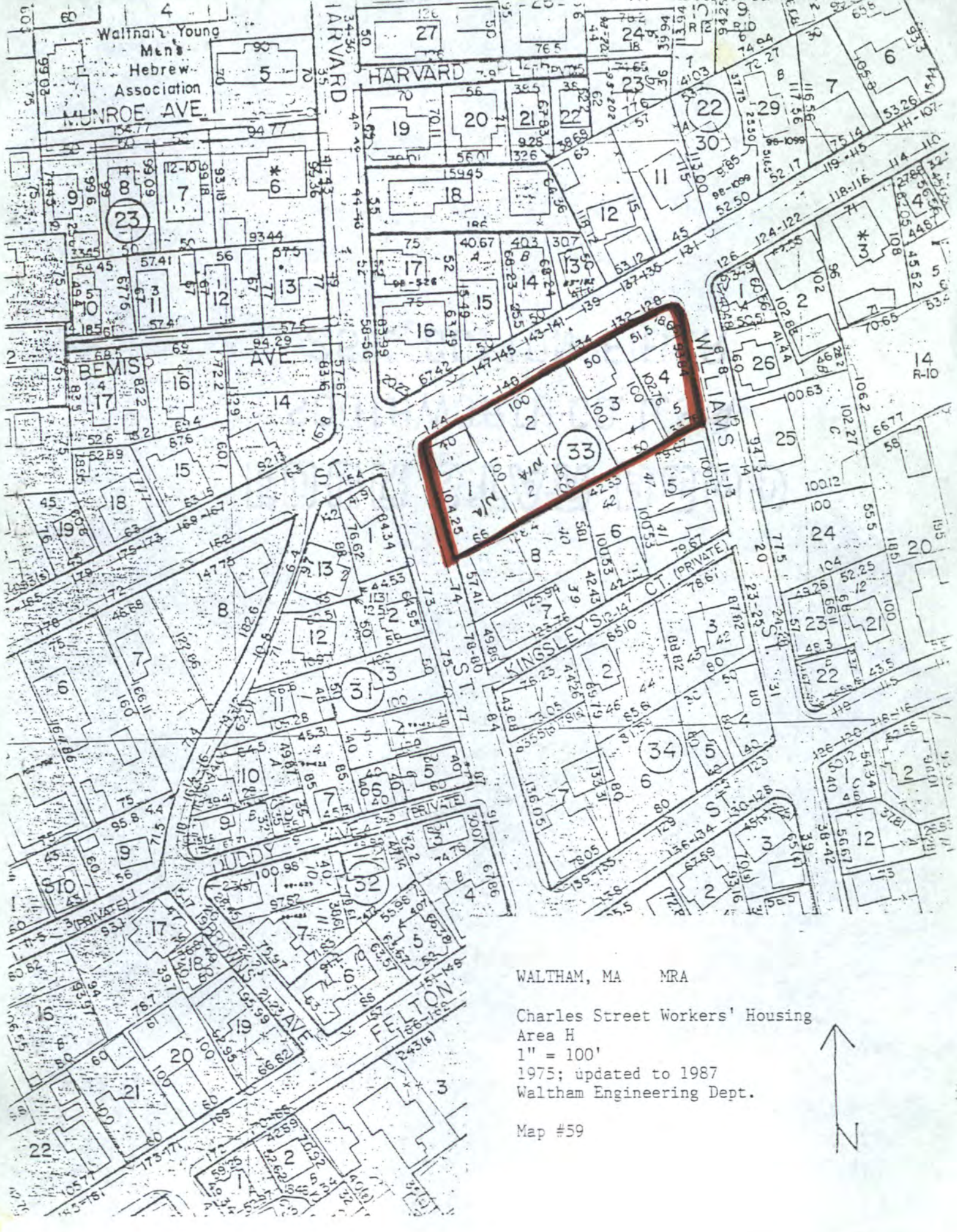

WALTHAM, MA MRA

Charles Street Workers' Housing
Area H

1" = 100'

1975; updated to 1987

Waltham Engineering Dept.

Map #59



Please refer to the map in the
Multiple Property Cover Sheet
for this property

Multiple Property Cover Sheet Reference Number: 64000301