

United States Department of the Interior
National Park Service

563184

National Register of Historic Places Registration Form

This form is for use in nominating or requesting determinations for individual properties and districts. See instructions in National Register Bulletin, *How to Complete the National Register of Historic Places Registration Form*. If any item does not apply to the property being documented, enter "N/A" for "not applicable." For functions, architectural classification, materials, and areas of significance, enter only categories and subcategories from the instructions.

1. Name of Property

Historic name: First Presbyterian Church

Other names/site number: _____

Name of related multiple property listing:

N/A

(Enter "N/A" if property is not part of a multiple property listing)

2. Location

Street & number: 216 West Sixth Street

City or town: Marion State: Indiana County: Grant

Not For Publication: Vicinity:

3. State/Federal Agency Certification

As the designated authority under the National Historic Preservation Act, as amended,

I hereby certify that this x nomination ___ request for determination of eligibility meets the documentation standards for registering properties in the National Register of Historic Places and meets the procedural and professional requirements set forth in 36 CFR Part 60.

In my opinion, the property x meets ___ does not meet the National Register Criteria. I recommend that this property be considered significant at the following level(s) of significance:

___ national ___ statewide x local

Applicable National Register Criteria:

x A ___ B x C ___ D

		<u>10.18.19</u>	
Signature of certifying official/Title:		Date	
<u>Indiana DNR-Division of Historic Preservation and Archaeology</u>			
State or Federal agency/bureau or Tribal Government			

In my opinion, the property ___ meets ___ does not meet the National Register criteria.	

Signature of commenting official:	Date

Title :	State or Federal agency/bureau or Tribal Government

First Presbyterian Church
Name of Property

Grant County, IN
County and State

4. National Park Service Certification

I hereby certify that this property is:

- entered in the National Register
- determined eligible for the National Register
- determined not eligible for the National Register
- removed from the National Register
- other (explain:)

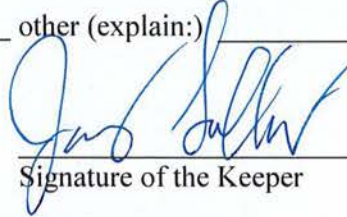
Signature of the Keeper

12.3.2018
Date of Action

5. Classification

Ownership of Property

(Check as many boxes as apply.)

- Private:
- Public – Local
- Public – State
- Public – Federal

Category of Property

(Check only **one** box.)

- Building(s)
- District
- Site
- Structure
- Object

First Presbyterian Church
Name of Property

Grant County, IN
County and State

Number of Resources within Property

(Do not include previously listed resources in the count)

Contributing	Noncontributing	
<u>1</u>	<u>1</u>	buildings
<u>0</u>	<u>0</u>	sites
<u>0</u>	<u>0</u>	structures
<u>0</u>	<u>0</u>	objects
<u>1</u>	<u>1</u>	Total

Number of contributing resources previously listed in the National Register 0

6. Function or Use

Historic Functions

(Enter categories from instructions.)

RELIGION: religious facility

Current Functions

(Enter categories from instructions.)

RELIGION: religious facility

First Presbyterian Church
Name of Property

Grant County, IN
County and State

7. Description

Architectural Classification

(Enter categories from instructions.)

LATE 19TH AND 20TH CENTURY REVIVALS: Late Gothic Revival

OTHER: Akron Plan

Materials: (enter categories from instructions.)

foundation: BRICK

walls: STONE: Limestone

roof: ASPHALT

other:

Narrative Description

(Describe the historic and current physical appearance and condition of the property. Describe contributing and noncontributing resources if applicable. Begin with a **summary paragraph** that briefly describes the general characteristics of the property, such as its location, type, style, method of construction, setting, size, and significant features. Indicate whether the property has historic integrity.)

Summary Paragraph

The First Presbyterian Church, constructed in 1903-1904, is located on the northeast corner of Sixth and Gallatin Streets southwest of Marion's downtown. The walls are faced with locally-quarried limestone and Bedford stone trim. A large entry tower is located on the southwest corner facing Sixth Street (south façade) and a massive, two-story rounded apse dominates the west façade (Gallatin Street). The building is constructed in the Late Gothic Revival style with gabled parapets on its steeply-pitched sanctuary roof, crenelated parapets on projecting bays, and Tudor Gothic arched windows, mostly composed of art glass. While the building's corner entry towers above the neighborhood, the building's overall mass emphasized by its stone walls and buttresses, evokes a substantial physical presence to the corner. A small, late addition was made on the northeast corner of the building, in the same style and material in 1955. A stone building sign, installed on the lot's southwest corner in 1993, is considered a non-contributing object.

First Presbyterian Church
Name of Property

Grant County, IN
County and State

Narrative Description

The former First Presbyterian Church building occupies most of the lot bounded by Sixth and Gallatin Streets, and the alleys that divide the city block east/west and north/south. The church lot is bounded on its west and south sides by concrete sidewalks and has a slightly raised lawn between the building and the two streets. Some mature landscaping is around the building on the west and south sides. A small building sign composed of stone matching the church is located in the southwest corner of the lot. It was installed in 1993 and is considered a non-contributing object (seen in foreground of photo 0018). The church has parking lots to its east (across the alley) and west (across Gallatin Street). Residential neighborhoods extend south and west from the church while public and commercial buildings extending out from the city's downtown are to its north and east.

Exterior (photographs 0018-0022)

The church has a full basement, used for utilities and classroom space, and a raised first floor. A second story balcony and tower study are in the west end of the building. The tall sanctuary roof and balcony give the impression of a large, two-story building with a basic cruciform plan and southwest corner entry tower (photo 0018). The church walls are faced with a bluish-gray-colored locally-quarried limestone flagstone with its split side facing outward and layered edges laid facing up (uncoursed rubble). Locally-quarried limestone forms voussoirs over the tops of basement windows. Dressed Bedford limestone trim forms Tudor Gothic arched surrounds around the building's wood windows. The surrounds have steeply-pitched sills and alternating large and small stone sides to give the surrounds a "long and short work" appearance. Many surrounds have chamfered edges. Most of the building's windows are composed of art glass, except for the basement windows which are clear glass. The art glass windows are fitted with protective storm windows with bottom awning sashes. The large art glass windows in the nave are described as "Tiffany" in church publications. An article in the *Marion News-Tribune* on May 18, 1904 states that Tiffany Company of New York City will do decoration of Presbyterian Church.

The central part of the building features large stepped buttresses and a steeply-pitched gabled roof covered with asphalt shingles. A large semicircular apse on the west façade also features stepped stone buttresses with Bedford stone caps (photo 0022). The building's gabled parapets are trimmed with dressed Bedford stone coping and pinnacles. The tower and bays that extend off the building's south, west and north facades have crenelated parapets that are trimmed with dressed Bedford stone. Centered on the gabled roof is a large octagonal bronze fleche that features louvers on each side and a tall pointed spire (best seen in photo 0019).

The front (south/Gallatin Street) façade is anchored by the entry tower on the southwest corner (photo 0018). The tower is supported on each of its corners by splayed, stepped buttresses that extend to the top of its belfry. The corner buttress features a Bedford stone cornerstone carved with "First Presbyterian Church" facing southwest, "Organized 1843" facing southeast and "erected 1903" facing northwest. The raised entry has stone steps that face south and southwest.

First Presbyterian Church

Name of Property

Grant County, IN

County and State

A wide Tudor Gothic arched entry surround is centered on the front of the tower. The concave, splayed-arch is capped by a label mold. It features a pair of deeply-recessed wood entry doors that form a pointed top, together, and have windows with tracery in their tops and heavy, hand-wrought hinge and metal strap work. The doors have massive ironwork hinges and hardware. The west wall of the tower's first floor features a row of three short slit windows, composed of art glass, with stone sills. A Tudor Gothic arched window of art glass is in the lower part of the wall and is located in the stairway to the basement inside the tower. The tower's second story walls match on the south and west facades. They feature a stone sill course between the buttresses and a tall Tudor Gothic arched opening composed of two short trefoil art glass windows at the bottom, followed by wood louvers, and two pointed-arched windows of art glass at the top. These windows are located in the pastor's/tower study. All four walls of the belfry are identical and feature a stone sill course between the buttresses. Two tall, deeply recessed, full-round arched openings with wood louvers are centered in each of the belfry's walls. Two short louvered openings with trefoil tops are at the bottom of each tall opening. A Bedford stone pier, splayed with the face of the wall, is between the tall louvered openings, and extends above the crenelated parapet of the tower. A carved stone pinnacle caps the pier. The buttress on the southwest corner of the tower continues above the crenelated parapet and is capped with a carved stone pinnacle that features trefoil carvings and gablets.

A wide, one-story section projects forward east of the tower to the east end of the building (photo 0019). The section is divided into six bays with buttresses near the ends of the façade. Each bay has a small basement opening filled with wood or metal louvers. The western-most two bays, divided by one of the buttresses, and the eastern-most bay have Tudor Gothic windows. The remaining three bays have Tudor Gothic windows divided into two lancets by wood tracery. The projecting section's crenelated parapet steps up toward the center. A five-sided bay with cutaway corners projects to the east on the southeast corner of the front façade, immediately east of the buttress at the east end of the projecting one-story section. The bay has a set of steps and concrete stoop in the west end of its south wall (right side of photo 0019). A Tudor Gothic-arched entry surround features a wood door with a pointed-arch window in its top half. A Tudor Gothic-arched window, covered with wood, is to the east of the door. The cutaway corner walls of the bay feature pairs of casement windows of art glass in Tudor Gothic surrounds. A narrow east wall features a capped interior chimney. The bay featured a crenelated parapet. A narrow basement access stair hall was added to the front of this bay, c. 1955, and it is covered with flagstone. It features a shed roof of concrete and has a metal door that faces east (right side of photo 0019).

Stepped back and rising above the one-story projecting section is the tall south-facing gabled wall of the cruciform plan. The wall is flanked by stepped buttresses and tall carved Bedford stone crocketed pinnacles on locally-quarried limestone piers. The highly-carved pinnacles feature trefoil carvings and gablets. The gabled parapet wall features a broad Tudor Gothic arched art glass window divided into multiple panes by wood tracery. A wood louver in a Tudor Gothic arched surround is in the top of the gable. A stone Celtic cross tops the gable. Narrow bays with crenelated tops are to the east and west of the gabled parapet, below the pinnacle.

First Presbyterian Church

Name of Property

Grant County, IN

County and State

The west façade faces Sixth Street and is dominated by a wide semicircular apse that extends from the corner tower to the north-facing gabled parapet wall (photo 0022). The apse is two-stories and is divided into six bays of windows by stepped buttresses. Each bay has two vertical rows of three windows: one in the basement, one of the first floor, and one in the balcony. The recessed first and second floor art glass windows have a dressed stone surround with Tudor Gothic arched top. The surround has “long and short work”, the dressed stone work between the paired bays meets and forms banding. Stepped back from, and above, the wide semicircular apse is the wall of the west leg of the cruciform plan, which is also semicircular. It features eight Tudor Gothic arched windows divided into two side-by-side pointed-arch sashes of art glass. A wood cornice with integral gutter, supported by stone corbels, is at the top of the wall. The steeply-pitched roof over the west leg is rounded with a conical appearance from the west façade.

A one-story entry bay is on the north end of the west façade, west of the wide semicircular bay (left side of photo 0022). It features a concrete porch and steps with a low wall of stone with stone cap, on its north end. The Tudor Gothic arched entry surround features a wide aluminum and glass door with wood casings and a pointed-arch trefoil transom. A wood handicap ramp extends west from this entry. The north wall of this bay features a Tudor Gothic arched wood window divided into two lancet casement sashes. A small 1/1 wood basement window is in the west end of the north wall. The one-story bay has a crenelated parapet.

The north façade, which faces the east/west alley, is dominated by the tall north-facing gabled parapet wall of the cruciform plan (photo 0021). On this façade, the full Tudor Gothic arched window of the sanctuary is visible. The window is divided horizontally by five rectangular sashes at the bottom, followed by wood tracery that defines tall trefoil lancet sashes topped by another set of four trefoil lancets. The whole window is composed of art glass. A tall stepped buttress is on the east end of the gabled parapet wall; it is capped by a pinnacle matching those on the front façade. A wide chimney with a stone cap is on the west end of the gabled parapet wall. Matching the front façade, a wood louver in a Tudor Gothic arched surround is in the top of the gable. A stone Celtic cross tops the gable. Narrow bays with crenelated tops are to the east and west of the gabled parapet, below the pinnacle. A five-sided, one-story bay projects forward from the northwest corner of the façade (right side of photo 0021). It features pairs of wood casement windows of art glass in a Tudor Gothic arched surround in each wall, except for the narrow west-facing wall. A basement window divided into two panes of glass is centered in the north-facing wall of the bay. It appears to have been used as a coal chute at one time. The bay has a crenelated parapet.

In 1955, the congregation completed the addition of a one-story, five-sided bay with cutaway corners sympathetic to the original design on the northeast corner of the building (left side of photo 0021). It projects to the north from a taller two-story part of the addition that will be described as part of the east façade. The addition's walls are composed of buff-colored limestone flagstone in similar random-laid coursing. The bay features a wood door with a Tudor Gothic arched window in the south end of its west wall and a 6/6 wood window in the north end of its west wall. The northwest-facing wall has a 1/1 wood basement window and a 6/6 wood window on the first floor. The north-facing wall has a 1/1 basement window. The northeast-facing wall matches the northwest-facing wall. The long east-facing wall features three bays of

First Presbyterian Church

Name of Property

Grant County, IN

County and State

1/1 basement windows and 6/6 first floor windows. The 6/6 windows have stone sills and lintels composed of stone voussoirs. The parapet has a flat stone cap.

The east façade, which faces the north/south alley, is mostly dominated by a tall, two-story wall with a crenelated parapet (photo 0020). Centered in this wall is a large Gothic arched window referred to as the Reformation Window, installed in 1951 with the chancel remodel. The center of the window features Christ and the cross; it is divided into smaller sashes flanking the main center window by wood tracery. To the south of the window, the two-story wall angles and steps in by where another former Tudor Gothic arched window opening has been filled with stone during the remodel (see on the right side of photo 0019). South of this section are two Tudor Gothic arched windows in the first floor of the façade. They are composed of art glass. North of the Reformation Window is an extension of the 1955 addition, two-stories tall, with two bays of 6/6 first floor windows and 1/1 basement windows (right side of photo 0020). Rising above the chancel addition is the original east-facing gabled parapet wall and segmented roof that covered the former apse. A capped stone chimney is on the south end of the gabled wall. A stone Celtic cross tops the gable.

Interior (photographs 0001-0017)

While the exterior of the building reads as a cruciform plan due to the orientation of its roof gables, the interior reads nearly as one large block with a wide semicircular apse on its west end and smaller one-story projecting bays off the main block. Using terms identified on the original plans, the building is primarily divided into the main central block, called the nave (photos 0006, 0008-0009, 0017), with the chancel at its east end, seen in photo 0008. The wide semicircular, two-story bay is called the Sunday School Assembly (photo 0007) and is separated from the nave by a walkway called the narthex that extends between the front entry vestibule and a vestibule on the north end of the building (photo 0010, 0017). A wood wall that recesses into the floor and a bulkhead above, operated by massive gears in the basement, allows the Sunday School Assembly to be closed off from the nave (seen on the right side of photo 0010 and in photo 0017). Most of the finishes throughout the interior consist of plaster walls and ceilings and carpets laid over original oak floors. Original dark wood baseboards, wainscot, and wood window and door trim are throughout much of the building. Most of the oak doors are original, unpainted, and feature four panels and original cast metal hardware. Several of the art glass windows feature brass donor plaques mounted on or near them (seen in photo 0005).

The front vestibule features stairs that lead down to the basement and up to the balcony level of the Sunday School Assembly in its west end (photo 0003). Doors lead into the narthex in the vestibule's north wall and the former chapel, now hallway with toilet rooms, in its east wall. The back vestibule features stairs that lead down to the basement in its north end and up to the Sunday School Assembly balcony in its southwest corner (photo 0004). Doors to the narthex are in its south wall and a classroom (photo 0005, the west five-sided bay on the north façade) is off the vestibule's east end. The only upper level spaces in the building are the semi-circular balcony in the Sunday School Assembly space (photo 0007), and the "tower study", which is accessed from a narrow staircase in the east end of the second level landing in the corner entry tower (see photo 0001).

First Presbyterian Church
Name of Property

Grant County, IN
County and State

The nave features tall, slender octagonal pilasters around its perimeter and octagonal columns in its west end (see photo 0006, 0017). The pilasters and columns support the ribs from the groin-vaulted ceiling which rest on plaster composite capitals. The narthex and nave have carpeting with the areas under the pews left with exposed oak flooring. The original wood pews are arranged in a semicircle with highly-carved ends with pilaster-like frames and foil-like circular low-relief carvings in their panels (photo 0008). The large art glass windows centered in the north and south walls are reproductions of Heinrich Hofmann paintings that feature depictions of Christ. The north window (photo 0010) depicts Christ as a child teaching in the temple (Christ and the Doctors) and the south window (photo 0006) is a depiction of Christ as an adult (Christ and the Rich Young Ruler). Three large lanterns of metal and art glass hang north-to-south across the nave from original plaster bosses (photo 0008). Two smaller matching lanterns hang over the north and south ends of the narthex (photo 0009). The lanterns were designed and manufactured by a parishioner in 1943. The five-sided chancel (photo 0008) has a raised floor and is centered in the east wall of the nave. It features the art glass Reformation Window in its back (east) wall and panels of fabric and wood tracery in each of the other four walls which function for sound transfer of the organ. The Reformation Window features Christ and a cross. Tall unpainted wood wainscot is at the bottom of the chancel walls and feature rows of pointed arches with carved wood doors leading north and south from the chancel platform.

The Sunday School Assembly area is separated from the nave by the retractable narthex wall, which while it is lowered, functions as a wood balustrade with pass-thru openings to the nave (seen on the right side of photo 0010 and photo 0017). The wall has a simple panel design. The assembly area (photo 0007) has a large central semicircular open area with segmented rooms divided by octagonal wood posts around its west perimeter. The rooms have a raised floor and dividing curtain walls between each of the rooms. Metal columns continue up from the wood posts on the balcony level; the metal columns support a plaster entablature at the base of a semicircular clerestory level that features rows of art glass windows. Ornamented wood ceiling beams radiate out from the east end of the clerestory ceiling and rests on large carved wood brackets. The semicircular balcony has a sweeping, curved front plaster wall trimmed with wood and a metal railing supported by ornate cast metal balusters. Beaded boards cover the backside of the balcony wall below the railing. The balcony has a stepped floor.

The front and back entry vestibules feature wood staircases with balustrades composed of turned balusters and highly-carved square newel posts that feature a pointed-arch and quarter-foil carving with a large acorn-like finial. The front vestibule (photo 0003) has the basement and balcony staircase stacked on its west end while the back vestibule (photo 0004) has an L-shaped staircase in its southwest corner. Marble baseboards are in both vestibules and are likely original to the building, however, both vestibules have modern ceramic tile floors and lighting, c. 1990. The second level areas also have balustrades matching those of the staircases that enclose the stairway openings (front landing area seen in photo 0002). The entry tower includes a room that was finished in 1938 as a study. A wood door with a pointed arch panel is in the southeast corner of the second level landing. It accesses a narrow set of wood steps that lead up to the study. The study features oak wainscot with rows of pointed arches as a panel design. The southwest and northeast corners are cutaway with a deep shelf in the northeast corner and a

First Presbyterian Church

Name of Property

Grant County, IN

County and State

corner cabinet (which appears to have been added c. 1960, photo 0001) in the southwest corner. The chair rail on top of the wainscot forms a deep wood window sill for art glass windows in the south and west walls. The space has oak floors and plaster walls and ceiling.

The former Christian Endeavors Chapel space, in which modern toilet rooms were constructed (photo 0015), features oak wainscot with rows of pointed arches with a tracery as a panel design on its walls. A wide set of wood pocket doors are in the east wall and separate the Ladies Parlor (now office) from the former chapel space (photo 0014). Each of the large pocket doors feature four panels with the top, tall panels carved with pointed arches. The former parlor has matching wainscot and features a fireplace with a brick hearth and carved wood surround (photo 0013). The surround features panels with pointed arches and tracery that flank the firebox and a mantel supported by carved brackets. The exposed brick of the fireplace and hearth may have been covered with more decorative materials given the second fireplace in the office on the southeast corner of the building. That fireplace features Roman brick with thin mortar joints, an ornamented cast metal surround to the firebox opening, and glazed brick hearth (photo 0012). This fireplace also features a wood mantel with rows of quarter-foil carved into its front. The floor of this office is oak.

Off the south end of the nave is a wide one-story bay on the front façade. The space was originally the Christian Endeavor Chapel with a Ladies Parlor in its east end. Modern toilet rooms were constructed in the former chapel, c. 1990 (photo 0015), while the Ladies Parlor is now an office (photos 0013-0014). East of the Ladies Parlor is a narrow hallway that extends from a secondary entry on the front façade to a stair hall and chancel at its north end (photo 0011). An office (the five-sided bay on the southeast corner of the building) is located off the east side of the narrow hallway (photo 0012). A small toilet room is between the office and stair hall. The rooms north of the chancel were added in 1955 and include a choir robe room immediately north of the chancel. A lounge/meeting room (the east five-side bay on the north façade, photo 0016) is north of the choir robe room and features a staircase on its west wall that leads to the ground-level entry and basement. The 1955 addition features concrete block interior walls, carpeted floors and drywall ceilings.

The basement level, which features many small windows around its perimeter to permit daylight, is divided into classrooms and meeting space that at one time included a youth center in its center, fellowship/social hall, Boy Scout room, and kitchen. A majority of the space is unfinished basement with utilities and storage in the east end of the building. A long hallway is directly below the narthex; it permits access to modern classrooms that radiate off the hallway in the semicircular bay. The gears that operate the large wood wall that can separate the narthex from the Sunday School Assembly space above is on the east side of the basement hallway. Large classrooms are in the south end of the basement and centrally located beneath the nave. The basement of the 1955 addition includes a former classroom, now storage space, and a hall that includes period kitchen cabinetry. Off its south end, through the area beneath the chancel, is a long hall with c. 1942 cabinetry. That cabinetry is painted with two-panel pine doors and drawers with metal pulls. Modern, c. 1960-1990 finishes dominate the finished areas of the basement. These include vinyl flooring, carpets, paneling, drywall, and acoustic ceilings.

First Presbyterian Church
Name of Property

Grant County, IN
County and State

8. Statement of Significance

Applicable National Register Criteria

(Mark "x" in one or more boxes for the criteria qualifying the property for National Register listing.)

- A. Property is associated with events that have made a significant contribution to the broad patterns of our history.
- B. Property is associated with the lives of persons significant in our past.
- C. Property embodies the distinctive characteristics of a type, period, or method of construction or represents the work of a master, or possesses high artistic values, or represents a significant and distinguishable entity whose components lack individual distinction.
- D. Property has yielded, or is likely to yield, information important in prehistory or history.

Criteria Considerations

(Mark "x" in all the boxes that apply.)

- A. Owned by a religious institution or used for religious purposes
- B. Removed from its original location
- C. A birthplace or grave
- D. A cemetery
- E. A reconstructed building, object, or structure
- F. A commemorative property
- G. Less than 50 years old or achieving significance within the past 50 years

First Presbyterian Church
Name of Property

Grant County, IN
County and State

Areas of Significance

(Enter categories from instructions.)

ARCHITECTURE

Period of Significance

1904-1955

Significant Dates

Significant Person (last name, first name)

(Complete only if Criterion B is marked above.)

Cultural Affiliation

Architect/Builder (last name, first name)

Richards, McCarty and Bulford

Teutsch, Carl M.

Patton, Philip

First Presbyterian Church
Name of Property

Grant County, IN
County and State

Period of Significance (justification)

The period of significance begins in 1904 when the original footprint and basic composition of the church was constructed and dedicated. Though going through minor remodeling projects in the 1930s-1940s, the year of original construction is used as the beginning of the period of significance. The period ends in 1955 after the chancel area was remodeled and a small addition was made to the northeast corner of the building.

Criteria Considerations (explanation, if necessary)

The building was constructed for religious purposes and was owned by the Presbyterian congregation of Marion until 2001 when it was sold to another congregation known as God's House Ministries, the current owner. The building is being nominated as a locally outstanding example of Gothic Revival architecture.

Statement of Significance Summary Paragraph (Provide a summary paragraph that includes level of significance, applicable criteria, justification for the period of significance, and any applicable criteria considerations.)

The First Presbyterian Church, Marion, Indiana, is eligible for the National Register of Historic Places under criterion C for its architectural significance. The building is an impressive example of an early 20th century building constructed for religious purposes in the Late Gothic Revival style. Few public buildings of this character and architectural style were constructed in Marion and Grant County. The exterior features random-course limestone rubble walls, a distinctive, massive, semicircular apse, and Tudor Revival details executed in dressed stone. The interior was designed around the Akron Plan, as shown by the dramatic Sunday School assembly room, with its two-story semicircular space.

Narrative Statement of Significance (Provide at least **one** paragraph for each area of significance.)

ARCHITECTURE

Ground was broken for the First Presbyterian Church of Marion in 1903 and the building was dedicated in late 1904. The cost of the building was just over \$58,000. The architectural firm selected was Richards, McCarty & Bulford of Columbus, Ohio, who had just designed the city's new public library (1902) and went on to produce some of Columbus's most notable early 20th century architecture. Phillip Patton, a local contractor, constructed the building. The church remains largely in its original configuration with little loss of historic material. Interior

First Presbyterian Church

Name of Property

Grant County, IN

County and State

remodeling projects only updated certain finishes of the building, like lighting and painting. An addition was made to the northeast corner of the building in 1955 (left side of photo 0021), which also included a remodel of the chancel area and restored pipe organ, but these changes were sympathetic in style and respect the original design including exterior materials. By the late 20th century, modern bathrooms were added into one of the larger public rooms (a former chapel, see photo 0015), and modern finishes were installed in the basement classroom areas during the 1960s-2000s.

The building's unusual display of the Gothic Revival style, which is less formal, but no less grand, includes an asymmetrical front façade dominated by a corner entry tower and massive buttresses that extend to the crenelated parapet (photo 0018). The design includes a wide semicircular bay on its other main façade, facing Sixth Street (photo 0022). This façade features bays of windows divided by buttresses that wrap the semicircular wall. This wide two-story bay, and a number of other one-story projecting bays reduce the scale of the building's height, but also give it a sprawling effect on the corner of the city block. While many large public buildings were being constructed with dressed limestone or brick in Marion during the early 20th century, the congregation turned to locally quarried flagstone described as "gray" or "blue limestone" to face the walls. The random-laid flagstone, curved wall, buttresses, and crenulations work together to give the building a medieval castle-like appearance. The building also features Tudor Gothic arched entries and windows with beautiful art glass framed with wood tracery. The interior also features a number of important Gothic details like groin-vaulted ceilings, tall, slender octagonal columns and pilasters (see photo 0009, 0017), and extensive woodwork that features pointed arches (see photos 0013-0015). The building has two fireplaces that are important features of the building, demonstrating the level of refinements included in the sophisticated design (photos 0012-0013). Another unusual feature is the massive wood door that rolls up and down, bi-parting in the middle, into the ceiling and floor of the narthex to separate the Sunday school space from the nave (right side of photo 0010, 0017). The building retains its original woodwork and pews, which provides for a seating capacity of 450 people (photo 0008).

A few later improvements to the building should be noted. In 1938, as a donation in memory of Miriam Bahr Robertson, the previously unfinished space on the third level of the tower was renovated to become the "tower study" for ministers (photo 0001). In 1943, it was determined that the original chandelier-style lights in the sanctuary should be replaced with the extant art glass lantern-style lights (photo 0008). Their creation was inspired by architectural features of the building, built to include chains from the original manual chiming action of the tower bells and were fabricated by parishioner M. W. Heavilin. The lights were first used for the Maundy-Thursday service on April 22, 1943. Between 1940 and 1951, a church dining room and Sunday School classrooms in the basement were completed. The most significant change to the original building occurred between 1951-1955 when the chancel area was remodeled and an addition was made to its north side in memory of Harold M. Serviss (see photo 0020). The chancel remodel included the installation of the Reformation Window, in its center east wall, in 1951 (photo 0008). The addition included a choir robe room and a lounge for informal meetings (photo 0016), as well as a new chiming system for the pipe organ (dedicated in 1957). The total cost was \$67,590. The architect of the addition/remodel project was Carl M. Teutsch of Chicago.

First Presbyterian Church

Name of Property

Grant County, IN

County and State

There are a number of examples of Gothic Revival style in Marion and Grant County, mostly confined to religious buildings, into the early part of the 20th century. The style had been popularized in house design books in the middle part of the 1800s and became popular in Midwestern towns by the 1850s. At least one house in Grant County exhibits early Gothic Revival touches, probably derived from pattern books: a central-passage house in Liberty Township, built of brick c. 1850, features pointed-arch windows and a central gable. The pattern books gave hints for other building types. A.J. Davis' *Rural Residences* (1837) included a design for a Gothic Revival "Village Church" as well as Gothic Revival houses. A religious revival in Britain in the early 19th century renewed interest in church construction and in the English Gothic style. In religious architecture, Gothic Revival reached full expression in the United States.

While Gothic Revival remained a popular choice with American congregations, toward the end of the century, architects were moving away from generic Gothic and the more recent Romanesque Revival. Interest in Tudor Gothic Revival was capturing attention. Collegiate Gothic, inspired by Tudor Gothic architecture, took hold at places like Bryn Maur (Pembroke Hall, Stewardson & Cope, 1894). New churches by Medievalist Ralph Adams Cram helped set the trend. For example, All Saints, Ashmont, Dorchester, Massachusetts, 1893, was a purely English-inspired Gothic church. First Presbyterian Church in Marion is early for its style, compared to these very first examples.

The First Presbyterian Church is also a large, and early example of the Akron Plan. Lewis Miller is credited with the development of the plan for his own church in Akron, Ohio in 1867. Miller was an amateur architect and Sunday School teacher. His church, First Methodist Church of Akron, was completed in 1872. Miller's plan placed the altar in one corner of the sanctuary with sections of pews that radiated out from that location. Children could also participate in services by the inclusion of large, movable screen walls at one end of the sanctuary. This provided the ability to close off classroom spaces as dictated by the flow of the service. Akron Plan floors are also often banked to provide better sightlines for congregants. Miller's plan was used with great regularity as Methodist and other Protestant congregations grew and included Sunday Schools during worship services in the late 1800s and early 1900s. First Presbyterian is an exceptional example due to its size, but also in the development of the radiating classrooms of the apse, and the massive movable wood wall that divided the space off from the remaining sanctuary.

Marion experienced a significant boon in the last decades of the 19th century, into the first decade of the 20th century due to the development of the natural gas industry in Grant County. This resulted in the construction of several large public buildings, one of the first being the Grant County Courthouse built in 1881-1883, and one of the last, the public library, was constructed in 1902 and was also designed by Richards, McCarty & Bulford (architectural firm responsible for First Presbyterian). Both of these government-funded buildings used the Neoclassical style, but religious buildings of similar scale to First Presbyterian also turned to the Gothic Revival style. The Episcopalian congregation built its house of worship, Gethsemane Episcopal (111 E. 9th Street), in 1890. The limestone building features a cruciform plan with corner tower. St. Paul's Catholic Church (915 S. Branson Street) was built 1895-1897 in a high version of the Late Gothic style. The brick building's front facade features tall twin towers and a steeply-pitched

First Presbyterian Church

Name of Property

Grant County, IN

County and State

front gable. Before the turn of the century, the federal government built a new chapel at the National Military Home located in Marion. The smaller-scaled brick building was built in 1899 with a cruciform plan, but split into two sanctuaries for separate Catholic and Protestant use. The last large Gothic Revival church constructed in Marion was the First Friends Church (1501 S. Adams) built in a more modern version of the style in 1914. The large brick building features crenelated parapets and is trimmed with limestone. With the exception of the chapel at the National Military Home, the other churches mentioned previously are within a few blocks of the First Presbyterian Church. It should be noted that when a portion of the Presbyterian congregation left and formed a new church, Westminster Presbyterian, they constructed their new building in the Colonial Revival style (1951-1952) north of the downtown.

Most of the other examples of the Gothic Revival style in Grant County, as applied to churches, are smaller-scaled, gable-front rural churches constructed between about 1894-1910. Twelve examples of Gothic Revival churches are scattered throughout the county in small towns and rural township locations. The buildings typically feature facades with steeply-pitched roofs and simple pointed-arch windows. Many are brick with corner entry towers and a few have crenelated parapets on the towers.

Developmental History/Additional historic context information

Grant County was organized in 1831 and Marion, settled near the center of the county on the banks of the Mississinewa River, was named the county seat. Within five years, a Presbyterian circuit rider named Dr. Martin Post preached the first sermon of that denomination to nine individuals gathered in a meeting room at fellow-Presbyterian Riley Marshall's tavern in Marion. The tavern had a public meeting hall that also served Grant County's court and election needs. Religious services were later held at Marshall's barn on the opposite side of the Mississinewa River and congregants were ferried across the river to attend. The Presbyterian denomination in the United States was first introduced by Francis Makemie, a pastor who came to the colonies from Ireland in 1683. Marion's First Presbyterian Church was organized October 3, 1843, as a mission church in the settlement, and the first Sabbath school in Marion was taught under the Presbyterian congregation by January 1845. The first pastor was Samuel Steel who served the congregation just one year, from 1843-1844. The original elders of the congregation were Adam Morrow (serving from 1843-1853) and Jacob Smith (serving from 1843-1847). Other organizers were John Gilbert, Willian Anthony, Martin Gingery, Mary Redick, Abigail Trask, and Sarah Sweetser. The first adult baptism was conducted in 1843. The first infant baptism was conducted the following year, and the first communion service was administered to fifteen members in 1844. Leading up to the time the congregation built their first church, services were held in a school house near 8th and Washington Streets.

The Presbyterians constructed their first house of worship in 1847 on the corner of 5th and Branson Streets, a block southeast of the courthouse square. The building was a 40' x 80' gable-front frame building with simple Greek Revival features. A bronze bell was donated by friends of the congregation in the eastern part of the United States. The 400 pound bell hung in the church portico and was the first bell in Marion. The congregation continued to meet through the

First Presbyterian Church

Grant County, IN

Name of Property

County and State

1850s under the Reverend Samuel Sawyer, who also established a Presbyterian college in Marion. However, during the Civil War, Reverend Sawyer enlisted as a chaplain and no regular Presbyterian services were held in Marion, except by traveling student pastors, and communion was not administered for a period of five years.

By the early 1870s, the Presbyterian congregation began to consider the need for a new house of worship at the same site. The second church was constructed 1871-1878 in the Gothic Revival style and was a larger two-story brick building with a corner tower. The basement of the building was used by the congregation for services until the sanctuary was completed. Later the basement was used for a high school class of seven students. The 100 members were under Pastor Dr. Charles Wallace. Membership grew steadily during the 1880s and 1890s, in large part due to the boom experienced in industry in Marion. A building committee met as early as 1893 to determine if the building, less than twenty years old, should be enlarged to support the increase in membership. However, a second building committee that formed in 1899, decided not to enlarge their current house of worship and instead recommended the construction of a new building at another site. This may have been in response to seeing other congregations build large new houses of worship, including the Episcopalians and Catholics in 1890 and 1895, respectively.

Anticipating the need for a new site, a house at the corner of 6th and Gallatin Streets was purchased in 1896 and the house (Tingley Homestead) was sold and removed from the site. The congregation sold their original church property for \$10,250.00 (the former church is no longer extant). Services for the 200 members were held in the newly-constructed Marion Public Library auditorium, just one block east of the new site, during the new building's construction. The estimate for construction was \$58,318.13 and the cornerstone was laid on June 17, 1903. Contents of the cornerstone, still sealed, include newspapers, coins, books, sermons, and photos. The building was completed and the first service was held on November 11, 1904. The building was dedicated on December 11, 1904. A few days later, the new church pipe organ was dedicated. The value of the 1500-pipe Estey organ alone was \$4700. The pastor during the church's construction was Reverend Freely Rohrer. By the 1920s, church membership had increased to 641.

During the 1950s, a part of the congregation established the Westminster Presbyterian Church north of the downtown, which caused the membership to decline. Possibly in response to this, programs aimed at the church's children and youth were undertaken through the 1960s-1970s. In the late 1980s and into the early 1990s, additional renovations were made to include new restrooms and improvements to the dining hall and kitchen. The church celebrated the 150th year of its founding in 1993, but by 1995, it began to re-evaluate its mission which led to the congregation's departure from the building in 2001. At that time another religious organization, God's House Ministries, purchased the building and began to hold services with a focus on youth and neighborhood outreach.

First Presbyterian Church
Name of Property

Grant County, IN
County and State

9. Major Bibliographical References

Bibliography (Cite the books, articles, and other sources used in preparing this form.)

Carr, Mrs. Earl (Anna Waggoner), *One Hundred Years: First Presbyterian Church 1843-1943*.

Centennial Service Program, First Presbyterian Church, October 3, 1943.

Church file of the Marion Public Library: First Presbyterian folder: accessed February 7, 2017.

“Contract has been Awarded”. *Marion News-Tribune* 18 May 1904. Page 3.

First Congregational Church (Michigan City, IN) National Register of Historic Places nomination form, 2001.

First Presbyterian Church 125th Anniversary Yearbook & Directory, 1968.

First Presbyterian Church, *Architectural Comments*, c. 1985 (no author listed).

First Presbyterian Church Record, Marion, Indiana 1843-1906.

Historic Sites and Structures of Grant County, Indiana. Indianapolis: Historic Landmarks Foundation of Indiana, 1993.

History of Grant County, Indiana. Chicago: Brant & Fuller, 1886.

Marler, Mrs. Roberta B. (Pauline), church historian, First Presbyterian Church Sesquicentennial Celebration, *The Road We Have Traveled 1843-1993*.

White, Joseph M. Where God's People Meet. Noblesville: Guild Press of Indiana, 1996.

Previous documentation on file (NPS):

- preliminary determination of individual listing (36 CFR 67) has been requested
- previously listed in the National Register
- previously determined eligible by the National Register
- designated a National Historic Landmark
- recorded by Historic American Buildings Survey # _____

First Presbyterian Church
Name of Property

Grant County, IN
County and State

_____ recorded by Historic American Engineering Record # _____
_____ recorded by Historic American Landscape Survey # _____

Primary location of additional data:

_____ State Historic Preservation Office
_____ Other State agency
_____ Federal agency
_____ Local government
_____ University
_____ Other
Name of repository: _____

Historic Resources Survey Number (if assigned): 053-384-37203

10. Geographical Data

Acreeage of Property Less than one acre

Use the UTM system

UTM References

Datum (indicated on USGS map):

NAD 1927 or NAD 1983

- | | | |
|-------------|-----------------|-------------------|
| 1. Zone: 16 | Easting: 613298 | Northing: 4490350 |
| 2. Zone: | Easting: | Northing: |
| 3. Zone: | Easting: | Northing: |
| 4. Zone: | Easting : | Northing: |

Verbal Boundary Description (Describe the boundaries of the property.)

Beginning on the north side of 6th Street, at the intersection of Gallatin Street, face north and continue in a line 135' with the east curb of Gallatin Street to the south side of the alley between 5th and 6th Streets. Turn east and continue in a line 135' to the west side of the alley between Gallatin and Boots Street. Turn south and continue in a line 135' with the west edge

First Presbyterian Church

Grant County, IN

Name of Property

County and State

of the alley to the north side of 6th Street. Then turn west and continue in a line 135' with the north curb of 6th Street to the east curb of Gallatin Street. This is Lot 2 of Boots Addition to the City of Marion.

Boundary Justification (Explain why the boundaries were selected.)

The property described above is the lot purchased by the First Presbyterian Church congregation for the construction of their new church in 1903-1904. The church building essentially fills the entire lot and is bounded on all four sides by public roads or alleys.

11. Form Prepared By

name/title: Kurt West Garner
organization: God's House Ministries/PIP
street & number: 12954 6th Road
city or town: Plymouth state: IN zip code: 46563
e-mail: kwgarner@kwgarner.com
telephone: 574-936-0613
date: March 13, 2017

Additional Documentation

Submit the following items with the completed form:

- **Maps:** A **USGS map** or equivalent (7.5 or 15 minute series) indicating the property's location.
- **Sketch map** for historic districts and properties having large acreage or numerous resources. Key all photographs to this map.
- **Additional items:** (Check with the SHPO, TPO, or FPO for any additional items.)

First Presbyterian Church
Name of Property

Grant County, IN
County and State

Photographs

Submit clear and descriptive photographs. The size of each image must be 3000x2000 at 300 ppi (pixels per inch) or larger. Key all photographs to the sketch map. Each photograph must be numbered and that number must correspond to the photograph number on the photo log. For simplicity, the name of the photographer, photo date, etc. may be listed once on the photograph log and doesn't need to be labeled on every photograph.

Photo Log

Name of Property: First Presbyterian Church

City or Vicinity: Marion

County: Grant State: IN

Photographer: Kurt West Garner

Date Photographed: February 7, 2017

Description of Photograph(s) and number, include description of view indicating direction of camera: Tower Study, looking southwest

1 of 22.

Name of Property: First Presbyterian Church

City or Vicinity: Marion

County: Grant State: IN

Photographer: Kurt West Garner

Date Photographed: February 7, 2017

Description of Photograph(s) and number, include description of view indicating direction of camera: Second level landing in front tower/entry, looking southwest

2 of 22.

Name of Property: First Presbyterian Church

City or Vicinity: Marion

First Presbyterian Church

Grant County, IN

Name of Property

County and State

County: Grant State: IN

Photographer: Kurt West Garner

Date Photographed: February 7, 2017

Description of Photograph(s) and number, include description of view indicating direction of camera: Front entry vestibule, looking southwest

3 of 22.

Name of Property: First Presbyterian Church

City or Vicinity: Marion

County: Grant State: IN

Photographer: Kurt West Garner

Date Photographed: February 7, 2017

Description of Photograph(s) and number, include description of view indicating direction of camera: Back entry vestibule, looking southwest

4 of 22.

Name of Property: First Presbyterian Church

City or Vicinity: Marion

County: Grant State: IN

Photographer: Kurt West Garner

Date Photographed: February 7, 2017

Description of Photograph(s) and number, include description of view indicating direction of camera: Classroom off back entry vestibule, looking northeast

5 of 22.

Name of Property: First Presbyterian Church

City or Vicinity: Marion

First Presbyterian Church
Name of Property

Grant County, IN
County and State

County: Grant State: IN

Photographer: Kurt West Garner

Date Photographed: February 7, 2017

Description of Photograph(s) and number, include description of view indicating direction of camera: South wall of nave, looking southeast

6 of 22.

Name of Property: First Presbyterian Church

City or Vicinity: Marion

County: Grant State: IN

Photographer: Kurt West Garner

Date Photographed: February 7, 2017

Description of Photograph(s) and number, include description of view indicating direction of camera: Sunday School Assembly space (semicircular bay), looking west

7 of 22.

Name of Property: First Presbyterian Church

City or Vicinity: Marion

County: Grant State: IN

Photographer: Kurt West Garner

Date Photographed: February 7, 2017

Description of Photograph(s) and number, include description of view indicating direction of camera: Nave, looking toward chancel/east

8 of 22.

Name of Property: First Presbyterian Church

First Presbyterian Church

Grant County, IN

Name of Property

County and State

City or Vicinity: Marion

County: Grant State: IN

Photographer: Kurt West Garner

Date Photographed: February 7, 2017

Description of Photograph(s) and number, include description of view indicating direction of camera: Narthex, looking south

9 of 22.

Name of Property: First Presbyterian Church

City or Vicinity: Marion

County: Grant State: IN

Photographer: Kurt West Garner

Date Photographed: February 7, 2017

Description of Photograph(s) and number, include description of view indicating direction of camera: North wall of nave, looking northeast

10 of 20.

Name of Property: First Presbyterian Church

City or Vicinity: Marion

County: Grant State: IN

Photographer: Kurt West Garner

Date Photographed: February 7, 2017

Description of Photograph(s) and number, include description of view indicating direction of camera: Back hall off south end of chancel, looking north

11 of 22.

Name of Property: First Presbyterian Church

First Presbyterian Church
Name of Property

Grant County, IN
County and State

City or Vicinity: Marion
County: Grant State: IN
Photographer: Kurt West Garner
Date Photographed: February 7, 2017

Description of Photograph(s) and number, include description of view indicating direction of camera: Fireplace in office/study, looking east

12 of 22.

Name of Property: First Presbyterian Church
City or Vicinity: Marion
County: Grant State: IN
Photographer: Kurt West Garner
Date Photographed: February 7, 2017

Description of Photograph(s) and number, include description of view indicating direction of camera: Fireplace in former Ladies Parlor/office, looking east

13 of 22.

Name of Property: First Presbyterian Church
City or Vicinity: Marion
County: Grant State: IN
Photographer: Kurt West Garner
Date Photographed: February 7, 2017

Description of Photograph(s) and number, include description of view indicating direction of camera: Pocket doors in west wall of former Ladies Parlor/office, looking northwest

14 of 22.

Name of Property: First Presbyterian Church

First Presbyterian Church
Name of Property

Grant County, IN
County and State

City or Vicinity: Marion
County: Grant State: IN
Photographer: Kurt West Garner
Date Photographed: February 7, 2017

Description of Photograph(s) and number, include description of view indicating direction of camera: Hallway and toilet rooms of former Christian Endeavor Chapel, looking west
15 of 22.

Name of Property: First Presbyterian Church
City or Vicinity: Marion
County: Grant State: IN
Photographer: Kurt West Garner
Date Photographed: March 10, 2017

Description of Photograph(s) and number, include description of view indicating direction of camera: Looking north in 1955 lounge/meeting room addition
16 of 22.

Name of Property: First Presbyterian Church
City or Vicinity: Marion
County: Grant State: IN
Photographer: Kurt West Garner
Date Photographed: March 10, 2017

Description of Photograph(s) and number, include description of view indicating direction of camera: Looking west from chancel toward narthex
17 of 22.

First Presbyterian Church

Grant County, IN
County and State

Name of Property

Name of Property: First Presbyterian Church

City or Vicinity: Marion

County: Grant State: IN

Photographer: Kurt West Garner

Date Photographed: March 10, 2017

Description of Photograph(s) and number, include description of view indicating direction of camera: Looking northeast at front façade from Sixth Street and Gallatin Street

18 of 22.

Name of Property: First Presbyterian Church

City or Vicinity: Marion

County: Grant State: IN

Photographer: Kurt West Garner

Date Photographed: March 10, 2017

Description of Photograph(s) and number, include description of view indicating direction of camera: Looking northwest at front façade from Sixth Street and alley

19 of 22.

Name of Property: First Presbyterian Church

City or Vicinity: Marion

County: Grant State: IN

Photographer: Kurt West Garner

Date Photographed: March 10, 2017

Description of Photograph(s) and number, include description of view indicating direction of camera: Looking west at east façade

20 of 22.

First Presbyterian Church

Grant County, IN

Name of Property

County and State

Name of Property: First Presbyterian Church

City or Vicinity: Marion

County: Grant State: IN

Photographer: Kurt West Garner

Date Photographed: March 10, 2017

Description of Photograph(s) and number, include description of view indicating direction of camera: Looking southwest at back (north) façade from intersection of alleys

21 of 22.

Name of Property: First Presbyterian Church

City or Vicinity: Marion

County: Grant State: IN

Photographer: Kurt West Garner

Date Photographed: March 10, 2017

Description of Photograph(s) and number, include description of view indicating direction of camera: Looking east at west façade from Gallatin Street

22 of 22.

Paperwork Reduction Act Statement: This information is being collected for applications to the National Register of Historic Places to nominate properties for listing or determine eligibility for listing, to list properties, and to amend existing listings. Response to this request is required to obtain a benefit in accordance with the National Historic Preservation Act, as amended (16 U.S.C.460 et seq.).

Estimated Burden Statement: Public reporting burden for this form is estimated to average 100 hours per response including time for reviewing instructions, gathering and maintaining data, and completing and reviewing the form. Direct comments regarding this burden estimate or any aspect of this form to the Office of Planning and Performance Management, U.S. Dept. of the Interior, 1849 C. Street, NW, Washington, DC.

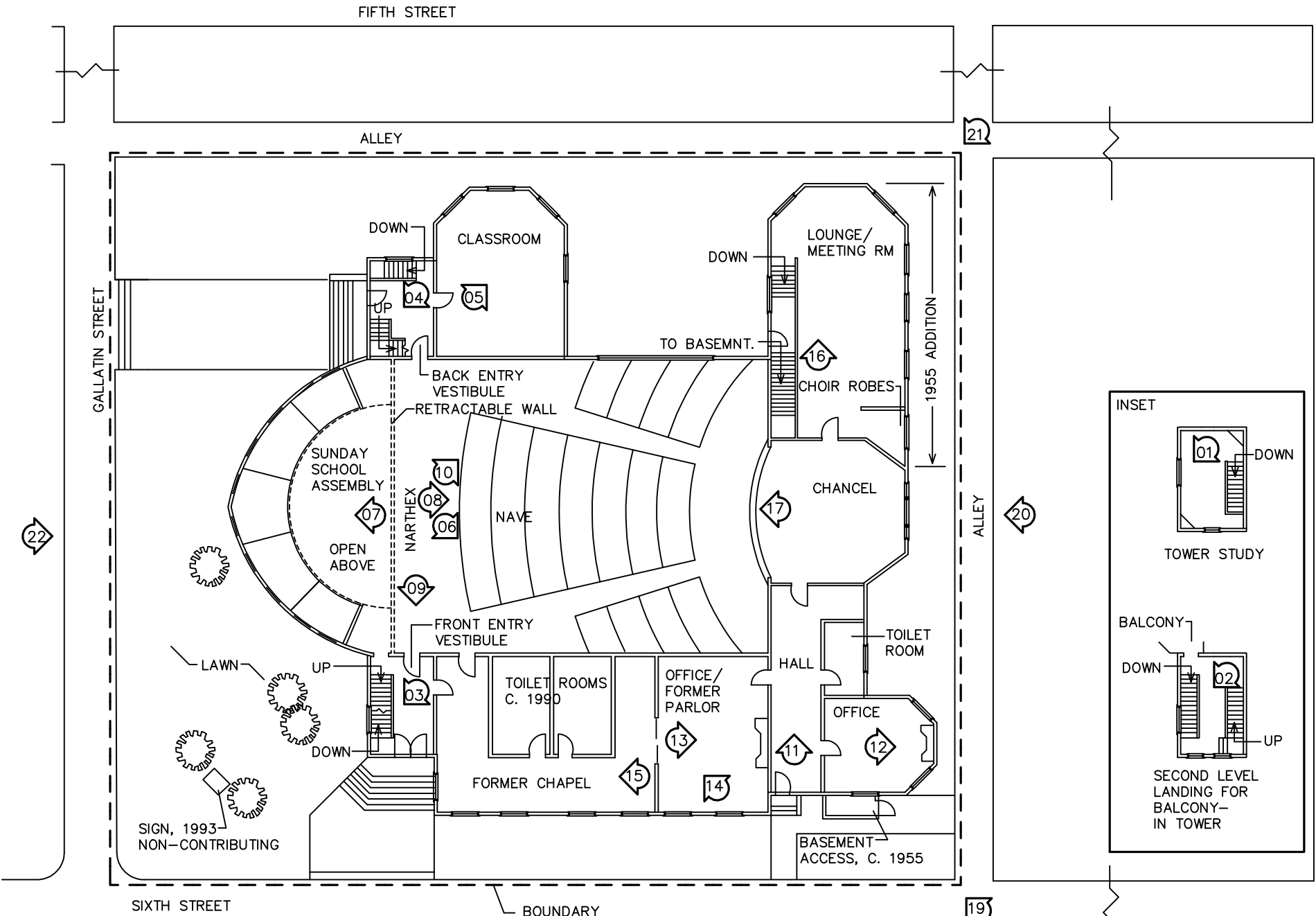

18 FIRST PRESBYTERIAN CHURCH
 NATIONAL REGISTER SITE PLAN
 MARION, GRANT COUNTY, IN



02 = PHOTOGRAPHS

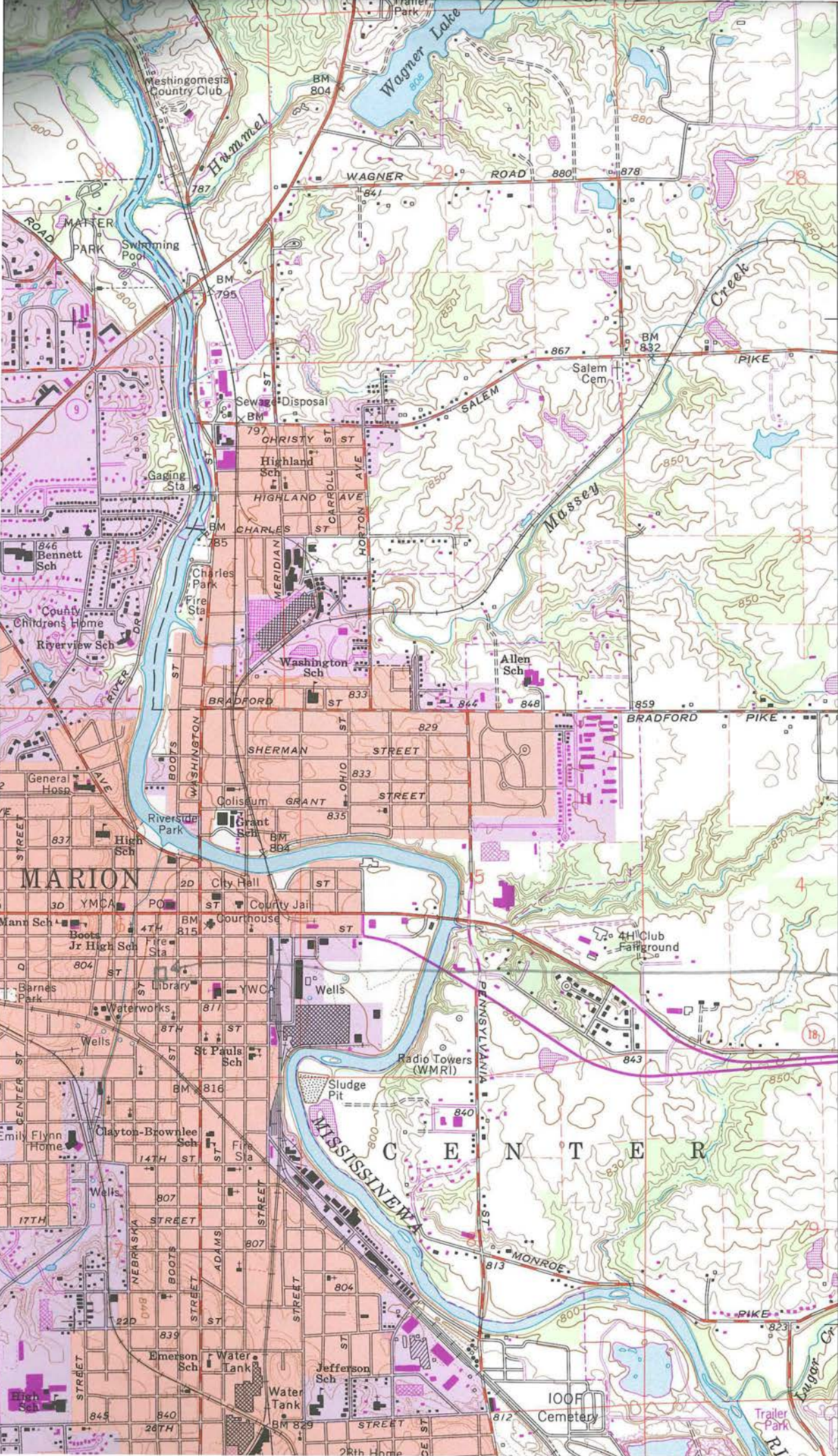

4494
35'
4493
4492
T. 25 N.
T. 24 N.
4490
4489
32'30"

First PRESBYTERIAN
CHURCH - NATIONAL REGISTER
MARION, GRANT CO., IA
NAD 83
UTM:
16 013298 4490350





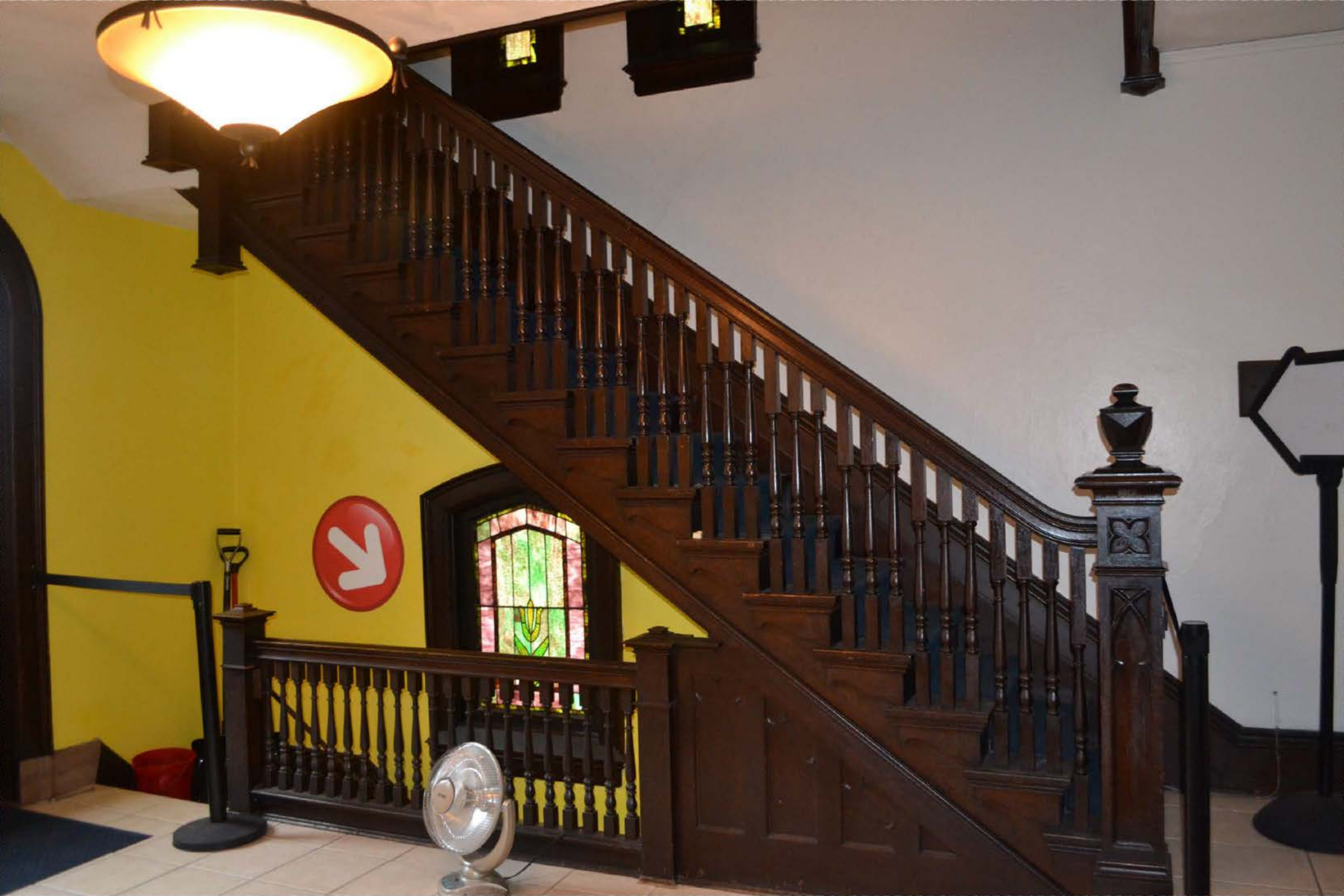













restrooms ↑







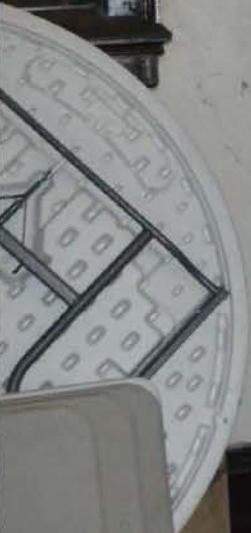







Men



MAN CAVE

U.S. AIR FORCE
SERVICE
SUNNYVALE







GOD'S HOUSE
MINISTRIES





Worship Center

20





UNITED STATES DEPARTMENT OF THE INTERIOR
NATIONAL PARK SERVICE

NATIONAL REGISTER OF HISTORIC PLACES
EVALUATION/RETURN SHEET

Requested Action: Nomination

Property Name: First Presbyterian Church

Multiple Name: _____

State & County: INDIANA, Grant

Date Received: 10/22/2018 Date of Pending List: 11/16/2018 Date of 16th Day: 12/3/2018 Date of 45th Day: 12/6/2018 Date of Weekly List: _____

Reference number: SG100003184

Nominator: State

Reason For Review:

X Accept Return Reject 12/3/2018 Date

Abstract/Summary Comments: Excellent example of late Gothic Revival, executed in native limestone. The church features a modified Akron plan.

Recommendation/ Criteria: Accept / C

Reviewer Jim Gabbert Discipline Historian

Telephone (202)354-2275 Date _____

DOCUMENTATION: see attached comments : No see attached SLR : No

If a nomination is returned to the nomination authority, the nomination is no longer under consideration by the National Park Service.



Division of Historic Preservation & Archaeology • 402 W. Washington Street, W274 • Indianapolis, IN 46204-2739
Phone 317-232-1646 • Fax 317-232-0693 • dhpa@dnr.IN.gov • www.IN.gov/dnr/historic



October 18, 2018

Ms. Joy Beasley
Keeper of the National Register
National Register of Historic Places
Mail Stop 7228
1849 C St, NW
Washington, D.C. 20240

Re: First Presbyterian Church, Marion, Grant County, Indiana

Dear Ms. Beasley,

Enclosed is a National Register of Historic Places nomination for the First Presbyterian Church, Marion, Grant County, Indiana. The Indiana Historic Preservation Review Board reviewed the application and voted to recommend its approval to the National Register of Historic Places.

The enclosed disc contains the true and correct copy of the nomination for the First Presbyterian Church, Marion, Grant County, Indiana to the National Register of Historic Places.

Please address any questions you or your staff may have about this nomination to my National Register staff members, Paul Diebold or Holly Tate.

Sincerely,

Cameron F. Clark
State Historic Preservation Officer

CFC:PCD:pcd

enclosure: nomination package