

BUILDING AND STRUCTURES

STATE OF CONNECTICUT
 CONNECTICUT HISTORICAL COMMISSION
 59 SOUTH PROSPECT STREET, HARTFORD, CONNECTICUT 06106
 1203, 566 3005

Item #55

TOWN OF WINDSOR

Town No. **06095** Site No. **1869-513-704**
 Date: **6/13/82**
 County: **Hartford**
 District: **Hartford North**
 If not specified: Actual Potential

1. BUILDING NAME (if common): _____
 2. TOPOGRAPHY: _____
 3. ADDRESS: **46 Court Street, Windsor, CT 06095**
 4. OFFICE: **Residential**
 5. TYPE OF BUILDING: **Residential**

6. ACCESSIBILITY: Yes No
 7. DATE OF CONSTRUCTION: **c. 1873**
 8. MATERIALS:
 - Masonry: Brick Other (Specify):
 - Siding: Asphalt Fieldstone
 - Board & Batten: Slat Cobblestone
 - Aluminum: Concrete Cast stone Details
 - Steel: Steel Structural iron or steel

9. ROOF: Asphalt shingle Roll asphalt Slate Other (Specify):
 - Gable: Flat Mansard Monitor Gambrel
 - Shed: Hip Round Other (Specify):
 - Wood shingle: Asphalt Tin Stone Other (Specify):
 10. FOUNDATION: Full Partial Elevated Excellent Good Fair Poor Deteriorated
 11. NUMBER OF STORIES: **3 1/2 x 3 1/2**
 12. RELATED OUTBUILDINGS OR LANDSCAPE FEATURES:
 Barn Shed Garage Other landscape features or buildings (Specify):
 Carriage house Shop Garden
 Open land Residential Scattered buildings visible from site
 Commercial Industrial Retail High building density

13. INTERRELATIONSHIP OF BUILDING AND SURROUNDINGS:
 Located on the west side of Court Street, an area very near Windsor Center in predominantly residential use.
 (OVER)

DESCRIPTION (Continued)
 2 story masonry dwelling with flat roof, and bold, projecting eaves. House has 2 story, north side ell and 1 story, south side ell. Penetration is symmetrical with segmental arch window openings. Each window has a segmental arch window head. Entries are from the sides under Italianate entry porches. The south side entry has a paneled door with sidelights.

SIGNIFICANCE
 Example of Italianate style duplex here executed in masonry. Compare this dwelling with other masonry houses at 116-118 Pogunock and 32-34 Maple Avenues. This house was built for H. Sidney Hayden about 1874. He was very active in developing the residential areas around Windsor Center in the late 19th century. (See forms for Loomis and Maple Avenues.) Upon his death he gave the house to his sister Sarah Powers. The 1915 resident is John H. Williams, who is a book dealer.

SOURCES
 Windsor Land Records, Vol. 63, pg. 371
 Stiles, Vol. I, pg. 466
 Hartford Suburban Directory: 1915-16
 Greater Hartford Directory: 1930
 Town of Windsor Assessor's Office

PHOTO
 NAME: Michael K. O'Leary
 ADDRESS: 275 Broad Street, Windsor, CT 06095
 DATE: 4/1/81
 ORGANIZATION: Preston Hayward
 DATE: Spring, 1981
 ORGANIZATION: Planning Consultant - Town of Windsor

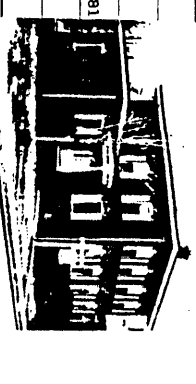

COMPILED BY: _____
 PHOTO: _____
 SOURCES: _____
 SIGNIFICANCE: _____
 DESCRIPTION (Continued): _____

AUG - 3 1982