

FORM B - BUILDING

AREA	FORM NO.
	528

MASSACHUSETTS HISTORICAL COMMISSION  
 294 WASHINGTON STREET, BOSTON, MA 02108

Town Taunton ✓

Address 171 Shores Street ✓

Historic Name Asa Lincoln House ✓

Present Owner: Edwin F. Nixon

Use: Present Residence

Original Residence

DESCRIPTION:

Date c. 1760; Portion-17th Century

Source OCHS Records

Style Georgian

Architect Unknown

Exterior wall fabric Clapboards

Outbuildings None

Major alterations (with dates) \_\_\_\_\_

Side lean-to converted to ell.

20th Century

Moved No Date \_\_\_\_\_

Approx. acreage Less than one

Setting Rural

PHOTO: (3x3" or 3x5", black & white)  
 staple to left side of form

Photo number \_\_\_\_\_

SKETCH Mar

Show property's location in relation to nearest cross streets and/or geographical features. Indicate all buildings between inventoried property and nearest intersection. Indicate north.

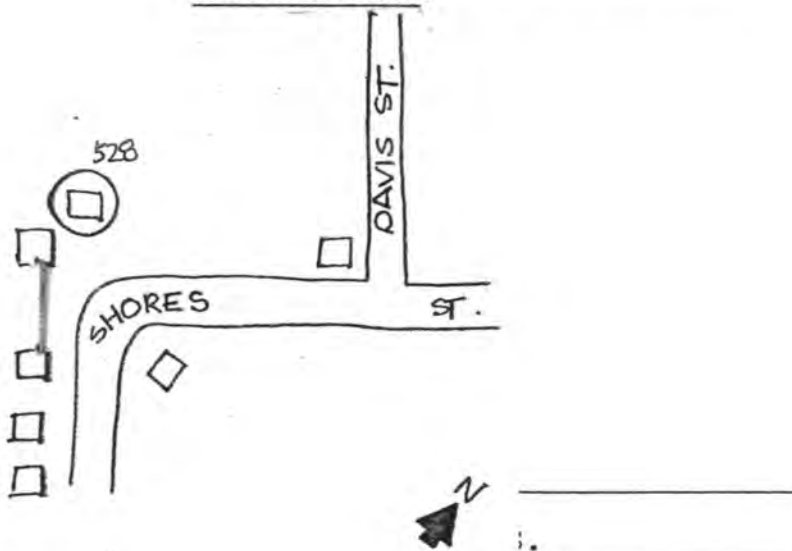

Date 10/26/79

19/323750/4640750

(Staple additional sheets here)

ARCHITECTURAL SIGNIFICANCE (Describe important architectural features and evaluate in terms of other buildings within the community.)

The asymmetrically-bayed, 1½-story house features a central chimney, central entrance, and 6/6 sash windows that are irregularly spaced. Its ell is enlarged from a small lean-to that may be contemporary with the main block.

HISTORICAL SIGNIFICANCE (Explain the role owners played in local or state history and how the building relates to the development of the community.)

This simple vernacular house is significant for its status as the original homestead of Asa Lincoln, one of Taunton's first settlers.

While some records show a construction date of c. 1760 for the house, examination of the structure's interior framing system raises the possibility that sections of the building may predate the 18th century.

Possessing integrity of location, design, setting, materials, workmanship and association, the Asa Lincoln House meets criteria A and C of the National Register of Historic Places as one of the best preserved examples in Taunton of the modest architecture of early homesteads.

*Boundaries conform to current lot lines.*

BIBLIOGRAPHY and/or REFERENCES (name of publication, author, date and publisher)

Dated Photos, OCHS

Appraisal, Philip LaFrance, THDC

United States Department of the Interior  
National Park Service

National Register of Historic Places  
Inventory—Nomination Form

For NPS use only  
received  
date entered

Continuation sheet

Item number

Page 5 of 9

Multiple Resource Area  
Thematic Group

Name Taunton Multiple Resource Area  
State Bristol County, MASSACHUSETTS

Nomination/Type of Review

Date/Signature

- |   |                                     |            |                             |
|---|-------------------------------------|------------|-----------------------------|
| 41. Leonard, James, House                     | Entered in the<br>National Register | for Keeper | <u>Delores Byers 7/5/84</u> |
|   |                                     | Attest     | _____                       |
| 42. Leonard School                            | Entered in the<br>National Register | for Keeper | <u>Delores Byers 7/5/84</u> |
|   |                                     | Attest     | _____                       |
| 43. Lincoln, Ambrose Jr., House               | Entered in the<br>National Register | for Keeper | <u>Delores Byers 7/5/84</u> |
|   |                                     | Attest     | _____                       |
| 44. Lincoln, Asa, House                       | Entered in the<br>National Register | for Keeper | <u>Delores Byers 7/5/84</u> |
|   |                                     | Attest     | _____                       |
| 45. Lincoln, Gen. Thomas,<br>House            | Entered in the<br>National Register | for Keeper | <u>Delores Byers 7/5/84</u> |
|   |                                     | Attest     | _____                       |
| 46. Lord-Baylies-Bennett House                | Entered in the<br>National Register | for Keeper | <u>Delores Byers 7/5/84</u> |
|   |                                     | Attest     | _____                       |
| 47. Lothrop, H. B., Store                     | Entered in the<br>National Register | for Keeper | <u>Delores Byers 7/5/84</u> |
|   |                                     | Attest     | _____                       |
| 48. Lothrop Memorial Building-<br>G.A.R. Hall | Entered in the<br>National Register | for Keeper | <u>Delores Byers 7/5/84</u> |
|   |                                     | Attest     | _____                       |
| 49. Macomber, Calvin T., House                | Entered in the<br>National Register | for Keeper | <u>Delores Byers 7/5/84</u> |
|   |                                     | Attest     | _____                       |
| 50. Marvel, Theodore L., House                | Entered in the<br>National Register | for Keeper | <u>Delores Byers 7/5/84</u> |
|   |                                     | Attest     | _____                       |

NATIONAL REGISTER OF HISTORIC PLACES  
EVALUATION/RETURN SHEET

Lincoln, Asa, House (Taunton MRA)  
Bristol County  
MASSACHUSETTS

Working No. MAY 21 1984  
Fed. Reg. Date: 2.5.85  
Date Due: 6-21-84 / 7-5-84  
Action:  ACCEPT 7-5-84  
 RETURN  
 REJECT  
Federal Agency: \_\_\_\_\_

Entered in the  
National Register

- resubmission
- nomination by person or local government
- owner objection
- appeal

Substantive Review:  sample  request  appeal  NR decision

Reviewer's comments:

Recom./Criteria \_\_\_\_\_  
Reviewer \_\_\_\_\_  
Discipline \_\_\_\_\_  
Date \_\_\_\_\_  
\_\_\_\_\_ see continuation sheet

Nomination returned for: \_\_\_\_\_ technical corrections cited below  
\_\_\_\_\_ substantive reasons discussed below

1. Name

2. Location

3. Classification

Category	Ownership	Status	Present Use
	Public Acquisition	Accessible	

4. Owner of Property

5. Location of Legal Description

6. Representation in Existing Surveys

Has this property been determined eligible?  yes  no

7. Description

Condition		Check one	Check one
<input type="checkbox"/> excellent	<input type="checkbox"/> deteriorated	<input type="checkbox"/> unaltered	<input type="checkbox"/> original site
<input type="checkbox"/> good	<input type="checkbox"/> ruins	<input type="checkbox"/> altered	<input type="checkbox"/> moved date _____
<input type="checkbox"/> fair	<input type="checkbox"/> unexposed		

Describe the present and original (if known) physical appearance

- summary paragraph
- completeness
- clarity
- alterations/integrity
- dates
- boundary selection

---

**8. Significance**

Period \_\_\_\_\_ Areas of Significance—Check and justify below \_\_\_\_\_

Specific dates \_\_\_\_\_ Builder/Architect \_\_\_\_\_  
Statement of Significance (*in one paragraph*) \_\_\_\_\_

- summary paragraph
- completeness
- clarity
- applicable criteria
- justification of areas checked
- relating significance to the resource
- context
- relationship of integrity to significance
- justification of exception
- other

---

**9. Major Bibliographical References**

---

**10. Geographical Data**

Acreege of nominated property \_\_\_\_\_  
Quadrangle name \_\_\_\_\_  
UTM References \_\_\_\_\_

Verbal boundary description and justification \_\_\_\_\_

---

**11. Form Prepared By**

---

**12. State Historic Preservation Officer Certification**

The evaluated significance of this property within the state is:

\_\_\_\_\_ national \_\_\_\_\_ state \_\_\_\_\_ local

State Historic Preservation Officer signature \_\_\_\_\_

title \_\_\_\_\_ date \_\_\_\_\_

---

**13. Other**

- Maps
- Photographs
- Other

Questions concerning this nomination may be directed to \_\_\_\_\_

Signed \_\_\_\_\_ Date \_\_\_\_\_ Phone: \_\_\_\_\_



#528

Lincoln, Asa, House

Taunton NRA, Mae

MAY 1980



by Berkey

MAY 1980



by Berkey

TOWN MULTIPLE RESOURCE  
NOMINATION  
FORM NO. 528  
ASA LINCOLN HOUSE  
SCALE: 1" = 60'  
MAP NO. WD7, Pg. 21, Lot 13A  
ACREAGE .22

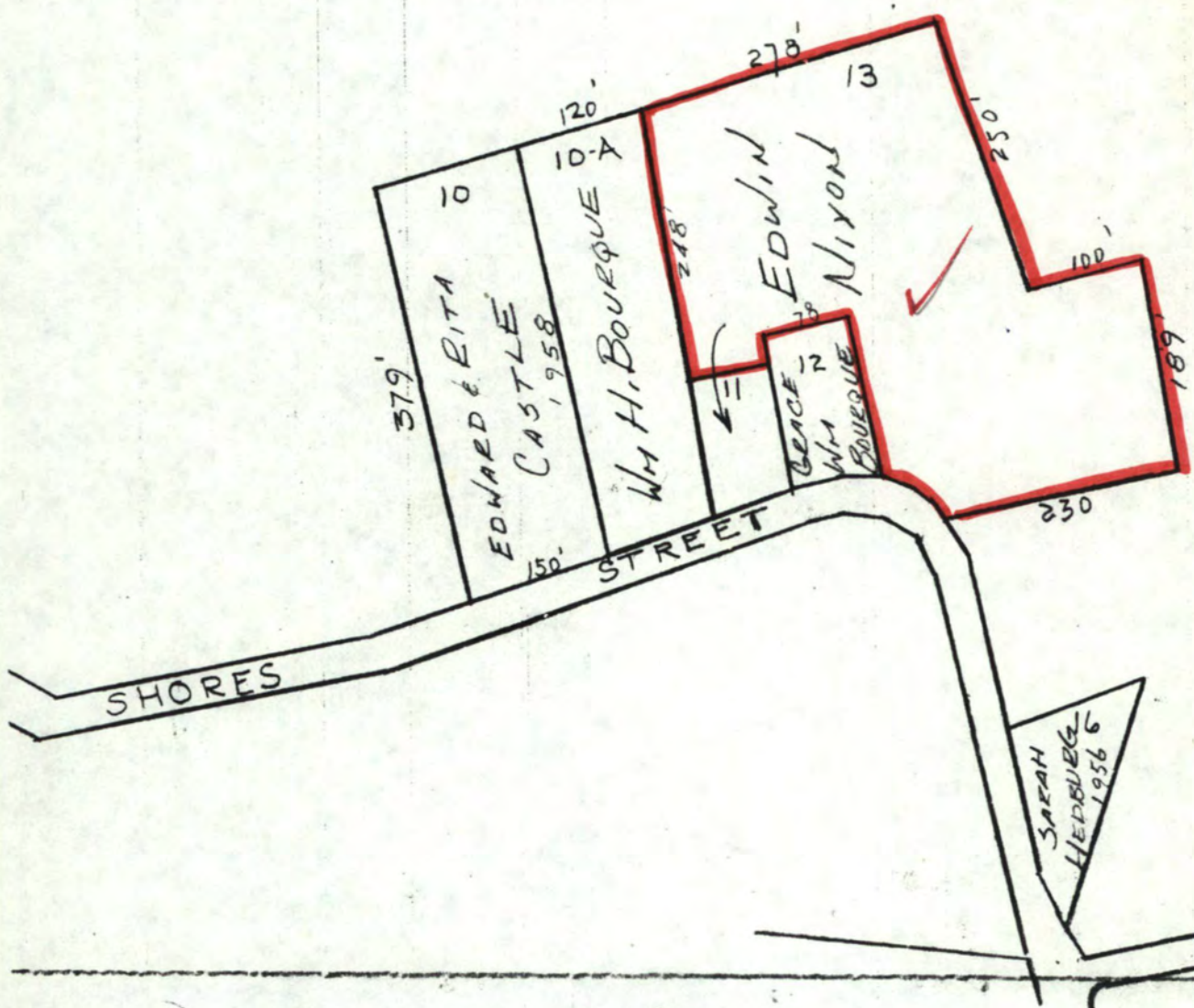

7-16 - 7-20

Date: unk.  
scale: 1" = 160'  
acres: 0.021  
WD 7 pg 21 lot 13A  
form # 328



5-10 - 2-20

Please refer to the map in the  
Multiple Property Cover Sheet  
for this property

Multiple Property Cover Sheet Reference Number: 64000297