



ARCHITECTURAL/HISTORICAL COMPONENT FORM

IMPORTANT: USE IN CONJUNCTION WITH THE GREEN INVENTORY RECORD FORM FOR RECORDING HISTORIC STRUCTURES AND DISTRICTS. USE SEPARATELY FOR RECORDING STRUCTURES LOCATED WITHIN DISTRICT BOUNDARIES.

- 1) Resource No. _____ 2) Temp No. 8 3) Name Lewis House
 4) Address 108 E. Simpson, Lafayette, CO 5) District Name Lafayette Coal Mining Era Buildings
I. INTEGRITY: 6) Condition: Good Fair _____ Deteriorated _____
 7) Original Use residence 8) Present Use museum
 9) Original Site Moved Date(s) of Move: 1910-1913
 10) Unaltered Altered Explain: A small addition has been built onto the rear (south) of the structure during Elmo Lewis' tenancy.

- II. DESCRIPTION:** 11) Building Materials frame
 12) Construction Date 1890s 13) Architect/Builder unknown
 14) Architectural Style(s) vernacular
 15) Special Features/Surroundings: The Lewis Home is a single story L-shaped residential structure with gable roofs and a small addition at the south side of the building. The foundation is of Lyons sandstone, the exterior material is narrow clapboard siding, and the roof is wooden shake shingles. The west side has a bay window with multiple wood framed double-hung windows in the bay. There is a very simple cornice head and surround
 16) Archaeological Potential: Yes No Unknown Explain: _____

III. CULTURAL ACTIVITIES: Key the resource type (ie: house, barn, shed, school, church, etc) to the cultural activity theme and sub-theme category associated with it.

	AREA OF SIGNIFICANCE		
17) THEME	industry		
18) SUB-THEME	coal		
19) TYPES	housing		

(Attach Photographs)

5, 6, 8
L-1
N, NW, SE

Frame Number _____
Roll Number _____
Facade Orientation _____

IV. SIGNIFICANCE: Assess whether or not the resource has any historical or architectural merit by checking appropriate categories and justifying below. Include any relevant historical data.

20) Architectural Significance:

- Represents work of a master
- Possesses high artistic values
- Represents a type, period, or method of construction

21) Historical Significance:

- Associated with significant persons
- Associated with significant events or patterns
- Contributes to the significance of an historic district

The Lewis House serves as an excellent example of a miner's home during Lafayette's coal era. Its simple design and small size are typical of the many structures which were once located at the mine sites, sold to miners, and moved into the community.

The Lewis House was one of the original miner's homes constructed in the 1890s at the Gladstone Mine near Lafayette. When the owner, Oscar Padfield, closed the mine, he gave the home to his son, Oscar Jr., who moved the structure to its present site after the start of the strike of 1910. Three years later, the Lewis family purchased the structure.

William E. Lewis was a miner for the Gatfield Mine, one of the strong union operations in the area. He was also characterized by his son, Elmo, as a "kind of leader," and during the tense years from 1910 to 1914, many meetings were held at Lewis' earlier home along Coal Creek and his new one at 108 East Simpson. The family was often forced to sleep in the basement because of the nighttime violence which occurred during the strike years. William E. died in 1914 from an illness related to his work as a miner, and that year food rations from the Union Store were halted, since the family had been removed

22) List Any Associated Cultural Group: n/a continued

V. REFERENCES:

1. Boulder County Courthouse Records
2. History files of the Lafayette Public Library
3. Elmo Lewis, oral history
4. Jeannie Heitman, "City Historical Museum has History of Its Own," Lafayette News, 15 September 1976, p. 6.

Lewis House
Lafayette Coal Mining Era Buildings

15. continued

at the other windows which are also wood framed and double-hung. The porch is roofed and has turned spindles in the balustrade. Behind the building and to the west slightly is a garage, of c. 1960 construction.

The house was built c. 1890 at the site of the Gatfield Mine. It was built by Oscar Patfield, owner of the mine, to provide housing for the miners. When the mine closed, he gave the house, one of several at the mine, to his son Oscar. The house was moved to its present location between 1910 and 1913.

20. continued

from the union's list. His wife Hannah managed to pay off the home with funds remaining and supported the family by washing and ironing clothers. The children were also forced to work. Hannah continued to live in the home until her death in 1975. The structure was sold the following year to the city of Lafayette, expenses being paid by the local historical society who have now located a Miner's Museum in the sturcture.

Typical miners' housing consisted of one-story frame vernacular buildings, modest in detailing. The Lewis House, a T-plan clapboarded structure with the original porch intact, has suffered no major exterior alteration. The former residence, therefore, represents one of the best preserved examples of miners' housing in Lafayette.

INVENTORY RECORD



IMPORTANT: COMPLETE THIS SHEET FOR EACH RESOURCE PLUS EITHER AN ARCHAEOLOGICAL OR HISTORICAL/ARCHITECTURAL COMPONENT FORM.

NOT FOR FIELD USE ___ DET. ELIG. ___ DET. NOT ELIG. ___ NOMINATED LISTED, DATE _____
--

I. IDENTIFICATION: 1)Resource No. _____ 2)Temp. No. 8

3)Resource Name Lewis House 4)Project Name Lafayette Thematic District
 Thematic

5)Category: Arch. Site __, Hist./Archit. Structure x, Hist./~~Archit.~~ District x.

6)(For Arch. site)In a District:yes __ no __;Name NA

II. LOCATION: 7)Township 15; Range 69W; SW $\frac{1}{4}$ of SW $\frac{1}{4}$ of NW $\frac{1}{4}$ of NW $\frac{1}{4}$ of Section 2; P.M. 6th. 8)County Boulder

9)USGS QUAD Lafayette, Colorado; 7.5 x 15; Date 1965 (71) Attach photocopy portion of Quad. Clearly show site. 10)Other maps NA

11)Dimensions --- mX --- m 12)Area --- sq.m(+4047=) less than 1 acres

13)UTM Reference: (One UTM centered on resource may be given for resource under 10 acres.)

A. | 1 | 3 | ; | 4 | 9 | 2 | 4 | 0 | 0 | mE; | 4 | 4 | 2 | 7 | 3 | 4 | 0 | mN. B. | | | ; | | | | | | | | | | mE; | | | | | | | | | | mN.
 C. | | | ; | | | | | | | | | | mE; | | | | | | | | | | mN. D. | | | ; | | | | | | | | | | mE; | | | | | | | | | | mN.

14)Address 108 E. Simpson, Lafayette, CO Lot 1 Block 6 Addition ---

III. MANAGEMENT DATA: 15)Field Assessment: Eligible x Not Eligible __ Need Data __

16)Owner/Address City of Lafayette, 201 East Simpson, Lafayette, CO

17)Gov't Involvement: County __ State __ Federal __ Private __; Agency NA

18)Disturbance:none __ light x moderate __ heavy __ total __; Explain Addition built on south side of structure.

19)Threats to Resource:Water Erosion __ Wind Erosion __ Animal Activity __ Neglect __ Vandalism __ Recreation __ Construction __; Comments NA

20)Management Recommendations Follow the Secretary's Standards for Rehabilitation

V. REFERENCE: 21)State/Fed. Permit Nos. NA

22)Photo Nos. L-1 5,6,8, on file at Colorado Historical Society

23)Report Title NA

24)Recorder Manuel Weiss 25)Recording Date January 23, 1982

26)Recorder Affiliation Community Services Collaborative 27)Phone No. 303-442-3601

V. SKETCH MAP: Map all features and show the boundaries of the resources. Show all major topographic features, permanent modern features, and vegetation zones as appropriate. Give names of features, streets and addresses if known. Provide scale, key and direction.

scale:
□ =
3 meters

key:



true x
mag. _____

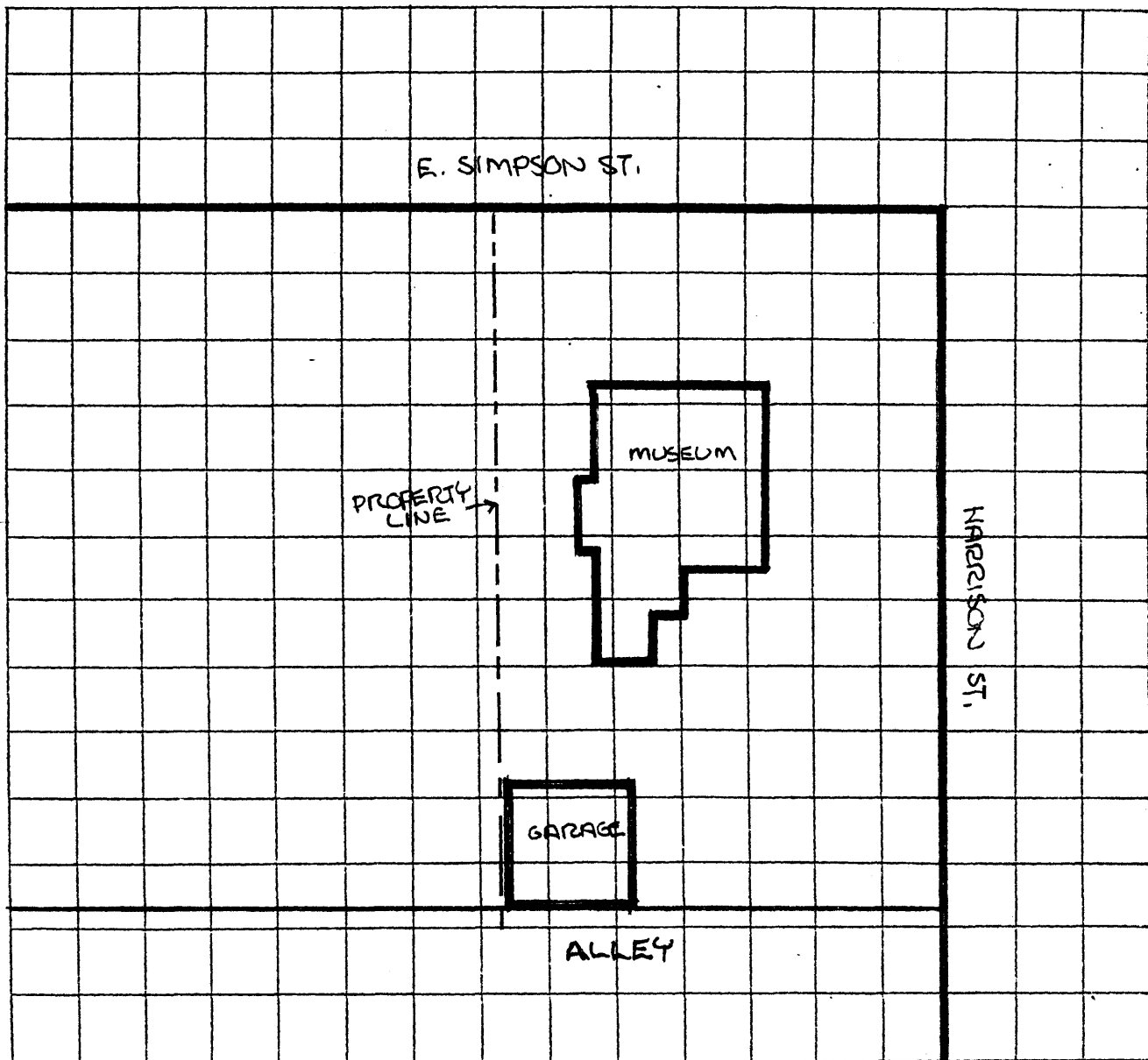

28) Location/Access: From the intersection of Hwy. 287 and East Simpson, drive east one block. The structure is situated on the southwest corner.

29) Boundary Description: Lot 1, block 6, Lafayette, Colorado

30) Boundary Justification: Limited to the lot occupied by the structure.

UNITED STATES
DEPARTMENT OF THE INTERIOR
GEOLOGICAL SURVEY

