

FORM B - BUILDING

MASSACHUSETTS HISTORICAL COMMISSION
80 BOYLSTON STREET
BOSTON, MA 02116

AREA	FORM NO.
	5182A

Photo (3"x3" or 3"x5", black and white) Indicate address of property on back of photo. Staple to left side of form.

Sketch Map: Draw map showing property's location in relation to nearest cross streets and/or geographical features. Indicate all buildings between inventoried property and nearest intersection(s).
Indicate north

(SEE ATTACHED MAP)

Town Newton, Mass. MRA
NEWTON (Newtonville)

Address 218 Walnut Street

Historic Name Central Congregational Church

Use: Present church

Original church

DESCRIPTION

Date 1895

Source Church history

Style Romanesque Revival

Architect Hartwell & Richardson

Exterior Wall Fabric granite

Outbuildings none

Major Alterations (with dates) none

Condition Excellent

Moved no Date ---

Acreage 33,098 sq. ft. (less than 1 acre)

Setting mixed residential/commercial

UTM REFERENCE 19.3 18130.46 91100

USGS QUADRANGLE NEWTON, MA

SCALE 1:25,000

Recorded by Barbara Thibault

Organization Newton Historical Comm.

Date November 1985

NATIONAL REGISTER CRITERIA STATEMENT (if applicable)

As a major example of the Romanesque Revival style of architecture executed in granite and as the work of a prominent Boston architectural firm, Hartwell & Richardson, the Central Congregational Church meets criterion C of the National Register of Historic Places.

ARCHITECTURAL SIGNIFICANCE Describe important architectural features and evaluate in terms of other buildings within the community.

Only Newton example, this granite, architect-designed church represents a type characteristic of American late 19th-century architecture. Significant features are: Syrian arch entranceways; a four-story square tower with slate and steeply pitched roof, vented by a broad dormer with a row of small window panes and capped by a copper finial; and bands of varying size windows light the building with a large recessed arched stained glass window in the front gable. The front facade has two projecting three-sided attached two-story turrets with roof caps in slate and topped with copper finials.

HISTORICAL SIGNIFICANCE Explain the role owners played in local or state history and how the building relates to the development of the community.

The Congregational Society in Newtonville was organized in 1868, simultaneously with other ecclesiastical groups and civic organizations, to meet the needs of a growing suburban population. This dressed granite structure marks the prosperity of the congregation and the community as it replaced a wooden building at a cost of more than \$100,000. The architectural firm of Hartwell & Richardson built at least eight buildings in Newton during the 1890s, though this is the only church. One of the firm's principals, William C. Richardson (1854-1935), resided in Newtonville (Area G) and may have been a church member.

BIBLIOGRAPHY and/or REFERENCES

Newton's 19th Century Architecture: Newtonville (1980).
Jackson Homestead Historical Collection.
Rowe, History of Newton (1930), pp. 130, 134, 335, 486.

United States Department of the Interior
National Park Service

National Register of Historic Places
Inventory—Nomination Form

For NPS use only
received 7/23/86
date entered

Continuation sheet

Item number

Page

Multiple Resource Area
Thematic Group

Name Newton MRA
State Middlesex County, MA

Nomination/Type of Review

Date/Signature

31. Buckingham, John, House

Entered in the
National Register

for Keeper

Helene Byers 9/4/86

Attest

32. Building at 1--6 Walnut
Terrace

Entered in the
National Register

for Keeper

Helene Byers 9/4/86

Attest

33. Central Congregational
Church

Entered in the
National Register

for Keeper

Helene Byers 9/4/86

Attest

34. Chestnut Hill, The

Entered in the
National Register

for Keeper

Helene Byers 9/4/86

Attest

35. Claflin, Adams, Estate

Entered in the
National Register

for Keeper

Helene Byers 9/4/86

Attest

36. Clark House

Entered in the
National Register

for Keeper

Helene Byers 9/4/86

Attest

37. Collins, Frederick,
House

Entered in the
National Register

for Keeper

Helene Byers 9/4/86

Attest

38. Curtis, Allan Crocker,
House--Pillar House

Entered in the
National Register

for Keeper

Helene Byers 9/4/86

Attest

39. Curtis, William, House

Entered in the
National Register

for Keeper

Helene Byers 9/4/86

Attest

40. Davis, Seth, House

Entered in the
National Register

for Keeper

Helene Byers 9/4/86

Attest

NATIONAL REGISTER OF HISTORIC PLACES
EVALUATION/RETURN SHEET

Central Congregational Church (Newton MRA)
Middlesex County
MASSACHUSETTS

Working No. _____
Fed. Reg. Date: JUL 23 1986 2/3/87
Date Due: 8/21/86 - 9/6/86
Action: ACCEPT 9-4-86
 RETURN _____
 REJECT _____
Federal Agency: _____

Entered in the
National Register

- resubmission
- nomination by person or local government
- owner objection
- appeal

Substantive Review: sample request appeal NR decision

Reviewer's comments:

Recom./Criteria _____
Reviewer _____
Discipline _____
Date _____
_____ see continuation sheet

Nomination returned for: _____ technical corrections cited below
_____ substantive reasons discussed below

1. Name

2. Location

3. Classification

Category _____ Ownership _____ Status _____ Present Use _____
Public Acquisition Accessible

4. Owner of Property

5. Location of Legal Description

6. Representation in Existing Surveys

Has this property been determined eligible? yes no

7. Description

Condition excellent good fair deteriorated ruins unexposed unaltered altered original site moved date _____

Describe the present and original (if known) physical appearance

- summary paragraph
- completeness
- clarity
- alterations/integrity
- dates
- boundary selection

8. Significance

Period _____ Areas of Significance—Check and justify below

Specific dates _____ Builder/Architect _____
Statement of Significance (*in one paragraph*)

- summary paragraph
- completeness
- clarity
- applicable criteria
- justification of areas checked
- relating significance to the resource
- context
- relationship of integrity to significance
- justification of exception
- other

9. Major Bibliographical References

10. Geographical Data

Acreeage of nominated property _____

Quadrangle name _____

UTM References _____

Verbal boundary description and justification

11. Form Prepared By

12. State Historic Preservation Officer Certification

The evaluated significance of this property within the state is:

_____ national _____ state _____ local

State Historic Preservation Officer signature

title _____ date _____

13. Other

- Maps
- Photographs
- Other

Questions concerning this nomination may be directed to _____

Signed _____ Date _____ Phone: _____



Newton, Mass. MRA
218 Walnut St., Newtonville
(Central Cong. Church)
Inv. #5182A



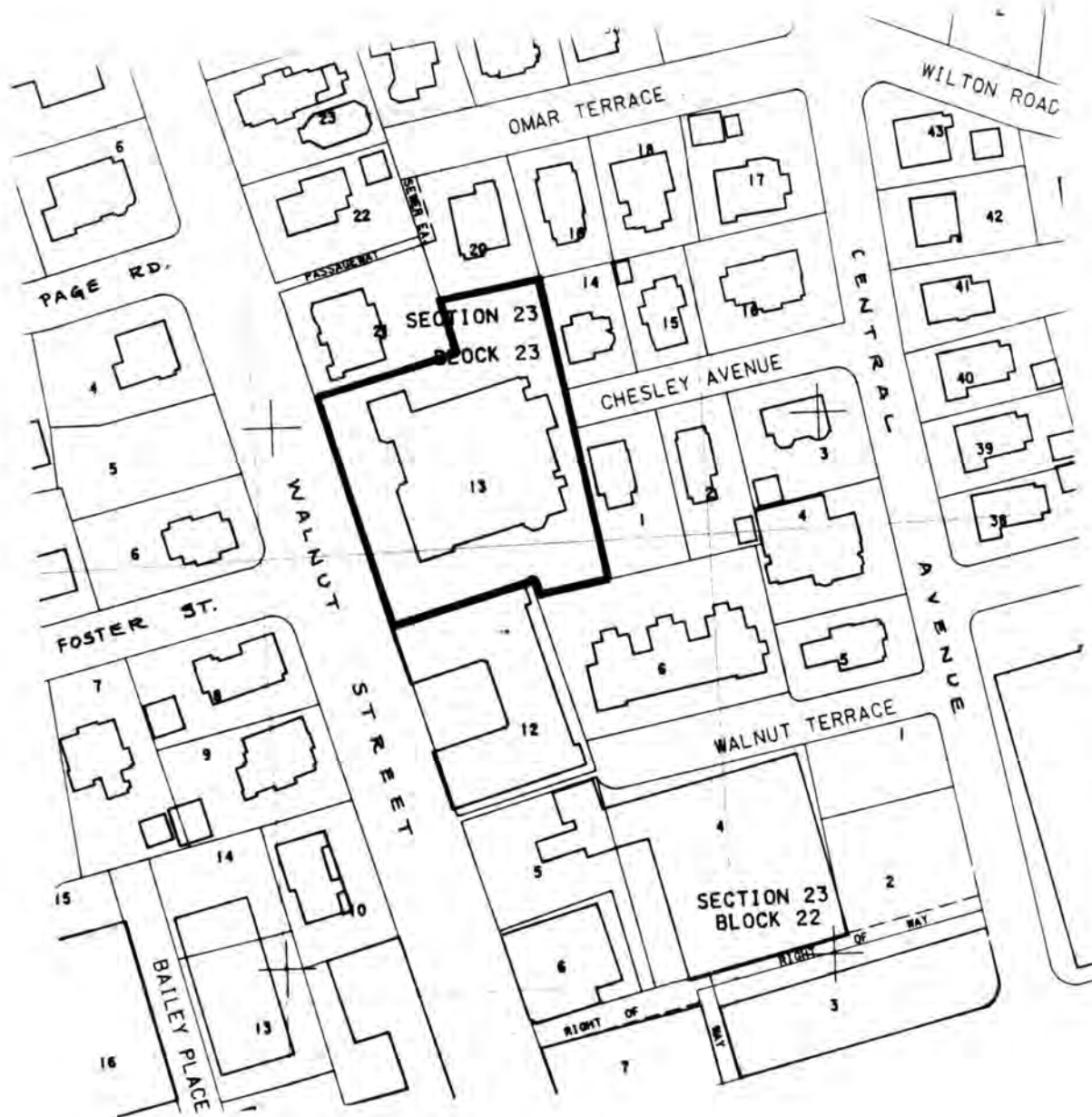

City of Newton Assessor's Maps. Sheet 31
 Metric Series. 1979
 Scale: UTM grid line interval = 100 meters (328 feet)

Newton, Mass. MRA
 218 Walnut St., Newtonville
 (Central Cong. Church)
 23-23-13