

KENTUCKY HISTORIC RESOURCES INVENTORY

Site No. WS-187

1. Historic Name(s) Edelen House Original Owner		22. ADD/County Lincoln Trail/Wash. <input type="checkbox"/> <input type="checkbox"/> <input checked="" type="checkbox"/>	
2. Present Name As above		23. U.S.G.S. Quadrant (15/75') Loretto <input type="checkbox"/> <input checked="" type="checkbox"/> <input type="checkbox"/>	
3. Location Manton, N. sd. Hwy 1183		24. UTM Reference 16 642130 4175140 Zone Easting Northing	
4. Owner's Name Mr. & Mrs. Richard Edelin		25. Coordinate Accuracy <input type="checkbox"/>	
5. Owner's Address Rt. 2, Loretto, Ky. 40037		26. Prehistoric Site Object Historic Site Structure Building Other	
6. Open to Public Yes ___ No <input checked="" type="checkbox"/>	7. Visible from road Yes <input checked="" type="checkbox"/> No ___	ownership private <input checked="" type="checkbox"/> local <input type="checkbox"/> state <input type="checkbox"/> federal <input type="checkbox"/>	
9. Local Contact/Organization Owner		27. National Register District Name: N/A <input type="checkbox"/> <input type="checkbox"/> <input type="checkbox"/> <input type="checkbox"/>	
10. Site Plan with North Arrow 		11. Architect unknown	
		12. Builder unknown	
		13. Date 1800-1825 (?) A. <input checked="" type="checkbox"/> B. <input type="checkbox"/>	
		14. Style A. Federal <input checked="" type="checkbox"/> B. <input type="checkbox"/>	
		15. Original Use Sing. fam. res. <input checked="" type="checkbox"/>	
		16. Present use As above	
		17. Condition Fair <input checked="" type="checkbox"/>	
18. Description 5 bay, 5/1 Eng. bond; jack arches; internal end chimneys; ext. chimney on ell; brick cornice limestone foundation; transom; sidelights; open string stair in central hall w/wave brackets; paneled pilasters and frieze on Fed. mantels; chair rails on 2nd fl. ; brick dependency to S w/jack arch and gable end. (Continue on Back)		No. Stories Two <input checked="" type="checkbox"/>	
		Single Pile <input checked="" type="checkbox"/> NA ___ Double Pile ___	
		Floor Plan Sing. p./cent.p. <input checked="" type="checkbox"/>	
		Structural Fabric Brick A. <input checked="" type="checkbox"/> B. <input type="checkbox"/>	
		Decorative Fabric Eng. bond A. <input checked="" type="checkbox"/> B. <input type="checkbox"/>	
		Roof Form Gable end	
19. History John Edelen owned. Grandfather got from Blincoes from Holy Cross.		28. Significance Evaluation NR <input checked="" type="checkbox"/>	
		29. Status National Landmark ___ Date ___ National Register ___ Landmark Certificate ___ Kentucky Survey ___ Local Landmark ___ HABS/HAER ___	
		30. Historic Theme Primary Architecture <input checked="" type="checkbox"/> Secondary ___ Other ___	
		31. Endangered Yes ___ No <input checked="" type="checkbox"/>	
		32. Preservation Project Status N/A <input type="checkbox"/> Actual Cost in \$1,000s <input type="checkbox"/> <input type="checkbox"/> <input type="checkbox"/> <input type="checkbox"/> <input type="checkbox"/>	
		33. ATTACH PHOTO Roll No. 31 Picture No. 14A-19A Direction ___	
		34. Prepared by: Joe DeSpain	
20. Significance Substantial brick I-house, one of a group featuring Greek Revival proportions and Federal details. Alterations do not affect significant form and details.		35. Organization Green Co. His. Soc., Inc.	
21. Source of Information Owner		36. Date 8 June 1983	
		37. Revision Dates 10/87	
		38. Staff Review	

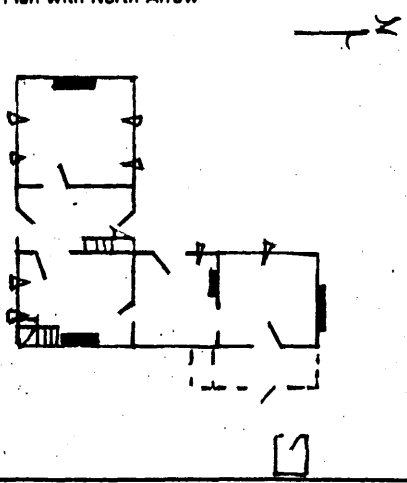

→ 11

→ 12A

→ 17A

→ 18A

→ 19A

→ 19A

→ 19

→ 19A

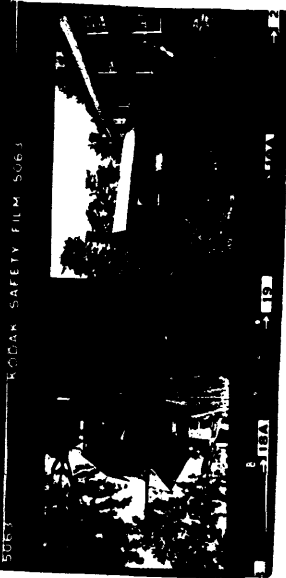

5087 KODAK SAFETY FILM 5061

→ 19

→ 19A

→ 19

**KENTUCKY HISTORIC RESOURCE INVENTORY SUPPLEMENT
BOUNDARY AND LOCATION INFORMATION**

Historic Property Name Edelen House Site # WS-187

Multiple Resource/Thematic Nomination Title Washington County Multiple Resource Area

U.T.M. Coordinates - List multiple UTMs if property is ten or more acres.

A. 16 _____ D. _____
 B. _____ E. _____
 C. _____ F. _____

Verbal Boundary Description

Acreege approximately one acre

Beginning at point A where a drive intersects with St. Rt. 1183 on the north side of Rt. 1183, thence north 85 feet to point B with the east side of said drive, thence east 110 feet to point C at northeast corner of concrete block garage, thence south 85 feet to point D on the north side of rt. 1183, thence west 110 feet with the north side of said road to the point of origin. The boundaries were chosen to include the house and its immediate domestic-related space. The boundaries encompass two contributing buildings (house and meathouse) one contributing stone cistern, and one noncontributing modern garage.

Sketch of Site Plan (Showing outbuildings, structures, landscape features and the site boundary as described above.)

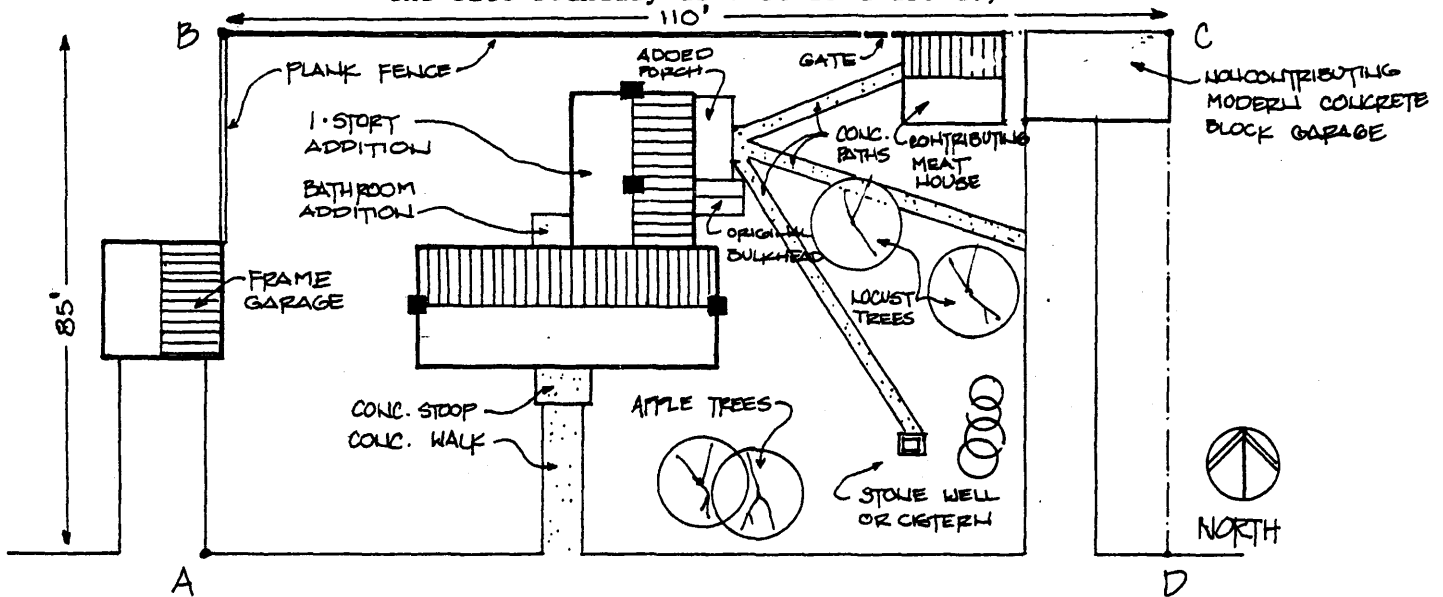

Official Courthouse Property Reference:

Washington County Courthouse, Springfield, Kentucky