



Rockefeller Center looking north. 1964  
New York, New York

Photo credit: ca. 1987  
The Rockefeller Group



Rockefeller Center excavation site.  
December, 1933  
New York, New York

Photo credit: ca. 1987  
The Rockefeller Group



Rockefeller Center site before construction,  
ca. 1932  
New York, New York

Photo credit: ca. 1987  
The Rockefeller Group



REINHARD & HOFMEISTER  
CORBETT, HARRISON & MACMURRAY  
HOOD & FOWLHOX  
ARCHITECTS  
1935

Rockefeller Center looking west.  
Architect's rendering  
New York, New York

Photo credit: ca. 1987  
The Rockefeller Group

Rockefeller Center. Plan from RCA building  
New York, New York

Photo credit: ca. 1987  
The Rockefeller Group

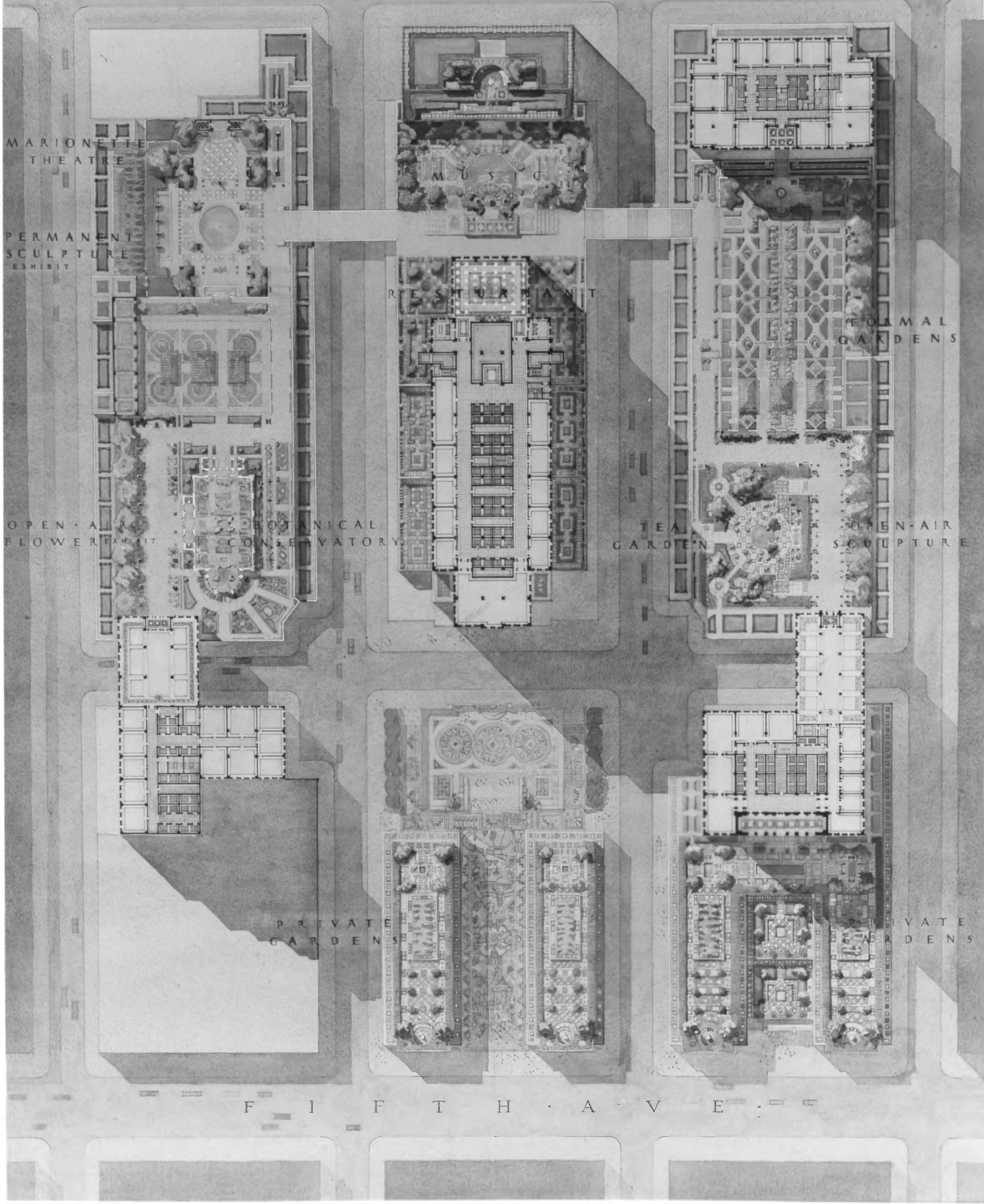



Rockefeller Center. "Spirit of Energy  
sending out Radio and Television."  
New York, New York

Photo credit: ca. The Rockefeller Group



Radio City Music Hall. "Rockettes"  
1939  
New York, New York

Photo credit: ca. The Rockefeller Group



Rockefeller Center. Sunken plaza skating rink.]  
New York, New York

Photo credit: ca. 1936  
The Rockefeller Group





Radio City Music Hall. Interior  
New York, New York

Photo credit: c. The Rockefeller Group

RADIO CITY MUSIC HALL ENTERTAINMENT CENTER'S  
AUDITORIUM

The most striking feature of the theatre auditorium is an immense proscenium arch, sixty feet in height. The semi-circular design is a stylized representation of a sunrise, and can be lighted in eight different colors. Shown here on each side of the Great Stage are some sets from "A New York Summer: A Magical Musical Celebration."