

RECEIVED

United States Department of the Interior  
National Park Service

DEC 13 1993

National Register of Historic Places  
Registration Form

NATIONAL  
REGISTER

This form is for use in nominating or requesting determinations for individual properties and districts. See instructions in *How to Complete the National Register of Historic Places Registration Form* (National Register Bulletin 16A). Complete each item by marking "x" in the appropriate box or by entering the information requested. If an item does not apply to the property being documented, enter "N/A" for "not applicable." For functions, architectural classification, materials, and areas of significance, enter only categories and subcategories from the instructions. Place additional entries and narrative items on continuation sheets (NPS Form 10-900a). Use a typewriter, word processor, or computer, to complete all items.

1. Name of Property

historic name Wallace, Samuel, House

other names/site number Calumet; WD 105

2. Location

street & number N.S. Old Frankfort Pike, immediately east of Wallace  not for publication N/A

city or town Midway  vicinity

state Kentucky code KY county Woodford code 239 zip code 40347

3. State/Federal Agency Certification

As the designated authority under the National Historic Preservation Act, as amended, I hereby certify that this  nomination  request for determination of eligibility meets the documentation standards for registering properties in the National Register of Historic Places and meets the procedural and professional requirements set forth in 36 CFR Part 60. In my opinion, the property  meets  does not meet the National Register criteria. I recommend that this property be considered significant  nationally  statewide  locally. ( See continuation sheet for additional comments.)

David L. Meyer SHPO/Ex. Director 11/18/93  
 Signature of certifying official/Title Date  
State Historic Preservation Office/Kentucky Heritage Council  
 State of Federal agency and bureau

In my opinion, the property  meets  does not meet the National Register criteria. ( See continuation sheet for additional comments.)

\_\_\_\_\_  
 Signature of certifying official/Title Date  
 \_\_\_\_\_  
 State or Federal agency and bureau

4. National Park Service Certification

I hereby certify that the property is:

- entered in the National Register.  See continuation sheet.
- determined eligible for the National Register  See continuation sheet.
- determined not eligible for the National Register.
- removed from the National Register.
- other, (explain:)

for Signature of the Keeper Entered in the National Register Date of Action  
Gregory M. Lapsley 1/27/94

Wallace, Samuel House  
Name of Property

Woodford, Kentucky  
County and State

**5. Classification**

**Ownership of Property**  
(Check as many boxes as apply)

- private
- public-local
- public-State
- public-Federal

**Category of Property**  
(Check only one box)

- building(s)
- district
- site
- structure
- object

**Number of Resources within Property**  
(Do not include previously listed resources in the count.)

Contributing	Noncontributing	
1	1	buildings
		sites
		structures
		objects
1	1	Total

**Name of related multiple property listing**  
(Enter "N/A" if property is not part of a multiple property listing.)  
Historic and Architectural Resources of  
North West Woodford County, Kentucky

**Number of contributing resources previously listed  
in the National Register**  
0

**6. Function or Use**

**Historic Functions**  
(Enter categories from instructions)  
DOMESTIC / single dwelling

**Current Functions**  
(Enter categories from instructions)  
DOMESTIC / single dwelling

**7. Description**

**Architectural Classification**  
(Enter categories from instructions)  
EARLY REPUBLIC / Federal

**Materials**  
(Enter categories from instructions)  
foundation STONE / Limestone  
walls BRICK  
roof ASPHALT  
other

**Narrative Description**  
(Describe the historic and current condition of the property on one or more continuation sheets.)

Wallace, Samuel, House  
Name of Property

Woodford, Kentucky  
County and State

## 8. Statement of Significance

### Applicable National Register Criteria

(Mark "x" in one or more boxes for the criteria qualifying the property for National Register listing.)

- A Property is associated with events that have made a significant contribution to the broad patterns of our history.
- B Property is associated with the lives of persons significant in our past.
- C Property embodies the distinctive characteristics of a type, period, or method of construction or represents the work of a master, or possesses high artistic values, or represents a significant and distinguishable entity whose components lack individual distinction.
- D Property has yielded, or is likely to yield, information important in prehistory or history.

### Criteria Considerations

(Mark "x" in all the boxes that apply.)

Property is:

- A owned by a religious institution or used for religious purposes.
- B removed from its original location.
- C a birthplace or grave.
- D a cemetery.
- E a reconstructed building, object, or structure.
- F a commemorative property.
- G less than 50 years of age or achieved significance within the past 50 years.

### Narrative Statement of Significance

(Explain the significance of the property on one or more continuation sheets.)

## 9. Major Bibliographical References

### Bibliography

(Cite the books, articles, and other sources used in preparing this form on one or more continuation sheets.)

#### Previous documentation on file (NPS):

- preliminary determination of individual listing (36 CFR 67) has been requested
- previously listed in the National Register
- previously determined eligible by the National Register
- designated a National Historic Landmark
- recorded by Historic American Buildings Survey  
# \_\_\_\_\_
- recorded by Historic American Engineering  
Record # \_\_\_\_\_

### Areas of Significance

(Enter categories from instructions)

ARCHITECTURE

### Period of Significance

c. 1817

### Significant Dates

c. 1817

### Significant Person

(Complete if Criterion B is marked above)

N/A

### Cultural Affiliation

na

### Architect/Builder

Kennedy, Matthew (attributed to, Arch)

### Narrative Statement of Significance

(Explain the significance of the property on one or more continuation sheets.)

## 9. Major Bibliographical References

### Bibliography

(Cite the books, articles, and other sources used in preparing this form on one or more continuation sheets.)

#### Previous documentation on file (NPS):

- preliminary determination of individual listing (36 CFR 67) has been requested
- previously listed in the National Register
- previously determined eligible by the National Register
- designated a National Historic Landmark
- recorded by Historic American Buildings Survey  
# \_\_\_\_\_
- recorded by Historic American Engineering  
Record # \_\_\_\_\_

#### Primary location of additional data:

- State Historic Preservation Office
- Other State agency
- Federal agency
- Local government
- University
- Other

Name of repository:

Kentucky Heritage Council

Wallace, Samuel, House  
Name of Property

Woodford, Kentucky  
County and State

**10. Geographical Data**

Acreage of Property 4 acres

**UTM References**

(Place additional UTM references on a continuation sheet.)  
Versailles, Kentucky 7.5 min. Quad.

1 | 16 | 702660 | 4221520 |  
Zone Easting Northing  
2 | 16 | 702770 | 4221460 |

3 | 16 | 702710 | 4221290 |  
Zone Easting Northing  
4 | 16 | 702600 | 4221340 |

See continuation sheet

**Verbal Boundary Description**

(Describe the boundaries of the property on a continuation sheet.)

**Boundary Justification**

(Explain why the boundaries were selected on a continuation sheet.)

**11. Form Prepared By**

name/title Christine Amos, Historian  
organization Burry & Amos, Inc. date December 1, 1992  
street & number 926 Main Street telephone (502) 633-5530  
city or town Shelbyville state Kentucky zip code 40065

**Additional Documentation**

Submit the following items with the completed form:

**Continuation Sheets**

**Maps**

- A USGS map (7.5 or 15 minute series) indicating the property's location.
- A Sketch map for historic districts and properties having large acreage or numerous resources.

**Photographs**

Representative black and white photographs of the property.

**Additional Items**

(Check with the SHPO or FPO for any additional items)

**Property Owner**

(Complete this item at the request of SHPO or FPO.)

name Mutual Benefit Life Insurance Company  
street & number \_\_\_\_\_ telephone \_\_\_\_\_  
city or town Georgetown state Kentucky zip code \_\_\_\_\_

**Paperwork Reduction Act Statement:** This information is being collected for applications to the National Register of Historic Places to nominate properties for listing or determine eligibility for listing, to list properties, and to amend existing listings. Response to this request is required to obtain a benefit in accordance with the National Historic Preservation Act, as amended (16 U.S.C. 470 et seq.).

**Estimated Burden Statement:** Public reporting burden for this form is estimated to average 18.1 hours per response including time for reviewing instructions, gathering and maintaining data, and completing and reviewing the form. Direct comments regarding this burden estimate or any aspect of this form to the Chief, Administrative Services Division, National Park Service, P.O. Box 37127, Washington, DC 20013-7127; and the Office of Management and Budget, Paperwork Reductions Projects (1024-0018), Washington, DC 20503.

---

7. Narrative Description

The property is a two-story, brick masonry residence built during the Federal Period, circa 1817, for the son of a prosperous, early settler of Woodford County on family land. The agricultural landscape surrounding the residence, approximately 350 acres, has been modified into a modern Thoroughbred farm landscape within the past twenty years (or less). No historic agricultural buildings or distinctive land patterns remain with the acreage. Two buildings are located in the rear yard area, a modern garage and extensively remodeled historic quarters, now used for a farm office. Neither building contributes to the understanding or significance of the nominated residence. The garage is included within the proposed nominated boundary area of 4 acres and is counted as a non-contributing building.

The Samuel Wallace House, locally known by its historic name of Calumet, is an impressive, two-story, double pile Federal residence, set back from the north side of the Old Frankfort Pike about 400 feet. When built, the community of Leesburg to the west was a thriving crossroad with stage station and mercantile (now Nugents Crossroads, see Historic District nomination, part of this MPL). The front, five bay facade is laid in Flemish bond (painted for the first time within the past 20 years) with Queen's closers and regular spaced pilasters that divide the front into balanced bays. The hip roof, clad with asphalt shingles, is pierced by four end chimneys that project slightly from the wall plane; about the distance of the pilasters. Topping the hip is a widow's walk, reached via a stair in the attic. A deeply molded cornice extends across the facade, wrapping the tops of the pilasters with a capitol effect. The cornice breaks over the central bay, spanned by a blind arch with large lunette with some colored glass that appears to be original in colors of blue, gold and ruby. The foundation is of limestone with a slight water table and some later pointing with square, raised mortar bed. Windows are six-over-six sash with simply molded architrave, flat arch lintels and stone sills (shutters not original). A central, single-story portico (a later antebellum addition according to Lancaster:1991), is topped by a flat roof with urn-shaped, ballustrated deck. Opening to the second floor deck are recently installed, double doors with multi-light panes, solid transom and side lights. (Photographs taken in 1941 and 1974 indicate a sash window flanked by inset shutters at this opening. The inset shutters may cover side lights.) The front entry features an elliptical fanlight with colored glass of ruby, blue and gold set into hand-carved, radiating mullions, separated at the center with a dividing band with curvilinear relief design. The double, leaf doors have 6-over-2 panels, flanked by an architrave of grouped collonettes on

---

rectangular bases. Sidelights have eight lights with semi-circular mullions, and are placed above rectangular panels with radiating medallions. The portico is supported by square, wood pilasters and fluted, Tuscan columns (hollow wood).

A 20th century, one-story, brick veneer shed extends across the full rear of the residence with concrete block foundation and recessed, central porch/entry. The original rear wall entry displays 6-over-2 paneled, leaf doors and plain sidelights over rectangular panels.

The interior is well maintained with good integrity, a center passage plan with stair in the rear half of the hall which is divided by an arch. The walnut stairway features a rear landing and open stringer with decorative relief design. Other interior details include ash floor throughout, Federal mantles, and panels beneath first floor windows. According to architectural historian, Clay Lancaster (1991), "Details inside the house are rather provincial. Aprons under the windows are embellished with three heavy sunbursts that look like flattened wheels with hubs, spokes and oval rims." (ibid, 171-172). He reports that the staircase is a replacement but does not indicate the source of information or when it was replaced.

The intricacy of building this residence is well displayed in the structure of the roof, visible in the attic. The hip roof is mortise and tenon framed and held with pegs. Most lumber displays fine adze or flat saw marks and is of an undertermined hard wood. A stair leads to the widow's walk on the roof and a hand built door, slatted for ventilation, provides access to the attic itself from the second floor upper landing. The attic is roughly finished and may have been occasionally occupied.

2. garage, non-contributing building. A recently built (c. 1970) three bay garage of common bond brick with pilaster separating the bays, asphalt shingled hip roof, paneled overhead door. Measures 38'6" by 24'9" overall.

## 8. Narrative Statement of Significance

The Samuel Wallace house, Calumet, is architecturally significant under Criteria C on a regional level within the theme of domestic architecture of the settlement period, a context developed in the North West Woodford County Multiple Property Form. The property is a well-built and preserved example of a two-story, double pile residence from the late Federal period. The house may have been designed by Lexington architect, Matthew Kennedy, an individual whose architectural contributions influenced decades of regional design in the Commonwealth.

---

Rather than describing the interior details as provincial, which refer to simplicity and relative plainness in furnishings, Calumet's interior woodwork and details are the unique and intricate examples of an unknown carpenter's art. Although the scale, proportions of individual components and overall design motifs may not be as sophisticated as other area representations, they nevertheless are important material evidence of stylistic interpretation and craftsmanship during an era. The house, likewise, is a striking example of one of the largest antebellum plan-types built occasionally throughout the region: the two-story, double-pile center passage. Almost invariably, those who could afford to build such homes were individuals of local prominence with substantial, agrarian-based wealth. To local scholar and visitor alike, homes like Calumet are recognizable as noteworthy examples of prosperous living in a bucolic setting.

The property is historically associated with members of the Wallace family, prominent in Woodford county agriculture and politics for many years and with Senator and businessman, Henry L. Martin, who lived here from 1882 until his death in 1942.

Samuel Wallace built this home on land first owned by his pioneer father, Judge Caleb Wallace, circa 1820 (see Lewis Payne House National Register nomination for information on Caleb Wallace). Caleb and several members of his family figured prominently in late 18th and 19th century social, political and agricultural circles of Woodford County. The property left the Wallace family in the mid-19th century and changed ownership several times before being purchased by Henry L. Martin, who at the age of 34, had already established his fortune in livestock. Martin's political and professional endeavors included serving in the Kentucky senate from 1893 to 1896 and as director and President of the Citizens Bank of Midway. During much of his adult life, Martin maintained dual residences in Woodford County and New Orleans, managing a livestock corporation that specialized in mules, and operating a sugar plantation. Martin lived at Calumet until his death in 1942 and is reported to have given the home its name when he purchased it in 1882.

The architect of Calumet is not known. However, it is very similar in form, plan, and detail to WD 112, Elkwood, a c.1835 residence attributed to both Matthew Kennedy and Gideon Shryock north of Midway (see Elkwood NR form with this MPL). Lancaster (1991) compares Calumet to the Kennedy House and to Grasslands (1823) in Fayette County, and extends his comparison to Auvergne and Bucknore in Bourbon, but does not mention Elkwood in the discussion.

---

**9. Major Bibliographic References**

Lancaster, Clay. Antebellum Architecture of Kentucky.  
(Lexington, University Press of Kentucky), 1991.

Mastin, Bettye Lee. Lexington Herald. Lexington, Kentucky.  
Clippings file, WD 105, Kentucky Heritage File, Frankfort,  
nd.

Railey, William E. History of Woodford County. (Versailles,  
Woodford County Improvement League), 1927.

Kentucky Heritage Council Inventory form: 1974.

**10. Verbal Boundary Description**

The property boundary contains approximately 4 acres and is defined by a rectangle formed by the lines drawn on the accompanying topographic map. That map was drawn from information appearing on the Woodford County Property Valuation Assessor map 39, parcel 36, for the property.

**Boundary Justification**

The nominated property includes only the front and side domestic yard area that is historically associated with the residence and contributes to the integrity of the property's setting. Although the residence of a large farm, no historic agricultural buildings or landscape features remain to illustrate the context of agriculture. The non-contributing garage is included in the boundary merely to maintain the even, rectangular shape of the parcel.



↑  
N  
WD 105  
CALUMET

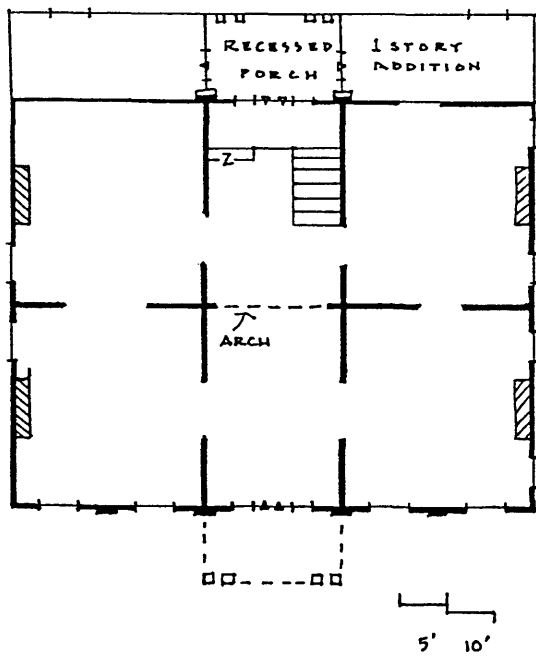

---

PHOTO LOG: Samuel Wallace House (Calumet, WD 105)

Property location: Woodford County, Kentucky.

Photographer: Christine Amos

Date of photograph: 1992

Location of original negative: Kentucky Heritage Council,  
Frankfort, Kentucky

1. Looking north-northeast to front and west side of residence from entry drive.
2. Looking north-northwest to front facade.
3. Looking north to front entry with fanlight and side light details, double leaf, paneled doors.
4. Interior, center passage, looking south to front entry. Note deeply reeded moldings and arch at center of hallway.