

1287

HISTORICAL AND ARCHITECTURAL INVENTORY

Site#

Legal Description: RV, Block 33, Lot 2

Address: 930 Adirondac

Ownership: Name: VFW

private address: P.O. Box 628, Hamilton, Mt.

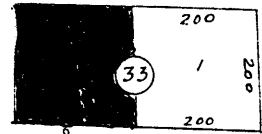

Location map or building plan with arrow north.

Roll# 10 Frame#12
 Historic Name: VFW Club
 Common Name: same
 Date of Construction: 1937 x estimated
 Architect: unknown
 Builder: VFW Club
 Original Owner: VFW Club
 Original Use: club house
 Present Use: club house

RESEARCH SOURCES:

Title Search: yes	Tax Records: yes	Bldg. Permit: no
Census Records: no	Sewer/Water: no	Sanborn Maps: not shown
Directories: yes	Newspapers: yes	

TITLE SEARCH

Martha J. Allison
 Fred L. Parker-1934
 VFW-1935

BIBLIOGRAPHY:

Personal Interview with May Vallance

Personal Interview with Gladys Nichols

RAVALLI REPUBLIC, Oct. 23, 1986

WESTERN NEWS, May 29, 1919 and Sept. 25, 1947

PHYSICAL DESCRIPTION

This is a one and one half story, wood frame building with a moderate to steep pitched gable roof with its axis perpendicular to Adirondac. Features include: a concrete foundation, a seven riser concrete stoop with metal pipe rail, a Classical engaged portico motif over a double metal front door. Windows are triple vertical mullion 1/1 double hungs with steel or metal screens applied. Window trim is 1x4 with a very small drip cap. Exterior siding is wood shingle with an 8 inch exposure and vertical corner trim. The upper gable is delineated by a wood barge board and a shingled gable end with a pair of small rectangular vents. The very peak has three boards of clapboard siding. A metal sided (shed roof) lean-to shed has been added to the back. At the center rear there is a square soft fired brick chimney. On the left side there is an access to the basement. It is a small, low, one story, wood frame shed. Rafter tails on that part are exposed. Rafter tails on the main gable are a very short box, 5 inch soffit with a moulded fascia board. The VFW Club has fallen into some disrepair. The shingles are showing age. Also, most of the wood trim details and fascia are showing weathering and age. This would be an expanded version of the Cape Cod Style with its tightly cropped eaves and shingle exterior. You can see the Classical motif that was popular also in the Cottage Style surrounding the front entryway.

INTEGRITY

With the exception of the metal lean-to shed to the back, this building appears to have excellent integrity. The foundation was done with a concrete form board dating it in the 1920's to 1930's when this technique was popular in Hamilton.

HISTORICAL INFORMATION

The World War I Veterans organized in a meeting at the Ravalli County Courthouse on May 29, 1919. Ralph Laws was president, Edwin L. Neilson was secretary and William Popham was Treasurer. Meetings were also held in the City Hall and the IOOF Hall. By 1937, the veterans were building their Memorial Hall. Grundy Nichols used his team of horses and a slip and with the help of other veterans, began excavation for the basement. The mortgage burning was on Sept. 25, 1947(1). Some of the charter members were Wilbur Vallance, Lawrence Waters, Cecil Tucker and Grundy Nichols.

Grundy Nichols passed away recently at 94 years of age. Mr. Nichols served in the Siberian Wolf Hound Division in World War I. He was stationed, for thirteen months, outside Vladivostok, Siberia, as a guard on the narrow gauge railroad going inland to Lake Bycol. He moved to the Bitterroot Valley in 1921 and was an active member of the Veterans of Foreign Wars Post. Grundy Lane, east of Hamilton, bears his name.

Footnote Sources: (1) Interview with Gladys Nichols, one of the last remaining charter members of the Auxiliary. She remembers cooking for

the men as they were building the hall.

Contributing buildings: 1

HISTORICAL AND ARCHITECTURAL SIGNIFICANCE

Areas of Significance: architecture
social history

The VFW Memorial Hall is eligible for listing on the National Register by meeting criteria A and C. The erection of the VFW Memorial Hall represents the bond and comradeship that was created by the men who served this country abroad during World War I and other associated wars. The VFW Clubs erected posts throughout the country in the period after the War (1917-1919). Architecturally, the Club has excellent integrity and distinctly embodies the Classicized Cape Cod Style with its Classical entry, shingle exterior, steep pitch gable with tightly cropped eaves and simple massing. It is the only civic constructed Cape Cod Style in the area surveyed. This style was popular for residences in this area from middle to late 1930's.

Form Prepared By: Kirk Michels and Ada Powell
205 Bedford Street, Hamilton, Mt.
Sept. 28, 1987

Acreage: less than one

UTM Reference: 11/718040/5126060