

RECEIVED
MAY 12 1992
NATIONAL REGISTER

United States Department of the Interior
National Park Service

National Register of Historic Places
Registration Form

This form is for use in nominating or requesting determinations of eligibility for individual properties or districts. See instructions in *Guidelines for Completing National Register Forms* (National Register Bulletin 16). Complete each item by marking "x" in the appropriate box or by entering the requested information. If an item does not apply to the property being documented, enter "N/A" for "not applicable." For functions, styles, materials, and areas of significance, enter only the categories and subcategories listed in the instructions. For additional space use continuation sheets (Form 10-900a). Type all entries.

1. Name of Property

historic name Lake Shetek State Park WPA/Rustic Style Historic District
other names/site number Lake Shetek State Park

2. Location

street & number off County Highway 37 not for publication N/A
city, town Murray and Shetek Townships Currie vicinity
state Minnesota code MN county Murray code 101 zip code 56123

3. Classification

Ownership of Property	Category of Property	Number of Resources within Property	
<input type="checkbox"/> private	<input type="checkbox"/> building(s)	Contributing	Noncontributing
<input type="checkbox"/> public-local	<input checked="" type="checkbox"/> district	<u>3</u>	<u>1</u> buildings
<input checked="" type="checkbox"/> public-State	<input type="checkbox"/> site	<u>3</u>	<u>2</u> structures
<input type="checkbox"/> public-Federal	<input type="checkbox"/> structure	<u>2</u>	<u>3</u> objects
	<input type="checkbox"/> object	<u>8</u>	<u>3</u> Total

Name of related multiple property listing:
Minnesota State Park CCC/WPA/Rustic Style
Historic Resources

Number of contributing resources previously listed in the National Register 0

4. State/Federal Agency Certification

As the designated authority under the National Historic Preservation Act of 1966, as amended, I hereby certify that this nomination request for determination of eligibility meets the documentation standards for registering properties in the National Register of Historic Places and meets the procedural and professional requirements set forth in 36 CFR Part 60. In my opinion, the property meets does not meet the National Register criteria. See continuation sheet.

Signature of certifying official Ian R. Stewart, Deputy State Historic Preservation Officer Date 5/12/92

State or Federal agency and bureau Minnesota Historical Society

In my opinion, the property meets does not meet the National Register criteria. See continuation sheet.

Signature of commenting or other official _____ Date _____

State or Federal agency and bureau _____

5. National Park Service Certification

I, hereby, certify that this property is:

- entered in the National Register. See continuation sheet.
- determined eligible for the National Register. See continuation sheet.
- determined not eligible for the National Register.
- removed from the National Register.
- other, (explain:)

Beth Boland 7/2/92

Signature of the Keeper

Date of Action

6. Function or Use

Historic Functions (enter categories from instructions)

RECREATION/Outdoor Recreation

LANDSCAPE/State Park

Current Functions (enter categories from instructions)

RECREATION/Outdoor Recreation

LANDSCAPE/State Park

7. Description

Architectural Classification

(enter categories from instructions)

Other: NPS Rustic Architecture

Materials (enter categories from instructions)

foundation Stone

walls Stone/Wood

roof Asphalt

other Stone

Describe present and historic physical appearance.

See Continuation Sheets

8. Statement of Significance

Certifying official has considered the significance of this property in relation to other properties:

nationally statewide locally

Applicable National Register Criteria A B C D

Criteria Considerations (Exceptions) A B C D E F G

Areas of Significance (enter categories from instructions)

Architecture
Landscape Architecture
Recreation
Government

Period of Significance

1938-41

Significant Dates

1938

Cultural Affiliation

N/A

Significant Person

N/A

Architect/Builder

State of Minnesota
Works Progress Administration

State significance of property, and justify criteria, criteria considerations, and areas and periods of significance noted above.

See Continuation Sheets

See continuation sheet

9. Major Bibliographical References

Department of Conservation. Third Biennial Report. 1935-36
Department of Natural Resources. Working Drawings and Specifications for Buildings and Structures at Lake Shetek State Park. Bureau of Engineering. St. Paul, Minnesota.
Minnesota State Emergency Relief Administration. Minnesota Work Relief History from 4/1/34 to 6/30/35. Mimeographed, undated bound volume at the Minnesota Historical Society Reference Library.
State of Minnesota. Minnesota State Park, Parkway and Recreational Area Study. 1938.

See continuation sheet

Previous documentation on file (NPS):

- preliminary determination of individual listing (36 CFR 67) has been requested
- previously listed in the National Register
- previously determined eligible by the National Register
- designated a National Historic Landmark
- recorded by Historic American Buildings Survey # _____
- recorded by Historic American Engineering Record # _____

Primary location of additional data:

- State historic preservation office
- Other State agency
- Federal agency
- Local government
- University
- Other

Specify repository: _____

10. Geographical Data

Acreage of property 34 Acres

UTM References

A	1 5	2 8 3 7 4 0	4 8 8 7 5 8 0
	Zone	Easting	Northing
C	1 5	2 8 4 2 6 0	4 8 8 6 8 4 0

B	1 5	2 8 4 2 7 0	4 8 8 7 5 6 0
	Zone	Easting	Northing
D	1 5	2 8 3 7 2 0	4 8 8 6 5 6 0

See continuation sheet

Verbal Boundary Description

The boundary for the Lake Shetek State Park WPA/Rustic Style Historic District is shown as the heavy cross-hatched line on the accompanying map entitled, "Lake Shetek State Park." It is defined by Lake Shetek on the north and west, by the park road to the east, and by a line just south of the Beach House to the south.

See continuation sheet

Boundary Justification

The boundary includes the buildings and structures that have been historically associated with the property and that maintain historic integrity. The boundary defines an area of the park developed by the Works Progress Administration.

See continuation sheet

11. Form Prepared By

name/title Rolf T. Anderson
organization N/A date April 26, 1992
street & number 212 West 36th Street telephone 612-824-7807
city or town Minneapolis state Minnesota zip code 55408

United States Department of the Interior
National Park Service

National Register of Historic Places Continuation Sheet

Section number 7 Page 1 Lake Shetek State Park WPA/Rustic Style Historic District
Murray and Shetek Townships, Murray County, Minnesota

DESCRIPTION

The Lake Shetek State Park WPA/Rustic Style Historic District consists of a 34 acre area on the eastern shore of Lake Shetek encompassing the public use area of the park. The district includes three contributing buildings, three contributing structures, and two contributing objects. One non-contributing building and two non-contributing structures are also included. Architects for the park buildings were from the Design Office within the Minnesota Division of State Parks.

A group camp was also constructed by the WPA and this property has been nominated to the National Register under a separate form. The service yard was also built as part of the park's development. However, because of significant alteration to the Custodian's Cabin and the Garage and Office, this area of the park has not been nominated.

Department of Natural Resources building identification numbers are located after the name of each building.

1. Building: Beach House 4-135 Builder: WPA
Architect: Harold Petersen Date: 1939-40

The Beach House is a rectangular structure located on a dramatic bluff high above Lake Shetek. The central section of the building is covered by a gable roof and originally contained rest rooms, a concession, and storage rooms. This 43'6" x 22'6" section also contains flanking loggias which pass through the width of the building. Partially enclosed changing wings, 20' x 15', are placed on either side of the building. Counters were located on the lake facade for the concession and in the loggias for check-in purposes.

The Beach House building rests on low split stone walls, 2'6" high, followed by 10" rough clapboard siding in the central section and vertical board and batten siding in the changing wings. A 22' x 52' terrace overlooks Lake Shetek and features a split stone retaining wall. Curving 6' wide stone stairways flank the terrace and descend 20' to the shore of Lake Shetek. The dramatic site and the careful composition of the stairways transform this standard Beach House into a particularly notable design.

United States Department of the Interior
National Park ServiceNational Register of Historic Places
Continuation SheetSection number 7 Page 2 Lake Shetek State Park WPA/Rustic Style Historic District
Murray and Shetek Townships, Murray County, Minnesota

In 1960 the concession counter was removed and a door and windows were added. In 1964 a 23' x 26' addition was made to the rear of the building which changed the building to a T-shaped configuration. The addition was built with stone and board and batten siding to match the original. This building is one of the few beach houses which retains its original changing wings.

2. Object: Drinking Fountains Builder: WPA
Architect: State of Minnesota Date: 1940

Two Drinking Fountains were constructed in the park and are located near the Beach House and Kitchen Shelter. Both fountains are built with native split stone 2'6" square at the base which tapers to 2' square at the top. The fountains rest on a concrete base which may have replaced original stone flagging.

3. Structure: Stone Steps Builder: WPA
Architect: State of Minnesota Date: 1940

Two short stairways built of stone lead from the parking area to the nearby Beach House. The stonework is set in mortar and the stairs are flanked by low walls 1' high. Square stone piers mark both the top and bottom of each stairway.

4. Building: Kitchen Shelter 4-136 Builder: WPA
Architect: N. Nielsen Date: 1940-41

The Kitchen Shelter is a 26' x 19' rectangular, gable-roofed building constructed with native stone laid random ashlar. The entrance consists of an 18' wide opening on the lake facade while large openings on the side walls are defined by stepped stonework. The gable areas above the openings are infilled with 10" rough horizontal siding. A battered chimney, 8' wide at the base which tapers to 6' at the top, is located on the rear facade and once contained four cast iron cook stoves. Sinks and wood boxes flanked the stoves. The Shelter is one of the more distinctive buildings of its type in the state park system.

A roll-up type door has been installed in the entrance and the openings in the side walls have been glazed.

United States Department of the Interior
National Park Service

National Register of Historic Places Continuation Sheet

Section number 7 Page 3 Lake Shetek State Park WPA/Rustic Style Historic District
Murray and Shetek Townships, Murray County, Minnesota

5. Building: Sanitation Building 4-134 Builder: WPA
Architect: N. Nielsen Date: 1940

The Sanitation Building is a 28' x 18' rectangular structure covered by a gable roof. The building is constructed with stone walls, 3' high, with 10" rough horizontal boards with an 8" face placed above. The stone walls extend beyond the end walls to form screens to shield the entrances. Vertical boards rest on the walls to complete the screens. Paired casement windows and an entrance door are placed on each end wall while two pairs of casements are located on each of the principal facades. The windows are hinged at the base. Skylights have been added to the building.

6. Building: Picnic Shelter Builder: Unknown
Architect: Dept. of Natural Resources Date: 1986

The Picnic Shelter is a 34' x 40'6" prefabricated structure which is covered by a gable roof supported by squared posts. The north section of the building is enclosed by board and batten siding. The building is non-contributing.

7. Structure: Causeway Builder: WPA
Architect: State of Minnesota Date: 1938

The 1,000 foot long causeway connects the park mainland with Loon Island. It was built with boulders, fieldstone, and gravel from the shoreline of Lake Shetek and nearby farm fields. It was one of six causeways which were designed to create a roadway across the entire lake. However, only five of the six were built and this is the only causeway which remains within the park.

Two bridges have been constructed along the Causeway. The bridge adjacent to the mainland was built in 1974 and is 46' long with timber posts and rails. The second bridge, built in 1966, is 20' long and is built with precast channels resting on concrete abutments. The two bridges are considered non-contributing.

United States Department of the Interior
National Park Service

National Register of Historic Places Continuation Sheet

Section number 8 Page 1 Lake Shetek State Park WPA/Rustic Style Historic District
Murray and Shetek Townships, Murray County, Minnesota

STATEMENT OF SIGNIFICANCE

The Lake Shetek State Park WPA/Rustic Style Historic District is historically significant for its association with the social, political, and economic impact of the Great Depression and the subsequent development of the various Federal Relief Programs such as the Works Progress Administration which was responsible for its construction. The district is also significant for its association with the development of the Minnesota state park system. Lake Shetek was selected as the site for the park because lakes are extremely rare in this section of the state and a park with extensive recreational facilities could attract a large county population. The park was also located 30 miles from Camden State Park and was intended to relieve the heavy use from that location.

The Lake Shetek State Park WPA/Rustic Style Historic District is architecturally significant for its exceptional examples of Rustic Style split stone construction utilizing irreplaceable labor intensive methods and finely crafted detailing. The Beach House in particular features finely executed stonework employed in a series of stairways, terraces, and retaining walls. The Kitchen Shelter also represents a unique design which departs from the usual form. The landscape design for Lake Shetek State Park is architecturally significant as one of the most extensive schemes from the period. In addition to the designs for the public use area, service yard, and group camp facility, a series of causeways were designed in order to link five islands and provide a roadway across the lake. Five causeways were eventually constructed, although the final section was never built. Today, only one section remains within the park.

Lake Shetek State Park was established in 1937 although a monument had been built on the site in 1907 in memory of 12 people who died in the U.S.-Dakota Conflict of 1862. The park was developed by a WPA camp for 200 transient and homeless men which was located on Keeley directly across Lake Shetek from the park. The camp was initially operated by the State Emergency Relief Administration and was one of 32 transient camps in the state. The camp was established in the fall of 1934 and was involved with various projects throughout Murray County until it closed in about 1941.

The buildings occupied by the WPA were of permanent construction rather than the typical temporary structures of the work camp facilities and were intended to serve as an underprivileged group camp after they were no longer needed for the relief program. However, that section of the park was later sold and the WPA camp is now used as a church camp.

Lake Shetek State Park WPA/Rustic Style Historic District
 *non-contributing

1. Beach House
2. Drinking Fountain
3. Stone Steps
4. Kitchen Shelter
5. Sanitation Building
6. Picnic Shelter*
7. Causeway

- Group Camp
 1. Mess Hall
 2. Crafts & Rec Bldg

LAKE SHETEK

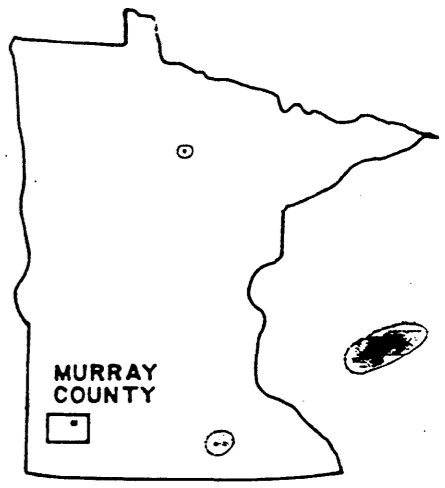
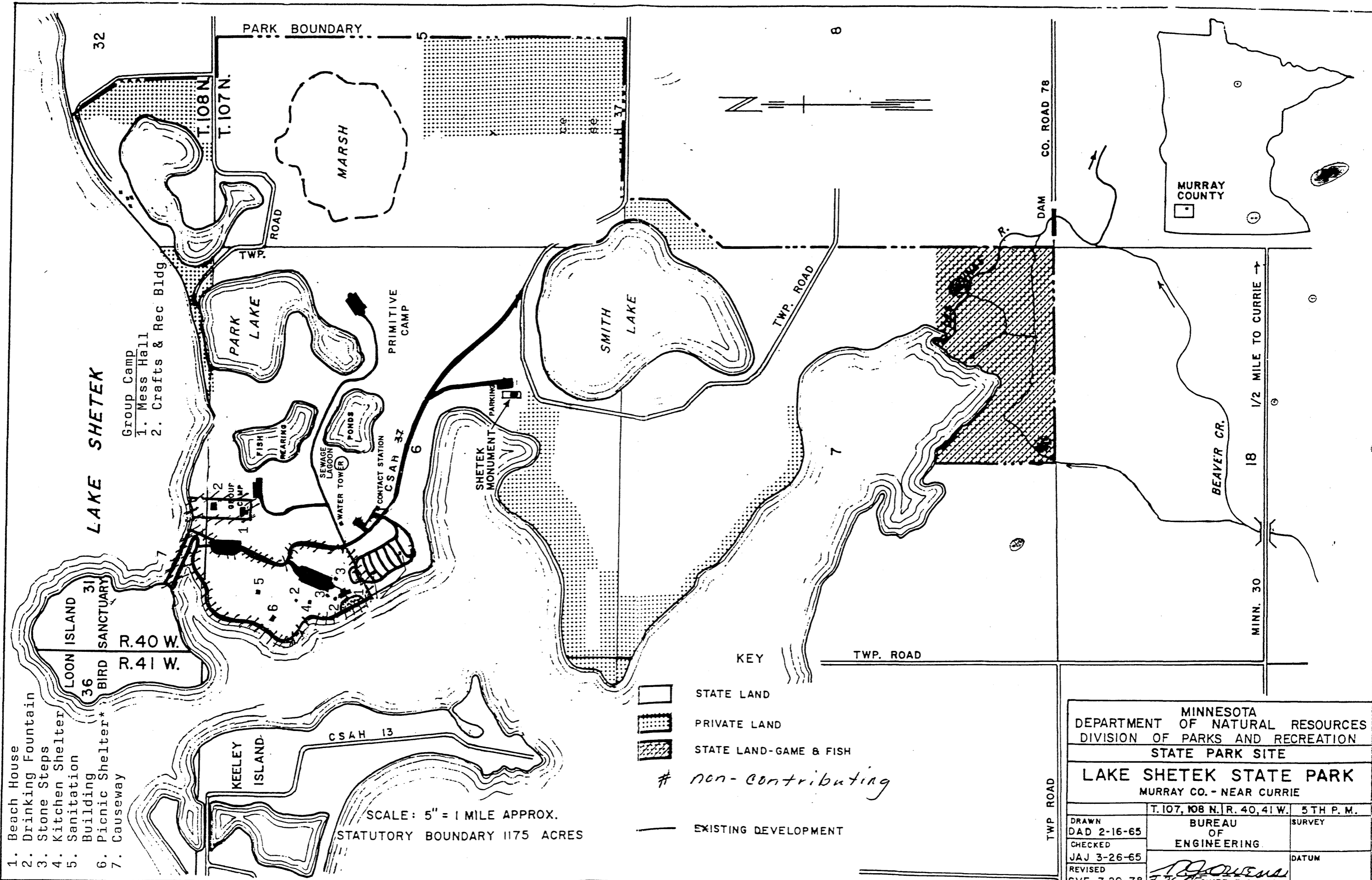

KEY TWP. ROAD

- STATE LAND
- PRIVATE LAND
- STATE LAND-GAME & FISH
- # *non-contributing*
- EXISTING DEVELOPMENT

SCALE: 5" = 1 MILE APPROX.
 STATUTORY BOUNDARY 1175 ACRES

MINNESOTA
 DEPARTMENT OF NATURAL RESOURCES
 DIVISION OF PARKS AND RECREATION
 STATE PARK SITE

LAKE SHETEK STATE PARK
 MURRAY CO. - NEAR CURRIE

T. 107, 108 N. R. 40, 41 W.		5TH P. M.
DRAWN DAD 2-16-65	BUREAU OF ENGINEERING	
CHECKED JAJ 3-26-65	DATUM	
REVISED SVF 7-20-78	CHIEF ENGINEER	

OWNERSHIP REV. REG.	REG.	SHEET	FILE
RES 6-25-73	64-187	35	P.030.00.C1