

**United States Department of the Interior
National Park Service**

**National Register of Historic Places
Continuation Sheet**

Section number _____ Page _____

Elmhurst

Greenbrier County, WEST VIRGINIA

Boundary Increase Approval

for Keeper Patrick Andrews 12/20/90

United States Department of the Interior
National Park Service

National Register of Historic Places
Continuation Sheet



NATIONAL
REGISTER

Section number 10 Page 1

N.R. REFERENCE NUMBER: 75001887

"Elmhurst", U.S. Route 60, Caldwell, Greenbrier County, WV
Acreage of property: 6

Boundary Revision

Verbal Boundary Description

The nominated property, "Elmhurst", stands approximately at the center of a six acre rectangle, the boundary of which begins at the meeting point of the southern edge of U.S. Route 60 with the east bank of the Greenbrier River, hence southwest in a straight line about 400 feet along the east bank of the Greenbrier River, hence in a straight line approximately 700 feet in a southeasterly direction, hence in a straight line 500 feet northward to the point of intersection with the southern edge of U.S. Route 60, and hence along the southern edge of U.S. Route 60 approximately 600 feet to the point of beginning. The boundary of historic "Elmhurst" encloses the red brick Elmhurst house, three contributing frame dependencies, a gravel approach driveway, an early 20th century stone wall, and a portion of the original road bed of the James River and Kanawha Turnpike.

Boundary Justification

The "Elmhurst" 1975 National Register Registration Form did not address the boundary locations of the listed property. This submission is necessary to provide a clear understanding of the historic resources and a careful delineation of the nominated acreage.

The six acres of the nominated property serve to encompass the centrally located 2-story, 1824 brick house within a rectangle which possesses significant historic focal points. The house's historic orientation to the north is along the road bed of the James River and Kanawha Turnpike, a major East-West corridor which connected eastern Virginia with the Ohio Valley. A preserved portion of the turnpike is present within the boundary. Also present within the boundary to the north of the house is an early 20th-century stone wall. The turnpike road bed and stone wall are below the grade of present U.S. Route 60 which serves, along its southern edge, to delineate the extent of these resources. Within the U.S. Route 60 embankment, below the boundary line, are stone steps built in the early 20th century to provide access from the highway to Elmhurst.

**United States Department of the Interior
National Park Service**

**National Register of Historic Places
Continuation Sheet**

Section number 10 Page 2

N.R. REFERENCE NUMBER: 75001887

Because the house was constructed in part to take advantage of commercial traffic, the much-traveled route provided the inn with a special advantage at the crossing point of the Greenbrier River. Here drovers, wagoners, and travelers were slowed to pay a toll at the bridge. Many paused to take advantage of the accommodations. The house and grounds were thus the center of many activities which refreshed and replenished the energies of both man and beast. The boundaries of the historic properties have been chosen, therefore, to include the river bank and nearby fields where animals were watered and grazed and where equipment such as wagons and cargo were parked or stowed.

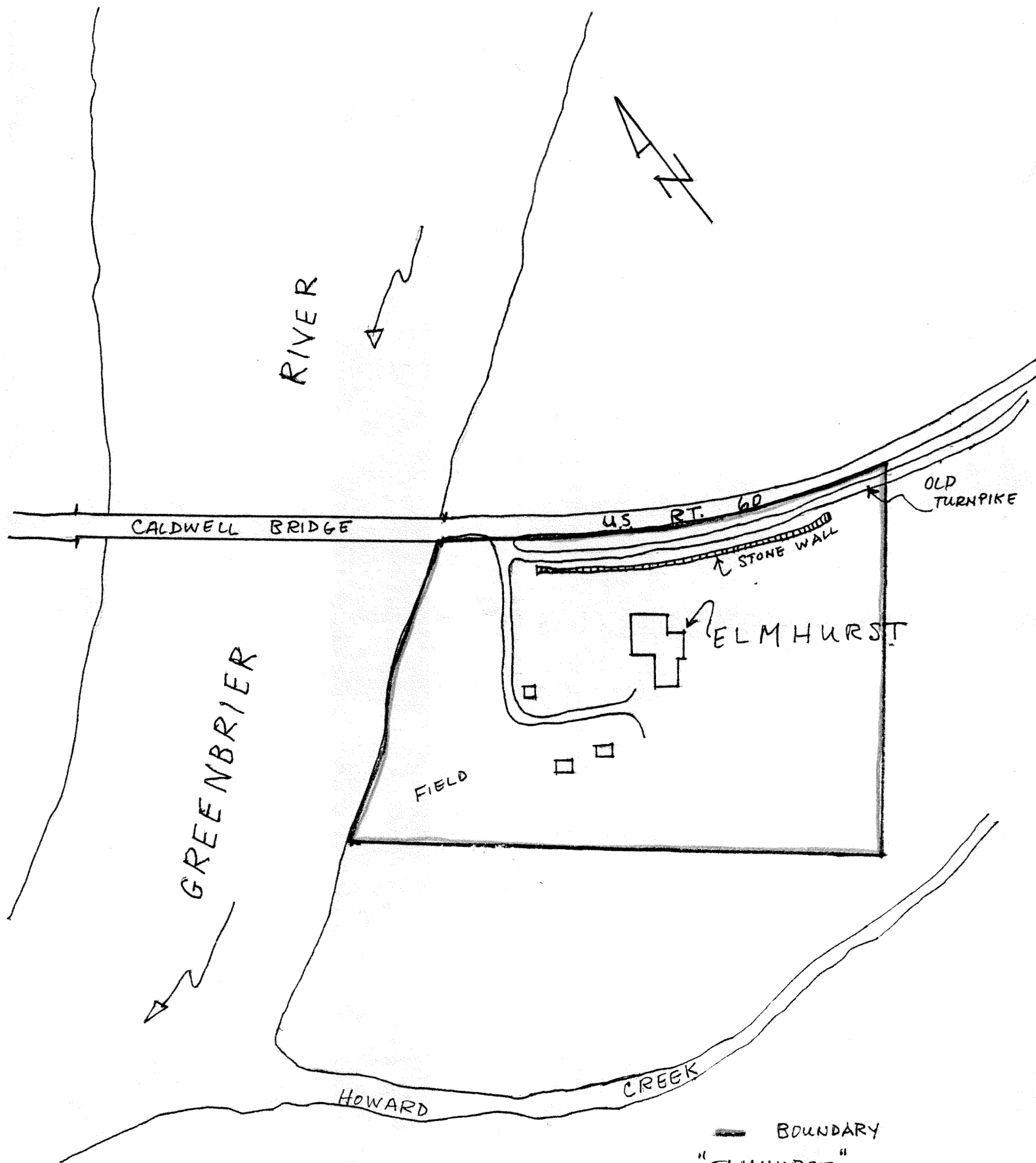

SCALE
0 200'

— BOUNDARY
"ELMHURST"
U.S. ROUTE 60
CALDWELL, GREENBRIER CO.
WEST VIRGINIA

N.R. REFERENCE NO. :
75001887

PHOTO INDEX

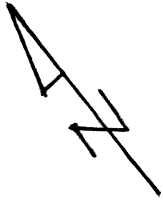

RIVER

CALDWELL BRIDGE

U.S. RT. 60

OLD TURNPIKE

STONE WALL

ELMHURST

GREENBRIER

FIELD

CREEK

HOWARD

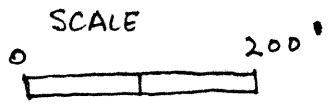

— BOUNDARY
"ELMHURST"
U.S. ROUTE 60
CALDWELL, GREENBRIER CO.
WEST VIRGINIA

