

UNITED STATES DEPARTMENT OF THE INTERIOR  
NATIONAL PARK SERVICE

**NATIONAL REGISTER OF HISTORIC PLACES  
INVENTORY -- NOMINATION FORM**

FOR NPS USE ONLY	
RECEIVED	JUN 13 1978
DATE ENTERED	DEC 4 1978

SEE INSTRUCTIONS IN *HOW TO COMPLETE NATIONAL REGISTER FORMS*  
TYPE ALL ENTRIES -- COMPLETE APPLICABLE SECTIONS

**1 NAME**

HISTORIC

Erastus Dean Farmstead

AND/OR COMMON

Dean Farm

**2 LOCATION**

STREET & NUMBER

Highway 14

CITY, TOWN

Janesville

STATE

Wisconsin

VICINITY OF

CODE

55

NOT FOR PUBLICATION

CONGRESSIONAL DISTRICT

First

COUNTY

Rock

CODE

105 ✓

**3 CLASSIFICATION**

CATEGORY	OWNERSHIP	STATUS	PRESENT USE
<input type="checkbox"/> DISTRICT	<input type="checkbox"/> PUBLIC	<input checked="" type="checkbox"/> OCCUPIED	<input checked="" type="checkbox"/> AGRICULTURE
<input checked="" type="checkbox"/> BUILDING(S)	<input checked="" type="checkbox"/> PRIVATE	<input type="checkbox"/> UNOCCUPIED	<input type="checkbox"/> MUSEUM
<input type="checkbox"/> STRUCTURE	<input type="checkbox"/> BOTH	<input type="checkbox"/> WORK IN PROGRESS	<input type="checkbox"/> COMMERCIAL
<input type="checkbox"/> SITE	<input type="checkbox"/> PUBLIC ACQUISITION	<input type="checkbox"/> ACCESSIBLE	<input type="checkbox"/> EDUCATIONAL
<input type="checkbox"/> OBJECT	<input type="checkbox"/> IN PROCESS	<input type="checkbox"/> YES: RESTRICTED	<input type="checkbox"/> ENTERTAINMENT
	<input type="checkbox"/> BEING CONSIDERED	<input type="checkbox"/> YES: UNRESTRICTED	<input type="checkbox"/> GOVERNMENT
		<input type="checkbox"/> NO	<input type="checkbox"/> INDUSTRIAL
			<input type="checkbox"/> MILITARY
			<input type="checkbox"/> OTHER:
			<input checked="" type="checkbox"/> PRIVATE RESIDENCE
			<input type="checkbox"/> PARK
			<input type="checkbox"/> RELIGIOUS
			<input type="checkbox"/> SCIENTIFIC
			<input type="checkbox"/> TRANSPORTATION

**4 OWNER OF PROPERTY**

NAME

See continuation sheet

STREET & NUMBER

CITY, TOWN

VICINITY OF

STATE

**5 LOCATION OF LEGAL DESCRIPTION**

COURTHOUSE,  
REGISTRY OF DEEDS, ETC.

Rock County Courthouse

STREET & NUMBER

51 S. Main Street

CITY, TOWN

Janesville

STATE

Wisconsin 53545

**6 REPRESENTATION IN EXISTING SURVEYS**

TITLE

Rock County Survey of Historic Sites and Buildings

DATE

1975

FEDERAL  STATE  COUNTY  LOCAL

DEPOSITORY FOR  
SURVEY RECORDS

Rock County Historical Society

CITY, TOWN

Janesville

STATE

Wisconsin 53545

# 7 DESCRIPTION

CONDITION		CHECK ONE	CHECK ONE
<input type="checkbox"/> EXCELLENT	<input type="checkbox"/> DETERIORATED	<input type="checkbox"/> UNALTERED	<input checked="" type="checkbox"/> ORIGINAL SITE late 19th c.
<input checked="" type="checkbox"/> GOOD	<input type="checkbox"/> RUINS	<input checked="" type="checkbox"/> ALTERED	<input checked="" type="checkbox"/> MOVED DATE <u>early 20th c.</u>
<input type="checkbox"/> FAIR	<input type="checkbox"/> UNEXPOSED		(some out-buildings)

## DESCRIBE THE PRESENT AND ORIGINAL (IF KNOWN) PHYSICAL APPEARANCE

The two main structures on the Dean farmstead are a 1 1/2 story frame and limestone vernacular gable-roofed house of about 1840, with a later wing, and a frame barn constructed in 1844. The other outbuildings on the farmstead include a 19th century tobacco barn moved to its present site in the early 20th century, and an early 20th century structure which originally housed migrant sugar beet workers, but is now used as a garage.

The front or north section of the house is post-framed, about 24 feet square. Siding is covered with cedar shingles, painted white. The original stone doorstep before the front door on the north side of the house is said to be two feet thick. A limestone wing, contiguous to the rear, is 24 feet wide and 14 feet deep, and is constructed of rough cut and random coursed limestone, partially covered with mortar, which is grooved into rectangles to imitate coursed orthogonal blocks. It is now whitewashed to match the front wing of the house. Straight wooden lintels are above the windows in the limestone walls. A two-panelled door with an iron handle leads from the back of this wing into the cellar, with dirt and concrete floors and rough posts and beams of prairie oak. A one-story frame wing to the south was added, probably later in the 19th century; its gabled roof intersects at right angles with the salt-box wing. Its porch was enclosed about forty years ago, and this wing is covered with white painted cedar shingles, like the front section of the house. The roof is also cedar-shingled (but not painted). The extensive use of cedar shingles is probably due to the Dean family's involvement in the lumber business since 1905.

The interior of the house has been extensively refurbished in mid-20th century vernacular taste, with pre-grooved sheet panelling and new plaster, although boxed-in oaken posts still project at the four corners of the front parlor. A cast iron stove remains in the parlor; but a fireplace on the east side of the stone wing has long been blocked up. Part of the attic was not panelled, and here the oaken posts, tongue-and-grooved floor boards, and 19th century sawed lath (above the stone wing) are visible. Generally speaking, the house is in good condition, although the stone work needs repointing and the wood lintels need repair.

The main barn is located diagonally across the farmyard from the house. About 60 feet wide and 64 feet deep, this barn is said to have been built in 1844. Handhewn timbers with adze marks, joined with wooden pegs and diagonal braces, support the building. The posts, 10" x 9" wide, and the beams, 8" x 9" wide, are probably of prairie oak. Originally occupied by both horses and cattle, the ground floor has been converted to a milking parlor. A dairy herd of 26 Holsteins and various calves occupied the quarters in 1977. The upper story remains in use as a hay mow. A small modern wing attached to the northeast corner of the barn now serves as milkhouse, although the original free-standing milk house is nearby. A silo north of the barn is no longer standing.

Five additional buildings line the south side of the farm yard, east of the main barn and to the rear of the house, and a seventh outbuilding is located to the east of the rear wing of the house. On the site of the original kitchen stands a shed structure of minimal significance.

UNITED STATES DEPARTMENT OF THE INTERIOR  
NATIONAL PARK SERVICE

**NATIONAL REGISTER OF HISTORIC PLACES  
INVENTORY -- NOMINATION FORM**

FOR NPS USE ONLY	
RECEIVED	JUN 13 1978
DATE ENTERED	DEC 4 1978

CONTINUATION SHEET

ITEM NUMBER 4 PAGE 1

OWNER OF PROPERTY

Mrs. Roy B. Dean  
c/o William A. Dean  
410 Jackman  
Janesville, Wisconsin 53545

Mrs. Daisy Dean Hutson  
1211 Garfield Street  
Madison, Wisconsin 53705

and

David A. Dean  
Avalon, Wisconsin 53505

UNITED STATES DEPARTMENT OF THE INTERIOR  
NATIONAL PARK SERVICE

**NATIONAL REGISTER OF HISTORIC PLACES  
INVENTORY -- NOMINATION FORM**

FOR NPS USE ONLY	
RECEIVED	JUN 13 1978
DATE ENTERED	DEC 4 1978

CONTINUATION SHEET

ITEM NUMBER 6 PAGE 1

---

(REPRESENTATION IN EXISTING SURVEYS, continued)

Wisconsin Inventory of Historic Places  
1975 State  
State Historical Society of Wisconsin  
Madison Wisconsin 53706

UNITED STATES DEPARTMENT OF THE INTERIOR  
NATIONAL PARK SERVICE

NATIONAL REGISTER OF HISTORIC PLACES  
INVENTORY -- NOMINATION FORM

FOR NPS USE ONLY	
RECEIVED	JUN 13 1978
DATE ENTERED	DEC 4 1978

CONTINUATION SHEET

ITEM NUMBER 7 PAGE 1

Immediately east of the main barn is a 19th century <sup>4</sup> tobacco barn, with its ventilating louvers still in place. The louvers have been nailed shut, and some board and batten has been applied. Approximately 63 feet wide and 42 feet deep, this structure may have been moved here from another location. Rough-hewn posts and beams, grooved and fitted together, are still visible in the interior of the tobacco barn, but some new beams have been substituted.

Further east and somewhat south is a former horse or <sup>5</sup> sheep barn, with stalls or pens removed. It is a simple one story structure of minor significance. Next east, and also of minor significance, is an early 20th century machine shed.<sup>6</sup> Beyond that is a garage which was built on another location on the farm before 1919 and originally was used as quarters for migrant sugar beet workers. A corn crib, of minimal significance, stands at the southeast corner of the farm yard.<sup>4</sup>

A 19th century metal fence, made up of interlocking wire ovals, borders the north side of the land along the old Racine-Janesville stage route, now U.S. Highway 14. According to family tradition this fence was built with money earned by Susan Brown Dean, the wife of James William Dean, through the boarding and rooming of travelers in the 1860's and 1870's. The yard behind the fence contains pines, cedar trees and a manual water pump which is now merely decorative.

1. "Old Home on Dean Farm..." Janesville Gazette, 1927; Dean family recollections.
2. Ibid.

# 8 SIGNIFICANCE

## PERIOD AREAS OF SIGNIFICANCE -- CHECK AND JUSTIFY BELOW

<input type="checkbox"/> PREHISTORIC	<input type="checkbox"/> ARCHEOLOGY-PREHISTORIC	<input type="checkbox"/> COMMUNITY PLANNING	<input type="checkbox"/> LANDSCAPE ARCHITECTURE	<input type="checkbox"/> RELIGION
<input type="checkbox"/> 1400-1499	<input type="checkbox"/> ARCHEOLOGY-HISTORIC	<input type="checkbox"/> CONSERVATION	<input type="checkbox"/> LAW	<input type="checkbox"/> SCIENCE
<input type="checkbox"/> 1500-1599	<input checked="" type="checkbox"/> AGRICULTURE	<input type="checkbox"/> ECONOMICS	<input type="checkbox"/> LITERATURE	<input type="checkbox"/> SCULPTURE
<input type="checkbox"/> 1600-1699	<input type="checkbox"/> ARCHITECTURE	<input type="checkbox"/> EDUCATION	<input type="checkbox"/> MILITARY	<input type="checkbox"/> SOCIAL/HUMANITARIAN
<input type="checkbox"/> 1700-1799	<input type="checkbox"/> ART	<input type="checkbox"/> ENGINEERING	<input type="checkbox"/> MUSIC	<input type="checkbox"/> THEATER
<input checked="" type="checkbox"/> 1800-1899	<input type="checkbox"/> COMMERCE	<input checked="" type="checkbox"/> EXPLORATION/SETTLEMENT	<input type="checkbox"/> PHILOSOPHY	<input type="checkbox"/> TRANSPORTATION
<input type="checkbox"/> 1900-	<input type="checkbox"/> COMMUNICATIONS	<input type="checkbox"/> INDUSTRY	<input type="checkbox"/> POLITICS/GOVERNMENT	<input type="checkbox"/> OTHER (SPECIFY)
		<input type="checkbox"/> INVENTION		

SPECIFIC DATES c. 1840, 1844 BUILDER/ARCHITECT Erastus Dean

### STATEMENT OF SIGNIFICANCE

The Dean farmstead on the Rock Prairie at Emerald Grove is probably the oldest complex of farm structures, as well as being one of the very oldest Century Farms, in Rock County. Both the post-and-beam vernacular house of about 1840 and the 1844 barn are rare in the county, as is the salt-box limestone addition to the house, and their combination in one farmstead is believed to be unique. Other outbuildings include a tobacco barn and the only documented early 20th century migrant workers' dwelling in the county. The farmstead is primarily of historical importance: its mix of buildings reflects a varied family-owned farm in operation for nearly 140 years. It is of some architectural interest because of the early frontier construction of the two oldest structures.

Erastus Dean (1798-1852) moved to Emerald Grove from Bristol, Vermont, via New York, New Jersey, and Michigan, in the winter of 1837-38. After a varied career including missionary work with the Cherokee Indians in Tennessee, Dean became the first settler of Bradford Township, Rock County, later purchasing 1,100 acres of government land at \$1.25 per acre, mostly in Bradford "where he built a home." It is presumed that the house was built around 1840. Erastus Dean also "erected a store building at Emerald Grove, having engaged in the mercantile business in New York," and he was reputed to have come to Rock County with \$10,000 in cash.

According to reminiscences attributed to William Allen Dean, grandson of the original builder, Erastus Dean built the house of wood hewn near the site where it stands, cutting "a good amount of the timber that went into it. The siding was mill cut, and was brought in from Milwaukee, the nearest sawmill. An Indian trail went through the yard.... A Spring nearby had made the ground a camping place... When the home was erected, they were allowed to enter, and often made their beds on the floor.... The old house, which has never been out of the hands of the Dean family...was built about 1840, while the barn, which also stands now, was erected in 1844. Three families lived in the house the first winter.... It was during that time that a school house was conducted in one room.... It was none too large. The frame part, erected with six by eight inch timbers, squared out of native oak logs, about 24 by 24 feet, was built first, and a stone addition, 14 by 24, was constructed immediately afterward."<sup>2</sup>

In addition to its use as an early area schoolroom (the Dean family papers include an 1848 order for school books by the half to two dozen), the house was also the site of the first church services in the region. In 1905, after the Milwaukee Road had built a new rail line through Rock Prairie, William Allen Dean, Erastus' grandson, moved to the new nearby settlement of Avalon and began the family's long involvement in the retail and wholesale lumber business which continues to the present time; that involvement is reflected in the shingled exterior of the old farm house. Since that time

# 9 MAJOR BIBLIOGRAPHICAL REFERENCES

See attached

## 10 GEOGRAPHICAL DATA

ACREAGE OF NOMINATED PROPERTY 2 1/2

QUADRANGLE NAME Shopiere, Wisconsin

QUADRANGLE SCALE 1:62,500

UTM REFERENCES

A 1,6 3,4,5,8,7,0 4,7,2,4,0,7,0

B                 
ZONE EASTING NORTHING

C               

D               

E               

F               

G               

H               

### VERBAL BOUNDARY DESCRIPTION

The boundary of the Erastus Dean Farmstead is shown as the green line on the accompanying hand-drawn map.

### LIST ALL STATES AND COUNTIES FOR PROPERTIES OVERLAPPING STATE OR COUNTY BOUNDARIES

STATE	CODE	COUNTY	CODE

## 11 FORM PREPARED BY

NAME / TITLE

Nancy Belle Douglas; Richard P. Hartung

ORGANIZATION

Rock County Historical Society

DATE

February 24, 1978

STREET & NUMBER

P. O. Box 896

TELEPHONE

(608) 756-4509

CITY OR TOWN

Janesville

STATE

Wisconsin 53545

## 12 STATE HISTORIC PRESERVATION OFFICER CERTIFICATION

THE EVALUATED SIGNIFICANCE OF THIS PROPERTY WITHIN THE STATE IS:

NATIONAL     

STATE     

LOCAL X

As the designated State Historic Preservation Officer for the National Historic Preservation Act of 1966 (Public Law 89-665), I hereby nominate this property for inclusion in the National Register and certify that it has been evaluated according to the criteria and procedures set forth by the National Park Service.

STATE HISTORIC PRESERVATION OFFICER SIGNATURE

*Richard A. Erney*

TITLE Richard A. Erney, Director  
State Historical Society of Wisconsin

DATE

5/31/78

FOR NPS USE ONLY

I HEREBY CERTIFY THAT THIS PROPERTY IS INCLUDED IN THE NATIONAL REGISTER

*[Signature]*  
KEEPER OF THE NATIONAL REGISTER

DATE

12.4.78

ATTEST:

*[Signature]*  
CHIEF OF REGISTRATION

DATE

12.1.78

UNITED STATES DEPARTMENT OF THE INTERIOR  
NATIONAL PARK SERVICE

**NATIONAL REGISTER OF HISTORIC PLACES  
INVENTORY -- NOMINATION FORM**

FOR NPS USE ONLY	
RECEIVED	JUN 13 1978
DATE ENTERED	DEC 4 1978

CONTINUATION SHEET

ITEM NUMBER 8 PAGE 1

the farm has been operated on shares, but with the active involvement of the family in the management of the land. In the early 20th century the rich land of Rock Prairie was used for raising sugar beets for processing in Janesville, and Belgian settlers were seasonally employed to raise and harvest the beets through the 1920's. The small tenant house, now a garage, dates from this period and was originally sited near the spring some distance from the farmstead proper.<sup>3</sup>

1. Brown, History of Rock County, pp. 954-955; Dean family papers; Dean family recollections.
2. "Old Home on Dean Farm..." Janesville Gazette, 1927.
3. Dean family papers, Dean family recollections.



UNITED STATES DEPARTMENT OF THE INTERIOR  
NATIONAL PARK SERVICE

**NATIONAL REGISTER OF HISTORIC PLACES  
INVENTORY -- NOMINATION FORM**

FOR NPS USE ONLY	
RECEIVED	JUN 13 1978
DATE ENTERED	DEC 4 1978

CONTINUATION SHEET

ITEM NUMBER 9 PAGE 1

Abstract of Title and other Dean family papers, in the possession of the family.

Bradford History, 1976, pp. 3,9.

Brown, Wm. F., ed., Rock County, 1908, vol. II, pp. 954-955.

Douglas and Hartung, Rock County Historic Sites and Buildings, Janesville, 1976, pp.88-159.

Dean family recollections: interviews, Virginia Dean Bell with Daisy Dean Hutson and David Dean, Fall, 1977.

"Old Home on Dean Farm..." Janesville Gazette, 1927.

Files of the Rock County Historical Society (RCHS).

POST OFFICE BOX 896  
 JANESVILLE, WISCONSIN 53545  
 PHONE 608-752-4519



FOUNDED 1948  
 440 N. JACKSON STREET

LINCOLN-TALLMAN HOUSE  
 1842 STONE HOUSE  
 CARRIAGE HOUSE MUSEUM

Legend

- 1a house, main wing
- 1b house, stone wing
- 2 main barn
- 3 milk house
- 4 tobacco barn
- 5 sheep barn
- 6 machine shed
- 7 migrant housing/garage
- 8 corn crib *structure*
- 9 shed
- 10 modern chicken house
- 11 metal fence

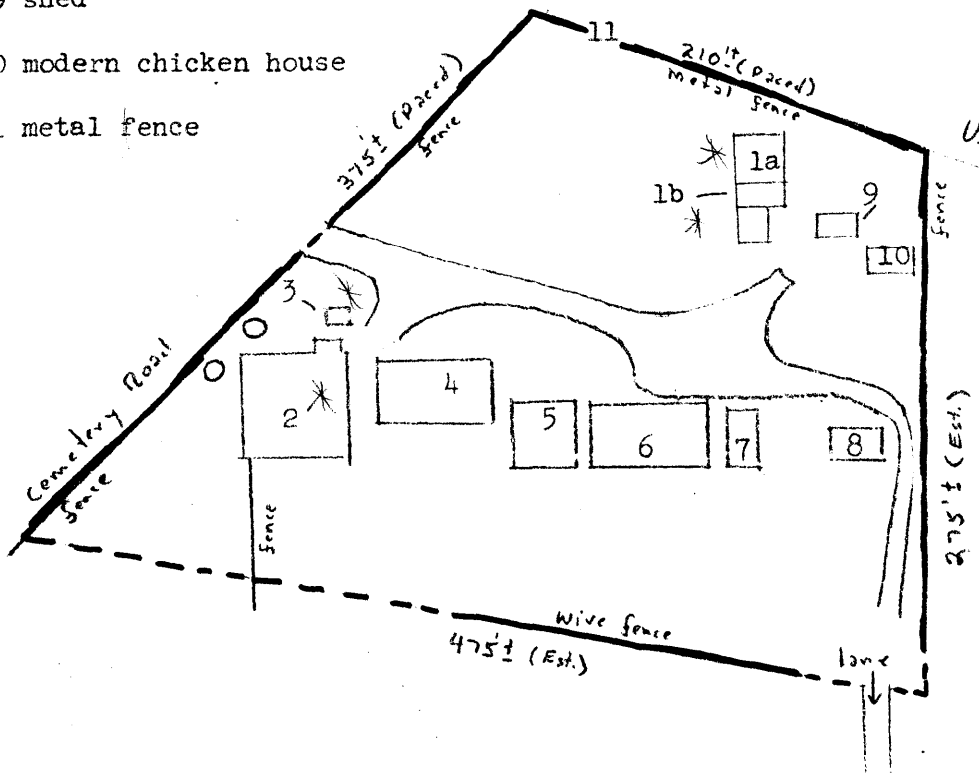
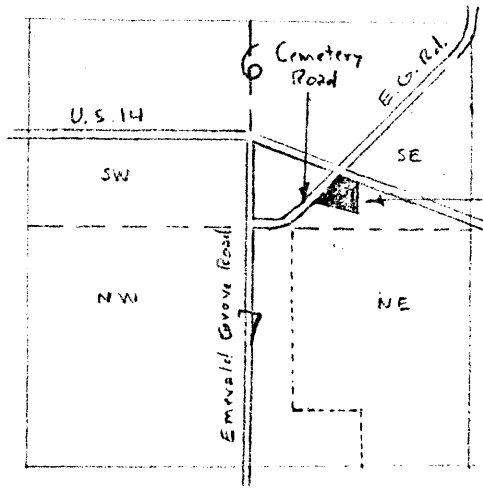

not surveyed or measured

