

**United States Department of the Interior  
National Park Service**

**National Register of Historic Places  
Continuation Sheet**

Section number \_\_\_\_\_ Page \_\_\_\_\_

**SUPPLEMENTARY LISTING RECORD**

**NRIS Reference Number:** 97000770

**Date Listed:** 7/25/97

Union Earthwork  
**Property Name**

Alcorn  
**County**

MISSISSIPPI  
**State**

N/A  
**Multiple Name**

-----  
This property is listed in the National Register of Historic Places in accordance with the attached nomination documentation subject to the following exceptions, exclusions, or amendments, notwithstanding the National Park Service certification included in the nomination documentation.

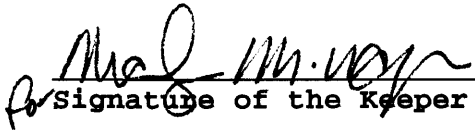
  
Signature of the Keeper

8/11/97  
Date of Action

=====  
**Amended Items in Nomination:**

Section No. 3

This nomination is amended to show that the State recommends that it be considered significant at the local level.

Section No. 5

The category of property is changed from site to structure.

These changes have been confirmed with the Mississippi SHPO.

**DISTRIBUTION:**

- National Register property file
- Nominating Authority (without nomination attachment)

United States Department of the Interior  
National Park Service  
NATIONAL REGISTER OF HISTORIC PLACES  
REGISTRATION FORM

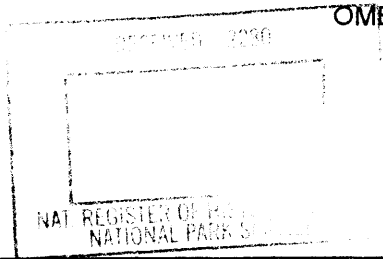

770

1. Name of Property

historic name:

other names/site number: Union Earthwork

2. Location

street & number: State Highway 356 not for publication N/A  
city or town: Rienzi vicinity X  
state: Mississippi code MS county Alcorn code 3 zip code 38865

3. State/Federal Agency Certification

As the designated authority under the National Historic Preservation Act of 1986, as amended, I hereby certify that this X nomination \_\_\_ request for determination of eligibility meets the documentation standards for registering properties in the National Register of Historic Places and meets the procedural and professional requirements set forth in 36 CFR Part 60. In my opinion, the property X meets \_\_\_ does not meet the National Register Criteria. I recommend that this property be considered significant \_\_\_ nationally X statewide X locally. ( \_\_\_ See continuation sheet for additional comments.)

Kenneth H. P. Pool JUNE 2, 1997  
Signature of certifying official Date

Deputy State Historic Preservation Officer  
State or Federal agency and bureau

In my opinion, the property \_\_\_ meets \_\_\_ does not meet the National Register criteria. ( \_\_\_ See continuation sheet for additional comments.)

\_\_\_\_\_  
Signature of commenting or other official Date

\_\_\_\_\_  
State or Federal agency and bureau

4. National Park Service Certification

I, hereby certify that this property is:  
X entered in the National Register  
\_\_\_ See continuation sheet.  
\_\_\_ determined eligible for the  
National Register  
\_\_\_ See continuation sheet.  
\_\_\_ determined not eligible for the  
National Register  
\_\_\_ removed from the National Register  
\_\_\_ other (explain): \_\_\_\_\_

Signature of the Keeper Maq M. Way Date of Action 7/25/97

**5. Classification**

---

**Ownership of Property:**  
Private

**Number of Resources within Property:**  
(Do not include previously listed resources in the count)

**Category of Property:**  
Site

| Contributing | Non-contributing |            |
|--------------|------------------|------------|
| 1            |                  | buildings  |
|              |                  | sites      |
|              |                  | structures |
|              |                  | objects    |
| 1            | 0                | Total      |

**Name of related multiple property listing:** N/A

**Number of contributing resources previously listed in the National Register:** 0

---

**6. Function or Use**

---

**Historic Functions:**  
Defense/Fortification

**Current Functions:**  
Not in Use/Forest

---

**7. Description**

---

**Architectural Classification(s):**  
No Style

**Materials:**  
foundation: earth  
roof: N/A  
walls: N/A  
other: N/A

**Narrative Description:**  
see continuation sheets

**8. Statement of Significance**

**Applicable National Register Criteria**

**Areas of Significance**  
Military

- X **A** Property is associated with events that have made a significant contribution to the broad patterns of our history.
- B** Property is associated with the lives of persons significant in our past.
- C** Property embodies the distinctive characteristics of a type, period, or method of construction or represents the work of a master, or possesses high artistic values, or represents a significant and distinguishable entity whose components lack individual distinction.
- D** Property has yielded, or is likely to yield information important in prehistory or history.

**Period of Significance**  
1862

**Significant Dates**  
1862

**Criteria Considerations:**

Property is:

- A** owned by a religious institution or used for religious purposes.
- B** removed from its original location.
- C** a birthplace or a grave.
- D** a cemetery.
- E** a reconstructed building, object or structure.
- F** a commemorative property.
- G** less than 50 years of age or achieved significance within the past 50 years.

**Significant Person(s)**  
N/A

**Cultural Affiliation(s)**  
N/A

**Architect/Builder**  
N/A

**Narrative Statement of Significance:**  
see continuation sheets

**9. Major Bibliographical References**

**Bibliography**

see continuation sheet

**Previous documentation on file (NPS)**

- preliminary determination of individual listing (36 CFR 67) has been requested.
- previously listed in the National Register
- previously determined eligible by the National Register
- designated a National Historic Landmark
- recorded by Historic American Buildings Survey  
# \_\_\_\_\_
- recorded by Historic American Engineering Record  
# \_\_\_\_\_

**Primary Location of Additional Data**

- State Historic Preservation Office
  - Other State agency
  - Federal agency
  - Local government
  - University
  - Other
- Name of repository:

**10. Geographical Data**

Acreage of Property: less than one acre

| UTM References: | Zone | Easting           | Northing | Zone | Easting | Northing |
|-----------------|------|-------------------|----------|------|---------|----------|
|                 | A    | 16/358320/3848130 |          | C    |         |          |
|                 | B    |                   |          | D    |         |          |

\_\_\_ See continuation sheet.

**Verbal Boundary Description**

see continuation sheet.

**Boundary Justification:**

see continuation sheet.

**11. Form Prepared By**

|                  |                                                                                   |                  |                  |
|------------------|-----------------------------------------------------------------------------------|------------------|------------------|
| name/title:      | Jack D. Elliott, Jr./ Historical Archaeologist with assistance of S. W. Bondurant | date:            | 26 February 1997 |
| organization:    | Mississippi Department of Archives and History                                    | street & number: | PO BOX 571       |
| street & number: | PO BOX 571                                                                        | city or town:    | Jackson          |
| city or town:    | Jackson                                                                           | state:           | MS               |
|                  |                                                                                   | zip code:        | 39205-0571       |
|                  |                                                                                   | telephone:       | (601) 359-6940   |

**Additional Documentation**

Submit the following items with the completed form:

Continuation Sheets

Maps

A USGS map (7.5 or 15 minute series) indicating the property's location.

A sketch map for historic districts and properties having large acreage or numerous resources.

Photographs

Representative black and white photographs of the property.

Additional items (Check with the SHPO or FPO for any additional items)

**Property Owner(s)**

|                  |                 |               |                |
|------------------|-----------------|---------------|----------------|
| name:            | L.D. "Bud" Cox  | telephone:    | (601) 462-5361 |
| street & number: | 709 Highway 356 | city or town: | Rienzi         |
| city or town:    | Rienzi          | state:        | MS             |
|                  |                 | zip code:     | 38865          |

**Paperwork Reduction Act Statement:** This information is being collected for applications to the National Register of Historic Places to nominate properties for listing or determine eligibility for listing, to list properties, and to amend existing listings. Response to this request is required to obtain a benefit in accordance with the National Historic Preservation Act, as amended (16 U.S.C. 470 et seq.).

**Estimated Burden Statement:** Public reporting burden for this form is estimated to average 18.1 hours per response including the time for reviewing instructions, gathering and maintaining data, and completing and reviewing the form. Direct comments regarding this burden estimate or any aspect of this form to the Chief, Administrative Services Division, National Park Service, P.O. Box 37127, Washington, DC 20013-7127; and the Office of Management and Budget, Paperwork Reductions Project (1024-0018), Washington, DC 20503.

**United States Department of the Interior  
National Park Service**

**NATIONAL REGISTER OF HISTORIC PLACES  
CONTINUATION SHEET**

Section: 7, 8

Page: 1

Union Earthwork  
Alcorn County, Mississippi

---

**Narrative Description**

The Union Earthwork at Rienzi is located on the crest of a wooded knoll immediately to the north of a cultivated field. On the north side of the earthwork, the terrain drops precipitously compared to the more level topography to the south. Protected by the terrain, the site has remained outside the pale of cultivation.

This earthwork is believed to have been constructed by Federal troops during their occupation of Rienzi, Mississippi, in 1862. It is well-preserved in the shape of a crescent and is approximately 20 meters long from cusp to cusp. The parapet is approximately 0.8 meters high above the interior, and about 1.5 to 2.0 meters high above the surrounding ditch in front. There is a remnant of a glacis in front of the ditch. Facing southwards on the crest of a ridge, it was designed to protect the position from assaults across the relatively low slopes to the south.

Based upon the accounts of relic hunters and the recollections of older area residents, a total of three sites have been located in the Rienzi vicinity that have Civil War earthworks or remnants of earthworks. This structure is the only one of the three that remains substantially intact. The earthwork maintains its original form and retains integrity of location, design, setting, materials, feeling, and association. It is one of the most intact surviving remnants of the fortifications surrounding Corinth.

**Statement of Significance**

The Union Earthwork at Rienzi is significant under Criterion A in the area of military history because of its association with the Federal occupation of the crucial rail junction of Corinth, Mississippi, and its surrounding area following withdrawal of Confederate forces from Corinth in May 1862. This fortification is one of the very few relatively intact earthworks of the type constructed by Federal forces in their efforts to fortify and defend Corinth. It specifically illustrates the construction of outlying defenses as far as eleven miles from Corinth along the major avenues of approach. It is also a well-preserved and representative example of the type of field fortifications built by the occupying Union forces. It is as well-preserved as any other earthworks of this period in the state, including such significant remains as those at Corinth, Grenada, and Grand Gulf.

The Union Earthwork at Rienzi must be understood in the context of the Federal occupation of Corinth, which is discussed in the National Historic Landmark documentation for the Siege and Battle of Corinth. (Several properties associated with the Siege and Battle of Corinth were designated as a National Historic Landmark in 1991.) Corinth was located at the intersection of two strategic railroads, the Mobile & Ohio and the Memphis & Charleston, which gave it considerable strategic importance. Following the Battle of Shiloh on April 6 and 7, 1862, and the subsequent Siege of Corinth, Confederate forces abandoned the town, withdrawing to the south by rail under cover of the night of May 29, 1862.

Following the Confederate withdrawal, Corinth was occupied by as many as 25,000 Union troops who remained through early 1864. From this fortified depot the Union forces conducted raids into Alabama, Tennessee, and the surrounding areas of Mississippi. To protect their Corinth base considerable numbers of Federal troops were stationed at such outlying sites as Rienzi, Jacinto, Burnsville, and Iuka. Up to 2,500 troops with the Fifth Division of Rosecrans's Army of the Mississippi were stationed for several months in 1862 at Rienzi (Kitchens 1987:13; Tunnard 1866:195; O.R. 1866:35-43). During this time considerable earthwork construction was carried out. Regimental records relate these activities in June of that year: "Within the last two weeks we have furnished two companies a day each for picket and entrenching duties and are now detailing from 150 to 200 men each day for duty," and "All men not being on picket guard were employed in throwing up entrenchments near Rienzi."

Sources pertaining to the occupation of Rienzi are spotty; it is not known how long the Federal troops remained there. Although there are no known sources that date the occupation to after 1862, it is quite possible that they remained until early 1864 when the Union forces abandoned Corinth.

United States Department of the Interior  
National Park Service

NATIONAL REGISTER OF HISTORIC PLACES  
CONTINUATION SHEET

Section: 9, 10

Page: 2

Union Earthwork  
Alcorn County, Mississippi

---

**Major Bibliographical References**

Brent, Joseph E. "Occupied Corinth: The contraband camp and the First Alabama Infantry of African Descent 1862-1864." A study prepared for Alcorn County, Mississippi, the City of Corinth, Mississippi, and the Siege and Battle of Corinth Commission, 1995.

Kitchens, Ben Earl. Rosecrans Meets Price. Alabama: Thornwood Book Publishers, 1987.

Siege and Battle of Corinth -- National Historic Landmark Nomination, Alcorn County, National Register File, Mississippi Department of Archives and History, Jackson.

The War of the Rebellion, A Compilation of the Official Records of the Union and Confederate Armies. Series I, vol. 17, part 1. Government Printing Office, Washington, D.C., 1886.

Tucker, Phillip Thomas. The South's Finest: The First Missouri Confederate Brigade from Pea Ridge to Vicksburg. Pennsylvania: White Mane Publishing Company, 1993.

Tunnard, Willie H. A Southern record: The story of the 3rd Louisiana Infantry. Baton Rouge, Louisiana, 1866.

**Geographical Data**

*Verbal Boundary Description*

The property is a rectangle 50 meters east-west by 40 meters north-south, centered on the middle of the earthwork, which is located at UTM reference 16/358290/3848150, in the northeast quarter of Section 3, Township 4 South, Range 7 East, in Alcorn County, Mississippi.

*Boundary Justification*

This boundary contains all of the earthwork and only the minimal area that can be considered as "the site proper."

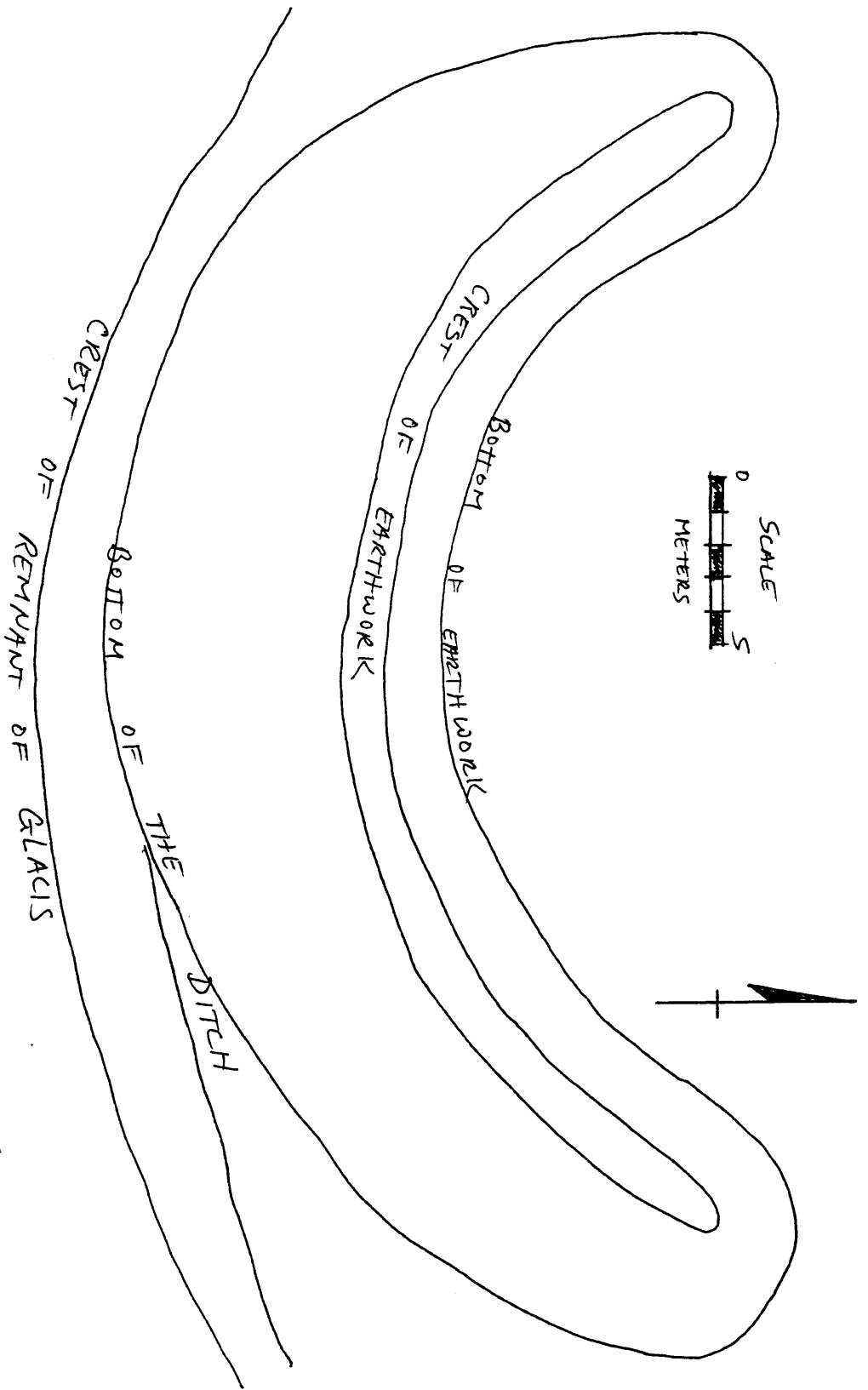

SKETCH MAP OF  
 UNION EARTHWORK  
 RIENZI, ALCOORN COUNTY, MISSISSIPPI



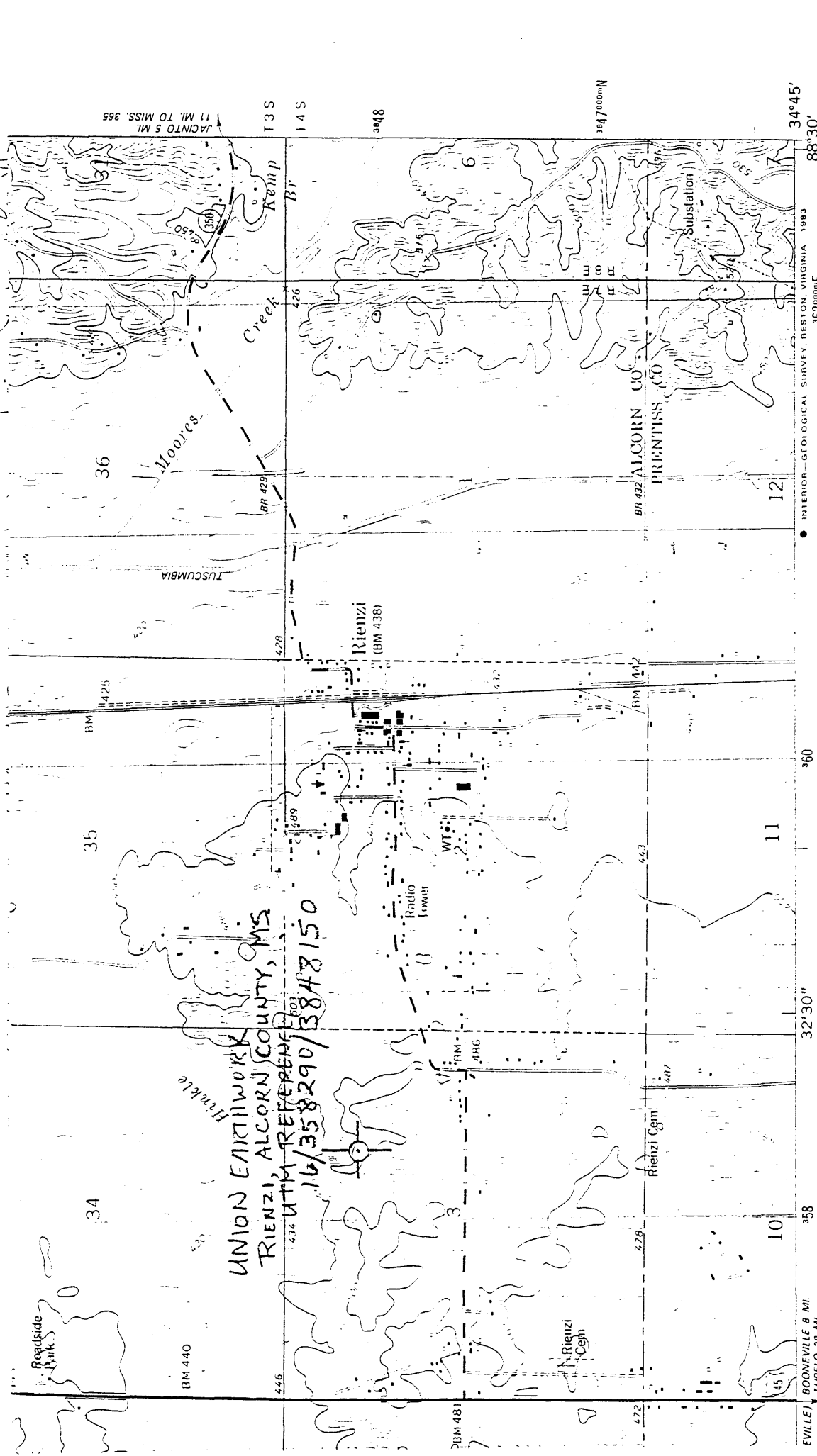

AL TITUDE  
3553 m NW

ROAD CLASSIFICATION

- Primary highway, hard surface
- Light-duty road, hard or improved surface
- Secondary highway, hard surface
- Unimproved road
- ( ) Interstate Route
- { } U. S. Route
- State Route



QUADRANGLE LOCATION

**RIENZI, MISS.**  
SE/4 CORINTH 15' QUADRANGLE  
N3445--W8830/7.5

NAL MAP ACCURACY STANDARDS  
URVEY, RESTON, VIRGINIA 22092  
AND SYMBOLS IS AVAILABLE ON REQUEST

1982

DATA FROM THE GEODETIC SURVEY