

United States Department of the Interior  
National Park Service

National Register of Historic Places  
Inventory—Nomination Form

For NPS use only  
received JUN 3 1983  
date entered

See instructions in *How to Complete National Register Forms*  
Type all entries—complete applicable sections

1. Name

historic The Arthur Jordan Memorial Hall

and/or common

2. Location

street & number 4600 Sunset Avenue/Butler University N/A not for publication

city, town Indianapolis N/A vicinity of

state Indiana code 018 county Marion code 097

3. Classification

<b>Category</b>	<b>Ownership</b>	<b>Status</b>	<b>Present Use</b>
<input type="checkbox"/> district	<input type="checkbox"/> public	<input checked="" type="checkbox"/> occupied	<input type="checkbox"/> agriculture
<input checked="" type="checkbox"/> building(s)	<input checked="" type="checkbox"/> private	<input type="checkbox"/> unoccupied	<input type="checkbox"/> commercial
<input type="checkbox"/> structure	<input type="checkbox"/> both	<input type="checkbox"/> work in progress	<input checked="" type="checkbox"/> educational
<input type="checkbox"/> site	<b>Public Acquisition</b>	<b>Accessible</b>	<input type="checkbox"/> entertainment
<input type="checkbox"/> object	<input type="checkbox"/> in process	<input checked="" type="checkbox"/> yes: restricted	<input type="checkbox"/> government
	<input type="checkbox"/> being considered	<input type="checkbox"/> yes: unrestricted	<input type="checkbox"/> industrial
	<u>N/A</u>	<input type="checkbox"/> no	<input type="checkbox"/> military
			<input type="checkbox"/> museum
			<input type="checkbox"/> park
			<input type="checkbox"/> private residence
			<input type="checkbox"/> religious
			<input type="checkbox"/> scientific
			<input type="checkbox"/> transportation
			<input type="checkbox"/> other:

4. Owner of Property

name Butler University

street & number 4600 Sunset Avenue

city, town Indianapolis N/A vicinity of state Indiana 46208

5. Location of Legal Description

courthouse, registry of deeds, etc. Marion County Recorder's Office

street & number 721 City-County Building

city, town Indianapolis state Indiana 46204

6. Representation in Existing Surveys

title N/A has this property been determined eligible?  yes  no

date  federal  state  county  local

depository for survey records N/A

city, town state

## 7. Description

### Condition

excellent  
 good  
 fair

deteriorated  
 ruins  
 unexposed

### Check one

unaltered  
 altered

### Check one

original site  
 moved date N/A

### Describe the present and original (if known) physical appearance

Arthur Jordan Memorial Hall is the oldest structure on the campus of Butler University, which is located in the north-central part of Indianapolis adjacent to the old Eli Lilly estate. It is a four-story (three above ground and one below) edifice of 186,800 square feet, and is an outstanding example of English Collegiate Gothic architecture.

The central form of Jordan Hall is a series of interconnecting quadrangles opening out from a central axis. In keeping with the architect's plan, this provides the maximum light and air, together with a continuous circulation within the building—a factor required by the climate—and is accomplished by making the stair towers the connecting elements between units.

The exterior walls are masonry bearing walls of rough variegated pink granite, trimmed, where exact surface is required, with Indiana limestone. The design features traditional Gothic battlement crestings with ribbed vaulting in each of the doorways. The battlements are accented by an ornamental belt of carved stone wrapping the entire perimeter.

The interior supports, floors and roofs are of reinforced concrete, an architectural innovation during the late Gothic revival. The materials were selected on the basis of climate, color and texture, and their manipulation was controlled by their nature and sound structural use.

The basis of the design is the expression of the structure in materials—the intention was to employ each material in accord with its natural function so that the building is executed in terms of the materials, handled entirely on the basis of their sound structural use. The aesthetics of the building's form was derived from a concern for function and simplicity rather than undue embellishment. But the symmetry of the structure is balanced by the absence of repetition. Jordan Hall is so illustrated that there is noticeable difference in the artistic detail of various similar elements. For instance, each carved panel on the building's exterior is unique in design (see attached examples). There are three series of carved panels (24 x 24 inches, 10 x 15 inches and 30 x 30 inches), each consisting of unique patterns that were, nevertheless, compatible with the individual series and the building as a whole. The delicacy of the detail in the panels is decreased with height.

There are eight arched entryways, each of which is framed in limestone. Within each entryway are oak ceiling beams and brass light fixtures, and above the doors are carved stone inscriptions:

"For My Mind Shall Speak the Truth"

"Enter To Learn, Depart to Fulfill"

"Take Fast Hold of Instruction"

"Wisdom Is The Principal Thing"

"To Everything There Is A Season"

"Have Taught Thee The Way of Wisdom"

"Hold Fast That Which Is Good"

No fundamental structural changes have been made in Jordan Hall since it was constructed in 1928, although the first phase of a renovation plan completed in 1980 updated interior space to provide for modernized classroom and office space, the installation of lifts to provide improved access for the handicapped, and the restoration of exterior masonry and replacement of the roof. All building alterations are sympathetic to the architect's original design.

# 8. Significance

Period	Areas of Significance—Check and justify below			
<input type="checkbox"/> prehistoric	<input type="checkbox"/> archeology-prehistoric	<input type="checkbox"/> community planning	<input type="checkbox"/> landscape architecture	<input type="checkbox"/> religion
<input type="checkbox"/> 1400–1499	<input type="checkbox"/> archeology-historic	<input type="checkbox"/> conservation	<input type="checkbox"/> law	<input type="checkbox"/> science
<input type="checkbox"/> 1500–1599	<input type="checkbox"/> agriculture	<input type="checkbox"/> economics	<input type="checkbox"/> literature	<input type="checkbox"/> sculpture
<input type="checkbox"/> 1600–1699	<input checked="" type="checkbox"/> architecture	<input checked="" type="checkbox"/> education	<input type="checkbox"/> military	<input type="checkbox"/> social/
<input type="checkbox"/> 1700–1799	<input type="checkbox"/> art	<input type="checkbox"/> engineering	<input type="checkbox"/> music	<input type="checkbox"/> humanitarian
<input type="checkbox"/> 1800–1899	<input type="checkbox"/> commerce	<input type="checkbox"/> exploration/settlement	<input type="checkbox"/> philosophy	<input type="checkbox"/> theater
<input checked="" type="checkbox"/> 1900–	<input type="checkbox"/> communications	<input type="checkbox"/> industry	<input type="checkbox"/> politics/government	<input type="checkbox"/> transportation
		<input type="checkbox"/> invention		<input type="checkbox"/> other (specify)

Specific dates 1928

Builder/Architect Robert Frost Daggett

## Statement of Significance (~~insert paragraph~~)

As the keystone building on Butler University's campus, Jordan Hall endures as a prime regional example of English Collegiate Gothic architecture. It is important because of its style and also because it was designed by one of Indiana's best known architects. Robert Frost Daggett gained wide acclaim for his building designs, which include some of this area's oldest public and private structures.

Even before completing the Jordan Hall design in 1927, Daggett had earned a full entry in the book, Indianapolis Men of Affairs, published in 1923 by The American Biographical Society. He was cited, in particular, for having been the first Hoosier architect to be named a Fellow of the American Institute of Architects, the highest professional honor an architect can achieve among his peers.

Daggett was born in Indianapolis in 1875. After graduating from the old Indianapolis High School, he attended the University of Pennsylvania and in 1901 completed requirements for graduation from the Ecole Des Beaux Arts in Paris. In 1915 he joined his father's well-established architectural firm in Indianapolis. At the time of the Jordan Hall design, he was associated with Thomas Hibben.

Still active professionally at the time of his death in 1955, the 80-year-old Daggett had an extensive list of local buildings to his design credit. The list includes the Chamber of Commerce Building, Tabernacle Presbyterian Church, Herron Art Institute, the City Trust Building, the Consolidated Building, Eli Lilly and Company buildings in Indianapolis and Greenfield, the Indianapolis Athletic Club, Riley Children's Hospital, LaRue Carter Hospital, Robert W. Long Hospital, the Indiana University School of Medicine, Community Hospital, and many structures on the Bloomington campus of Indiana University.

Daggett intended the Jordan Hall design of 1927 to establish an architectural style for the Butler campus development. The prominent Gothic buttresses flank the facades as the Gothic effects dignify the towers of the building. The design of newer buildings on the campus—Gallahue Hall and the Holcomb Institute complex, for example—reflects a sensitivity to the distinctive presence of Jordan Hall. As renovation continues toward complete modernization of its interiors, Jordan's exterior retains the structural strength and beauty of its original design.

# 9. Major Bibliographical References

Please see continuation sheet

# 10. Geographical Data

Acreage of nominated property 1.82 acres

Quadrangle name Indianapolis, West

Quadrangle scale 1:24000

UTM References

A 

1	6	5	7	0	8	2	0	4	4	0	9	9	7	0
Zone		Easting				Northing								

B 

Zone		Easting				Northing								

C 

Zone		Easting				Northing								

D 

Zone		Easting				Northing								

E 

Zone		Easting				Northing								

F 

Zone		Easting				Northing								

G 

Zone		Easting				Northing								

H 

Zone		Easting				Northing								

Verbal boundary description and justification

Please see continuation sheet

List all states and counties for properties overlapping state or county boundaries

state N/A code county code

state code county code

# 11. Form Prepared By

Dr. Thomas McClanahan, Director of Grants and Special Projects, in cooperation with architects from The McGuire and Shook Corporation

organization Butler University date 9-15-82

street & number 4600 Sunset Avenue telephone 317/283-9331

city or town Indianapolis state Indiana 46208

# 12. State Historic Preservation Officer Certification

The evaluated significance of this property within the state is:

national  state  local

As the designated State Historic Preservation Officer for the National Historic Preservation Act of 1966 (Public Law 89-665), I hereby nominate this property for inclusion in the National Register and certify that it has been evaluated according to the criteria and procedures set forth by the National Park Service.

State Historic Preservation Officer signature J. M. Kidenon

title Indiana State Historic Preservation Officer date 5-16-83

For NPS use only

I hereby certify that this property is included in the National Register

Entered in the National Register

date 6/30/83

for Shelton Byers  
Keeper of the National Register

Attest:

date

Chief of Registration

**United States Department of the Interior  
National Park Service**

**National Register of Historic Places  
Inventory—Nomination Form**

For NPS use only

received

date entered

Arthur Jordan

Continuation sheet Memorial Hall

Item number 9

Page 1

Brown, Paul Donald, ed. Indianapolis Men of Affairs. Indianapolis: The American Biographical Society, 1923, p. 143.

Hibben, Thomas, "Analysis of Design," The American Architect, January 5, 1928

Hibben, Thomas, "Arthur Jordan Building, Butler University," The American Architect, January 5, 1928, pp. 1-26.

Indianapolis Architecture. Indianapolis: Indiana Architectural Foundation, 1975.

Indianapolis News. Files on Jordan Hall and Robert Frost Daggett.

Indianapolis Star. Files on Robert Frost Daggett.

Indianapolis Times. Files on Robert Frost Daggett.

Naegele, F. Harold, AIA. Letter to Michael A. Tomlan, Ball State University.  
January 25, 1979.

**United States Department of the Interior  
National Park Service**

**National Register of Historic Places  
Inventory—Nomination Form**

Arthur Jordan

Continuation sheet Memorial Hall

Item number 10

Page 2

For NPS use only

received

date entered

Butler University, Oxford Place; being part of lot 55 of Columbia Place addition. An addition to the City of Indianapolis and recorded in Plat Book 9, page 161, Marion County Recorder's Office; lying East of the East line of Clarendon Road, as now open, excepting, however, a strip 25 feet wide, between parallel line off the North side of lot 55. The same being the South half of 43rd Street as now opened. All of which is more particularly described as follows:

Beginning at a point a distance of 179 feet South of the Northeast corner of said lot 55, along the East line of lot 55, continuing thence South along the East line thereof for a distance of 450 feet to the corner of said lot 55 and the North line of 42nd Street; thence in a Westerly direction a distance of 177.80 feet along the South line of lot 55 and the North line of 42nd Street to the East line of Clarendon Road, above mentioned; thence Northwardly along said East line 450 feet to a point; thence Eastwardly a distance of 178.92 feet to place of beginning. Containing 1.82 acres, more or less.



DESIGNS FOR THREE OF A SERIES OF CARVED PANELS, 24X24 INCHES

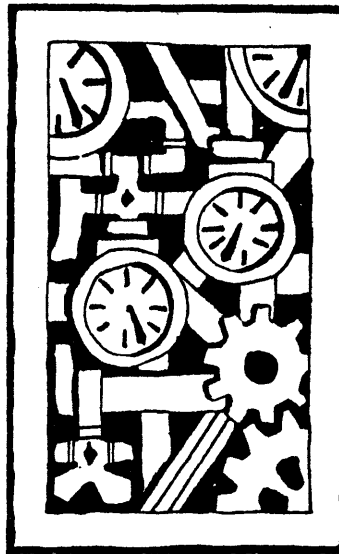
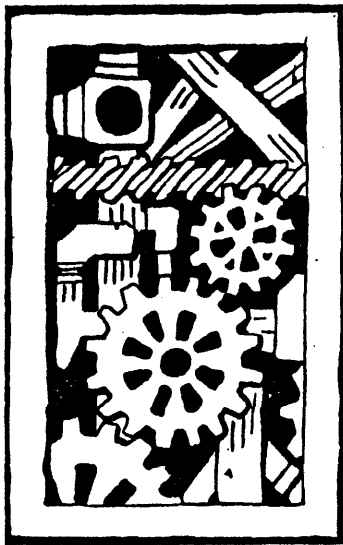

DESIGNS FOR THREE OF A SERIES OF CARVED PANELS, 10X15 INCHES

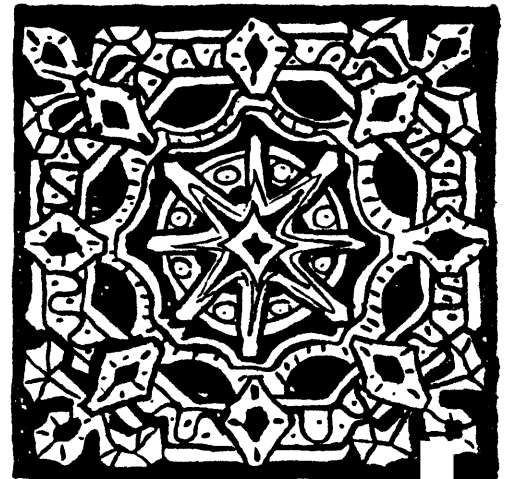



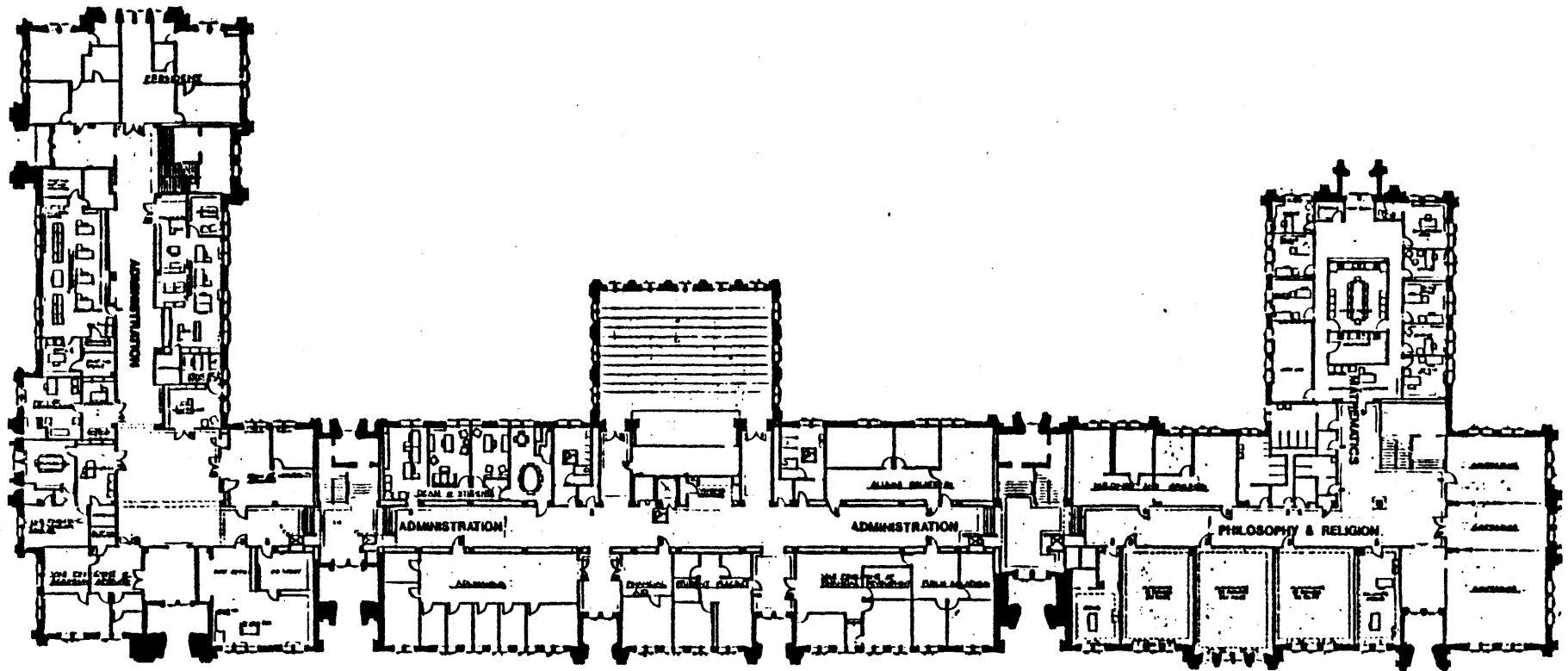

DESIGNS FOR TWO OF A SERIES OF CARVED PANELS, 30 X 30 INCHES

THESE DESIGNS ARE BASED ON THE USE OF THE PNEUMATIC CHISEL WITHOUT FINISHING. THE PATTERN IS SHOWN IN BLACK AND WHITE WITH VARYING THIRD DIMENSIONAL DEPTHS. ALL CARVING IS BACK OF THE SURFACE OF THE STONE. NARROW LINES INDICATE V-SHAPED INCISED LINES

ARTHUR JORDAN GROUP, BUTLER UNIVERSITY, INDIANAPOLIS, IND.



 WALLS  

 OPENINGS  

 STAIRS  

 ELEVATOR

**FIRST FLOOR**  
 1917-18

JORDAN HALL  
**BUTLER UNIVERSITY**