

HISTORIC PRESERVATION UNIT
DEPARTMENT OF CULTURE & HISTORY
SCIENCE & CULTURE CENTER
CHARLESTON, WEST VIRGINIA 25305

File No: 7
Theme(s):
Neg No(s):
USGS Quad:
UTM Ref: 17 451660 4376160

DISTRICT . SITE . BUILDING . STRUCTURE . OBJECT

- 1. NAME(S), historic/common: Sharon Lodge #28 I.O.O.F.
(Downtown Parkersburg MA)
- 2. LOCATION, street/road: 316 Fifth St. (W corner of 5th St. & Phillips Court)
TAX MAP - LOT # 93-20
city/town: Parkersburg, WV 26101
(incorporated/unincorporated)
- 3. USE/FUNCTION, present: commercial/social hall (lodge) (public/private restricted)
original: social hall (lodge)
- 4. OWNER/ADDRESS, present: I.O.O.F. (public/private)
address above
original: Sharon Lodge #28 I.O.O.F.
310 Ninth Street, Parkersburg
- 5. PHOTO/SKETCH OF: 8112-R2-F15
8201-R1-F 12-16
- 7. PLAN (include approx. dimensions):



6. LOCALE/ENVIRONMENT (map):

8. ACREAGE (approx):

40' x 85'

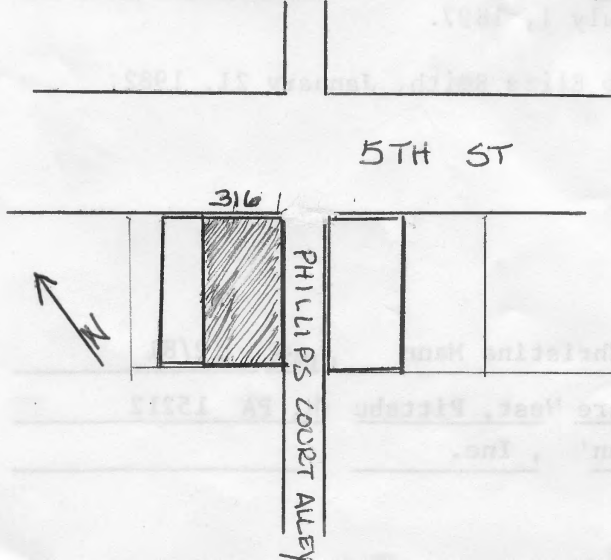

COUNTY: WOOD
Survey Region: _____
Planning District: _____

9. DESCRIPTION (clarify as appropriate): See attached

a. Exterior Fabric

stone trim _____
 brick Pompeian _____
 concrete _____
 stucco _____
 weatherboard _____
 clapboard _____
 board & batten _____
 shingle _____
 other _____

b. Structural System

masonry X _____
 frame _____
 log _____
 metal _____
 other _____
 foundation stone _____

c. Roofing Material

wood _____
 metal _____
 slate On tall hip roof over front _____
 tile _____ portion _____
 asphalt _____
 composition _____
 other _____

d. Associated Structures (use/type):

outbuildings _____

 dependencies _____

 other _____

e. Integrity (include dates):

original site/relocated _____
 alterations 1st and 2nd story _____
brick infill _____

 additions _____

f. Condition:

excellent _____
 good _____
 fair X _____
 deteriorated _____
 abandoned _____

g. Threats:

None apparent.

10. SIGNIFICANCE (use additional sheet if necessary):

- a. Architect/Builder/Engineer:
Harry R. Warne, Arch.
J.M. Charfer, Builder
- b. Style/Period: Romanesque/
Eclectic
- c. Date(s): 1897 (datestone)

This building incorporates an eclectic combination of Romanesque features, including broad stone arches, squat colonettes, and deep medieval corbeling. It is the earliest known work of a significant West Virginia architect.

While marred by 1st story front elevation alterations, the building as a whole reflects significant late Victorian design features that have nearly disappeared from the downtown. The vertical emphasis of the Dutch stepped parapet and steep hip roof, is characteristic of two important turn-of-the-century buildings: Parkersburg City Hall (demolished) and Wood County Courthouse. Architect H. Rus Warne (1872-1954) of Parkersburg and Charleston later attained statewide fame for his buildings and public commissions and as an organizer of professional architects.

11. BIBLIOGRAPHY:

Parkersburg State Journal, July 1, 1897.

Letter from Rodney Collins to Eliza Smith, January 21, 1982.

12. FORM PREPARED BY Eliza Smith, Christina Mann, DATE 12/81

a. Address Allegheny Square West, Pittsburgh, PA 15212

b. Organization Landmarks Plann, Inc.

Sharon Lodge #28 I.O.O.F.
316 Fifth St. (W corner of 5th St. & Phillips Court Alley)
93-20

This 5-story building incorporates an eclectic combination of basically Romanesque features. Its 2 to 3 bay facade is crowned by a deep Chateaufesque hip roof over the front portion, fronted by 2 stepped gable parapets; the gables contain oculars above paired d/s with colonettes; cornice-level corbeling flanks the gables and wraps around the sides of the building. The 4th story features 6 d/s windows with relieving arches, separated by pilaster strips and resting on a continuous sill course. Above the 3rd story is a deep corbeled cornice; the central bay contains a lowered triad of stilted arched windows (transomed 1/1) whose pilaster strip capitals and sill course continues as a sill course for the triad d/s with squat colonettes in the flanking bays. The 1st and 2nd stories, having a broad arched aperture flanked by 2 tall narrow ones, are now mostly filled in with brick. The rear is inaccessible, but appears to be quite plain.

