

United States Department of the Interior
National Park Service

National Register of Historic Places
Inventory—Nomination Form

For NPS use only
received AUG 31 1982
date entered

See instructions in *How to Complete National Register Forms*
Type all entries—complete applicable sections

1. Name

historic Phillips Woolen Mill

and/or common Phillips Woolen Mill

2. Location

street & number 71 Grove Street N/A not for publication

city, town Adams N/A vicinity of ~~Congressional district~~

state Massachusetts code 025 county Berkshire code 003

3. Classification

Category	Ownership	Status	Present Use
<input type="checkbox"/> district	<input type="checkbox"/> public	<input checked="" type="checkbox"/> occupied	<input type="checkbox"/> agriculture
<input checked="" type="checkbox"/> building(s)	<input checked="" type="checkbox"/> private	<input type="checkbox"/> unoccupied	<input type="checkbox"/> commercial
<input type="checkbox"/> structure	<input type="checkbox"/> both	<input type="checkbox"/> work in progress	<input type="checkbox"/> educational
<input type="checkbox"/> site	Public Acquisition	Accessible	<input type="checkbox"/> entertainment
<input type="checkbox"/> object	<input type="checkbox"/> in process	<input checked="" type="checkbox"/> yes: restricted	<input type="checkbox"/> government
	<input checked="" type="checkbox"/> being considered	<input type="checkbox"/> yes: unrestricted	<input checked="" type="checkbox"/> industrial
		<input type="checkbox"/> no	<input type="checkbox"/> military
			<input checked="" type="checkbox"/> other: warehouse
			<input type="checkbox"/> museum
			<input type="checkbox"/> park
			<input type="checkbox"/> private residence
			<input type="checkbox"/> religious
			<input type="checkbox"/> scientific
			<input type="checkbox"/> transportation

4. Owner of Property

name Mullen Bros., Inc. of North Adams

street & number 71 Grove Street

city, town Adams N/A vicinity of state Massachusetts 01220

5. Location of Legal Description

courthouse, registry of deeds, etc. Northern Berkshire Registry of Deeds

street & number Town Hall, Park Street

city, town Adams state Massachusetts 01220

6. Representation in Existing Surveys

title Inventory of Historic Assets of the Commonwealth #608 has this property been determined eligible? yes no

date September 1980 federal state county local

depository for survey records Massachusetts Historical Commission

city, town 294 Washington Street, Boston state Massachusetts 02108

7. Description Phillips Woolen Mills, 71 Grove St., Adams, MA

Condition		Check one	Check one	
<input type="checkbox"/> excellent	<input type="checkbox"/> deteriorated	<input type="checkbox"/> unaltered	<input checked="" type="checkbox"/> original site	N/A
<input type="checkbox"/> good	<input type="checkbox"/> ruins	<input checked="" type="checkbox"/> altered	<input type="checkbox"/> moved	date _____
<input checked="" type="checkbox"/> fair	<input type="checkbox"/> unexposed			

Describe the present and original (if known) physical appearance

The former Phillips Woolen Mill stands on the west side of Grove Street near the Cheshire town line. The mill contains five different sections of various construction, all of which have had their windows covered.

The largest and most visible section of the mill is building #1 (see attached map). Building #1 (ca 1864) is a three-story brick structure with a four-story tower centered on its south end. The building rests on a foundation of coursed rubble and is enclosed by a pitched roof trimmed with a wide brick cornice. Window openings are evenly spaced one per bay; each is framed by a rectangular sill and lintel of slate. The east elevation contains 19 bays, although only the northernmost 6 bays of the first story retain 12/12 sash. The 7th and 8th bays from the north have been rebuilt with a garage door at the first story. The gabled north elevation contains an arched entry flanked by 4 windows at the first story and 6 windows at both the second and third stories; some of these windows retain original 12/12 and 8/8 sash.

The gable contains four windows surmounted by a seven-sided light. Set out from the central two bays of the north elevation is a mid-nineteenth century fire escape of cast iron. The west elevation of building #1 is blocked by an addition at the first story and has 15 bays exposed at both the second and third stories. The south elevation is dominated by the tower, which is blank on all faces except its east elevation which has paired windows at the first three stories and a tri-partite window at the fourth. Added to the south face of the tower is a small brick structure (ca 1920-30?) which, presumably, contains plumbing.

Building #6 (ca 1864) extends southward from the southwest corner of Building #1; it is built of brick, two stories high and has the same details as Building #1. The east elevation of building #6 contains 6 bays although those of the first story have been partially rebuilt. The south elevation is four bays wide and contains two added garage doors (1950's) at the first story, four windows at the second and a loading bay and one window in the gable. The north elevation contains nine bays, one with a loading door, and is above ground level at the second story only.

Building #4 (ca 1864?) is a three-story structure built of rubble stone and attached to Building #1 (east) and Building #1A (west). Enclosed by a low-pitched roof, Building #4 has been extensively altered. Originally it had evenly spaced bays each containing one window (12/12 or 20/20) per story; each window was set in a stone surround with a wooden lintel as sill. Due to later additions, the north elevation possesses only three exposed bays at the first story and nine each at the second and third. The south elevation has been more extensively altered due to an addition (formerly Building #5 - ca 1895) which has subsequently been removed. The south elevation contains some brick and concrete at its base, only two windows at the second story and eight at the third.

Building #4A (ca 1920-30) is a poured concrete structure built on a base of steel "I" beams, which elevates the structure to the same level as the third story of Building #4 to which it is attached. The west elevation contains a central doorway

(continued)

**United States Department of the Interior
National Park Service**

**National Register of Historic Places
Inventory—Nomination Form**

Phillips Woolen Mill, Adams

Continuation sheet

Item number 7

Page 1

For NPS use only

received

date entered

flanked by two windows, the north elevation contains three windows and the south contains a central loading bay flanked by two windows. Where the base of this section rises above ground level, it is covered with sheets of corrugated metal.

Buildings #2 and #3 (ca 1920-30) are a one-story wood and brick structure built along the west elevation of Building #1 and the north elevation of Building #4. Both are enclosed by a low-sloping roof; the north elevation is faced with brick and contains a loading door, entry and windows. The west elevation is covered with stucco and contains twelve evenly spaced windows.

Although water courses and raceways have been filled with earth during the mid-twentieth century channels once passed beneath Building #4.

8. Significance

Phillips Woolen Mills, 71 Grove St., Adams, MA

Period	Areas of Significance—Check and justify below			
<input type="checkbox"/> prehistoric	<input type="checkbox"/> archeology-prehistoric	<input type="checkbox"/> community planning	<input type="checkbox"/> landscape architecture	<input type="checkbox"/> religion
<input type="checkbox"/> 1400-1499	<input type="checkbox"/> archeology-historic	<input type="checkbox"/> conservation	<input type="checkbox"/> law	<input type="checkbox"/> science
<input type="checkbox"/> 1500-1599	<input type="checkbox"/> agriculture	<input type="checkbox"/> economics	<input type="checkbox"/> literature	<input type="checkbox"/> sculpture
<input type="checkbox"/> 1600-1699	<input checked="" type="checkbox"/> architecture	<input type="checkbox"/> education	<input type="checkbox"/> military	<input type="checkbox"/> social/ humanitarian
<input type="checkbox"/> 1700-1799	<input type="checkbox"/> art	<input type="checkbox"/> engineering	<input type="checkbox"/> music	<input type="checkbox"/> theater
<input checked="" type="checkbox"/> 1800-1899	<input type="checkbox"/> commerce	<input type="checkbox"/> exploration/settlement	<input type="checkbox"/> philosophy	<input type="checkbox"/> transportation
<input type="checkbox"/> 1900-	<input type="checkbox"/> communications	<input checked="" type="checkbox"/> industry	<input type="checkbox"/> politics/government	<input type="checkbox"/> other (specify)
		<input type="checkbox"/> invention		

Specific dates 1864 or earlier **Builder/Architect** unknown

Statement of Significance (in one paragraph)

The former Phillips Woolen Mill possesses integrity of location, design and materials as well as historical associations with the industrial development of Adams. It is also an excellent example of mid-nineteenth century mill construction. Thus it meets criteria A and C of the National Register of Historic Places.

The site on which the mill stands was first developed for its water power, soon after January 9, 1828 when Nathan Mason, a farmer, granted the property and the right to build a dam to his sons Almond W. and Ethan A. By 1832 a cotton factory, three houses, a shed and a barn had been built by the brothers, who sold an interest in their mill to Jesse Jenks of Cheshire In July 1833, a judgement against the mill's owners resulted in the property's return to Nathan Mason who sold it to Ira Mason on February 11, 1839. By 1845, the mill had been sold again, to Stephen L. and Silas H. Arnold who manufactured cotton goods here until the beginning of the Civil War.

Perhaps as a result of the cotton shortages which accompanied the Civil War, the mill was converted to the manufacture of woolen goods in 1864 by its new owners, Peter Blackinton and Benjamin F. Phillips. Formed in 1853, the firm of Blackinton & Phillips had occupied rental space until 1860-1861 when it built the nearby Maple Grove Woolen Mill. Following its 1864 purchase of the Phillips Mill, the firm dissolved and Benjamin Phillips took title to the mill under the name of B. F. Phillips & Co. The Phillips family continued to manufacture woolen goods on this site until the early twentieth century when the Adams Woolen Manufacturing Company purchased the property. Manufacturing in this mill ceased gradually between the 1930's and early 1950's when the last machinery was moved out and the building was fully converted to use as a storehouse.

An excellent local example of mill architecture of the mid-nineteenth century, the former Phillips Mill is Adams' best remaining of the small-scale brick mills which figured prominently in its early industrial development (ca 1815-1850). Although secondary sources report that the mill was built by Blackinton & Phillips in 1864, it seems more likely that its brick sections were built in the 1840s or early 1850s and that these sources have mistakenly reported the date of the mill's conversion to wool as its date of construction. A construction date of ca. 1840-1855 would be supported by the scale and Greek Revival style trim of Buildings #1 & #6. It is also possible that the stone section of the mill was part of the original E. & A. Mason Mill of 1828-1832, although the use of rubble stone construction was relatively common in the Adams area from ca. 1830-1860, making it difficult to provide a date for this section based on its exterior appearance. Other sections of the mill (Buildings #4A & #2) appear to have been built during the 1920s, probably for the Adams Woolen Manufacturing Company.

9. Major Bibliographical References

Child, Hamilton. Berkshire County Gazetteer. Syracuse, N.Y.: Hamilton Child, 1885
Berkshire County Deeds: Bk. 40 p. 106; Bk. 35 p. 487-488; Bk. 40, p. 147; Bk. 50, p. 295

10. Geographical Data

Acree of nominated property 1.154 acres

Quadrangle name Cheshire

Quadrangle scale 1:25000

UMT References

A

18	6	53	0	210	4	7	118	5	170
Zone	Easting			Northing					

B

Zone	Easting			Northing					

C

Zone	Easting			Northing					

D

Zone	Easting			Northing					

E

Zone	Easting			Northing					

F

Zone	Easting			Northing					

G

Zone	Easting			Northing					

H

Zone	Easting			Northing					

Verbal boundary description and justification

The nominated property includes only the lot on which the mill stands; this lot is described in Berkshire County Deeds, Book 674, page 1037. The boundaries of this lot correspond approximately to those of the property's nineteenth century "Factory Lot."

List all states and counties for properties overlapping state or county boundaries

state	code	county	code
N/A			

state	code	county	code
-------	------	--------	------

11. Form Prepared By

Brian Pfeiffer

name/title Candace Jenkins, Registration Director with ACT for Massachusetts

organization Massachusetts Historical Commission

date June 1982

street & number 294 Washington Street

telephone (617) 727-8470

city or town Boston

state Massachusetts

12. State Historic Preservation Officer Certification

The evaluated significance of this property within the state is:

national state local

As the designated State Historic Preservation Officer for the National Historic Preservation Act of 1966 (Public Law 89-665), I hereby nominate this property for inclusion in the National Register and certify that it has been evaluated according to the criteria and procedures set forth by the National Park Service:

State Historic Preservation Officer signature

Valerie Ann Talmage

title Executive Director, Massachusetts Historical Commission

date Aug 24, 1982

For NPS use only

I hereby certify that this property is included in the National Register

Entered in the
National Register

date

9/30/82

for *Delores Byer*
Keeper of the National Register

Attest:

date

Chief of Registration

Phillips. WOOLEN MILL
71 Grove Street
Adams, Massachusetts

Sketch Map

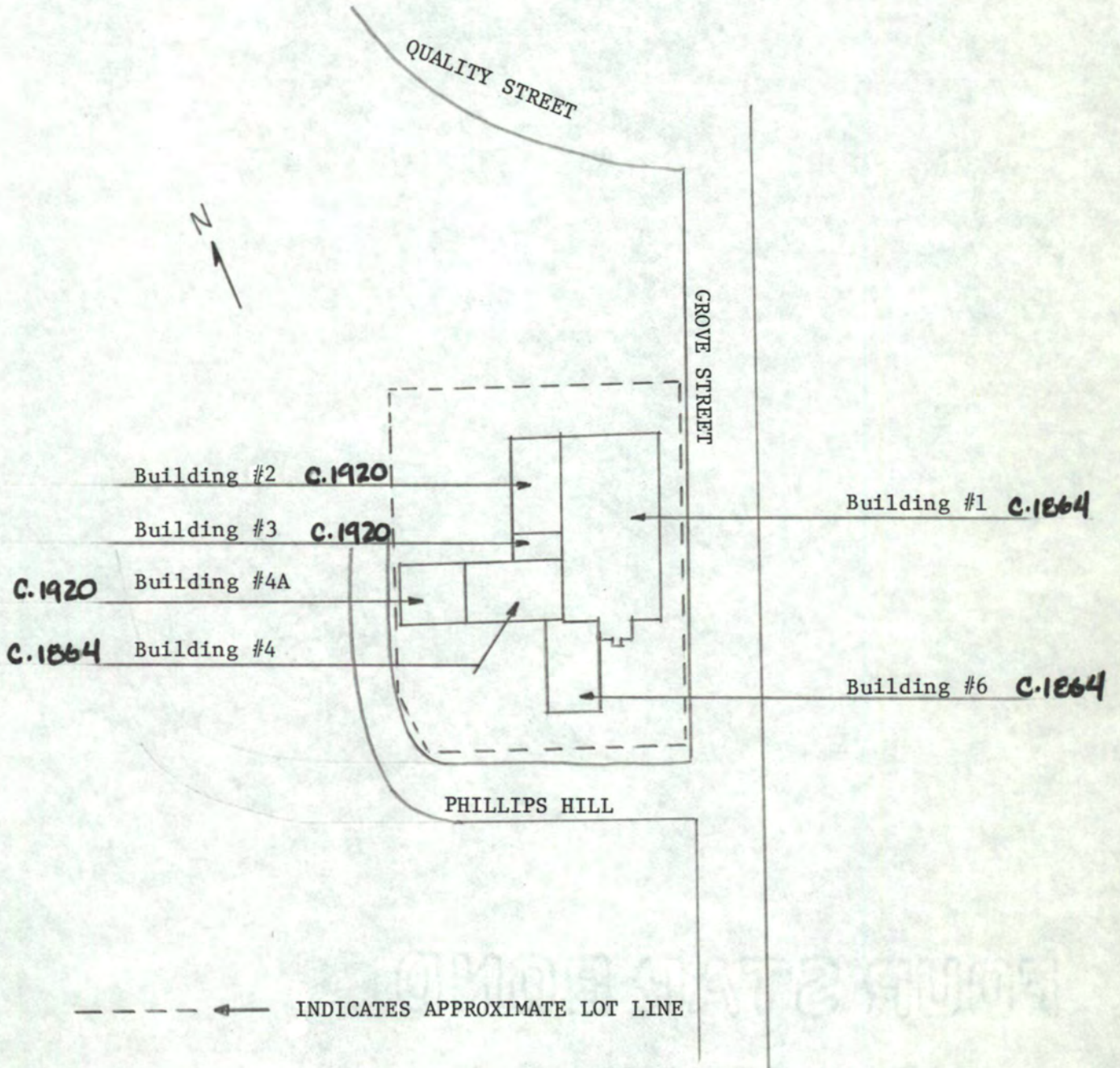

United States Department of the Interior
National Park Service

Phillips Wollen Mill
Berkshire County
MASSACHUSETTS

Working No. 8/31/82-2371
Fed. Reg. Date: 2.1.83
Date Due: 9/30/82 - 10/15/82

Action: ACCEPT 9/30/82
Entered in the RETURN
National Register REJECT

Federal Agency: _____

- resubmission
 - nomination by person or local government
 - owner objection
 - appeal
- Substantive Review: sample request appeal NR decision

Reviewer's comments:

Recom. / Criteria _____
Reviewer _____
Discipline _____
Date _____
 see continuation sheet

Nomination returned for: technical corrections cited below
 substantive reasons discussed below

1. Name

2. Location

3. Classification

Category	Ownership	Status	Present Use
	Public Acquisition	Accessible	

4. Owner of Property

5. Location of Legal Description

6. Representation in Existing Surveys

has this property been determined eligible? yes no

7. Description

Condition		Check one	Check one
<input type="checkbox"/> excellent	<input type="checkbox"/> deteriorated	<input type="checkbox"/> unaltered	<input type="checkbox"/> original site
<input type="checkbox"/> good	<input type="checkbox"/> ruins	<input type="checkbox"/> altered	<input type="checkbox"/> moved date _____
<input type="checkbox"/> fair	<input type="checkbox"/> unexposed		

Describe the present and original (if known) physical appearance

- summary paragraph
- completeness
- clarity
- alterations/integrity
- dates
- boundary selection

8. Significance

Period _____ Areas of Significance—Check and justify below

Specific dates _____ Builder Architect _____

Statement of Significance (In one paragraph)

- summary paragraph
- completeness
- clarity
- applicable criteria
- justification of areas checked
- relating significance to the resource
- context
- relationship of integrity to significance
- justification of exception
- other

9. Major Bibliographical References

10. Geographical Data

Acres of nominated property _____

Quadrangle name _____

UMT References _____

Verbal boundary description and justification _____

11. Form Prepared By

12. State Historic Preservation Officer Certification

The evaluated significance of this property within the state is:

national state local

State Historic Preservation Officer signature _____

Title _____ date _____

13. Other

- Maps
- Photographs
- Other

Questions concerning this nomination may be directed to _____

Signed _____ Date _____ Phone: 202 272-3504

Comments for any item may be continued on an attached sheet



Phillips Woolen Mill

Adams, Massachusetts

Brian Pfeiffer, photographer June 19, 1981

negative at: ACT for Massachusetts
45 School Street
Boston, Massachusetts 02108

view of the east and north elevations of the
Main Building taken from a position facing
southwest



Phillips Woolen Mill

Adams, Massachusetts

Brian Pfeiffer, photographer

June 19, 1981

negative at: ACT for Massachusetts
45 School Street
Boston, Massachusetts 02108

view of the south and east elevations, showing
(left to right) sections #4A, 4, 6 and 1
(Main Mill Building) taken from a position
facing northwest.

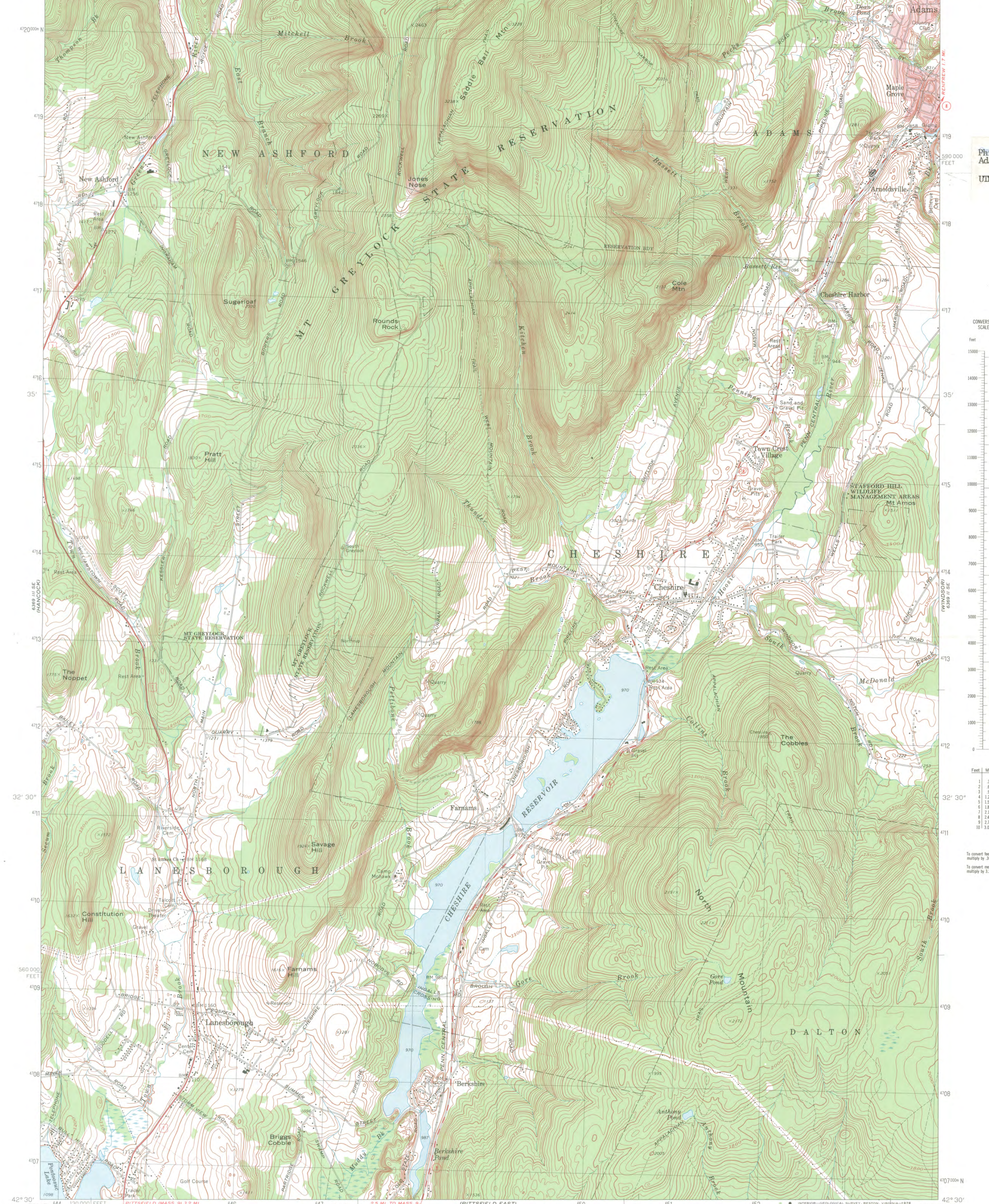

Phillips Woolen Mill
 Adams, Massachusetts
 UTM: 18 653020
 4718570



To convert feet to meters multiply by 0.3048
 To convert meters to feet multiply by 3.2808

Mapped, edited, and published by the Geological Survey Control by USGS, USC&GS, and Massachusetts Geodetic Survey
 Planimetry by photogrammetric methods from aerial photographs taken 1942. Topography by planimetric surveys 1943-1944. Revised from aerial photographs taken 1971. Field checked 1973
 Polyconic projection. 1927 North American datum
 10,000-foot grid based on Massachusetts coordinate system, mainland zone
 1000-meter Universal Transverse Mercator grid, zone 18
 Fine red dashed lines indicate selected fence and field lines where generally visible on aerial photographs. This information is unchecked
 Red tint indicates areas in which only landmark buildings are shown

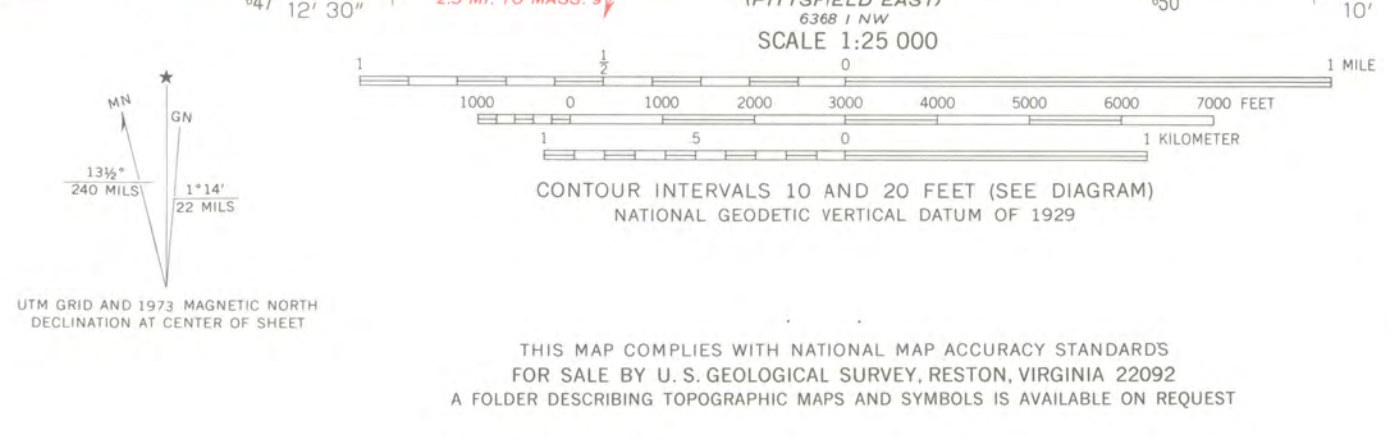

ROAD CLASSIFICATION
 Primary highway, hard surface ———— Light-duty road, hard or improved surface ————
 Secondary highway, hard surface ———— Unimproved road ————
 Interstate Route ———— U. S. Route ———— State Route ————

CHESHIRE, MASS.
 N4230—W7307.5/7.5
 1973
 AMS 6369 II SW—SERIES V814
 GREYLOCK WOOLEN MILL
 ADAMS, MASS.



**COMMONWEALTH OF MASSACHUSETTS
Office of the Secretary of State**

**MASSACHUSETTS
HISTORICAL
COMMISSION**

294 Washington Street
Boston, Massachusetts
02108
617-727-8470

MICHAEL JOSEPH CONNOLLY
Secretary of State

August 24, 1982

Mr. Jerry Rogers
Keeper, National Register of Historic Places
National Park Service
Department of the Interior
Washington, D.C. 20243

Dear Mr. Rogers:

Enclosed you will find the following nomination forms:

- ✓Adams - Phillips Woolen Mill (local)
- Adams - Renfrew Mill #2 (local)
- Belchertown - Walker Collis House (local)
- Hudson - Col. Adelbert Mossman House (local)
- Lenox - Lenox Academy (state)
- Lenox - The "Church on the Hill" (local)
- New Bedford - Dawson Building (local)
- New Marlborough - New Marlborough Village Historic District (local)
- North Andover - Machine Shop Village (state)
- Pittsfield - Wollison- Shipton Building (local)
- Rockport - Sewall-Scripture House (local)

All have been voted eligible by the State Review Board and have been signed by the State Historic Preservation Officer. Owners were notified of pending State Review Board considerations 30-75 days before the meeting and were afforded the opportunity to comment. Comments received to date are attached to the nomination forms.

Sincerely,

Candace Jenkins

Candace Jenkins
Registration Director
Massachusetts Historical Commission

Enclosures

CJ/mas

