

PH0036994

Form 10-300
(July 1969)

UNITED STATES DEPARTMENT OF THE INTERIOR
NATIONAL PARK SERVICE

**NATIONAL REGISTER OF HISTORIC PLACES
INVENTORY - NOMINATION FORM**

(Type all entries - complete applicable sections)

STATE: California	
COUNTY: Madera	
FOR NPS USE ONLY	
ENTRY NUMBER 71.9.06.0053	DATE 9/3/71

SEE INSTRUCTIONS

1. NAME

COMMON:
Madera County Courthouse

AND/OR HISTORIC:
Madera County Courthouse

2. LOCATION

STREET AND NUMBER:
210 West Yosemite

CITY OR TOWN:
Madera

STATE California	CODE 06	COUNTY: Madera	CODE 039
----------------------------	-------------------	--------------------------	--------------------

3. CLASSIFICATION

CATEGORY (Check One)	OWNERSHIP	STATUS	ACCESSIBLE TO THE PUBLIC
<input type="checkbox"/> District <input type="checkbox"/> Site <input type="checkbox"/> Object <input checked="" type="checkbox"/> Building <input type="checkbox"/> Structure <input type="checkbox"/> Object	<input checked="" type="checkbox"/> Public <input type="checkbox"/> Private <input type="checkbox"/> Both	<input checked="" type="checkbox"/> Occupied <input type="checkbox"/> Unoccupied <input type="checkbox"/> Preservation work in progress <input type="checkbox"/> In Process <input type="checkbox"/> Being Considered	Yes: <input checked="" type="checkbox"/> Restricted <input type="checkbox"/> Unrestricted <input type="checkbox"/> No

PRESENT USE (Check One or More as Appropriate)

<input type="checkbox"/> Agricultural	<input checked="" type="checkbox"/> Government	<input type="checkbox"/> Park	<input type="checkbox"/> Transportation	<input type="checkbox"/> Comments
<input type="checkbox"/> Commercial	<input type="checkbox"/> Industrial	<input type="checkbox"/> Private Residence	<input type="checkbox"/> Other (Specify)	
<input type="checkbox"/> Educational	<input type="checkbox"/> Military	<input type="checkbox"/> Religious		
<input type="checkbox"/> Entertainment	<input checked="" type="checkbox"/> Museum	<input type="checkbox"/> Scientific		

4. OWNER OF PROPERTY

OWNER'S NAME:
Madera County

STREET AND NUMBER:
209 West Yosemite

CITY OR TOWN:
Madera

STATE: California	CODE 06
-----------------------------	-------------------

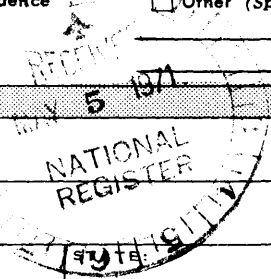

5. LOCATION OF LEGAL DESCRIPTION

COURTHOUSE, REGISTRY OF DEEDS, ETC.:
County Government Center, County Clerks Office

STREET AND NUMBER:
209 West Yosemite

CITY OR TOWN:
Madera

STATE: California	CODE 06
-----------------------------	-------------------

6. REPRESENTATION IN EXISTING SURVEYS

TITLE OF SURVEY:
Historical Places Inventory

DATE OF SURVEY: **1970** Federal State County Local

DEPOSITORY FOR SURVEY RECORDS:
County Clerk's Office

STREET AND NUMBER:
209 West Yosemite

CITY OR TOWN:
Madera

STATE: California	CODE 06
-----------------------------	-------------------

STATE: **California**

COUNTY: **Madera**

ENTRY NUMBER: **71.9.06.0053**

DATE: **9/3/71**

FOR NPS USE ONLY

7. DESCRIPTION

CONDITION	(Check One)					
	<input type="checkbox"/> Excellent	<input type="checkbox"/> Good	<input checked="" type="checkbox"/> Fair	<input type="checkbox"/> Deteriorated	<input type="checkbox"/> Ruins	<input type="checkbox"/> Unexposed
	(Check One)			(Check One)		
	<input type="checkbox"/> Altered	<input checked="" type="checkbox"/> Unaltered		<input type="checkbox"/> Moved	<input checked="" type="checkbox"/> Original Site	

DESCRIBE THE PRESENT AND ORIGINAL (if known) PHYSICAL APPEARANCE

This courthouse was constructed in 1900. Made of granite from Madera County, taken from the Raymond Granite quarries in Madera County.

A fire burned some of the interior in 1906, the clock tower fell. Clock was not injured. It was running in 1968. Just a little attention and will continue to run.

After 1953 survey, the building was declared unsafe and County government was moved to a building across the street.

The County road department is still in the building but they will move out the middle of July.

The Madera County Board of Supervisors turned the old Courthouse over to the Historical Society. At this time the Society is raising money to restore the Courthouse so it may be used as a museum.

The building is a beautiful structure for its type of architecture. From the outside it looks the same as it ever did. The grounds are well kept. MINOR INTERIOR MODERNIZATION,

A very pleasant park adjoins the Courthouse grounds on the east.

The building has two floors and a full basement. Reflecting the rectangular masonry neo-classic architecture that prevailed in public buildings throughout the country for a century, the relatively severe ornamentation is relieved with a high clock tower surmounted by a vaulted and columned cupola. Plan dimensions approximately 84' x 93'.

SEE INSTRUCTIONS



8. SIGNIFICANCE

PERIOD (Check One or More as Appropriate)

- | | | | |
|--|---------------------------------------|---------------------------------------|--|
| <input type="checkbox"/> Pre-Columbian | <input type="checkbox"/> 16th Century | <input type="checkbox"/> 18th Century | <input checked="" type="checkbox"/> 20th Century |
| <input type="checkbox"/> 15th Century | <input type="checkbox"/> 17th Century | <input type="checkbox"/> 19th Century | |

SPECIFIC DATE(S) (If Applicable and Known) 1900

AREAS OF SIGNIFICANCE (Check One or More as Appropriate)

- | | | | |
|--|---|--|--|
| <input type="checkbox"/> Aboriginal | <input type="checkbox"/> Education | <input type="checkbox"/> Political | <input type="checkbox"/> Urban Planning |
| <input type="checkbox"/> Prehistoric | <input type="checkbox"/> Engineering | <input type="checkbox"/> Religion/Philosophy | <input type="checkbox"/> Other (Specify) |
| <input checked="" type="checkbox"/> Historic | <input type="checkbox"/> Industry | <input type="checkbox"/> Science | <u>First really</u> |
| <input type="checkbox"/> Agriculture | <input type="checkbox"/> Invention | <input type="checkbox"/> Sculpture | <u>planned building</u> |
| <input checked="" type="checkbox"/> Architecture | <input type="checkbox"/> Landscape Architecture | <input type="checkbox"/> Social/Humanitarian | <u>of any importance</u> |
| <input type="checkbox"/> Art | <input type="checkbox"/> Literature | <input type="checkbox"/> Theater | <u>in Madera County.</u> |
| <input type="checkbox"/> Commerce | <input type="checkbox"/> Military | <input type="checkbox"/> Transportation | _____ |
| <input type="checkbox"/> Communications | <input type="checkbox"/> Music | | _____ |
| <input type="checkbox"/> Conservation | | | _____ |

STATEMENT OF SIGNIFICANCE

This building was erected in 1900. It was the first important building for Madera after it became a county. The citizens of Madera County have always been very proud of their Courthouse and were sorry when it was decided the building was not adequate for county government unless a large sum be spent to bring up to present day requirements.

It will make a fine museum. No changes will be made other than to make it safe. In its day it was considered a very fine building. Madera County started its first library in the Courthouse also.

It is located near the highway, easily accessible to tourists, has a lovely park adjoining it.

The people of Madera County hope the building will be used as a museum and its historic value will add to its attraction as a museum.

Madera County came into existence in 1893, created from a part of Fresno, some 40 years after the organization of that county. Madera has been the county seat from the beginning; thus, the Madera County Courthouse. For sixty years the Courthouse served as the administrative and political center for a largely agricultural oriented population.

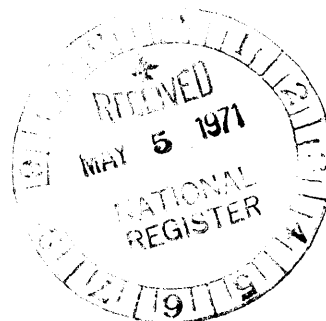

SEE INSTRUCTIONS

9. MAJOR BIBLIOGRAPHICAL REFERENCES

No definite history of Madera County has been written since the first of the 20th Century. It is therefore necessary to rely on articles printed in the Madera County Historian for information concerning the Madera County Courthouse.

10. GEOGRAPHICAL DATA

LATITUDE AND LONGITUDE COORDINATES DEFINING A RECTANGLE LOCATING THE PROPERTY			O R	LATITUDE AND LONGITUDE COORDINATES DEFINING THE CENTER POINT OF A PROPERTY OF LESS THAN TEN ACRES		
CORNER	LATITUDE	LONGITUDE		LATITUDE	LONGITUDE	
	Degrees Minutes Seconds	Degrees Minutes Seconds		Degrees Minutes Seconds	Degrees Minutes Seconds	
NW	° ' "	° ' "		36 ° 57 ' 32 "	120 ° 03 ' 37 "	
NE	° ' "	° ' "				
SE	° ' "	° ' "				
SW	° ' "	° ' "				

10/7617
409423
CD

SEE INSTRUCTIONS

APPROXIMATE ACREAGE OF NOMINATED PROPERTY: 5.0 +/-

LIST ALL STATES AND COUNTIES FOR PROPERTIES OVERLAPPING STATE OR COUNTY BOUNDARIES

STATE:	CODE	COUNTY	CODE

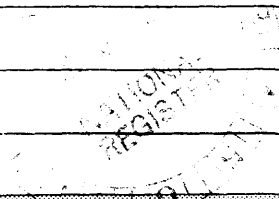

11. FORM PREPARED BY

NAME AND TITLE: Maud Lindemann, Curator

ORGANIZATION: Madera County Historical Society DATE: July 5, 1970

STREET AND NUMBER: 210 West Yosemite

CITY OR TOWN: Madera STATE: California CODE: 06

12. STATE LIAISON OFFICER CERTIFICATION

NATIONAL REGISTER VERIFICATION

As the designated State Liaison Officer for the National Historic Preservation Act of 1966 (Public Law 89-665), I hereby nominate this property for inclusion in the National Register and certify that it has been evaluated according to the criteria and procedures set forth by the National Park Service. The recommended level of significance of this nomination is:

National State Local

Name: [Signature]

Title: State Liaison Officer

Date: August 3, 1970

I hereby certify that this property is included in the National Register.

[Signature]
Chief, Office of Archeology and Historic Preservation

SEP 3 1971

Date: _____

ATTEST:

[Signature]
Keeper of The National Register

Date: JUN 24 1971

MAP OF ELECTION PRECINCTS IN CITY OF MADERA

Approved Nov. 2nd 1925
by
Board of Supervisors

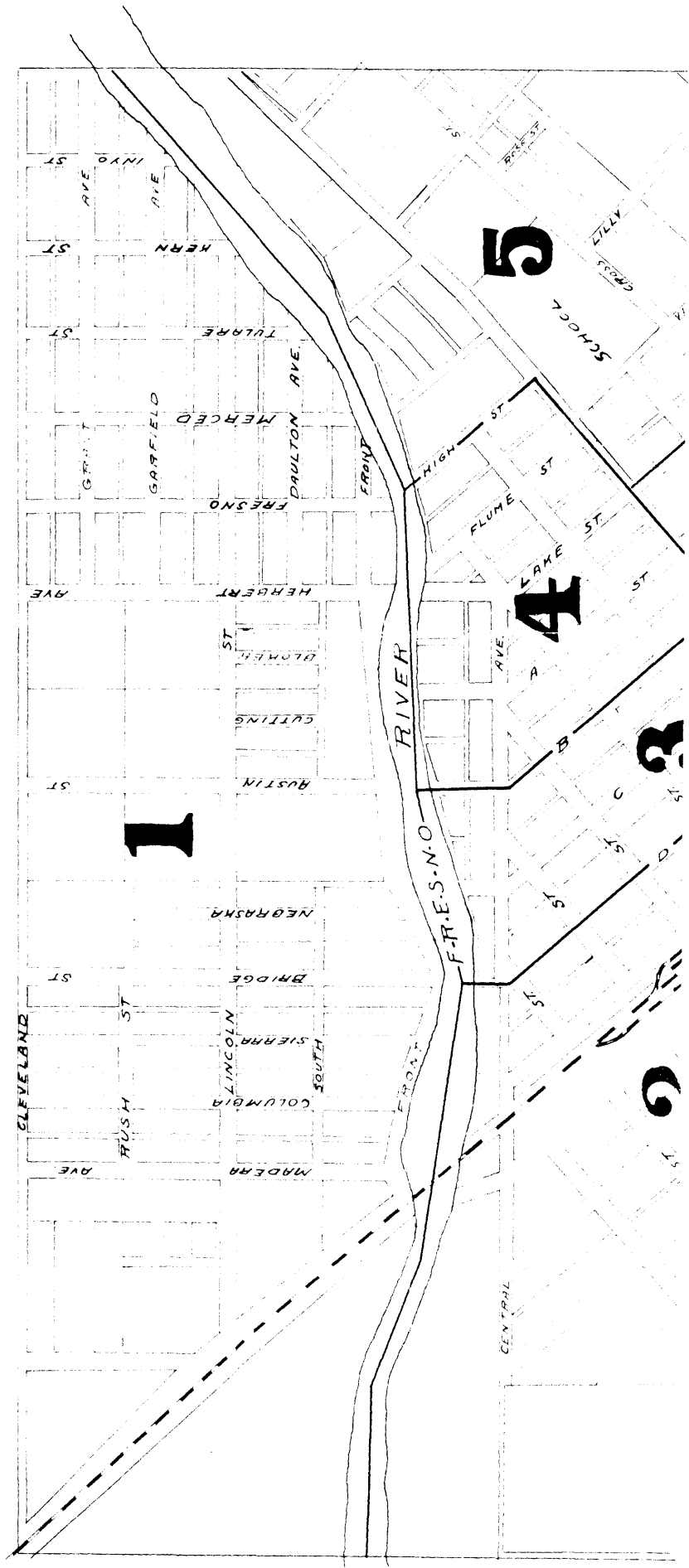

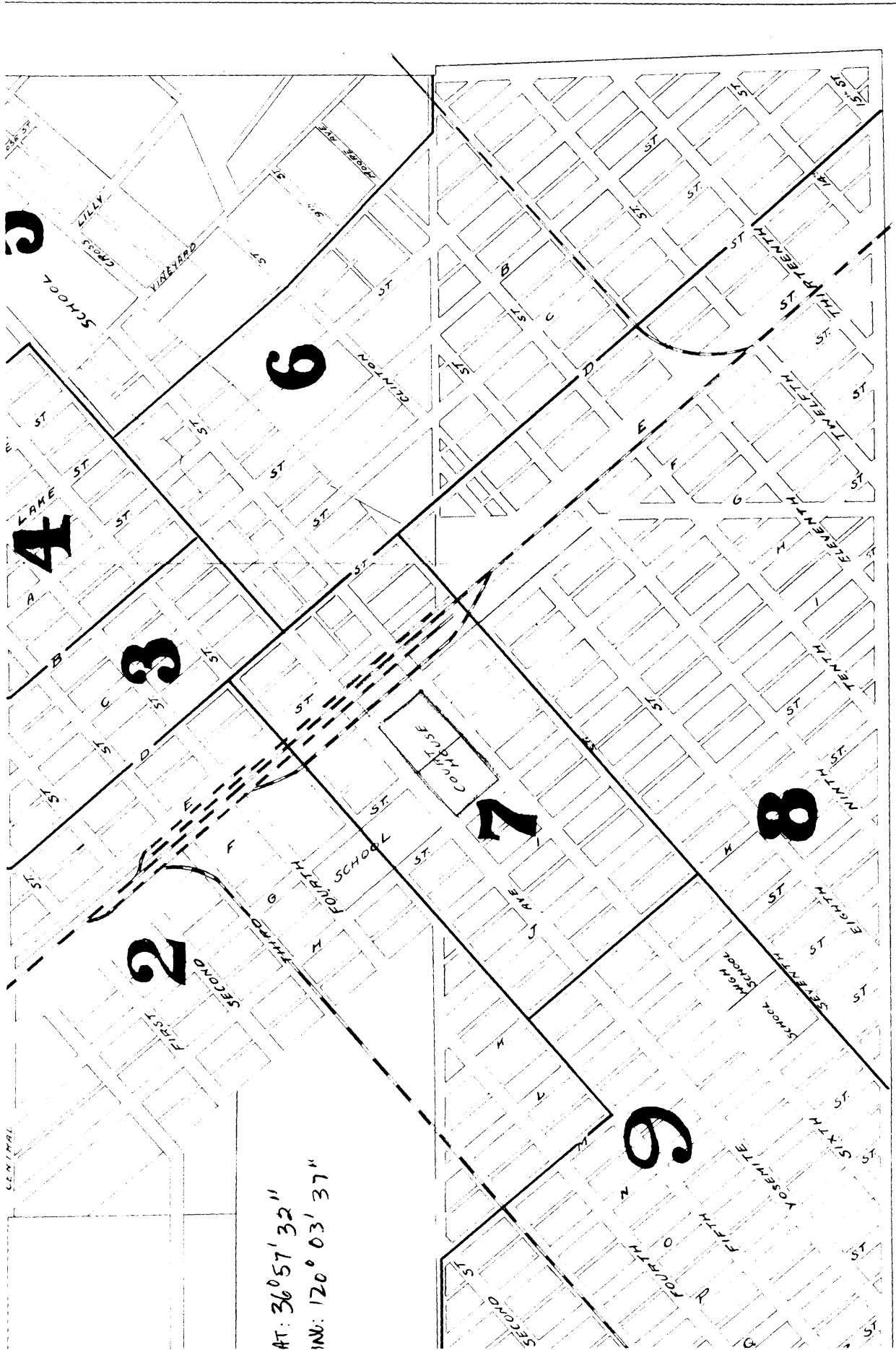

AT: 36° 57' 32"
 IN: 120° 03' 37"

A. L. Hughes
 Co. Surveyor