

ARCHITECTURAL SURVEY FORM

MARION COUNTY COURTHOUSE (SECOND)

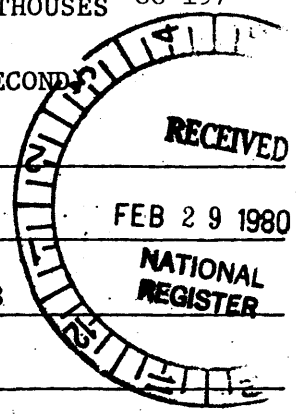

Name of Structure: OLD Marion County Courthouse (Second)

Location: Tazewell, Georgia 31828

Cost: \$1,637

Date of Construction: 1848

Architect/builder: L. W. Wall

Contractor: \_\_\_\_\_

Subsequent architects: \_\_\_\_\_

TAX MAP/PARCEL NUMBERS

Unmapped

Zone 16/E740750/N3585320

UTM NO. \_\_\_\_\_

DESCRIPTION:

Style: Carpenter Style

Boundary: As marked on the enclosed city map.

Facade Material: Wood (pine)

Acreage: less than one

Condition: [ ] Excellent [X] Good [ ] Fair

This is a two story square structure with a hipped roof and a full width one story porch supported by wooden posts. The facade has two entrance doors and three windows with wooden shutters. A rear door is nail studded, a safety device to prevent burglary. The weather boarded five bay facade faces a crossroads. Few other structures remaining in the area.

## THEMATIC NATIONAL REGISTER NOMINATION - GEORGIA COURTHOUSES

ARCHITECTURAL SURVEY FORM

MARION COUNTY COURTHOUSE (SECOND)

PAGE 2



## SIGNIFICANCE:

In 1850 the county seat was moved to Buena Vista. This building has since been used as a Masonic Lodge Hall and as a general store. It is not unlike the plan of the old Chatahoochee County courthouse, now at Westville, a restored 1850 community. It is an excellent example of the Carpenter Style and one of two wooden courthouses remaining in the state.

The weekly Columbus (Ga.) Enquirer reported on Dec. 22, 1846 in a "Notice to Builders" that bids were being accepted the following January for this building. "Brick masons and carpenters" were urged to attend.

SEP 18 1980



MARION COUNTY COURTHOUSE (Second)

## MAILING ADDRESS:

Mr. Jessie W. Smith, Secretary  
 Marion Lodge, No. 14  
 Tazewell, Georgia 31828

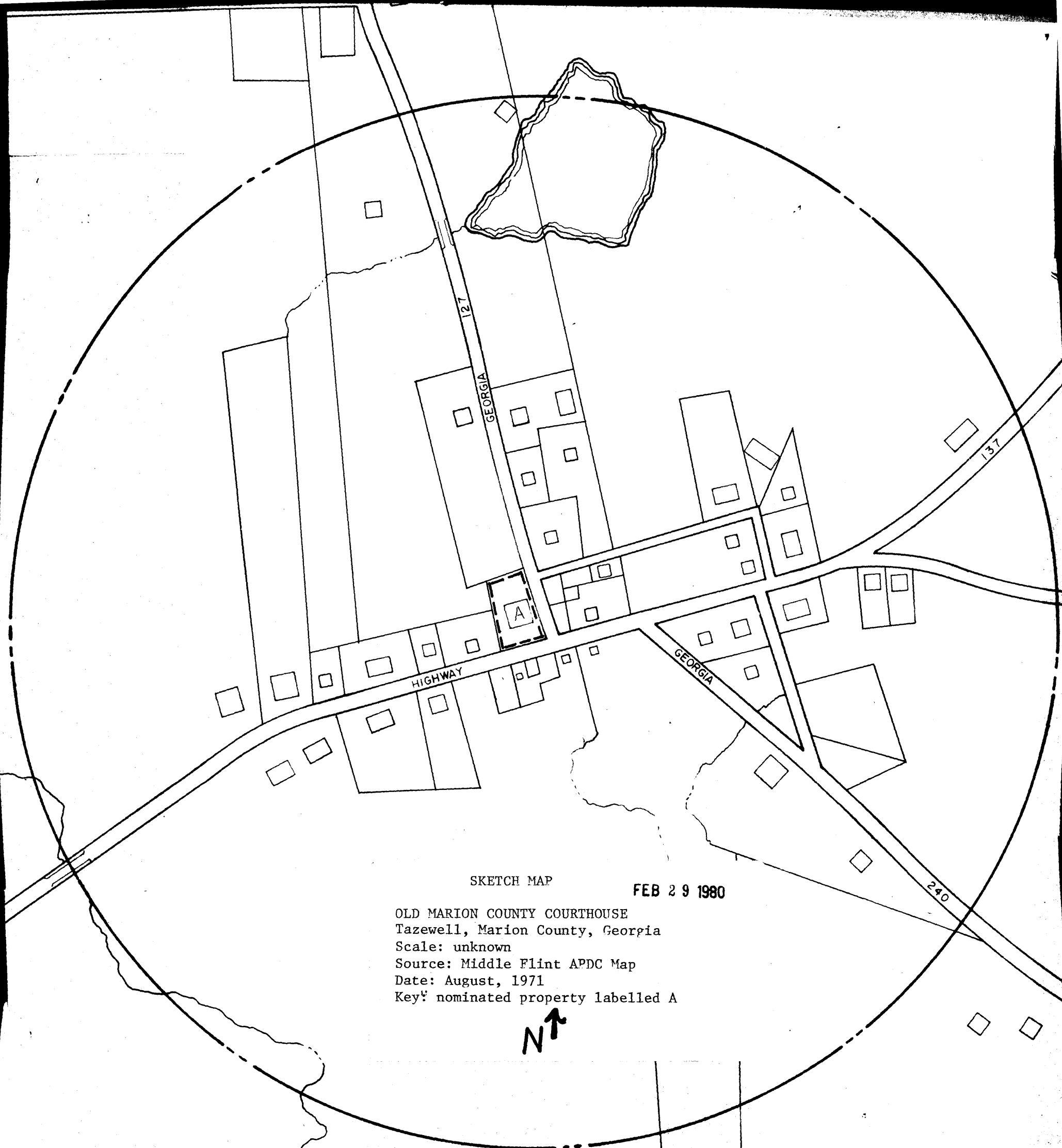

SKETCH MAP

FEB 29 1980

OLD MARION COUNTY COURTHOUSE  
Tazewell, Marion County, Georgia  
Scale: unknown  
Source: Middle Flint APDC Map  
Date: August, 1971  
Key: nominated property labelled A

