

United States Department of the Interior
National Park Service

National Register of Historic Places
Inventory—Nomination Form

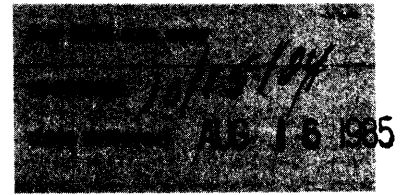

Pulaski County Multiple Resource

Continuation sheet Area, Kentucky

Item number

Page

Name: James-Owens House (PU-60)

Location: Shopville, Kentucky
off KY 80

Owner: Mrs. Charlie Wright
Route 4, Box 454
Somerset, KY 42501

Classification: Building

Description: The James-Owens House is a two-story, three bay brick structure on a stone foundation. The brick is of five-course common bond with jack arches over the doors and windows. The windows on both facades are tri-part nine-over-nine sash with six-light sidelights in the Greek Revival style. Below the windows are limestone sills and around the windows is a molded surround with corner blocks. The original porch of the house was removed and replaced with a Bungalow style porch ca. 1920. At the roofline is an unusual quadruple mouse tooth cornice. The roof is composed of a standing seam metal roof. At the rear of the original brick section is a one-story frame addition with a shed roof.

Significance: The James family settled in the Flat Lick area in 1798 and became some of the larger landowners in the county. John James and his three sons worked as farmers, ministers and county officials in the early 19th century. The land around the Flat Lick-Shopville area is some of the best farming land in the county and the James family prospered during these years. The first house built by John James was a substantial two-story brick house constructed ca. 1810 and the ruins of this house are still extant off Highway 80 near Shopville. The James-Owens House was erected ca. 1840 by William Owens a relation of the James family. This two-story brick house is one of the few early brick homes remaining in the county and is in excellent condition. Despite the added porch and rear additions the house retains its original architectural character.

Acreage: approx. 1 acre

Verbal Boundary Description: The house sits on a slight rise with the boundary encompassing approximately one acre surrounding the house. This area consists of the yard or domestic space and is defined by hedge lines on the north and east, a driveway on the south and county road 1677 on the west.

UTM References: (Shopville Quadrangle) Latitude - 37 9' 5" Longitude - 84 28' 45"

10/15/87

KENTUCKY HISTORIC RESOURCE INVENTORY SUPPLEMENT
BOUNDARY AND LOCATION INFORMATION

Historic Property Name James-Owens House Site # PU-60

Multiple Resource/Thematic Nomination Title Pulaski County Multiple Resource Area

U.T.M. Coordinates - List multiple UTMs if property is ten or more acres.

A. Lat- 37 9' 5" D. _____

B. Long- 84 28' 45" E. _____

C. _____ F. _____

Verbal Boundary Description Acreage approx. 1 acre

The house sits on a slight rise with the boundary encompassing approximately one acre surrounding the house. This area consists of the yard or domestic space and is defined by hedge lines on the north and east, a driveway on the south and county road 1677 on the west.

Sketch of Site Plan (Showing outbuildings, structures, landscape features and the site boundary as described above.)

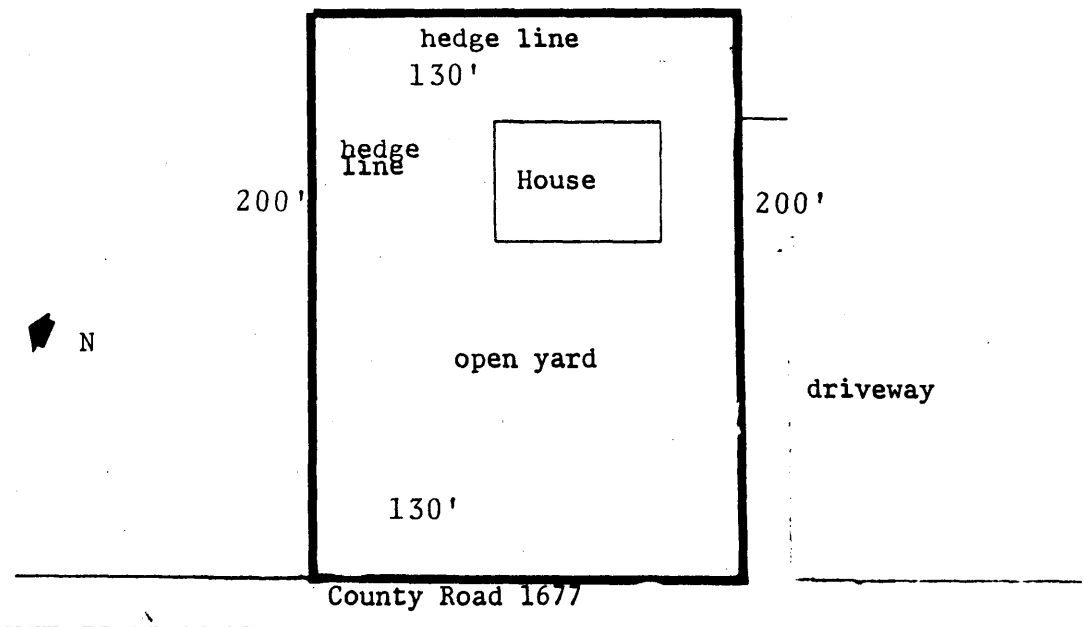

Official Courthouse Property Reference: