

FORM B - BUILDING

AREA	FORM NO. 129/440-39
------	------------------------

MASSACHUSETTS HISTORICAL COMMISSION
294 WASHINGTON STREET, BOSTON, MA 02108

Town Brookline MRA

Address 400 Heath Street

Historic Name Roughwood

(now Pine Manor College)

PHOTO: (3x3" or 3x5", black & white)
staple to left side of form

Use: Present Institutional

Photo number _____

Original residential

DESCRIPTION:

Date 1891

Source Building permit

SKETCH MAP

Show property's location in relation to nearest cross streets and/or geographical features. Indicate all buildings between inventoried property and nearest intersection. Indicate north.

Style Shingle

Architect Andrews, Jaques, and Ran-

Exterior wall fabric stone and shingle

Outbuildings carriage house, cowbarn, garage, attached rowhouses, 3 small detached houses (originally gate-

houses
Major alterations (with dates) Main house-1901-conservatory added; 1916-35X 22 addition; 1909-music room added; 196 altered into admin. building, 1964-alterations to garage, barn; 1968, 1984-alterations to carriage house.

Moved NA Date NA

CARRIAGE HOUSE - #4 on map

Approx. acreage 79 acres

Recorded by Carla Benka

Setting Residential area of large estates and houses set on one acre plots; abutting Country Club and

Organization Brookline Historical Com.

large Town-owned park and recreational facility

Date March 1985

Newton Quadrangle

(Staple additional sheets here)

UTM References: A: 19/322500/468758C
B: 19/322330/468706C
C: 19/321940/468778C
D: 19/321860/468714C
E: 19/322090/468762C

Map #: 33

400 Heath Street meets NR criteria ^{and} C, having been designed in the Shingle Style by the well known firm of Andrews, Jaques and Rantoul and representing ^{Brookline's} a late 19th century country estate development.

ARCHITECTURAL SIGNIFICANCE (Describe important architectural features and evaluate in terms of other buildings within the community.)

One of the larger Shingle Style country homes in Brookline, Roughwood was designed by Andrews, Jaques, and Rantoul in 1891. Later additions to the house have been designed to conform with the original style. In its use of stone and decorative and banded shingles, it is not unlike the home of Herbert Jaques at 50 Dunster Road, designed some four years earlier. The Heath Street house has a hip roof and is symmetrical, with two large turreted bays flanking a central entrance. Massive panel brick chimneys are of particular interest. Other buildings on the estate took their stylistic "cues" from this house, consequently their designs are similar or

HISTORICAL SIGNIFICANCE (Explain the role owners played in local or state complimentary history and how the building relates to the development of the community.)

Four hundred Heath Street, now Pine Manor College, was built as the country estate of William and Josephine Cox; he was president of C and M Cox Co., wholesale boot and shoe dealers. Andrews, Jaques and Rantoul designed the main house as well as most of the outbuildings on the estate which included a large cowbarn, a "lodge", four attached houses, two gate houses, a garage, and a carriage house. Andrews, who lived at 50 Fisher Avenue in Brookline, was the senior member of the firm (established in 1885) and was an early member of the Boston Society of architects. He had been a draftsman in the office of H.H. Richardson and an "office boy" for Peabody and Stearns. Among his works are the east and west wings of the State House, the Country Court House in Worcester, and the Dexter building in Boston. Herbert Jaques studied architecture at MIT and also lived in Brookline, while Augustus Rantoul received his training at Harvard.

The Coxes purchased their property from Thomas Gaffield, a Boston wool merchant whose holdings extended along Woodland Road to Hammond Street. Interestingly, their daughter Mildred Cox married Osborne Howes who built a number of homes on Woodland Road. The Coxes built almost all of the present outbuildings (except the attached houses) as well as some greenhouses which have since been demolished and a large hen house in which Mr. Cox raised Wyandotte poultry. Large vegetable gardens, an orchard, a vineyard, and cutting gardens were where part of the residential campus sits today.

Cox died in 1902 and two years later, the property, consisting of 34½ acres,

BIBLIOGRAPHY and/or REFERENCES (name of publication, author, date and publisher)

Permits-1890-1917; 1964-68

Proceedings-Brookline Historical Society- "Roughwood" (1959-1963)

Atlas-1888, 1893, 1897, 1900, 1907, 1913, 1919

Henry, Rodman, Ph.D, "1620 On ... A Chronological Study and Assessment of the Pine Manor Land and Buildings."

INVENTORY FORM CONTINUATION SHEET

MASSACHUSETTS HISTORICAL COMMISSION
Office of the Secretary, Boston

Community: Brookline	Form No: 129/440-39
Property Name: Roughwood (Pine Manor College)	

Indicate each item on inventory form which is being continued below.

was sold to Ernest Dane and his family. Dane, a banker with many business interests, became the president of the Brookline Trust Company in 1906. After purchasing "Roughwood", he gradually added land so that eventually, his entire estate totalled 120 acres. He also built a small dwelling to house servants (308 Heath); row houses (now Le Manoir Madelaine (designed by Brainard and Leeds in 1909); added on to the cowbarn and greenhouses, and constructed a wing on the west end of the main house in 1909 to contain the music room and organ loft.

Before the estate was sold to Pine Manor Junior College in 1961, some of the land was sold off. To the south, some 24 acres were sold to The Country Club, while 18 acres were deeded to the Town of Brookline in 1951 as a gift and for the establishment of Dane Park.

In spite of the construction of additional buildings for educational and residential purposes, much of the rural flavor of the estate remains. Parking areas and dormitories have been placed in unobtrusive locations and large open spaces have been preserved. A number of original, late 19th and early 20th century structures have been enlarged and modified, but in ways in which the original design has been left intact.

The following is a list of pre-1910 structures remaining on the site

1. -400 Heath Street-main house, now administration building, Andrews, Jaques & Rantoul
2. -70 Woodland Road - 1892- originally "lodge", now Child Study Center (probably designed by Andrews, Jaques and Rantoul)
3. -356 Heath Street - 1891- originally gatehouse or cottage (probably designed by Andrews, Jaques and Rantoul)
4. -Carriage House - 1891-now Annenberg Communication Center, Andrews, Jaques and Rantoul; addition by Shepley, Bulfinch, Richardson, and Abbott
5. -Garage-1905- now Science Building
6. -Cowbarn-1891, Andrews, Jaques, and Rantoul, now maintenance building
7. -308 Heath Street-1906- servants' housing, now faculty residence, Andrews, Jaques, and Rantoul
8. -134-6-1909, Attached houses, now "French House" (Le Manoir Madelaine), Brainard and Leeds

ATTACHED HOUSES
NOW LE MANOIR MADELAINE
8 ON MAP

Staple to Inventory form at bottom

United States Department of the Interior
National Park Service

National Register of Historic Places
Inventory—Nomination Form

For NPS use only
received 9/1/85
date entered

Continuation sheet

Item number

Page

Multiple Resource Area
Thematic Group

Name Brookline MRA
State MASSACHUSETTS

Nomination/Type of Review

Date/Signature

61. Milestone
(Boylston St.)

Entered in the
National Register

for Keeper

Delores Byers 10/17/85

Attest

62. Murphy, William, House

Entered in the
National Register

for Keeper

Delores Byers 10/17/85

Attest

63. Orrock, Rev. John, House

Entered in the
National Register

for Keeper

Delores Byers 10/17/85

Attest

64. Paine Estate

Entered in the
National Register

for Keeper

Delores Byers 10/17/85

Attest

65. Perkins Estate

Entered in the
National Register

for Keeper

Delores Byers 10/17/85

Attest

66. Reservoir Park

Entered in the
National Register

for Keeper

Delores Byers 10/17/85

Attest

67. Ritchie Building

Entered in the
National Register

for Keeper

Delores Byers 10/17/85

Attest

68. Roughwood

Entered in the
National Register

for Keeper

Delores Byers 10/17/85

Attest

69. Saint Aidan's Church and
Rectory

Entered in the
National Register

for Keeper

Delores Byers 10/17/85

Attest

70. Saint Mary of the Assumption
Church, Rectory, School and
Convent

Entered in the
National Register

for Keeper

Delores Byers 10/17/85

Attest

85003309

NATIONAL REGISTER OF HISTORIC PLACES
EVALUATION/RETURN SHEET

Roughwood (Brookline MRA)
Norfolk County
MASSACHUSETTS

Working No. SEP / 4 1985
Fed. Reg. Date: 2/3/87
Date Due: 10/3/85 - 10/19/85
Action: ACCEPT 10-17-85
 RETURN
 REJECT
Federal Agency: _____

- resubmission
- nomination by person or local government
- owner objection
- appeal

Entered in the
National Register

Substantive Review: sample request appeal NR decision

Reviewer's comments:

Recom./Criteria _____
Reviewer _____
Discipline _____
Date _____
_____ see continuation sheet

Nomination returned for: _____ technical corrections cited below
_____ substantive reasons discussed below

1. Name

2. Location

3. Classification

Category	Ownership Public Acquisition	Status Accessible	Present Use
----------	---------------------------------	----------------------	-------------

4. Owner of Property

5. Location of Legal Description

6. Representation in Existing Surveys

Has this property been determined eligible? yes no

7. Description

Condition

- excellent
- good
- fair
- deteriorated
- ruins
- unexposed

Check one

- unaltered
- altered

Check one

- original site
- moved date _____

Describe the present and original (if known) physical appearance

- summary paragraph
- completeness
- clarity
- alterations/integrity
- dates
- boundary selection

8. Significance

Period _____ Areas of Significance—Check and justify below

Specific dates _____ Builder/Architect _____

Statement of Significance (*in one paragraph*)

- summary paragraph
- completeness
- clarity
- applicable criteria
- justification of areas checked
- relating significance to the resource
- context
- relationship of integrity to significance
- justification of exception
- other

9. Major Bibliographical References

10. Geographical Data

Acreage of nominated property _____

Quadrangle name _____

UTM References _____

Verbal boundary description and justification _____

11. Form Prepared By

12. State Historic Preservation Officer Certification

The evaluated significance of this property within the state is:

____ national ____ state ____ local

State Historic Preservation Officer signature _____

title _____ date _____

13. Other

- Maps
- Photographs
- Other

Questions concerning this nomination may be directed to _____

Signed _____ Date _____ Phone: _____



Pine Manor Cottage

Former cow Barn

Present Maintenance Bldg

Roughwood

Brookline MRA, Ma



Pine Manor College
Garage

Roughwood

Brookline MA, Ma



308 Heath St

Servants' House

Roughwood

Brookline MRA, MA



Pine Manor College

Children's Study Center

70 Woodland Rd

Roughwood

Brookline, MRA, MA



main Bldg Pine Manor

Roughwood

400 Heath St

NOV 1977

NOV 1977

Brookline (MA) MFA



Pine Manor gatehouse

356 Heath

Roughwood

Brookline, MRA, MA



308 Heath

308 Heath St

Servants House

Roughwood

Brookline MRA, MA



Pine Manor College
French House - "Le Manoir Madeline"
134-136 WOODLAND Rd
Roughwood
Brookline MA

2-85



Pine Manor College
Furber Carriage House
New Library/Communications Center
Roughwood

400 Heath St
Brookline (MA) MRA

PINE Manor College (129/440-79)
400 Heath ST.
Rough wood
Town of Brookline Map
scale 1/2" = 200ft.

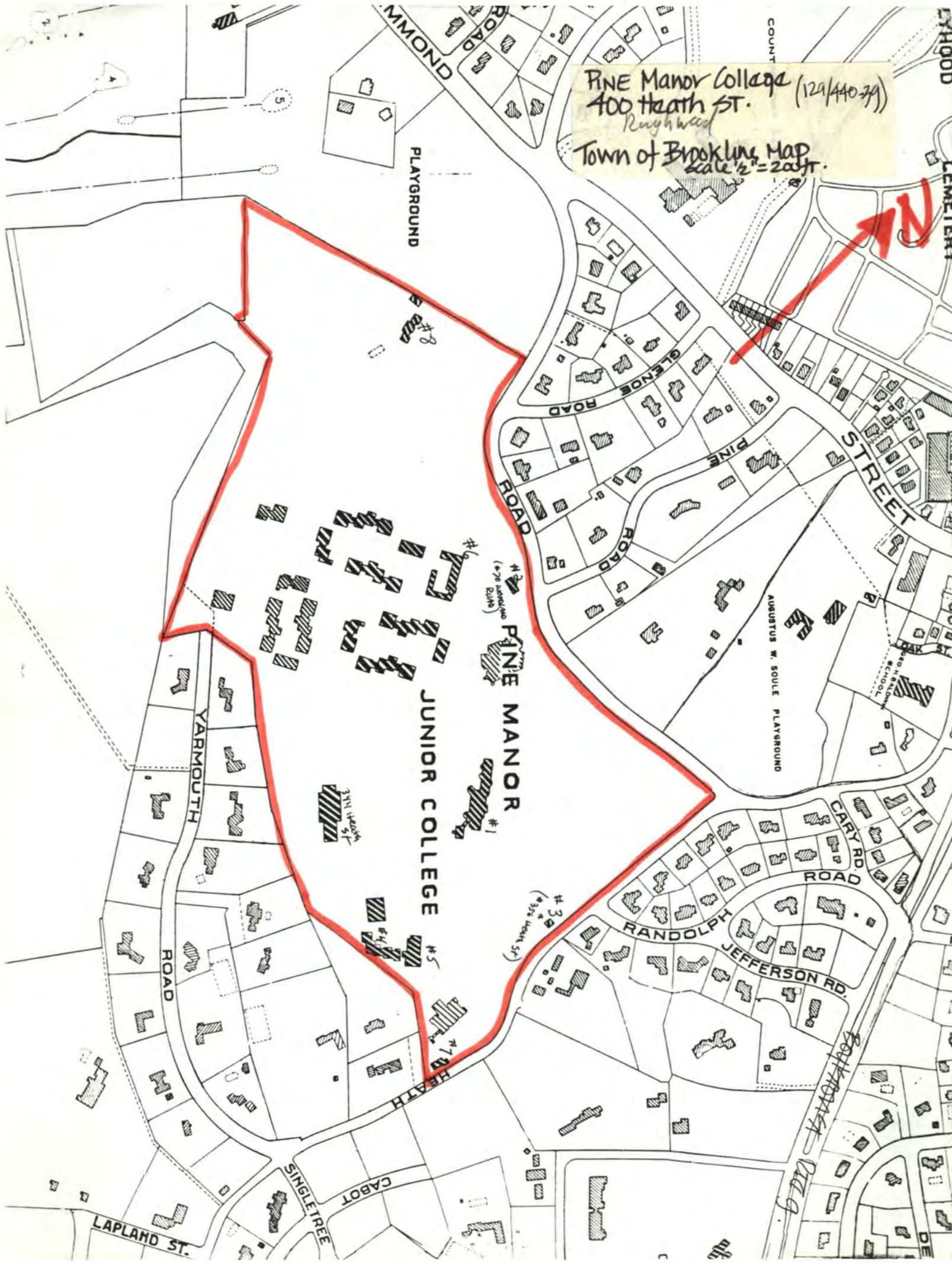

PLAYGROUND

JUNIOR COLLEGE

PINE MANOR

STREET

LAPLAND ST.

SINGLE TREE

CABOT

RANDOLPH

JEFFERSON RD.

CARY RD.

AUGUSTUS W. SOULE PLAYGROUND

PINE ROAD

GLENSIDE ROAD

YARMOUTH ROAD

MMOND ROAD

COUNT

LYHOOD

CEMETERY

STREET

OAK ST.

ROAD

ROAD

ROAD

DE



House at Brookline -
Andrews, Jacques & Ran
ARCH

400 Heath Street
Brookline (MA) MRA

Cox - later Davis estate - now Pine Manor