

United States Department of the Interior
National Park Service

National Register of Historic Places
Registration Form

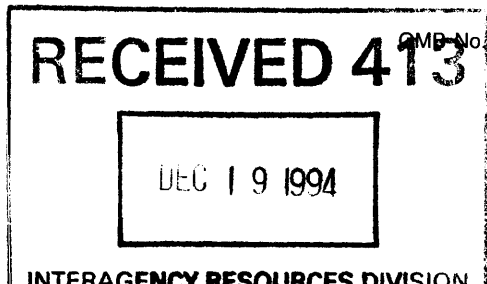

1584
OMB No. 10024-0018

This form is for use in nominating or requesting determinations for individual properties and districts. Complete the National Register of Historic Places Registration Form (National Register Bulletin 16A). Complete each item by marking "x" in the appropriate box or by entering the information requested. If an item does not apply to the property being documented, enter "N/A" for "not applicable." For functions, architectural classification, materials, and areas of significance, enter only categories and subcategories from the instructions. Place additional entries and narrative items on continuation sheets (NPS Form 10-900a). Use a typewriter, word processor, or computer, to complete all items.

1. Name of Property

historic name Ferriday Commercial Historic District
other names/site number _____

2. Location

street & number bounded roughly by First St., Louisiana Ave., Third Street & Mississippi Ave. N/A not for publication
city or town Ferriday N/A vicinity
state Louisiana code LA county Concordia code 029 zip code 71334

3. State/Federal Agency Certification

As the designated authority under the National Historic Preservation Act, as amended, I hereby certify that this nomination request for determination of eligibility meets the documentation standards for registering properties in the National Register of Historic Places and meets the procedural and professional requirements set forth in 36 CFR Part 60. In my opinion, the property meets does not meet the National Register criteria. I recommend that this property be considered significant nationally statewide locally. (See continuation sheet for additional comments.)
Gerri Hobdy 12/15/94
Signature of certifying official/Title Gerri Hobdy, Date
LA SHPO, Dept of Culture, Recreation and Tourism
State of Federal agency and bureau

In my opinion, the property meets does not meet the National Register criteria. (See continuation sheet for additional comments.)

Signature of certifying official/Title Date

State or Federal agency and bureau

4. National Park Service Certification

- I hereby certify that the property is:
 entered in the National Register.
 See continuation sheet.
- determined eligible for the National Register
 See continuation sheet.
- determined not eligible for the National Register.
- removed from the National Register.
- other, (explain): _____

for
Edson H. Beall Signature of the Keeper
Entered in the Date of Action
National Register 1-27-95

5. Classification

Ownership of Property

(Check as many boxes as apply)

- private
- public-local
- public-State
- public-Federal

Category of Property

(Check only one box)

- building(s)
- district
- site
- structure
- object

Number of Resources within Property

(Do not include previously listed resources in the count.)

Contributing	Noncontributing	
21	2	buildings
		sites
		structures
		objects
21	2	Total

Name of related multiple property listing

(Enter "N/A" if property is not part of a multiple property listing.)

N/A

Number of contributing resources previously listed in the National Register

0

6. Function or Use

Historic Functions

(Enter categories from instructions)

COMMERCE/TRADE: specialty store/department store

Current Functions

(Enter categories from instructions)

COMMERCE/TRADE: specialty store/department store

7. Description

Architectural Classification

(Enter categories from instructions)

Italianate
no style

Materials

(Enter categories from instructions)

foundation brick;concrete
walls brick

roof other: tar and gravel; metal; asphalt
other

Narrative Description

(Describe the historic and current condition of the property on one or more continuation sheets.)

8. Statement of Significance

Applicable National Register Criteria

(Mark "x" in one or more boxes for the criteria qualifying the property for National Register listing.)

- A** Property is associated with events that have made a significant contribution to the broad patterns of our history.
- B** Property is associated with the lives of persons significant in our past.
- C** Property embodies the distinctive characteristics of a type, period, or method of construction or represents the work of a master, or possesses high artistic values, or represents a significant and distinguishable entity whose components lack individual distinction.
- D** Property has yielded, or is likely to yield, information important in prehistory or history.

Criteria Considerations N/A
(Mark "x" in all the boxes that apply.)

Property is:

- A** owned by a religious institution or used for religious purposes.
- B** removed from its original location.
- C** a birthplace or grave.
- D** a cemetery.
- E** a reconstructed building, object, or structure.
- F** a commemorative property.
- G** less than 50 years of age or achieved significance within the past 50 years.

Narrative Statement of Significance

(Explain the significance of the property on one or more continuation sheets.)

9. Major Bibliographical References

Bibliography

(Cite the books, articles, and other sources used in preparing this form on one or more continuation sheets.)

Previous documentation on file (NPS): N/A

- preliminary determination of individual listing (36 CFR 67) has been requested
- previously listed in the National Register
- previously determined eligible by the National Register
- designated a National Historic Landmark
- recorded by Historic American Buildings Survey # _____
- recorded by Historic American Engineering Record # _____

Areas of Significance

(Enter categories from instructions)

architecture

commerce

Period of Significance

c.1905-c.1940 (architecture)

c.1905-1944 (commerce)

Significant Dates

N/A

Significant Person

(Complete if Criterion B is marked above)

N/A

Cultural Affiliation

N/A

Architect/Builder

unknown

Primary location of additional data:

- State Historic Preservation Office
- Other State agency
- Federal agency
- Local government
- University
- Other

Name of repository:

10. Geographical Data

Acreage of Property @ 4 acres

UTM References

(Place additional UTM references on a continuation sheet.)

1 [1|5] [6|3|7|1|2|0] [3|5|0|0|0|9|0]
Zone Easting Northing
2 [1|5] [6|3|7|3|7|0] [3|5|0|0|0|9|0]

3 [1|5] [6|3|7|3|7|0] [3|4|9|9|9|0|0]
Zone Easting Northing
4 [] [] [] [] [] [] [] [] [] [] [] []

See continuation sheet

Verbal Boundary Description

(Describe the boundaries of the property on a continuation sheet.)

Boundary Justification

(Explain why the boundaries were selected on a continuation sheet.)

11. Form Prepared By

name/title National Register Staff

organization Division of Historic Preservation date November 1994

street & number P. O. Box 44247 telephone 504-342-8160

city or town Baton Rouge state Louisiana zip code 70804

Additional Documentation

Submit the following items with the completed form:

Continuation Sheets

Maps

A USGS map (7.5 or 15 minute series) indicating the property's location.

A Sketch map for historic districts and properties having large acreage or numerous resources.

Photographs

Representative black and white photographs of the property.

Additional items

(Check with the SHPO or FPO for any additional items)

Property Owner

(Complete this item at the request of SHPO or FPO.)

name Multiple ownership

street & number telephone

city or town state zip code

Paperwork Reduction Act Statement: This information is being collected for applications to the National Register of Historic Places to nominate properties for listing or determine eligibility for listing, to list properties, and to amend existing listings. Response to this request is required to obtain a benefit in accordance with the National Historic Preservation Act, as amended (16 U.S.C. 470 et seq.).

Estimated Burden Statement: Public reporting burden for this form is estimated to average 18.1 hours per response including time for reviewing instructions, gathering and maintaining data, and completing and reviewing the form. Direct comments regarding this burden estimate or any aspect of this form to the Chief, Administrative Services Division, National Park Service, P.O. Box 37127, Washington, DC 20013-7127; and the Office of Management and Budget, Paperwork Reductions Projects (1024-0018), Washington, DC 20503.

United States Department of the Interior
National Park Service

National Register of Historic Places Continuation Sheet

Ferriday Commercial Historic District, Concordia Parish,

Section number 7 Page 1

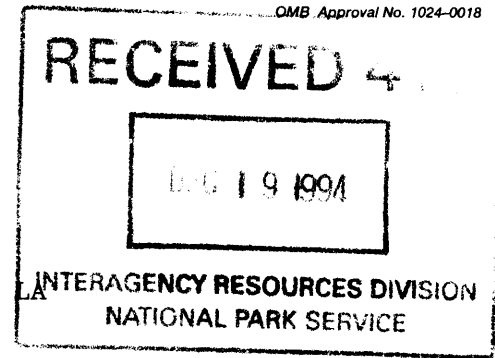

The twenty-three buildings which comprise the Ferriday Commercial Historic District represent the historic portion of the only surviving commercial center within the large rural parish of Concordia. The district consists of one and two story masonry commercial buildings located within a roughly two block area west of the town's railroad corridor. Contributing elements range in date between c.1905 and c.1940. Boundaries were drawn to include all structures within the central business district which retain sufficient historic character while excluding other buildings which have lost their integrity or date to after the historic period. The district has a low non-contributing rate of only nine percent.

All of the district's buildings stand flush to adjacent sidewalks, and approximately three-fourths are connected by party walls. As a result, most mass closely together along the streets, with only a few gaps between structures. The majority of the buildings in the district are uniformly simple, flat-roofed structures with restrained decorative detailing, mostly in the form of molded brick architraves across parapets. Transom windows and canopies are also prominent features. Finally, Italianate segmentally arched windows are found above the shopfronts on all but one of the district's seven, two-story structures.

Contributing Elements

All 50+ year old buildings which retain sufficient integrity are considered contributing elements for the purpose of this submission.

Non-Contributing Elements

There are only two non-contributing elements in the district. These include one modern building and one historic building whose post-fire remodeling may not be fifty years old.

Breakdown of Buildings by Date:

Where possible, buildings were dated using Sanborn Fire Insurance Company Maps (1923, 1926, 1938). Otherwise, a circa date was given based upon the architectural evidence.

CONTINUED

**United States Department of the Interior
National Park Service**

**National Register of Historic Places
Continuation Sheet**

Ferriday Commercial Historic District, Concordia Parish, LA

Section number 7 Page 2

Breakdown by Date

c.1905-1923	6
Between 1923 and 1926	8
Between 1926 and c.1940	7
Non-contributing	2

Assessment of Integrity

Part of Ferriday's central business district is excluded from this National Register submission due to loss of integrity. However, the Division of Historic Preservation estimates that over half of what was historically the CBD is included within the boundaries of the historic district. Although many of the included structures have experienced alteration in the form of changes to their shopfronts and canopies, the buildings still easily convey their architectural status as builder-vernacular commercial buildings and the historic role of the CBD as a commercial center for the almost completely rural Concordia Parish (see part 8).

CONTINUED

**United States Department of the Interior
National Park Service**

**National Register of Historic Places
Continuation Sheet**

Ferriday Commercial Historic District, Concordia Parish, LA
Section number 7 Page 3

FERRIDAY COMMERCIAL HISTORIC DISTRICT INVENTORY

1. **Contributing Element.** United States Post Office (1939). One-story brick French Neo-Classical style building with false chimneys and arched windows set within arched panels. WPA murals.
2. **Non-Contributing Element.** (Original construction between 1923 and 1926.) Two-story brick and metal movie theater with stepped parapet. According to local sources, the building was partially destroyed by fire and rebuilt during or just after World War II. Because the present facade may not be fifty years old, the building is being classified a non-contributing element.
3. **Contributing Element.** (Between 1923 and 1926) One-story brick, party wall commercial building with restrained decorative brick cornice and altered shopfront and canopy. Although buildings no. 3, 4, and 5 all have identical cornice treatments, they are separate party wall buildings.
- 4) **Contributing Element.** (Between 1923 and 1926) Two-story brick Italianate party wall commercial building with segmentally arched windows and restrained decorative brick cornice. Shopfront and canopy replaced; second floor windows boarded over.
- 5) **Contributing Element.** (Between 1923 and 1926) One-story brick, party wall commercial building with restrained decorative brick cornice. Shopfront and canopy replaced.
6. **Contributing Element.** Vogt's Ferriday Drug Store (before 1923). Two story, low-key Italianate party wall commercial building with segmentally arched openings and second floor doors opening to lost balcony. Balcony replaced by canopy, possibly before 1938.
7. **Contributing element.** (Between 1926 and 1938) One-story brick party wall commercial building featuring brick pilasters and cornice. Canopy added before 1938.
8. **Non-Contributing Element.** Small modern one-story brick office building.

CONTINUED

**United States Department of the Interior
National Park Service**

**National Register of Historic Places
Continuation Sheet**

Ferriday Commercial Historic District, Concordia Parish, LA

Section number 7 Page 4

9. Contributing Element. (Between 1926 and 1938) Wilson's Printing. One-story brick commercial building featuring pilasters, a corbelled cornice and a parapet. Doors replaced.
10. Contributing Element. (Between 1923 and 1926) One-story brick party wall commercial building. Shopfront altered; canopy lost. Although from the exterior buildings No. 10 and 11 appear to be one structure, Sanborn Fire Insurance Maps clearly show that No. 11 did not exist in 1926.
11. Contributing Element. (Between 1926 and 1938) One story brick party wall commercial building originally identical in appearance to No. 10. Shopfront altered; canopy lost.
12. Contributing Element. (Between 1923 and 1926) Small one-story brick party wall commercial building with replaced canopy.
13. Contributing Element. (Before 1923) One-story brick party wall commercial building with three bays, corbelled cornice, and stepped parapet. Shopfronts altered.
14. Contributing Element. (Before 1923) One-story brick party wall commercial building with three bays, corbelled cornice, and stepped parapet; originally identical to building # 13. Shopfronts replaced and modern canopy added.
15. Contributing Element. Concordia Drugs (before 1923). Two story Italianate party wall commercial building with segmentally arched windows, corbelled cornice and shaped parapet. Second floor doors opening to lost front balcony. Shopfront replaced; windows boarded over on front.
16. Contributing Element. (Between 1923 and 1926) One-story brick party wall commercial building with shopfronts replaced.
17. Contributing Element. (Between 1926 and 1938) One-story brick party wall commercial building with restrained decorative cornice and altered shopfront. Although at first glance buildings No. 16 and 17 appear to be one structure, the Sanborn Maps indicate that No. 17 did not exist in 1926.

CONTINUED

**United States Department of the Interior
National Park Service**

**National Register of Historic Places
Continuation Sheet**

Ferriday Commercial Historic District, Concordia Parish, LA

Section number 7 Page 5

18. Contributing Element. Ferriday Dental Clinic (before 1923). Large two story brick Italianate corner commercial building with segmentally arched windows, corbelled cornice and semi-circular windows within frieze below parapet; lower story altered.
19. Contributing Element. (Between 1923 and 1926) One-story brick party wall commercial building with tile facade and shaped parapet. Shopfront altered.
20. Contributing Element. (Between 1926 and 1938) One-story brick party-wall commercial building with altered shopfront.
21. Contributing Element. (c.1940) One-story brick party wall commercial building with corbelled cornice and altered shopfront.
22. Contributing Element. (Between 1923 and 1926) Large two-story brick Italianate commercial building with segmentally arched windows; altered shopfront and canopy; second story windows boarded over.
23. Contributing Element. Myer Discount House (before 1923). Two-story brick commercial building with Italianate segmentally arched windows and triangular decorative motifs within the frieze. Shopfront and canopy altered.

United States Department of the Interior
National Park Service

National Register of Historic Places
Continuation Sheet

Ferriday Commercial Historic District, Concordia Parish, LA
Section number 8 Page 1

The Ferriday Commercial Historic District is locally significant in the areas of architecture and commerce. It is important architecturally because it is the only concentration of historic commercial buildings in Concordia Parish. The period of significance for this section of the nomination ranges from c.1905, the date of the earliest buildings, to c.1940, the construction date of the latest contributing element. The district is significant in the area of commerce because it was historically the commercial center of a large active agricultural area. Downtown Ferriday continued to serve in this capacity until well after the 50 year cutoff date. Therefore, the period of significance for this portion of the nomination ranges from c.1905 to 1944.

Architecture

Ferriday stands on land which was once a part of a cotton plantation called Helena. A far-sighted individual who recognized the importance of the railroad, J. C. Ferriday, Helena's owner, encouraged railroad development in Concordia Parish by granting generous rights-of-way across his land. The Texas and Pacific and the Iron Mountain appear to have been two of the railroads which built across Ferriday's land. After his death in 1895, one of the railroads served his widow with a quick[?] claim deed and assumed control of part of the plantation. By 1903, this control had passed to the Ferriday Realty Company, which platted Ferriday as a railroad town in that year. Three years later the town had grown enough to warrant incorporation. *quit*

The commercial zone which developed in Ferriday represents a characteristic type of commercial development found throughout Louisiana during the period from the 1890s through the 1930s. The type consists of small, brick, false-fronted, commercial buildings of one or two stories. Single story buildings typically have broad and open shopfronts (containing plate glass windows and transoms) surmounted by modestly ornamental brick parapets, some of which have shaped tops. Two story buildings have this treatment plus a second story facade with large windows and additional ornamental brickwork. In Ferriday, all but one of the two-story buildings feature segmentally arched windows. As a rule, buildings are set right up against the sidewalk and are separated from each other by party walls. This makes for a distinctive streetscape.

CONTINUED

**United States Department of the Interior
National Park Service**

**National Register of Historic Places
Continuation Sheet**

Ferriday Commercial Historic District, Concordia Parish, LA

Section number 8 Page 2

Architecturally these structures are usually seen as rural, builder-vernacular descendants of pretentious Victorian commercial buildings. In most Louisiana rural communities brick commercial buildings of this type began to replace older frame commercial buildings in about 1895. They were fashionable because they were more like urban commercial buildings, and, more importantly, they were fireproof. Often entire central business districts were rebuilt during this period, and available Sanborn Fire Insurance Maps indicate that such building replacement did take place in Ferriday.

Commercial areas of the type found in Ferriday occur so often that today they are rightly regarded as a distinct phase of Louisiana commercial architecture. However, the Historic Standing Structures Survey for Concordia Parish clearly documents that Ferriday's is the only surviving historic commercial district in the parish. The town's only rival, the parish seat of Vidalia, lost virtually its entire CBD to Mississippi River bridge construction and a levee widening project during the late 1930s.

Commerce

The Ferriday Commercial Historic District is locally significant in the area of commerce because it represents the important role which Ferriday played as a trading center to the surrounding agricultural community.

The story of Ferriday's founding has been related above. In addition to the passenger terminal, freight depot, and roundhouse built in Ferriday by the railroads (all demolished), a number of other industries and businesses developed in the town. Sanborn Fire Insurance Maps indicate the pattern of this development. For example, in 1923 (the first year for which these maps are available) Ferriday supported two hotels, three restaurants, three drugstores, two cobblers, four grocers, four barbers, a pool hall, three boarding houses, and one store somehow related to the automobile industry. The 1926 map records a movie theater, one hotel, two restaurants, three drugstores, one cobbler, six grocers, one newspaper, two barbers, one jewelry store, one pool hall, two

CONTINUED

**United States Department of the Interior
National Park Service**

**National Register of Historic Places
Continuation Sheet**

Ferriday Commercial Historic District, Concordia Parish, LA

Section number 8 Page 3

rooming houses, and eight vacant stores. By 1938 (the date of the last available map) the town was showing the effects of economic decline, but it still supported the movie house, a telegraph office, one hotel, six restaurants, two dry cleaners, one drug store, one cobbler, one grocer and 23 businesses identified only as "stores." All of these businesses were located within two blocks of the town's railroad corridor. Other early twentieth century industries and businesses mentioned in a history of the town published in 1991 include hoop and cooperage companies, a lumber company, a cotton compressing plant, a gas distribution plant, hardware, feed, and dry goods stores, a millinery shop, a post office, an undertaker, and a florist. With these conveniences Ferriday was able to provide the goods and services needed by the cotton farmers in the surrounding area.

United States Department of the Interior
National Park Service

National Register of Historic Places
Continuation Sheet

Ferriday Commercial Historic District, Concordia Parish, LA
Section number 9/10 Page 1

BIBLIOGRAPHY

Division of Historic Preservation, Standing Structures Survey of
Concordia Parish, LA.

Dundy, Elaine. Ferriday, Louisiana. New York: Donald I. Fine,
Inc., 1991.

Gremillion, J. B. "Concordia Parish." Typescript, c. 1961. Copy
at Louisiana State Library.

Sanborn Insurance Company maps, 1923, 1926, 1938.

BOUNDARY DESCRIPTION/JUSTIFICATION

Description: The boundaries are shown on the attached sketch map.

Justification: The boundary lines were drawn to encompass the
concentration of commercial buildings in downtown Ferriday which
retain sufficient integrity. The boundaries exclude portions of
the CBD which have major integrity problems. For example, party
wall commercial buildings are located on the other side of
Louisiana, but virtually all are either historic buildings whose
facades have been covered with metal (or some other material) or
less than fifty year old buildings. One boundary line requires
explanation. The photograph of building #23 suggests a party wall
boundary. However, there is actually a narrow space between
building #23 and the adjacent non-historic building.

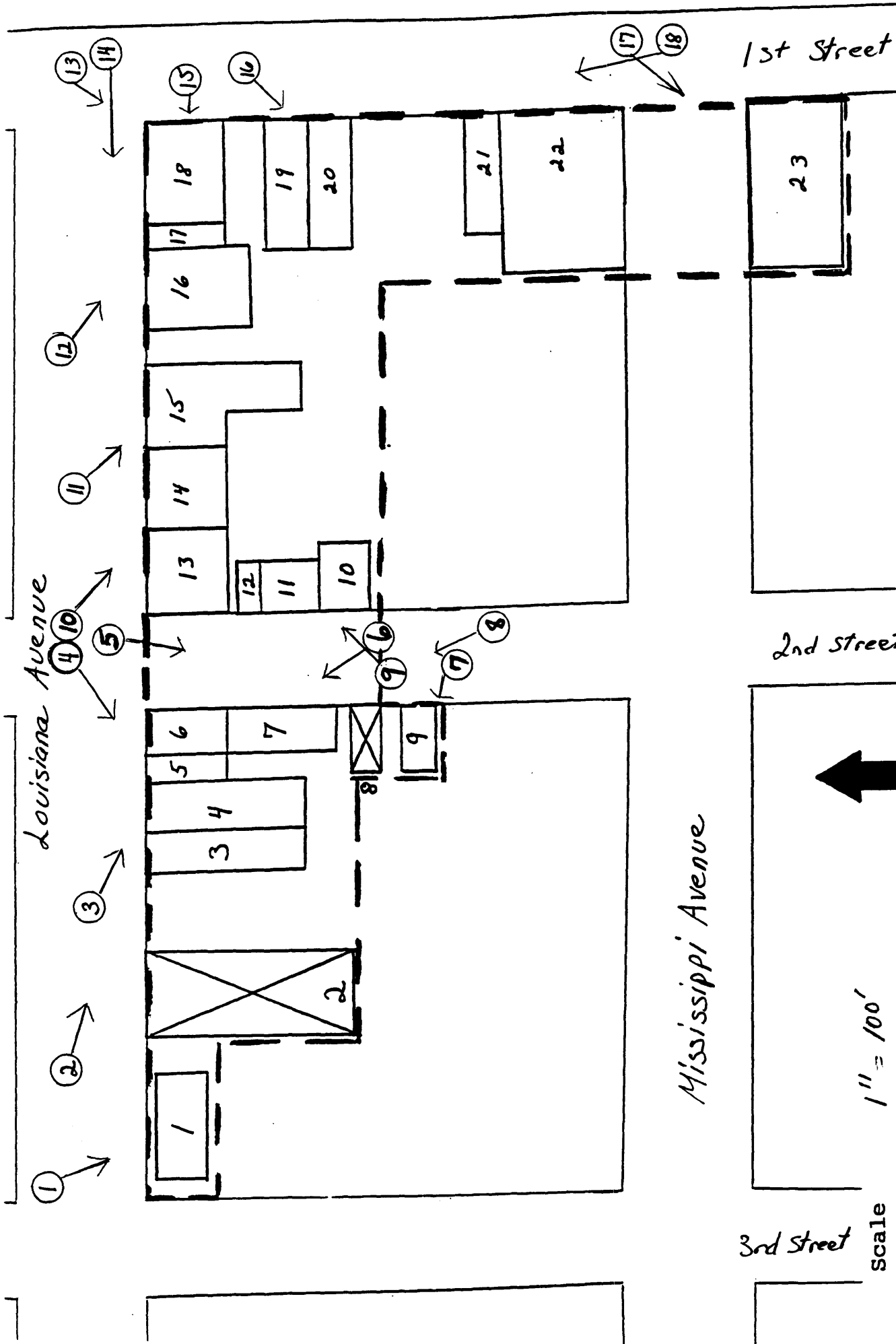



**FERRIDAY COMMERCIAL
HISTORIC DISTRICT**

Ferriday, Concordia Parish, LA

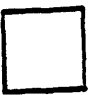

Scale 1" = 100'

- Boundary — — — — —
- Contributing Element 
- Non-Contributing 

3rd Street

Mississippi Avenue

2nd Street

1st Street

Louisiana Avenue