

United States Department of the Interior
National Park Service

National Register of Historic Places
Registration Form

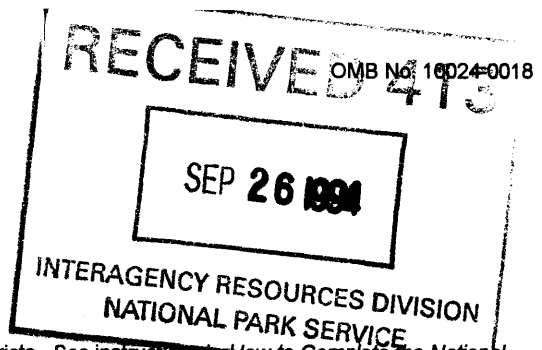

This form is for use in nominating or requesting determinations for individual properties and districts. See instructions in *How to Complete the National Register of Historic Places Registration Form* (National Register Bulletin 16A). Complete each item by marking "X" in the appropriate box or by entering the information requested. If an item does not apply to the property being documented, enter "N/A" for "not applicable." For functions, architectural classification, materials, and areas of significance, enter only categories and subcategories from the instructions. Place additional entries and narrative items on continuation sheets (NPS Form 10-900a). Use a typewriter, word processor, or computer, to complete all items.

1. Name of Property

historic name Island Home Park Historic District

other names/site number N/A

2. Location

street & number Island Home Boulevard, Fisher Place, Spence Place & Maplewood N/A not for publication

city or town Knoxville

N/A vicinity

state Tennessee code TN county Knox code 093 zip code 37920

3. State/Federal Agency Certification

As the designated authority under the National Historic Preservation Act, as amended, I hereby certify that this nomination request for determination of eligibility meets the documentation standards for registering properties in the National Register of Historic Places and meets the procedural and professional requirements set for in 36 CFR Part 60. In my opinion, the property meets does not meet the National Register criteria. I recommend that this property be considered significant nationally statewide locally. (See continuation sheet for additional comments.)

Herbert L. Huger
Signature of certifying official/Title

9/20/94
Date

Deputy State Historic Preservation Officer, Tennessee Historical Commission
State or Federal agency and bureau

In my opinion, the property meets does not meet the National Register criteria. (See Continuation sheet for additional comments.)

Signature of certifying official/Title

Date

State or Federal agency and bureau

4. National Park Service Certification

I hereby certify that the property is:

- entered in the National Register. See continuation sheet
- determined eligible for the National Register. See continuation sheet
- determined not eligible for the National Register.
- removed from the National Register.
- other, (explain:)

for
Gregory M. Rapley
Signature of the Keeper

Entered in the 11/10/94
National Register Date of Action

5. Classification

Ownership of Property (Check as many boxes as apply)

Category of Property (Check only one box)

Number of Resources within Property (Do not include previously listed resources in count.)

- private, public-local, public-State, public-Federal

- building(s), district, site, structure, object

Table with columns: Contributing, Noncontributing, buildings, sites, structures, objects, Total. Values: 119, 10, 2, 1, 122, 10.

Name of related multiple property listing (Enter "N/A" if property is not part of a multiple property listing.)

Historic & Architectural Resources of Knox County, TN

Number of Contributing resources previously listed in the National Register

0

6. Function or Use

Historic Functions

(Enter categories from instructions)

DOMESTIC: single dwelling

DOMESTIC: secondary structure

Current Functions

(Enter categories from instructions)

DOMESTIC: single dwelling

DOMESTIC: multiple dwelling

DOMESTIC: secondary structure

7. Description

Architectural Classification

(Enter categories from instructions)

Bungalow; Tudor Revival, Colonial Revival;

OTHER: minimal traditional

Materials

(Enter categories from instructions)

foundation BRICK, STONE, CONCRETE

walls weatherboard, STONE, STUCCO, BRICK

roof ASPHALT

other STONE, WOOD

Narrative Description

(Describe the historic and current condition of the property on one or more continuation sheets.)

8. Statement of Significance

Applicable National Register Criteria

(Mark "X" in one or more boxes for the criteria qualifying the property for National Register listing.)

- A** Property is associated with events that have made a significant contribution to the broad patterns of our history.
- B** Property is associated with the lives of persons significant in our past.
- C** Property embodies the distinctive characteristics of a type, period, or method of construction or represents the work of a master, or possesses high artistic values, or represents a significant and distinguishable entity whose components lack individual distinction.
- D** Property has yielded, or is likely to yield, information important in prehistory or history.

Areas of Significance

(Enter categories from instructions)

COMMUNITY PLANNING AND DEVELOPMENT
ARCHITECTURE

Period of Significance

1899 - 1940

Significant Dates

1899

Significant Person

(Complete if Criterion B is marked)

N/A

Cultural Affiliation

N/A

Architect/Builder

MULTIPLE UNKNOWN

Criteria Considerations

(Mark "X" in all the boxes that apply.)

Property is: N/A

- A** owned by a religious institution or used for religious purposes.
- B** removed from its original location.
- C** moved from its original location.
- D** a cemetery.
- E** a reconstructed building, object, or structure.
- F** a commemorative property
- G** less than 50 years of age or achieved significance within the past 50 years.

Narrative Statement of Significance

(Explain the significance of the property on one or more continuation sheets.)

9. Major Bibliographical References

Bibliography

(Cite the books, articles, and other sources used in preparing this form on one or more continuation sheets.)

Previous documentation on file (NPS): N/A

- preliminary determination of individual listing (36 CFR 67) has been requested
- previously listed in the National Register
- previously determined eligible by the National Register
- designated a National Historic Landmark
- recorded by Historic American Buildings Survey # _____
- recorded by Historic American Engineering Record # _____

Primary location of additional data:

- State Historic Preservation Office
- Other State Agency
- Federal Agency
- Local Government
- University
- Other

Name of repository:

KNOXVILLE-KNOX COUNTY MPC

Island Home Park Historic District
Name of Property

Knox County, TN
County and State

10. Geographical Data

Acreeage of Property approximately 53 acres

UTM References

(Place additional UTM references on a continuation sheet.)

Knoxville, TN 147NW

1	<u>16</u>	<u>239380</u>	<u>3983180</u>	3	<u>16</u>	<u>240260</u>	<u>3983120</u>
	Zone	Easting	Northing		Zone	Easting	Northing
2	<u>16</u>	<u>239920</u>	<u>3982920</u>	4	<u>16</u>	<u>239930</u>	<u>3983220</u>

See continuation sheet

Verbal Boundary Description

(Describe the boundaries of the property on a continuation sheet.)

Boundary Justification

(Explain why the boundaries were selected on a continuation sheet.)

11. Form Prepared By

name/title Ann K. Bennett, Senior Planner
organization Knoxville-Knox County Metropolitan Planniing Commission date May 1994
street & number 403 City County Building, 400 Main Avenue telephone 615-521-2500
city or town Knoxville state TN zip code 37902

Additional Documentation

Submit the following items with the completed form:

Continuation Sheets

Maps

A **USGS map** (7.5 or 15 minute series) indicating the property's location.

A **Sketch map** for historic districts and properties having large acreage or numerous resources.

Photographs

Representative **black and white photographs** of the property.

Additional items

(Check with the SHPO or FPO for any additional items.)

Property Owner

(Complete this item at the request of SHPO or FPO.)

name Legal Notice
street & number _____ telephone _____
city or town _____ state _____ zip code _____

Paperwork Reduction Act Statement: This information is being collected for applications to the National Register of Historic Places to nominate properties for listing or determine eligibility for listing, to list properties, and to amend existing listing. Response to this request is required to obtain a benefit in accordance with the National Historic Preservation Act, as amended (16 U.S.C. 470 *et seq.*).

Estimated Burden Statement: Public reporting burden for this form is estimated to average 18.1 hours per response including time for reviewing instructions, gathering and maintaining data, and completing and reviewing the form. Direct comments regarding this burden estimate or any aspect of this form to the Chief, Administrative Services Division, National Park Service, P. O. Box 37127, Washington, DC 20013-7127; and the Office of Management and Budget, Paperwork Reductions Projects (1024-0018), Washington, DC 20303.

United States Department of the Interior
National Park Service

National Register of Historic Places Continuation Sheet

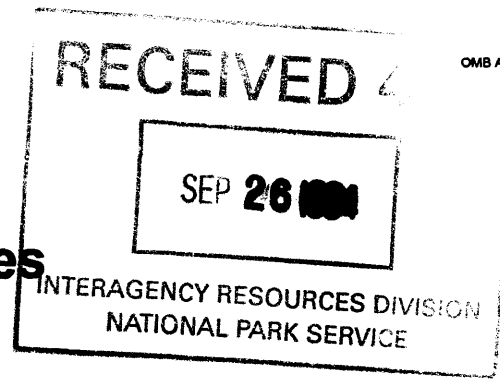

Section number 7 Page 1

Island Home Park Historic District
Knox County, TN

NARRATIVE DESCRIPTION

Island Home Park Historic District is a five and one-half block neighborhood in south Knoxville, Knox County, Tennessee. The district is composed of ninety-one primary properties in an area along Island Home Boulevard (divided by a median strip where the streetcar ran), Spence Place, Fisher Place and Maplewood Drive.

The land that comprises the district is level. It was acquired by the Island Home Park Company in 1899. The exact date of subdividing the land is not known, but the earliest houses in the subdivision appear to date from the first decade of the twentieth century. The company coordinated its activities with the streetcar line construction; this district includes the area that was the original subdivision. Additional construction of newer structures has taken place to the north, along the banks of the Tennessee River, and to the south along a wooded ridge line. Island Home Avenue, with newer and older residences of inconsistent character, marks its western boundary. The eastern boundary is the Tennessee School for the Deaf.

Development of the Island Home Park Historic District follows the pattern for streetcar suburbs as described in Suburban Growth and Development from 1861 to 1940 in the Multiple Resource nomination for Knoxville and Knox County. Principal buildings in the district are single family dwellings. The houses are located on large lots, with mature landscaping. Island Home Boulevard itself is divided by a median strip which once contained the streetcar tracks for the trolley that served the subdivision. The median is now a grassy strip with intermittent mature landscaping and trees. The district retains a high degree of architectural integrity.

The houses in the district are frame and one to two stories tall. The district contains Craftsman and Bungalow dwellings, sometimes influenced by Tudor Revival, Neoclassical or Colonial Revival architectural details. Colonial Revival, Minimal Traditional and Tudor Revival styles are also found in the district.

Island Home Park contains some of the best examples of Bungalow and Craftsman architecture in the city. The Bungalow styles are exemplified in homes at 2221 Island Home Boulevard and 2207 Island Home Boulevard, while 2101 Spence Place and 2135 Island Home Boulevard are good examples of Bungalows with Tudor Revival Influence. Craftsman styling is noteworthy on the house at 2125 Island Home Boulevard. Of particular interest is the use of cobblestone detailing for foundations, balustrades and porch posts and columns; this material is not found elsewhere in Knoxville. 2030 Spence Place, a house of the Bungalow style which uses cobblestone extensively for balustrades, basement, porch columns and chimneys, is a particularly good example of the use of this material.

Most of the secondary structures in the district are garages, built after the use of the automobile was more prevalent. One servants' quarters remains at 2200 Island Home Boulevard, and is an unusual, well-detailed Tudor Revival design blending with the primary structure on the lot.

Listed below, by street address, are the principal resources of the Island Home Park Historic District. There are 132 resources in the district. Eighty-nine of them are residences, of which seven are non-contributing in the district. There are also forty outbuildings, with three which do not contribute to the district. In addition, the gateposts to the Island Home Park Historic District, the trolley turn around on Spence Place, and the median strip along Island Home Boulevard, which date from the time of ownership by the Island Home Park Company, are also contributing resources in the district.

**United States Department of the Interior
National Park Service**

National Register of Historic Places Continuation Sheet

Section number 7 Page 2

Island Home Park Historic District
Knox County, TN

FISHER PLACE

01. 2118 Fisher Place. (c.1915). Bungalow with Tudor Revival influence. Two story frame with brick veneer and asbestos shingle wall covering. Steeply sloped front gable roof with shed dormers, asphalt shingle roof covering and half lunette attic windows flanking chimney. Six over six double hung windows. Offset projecting gable with pedimented front entry. Exterior offset front brick chimney. Brick foundation. Irregular plan. Extended wall on south elevation of front elevation with arched entry. (C)

(c.1915). One story frame garage with asbestos shingle wall covering. Front gable roof with asphalt shingle roof covering. (C)

02. 2126 Fisher Place. (c.1925). Craftsman. One and one-half story frame with weatherboard wall covering. Cross gable jerkin head roof with braces, lattice wood attic vent and asphalt shingle roof covering. Double hung windows with upper sash six light Prairie style and lower sash one light. One story full front porch with dentil molding, widely spaced, on cornice, square wood columns, paired and tripled, and aluminum balustrade. Exterior end brick chimney. Brick foundation. Irregular plan. (C)

(c.1925). One story frame garage with weatherboard wall covering. Side gable roof with asphalt shingle covering. (C)

ISLAND HOME BOULEVARD

03. Gateposts. Intersection of Island Home Avenue and Spence Place. (1899). Trapezoidal stone columns with marble plaques incised with the subdivision name, Island Home. (C)

04. Island Home Boulevard Median. (1899). Twenty foot wide landscaped median strip, with curbs and curb cuts centrally located on short side of blocks to allow passage of streetcar tracks. (C)

05. 2000 Island Home Boulevard. (c.1905). Bungalow with Neoclassical influence. One story frame with brick veneer wall covering. Hip roof with projecting gable bays, enclosed projecting gable with boxed cornice on west elevation, asphalt shingle in attic gables and asphalt shingle roof covering. One over one double hung windows with casement windows in attic, cast concrete sills and lintels. One story front and side wrap around porch with tripled fluted posts with Doric capitals on rock faced ashlar limestone piers, sawn wood balustrade. Exterior offset end brick chimney with rock faced ashlar limestone trim. Rock faced ashlar limestone foundation. Irregular plan. Leaded sidelights and beveled glass transom at front entry. (C)

(c.1915). One story frame garage, brick veneer wall covering. Hip roof, asphalt shingle covering. One over one double hung windows, concrete sills and lintels. (C)

United States Department of the Interior
National Park Service

National Register of Historic Places Continuation Sheet

Section number 7 Page 3

Island Home Park Historic District
Knox County, TN

-
06. 2003 Island Home Boulevard. (c.1935). Minimal Traditional. One story frame with brick veneer wall covering. Steeply pitched hip roof with asphalt shingle covering. Four light paired casement windows. One story one-half bay recessed front porch with brick columns. Interior offset brick chimney. Brick foundation. Irregular plan. (C)
07. 2016 Island Home Boulevard. (c.1950). Modern. One story frame with wood shingle and Crab Orchard uncoursed fieldstone veneer wall covering. Side gable roof with asphalt shingle covering. Eight over eight double hung diamond pane and tripartite multi-pane casement windows on front facade. One story two bay front porch with square wood columns. Exterior side front brick chimney. Cast concrete foundation. Attached one bay garage. Irregular plan. (NC)
08. 2017 Island Home Boulevard. (c.1920). Colonial Revival. Two story frame with stucco wall covering. Side gable roof with asphalt shingle covering. Six over six double hung windows. One story one bay front porch with round cast concrete columns with Doric capitals, extended porte cochere with round cast concrete columns with Doric capitals. Exterior side brick chimney. Stuccoed foundation. Rectangular plan. (C)
09. 2022 Island Home Boulevard. (c.1918). Bungalow with Craftsman influence. One story frame with brick veneer on lower portion of facade and shiplap wood siding under gables. Front gable roof with king post, knee braces, rafter tails, telescoping gable on front cutaway bay and asphalt shingle covering. Four over one and three over one double hung windows. Exterior end brick chimney. One story two bay front porch with brick balustrade and square brick columns. Brick foundation. Irregular plan. (C)
10. 2023 Island Home Boulevard. (c.1920). Craftsman. One story frame with brick veneer wall covering. Cross gable roof with telescoping front gable, knee braces, and asphalt shingle roof covering. Four over one double hung windows with cottage window on front elevation with small pane transom. One story one-half front porch with wood posts on brick piers. Exterior side brick chimney. Brick foundation. Irregular plan. Transom, sidelights surrounding French door at front entry. (C)
- (c.1920). One story frame double garage with brick veneer wall covering. Front gable roof with asphalt shingle covering. (C)
11. 2026 Island Home Boulevard. (c.1925). Tudor Revival. Two story frame with oversized brick veneer wall covering. Steep front gable roof with shed dormer, circular louvered wood attic vent above door and concrete tile covering. Six over six double hung windows. Projecting offset front gable entry with broken pediment above engaged pilasters with Doric capitals. Exterior front brick chimney. Brick foundation. One story one bay porch on east elevation with brick columns, sawn wood balusters. Irregular plan. (C)
- (c.1940). One story frame garage with vertical board wall covering. Front gable roof with asphalt shingle covering. (C)
12. 2027 Island Home Boulevard. (c.1920). Craftsman. One story frame with aluminum siding wall covering. Cross gable roof with asphalt shingle roof covering, knee braces. Five over one double hung windows. One story two-third front porch with brick columns. Exterior side brick chimney. Brick foundation. Irregular plan. Sidelights at front entry. (C)

United States Department of the Interior
National Park Service

National Register of Historic Places Continuation Sheet

Section number 7 Page 4

Island Home Park Historic District
Knox County, TN

13. 2032 Island Home Boulevard. (c.1918) Bungalow with Craftsman influence. Two story frame with aluminum siding wall covering. Steep side gable roof with lower cross gables, rafter tails, knee braces and asphalt shingle roof covering. Three over one double hung windows. One story full screened front porch with brick columns and brick balustrade. Exterior end brick chimney. Brick foundation. Projecting side bays. Irregular plan. (C)
- (c.1930). One story frame garage with vertical board wall covering. Front gable roof with asphalt shingle covering. (C)
14. 2033 Island Home Boulevard. (c.1925). Minimal Traditional with Neoclassical influence. One and one-half story frame with brick veneer wall covering. Cross gable roof with gabled front dormers, asphalt shingle roof covering. Six over six double hung windows. Front stoop. Exterior front brick chimney. Brick foundation. Enclosed sun porch on side elevation with aluminum siding wall covering. Irregular plan. (C)
- (c.1914). One story frame double garage with brick veneer wall covering. Front gable roof with asphalt shingle covering. (C)
15. 2038 Island Home Boulevard. (c.1935). Minimal Traditional. One story frame with brick veneer wall covering. Side gable roof with asphalt shingle covering. One over one double hung windows with cottage window on front facade. Offset projecting gabled entry with flanking extended porch floors, aluminum balustrade. Exterior end brick chimney. Brick foundation. Rectangular plan. (C)
- (c.1935). One story frame garage with weatherboard wall covering. Front gable roof with asphalt shingle covering. (C)
16. 2103 Island Home Boulevard. (c.1915). Craftsman. One and one-half story frame with weatherboard wall covering. Side gable roof with front shed roof dormer, asphalt shingle covering and knee braces. Double hung windows with Prairie style upper sash and single pane lower sash. Front porch altered by removal of roof with brick balustrade and piers and rock faced stone cap, cobblestone quoins. Exterior side brick chimney. Brick foundation. Rectangular plan. (C)
17. 2107 Island Home Boulevard. (c.1920). Tudor Revival. One and one-half story frame with brick veneer wall covering. Cross gable jerkin head roof, concrete tile roof covering. Paired and tripled six over six double hung windows. One story recessed front porch with arched entry. Interior central brick chimney. Brick foundation. Irregular plan. (C)
- (c.1920). One story frame garage with weatherboard wall covering. Front gable roof with asphalt shingle covering. (C)
18. 2108 Island Home Boulevard. (c.1927). Tudor Revival. One story frame with brick veneer wall covering. Side gable roof with wood shingle covering and rectangular wood louvered attic vents. Paired projecting gables on front facade with partial cornice returns. Exterior front brick chimney. Brick foundation. Irregular plan. (C)
- (c.1920). One story frame garage with vertical board wall covering. Front gable roof with asphalt shingle roof covering. (C).

United States Department of the Interior
National Park Service

National Register of Historic Places

Continuation Sheet

Section number 7 Page 5

Island Home Park Historic District
Knox County, TN

19. 2114 Island Home Boulevard. (c.1925). Colonial Revival. Two story frame with brick veneer wall covering. Side gable roof with asphalt shingle covering. Six over six and two over two double hung and eight light casement windows on west elevation sun room. Gabled front portico with round posts with Doric capitals on large wooden plinths. Exterior side brick chimney with flanking half-lunette wood louvered attic vents. Brick foundation. Rectangular plan. (C)
20. 2115 Island Home Boulevard. (c.1935). Minimal Traditional. One story frame with brick veneer and asbestos shingle wall covering. Cross gable roof with asphalt shingle covering. Six over six double hung windows. Front stoop. Brick foundation. Ells at each side elevation. Attached enclosed garage. Added carport with aluminum columns. Irregular plan. (C)
21. 2120 Island Home Boulevard. (c.1925). Tudor Revival. Two story frame with oversize brick veneer and aluminum siding on shed dormer. Steep front gable roof with shed dormers, rectangular wood louvered attic vents and concrete tile covering. Six over six double hung and four light casement windows with brick lintels. Offset projecting gable entrance. Exterior front brick chimney. Brick foundation. Irregular plan. (C)
- (c.1960). One story frame garage with aluminum siding wall covering. Front gable roof with asphalt shingle roof covering. (NC)
22. 2121 Island Home Boulevard. (c.1915). Craftsman. One story frame with brick veneer wall covering. Side gable roof with telescoping from gables, asphalt shingle roof covering, knee braces and rafters. Three over one tripled double hung windows. One story one bay front portico with gabled roof, square wood columns with Doric caps and oversize plinths. Unroofed flanking porches on each side of portico. Interior side brick chimney. Brick foundation. Rectangular plan. (C)
23. 2122 Island Home Boulevard. (c.1915). Bungalow with Craftsman influence. One story frame with aluminum siding wall covering. Front gable roof with telescoping gables and asphalt shingle roof covering. Double hung windows with Prairie style upper sash and one light lower sash. One story two bay extended front porch with truncated wood posts on brick piers, sawn wood balustrade. Exterior side brick chimney. Brick foundation. Projecting cutaway bay on west elevation. Irregular plan. (C)
- (c.1915). One story frame narrow one bay garage with vertical board wall covering. Front gable roof with asphalt shingle roof covering. (C)
24. 2125 Island Home Boulevard. (c.1915). Craftsman. Two story frame with wood shingle wall covering. Front gable roof with asphalt shingle covering, rafters and knee braces. Three over one paired and tripled double hung windows. One story full front porch with brick balustrade, paired chamfered wood posts with Doric caps. Extended porte cochere with chamfered wood posts with Doric caps on brick piers. Exterior side brick chimney. Brick foundation. Irregular plan. (C)
- (c.1915). Two story frame garage with vertical board wall covering. Front gable roof with asphalt shingle covering (C)

United States Department of the Interior
National Park Service

National Register of Historic Places Continuation Sheet

Section number 7 Page 6

Island Home Park Historic District
Knox County, TN

25. 2128 Island Home Boulevard. (c.1910). Bungalow with Craftsman influence. One and one-half story frame with weatherboard wall covering. Cross gable roof with asphalt shingle roof covering, knee braces. Double hung windows with Prairie style upper pane and single light lower pane, altered by addition of Palladian type window in attic over porch. One story full recessed front porch with aluminum posts on brick piers, brick columns at corners and sawn wood balustrade. Exterior side brick chimney. Brick foundation. Paired projecting bays on front facade. Irregular plan. (C)
- (c.1910). One story one bay frame garage with weatherboard wall covering. Front gable roof with asphalt shingle covering. (C)
26. 2131 Island Home Boulevard. (c.1920). Colonial Revival. Two story frame with aluminum siding wall covering. Side gable roof with asphalt shingle covering. Six over one and eight over one double hung windows. One story one bay front portico with gabled roof, arched underside, and round wood columns with Doric capitals. Interior central brick chimney. Brick foundation. Rectangular plan. (C)
27. 2134 Island Home Boulevard. (c.1927). Tudor Revival. Two story frame with brick veneer wall covering. Side gable roof with weatherboard on gable ends, concrete tile roof covering and eyebrow curved roof line above second story front facade. Six over six and four over four double hung windows. Steep projecting front gable with partial cornice returns arched entrance. Exterior side brick chimney. Brick foundation. Irregular plan. (C)
- (c.1927). One story frame double garage with wood shingle wall covering. Front gable roof with asphalt shingle roof covering. (C)
28. 2135 Island Home Boulevard. (c.1915). Bungalow with Colonial Revival influence. One story frame with weatherboard wall covering. Side gable roof with front facing central gablet, asphalt shingle covering. Six over six double hung windows. One story one bay front portico with gabled roof with arched underside, aluminum columns. Extended porte cochere with square wood columns on brick piers. Exterior end brick chimney. Brick foundation. Irregular plan. (C)
29. 2140 Island Home Boulevard. (c.1915). Bungalow with Craftsman influence. One story frame with weatherboard wall covering. Front gable roof with telescoping gables, knee braces and asphalt shingle roof covering. Six over six and one over one double hung windows with six light casement in attic. One story two bay front porch with brick columns and sawn wood balustrade. Exterior side brick chimney. Brick foundation. Irregular plan. (C)
- (c.1925). One story frame double garage with weatherboard wall covering. Front gable roof with asphalt shingle roof covering. (C)
30. 2141 Island Home Boulevard. (c.1930). Minimal Traditional with Tudor Revival influence. One story frame with brick veneer wall covering. Side gable roof with telescoping front gables and asphalt shingle covering. Six over six double hung windows with two cottage windows on front elevation. One bay front portico with arched front entry and recessed porch to one side. Exterior front brick chimney. Brick foundation. Rectangular plan. (C)
- (c.1930). One story frame double garage with brick veneer wall covering. Pyramidal hip roof with asphalt shingle covering. (C)

United States Department of the Interior
National Park Service

National Register of Historic Places Continuation Sheet

Section number 7 Page 7

Island Home Park Historic District
Knox County, TN

31. 2144 Island Home Boulevard. (c.1915). Bungalow with Craftsman influence. One story frame with weatherboard wall covering and aluminum siding wall covering. Side gable roof with wood shingles on gable ends, kingpost, lattice attic vents and a V-crimp metal roof covering. One over one double hung small windows. One story three-quarter gabled front porch with tripled fluted wood posts on brick piers, sawn wood balustrade. Exterior side brick chimney. Brick foundation. Projecting bays on side elevations. Irregular plan. Sidelights and transom at front entry. (C)
32. 2145 Island Home Boulevard. (c.1915). Craftsman. One story frame with brick veneer wall covering. Cross gable roof with telescoping front gables, asphalt shingle roof covering, knee braces and rafters. Three over one double hung windows. One story wrap around front and side porch with truncated wood posts on brick piers, sawn wood balustrade. Interior offset brick chimney. Brick foundation. Irregular plan. (C)
33. 2200 Island Home Boulevard. (c.1925). Tudor Revival. One story frame with stuccoed wall covering and brick quoins at corners and front entry. Side gable roof with slate roof covering. Eight light casement windows. Front stoop with arched front entry. Two brick chimneys, one exterior offset front and one interior offset rear. Stuccoed foundation. Irregular plan. (C)
- (c.1925). One story frame servants quarters with stucco wall covering with brick quoins at corners and entry. Cross gable roof with slate roof covering, half timbering in front gable. Nine light casement windows. Stuccoed foundation. Projecting bay on front elevation. Irregular plan. (C)
34. 2207 Island Home Boulevard. (c.1920). Bungalow with Craftsman influence. One story frame raised basement with wood shingle wall covering. Cross gable roof with front gable on porch roof, knee braces, rafters and asphalt shingle roof covering. One over one double hung windows. One story one-half front porch with square wood posts on square brick piers, brick balustrade. Interior end brick chimney. Brick foundation. Irregular plan. Garage under house. (C)
35. 2208 Island Home Boulevard. (c.1915). Craftsman. One story frame with asbestos shingle wall covering. Cross gable roof with telescoping front gables, rafters, knee braces and asphalt shingle roof covering. Four over one and six over one double hung windows. One story one-half front porch with square wood posts with Doric capitals on truncated brick piers, brick balustrade. Exterior end brick chimney. Brick foundation. Irregular plan. Half view sidelights at front entry. (C)
- (c.1920). One story frame garage with weatherboard wall covering. Front gable roof with asphalt shingle covering. (C)
36. 2211 Island Home Boulevard. (c.1924). Craftsman. One story frame with asbestos shingle wall covering. Cross gable roof with gabled dormers, braces, wood louvered attic vent and asphalt shingle covering. One over one double hung windows. One story three-quarter front porch with square brick columns and square brick piers. Exterior end brick chimney. Brick foundation. Irregular plan. (C)

**United States Department of the Interior
National Park Service**

**National Register of Historic Places
Continuation Sheet**

Section number 7 Page 8

Island Home Park Historic District
Knox County, TN

37. 2212 Island Home Boulevard. (c.1920). Bungalow. One story frame with aluminum siding wall covering. Cross gable roof with asphalt shingle covering. Six and twelve light casement windows. One story one-half front porch with square brick columns, sawn wood balustrade. Exterior side truncated brick chimney. Brick foundation. Irregular plan. (C)
- (c.1920). One story frame garage with weatherboard wall covering. Front gable roof with asphalt shingle covering. (C)
38. 2217 Island Home Boulevard. (c.1920). Colonial Revival. Two story frame with aluminum siding wall covering. Hip roof with asphalt shingle covering. Four over four and six over six double hung windows. One story one bay portico with round wood columns with Doric capitals. One story full porch on east elevation with paired round wood columns with Doric capitals and enclosed balustrade. Interior offset rock faced ashlar limestone chimney. Rock faced ashlar limestone foundation. Irregular plan. (C)
- (c.1950). One story double frame garage with weatherboard wall covering. Front gable roof with asphalt shingle covering. (NC)
39. 2218 Island Home Boulevard. (c.1955). Ranch. One story frame with brick veneer wall covering. Side gable roof with asphalt shingle covering. Six light casement windows. One bay front portico with aluminum columns. Slab foundation. Rectangular plan. (NC)
40. 2221 Island Home Boulevard. (c.1915). Bungalow. Two story frame with brick veneer wall covering. Hip roof with asphalt shingle covering, attic dormer on front elevation, decorative paired sawn wood brackets under overhanging eaves. Three over one double hung windows. One story three-quarter front porch with brick columns and balustrade with limestone coping. Exterior offset front brick and interior offset rear brick chimneys. Brick foundation. Rectangular plan. (C)
41. 2222 Island Home Boulevard. (c.1925). Craftsman. One story frame with weatherboard wall covering. Cross gable roof with telescoping front gables, knee braces, rafters and asphalt shingle roof covering. Nine light casement windows. One story one-half front porch with truncated wood posts on brick piers. Exterior side brick chimney. Brick foundation. Projecting one story bay on east elevation. Irregular plan. Sidelights at front entry. (C)
- (c.1915). One story one bay front garage with weatherboard wall covering. Hip roof with asphalt shingle covering. (C)
42. 2227 Island Home Boulevard. (c.1925). Tudor Revival. One and one-half story raised basement frame with brick veneer wall covering. Side gable roof with asbestos tile roof covering, arched attic vents and window. Six light casement windows with transoms. Exterior offset front brick chimney. Brick foundation. Irregular plan. Copper gutters and downspouts. (C)
43. 2228 Island Home Boulevard. (c.1925). Craftsman. One story frame with weatherboard wall covering. Cross gable roof with rafters, knee braces and elaborate Chevron shaped design in bracing at center of front elevation, asphalt shingle roof covering. Six over six double hung windows and Cottage window on front elevation. One story front and side wrap

United States Department of the Interior
National Park Service

National Register of Historic Places Continuation Sheet

Section number 7 Page 9

Island Home Park Historic District
Knox County, TN

around porch with square fluted wood posts with Doric capitals on truncated brick piers, sawn wood balustrade. Exterior side brick chimney. Brick foundation. Irregular plan. Sidelights at front entry. (C)

44. 2234 Island Home Boulevard. (c.1925). Craftsman. One story frame with aluminum siding wall covering. Cross gable roof with telescoping front gables, asphalt shingle covering. Six over one double hung paired and tripled windows. One story wrap around front and side porch with truncated wood posts on truncated brick piers, sawn wood balustrade. Exterior side brick chimney. Brick foundation. Irregular plan. (C)
45. 2237 Island Home Boulevard. (c.1912). Bungalow. Two story frame with aluminum siding wall covering. Jerkin head gable roof with shed dormers, asphalt shingle covering. Four over four and six over one double hung windows and six light casements. One story full recessed front porch with tripled wood posts with Doric capitals on brick balustrade with lattice between posts. Interior offset brick chimney. Brick foundation. Projecting bay on west elevation. Irregular plan. Stained glass divided light transom and sidelights. (C)
46. 2238 Island Home Boulevard. (c.1925). Craftsman. One story frame with weatherboard wall covering. Cross gable roof with rafters, knee braces, asphalt shingle roof covering. Six over one double hung paired and tripled windows. One story wrap around front and side porch with truncated wood posts on truncated brick piers, sawn wood balustrade. Exterior side brick chimney. Brick foundation. Irregular plan. (C)
- (c.1925). One story frame garage with weatherboard wall covering. Front gable roof with asphalt shingle covering. (C)
47. 2244 Island Home Boulevard. (c.1928). Tudor Revival. One story frame with brick veneer wall covering of oversize bricks. Cross gable roof with telescoping front gables, asphalt shingle roof covering, louvered wood attic vents. Six over six double hung windows. One story one bay recessed front entry with arcaded entry of brick. Exterior front brick chimney. Brick foundation. Irregular plan. (C)
48. 2245 Island Home Boulevard. (c.1927). Tudor Revival. Two story frame with brick veneer wall covering. Steeply pitched side gable roof with cresting, concrete tile covering, and half timbering with stucco in upper gables. Six over six double hung windows. Projecting offset gable entry with Tudor arched doorway. Exterior offset front brick double flue chimney. Brick foundation. Irregular plan. (C)
- (c.1927). One story one bay frame garage with brick veneer wall covering. Front gable roof with asphalt shingle roof covering. (C)
49. 2249 Island Home Boulevard. (c.1915). Craftsman. One story frame with aluminum siding wall covering. Front gable roof with projecting front gable porch, knee braces and asphalt shingle covering. Six over six and four over four double hung windows. One story three-quarter porch with braced gable roof with projecting joists, aluminum columns. Exterior offset side ashlar limestone and brick chimney. Ashlar limestone foundation. Irregular plan. (C)
- (c.1915). One story one bay frame garage with aluminum siding wall covering. Front gable roof with asphalt shingle roof covering. (C)

United States Department of the Interior
National Park Service

National Register of Historic Places Continuation Sheet

Section number 7 Page 10

Island Home Park Historic District
Knox County, TN

50. 2300 Island Home Boulevard. (c.1965). Modern. One story frame with brick veneer wall covering. Hip roof with asphalt shingle roof covering. Sixteen over eight double hung metal windows. Front stoop with aluminum balustrade. Slab foundation. Irregular plan. (NC)

51. 2301 Island Home Boulevard. (c.1912). Bungalow. One and one-half story frame with aluminum siding wall covering. Jerkin head cross gable roof with rafter tails, asphalt shingle covering. Three over one double hung windows. One story full front porch with square wood posts with Doric capitals on brick piers, brick balustrade with concrete cap. Exterior offset side and interior offset rear brick chimneys. Brick foundation. Rectangular plan. (C)

(c.1912). One story one bay frame garage with asphalt shingle and board and batten wall covering. Front gable roof with asphalt shingle roof covering. (C)

52. 2307 Island Home Boulevard. (c.1915). Bungalow. One and one-half story frame with raised basement and aluminum siding wall covering. Bellcast gable roof with shed dormers and asphalt shingle covering. Three over one and one over one double hung windows. One story one bay front porch with aluminum columns, no balustrade. Exterior offset side brick chimney. Stuccoed foundation. Projecting bay on west elevation. Irregular plan. (C)

(c.1915). One story one bay frame garage with aluminum siding wall covering. Front gable roof with asphalt shingle covering. (C)

53. 2316 Island Home Boulevard. (c.1915). Bungalow with Craftsman influence. One and one-half story frame with raised basement and weatherboard wall covering. Side gable roof with shed roof dormer, rafters, knee braces and asphalt shingle roof covering. Casement windows with Prairie style pane configuration. One story front and side wrap around porch with gable roof, rafter tails and knee braces. Sawn wood balustrade and truncated brick columns with large capitals in form of cross braces. Flanking extended porch floors at each end of wrap around porch. Exterior end brick chimney. Brick foundation. Irregular plan. (C)

(c.1915). One story frame garage with weatherboard wall covering. Side gable roof with asphalt shingle roof covering. (C)

54. 2321 Island Home Boulevard. (c.1910). Bungalow with Craftsman influence. Two story frame with raised basement, weatherboard wall covering. Telescoping cross gable roof with rafter tails, knee braces, rectangular wood louvered attic vents and asphalt shingle covering. Nine over ten double hung, six over one casement and fifteen light fixed windows. One story front and side wrap around porch with gabled roof, massive truncated cobblestone piers and sawn wood balustrade. Lattice on rear porch. Open balcony above porch on front elevation with sawn wood balustrade. Exterior offset side brick chimney. Brick foundation. Irregular plan. (C)

(c.1910). One story one bay frame garage with shiplap wall covering. Front gable roof with asphalt shingle roof covering, nine light casement windows. (C)

United States Department of the Interior
National Park Service

National Register of Historic Places

Continuation Sheet

Section number 7 Page 11

Island Home Park Historic District
Knox County, TN

MAPLEWOOD

55. 2147 Maplewood. (c.1925). Bungalow. One story raised basement frame with aluminum siding wall covering. Side gable roof with asphalt shingle covering. Three over one double hung windows. Gabled front portico with braces. Screened one bay porch on east elevation. Exterior offset side brick chimney. Brick foundation. Irregular plan. (C)
56. 2205 Maplewood. (c.1925). Bungalow. One and one-half story frame with asbestos shingle wall covering. Front gable roof with gabled front dormer, asphalt shingle covering. Eight over eight double hung windows. One story one bay front portico with square wood columns and fluted engaged pilasters. Exterior side brick chimney. Concrete block foundation. Rectangular plan. (C)
- (c.1925). One story concrete block garage. Front gable roof with asphalt shingle roof covering. (C)
57. 2213 Maplewood. (c.1920). Colonial Revival. Two story frame with asbestos shingle wall covering. Side gable roof with asphalt shingle covering. Eight over eight double hung windows. One story one bay front portico with square wood columns and engaged pilasters and sawn wood balustrade around roof. Concrete block foundation. Rectangular plan. (C)
58. 2219 Maplewood. (c.1935). Minimal Traditional. One story raised basement frame with aluminum siding wall covering. Side gable roof with asphalt shingle covering. Eight over eight and six over six double hung windows. Recessed entry. Exterior offset side chimney. Stucco foundation. Rectangular plan. (C)
59. 2223 Maplewood. (c.1935). Minimal Traditional. One story raised basement with brick veneer and aluminum siding wall covering. Side gable roof with asphalt shingle covering and extensions. Six over six double hung windows. Exterior offset side brick chimney. Brick foundation. Rectangular plan. (C)
60. 2229 Maplewood. (c.1930). Tudor Revival. One story frame with brick veneer wall covering. Side gable roof with front gable dormers and asphalt shingle roof covering. Six over six and eight over eight double hung windows. Gabled one story one bay recessed front portico with arched entry with rock faced keystone. Exterior side brick chimney. Brick foundation. Rectangular plan. (C)
61. 2235 Maplewood. (c.1950). Modern. One story frame with brick veneer wall covering. Hip roof with asphalt shingle covering. Three light metal double hung windows with picture window on front elevation. Front stoop. Interior offset brick chimney. Slab foundation. Rectangular plan. (NC)
62. 2247 Maplewood. (c.1927). Tudor Revival. One story frame with oversized brick veneer wall covering. Bellcast side gable roof with louvered wood attic vents, asphalt shingle roof covering. Four over four double hung and four and eight light casement windows. One story two bay porch with round arcaded openings. Exterior offset side brick chimney. Brick foundation. Rectangular plan. (C)

United States Department of the Interior
National Park Service

National Register of Historic Places Continuation Sheet

Section number 7 Page 12

Island Home Park Historic District
Knox County, TN

SPENCE PLACE

63. 1900 Spence Place. (c.1910). Bungalow with Craftsman influence. One and one-half story frame with aluminum siding wall covering. Side gable roof with hipped attic dormers on front facade, shed dormer on rear, knee braces, and asphalt shingle roof covering. Three over one and one over one double hung and one light paired attic casement windows. One story full porch with cobblestone columns, engaged pilasters and balustrade. Exterior offset side cobblestone chimney. Brick foundation. Irregular plan. Projecting bay with three over one windows on east elevation. (C)
- (c.1910). One story one bay frame garage with weatherboard wall covering. Front gable roof with asphalt shingle covering and pyramidal shaped cupola with louvered vents, shaped rafter tails and knee braces. Nine light casement windows. (C)
64. 1932 Spence Place. (c.1915). American Four Square. Two story frame with brick veneer wall covering on first story and weatherboard wall covering on second story. Hip roof with diamond pattern oversize asphalt shingle roof covering. One over one double hung windows. One story full front porch with square brick columns and brick balustrade. Exterior end brick chimney. Flared beltcourse dividing first and second stories. Transom and sidelights at front entry. (C)
65. 1931 Spence Place. (c.1920). Dutch Colonial Revival. Two story frame with raised basement, aluminum siding wall covering. Side gable roof with shed dormers, extensions and slate roof covering. Six over six and four over four double hung windows. Shed roofed one bay portico with aluminum columns. Interior central brick chimney. Stuccoed foundation. Irregular plan. One bay garage under house on west elevation. (C)
66. 1936 Spence Place. (c.1925). Craftsman. One story frame with weatherboard wall covering. Side gable roof with lower cross front gable porch roof, projecting gablet with small pane attic vent casement window and asphalt shingle covering. Nine over one double hung and six light casement windows. One story full front porch with truncated cobblestone columns and cobblestone balustrade, and flanking unroofed porch. Exterior end cobblestone chimney. Cobblestone foundation. Irregular plan. (C)
67. 1937 Spence Place. (c.1937). Minimal Traditional. One story frame with brick veneer wall covering. Side gable roof with connection between porch and garage, triangular shaped attic vents and asphalt shingle roof covering. Four light casement windows. One story three bay front porch, aluminum columns and aluminum balustrade. Interior offset rear brick chimney. Brick foundation. Irregular plan. Attached one bay one story brick garage. (C)
68. 1942 Spence Place. (c.1926). Craftsman. One story frame with brick veneer wall covering. Cross gable roof with telescoping front gables, knee braces and asphalt shingle covering. Nine over one double hung windows. One story two-thirds front porch with truncated brick columns and dentil mold effect on front porch gable. Exterior end brick chimney. Brick foundation. Irregular plan. Projecting bay on east elevation. (C)
69. 1948 Spence Place. (c.1920). Bungalow with Craftsman and Mission influence. One story frame with stuccoed wall covering. Side gable roof with projecting front telescoping gable and arched parapet roof at front entrance, asphalt shingle roof covering. Six over one double hung windows. One story one bay recessed front porch with paired square stucco columns with recessed panel. Interior offset rear brick chimney. Stuccoed foundation. Irregular plan. (C)

United States Department of the Interior
National Park Service

National Register of Historic Places Continuation Sheet

Section number 7 Page 13

Island Home Park Historic District
Knox County, TN

70. 1951 Spence Place. (c.1935). Minimal Traditional. One story raised basement frame with vertical board and wood shingle wall covering. Side gable roof, asphalt shingle roof covering, rectangular louvered wood attic vents. Six over six double hung windows, three and four light casement windows with four light casement windows arranged in tripartite configuration on front facade. One bay stoop with aluminum balustrade. Interior central brick chimney. Concrete block foundation. Rectangular plan. (C)
71. 2004 Spence Place. (c.1920). Colonial Revival with Craftsman influence. Two story frame with oversize brick veneer wall covering. Side gable roof with knee braces, concrete French tile roof covering. Three over three double hung single, paired, quadruple and two light casement windows. One story two-thirds front porch with wood posts on brick piers, brick balustrade. Interior offset rear brick chimney. Brick foundation. Rear two story frame with brick veneer ell with double garage on first floor. Pergola with brick columns at entrance to garage. Irregular plan. (C)
72. 2010 Spence Place. (c.1925). Tudor Revival. One and one-half story frame with brick veneer wall covering. Side gable roof, hipped roof front dormers and concrete tile roof covering. Eight light casement windows. One story two-third front porch with brick balustrade, paired square wood posts. Exterior end brick chimney. Brick foundation. Rectangular plan. (C)
- (c.1925). One story frame garage with brick veneer wall covering. Front gable roof with asphalt shingle roof covering. (C)
73. 2011 Spence Place. (c.1918). Craftsman. One and one-half story raised basement frame with vertical board, weatherboard and wood shingle wall covering. Side gable roof with projecting and telescoping cross gables, asphalt shingle roof covering. Gabled front attic dormer, rafters, knee braces, and triangular shaped louvered attic vents. Six over one and four over one double hung and two light casement attic windows. One story gabled front and side wrap around porch with brick columns and brick balustrade. Enclosed sun porch on side elevation. Exterior offset brick chimney. Brick foundation. Irregular plan. (C)
74. 2014 Spence Place. (c.1920). Dutch Colonial Revival. Two story frame with wood shiplap siding. Gambrel roof with shed roof front and rear dormers and asphalt shingle roof covering. Four over four and six over six double hung windows. One bay front stoop with stepped brick balustrades. Interior offset rear brick chimneys. Brick foundation. Projecting bays flanking entry on front facade. Irregular plan. Enclosed side porch. Sidelights at front entry. (C)
- (c.1925). One story frame garage with brick veneer wall covering. Front gable roof with asphalt shingle roof covering. (C)
75. 2015 Spence Place. (c.1915). Bungalow with Craftsman and Neoclassical influence. Two story frame with raised basement and aluminum siding wall covering. Side gable roof with front shed dormers, knee braces and asphalt shingle covering. Four over one and eight over one double hung windows. One story recessed full front porch with round wood columns with Doric capitals. Two brick chimneys, one exterior end and one interior offset side. Stuccoed brick foundation. Rectangular plan. Sidelights at front entry. (C)

United States Department of the Interior
National Park Service

National Register of Historic Places Continuation Sheet

Section number 7 Page 14

Island Home Park Historic District
Knox County, TN

-
76. 2016 Spence Place. (c.1950). Modern. One story frame with brick veneer wall covering. Side gable roof with asphalt shingle covering. Two over two double hung metal windows. One story two-thirds front porch with aluminum columns. Interior central brick chimney. Brick foundation. Rectangular plan. (NC)
77. 2025 Spence Place. (c.1925). Colonial Revival. Two story frame with raised basement, aluminum siding wall covering. Side gable roof with partial cornice returns, concrete tile roof covering and flat roof on one story addition on west elevation. Eight over eight and six over six double hung windows. One story one bay gabled porch on east elevation with square wood columns with Doric capitals, enclosed balustrade. One story one bay flat roof front porch with round wood columns with Doric capitals. Exterior offset end brick chimney. Brick foundation. Irregular plan. Five light sidelights at front entry. (C)
78. 2026 Spence Place. (c.1925). Bungalow. Two story frame with aluminum siding wall covering. Cross gable roof with asphalt shingle covering. One over one replacement windows. Enclosed front porch. Interior end brick chimney. Cast concrete foundation. Irregular plan. (NC)
79. 2030 Spence Place. (c.1910). Bungalow. Two story frame with weatherboard wall covering and wood shingles in gables. Front gable roof with rafters, wood louvered attic vent and asphalt shingle covering. Three over one and one over one double hung windows. One story two-thirds front porch with square wood posts on large truncated cobblestone piers, cobblestone balustrade. Porte cochere with truncated tall cobblestone piers with square wood posts. Exterior end brick chimney. Cobblestone foundation. Irregular plan. (C)
- (c.1910). One story frame garage with weatherboard wall covering. Side gable roof with asphalt shingle roof covering. (C)
80. 2036 Spence Place. (c.1915). Bungalow with Craftsman influence. Two story frame with wood shingle wall covering. Cross gable roof with rafters, shed roofed dormer and asphalt shingle covering. Three over one quadrupled and paired double hung windows. One bay front stoop. Exterior end brick chimney. Brick foundation. One story projecting bay on front elevation. Irregular plan. (C)
- (c.1915). One story frame garage with weatherboard wall covering. Front gable roof with asphalt shingle roof covering. (C)
81. 2100 Spence Place. (c.1920). Tudor Revival. One and one-half story frame with brick veneer wall covering. Cross gable roof with concrete tile roof covering. Nine over nine and six over six double hung paired and tripled windows. One story one-half arcaded recessed front porch with brick columns, and porte cochere with arched entry. One story side ell with paired French doors topped by arched fanlight. Exterior end brick chimney. Brick foundation. Irregular plan. (C)
- (c.1920). One story frame garage with brick veneer wall covering. Front gable roof with asphalt shingle roof covering. (C)
82. 2101 Spence Place. (c.1927). Bungalow with Tudor Revival influence. One and one-half story frame with raised basement, brick veneer wall covering of oversized brick. Side gable roof with front hipped roof dormer, scrolled brackets

United States Department of the Interior
National Park Service

National Register of Historic Places Continuation Sheet

Section number 7 Page 15

Island Home Park Historic District
Knox County, TN

under eaves and asphalt shingle covering. Four over four double hung and six light casement windows with arched wooden lintels above second story windows brick corbelling in triangular pattern below first story windows, and wood window trim of turned rope design. Unroofed front porch with French doors at front entry. Interior offset brick chimney. Projecting bay on west elevation with six light casement windows with two light transoms. Enclosed rear porch with spindle trim. Brick foundation. Irregular plan. (C)

83. 2109 Spence Place. (c.1935). Minimal Traditional. One story frame with aluminum siding wall covering. Side gable roof with asphalt shingle covering and projecting front bay with nine light ocular attic window above bay window on front facade. Six over six, ten over ten and one over one double hung windows. One story one bay flat roof front stoop. Exterior offset front brick chimney. Brick foundation. Irregular plan. (C)

84. 2110 Spence Place. (c.1915). Colonial Revival. Two story frame with oversized brick veneer wall covering. Side gable roof with partial cornice returns, concrete Roman tile roof covering. Six over six double hung windows with cast concrete sills, paired on first story. One story one bay front portico with sawn wood balustrade, round wood columns with Doric capitals. Two exterior end brick chimneys with flanking lunette windows. One story side extension with sawn wood balustrade topping flat roof. Irregular plan. (C)

(c.1950). One story concrete block garage with front gable roof with asphalt shingle roof covering. (NC)

85. 2117 Spence Place. (c.1925). Bungalow. Two story frame with raised basement and brick veneer wall covering. Side gable roof with asphalt shingle roof covering and aluminum siding soffit covering obscuring rafters and knee braces. Four, twelve and eight light casement windows. One story one bay projecting gabled front portico with aluminum posts on brick piers, flanked on each side by extended porch floors across entire facade with brick piers with aluminum balustrade marking boundary. Interior offset side brick chimney. Brick foundation. One story gabled wing on east elevation. Irregular plan. (C)

86. 2120 Spence Place. (c.1950). Minimal Traditional. One story frame with aluminum siding wall covering. Side gable roof with asphalt shingle roof covering. Six over six double hung windows. Front stoop. Cast concrete foundation. Rectangular plan. (NC)

87. 2122 Spence Place. (c.1920). Colonial Revival. Two story frame with weatherboard wall covering. Side gable roof with asphalt shingle roof covering. Six over six and eight over eight double hung windows. One story one bay gabled front portico with arched underside supported by round wood columns with Doric capitals. Exterior end brick chimney. Brick foundation. One story enclosed screened porch with round wood columns forming side ell. Irregular plan. (C)

**United States Department of the Interior
National Park Service**

National Register of Historic Places Continuation Sheet

Section number 7 Page 16

Island Home Park Historic District
Knox County, TN

88. 2125 Spence Place. (c.1927). Tudor Revival. Two story frame with raised basement, oversized brick veneer wall covering, weatherboard wall covering on addition on east elevation. Steep side gable roof with offset, narrow louvered wood attic vents, projecting gables on front facade and asphalt shingle roof covering. Six over six and eight over eight double hung windows. Interior central brick chimney. Stuccoed foundation. Irregular plan. (C)
- (c.1927). One story one bay frame garage with weatherboard wall covering. Front gable roof with asphalt shingle roof covering. (C)
89. 2128 Spence Place. (c.1920). Colonial Revival with Tudor Revival influence. One story frame with brick veneer wall covering. Side gable roof with asphalt shingle roof covering. One over one double hung windows. One story one bay front portico with gabled roof. Exterior end brick chimney. Brick foundation. One story screened porch forming side ell. Irregular plan. (C)
- (c.1920). One story frame double garage with weatherboard wall covering. Front gable roof with asphalt shingle roof covering. (C)
90. 2136 Spence Place. (c.1920). Colonial Revival. One story frame with aluminum siding wall covering. Side gable roof with two front gable roofed dormers, asphalt shingle roof covering. Eight over twelve double hung windows. One story one bay front portico with French door at front entry, and square wood columns. Interior offset brick chimney. Brick foundation. Screened porch on side elevation with square wood columns. Irregular plan. (C)
91. 2144 Spence Place. (c.1925). Craftsman. One story frame with brick veneer wall covering. Side gable roof with rafters, knee braces and asphalt shingle roof covering. Six over six double hung windows. One bay front stoop. Exterior end brick chimney. Brick foundation. Rectangular plan. (C)
- (c.1925). One story frame double garage with brick veneer wall covering. Front gable roof with asphalt shingle roof covering (C)
92. Spence Place. (1899) Trolley turnaround just inside Island Home gateposts. (C)

United States Department of the Interior
National Park Service

National Register of Historic Places Continuation Sheet

Section number 8 Page 17

Island Home Park Historic District
Knox County, TN

STATEMENT OF SIGNIFICANCE

The Island Home Park Historic District in Knoxville, Knox County, Tennessee, is nominated under criteria A and C. The neighborhood is nominated under the Suburban Growth and Development, 1861-1940 context of the Multiple Resources Documentation Form for Historic and Architectural Resources in Knoxville and Knox County, Tennessee. In applying criterion A for Community Planning and Development, the neighborhood, which was developed in conjunction with the extension of a streetcar line, marks suburban development in the streetcar era in Knoxville. Under criterion C for Architecture, the district contains some of the best (and the only concentrated collection) of Bungalow and Craftsman style houses, and as added significance, cobblestones are extensively used for building materials on the houses.

The Island Home neighborhood was named for the model farm and second home of Perez Dickinson. Mr. Dickinson was a merchant, banker and educator, prominent in Knoxville and Knox County. He owned Island Home from 1875 to approximately 1899, when the Island Home Park Company took control of the property. Prior to that time, Mr. Dickinson, who maintained a large, elegant home in downtown Knoxville as his primary residence, used Island Home as a summer cottage, a guest residence, and an agricultural and horticultural center. Mr. Dickinson's house, although extensively modified from its original Italianate design, still exists on the grounds of the Tennessee School for the Deaf located at the eastern boundary of the subdivision. The Island Home Park Historic District lies on land that formed the front approach to the grounds, and Island Home Boulevard follows the path established by the original drive to Mr. Dickinson's home.

Mr. Dickinson is reported to have been very gracious in sharing Island Home with the community. He purchased the land from Colonel Thomas L. Spence (for whom Spence Place, a street in the subdivision, is named) in 1869. He also purchased an adjacent island, Williams Island, which now houses Island Home Airport, and was owned by John C. J. Williams. Mr. Dickinson entertained local Knoxvillians, and visiting dignitaries. He encouraged various civic groups and organizations to hold meetings at Island Home, and picnics by Sunday Schools, civic organizations, and the Dickinson Rifles or Dickinson Light Guard, a militia formed by Mr. Dickinson, were common at Island Home. Citizens of Knoxville were accustomed to sharing the hospitality Mr. Dickinson extended; this affection extended to the new Island Home Park Subdivision.

The citizens of Knoxville became even more interested in Island Home after the Gay Street Bridge was constructed in 1898. Before the bridge was complete, a trolley company had been granted an easement to install tracks across the Gay Street Bridge. Prior to installation of the trolley, South Knoxville had always been fairly isolated from the developing city on the north side of the Tennessee River.

In 1899, the Island Home Park Company took control of the property located outside the gardens of Perez Dickinson's house. The gateposts were constructed, and Island Home Boulevard and Spence Place were paved. The streetcar line ran in a median on Island Home Boulevard, and rounded curb cuts that allowed the streetcars to cross intersecting streets are still visible. The exact date of development of the residential subdivision is not known. However, houses were apparently not constructed for the first few years of ownership by Island Home Park, until around 1910. It is known that the land was used as a public gathering place, and for picnics, for a number of years before residential development grew up on Spence Place, Maplewood, Fisher Place and Island Home Boulevard.

Island Home Park Subdivision was platted as a streetcar suburb, with long rectangular blocks facing the rail line in the median on Island Home Boulevard. The lots are relatively narrow and deep, and sidewalks can be found parallel to the streets

United States Department of the Interior
National Park Service

National Register of Historic Places

Continuation Sheet

Section number 8 Page 18

Island Home Park Historic District
Knox County, TN

throughout the neighborhood. The early residents of the district were middle class and professional people associated with the prosperous warehousing and industrial economy of early twentieth century Knoxville. The architectural styles in the neighborhood reflect the styles prevalent in the early 1900s, with Craftsman, Bungalow, Tudor Revival and Colonial Revival, as well as Minimal Traditional, being represented. It is the dominance of the Bungalow styling that contributes greatly to the significance of Island Home Park Historic District. Although there are other areas in Knoxville with Bungalows, there is no other area where the Bungalows are this large or elaborate, or where there are this many of them. In addition, the use of cobblestone contributes to their significant character.

United States Department of the Interior
National Park Service

National Register of Historic Places Continuation Sheet

Section number 9 Page 19

Island Home Park Historic District
Knox County, TN

MAJOR BIBLIOGRAPHICAL REFERENCES

Deed Records, Knox County.

United States Department of the Interior
National Park Service

National Register of Historic Places Continuation Sheet

Section number 10 Page 20

Island Home Park Historic District
Knox County, TN

VERBAL BOUNDARY DESCRIPTION

Beginning at the gateposts of Island Home Park Subdivision on Spence Place at Island Home Avenue, continuing south along the west boundary of lot 3 to its rear boundary, then east along lots 3 and 4 to an alley, then south along the rear of lot 8.01 and west along the side of lot 8.01 to Maplewood Drive, then south along Maplewood Drive to the alley south of lots 1 through 6 and along that alley to the side boundary of lot 23, then south along lot 23 to Maplewood Drive, then east along Maplewood Drive and crossing Fisher Place to the rear of lot 14 and Willis Place to Willis Place's intersection with Spence Place, then following the rear lines of lots 1, 9, 10, 11, 12, 13, and 14 (fronting on Spence Place) to the cross street Estelle Circle, then along the southern line of Spence Place to the point of beginning.

BOUNDARY JUSTIFICATION

The proposed boundaries include all the lots which were originally subdivided and developed as part of the Island Home Park development, associated with the streetcar development south of the Tennessee River in Knoxville.

United States Department of the Interior
National Park Service

National Register of Historic Places

Continuation Sheet

Section number Photos Page 21

Island Home Park Historic District
Knox County, TN

PHOTOGRAPHS

Island Home Park Historic District
Knoxville, Knox County, Tennessee

Photo By: Ann K. Bennett

Date: February 3, 1994

Neg.: Tennessee Historical Commission

Island Home Park Gateposts
Southeast view, facing northwest
#1 of 6

2000 Island Home Boulevard
Northeast elevation facing southwest.
#2 of 6

2221 Island Home Boulevard
South elevation facing north
#3 of 6

2030 Spence Place
North elevation facing south
#4 of 6

1900 block, Spence Place
Facing southwest
#5 of 6

Median, Island Home Boulevard
View from west, facing east
#6 of 6

United States Department of the Interior
National Park Service

National Register of Historic Places
Continuation Sheet

Section number _____ Page 22

Island Home Park Historic District
Knox County, TN

Ms. Elizabeth Randall
2125 Spence Place
Knoxville, TN 37920

Mr. Willis Gibbs
2016 Spence Place
Knoxville, TN 37920

Mr. Harry Bayless
2117 Spence Place
Knoxville, TN 37920

Ms. Mae Mashburn
2026 Spence Place
Knoxville, TN 37920

Ms. Ada Koho
2109 Spence Place
Knoxville, TN 37920

Mr. John Miller
2030 Spence Place
Knoxville, TN 37920

Mr. Robert Campbell
2101 Spence Place
Knoxville, TN 37920

Mr. Joseph Acree
2036 Spence Place
Knoxville, TN 37920

Mr. Samuel Shipman
2025 Spence Place
Knoxville, TN 37920

Mr. Robert Stanley
2100 Spence Place
Knoxville, TN 37920

Mr. Billy Couch
P. O. Box 267
Jefferson, Kentucky 41751

Mr. Harry Wood
2110 Spence Place
Knoxville, TN 37920

Mr. Robert Haws
2011 Spence Place
Knoxville, TN 37920

Mr. Charles Moore
2120 Spence Place
Knoxville, TN 37920

Mr. Earl Jordan
2004 Spence Place
Knoxville, TN 37920

Mr. John Goodwin
2122 Spence Place
Knoxville, TN 37920

Mr. John Reep
3000 Peachtree Street
Knoxville, TN 37920

Mr. Warren Maclin
2136 Spence Place
Knoxville, TN 37920

Mr. Allen Dann
2014 Spence Place
Knoxville, TN 37920

Ms. Judi Gaston
2144 Spence Place
Knoxville, TN 37920

United States Department of the Interior
National Park Service

National Register of Historic Places

Continuation Sheet

Section number _____ Page 23

Island Home Park Historic District
Knox County, TN

Mr. James Miller
2237 Spence Place
Knoxville, TN 37920

Mr. Linnie Brown
2027 Island Home Boulevard
Knoxville, TN 37920

Ms. Inez Seaton
2141 Island Home Boulevard
Knoxville, TN 37920

Ms. Ilona Lehi
2023 Island Home Boulevard
Knoxville, TN 37920

Mr. Bruce Rankin
2135 Island Home Boulevard
Knoxville, TN 37920

Ms. Wanda Bayless
2017 Island Home Boulevard
Knoxville, TN 37920

Mr. Haven Westbrook
2131 Island Home Boulevard
Knoxville, TN 37920

Ms. Amy Neff
2003 Island Home Boulevard
Knoxville, TN 37920

Mr. Neil Range
2125 Island Home Boulevard
Knoxville, TN 37920

Mr. Thomas Sharp
2000 Island Home Boulevard
Knoxville, TN 37920

Ms. Eda Morton
2121 Island Home Boulevard
Knoxville, TN 37920

Mr. Claiborne Bailey
2016 Island Home Boulevard
Knoxville, TN 37920

Mr. Orin Payless
2117 Spence Place
Knoxville, TN 37920

Mr. Robert Stokes
2022 Island Home Boulevard
Knoxville, TN 37920

Mr. Campbell Clark
Route 3, Box 2670
Bean Station, TN 37708

Mr. Carson Chapin
2026 Island Home Boulevard
Knoxville, TN 37920

Mr. Norman Adams
2010 Brown Avenue
Knoxville TN 37917

Ms. Mary Wiginton
2032 Island Home Boulevard
Knoxville, TN 37920

Ms. Mary Rogers
2222B Cabin Hill Road
Nashville, TN 37214

Mr. James Wise
2038 Island Home Boulevard
Knoxville, TN 37920

United States Department of the Interior
National Park Service

National Register of Historic Places
Continuation Sheet

Section number _____ Page 24

Island Home Park Historic District
Knox County, TN

Mr. Lee Neely
2104 Island Home Boulevard
Knoxville, TN 37920

Mr. John Houck
2307 Island Home Boulevard
Knoxville, TN 37920

Mr. Felix Griffin
2108 Island Home Boulevard
Knoxville, TN 37920

Mr. Troy Haydon
2301 Island Home Boulevard
Knoxville, TN 37920

Mr. Stewart Lush
2114 Island Home Boulevard
Knoxville, TN 37920

Mr. Hite Sanford
2249 Island Home Boulevard
Knoxville, TN 37920

Ms. Gaynell Noel
2120 Island Home Boulevard
Knoxville, TN 37920

Mr. Clarence Harbin
2245 Island Home Boulevard
Knoxville, TN 37920

Mr. Richard Bowling
2122 Island Home Boulevard
Knoxville, TN 37920

Mr. Bernard Strange
2237 Island Home Boulevard
Knoxville, TN 37920

Mr. David Giles
2128 Island Home Boulevard
Knoxville, TN 37920

Mr. George Cowart
2221 Island Home Boulevard
Knoxville, TN 37920

Mr. Gordon Carlson
2134 Island Home Boulevard
Knoxville, TN 37920

Mr. Gene Perkins
2217 Island Home Boulevard
Knoxville, TN 37920

Mr. Thomas Chen
406 Moser Lane
Knoxville, TN 37914

Mr. Paul Palko
2207 Island Home Boulevard
Knoxville, TN 37920

Mr. Robert Miller
2144 Island Home Boulevard
Knoxville, TN 37914

Ms. Genevieve Platt
2211 Island Home Boulevard
Knoxville, TN 37920

Mr. Jewell Cox
1800 St. Mary's Street
Knoxville, TN 37917

Ms. Roxann Hovland
2150 Maplewood
Knoxville, TN 37920

Mr. Jewel Paschel
2321 Island Home Boulevard
Knoxville, TN 37920

**United States Department of the Interior
National Park Service**

**National Register of Historic Places
Continuation Sheet**

Section number _____ Page 25

Island Home Park Historic District
Knox County, TN

Mr. Cranston O'Neal
2200 Maplewood
Knoxville, TN 37920

Ms. Elizabeth Brabson
2218 Island Home Boulevard
Knoxville, Tn 37920

Mr. Frances Lockett
2206 Maplewood
Knoxville, TN 37920

Mr. Gregory Congleton
2222 Island Home Boulevard
Knoxville, TN 37920

Mr. Stewart Crane
2214 Maplewood
Knoxville, TN 37920

John and Martha James
2227 Island Home Boulevard
Knoxville, TN 37920

Ms. Eula Watson
2216 Maplewood
Knoxville, TN 37920

Ms. Nancy Ault
2228 Island Home Boulevard
Knoxville, TN 37920

Ms. Ruth Carnes
2230 Maplewood
Knoxville, TN 37920

Mr. Larry Harbin
2234 Island Home Boulevard
Knoxville, TN 37920

Mr. Willie Smith
2240 Maplewood
Knoxville, TN 37920

Mr. William Matthews
2238 Island Home Boulevard
Knoxville, TN 37920

Mr. Glen Fleming
2244 Maplewood
Knoxville, TN 37920

Mr. Samuel Henley
2009 Willis Place
Knoxville, TN 37920

Mr. William Moorfield
2200 Island Home Boulevard
Knoxville, TN 37920

Mr. Fritts King
2300 Island Home Boulevard
Knoxville, TN 37920

Mr. Paul Efird
2208 Island Home Boulevard
Knoxville, TN 37920

Ms. Katherine Tipton
2316 Island Home Boulevard
Knoxville, TN 37920

Ms. Judith Cummins
2212 Island Home Boulevard
Knoxville, TN 37920

Mr. Frances Smith
2118 Fisher Place
Knoxville, TN 37920

United States Department of the Interior
National Park Service

National Register of Historic Places

Continuation Sheet

Section number _____ Page 26

Island Home Park Historic District
Knox County, TN

Mr. Warren Weaver
2126 Fisher Place
Knoxville, TN 37920

Mr. Broughton Iron
2247 Maplewood
Knoxville, TN 37920

Ms. Bertha Henderson
2235 Maplewood
Knoxville, TN 37920

Ms. Florence Davis
2229 Maplewood
Knoxville, TN 37920

Mr. John Miser
2223 Maplewood
Knoxville, TN 37920

Mr. Frank Hughes
2219 Maplewood
Knoxville, TN 37920

Ms. Elizabeth Hickman
2213 Maplewood
Knoxville, TN 37920

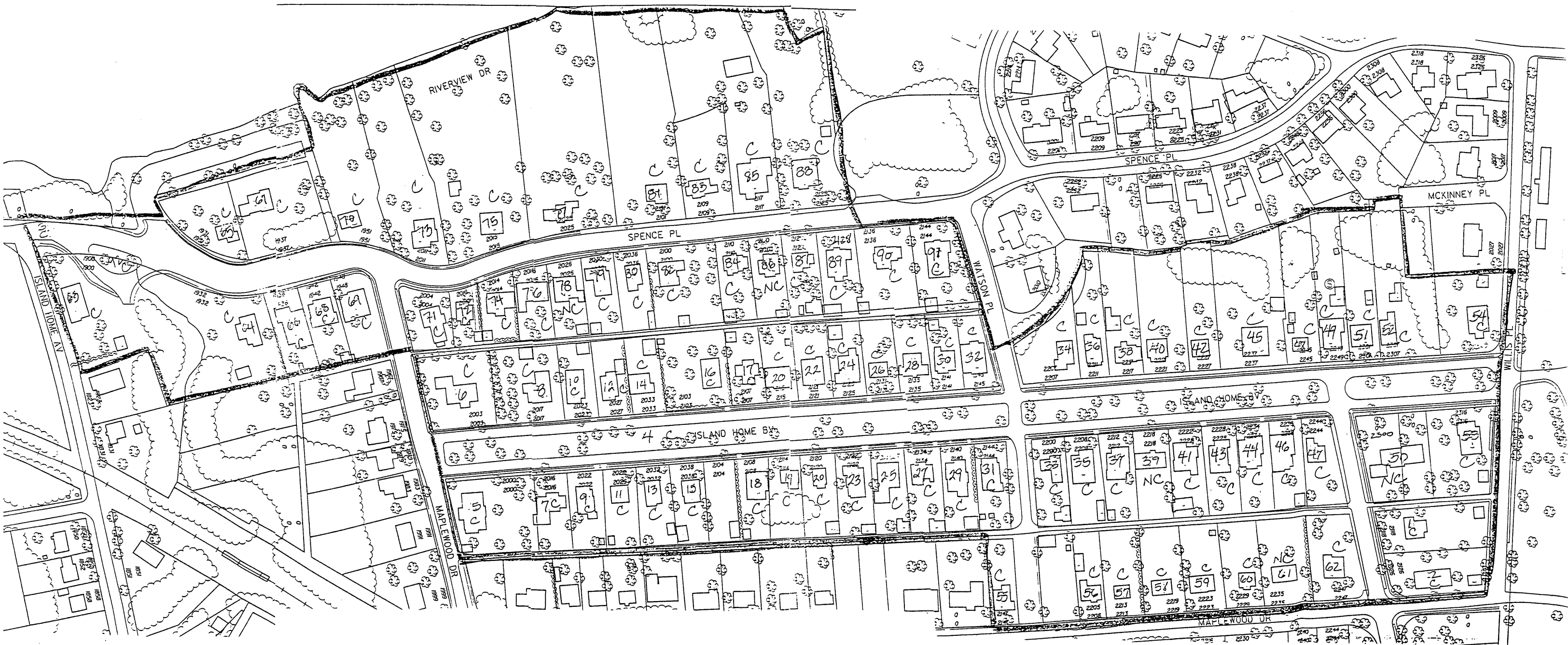

ISLAND HOME HISTORIC DISTRICT
 KNOXVILLE, KNOX COUNTY, TN

Approx Scale $9/16" = 50'$

