

UNITED STATES DEPARTMENT OF THE INTERIOR  
NATIONAL PARK SERVICE

FOR NPS USE ONLY  
RECEIVED . 11 SEP 1979  
DATE ENTERED DEC 6 1979

**NATIONAL REGISTER OF HISTORIC PLACES  
INVENTORY -- NOMINATION FORM**

SEE INSTRUCTIONS IN *HOW TO COMPLETE NATIONAL REGISTER FORMS*  
TYPE ALL ENTRIES -- COMPLETE APPLICABLE SECTIONS

**1 NAME**

HISTORIC

Lake Providence Historic District (~~Commercial~~)

AND/OR COMMON

Same

**LOCATION**

STREET & NUMBER

Lake, Levee, and Scarborough Streets

---NOT FOR PUBLICATION

CITY, TOWN

Lake Providence

CONGRESSIONAL DISTRICT

5th - Jerry Huckaby

--- VICINITY OF

STATE

Louisiana

CODE

022

COUNTY

East Carroll Parish

CODE

035

**CLASSIFICATION**

CATEGORY	OWNERSHIP	STATUS	PRESENT USE	
<input checked="" type="checkbox"/> DISTRICT	<input type="checkbox"/> PUBLIC	<input checked="" type="checkbox"/> OCCUPIED	<input type="checkbox"/> AGRICULTURE	<input type="checkbox"/> MUSEUM
<input type="checkbox"/> BUILDING(S)	<input checked="" type="checkbox"/> PRIVATE	<input type="checkbox"/> UNOCCUPIED	<input checked="" type="checkbox"/> COMMERCIAL	<input type="checkbox"/> PARK
<input type="checkbox"/> STRUCTURE	<input type="checkbox"/> BOTH	<input type="checkbox"/> WORK IN PROGRESS	<input type="checkbox"/> EDUCATIONAL	<input type="checkbox"/> PRIVATE RESIDENCE
<input type="checkbox"/> SITE	<input type="checkbox"/> PUBLIC ACQUISITION	<input type="checkbox"/> ACCESSIBLE	<input type="checkbox"/> ENTERTAINMENT	<input type="checkbox"/> RELIGIOUS
<input type="checkbox"/> OBJECT	<input type="checkbox"/> IN PROCESS	<input type="checkbox"/> YES: RESTRICTED	<input type="checkbox"/> GOVERNMENT	<input type="checkbox"/> SCIENTIFIC
	<input type="checkbox"/> BEING CONSIDERED	<input checked="" type="checkbox"/> YES: UNRESTRICTED	<input type="checkbox"/> INDUSTRIAL	<input type="checkbox"/> TRANSPORTATION
		<input type="checkbox"/> NO	<input type="checkbox"/> MILITARY	<input type="checkbox"/> OTHER:

**OWNER OF PROPERTY**

NAME

See continuation sheet

STREET & NUMBER

CITY, TOWN

--- VICINITY OF

STATE

**LOCATION OF LEGAL DESCRIPTION**

COURTHOUSE.

REGISTRY OF DEEDS, ETC.

East Carroll Parish

STREET & NUMBER

CITY, TOWN

Lake Providence

STATE

Louisiana

**6 REPRESENTATION IN EXISTING SURVEYS**

TITLE

Louisiana Historic Sites Survey

DATE

1979

---FEDERAL  STATE ---COUNTY ---LOCAL

DEPOSITORY FOR  
SURVEY RECORDS

State Historic Preservation Office

CITY, TOWN

Baton Rouge

STATE

Louisiana

# 7 DESCRIPTION

CONDITION		CHECK ONE	CHECK ONE
<input type="checkbox"/> EXCELLENT	<input type="checkbox"/> DETERIORATED	<input type="checkbox"/> UNALTERED	<input checked="" type="checkbox"/> ORIGINAL SITE
<input type="checkbox"/> GOOD	<input type="checkbox"/> RUINS	<input checked="" type="checkbox"/> ALTERED	<input type="checkbox"/> MOVED      DATE _____
<input checked="" type="checkbox"/> FAIR	<input type="checkbox"/> UNEXPOSED		

---

## DESCRIBE THE PRESENT AND ORIGINAL (IF KNOWN) PHYSICAL APPEARANCE

The Lake Providence Commercial Historic District encompasses the Lake Street corridor, which was historically the main commercial area of old Lake Providence. The historic corridor extends two and a half blocks back (westward) from the Mississippi River levee, and half a block to the south on Scarborough Street. Boundaries have been carefully drawn to exclude all intrusions in the vicinity.

The district consists of 33 late 19th and early 20th century brick commercial buildings, 30 of which are one story high. The buildings share common party walls. With the exception of three major gaps, they enclose the streetscape. Although most of the buildings are only one story high, they all have a substantial parapet area above the shop front level which is treated with ornamental brickwork. In the earlier buildings, those built prior to 1910, the ornamental brickwork takes the form of multiple corbel tables and inset panels filled with bricks laid with the corners pointing outward. In the later buildings, those built after 1910, the ornamental brickwork generally takes the form of simple inset brick panels and denticular cornices formed of bricks. Several of these later buildings also have castiron grills, each set in its own brick frame.

In 12, (approximately 40%) of the buildings, the original shop front columns and fenestration survives. Particularly impressive in this respect are building numbers 1 through 7 (see map) which are set between Levee and Sparrow Streets. Here is an almost entire block of buildings, all of which retain their original turn-of-the-century shop fronts. Although some of the glass has been replaced, the ornamental castiron columns remain, as do the shop window openings and the panels set below them. The modern aluminum awnings on these buildings could be easily removed. The other original fronts are on the north side of Lake Street in a less concentrated grouping. Two more of the buildings retain their original door and window openings, though they have been partially boarded up. In 19 of the 33 buildings, the shop fronts have been modernized, with large sheets of plate glass, tile, and new brickwork. In only two cases has this modernization affected areas above the shop front level. In both of these cases the facades have been stuccoed over, but only one has lost its cornice.

Some parts of the district are somewhat deteriorated, and in some areas aluminum awnings have been installed. But cosmetic repairs would be sufficient to rectify these problems.

The district is low-scale and relatively open for a downtown center. To the south and west of the district is a newer mixed commercial and residential area in which the buildings are comparatively widely spaced, and there are parking lots. To the north is an open grassy area with small residences beyond.

UNITED STATES DEPARTMENT OF THE INTERIOR  
NATIONAL PARK SERVICE

**NATIONAL REGISTER OF HISTORIC PLACES  
INVENTORY -- NOMINATION FORM**

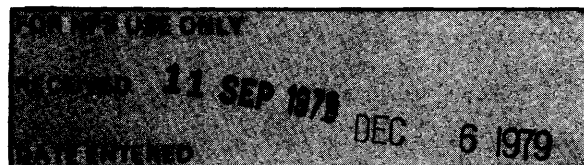

CONTINUATION SHEET

ITEM NUMBER 7 PAGE 2

INVENTORY

1. Masonic Temple - 2-story, 3-bay building with central segmental pedimented gable; castiron columns on the ground floor with acanthus console capitals. Building ornamented with bands of exposed brick corners. Ca. 1910.
2. and 3. - Brick 1-story, 9-bay shop with castiron columns which have fluting and patera. Building surmounted by corbel table. Ca. 1899.
4. Brick 1-story, 2-bay shop surmounted by double corbel table and upper brick panel laid in herringbone pattern. Single castiron column (from J. Wall Foundry of Greenville, Miss.) has fluting and a star motif. 1898.
5. 3-bay version of #4 with raised central paneled parapet. Iron columns also from J. Wall Foundry. Ca. 1900.
- \* 6. 2-story, 5-bay brick commercial building with 4 brick pilaster strips, segmentally arched upper window, panels of exposed brick corners, a castiron shop front with fluted columns and a central free-standing column; ironwork from J. Wall Foundry; original pressed tin ceiling and Georgian style cabinets. Ca. 1897.
7. 3-bay, 1-story castiron fronted store with two elaborate columns which have scrollwork bases, fluting, and anthemion capitals. 1897.
8. Modified shop front, brick 1-story building with corbel table. Ca. 1920.
- 9.,10.,11. Each is a modified shop front, 1-story brick building with denticular cornices, and central segmental arch framed within a raised brick panel, and containing castiron scrollwork. #11 has been stuccoed over but still shows ornamentation and cornice. Ca. 1920.

UNITED STATES DEPARTMENT OF THE INTERIOR  
NATIONAL PARK SERVICE

**NATIONAL REGISTER OF HISTORIC PLACES  
INVENTORY -- NOMINATION FORM**

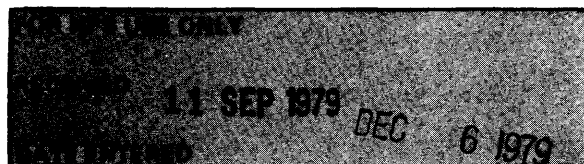

CONTINUATION SHEET

ITEM NUMBER 7 PAGE 3

12. 2-story, 5-bay brick building; modified shop front and stuccoed upstairs but has two castiron panels similar to #'s 9, 10, and 11. Ca. 1920.
13. 1-story brick, modified shop front, stuccoed upper portion still showing cornice. Ca. 1920's.
14. and 15. Stuccoed 1-story buildings. Ca. 1920.
- \* 16. Fisher Hotel - Buff brick 2-story building (designed with 3 stories but never completed). bays with quoins, jack arches, double arches, and Cerlian window formed of brick. Castiron Doric columns. Ground floor partially modified. 1905.
17. Modified shop front, 1-story commercial building with brick trimmed parapet and 2 grill panels. 1922.
18. Modified shop front, brick 1-story building; central portion of parapet raised and trimmed in vertical bricks; grill-work panels. 1916.
19. 2-bay, 1-story brick building with vertical brick cornice and central segmental pediment; has turn-of-the-century Colonial details on shop front. Ca. 1910.
- \* 20.,21.,22. 1-story dark red brick, modified shop front buildings with small decorative panels of brick and concrete; denticular cornices and partially raised parapets capped with concrete. 1926.
- 23.,24.,25. 1-story, 3-bays each with fluted wood columns made to imitate the castiron columns in other parts of town; buildings capped by corbel table. 1898.
26. Brick, 1-story, wood shop front with corbel table and egg and dart molding. 1902.
27. Modified shop front, wide, 1-story brick building; stuccoed upper portion. 1906.

UNITED STATES DEPARTMENT OF THE INTERIOR  
NATIONAL PARK SERVICE

**NATIONAL REGISTER OF HISTORIC PLACES  
INVENTORY -- NOMINATION FORM**

FOR NPS USE ONLY	
RECEIVED	11 SEP 1979
DATE ENTERED	DEC 6 1979

CONTINUATION SHEET

ITEM NUMBER 7 PAGE 4

28. Modified shop front with upper part containing brick panel, corbel table and segmental arch vent. 1905.
29. 1-story brick building, elaborate upper portion containing panels of bricks laid with exposed corners, corbel table and grill vents. Though brick has been laid between them the original castiron columns still show at the shop front level. They were cast at the Chickasaw Iron Works in Memphis, Tenn. 1915.
30. Wood, shop fronted, 1-story brick building. 3 bays with simple brick molding and ladder work in the upper portion. 1915.
- \* 31. 3-bay, 1-story brick building with modified shop front; & exceptionally fine brick work in upper portion, including a row of diagonally laid bricks, a frieze containing straight-sided pointed arches, and molded cornice with a row of bricks laid with corners exposed. 1910.
- \* 32. Brick 3-bay, 1-story building with deeply molded upper panel. 1920.
33. Small 1-bay, 1-story brick building with upper panel containing vertically laid bricks. 1920.

\* indicates photograph of individual building

# 8 SIGNIFICANCE

PERIOD	AREAS OF SIGNIFICANCE -- CHECK AND JUSTIFY BELOW			
<input type="checkbox"/> PREHISTORIC	<input type="checkbox"/> ARCHEOLOGY-PREHISTORIC	<input type="checkbox"/> COMMUNITY PLANNING	<input type="checkbox"/> LANDSCAPE ARCHITECTURE	<input type="checkbox"/> RELIGION
<input type="checkbox"/> 1400-1499	<input type="checkbox"/> ARCHEOLOGY-HISTORIC	<input type="checkbox"/> CONSERVATION	<input type="checkbox"/> LAW	<input type="checkbox"/> SCIENCE
<input type="checkbox"/> 1500-1599	<input type="checkbox"/> AGRICULTURE	<input type="checkbox"/> ECONOMICS	<input type="checkbox"/> LITERATURE	<input type="checkbox"/> SCULPTURE
<input type="checkbox"/> 1600-1699	<input checked="" type="checkbox"/> ARCHITECTURE	<input type="checkbox"/> EDUCATION	<input type="checkbox"/> MILITARY	<input checked="" type="checkbox"/> SOCIAL/HUMANITARIAN
<input type="checkbox"/> 1700-1799	<input type="checkbox"/> ART	<input type="checkbox"/> ENGINEERING	<input type="checkbox"/> MUSIC	<input type="checkbox"/> THEATER
<input checked="" type="checkbox"/> 1800-1899	<input checked="" type="checkbox"/> COMMERCE	<input type="checkbox"/> EXPLORATION/SETTLEMENT	<input type="checkbox"/> PHILOSOPHY	<input type="checkbox"/> TRANSPORTATION
<input checked="" type="checkbox"/> 1900-	<input type="checkbox"/> COMMUNICATIONS	<input type="checkbox"/> INDUSTRY	<input type="checkbox"/> POLITICS/GOVERNMENT	<input type="checkbox"/> OTHER (SPECIFY)
		<input type="checkbox"/> INVENTION		

SPECIFIC DATES

BUILDER/ARCHITECT

## STATEMENT OF SIGNIFICANCE

Lake Providence Commercial Historic District is significant for its architecture and for its social and commercial importance.

The district is a relatively well preserved turn-of-the-century commercial area. Whereas most comparable districts have only a few of the original shop fronts remaining, in Lake Providence a full 40% of them survive, including almost an entire block of pre-1900 buildings, all with the original shop fronts. In addition, Lake Providence has an unusually rich and varied collection of commercial brickwork from the ca. 1900 corbel tables and inset panels to the ca. 1920 recessed panels and simple cornices. In fact, Lake Providence can be said to contain a history of small town commercial architecture from the inception of masonry buildings in about 1895 to the first touches of modernism in the Levy Building (1926).

At the turn of the century, the old downtown area of Lake Providence was the place where the people of East Carroll Parish came to purchase needed goods and foodstuffs. People also came from parts of Mississippi by ferry. By all accounts ferry business was brisk. For example, in 1920, John Edwards operated a ferry which made four runs a day between Lake Providence and Ben Lomond, Mississippi. The Maguire and Schneider ferry which operated in 1907, also owned one of the town's three landings. Three other ferries also operated during this period. Knowledgeable old residents of the town report that Lake Providence was, indeed, the place where people came to shop. Newspaper advertisements from the turn of the century confirm this. For example, they list clothing stores such as T.J. Powell's, Nemo White's, Max Levy, S.W. Green, and Hill Bros. They list drug stores such as Guenard Drugs, City Drugs, and the Levee Street Drug Store. They also list coal for sale at Maguire and Schneider's landing, and foodstuffs for sale at S.A. McNeil Grocery Store. In addition, there was fish market, a lumber mill, a cotton seed oil mill, several dry goods stores, and several hardware stores. The fact that the town's business supported so many stores and manufacturing concerns indicates the importance of Lake Providence as a commercial focal point for the area.

Lake Providence was also a place to come for amusement and diversion at the turn of the century. Old residents report that gambling was a daily activity in the back rooms of the commercial area from the late nineteenth century until the early 1950's, when the practice was broken up by Sherriff "Red" Gilbert. At any given time, there were ten to twelve saloons operating in the town. An example was the Phil McQuire Billiards and Pool Hall, which was advertised as the sole distributor for the Live Oak Distillery Company of Cincinnati, Ohio. Another example was Van's Saloon, just back of the levee, which was frequented by blacks and had a reputation for

# 9 MAJOR BIBLIOGRAPHICAL REFERENCES

File of old newspapers, especially East Carroll Democrat, ca. 1890 - 1920, in possession of Elizabeth Reed.

Interviews with Maude McPhate Van Fossèn, local historian, and Samuel Maggio, owner of local barbershop since 1913.

Pinkston, Georgia D.P., A Place to Remember: East Carroll Parish, LA, 1832 - 1976 (Baton Rouge: Claitor's Publishing Division, 1977), especially chapter 4.

# 10 GEOGRAPHICAL DATA

**UTM NOT VERIFIED**

ACREAGE OF NOMINATED PROPERTY approx. 8 acres

QUADRANGLE NAME \_\_\_\_\_

QUADRANGLE SCALE \_\_\_\_\_

UTM REFERENCES

A 1,5 6,7,11,3,5,0 3,6,3,0,9,4,0

B \_\_\_\_\_

ZONE EASTING NORTHING

ZONE EASTING NORTHING

C \_\_\_\_\_

D \_\_\_\_\_

E \_\_\_\_\_

F \_\_\_\_\_

G \_\_\_\_\_

H \_\_\_\_\_

VERBAL BOUNDARY DESCRIPTION

See attached city lot and block map.

LIST ALL STATES AND COUNTIES FOR PROPERTIES OVERLAPPING STATE OR COUNTY BOUNDARIES

STATE	CODE	COUNTY	CODE
STATE	CODE	COUNTY	CODE

# 11 FORM PREPARED BY

NAME / TITLE

Mrs. Elizabeth Reed

ORGANIZATION

DATE

STREET & NUMBER

1002 Lake St.

TELEPHONE

CITY OR TOWN

Lake Providence 71254

STATE

Louisiana

# 12 STATE HISTORIC PRESERVATION OFFICER CERTIFICATION

THE EVALUATED SIGNIFICANCE OF THIS PROPERTY WITHIN THE STATE IS:

NATIONAL

STATE

LOCAL

As the designated State Historic Preservation Officer for the National Historic Preservation Act of 1966 (Public Law 89-665), I hereby nominate this property for inclusion in the National Register and certify that it has been evaluated according to the criteria and procedures set forth by the National Park Service.

STATE HISTORIC PRESERVATION OFFICER SIGNATURE

*J. Bernard Lamar*

TITLE State Historic Preservation Officer

DATE

8/16/79

FOR NPS USE ONLY

I HEREBY CERTIFY THAT THIS PROPERTY IS INCLUDED IN THE NATIONAL REGISTER

KEEPER OF THE NATIONAL REGISTER

DATE 12/6/79

ATTEST: *Beth Carson*  
CHIEF OF REGISTRATION

DATE 12/4/79

UNITED STATES DEPARTMENT OF THE INTERIOR  
NATIONAL PARK SERVICE

**NATIONAL REGISTER OF HISTORIC PLACES  
INVENTORY -- NOMINATION FORM**



CONTINUATION SHEET

ITEM NUMBER 8 PAGE 2

---

rowdiness.

There was an opera house which gave regular musical performances. But even if there were no planned event such as a circus or musical, people still came to Lake Providence to meet friends and "watch the people." Old residents have reported that Saturday was a significant day in old Lake Providence. It was the day when families from the surrounding plantations came to town to shop. But more than a shopping trip, it was also a social occasion in which people mingled, received news of other families, picked up the mail, attended a movie or musical performance, and simply sat and watched passers-by.



DEC 6 1

Property Owners of Lake Providence Historic District  
(Commercial)

Division of  
Archaeology and  
Historic Preservation  
P. O. Box 44247  
Baton Rouge, La. 70804

BLOCK 1

1. Salvador Salemi  
209 Sparrow St.  
Lake Providence, La. S 30ft. of Lot 1 Block 1
2. Jong, Inc.  
Wally Jong  
217 N. Hood  
Lake Providence, La. 71254 Lots 1 and 2 of Block 1  
39 ft. on S side of Lake St.
3. No. La. Savings and Loan  
201-A Hood St.  
Lake Providence, La. Certain Lot Fronting on S side  
Lake St. Block 1, 36 ft.
4. Jeff Hair  
114 Lake St.  
Lake Providence, La. Part of Lot 21 and part of 19  
40 ft. fronting on Lake St.
5. Charles Perry  
116 Lake St.  
Lake Providence, La. 71254 Lot 20 and 21. 26½ ft. in Lot 20  
and 32 ft. in Lot 21 Block 1

BLOCK 8

1. Leon Minsky Est. and  
Salvador Salemi  
209 Sparrow St.  
Lake Providence, La. Lot 1, Block 8. 28 ft. on S side  
Lake St. and 120,75 ft. fronting  
on Sparrow St.
2. Charles Leach  
204 Lake St.  
Lake Providence, La. Lots 2, 3, 4, Block 8  
and half lot 4
3. R. S. Guenard  
P. O. Box 311  
Lake Providence, La 71254 Lot 5, Block 8 26 ft. and 22 ft lot 4
4. Nan S. Williams  
P. O. Box 586  
Lake Providence, La. Lot 6, Block 8 30 ft.
5. Max Stockner  
P. O. Box 166  
Lake Providence, La. Lot 7, Block 8 30 ft.
6. Alex S. Herzog  
214 Lake St.  
Lake Providence, La. 71254 Lot 8, Block 8 32 ft.

7

BLOCK 9

Dr.

1. F. M. Terral  
P. O. Box 471  
Lake Providence, La. 71254

Lots 1, 2, and 3 90 ft. on  
Lake St. and 85 ft. on  
Scarborough St.

Also, a lot 40 ft. by 70 ft.  
Beginning 95 ft. S of N.E.  
corner of Block 9

2. Gibson Drugs  
310 Lake St.  
Lake Providence, La. 71254

Lots 4 and 5

3. W. E. Scott  
P. O. Box 686  
Lake Providence, La. 71254

Lot 6

4. Hamley, Inc.  
Lake Providence, La.

MISSISSIPPI RIVER LEVEE

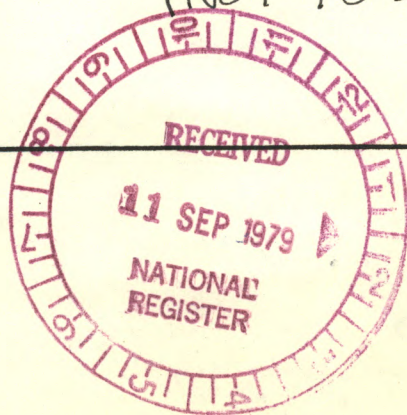
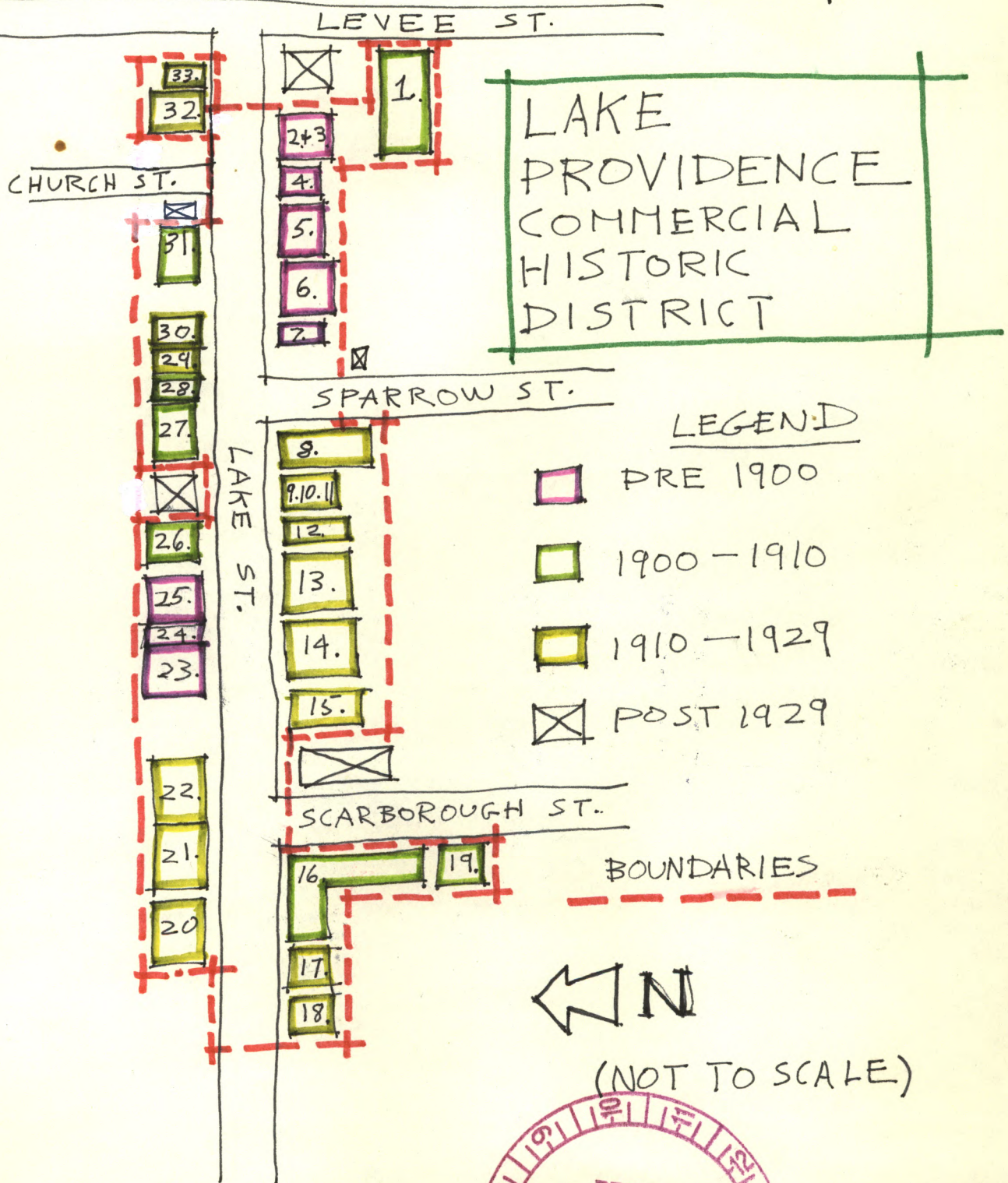

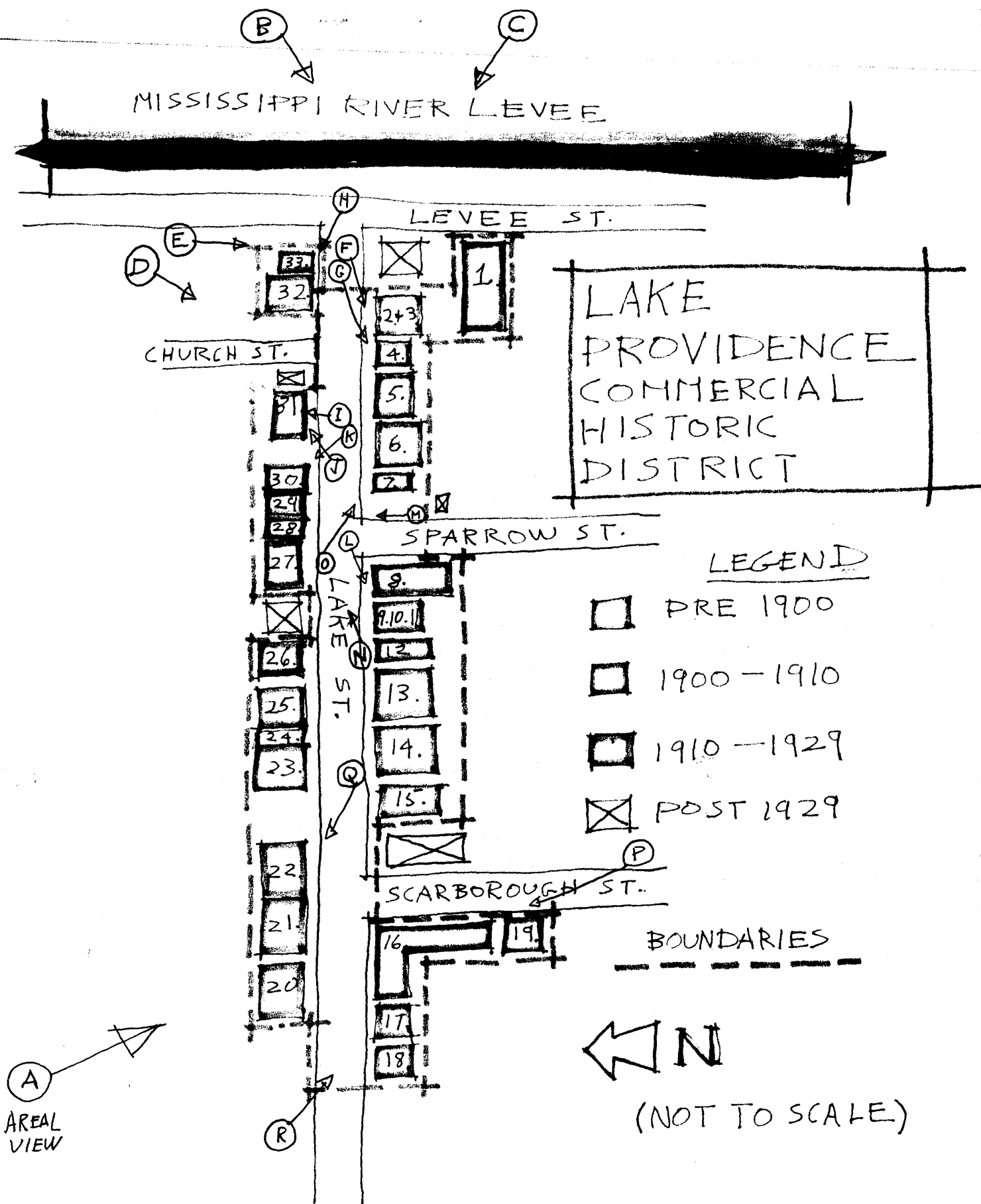

LAKE PROVIDENCE PHOTO DIRECTIONAL  
MAP — (INDIVIDUAL BUILDINGS  
 WERE PHOTO GRAPHED SEPARATELY  
 AND ARE LISTED ACCORDING TO BUILDING  
 NUMBER)