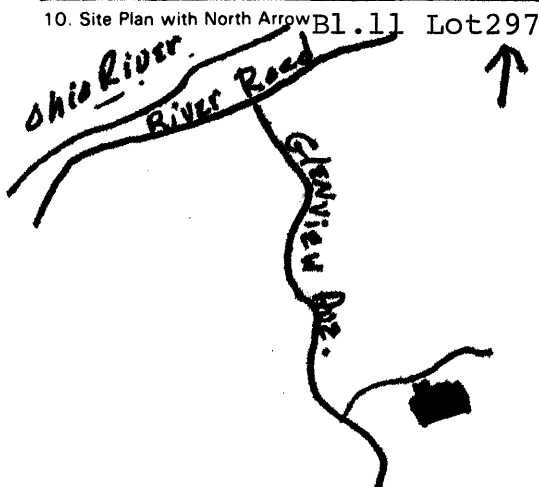

KENTUCKY HISTORIC RESOURCES INVENTORY

Site No. JF-540

1. Historic Name(s) <u>Edgewood</u> Original Owner <u>John B. McFerran</u>		22. ADD/County <u>Jefferson/Jefferson</u> <u>0516</u>	
2. Present Name <u>Edgewood</u>		23. U.S.G.S. Quadrant (15'/75') <u>Jeffersonville, Ind.</u> <u>0816</u> G.I.S. Mod.	
3. Location <u>3605 Glenview Ave. Louisville, Ky.</u>		24. UTM Reference <u>16</u> <u>61</u> <u>8</u> <u>56</u> <u>0</u> <u>42</u> <u>3</u> <u>99</u> <u>50</u> Zone Easting Northing	
4. Owner's Name <u>Joseph E. & Lue Allred Herpen</u>		25. Coordinate Accuracy <input type="checkbox"/>	
5. Owner's Address <u>3605 Glenview Ave. Louisville, Ky. 40222</u>		26. Prehistoric Site Object Historic Site Structure Building <input checked="" type="checkbox"/> Other	
6. Open to Public Yes <input type="checkbox"/> No <input checked="" type="checkbox"/>	7. Visible from road Yes <input checked="" type="checkbox"/> No <input type="checkbox"/>	8. Ownership Private <input checked="" type="checkbox"/> Local <input type="checkbox"/> State <input type="checkbox"/> Federal <input type="checkbox"/>	
9. Local Contact/Organization <u>Jeff. Co. Office of Historic Preservation and Archives</u>		27. National Register District Name:	
10. Site Plan with North Arrow <u>B1.11 Lot 297</u> 		28. Significance Evaluation <u>Meets Nat. Reg. Criteria</u> <u>d</u>	
11. Architect <u>Unknown</u>		29. Status Date National Landmark <input type="checkbox"/> National Register <input type="checkbox"/> Landmark Certificate <input type="checkbox"/> Kentucky Survey <input checked="" type="checkbox"/> <u>1977</u> Local Landmark <input type="checkbox"/> HABS/HAER <input type="checkbox"/>	
12. Builder <u>Unknown</u>		30. Historic Theme Primary <u>Architecture</u> <u>03</u> Secondary <input type="checkbox"/> Other <input type="checkbox"/>	
13. Date <u>see next page</u> A. <u>4</u> B. <u>6</u>		31. Endangered Yes <input type="checkbox"/> No <input checked="" type="checkbox"/>	
14. Style A. Italianate <u>5</u> B. Colonial Rev <u>14</u>		32. Preservation Project Status <input type="checkbox"/>	
15. Original Use <u>Sing. Fam. Res.</u> <u>1</u>		Actual Cost in \$1,000s	
16. Present use <u>Sing. Fam. Res.</u>		33. ATTACH PHOTO	
17. Condition <u>Excellent</u> <u>1</u>		Roll No. _____ Picture No. _____ Direction _____	
18. Description <u>see next page</u>		34. Prepared by: <u>Mary Jean Kinsman</u> <u>Researcher</u>	
No. Stories <u>three</u> <u>d</u> Single Pile _____ NA <input checked="" type="checkbox"/> Double Pile _____ Floor Plan <u>other</u> <u>0</u> Structural Fabric <u>Brick</u> A. <u>C</u> B. <input type="checkbox"/> Decorative Fabric <u>Weatherboard</u> A. <u>J</u> B. <input type="checkbox"/> Roof Form <u>Hipped</u>		35. Organization <u>Jeff. Co. Office of Historic Preservation & Archives</u> <u>J</u>	
19. History <u>see next page</u>		36. Date <u>77</u>	
20. Significance <u>see next page</u>		37. Revision Dates <u>83</u>	
21. Source of Information <u>see next page</u>		38. Staff Review	

(Continue on Back)

13. ca. 1868-70

additions ca. 1905-1915

18. Description

Edgewood is a 2½ story structure with a five-bay facade and small rectangular attic windows. During recent interior work, it was discovered that the main block of the house is a brick structure covered with clapboarding. The roof is a low, hipped roof and there are interior brick chimneys and small brackets beneath the cornice. The Palladian window and the wide, columned veranda were added about 1905. The two-story wing on the north was added about 1915.

19. History

Edgewood is thought to have been built by John B. McFerran after his father, James C. McFerran, acquired part of the Berry Hill farm (JF-552) in 1868. The senior McFerran established a trotting horse-breeding farm and changed the name to Glenview Stock Farm. In 1905 the house and a 10 acre tract of land was purchased by John W. Price, secretary and later a vice president of Belknap Hardware and Manufacturing Company. The Price family used the house as a summer home. Mr. Price added the Palladian window and the veranda soon after buying the property. The house was owned by Price descendants until 1981.

20. Significance

The main block of Edgewood is a handsome example of an Italianate country house. It is one of a very few late 19th-century summer homes in the Glenview area. (see JF-542 and JF-543.) The Colonial Revival details which were added around 1905 and 1915 are consistent with architectural trends of that era and, overall, do not detract from the building's integrity.

21. Sources of Information

Jefferson County (Ky) Deed Books

Gill, R. Scott. Glenview, Kentucky, unpublished research paper, Louisville, 1976.

KENTUCKY HISTORIC RESOURCE INVENTORY SUPPLEMENT
BOUNDARY AND LOCATION INFORMATION

Historic Property Name Edgewood Site # JF-540

Multiple Resource/Thematic Nomination Title Jefferson County, Ky MRA

U.T.M. Coordinates - List multiple UTMs if property is ten or more acres.

A. 16 618560 4239950 D. _____

B. _____ E. _____

C. _____ F. _____

Verbal Boundary Description _____ Acreage 7.15

The nominated property comprises all of Lot 297 in County Block 11 of the Jefferson County Property Valuation Administrator: approximately 7.15 acres.

Sketch of Site Plan (Showing outbuildings, structures, landscape features and the site boundary as described above.)

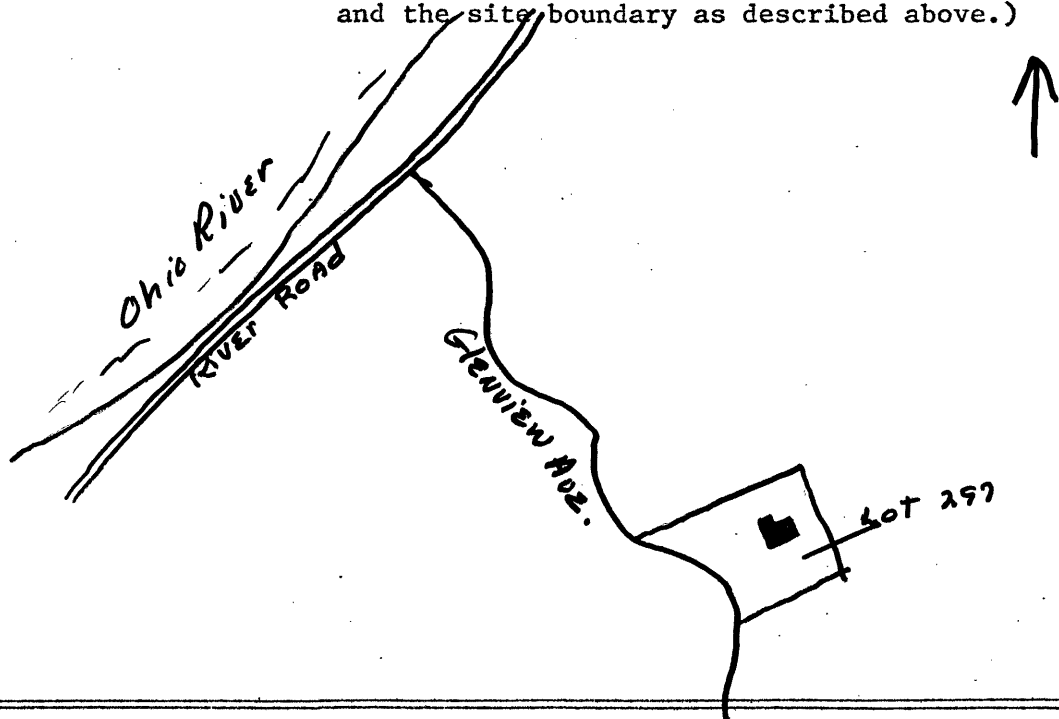

Official Courthouse Property Reference:

Description as recorded in Deed Book 5248 page 529, August 1981.