

DEC 8 1988

3339

KENTUCKY HISTORIC RESOURCES  
Individual Inventory Form

Resource # MA-234  
Madison County

1. Name of Resource: Chenault House

2. Original Owner: Mrs. William Chenault, Sr.

3. Other Names: Burnam House

4. Prehistoric Site  Building X  Object  
Historic Site  Structure  Other

5. Location: North of Lexington Road and East of I-75.

6. Owner's Name: Mr. & Mrs. C. Bracelen Flood [ P ]

7. Owner's Address: Lexington Road  
Richmond, KY 40475

8. Evaluation: [ N ]

9. Recognition & Date:  
Nat.Landmark  Local Landmark   
Nat.Register  HABS/HAER   
Highway Marker  KY Inventory 1985  
KY Landmark Certificate

10. N.R.Status & Date:

11. N.R.Group:  
District Name: [ ]  
Mult.Resource Area: Madison Co. [ ]  
Thematic Name: [ ]

12. Historical Theme:  
Primary: Architecture [030]  
Secondary: [ ]  
Other: [ ]

13. Statement of Significance:  
See attached. [ ]

16. Date: Original Building 1830 [ 7 ]  
Addition door 1840, windows [7,6]  
1870

17. Style: Federal [21]  
Greek Revival [31]

18. Architect/Builder: Unknown

19. No. of Stories: [2,0]

20. Original Floor Plan: Central Passage [CP]

21. Single Pile  Double Pile  N.A.

22. Roof Form & Material: Original  
Asbestos Shingle Not Original X

23. Structural Material: Brick [B]

24. Exterior Material: Brick/Flemish Bond [B]

25. Foundation Material: Stone [S]

26. Major Alterations: None  
Moved/Rebuilt Other  
Additions X Porch enclosed, concrete sills 1960's.

27. Special Features: Belt Course Between Stories

28. Outbuildings: None [ ]

29. Original Function: Single Dwelling [01A]

30. Present Use: Single Dwelling [ ]

31. Condition: Good [G]

32. Endangered: Richmond Yes [X]  
Possibly: Bypass No

33. Attach Photos:  
Roll: Photo Nos: No. of Slides:

14. History:  
Mrs. William Chenault Sr. built the house in the early 19th century on land that had originally been owned by William Irvine as a part of the Irvine pre-emption. The first dwelling on this property was a double log house. Samuel Stone and his wife (Nancy Rodes, daughter of Judge Robert Rodes) lived here from Susannah Chenault's death in the late 1840's through the Civil War. It was occupied by Mr. & Mrs. Thomas D. Chenault from 1866-1885. The house was acquired by A.R. Burnam in the 1920's and subsequently owned by

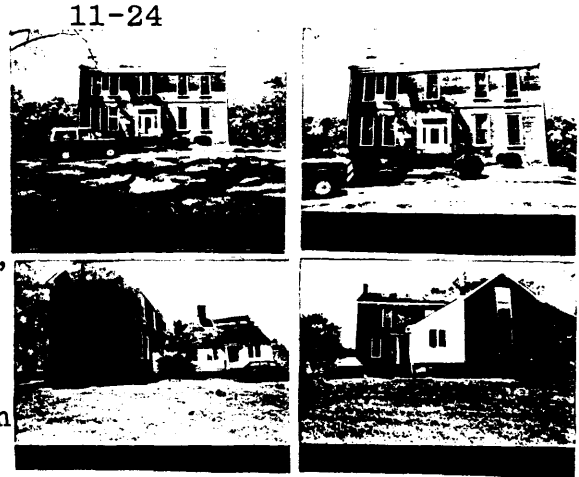

15. Source of historical information and/or contact person:  
Mrs. James Caperton/Townsend Room  
Kathy Flood

34. Prepared by: H Powell & S. Willis

35. Organization: Madison Co. Hist. Society

36. Date: 1985

37. New Survey  Resurvey

KENTUCKY HISTORIC RESOURCES  
Individual Inventory Form

Resource # MA-234

38. UTM Point of Primary Building: Zone Easting Northing 39. G.I.S. Mod. [ ]  
Quadrant: Richmond North 10 737540 4184020 40. Coordi.Accuracy [ ]

41. UTM Points of Boundary (for N. R. eligible sites only):

A. ----- D. -----  
B. ----- E. -----  
C. ----- F. -----

42. Total Acreage in Present Property: 43. Acreage included in proposed N.R. boundary:

44. Site Plan (and boundary description and justification for N.R. sites):

See Attached.

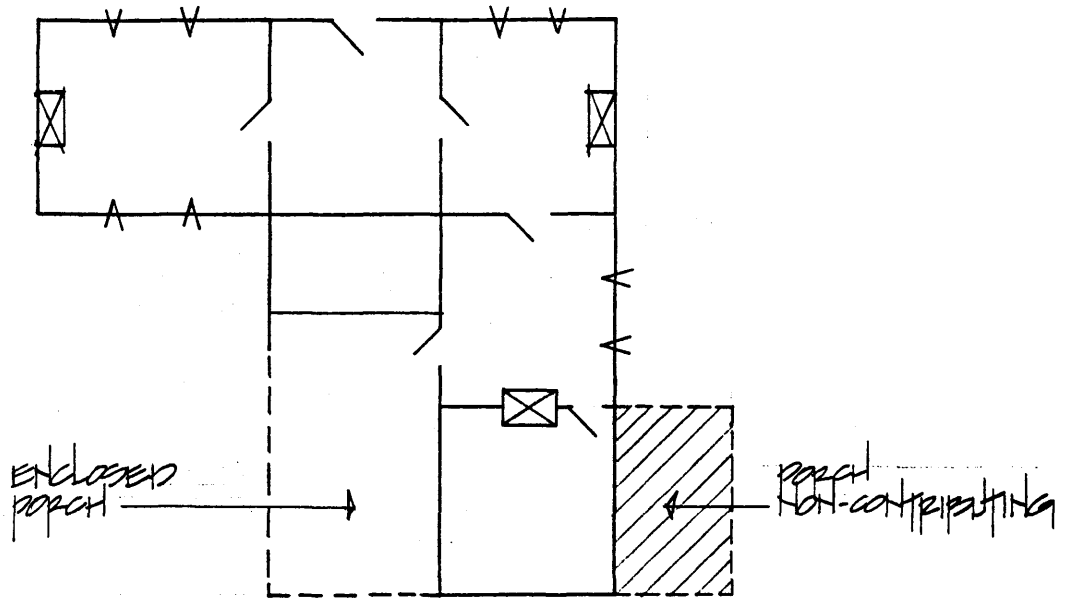

45. Description and House Plan:

See attached.

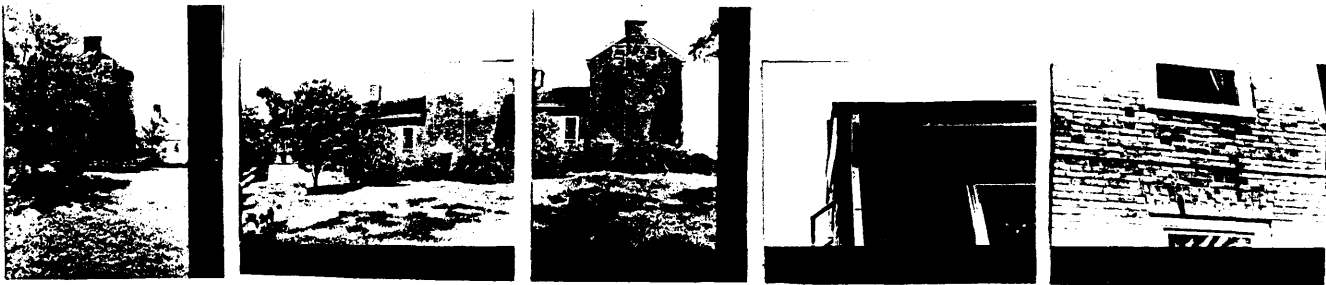

## Chenault House

## 14. History (cont.)

Mr. and Mrs. George Burnam and Caperton Burnam.

## 45. Description

The Chenault House is a two-story, five-bay brick structure. The front facade has Flemish bond and a three-row belt course between the first and second stories. A molded wooden cornice is located at the eaves. The brick bond on the side facades is five-course common bond. The first floor is raised on a stone foundation. Basement vents with varmit bars were originally visible in the front facade but were closed during remodelling in 1976. The central doorway was modified from an arched opening to a shouldered architrave in the mid-nineteenth century. The doorway itself has three-light sidelights and a large four-light transom. The windows have the original reeded window surrounds, but the glazing has been changed to one over one. There are stretcher-header jack arches over the windows. The original window sills have been replaced by molded concrete ones which are relatively unobtrusive by virtue of their color and detailing. The original floor plan features a central hall flanked on either side by a single room, each with an interior end chimney. An original brick one-and-a-half story ell extends to the rear. A porch on the north side of the ell has been enclosed with aluminum siding. Another screened porch has been added to the south side of the ell.

KENTUCKY HISTORIC RESOURCE INVENTORY SUPPLEMENT  
BOUNDARY AND LOCATION INFORMATION

Historic Property Name Chenault House Site # MA-234  
Multiple Resource/Thematic Nomination Title MULTIPLE RESOURCES OF MADISON  
COUNTY, KENTUCKY

U.T.M. Coordinates - List multiple UTMs if property is ten or more acres.

A. \_\_\_\_\_ D. \_\_\_\_\_  
B. \_\_\_\_\_ E. \_\_\_\_\_  
C. \_\_\_\_\_ F. \_\_\_\_\_

Verbal Boundary Description \_\_\_\_\_ Acreage 5.13

Starting at a point 600 feet east of the south corner of the house, then 100 feet south to a point; then 860 feet west to a point; then north 260 feet to a point; then 860 feet east to a point; then 150 feet south to the point of beginning.

Sketch of Site Plan (Showing outbuildings, structures, landscape features and the site boundary as described above.)

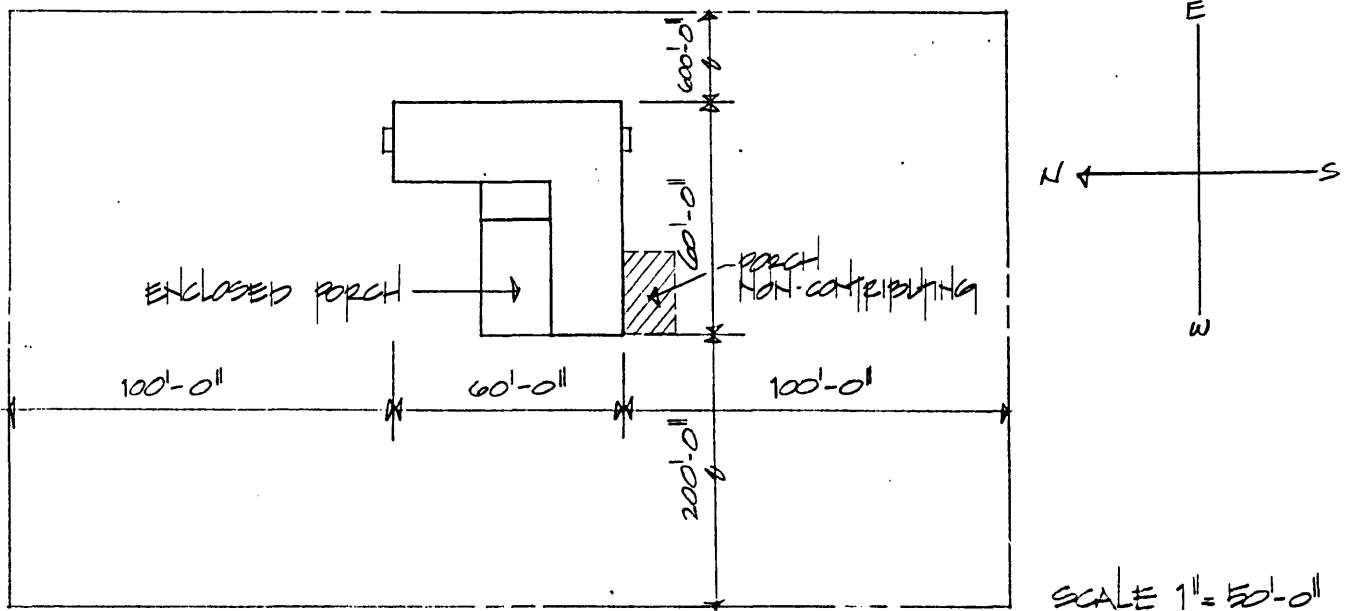

Official Courthouse Property Reference:

Page 5 of 5  
Ma-234  
Chenault House

**Statement of Significance**

The Chenault House is significant under criterion C for the period 1840 to 1870 as an example of how Madison County houses were updated by the enframing of the Federal entrance with an entablature to reflect the increasing popularity of the Greek Revival style.

**Verbal Boundary Justification**

The boundary was chosen arbitrarily to provide a minimal setting for the house.

The boundary contains one contributing building.