

1154

United States Department of the Interior
National Park Service

RECEIVED

OCT 01 1993

NATIONAL REGISTER

National Register of Historic Places
Registration Form

This form is for use in nominating or requesting determinations for individual properties and districts. See instructions in *How to Complete the National Register of Historic Places Registration Form* (National Register Bulletin 16A). Complete each item by marking "x" in the appropriate box or by entering the information requested. If an item does not apply to the property being documented, enter "N/A" for "not applicable." For functions, architectural classification, materials, and areas of significance, enter only categories and subcategories from the instructions. Place additional entries and narrative items on continuation sheets (NPS Form 10-900a). Use a typewriter, word processor, or computer, to complete all items.

1. Name of Property

historic name Columbia County High School

other names/site number Columbia County Junior High School/8CO494

2. Location

street & number 528 West Duval Street n/a not for publication

city or town Lake City n/a vicinity

state Florida code FL county Columbia code 023 zip code 32056

3. State/Federal Agency Certification

As the designated authority under the National Historic Preservation Act, as amended, I hereby certify that this nomination request for determination of eligibility meets the documentation standards for registering properties in the National Register of Historic Places and meets the procedural and professional requirements set forth in 36 CFR Part 60. In my opinion, the property meets does not meet the National Register criteria. I recommend that this property be considered significant nationally statewide locally. (See continuation sheet for additional comments.)

Suzanne P. Walker / Deputy SHPO 9/22/93
Signature of certifying official/Title Date

Florida State Historic Preservation Officer, Division of Historical Resources
State of Federal agency and bureau

In my opinion, the property meets does not meet the National Register criteria. (See continuation sheet for additional comments.)

Signature of certifying official/Title Date

State or Federal agency and bureau

4. National Park Service Certification

I hereby certify that the property is:

- entered in the National Register. See continuation sheet.
- determined eligible for the National Register See continuation sheet.
- determined not eligible for the National Register.
- removed from the National Register.
- other, (explain:)

Signature of the Keeper

Date of Action

Mal M. [Signature]

11/15/93

Columbia Co. High School
Name of Property

Columbia Co., FL
County and State

5. Classification

Ownership of Property
(Check as many boxes as apply)

- private
- public-local
- public-State
- public-Federal

Category of Property
(Check only one box)

- building(s)
- district
- site
- structure
- object

Number of Resources within Property
(Do not include previously listed resources in the count.)

Contributing	Noncontributing	
1	0	buildings
0	0	sites
0	0	structures
0	0	objects
1	0	Total

Name of related multiple property listing
(Enter "N/A" if property is not part of a multiple property listing.)

Historic Resources of Lake City, FL

Number of contributing resources previously listed in the National Register

0

6. Function or Use

Historic Functions
(Enter categories from instructions)

Education: School

Current Functions
(Enter categories from instructions)

Work in progress

7. Description

Architectural Classification
(Enter categories from instructions)

Other: Masonry Vernacular

Materials
(Enter categories from instructions)

foundation Brick
walls Brick
roof Asphalt
other Stucco

Narrative Description

(Describe the historic and current condition of the property on one or more continuation sheets.)

8. Statement of Significance

Applicable National Register Criteria

(Mark "x" in one or more boxes for the criteria qualifying the property for National Register listing.)

- A** Property is associated with events that have made a significant contribution to the broad patterns of our history.
- B** Property is associated with the lives of persons significant in our past.
- C** Property embodies the distinctive characteristics of a type, period, or method of construction or represents the work of a master, or possesses high artistic values, or represents a significant and distinguishable entity whose components lack individual distinction.
- D** Property has yielded, or is likely to yield, information important in prehistory or history.

Criteria Considerations

(Mark "x" in all the boxes that apply.)

Property is:

- A** owned by a religious institution or used for religious purposes.
- B** removed from its original location.
- C** a birthplace or grave.
- D** a cemetery.
- E** a reconstructed building, object, or structure.
- F** a commemorative property.
- G** less than 50 years of age or achieved significance within the past 50 years.

Areas of Significance

(Enter categories from instructions)

Education

Period of Significance

1921-1940

Significant Dates

1921

1926

Significant Person

(Complete if Criterion B is marked above)

n/a

Cultural Affiliation

n/a

Architect/Builder

Unknown/Spooner & Cauthon, contractors

Narrative Statement of Significance

(Explain the significance of the property on one or more continuation sheets.)

9. Major Bibliographical References

Bibliography

(Cite the books, articles, and other sources used in preparing this form on one or more continuation sheets.)

Previous documentation on file (NPS):

- preliminary determination of individual listing (36 CFR 67) has been requested
- previously listed in the National Register
- previously determined eligible by the National Register
- designated a National Historic Landmark
- recorded by Historic American Buildings Survey # _____
- recorded by Historic American Engineering Record # _____

Primary location of additional data:

- State Historic Preservation Office
- Other State agency
- Federal agency
- Local government
- University
- Other

Name of repository:

Columbia Co., High School
Name of Property

Columbia Co., FL
County and State

10. Geographical Data

Acreeage of Property Less than 1 acre

UTM References

(Place additional UTM references on a continuation sheet.)

A 1

1	7
---	---

3	4	2	0	4	0
---	---	---	---	---	---

3	3	4	0	6	7	0
---	---	---	---	---	---	---

Zone

Easting

Northing

2

3

Zone

Easting

Northing

4

See continuation sheet

Verbal Boundary Description

(Describe the boundaries of the property on a continuation sheet.)

Boundary Justification

(Explain why the boundaries were selected on a continuation sheet.)

11. Form Prepared By

name/title Stephen Olauson/consultant & Barbara E. Mattick, Historic Sites Specialist

organization Bureau of Historic Preservation date September 1993

street & number R.A. Gray Bldg., 500 S. Bronough Street telephone (904) 487-2333

city or town Tallahassee state Florida zip code 32399-0250

Additional Documentation

Submit the following items with the completed form:

Continuation Sheets

Maps

A **USGS map** (7.5 or 15 minute series) indicating the property's location.

A **Sketch map** for historic districts and properties having large acreage or numerous resources.

Photographs

Representative **black and white photographs** of the property.

Additional items

(Check with the SHPO or FPO for any additional items)

Property Owner

(Complete this item at the request of SHPO or FPO.)

name Columbia County School System

street & number P.O. Box 1148 telephone _____

city or town Lake City state Florida zip code 32056

Paperwork Reduction Act Statement: This information is being collected for applications to the National Register of Historic Places to nominate properties for listing or determine eligibility for listing, to list properties, and to amend existing listings. Response to this request is required to obtain a benefit in accordance with the National Historic Preservation Act, as amended (16 U.S.C. 470 *et seq.*).

Estimated Burden Statement: Public reporting burden for this form is estimated to average 18.1 hours per response including time for reviewing instructions, gathering and maintaining data, and completing and reviewing the form. Direct comments regarding this burden estimate or any aspect of this form to the Chief, Administrative Services Division, National Park Service, P.O. Box 37127, Washington, DC 20013-7127; and the Office of Management and Budget, Paperwork Reductions Projects (1024-0018), Washington, DC 20503.

**United States Department of the Interior
National Park Service**

**National Register of Historic Places
Continuation Sheet**

Columbia County High School,
Lake City, Columbia Co., FL

Section number 7 Page 1

SUMMARY

Columbia County High School is a two-story educational building located at 528 West Duval Street in Lake City, Columbia County, Florida. The high school, a Masonry Vernacular building with some features typical of the Italian Renaissance style, was constructed in two stages between 1921 and 1926. It contributes to the Historic Resources of Lake City, Florida multiple property group under property type F.3, Historic Public, Social, and Religious Buildings of Lake City, 1886-1940.

SETTING

The Columbia County High School building is located in the northeast corner of a large tract of land five blocks west of Lake City's historic downtown commercial area. Until recently, the six-city-block area served as the site of Columbia County's main educational complex. Originally, the high school occupied a single block of land bounded by West Duval, South 3rd, West Nassau, and South 4th streets. It was surrounded by residential areas on the north, east, and south, and the Lake City Public School on the west. The present configuration of the campus was created during the mid-1920s when the areas of West Nassau and South 4th streets immediately adjacent to the high school property were closed. Since World War II the areas to the north and east of the high school have been developed for commercial purposes. The historic public school buildings to the west of the high school were razed and new educational facilities have replaced them.

PHYSICAL DESCRIPTION

Columbia County High School is a two-story, Masonry Vernacular building that exhibits some elements of the Italian Renaissance style. It was constructed in two phases during the 1920s. The original part of the school, completed in 1921, is a rectangular building with a masonry structural system, measuring 192 feet in width and seventy-five feet in depth. It has a low-pitched, side gabled roof with returns and decorative modillions, which project from under the eaves. The additions to the school were constructed in 1926 and consist of two two-story classroom wings attached to the east and west corners of the south elevation, and an auditorium, that runs between the two additions. The additions were constructed with steel frame

**United States Department of the Interior
National Park Service****National Register of Historic Places
Continuation Sheet**Columbia County High School,
Lake City, Columbia Co., FLSection number 7 Page 2

structural systems and have full basements. The exterior fabric for the entire structure is red brick. The roof is covered with asphalt shingles.

The main (north) elevation of the building possesses overall symmetry and radiates around a central, inset entrance that is decorated with a white stucco arcade crowned with a balustrade (photo 1). Its round arch openings are separated by Doric pilasters. The central opening leads to a main double-door entrance, which is flanked by single doors. The walls of the facade are pierced with numerous single and paired double-hung sash windows with 8/8 lights. A decorative stringcourse runs beneath the second story windows.

The east and west sides of the school mirror each other and consist of the gable end of the original school and a side of the rear gabled additions (photos 2 and 3). The main architectural features of the gable ends are round window vents and two-story, one-bay hip roofed extensions. The extensions house stairwells and side entrances to the building. The entrances are recessed and have decorative white stucco pilaster and ball finial surrounds (photo 4). Paired double-hung sash windows with 8/8 lights flank the extensions. The classroom wings consist of three bays. The northernmost bay features single double-hung sash windows in the first and second stories and a sunken entrance that leads to the basement classrooms. The two southern bays have double-hung sash windows set in groups of four on the first and second story, and awning windows that provide light for the basement rooms.

The rear (south) elevation consists of the auditorium and flanking gable ends of the two class-room additions (photo 5). The gable end walls are pierced with double-hung sash windows and a central entrance. The auditorium features an arched roof and a five-bay facade. The bays are divided by brick buttresses with masonry caps. Each bay contains paired double-hung sash windows with 6/6 lights crowned by four-light transoms in the second story. The ground story of center bay has a round arch double-door entrance flanked by single double-hung sash windows with 1/1 lights. The first story of the remaining bays originally contained two double-hung sash windows with 3/3 lights. Several of those window openings have been enclosed with brick.

**United States Department of the Interior
National Park Service**

**National Register of Historic Places
Continuation Sheet**

Columbia County High School,
Lake City, Columbia Co., FL

Section number 7 Page 3

Interior

The main entrance to the first floor leads to a wide foyer that is flanked by the principal's and guidance offices. An east/west running hallway is located in the center of the original part of the school and terminates at the stairwells that lead to the second floor and side entrances (photos 6 and 7). The classrooms throughout the original building and the two-story wings are spacious and well lit by the many windows (photo 8). Directly opposite the foyer is the hall through which the auditorium is accessed (photo 9). Each of the two rear classroom additions has a north/south hallway. The basement and second floor are reached by stairwells located at the southern end of each hall in the additions. The first floor of the west addition contains the school library (photo 10). The east addition is divided into three classrooms. The auditorium is a large open space with a balcony that overlooks a large stage (photos 11 and 12). The stage was also used as the school gym and contains a basketball court.

The hallway system of the second floor is similar to that of the ground level (photo 13). All of the rooms of the second level, with the exception of two bathrooms, were used as classrooms. The balcony of the auditorium is reached through a hallway that runs between the two rear classroom additions (photo 14).

The basement of the school, located under the two classroom additions and the auditorium, contains rooms that were used for shop and home economics classes (photo 15). Several additional classrooms are located below the floor of the auditorium.

Alterations

There have been no significant alterations to the original exterior appearance of the school. The lower sash of many of the classroom windows were fitted with air conditioning units in the 1970s. Most of those units have since been removed, but their wood frames remain. The interior of the building is presently undergoing renovation, and some of the original plaster ceilings have been removed. The interior spaces, however, remain intact, and overall the building retains a high degree of its original architectural integrity.

**United States Department of the Interior
National Park Service**

**National Register of Historic Places
Continuation Sheet**

**Columbia County High School,
Lake City, Columbia Co., FL**

Section number 8 Page 1

SUMMARY

Columbia County High School is locally significant under **Criterion A** in the area of **Education** as Lake City's only surviving historic educational building. It contributes to the **Historic Resources of Lake City, Florida** multiple property group under property type **F.3, Historic Public, Social and Religious Buildings of Lake City, 1886-1940** and historic context **III, Boom, Bust, and the Great Depression, 1919-1941**.

HISTORIC CONTEXT

The development of advanced educational facilities is one of the prevailing themes of Lake City's history. In 1883, due to its central location and an intensive lobbying campaign undertaken by a number of prominent local citizens, the city was chosen by the Florida Legislature as the site of the first Florida State Agricultural College, which later was renamed the University of Florida. When that facility was moved to Gainesville during a consolidation of the state college system in 1905, the University buildings were sold to the Florida Baptist Convention, which established Columbia College at the site in 1907. In 1917 Columbia College merged with Stetson University and was moved to DeLand. Several other schools and colleges were also formed in Lake City during the period, including Saint James Female College (established 1882) and Lake-side College (established 1888).

The first public school facility for white children of Columbia County was established in the mid-1850s when the town was still known as Alligator. In 1868, after Emancipation, the school system was reorganized to provide facilities for Blacks, and the Columbia County Board of Instruction, the forerunner of the present County Board of Education, was formed. The original schoolhouse for whites was located on West St. Johns Street in a building owned by Columbia Lodge 27, Free and Accepted Masons of Lake City. In 1893 the Board of Instruction purchased the site where the high school now stands and constructed a wood frame schoolhouse. A separate two-story brick high school building was constructed on the site between 1906 and 1912. In the immediate post-World War I period Lake City experienced a significant increase in population that taxed the existing public school facilities.

**United States Department of the Interior
National Park Service**

**National Register of Historic Places
Continuation Sheet**

Columbia County High School,
Lake City, Columbia Co., FL

Section number 8 Page 2

HISTORIC SIGNIFICANCE

In response to the overcrowding, the city council purchased a one and one-half acre site east of the old school property in October 1920. Funds for the \$6,500 site and the proposed school building were raised through the sale of the former Columbia College property to the Federal Government for use as a Veterans Administration Hospital. In February 1921, Spooner & Cauthon, a contracting firm from Tifton, Georgia, was hired to construct the new \$60,000 facility.

Finished in time for the opening of the 1921 school year, the school represented modern educational concepts concerning the creation of a healthy and functional learning environment. The 192 x 75 foot building featured central steam heating and indoor plumbing, which included five bathrooms and two continuously flowing drinking fountains. The first floor had a total of eight well-lit and ventilated classrooms, each measuring 23 x 30 feet, a principal's office, and teacher's study room. The second floor consisted of six 23 x 30 foot classrooms, a 34 x 60 foot study room, three 18 x 23 foot recitation rooms, two 16 x 23 foot chemistry rooms, a 14 x 23 foot library, and a 23 x 26 foot lecture room.

The continued growth of the city's population base during the land boom years of the mid-1920s necessitated the further expansion of the school facilities. In 1926 two two-story wings and a large auditorium were added to the rear of the building. The additions were constructed with full basements to create additional space for vocational studies, such as home economics and shop classes. The auditorium featured a sloped seating area and a balcony that overlooked a large stage that doubled as a gymnasium. Locker rooms were located below the stage in the basement.

The building remained in use as Columbia County's main high school until 1959, when a new facility was constructed in the eastern part of the city. It later served as the Lake City Junior High School. During the late 1970s and early 1980s, the building was used for a variety of purposes by the Columbia County School Board until it was closed in 1989. The building is presently undergoing restoration to its original 1920s appearance.

**United States Department of the Interior
National Park Service**

**National Register of Historic Places
Continuation Sheet**

Columbia County High School,
Lake City, Columbia Co., FL

Section number 8 Page 3

The development of educational facilities is an important aspect of the history of Lake City, which served as the site of several colleges, including the original University of Florida, and had one of the state's earliest organized public school systems. The construction of the Columbia County High School was a response to the large population influx the city experienced during the land boom years of the 1920s. During the remaining years of the historic period, the building served as the county's main high school. It stands today as the only surviving building associated with Lake City's long history of educational development.

United States Department of the Interior
National Park Service

**National Register of Historic Places
Continuation Sheet**

Columbia County High School,
Lake City, Columbia Co., FL

Section number 9 Page 1

MAJOR BIBLIOGRAPHICAL REFERENCES

Lake City Historical Committee. Century in the Sun, Lake City, Florida 1859-1959. Lake City: Lake City Chamber of Commerce, 1959.

Lake City Reporter (newspaper), October 22, 1920 and February 18, 1921.

McAlester, Virginia, and Lee McAlester. A Field Guide to American Houses. New York: Alfred Knopf, 1984.

Maddex, Diane, ed. Built in the U.S.A., American Buildings from Airports to Zoos. Washington, D.C.: National Trust For Historic Preservation, 1985.

Olausen, Stephen A., "Cultural Resource Survey of Lake City, Florida," Report. Historic Property Associates, St. Augustine, 1990.

Sanborn Fire Insurance Map Company. Fire Insurance Map of Lake City, Columbia County, Florida. New York, 1902, 1906, 1912, 1924, 1930.

**United States Department of the Interior
National Park Service**

**National Register of Historic Places
Continuation Sheet**

Columbia County High School,
Lake City, Columbia Co., FL

Section number 10 Page 1

VERBAL BOUNDARY DESCRIPTION

The boundary begins at a point on the southwest corner of the intersection of West Duval and South 3rd streets, then runs west 300 feet, then south 265 feet, then east 300 feet, then north 265 feet to the point of beginning.

BOUNDARY JUSTIFICATION

The boundary was drawn to encompass the Columbia County High School building and the property surrounding it that remains unaltered from its historic appearance. Part of the original lot upon which the building is located was excluded due to the addition of non-contributing elements. The property to the rear of the building has been altered by the construction of a modern asphalt basketball court and School Board Administration building.

**United States Department of the Interior
National Park Service**

**National Register of Historic Places
Continuation Sheet**

Photos 1 Columbia County High School
Section number _____ Page _____
Lake City, Columbia Co., FL

- 1) 1. Columbia County High School, 528 West Duval Street
2. Lake City, Columbia County, Florida
3. Stephen A. Olausen
4. November 5, 1992
5. Historic Property Associates, Inc., P.O. Box 1002,
St. Augustine Florida 32085-1002
6. View of north facade, facing south
7. 1 of 15

Numbers 1-5 are the same for the remainder of the photographs

- 2) 6. View of east side, facing west
7. 2 of 15
- 3) 6. View of west side, southeast
7. 3 of 15
- 4) 6. Detail view of east side entrance, facing west
7. 4 of 15
- 5) 6. View south elevation, facing north
7. 5 of 15
- 6) 6. Interior view of first floor, main east/west running
hallway, facing west
7. 6 of 15
- 7) 6. Interior view of first floor northeast corner
stairwell, facing northeast
7. 7 of 15
- 8) 6. Interior view of first floor southeast corner
classroom, facing southeast
7. 8 of 15
- 9) 6. Interior view of first floor hallway leading to the
auditorium, facing south
7. 9 of 15
- 10) 6. Interior view of first floor library, facing
northwest
7. 10 of 15

**United States Department of the Interior
National Park Service**

**National Register of Historic Places
Continuation Sheet**

Photos

2

**Columbia County High School
Lake City, Columbia Co., FL**

Section number _____ Page _____

- 11) 6. Interior view of the auditorium stage/basketball court, facing south
7. 11 of 15
- 12) 6. Interior view of the auditorium balcony taken from the stage, facing north
7. 12 of 15
- 13) 6. Interior view of second floor hall, facing east
7. 13 of 15
- 14) 6. Interior view of the second story balcony hall, facing east
7. 14 of 15
- 15) 6. Interior of basement shop classroom, facing southeast
7. 15 of 15

Columbia County High School
528 W. Duval Street
Lake City, Florida

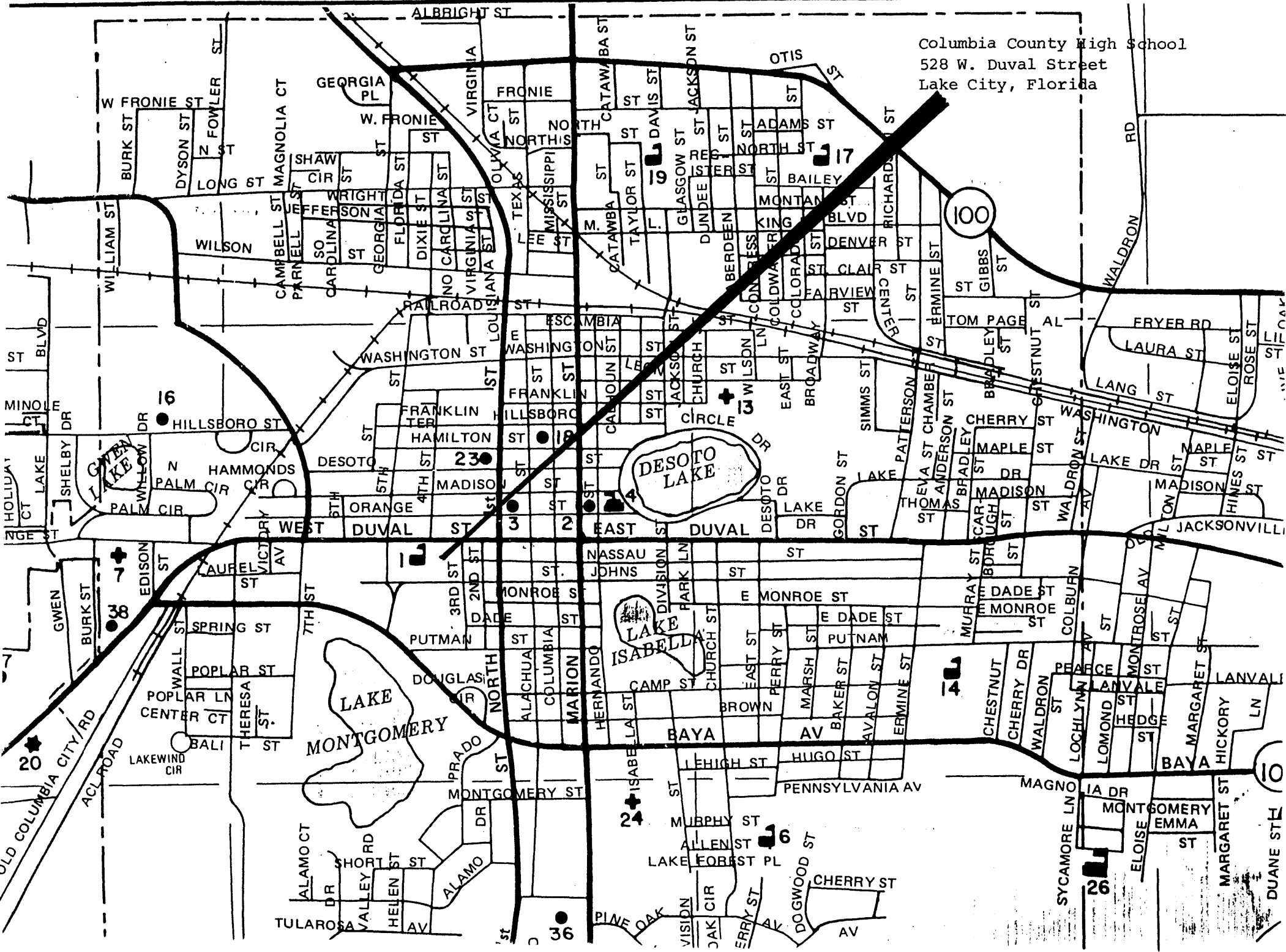

16

20

23

24

26

36

100

LAKE MONTGOMERY

DESOTO LAKE

LAKE ISABELLA

10

LAKE CITY HIGH SCHOOL SITE PLAN

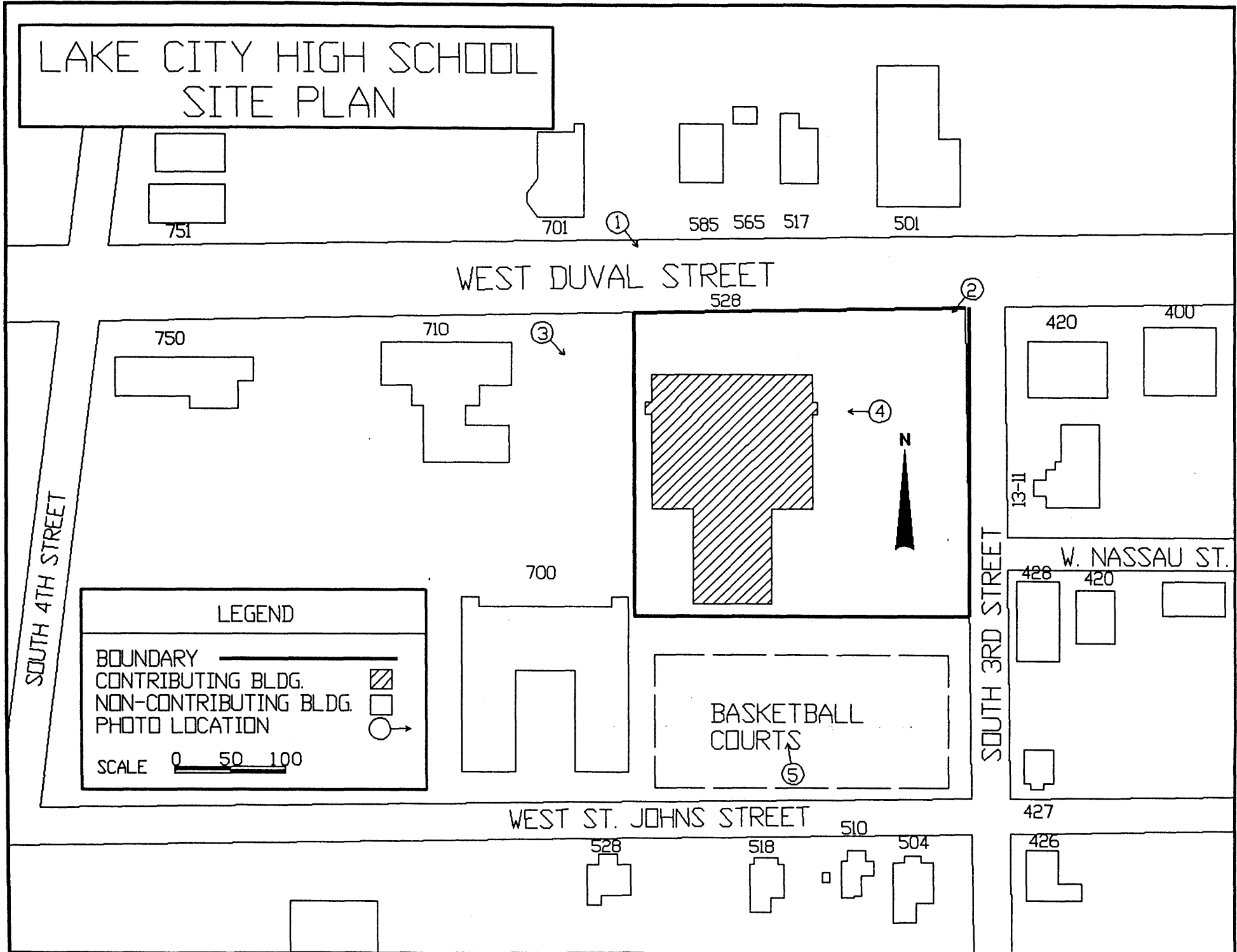

COLUMBIA COUNTY HIGH SCHOOL BASEMENT FLOOR PLAN

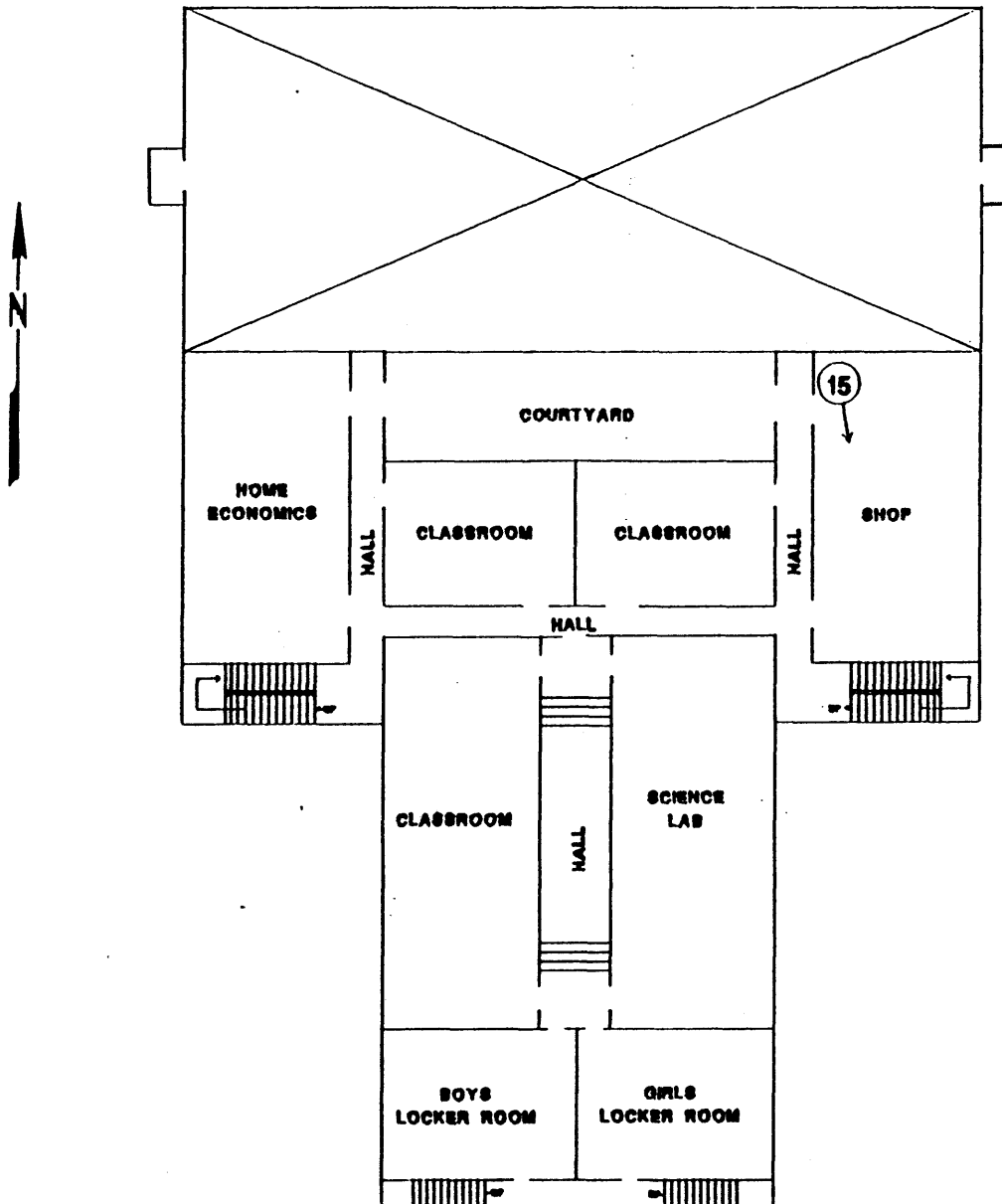

PHOTO LOCATION = ○ →

COLUMBIA COUNTY HIGH SCHOOL FIRST FLOOR PLAN

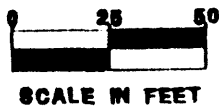
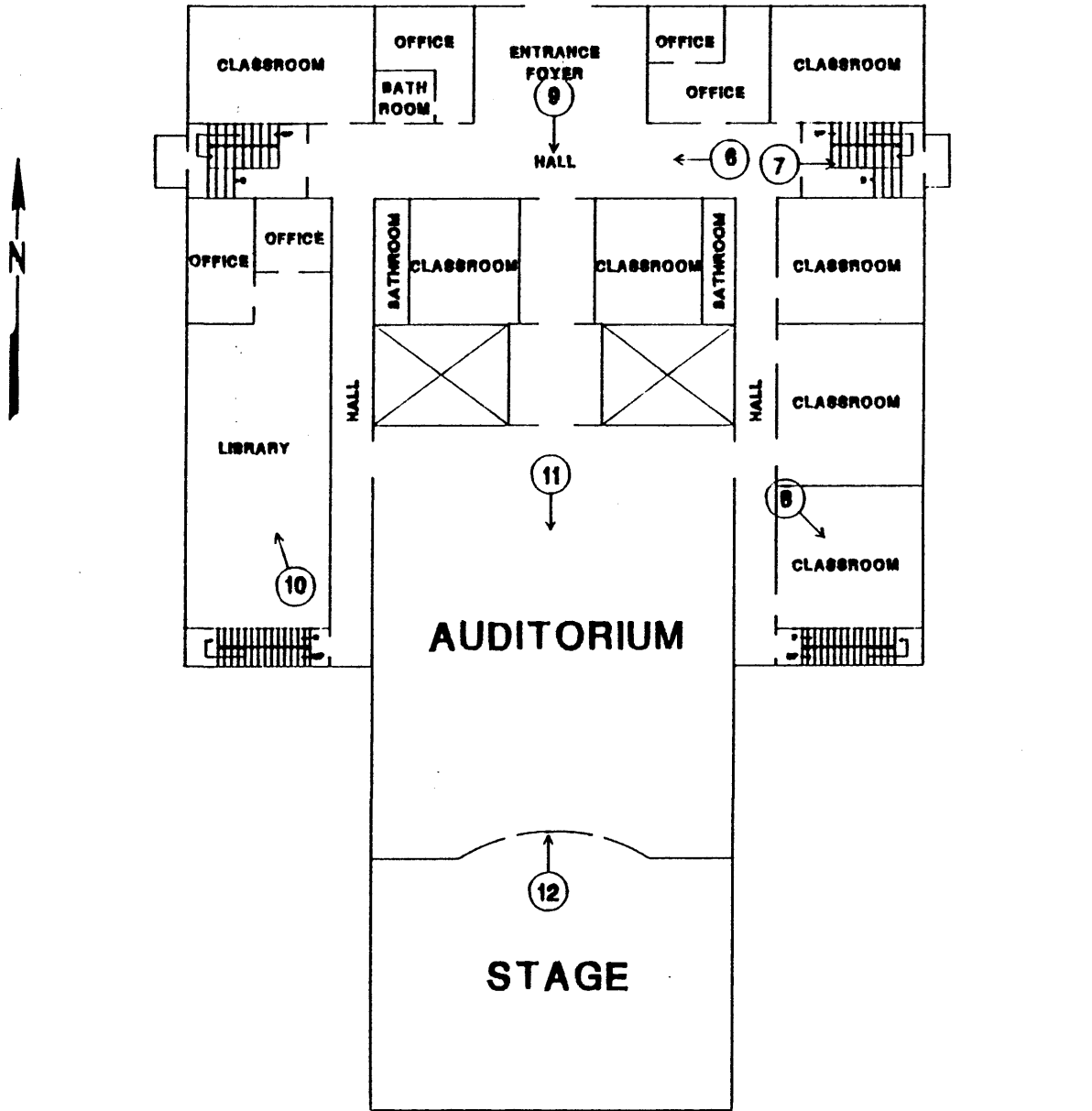

PHOTO LOCATION = ○ →

COLUMBIA COUNTY HIGH SCHOOL SECOND FLOOR PLAN

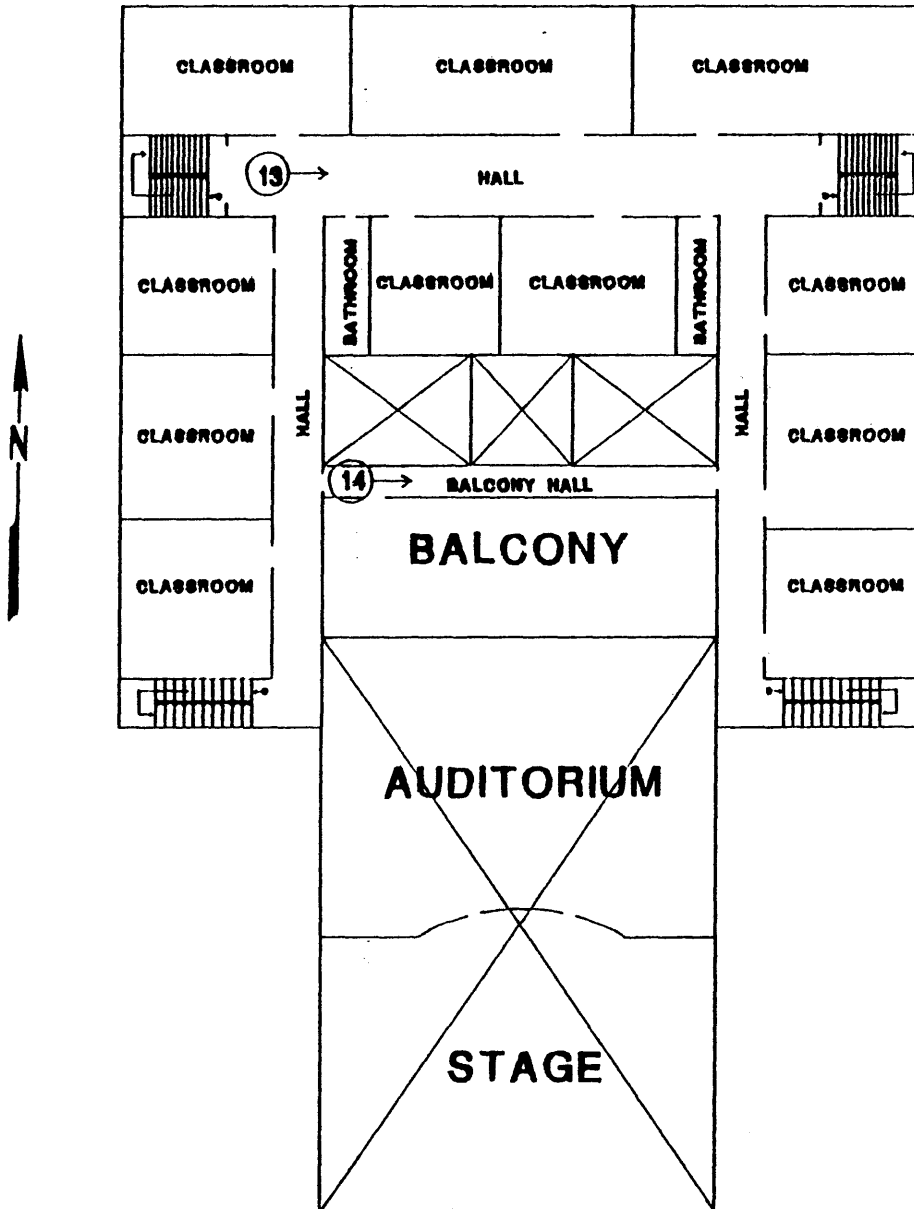

PHOTO LOCATION = ○ →