

3051

UNITED STATES DEPARTMENT OF THE INTERIOR  
NATIONAL PARK SERVICE

**NATIONAL REGISTER OF HISTORIC PLACES  
INVENTORY -- NOMINATION FORM**

FOR FEDERAL PROPERTIES

**FOR NPS USE ONLY**  
RECEIVED **NOV 22 1988**  
DATE ENTERED

SEE INSTRUCTIONS IN *HOW TO COMPLETE NATIONAL REGISTER FORMS*  
TYPE ALL ENTRIES -- COMPLETE APPLICABLE SECTIONS

**1 NAME**

HISTORIC Marine Reservation Historic District

AND/OR COMMON

**2 LOCATION**

STREET & NUMBER See individual inventory forms

CITY, TOWN

Bremerton

— VICINITY OF

— NOT FOR PUBLICATION  
CONGRESSIONAL DISTRICT

STATE

Washington

CODE

COUNTY  
Kitsap

CODE

**3 CLASSIFICATION**

CATEGORY	OWNERSHIP	STATUS	PRESENT USE	
<input checked="" type="checkbox"/> DISTRICT	<input checked="" type="checkbox"/> PUBLIC	<input checked="" type="checkbox"/> OCCUPIED	<input type="checkbox"/> AGRICULTURE	<input type="checkbox"/> MUSEUM
<input type="checkbox"/> BUILDING(S)	<input type="checkbox"/> PRIVATE	<input type="checkbox"/> UNOCCUPIED	<input type="checkbox"/> COMMERCIAL	<input type="checkbox"/> PARK
<input type="checkbox"/> STRUCTURE	<input type="checkbox"/> BOTH	<input type="checkbox"/> WORK IN PROGRESS	<input type="checkbox"/> EDUCATIONAL	<input type="checkbox"/> PRIVATE RESIDENCE
<input type="checkbox"/> SITE	<b>PUBLIC ACQUISITION</b>	<b>ACCESSIBLE</b>	<input type="checkbox"/> ENTERTAINMENT	<input type="checkbox"/> RELIGIOUS
<input type="checkbox"/> OBJECT	<input type="checkbox"/> IN PROCESS	<input checked="" type="checkbox"/> YES: RESTRICTED	<input type="checkbox"/> GOVERNMENT	<input type="checkbox"/> SCIENTIFIC
Thematic Group	<input type="checkbox"/> BEING CONSIDERED	<input type="checkbox"/> YES: UNRESTRICTED	<input type="checkbox"/> INDUSTRIAL	<input type="checkbox"/> TRANSPORTATION
	N/A	<input type="checkbox"/> NO	<input checked="" type="checkbox"/> MILITARY	<input type="checkbox"/> OTHER:

**4 AGENCY** Department of Defense/United States Navy

REGIONAL HEADQUARTERS: (If applicable) Puget Sound Naval Shipyard

STREET & NUMBER N/A

CITY, TOWN

Bremerton

— VICINITY OF

STATE  
Washington 98314

**5 LOCATION OF LEGAL DESCRIPTION**

COURTHOUSE,  
REGISTRY OF DEEDS, ETC. Kitsap County Courthouse

STREET & NUMBER  
614 Division Street

CITY, TOWN

Port Orchard

STATE  
Washington 98366

**6 REPRESENTATION IN EXISTING SURVEYS**

TITLE Historic Survey of Puget Sound Naval Shipyard

DATE

April, 1986

FEDERAL  STATE  COUNTY  LOCAL

DEPOSITORY FOR  
SURVEY RECORDS Puget Sound Naval Shipyard

CITY, TOWN

Bremerton

STATE  
Washington 98314

## 7 DESCRIPTION

CONDITION		CHECK ONE	CHECK ONE
<input checked="" type="checkbox"/> EXCELLENT	<input type="checkbox"/> DETERIORATED	<input checked="" type="checkbox"/> UNALTERED	<input checked="" type="checkbox"/> ORIGINAL SITE
<input checked="" type="checkbox"/> GOOD	<input type="checkbox"/> RUINS	<input checked="" type="checkbox"/> ALTERED	<input type="checkbox"/> MOVED DATE _____
<input type="checkbox"/> FAIR	<input type="checkbox"/> UNEXPOSED		

---

### DESCRIBE THE PRESENT AND ORIGINAL (IF KNOWN) PHYSICAL APPEARANCE

The Marine Reservation Historic District is located in the northwesterly section of the Puget Sound Naval Shipyard west of the Hospital Reservation Historic District. The facility was established in this location in 1911. At its period of maximum historical development, prior to World War II, the district contained the four properties included in this nomination and a barracks building which has been demolished. This latter building was a three and one half story brick structure with architectural influences similar to the remaining officers quarters. All the original Marine Reservation buildings faced the Marine parade ground, an open space located to the south and west. It has been retained as an undeveloped parcel, and is now used as a playfield.

The district consists of four quarters buildings of brick construction with Colonial Revival influences. These two story buildings utilize Georgian Colonial details, a style found along the eastern seaboard between the 1820's and 1840's. Quarters M-1, M-2 and M-3 were designed by Washington, D.C. architect J.H. DeDibour, in 1910. The buildings in the district are sited on a man-made ledge or bench cut into the shallow hillside. Each building has front, side and rear yards of lawn, native plantings and garden areas. Apart from the garages, which were built in the 1930's, there is no construction within this district dating from 1914.

**8 SIGNIFICANCE**

PERIOD	AREAS OF SIGNIFICANCE -- CHECK AND JUSTIFY BELOW			
<input type="checkbox"/> PREHISTORIC	<input type="checkbox"/> ARCHEOLOGY-PREHISTORIC	<input type="checkbox"/> COMMUNITY PLANNING	<input type="checkbox"/> LANDSCAPE ARCHITECTURE	<input type="checkbox"/> RELIGION
<input type="checkbox"/> 1400-1499	<input type="checkbox"/> ARCHEOLOGY-HISTORIC	<input type="checkbox"/> CONSERVATION	<input type="checkbox"/> LAW	<input type="checkbox"/> SCIENCE
<input type="checkbox"/> 1500-1599	<input type="checkbox"/> AGRICULTURE	<input type="checkbox"/> ECONOMICS	<input type="checkbox"/> LITERATURE	<input type="checkbox"/> SCULPTURE
<input type="checkbox"/> 1600-1699	<input type="checkbox"/> ARCHITECTURE	<input type="checkbox"/> EDUCATION	<input checked="" type="checkbox"/> MILITARY	<input type="checkbox"/> SOCIAL/HUMANITARIAN
<input type="checkbox"/> 1700-1799	<input type="checkbox"/> ART	<input type="checkbox"/> ENGINEERING	<input type="checkbox"/> MUSIC	<input type="checkbox"/> THEATER
<input type="checkbox"/> 1800-1899	<input type="checkbox"/> COMMERCE	<input type="checkbox"/> EXPLORATION/SETTLEMENT	<input type="checkbox"/> PHILOSOPHY	<input type="checkbox"/> TRANSPORTATION
<input checked="" type="checkbox"/> 1900-	<input type="checkbox"/> COMMUNICATIONS	<input type="checkbox"/> INDUSTRY	<input type="checkbox"/> POLITICS/GOVERNMENT	<input type="checkbox"/> OTHER (SPECIFY)
		<input type="checkbox"/> INVENTION		

SPECIFIC DATES 1911-1914

BUILDER/ARCHITECT See individual forms

## STATEMENT OF SIGNIFICANCE

The Marine Reservation Historic District is significant because it contains all but one of the buildings representative of this function within the Puget Sound Naval Shipyard Shore Facility. Constructed between 1911 and 1914, the buildings in this district symbolize the role which the Marine Corps played as a security and training arm of the United States Navy, a function which began at the shipyard in 1896 and continued until 1977, when the function was moved to Subase Bangor.

One year after the Puget Sound Naval Shipyard was established its founding commandant, Lieutenant Ambrose B. Wyckoff, requested a Marine detachment to provide yard security. It was not until 1896, however, that First Sergeant George Carter, along with twenty Marines, were sent to Bremerton. The Marine Reservation was established on what is now the corner of the yard bounded by Chester Avenue and the alley south of Burwell Street. By 1899, an officers quarters and barracks building had been constructed. As early as 1901, the Marine Corps commandant was recommending the removal of the reservation to a more desirable location. He argued that

by reason of the addition of numerous buildings required for yard purposes, and in connection with the docking of large ships, the marine barracks is becoming more and more shut in, and that the location of the barracks has become undesirable, both for the comfort of the men and the difficulty of preserving proper discipline on account of the proximity of the barracks to saloons, etc., immediately outside the station. (Annual Report, 1901, p.1219)

The move was not authorized at this time. Instead, funds were allocated to add additional stories onto the barracks building.

Two events caused the Marine Reservation to be moved to its present location. The first was Executive Order 969 signed by President Theodore Roosevelt in 1908. This Order redefined the role which the Marine Corps was to play within the United States defense structure by expanding its duties beyond shore facility and shipboard security to defense activities outside the continental United States. The second was an expansion of the industrial area of the Puget Sound Naval Shipyard. The relocation of the Marine Reservation corresponded in time to the construction of Drydock No. 2 (1909-1913). This change in location was noted in the 1912 Annual Report (p.588).

In the act approved March 3, 1909, provision was made for a new barracks building and a contract entered into for its erection on May 29, 1911, at the contract price of \$135,428. This building was turned over to the Marine Corps by the contractor and accepted May 30, 1912, four months prior to the date specified in the contract. A large amount of grading and clearing has been found necessary owing to the fact that the plat of ground where the barracks is located was practically a wilderness. This work is being done as rapidly as the appropriations will permit. The old barracks building at this station is being turned over to

# 9 MAJOR BIBLIOGRAPHICAL REFERENCES

See thematic group nomination form.

## 10 GEOGRAPHICAL DATA Bremerton West Quadrangle The Scale is: 1:24000

ACREAGE OF NOMINATED PROPERTY 3.5 acres

UTM REFERENCES

A	1, 0	5, 2, 6, 6, 8, 4	5, 2, 6, 7, 6, 1, 8	B			
	ZONE	EASTING	NORTHING		ZONE	EASTING	NORTHING
C				D			

VERBAL BOUNDARY DESCRIPTION

The Marine Reservation Historic District is located to the west of the Hospital Reservation Historic District and is bounded by Dewey Street and Doyen Street. The properties are located within the following Puget Sound Naval Shipyard grid references: K 35, J 35 and I 35.

LIST ALL STATES AND COUNTIES FOR PROPERTIES OVERLAPPING STATE OR COUNTY BOUNDARIES

STATE	CODE	COUNTY	CODE
N/A			
STATE	CODE	COUNTY	CODE

## 11 FORM PREPARED BY

NAME/TITLE  
Caroline Gallacci and August Gene Grulich

ORGANIZATION	DATE
Grulich Architecture and Planning	September, 1986
STREET & NUMBER	TELEPHONE
707 Court A	(206) 272-0007
CITY OR TOWN	STATE
Tacoma	Washington 98402

## 12 CERTIFICATION OF NOMINATION

STATE HISTORIC PRESERVATION OFFICER RECOMMENDATION

YES  NO  NONE

STATE HISTORIC PRESERVATION OFFICER SIGNATURE

In compliance with Executive Order 11593, I hereby nominate this property to the National Register, certifying that the State Historic Preservation Officer has been allowed 90 days in which to present the nomination to the State Review Board and to evaluate its significance. The evaluated level of significance is  National  State  Local.

FEDERAL REPRESENTATIVE SIGNATURE F. S. STERNS F. S. STERNS

TITLE Director, Installations & Facilities, OASN(S&L) DATE 11-16-84

FOR NPS USE ONLY	
I HEREBY CERTIFY THAT THIS PROPERTY IS INCLUDED IN THE NATIONAL REGISTER	
<u>Antoinette Albee</u>	DATE 7/16/90
DIRECTOR, OFFICE OF ARCHEOLOGY AND HISTORIC PRESERVATION	
ATTEST:	DATE
<u>for</u> KEEPER OF THE NATIONAL REGISTER	



NAME OF STRUCTURE OFFICER'S QUARTERS & GARAGE 653

Construction Date 1911

Uses: Original Jr. Officer Quarters USMC

WWII Jr. Officer Quarters USMC

Present Officer's Quarters

Alterations/Additions

(Alt-54,57,62)

(Remod-54, basement, porch, chimney;

79, gen. repair)

DESIGNED BY J.H. De SIBOUR WASHINGTON D.C.

DATE 1910

DESCRIPTION: Condition Excellent Altered Yes Original Site Yes



Building 653, built in 1936, is a two car garage with gabled cedar shingle roof, asbestos shingle siding, fixed wood windows with 2 over 2 lights and a concrete slab. The doors are double sliding type.

Building 652, officer's quarters, is a rectangular, two story brick residence with attic. The red brick veneer building measures 46 feet by 38 feet with a small wooden porch at the entry of 18 feet by 14 feet. The brick is laid in a common bond with 6th course headers. The wooden porch is constructed with modified Tuscan columns supporting a flat roof. The building, constructed with Buildings 656 and 654, exhibits "Georgian" details in porch, doorway and window designs. Windows are flat arched brick with limestone keystone and sill. Windows are double-hung wood sash and frames with 6 over 1 lights. Chimney is corbelled brick. The roof is a mansard roof with composition shingles and hip roof dormers.

The interior of Building 652 (6-1) consists of oak floors on 1st and 2nd floors, fir floors on 3rd floor. Walls and ceilings are plaster on wood lath. Living room and dining room have fireplace with wood mantle and paneling over firebox opening. The entry contains open stairway to 2nd floor. Stair has painted wood tread and riser with turned spindles. Doors are 5 panelled. Kitchen and bath have vinyl flooring. Kitchen has unit cabinets and plastic laminate countertops. The den contains a small fireplace. The 3rd floor (attic) has fir floors, plaster walls and ceilings, a skylight in central stair area. The third floor bath has hexagonal floor tile, pull-chain toilet and claw foot tub.

The basement has concrete floor, brick walls, plaster partitions and a half bath.

SIGNIFICANCE: Period 1900- Area of Significance Military

1. X12. 13. 14.

Building 652 was built as the quarters for the Commanding Officer of the newly established Marine Reservation of 1910. Building 652 was constructed with Building 654 and 656 as Officers Quarters along with a large barracks (demolished), Building 169, as the major permanent structures of the Marine Reservation; The building was designed by architect J.H. De Sibour of Washington D.C. in a composition which reflects "Georgian/Federal" influences.

Building 652 was the primary quarters of the Marine Reservation flanked by Buildings 654 and 656, it overlooked a level area of the reservation known as the Parade Grounds. With the major role of the Marines redefined by Executive Order 969 the earlier shipyard Marine Reservation was dissolved and relocated to the larger area in the western area of the shipyard.

(cont'd on back)



Negative No.  
 SP 85-00992-652  
 SP86-01720-652-5



Acreage:  
 less than 1  
 Verbal Boundary  
 Description:  
 Between Doyen  
 St. and Dewey  
 St., between  
 Bldgs. 654 &  
 656.

Facility  
 No.  
 652/653

LOCATION :

PSNS  
 GRID  
 K 35

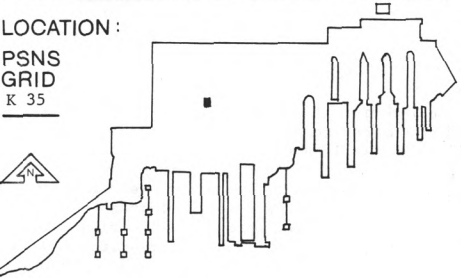

UTM Zone	Easting				Northing							
10	5	2	6	6	8	5	2	6	7	2	8	5
Quadrangle <u>Bremerton West</u>												
scale <u>1:24,000</u>												



**CONTINUATION of SIGNIFICANCE**

Building 652 was designed with "Georgian" details in a composition which reflects "Georgian/Federal" design influences. Similar to Buildings 654 and 656, Building 652 is constructed of brick exterior with a small entry porch with doubled columns, mansard roof and flat arched openings and reflects "Georgian/Federal" elements.

Building 652 served as Marine Commandant Quarters until the Marine Reservation was permanently removed from the shipyard. The building has maintained its prominent position overlooking the Parade Ground and now serves as Officer Quarters for the shipyard. The building is well maintained.

NAME OF STRUCTURE OFFICER'S QUARTERS & GARAGE 655

Construction Date 1911

Alterations/Additions

Uses: Original Jr. Officer Quarters USMC

(Remod-52;54,kit,liv,powder rm,wiring; 75,wiring;79,repairs.)

WWII Jr. Officer Quarters USMC

Present Officer's Quarters

DESIGNED BY J.H. De SIBOUR ARCHITECT WASHINGTON D.C.

DATE 1910

DESCRIPTION:

Condition Excellent Altered No Original Site Yes



Building 655 is a single car garage with gabled roof with cedar shingles, siding of asbestos shingles and a fiberglass garage door. The floor is a concrete slab. Building 655 was constructed in 1936.

Building 654, officer's quarters, is a rectangular, two story brick residence with attic. The red brick veneer over wood frame is laid in a common bond with 6th course headers. A projecting front porch measures the length of the front elevation. The building measures 46 feet by 38 feet with a porch of 46 feet by 18 feet. The porch is constructed with modified "Etruscan" columns supporting a flat roof with balustrade above. The building exhibits several "Georgian" details including the porch, flat brick arches with limestone keystone and sills and corbeled brick chimneys. The roof of the building is a mansard roof with composition shingles and hip roof dormers. Windows are wood double-hung in wood frames with 6 over 1 lights. dormer windows have been replaced with mill finish aluminum sliding windows. A continuous limestone band is formed by the window sills of the upper floor. At the rear of the residence there is a glazed-in porch contained within a balustrade of turned balusters.

The interior of 654 (M-2) consists of oak flooring on first and second floors, plaster on wood lath on walls and ceilings. Ceilings are 9 ft high. Entry foyer contains stairway to second floor with painted balustrade. Above stairway is a central skylight. French doors with 10 lights separate foyer from living room. The fireplace has a wood mantle with brick surround and tile hearth. The kitchen has painted cabinets with plastic laminate countertop. The 3rd floor (attic) has painted wood floors.

SIGNIFICANCE:

Period 1900-

Area of Significance Military

1. x 2. 3. 4.

Building 654 was constructed with Building 652 and 656 in 1911 when the second Marine Reservation was established. The design of Building 654 exhibits "Georgian" detail in a "Georgian/Federal" influenced composition. Its colonaded porch, brick exterior and hipped mansard roof are composed in a symmetrical composition. Building 654 and Building 656 are identical compositions while 652 exhibits minor alterations to the composition. Building 654 was designed by architect J. H. DeSibour of Washington D.C. for the United States Marine Corp.

Building 654 served as Officers Quarters for the Marine Reservation. Construction of 654 as well as 652, 656 and the Marine Barracks Building 169 reflected a major expansion of the Marine personnel at the shipyard. This expansion was in response to the expanded role of the Marines as defined by Executive Order 969 in November of 1908. (cont'd on back)





Negative No.  
 SP 85-00992-654  
 SP86-01720-654-5

Acreage:  
 less than 1  
 Verbal Boundary  
 Description:

Between Doyen  
 St. and Dewey  
 St. between  
 Bldg. 652 and  
 Decatur Ave.

Facility  
 No.

654/655

LOCATION :

PSNS  
 GRID  
 K 35

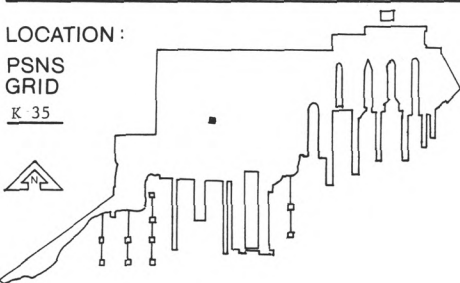

UTM Zone	Easting	Northing
10	5 2 6 6 6 4	5 2 6 7 2 5 8

Quadrangle Bremerton West  
 scale 1:24,000



### CONTINUATION of SIGNIFICANCE

Building 654 was sited with 652 and 656 on a ridge overlooking the newly created flat ground areas known as the Parade Ground.

Building 654 remained as Marine Officers Quarter until the termination of the Marine Reservation and the return of the Reservation property to the control of the shipyard. The building retains its position overlooking the Parade Ground. The building has been well maintained.

Surveyed by

August Gene Grulich, A.I.A.

Date

August 1985

NAME OF STRUCTURE OFFICER'S QUARTERS & GARAGE 657

Construction Date 1911

Alterations/Additions

Uses: Original Jr. Officer Quarter USMC

(Alt-57, 62)

WWII Marine Officer Quarters

(Remod-57, elect; 79, repairs)

Present Officer's Quarters

DESIGNED BY J.H. De SIBOUR WASHINGTON D.C.

DATE 1910

DESCRIPTION: Condition Excellent Altered No Original Site Yes

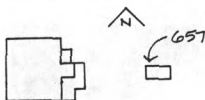

Building 656, officer's quarters is a rectangular two story brick residence with attic. The red brick veneer over wood frame is laid in a common bond with 6th course headers. A projecting front porch measures the length of the front elevation. The building measures 46 feet by 38 feet with a porch of 46 feet by 18 feet. The porch is constructed with modified "Etruscan" columns supporting a flat roof with balustrade above. The building exhibits several "Georgian" details, including the porch, flat brick arches with limestone keystone and sills, also corbeled brick chimneys. The roof of the building is a mansard roof with composition shingles and hip roof dormers. Windows are wood double-hung in wood frames with 6 over 1 lights. A continuous limestone band is formed by the window sills of the upper floor. At the rear of the residence there is a glazed-in porch contained within a balustrade of turned balusters.

(cont'd) a skylight. The bath has hexagonal tile. The attic has painted wood ( fir) floors and a bath with hexagonal tile floor and a claw-foot bathtub. The basement has concrete floor, brick exterior walls and plaster partitions. In the basement there is an old clothes dryer manufactured by the Chicago Dryer Co. titled Chicago "Francis" Dryer # 9356.

The interior of Quarters 656 (M-3) consists of oak floors on the first and second floors and painted wood (fir) in the attic. All walls are plaster on wood lath. The entry contains a central stairway to the upper floors and entry via double pocket doors to the living room and library. There are fireplaces in the living room, dining room and library of similar design which include wood surround and mantle. The ceiling height is 9 feet. Double pocket doors are between living room and dining room. The kitchen has vinyl floor, painted wood cabinets and plastic laminate countertops. The stairway has painted square newel posts and square spindle. The second floor has a 9 foot ceiling and contains

(continued on back)

SIGNIFICANCE:

Period 1900- Area of Significance Military

1. 2. 3. 4.

Building 656 was constructed with Building 652 and 654 in 1911 when the second Marine Reservation was established. The design of Building 656 exhibits "Georgian" detail in a "Georgian/Federal" influenced composition. Its colonaded porch, brick exterior and hipped mansard roof are composed in a symmetrical composition. Building 656 and Building 654 are identical compositions while 652 exhibits minor alterations to the composition. Building 656 was designed by architect J.H. DeSibour of Washington D.C. for the United States Marine Corp.

Building 656 served as Officers Quarters for the Marine Reservation. Construction of 656 as well as 652, 654 and the Marine Barracks Building 169 reflected a major expansion (cont'd on back)



Negative No.  
SP 85-00992-656

Acreage:  
less than 1  
Verbal Boundary  
Description:  
Between Doyen  
St. and Dewey  
St. adjacent  
to Bldg. 652.



Facility  
No.

656/657

LOCATION :

PSNS  
GRID  
J 35

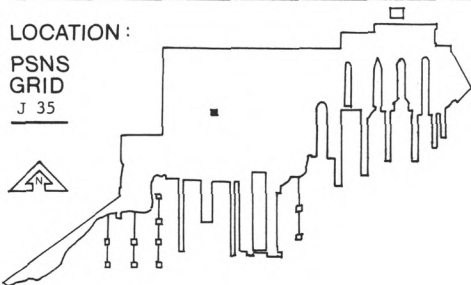

UTM Zone	Easting			Northing		
10	5	2	6	6	2	5
Quadrangle	Bremerton West					
scale	1:24,000					



Garage 657, constructed in 1936, with sign "M7" is a gable roofed, one car garage with cedar shingles on the roof and asbestos shingles for siding. The floor is a concrete slab.

## CONTINUATION of SIGNIFICANCE

of the Marine personnel at the shipyard. This expansion was in response to the expanded role of the Marines as defined by Executive Order 969 in November of 1908.

Building 656 was sited with 652 and 654 on a ridge overlooking the newly created flat ground area known as the Parade Ground. Building 656 remained as Marine Officers Quarters until the termination of the Marine Reservation and the return of the Reservation property to the control of the shipyard. The building retains its position overlooking the Parade Ground. The building has been well maintained.

# PSNS INVENTORY

# HISTORIC SURVEY PUGET SOUND NAVAL SHIPYARD

NOV 7 2 1988

Historic Name

MARINE OFFICER'S QUARTERS  
M4, M4A, M4B, M4C, M4D

Facility  
No.

658

NAME OF STRUCTURE OFFICER'S QUARTERS & GARAGE 659

Construction Date 1914

Uses: Original Marine Officers Quarters

WWII " " "

Present Officers Quarters

Alterations/Additions

(Alt-50, stair 7 porches)

(Remod-52, roof; 61, kit; 62, kit; 79, roof,  
whole house repair)

DESIGNED BY UNITED STATE NAVY YARD, PUGET SOUND WASHINGTON

DATE 1913

DESCRIPTION:

Condition Excellent

Altered Yes Original Site Yes



Building 658, Officer's Quarters, is a four residence, two story brick veneer over wood frame building with attic and basement. The brick is dark red common and laid in a running bond. The building exhibits "Georgian" influences in design. The entry doors are wooden doors and frames with lights in upper portions with side lights. The main entry is crowned with an oval fanlight constructed of wood. Windows are double-hung wood sash with 6 over 1 lights. The window heads are flat arched with limestone keystone and limestone sills. The exterior walls rest on a concrete base forming basement walls. The attic is enclosed with gable and hip roof sections and contains dormers crowned with hip roofs. The dormers are sided with 8 inch bevel siding containing double-hung wooden windows with 3 over 2 lights. Covered exterior porches are inset in the exterior walls. The porches are formed by two exterior walls of the building and a square corner pier of brick. Railings of the porches are wrought iron.

Building 658 is composed of four single floor units (two up/two down). One entry foyer serves units M4A and M4C and another serves M4B and M4D. The foyers have enlaid marble floors. Each unit has oak floors, plaster on wood lath walls and ceilings. Each unit entry has crown moldings at the ceiling. The fireplace contains wood mantle, flanking openings are two fluted columns. The hearth is stained concrete in a tile pattern. Ceiling are 9 ft in height. Baths have hexagonal white tile floors and rectangular tile wainscot. Bath thresholds are marble. Sliding pocket doors separate

(cont'd) living and dining rooms. Kitchens of all units are slightly different with cabinets of painted wood or stained/varnished wood, VAT on all kitchen floors. The attic is half unfinished and half with bedroom and central hallway with bath. The basement is open unused storage with concrete floor, walls and columns. Interior stair is steel. (cont'd on back)

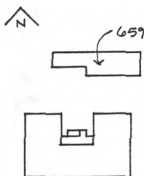

SIGNIFICANCE:

1. 2. 3. 4.

Period 1900-

Area of Significance Military

Building 658 was the first four-plex constructed as quarters. Constructed for Marine Officers, it was one of five original quarters' buildings for the new Marine Reservation established in 1910. Constructed in 1910 it served as quarters for Bachelor Marine Officer until 1924 when it was assigned as Apartment House for Marine Corp.

Building 658 reflects the "Georgian/Federal" influences of the other Marine quarters but was designed by the Navy Yard Puget Sound under the direction of Public Works Officer, Captain L.E. Gregory, U.S.N. The design is composed of four units, two over two, in a configuration of two stories with additional spaces in the attic and basement. The design has a symmetrical front and rear with the main entry on the sides. The "Georgian"

(cont'd on Back)



Negative No.  
SP 85-00992 -658

Acreage:  
less than 1  
Verbal Boundary  
Description:  
Between Doyen  
St. and Dewey  
St., South of  
Cole Avenue.



Facility  
No.  
658/659

LOCATION :

PSNS  
GRID  
I 35

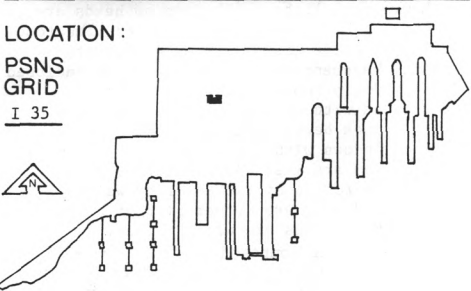

UTM Zone	Easting			Northing									
110	5	2	6	6	5	8	5	2	6	7	4	1	2

Quadrangle Bremerton West  
scale 1:24,000



Building 659 serves as garage for Building 568 . The garage was constructed in 1947.

**CONTINUATION of SIGNIFICANCE**

details of brick walls with white painted windows and doors are consistant with buildings of similar design including 652,654 and 656.  
Building 658 is the last remaining major structure of the Marine Reservation (several garages were constructed later) and completes the composition. The building has experienced modernization of its plumbing and wiring. The building has been well maintained.